



PERMIT CARD - PLEASE POST AT JOB SITE

THIS DOCUMENT BECOMES YOUR PERMIT WHEN PROPERLY VALIDATED

Per FBC 105 3.3 An enforcing authority may not issue a building permit for any building construction, erection, alteration, modification, repair or addition unless the permit either includes on its face or there is attached to the permit the following statement: "NOTICE: In addition to the requirements of this permit, there may be additional restrictions applicable to this property that may be found in the public records of this county, and there may be additional permits required from other governmental entities such as water management districts, state agencies, or federal agencies." The issuance of this permit does not grant permission to violate any applicable City, Orange County, State of Florida and/or Federal codes and/or ordinances. Separate permits are required for Signs, Roofing, Electrical, Gas, Plumbing and Mechanical services. This permit becomes VOID if the work authorized is not commenced within 6 months, or is suspended or abandoned for a period of 6 months after commencement. WORK SHALL BE CONSIDERED SUSPENDED IF AN APPROVED INSPECTION HAS NOT BEEN MADE WITHIN A 6 MONTH PERIOD. PERMISSION IS GRANTED TO DO THE FOLLOWING WORK ACCORDING TO THE CONDITIONS HEREON AND THE APPROVED PLANS AND SPECIFICATIONS, SUBJECT TO COMPLIANCE WITH THE ORDINANCES OF THE CITY OF BELLE ISLE, FLORIDA.

Scope of Work: BUILDING: Shed

Comments: None

Project Information
 Address: 2414 Hoffner Ave, Belle Isle, FL 32809
 Parcel ID: 18-23-30-8856-05-261
 Property Owner: Gregory, Steve
 Phone Number: 727-644-7018

 Company Name: BY OWNER
 Contractor Name:
 License Number:
 Address:
 Phone Number:

Permit Number: 2014-12-004
Date of Application: 12/09/2013
Date Permit Issued: 08/01/2014

WARNING TO OWNER: "YOUR FAILURE TO RECORD A NOTICE OF COMMENCEMENT MAY RESULT IN YOU PAYING TWICE FOR IMPROVEMENTS TO YOUR PROPERTY, IF YOU INTEND TO OBTAIN FINANCING, CONSULT WITH YOUR LENDER OR AN ATTORNEY BEFORE RECORDING YOUR NOTICE OF COMMENCEMENT." ON THE JOB INSPECTION(S) MUST BE MADE BEFORE PROCEEDING WITH SUBSEQUENT WORK. THIS CARD MUST BE DISPLAYED OUTSIDE AND BE PROTECTED FROM THE WEATHER WHILE BEING VISIBLE FROM THE STREET UNTIL THE FINAL INSPECTIONS HAVE BEEN APPROVED.

BUILDING FEATURES

<p>IMPACT FEES</p> <p>School \$ Traffic \$</p> <p>ZONING FEES</p> <p>Zoning Fee \$60.00 ATF</p> <p>UNIVERSAL ENG - BUILDING FEES</p> <p>Boat Dock \$ Boat House \$ Building \$ Demo \$ Door(s) \$ Driveway \$ Electrical \$ Fence \$ Gas \$ Irrigation \$ Low Voltage \$ Mechanical \$ Plumbing \$ Pool \$ Roofing \$ Screen End \$ Shed \$87.00 ATF Temp Pole \$ Window(s) \$</p> <p>SURCHARGE FEES</p> <p>Surcharge Fee \$2.00 Surcharge Fee \$2.00</p> <p>TOTAL FEES \$151.00</p> <p>Date Paid 8-7-14 CC or Check # 5032 Amount Paid \$151.00</p> <p>The person accepting this permit shall conform to the terms of the application on file and construction shall conform to the requirements of the Florida Building Code (FS 553).</p>	<p>BUILDING INSPECTOR USE ONLY</p> <p>IF APPLICABLE: Have Zoning Approval Conditions Been Met? YES NO Have Stormwater Approval Conditions Been Met? YES NO Silt fencing in place? YES NO Turbidity Barrier in place? YES NO</p> <p>BUILDING 1st _____ (Footing/Foundation) Survey specific foundation plan must be onsite before slab pour. Approved Plan on Site? _____ 2nd _____ (Slab) 3rd _____ (Lintel) (Wall Reinforcing on Masonry Building) 4th _____ (Exterior Framing) (Roof/Wall Sheathing) 5th _____ (Framing) (To be made after Plumbing/ Mechanical/ Electrical Rough-Ins & Windows/Doors Installed) 6th _____ (Insulation to be Made After Roof Installed) 7th _____ (Drywall) 8th _____ (Sidewalk/Driveway) 9th _____ (Other) 10th _____ (Final - After MEP and Other Applicable Finals)</p> <p>ROOFING OSHA APPROVED ACCESS MUST BE MADE AVAILABLE TO INSPECTOR 1st ROOFING Deck Nailing/Dry-in/Flashing _____ 2nd ROOFING Covering In-Progress _____ 3rd ROOFING Covering Final _____</p> <p>PLUMBING (Pool-Piping, Solar, Irrigation, Water Treatment Equip, Etc...) 1st _____ (Underground) 2nd _____ (Sewer) 3rd _____ (Rough-In/Tub Set) 4th _____ (Final)</p> <p>CHECK APPROPRIATE BOX GAS ___ Natural ___ LP ___ MECHANICAL ___ ELECTRICAL ___ LOW VOLTAGE 1st _____ (Rough-In) 2nd _____ (Final)</p>
--	--

Inspection requests are to be emailed to BidScheduling@UniversalEngineering.com; a confirmation email will be sent back to you upon scheduling. Next-Day Inspection requests must be made by 1pm. Please include the following in your request: Permit #, project address, type of inspection, date of the requested inspection, a contact name & a contact phone number. AM or PM may be requested but cannot be guaranteed.

AFT

CITY OF BELLE ISLE
Permit Application Review Sheet

Permit Number	2014-12-004
Property Owner	Gregory
Address	2414 Hoffner Ave
Nature of Improvement	Shed
Received Application	12-9-13
Sent for Stormwater Review	12-9-13
Stormwater Approved	3-14-14
Sent for Zoning Review	12-9-13
Zoning Approved	3-14-14
Applied for Variance	1-28-14
Variance Approved	2-25-14
Sent to BO for Review	3-14-14
Building Official Approved	8-01-2014
Comments	
1. 3-20-14 scq	emailed Steve Angelo's comments
2. 6-6-14 scq	emailed Steve for Status of plans
3. 7-1-14 scq	" " " " " "
4. 7-16-14 Susan	please see new plans attached w/ # 39308
5. 7-17-2014 AP	Certify Plans to EXPOSURE "D". Add details
6. " "	OF BOTTOM PLATE ANCHORING TO SUCH EXPOSURE
7. 7-21-14 scq	emailed Angelo's comments to Steve
8. 7-29-14	Received revised plans w/ 40183
9.	
10.	
11.	
12.	

A77

CITY OF BELLE ISLE
Permit Application Review Sheet

Permit Number	2014-12-004
Property Owner	Georgy
Address	2414 Hoffman Ave
Nature of Improvement	Shed
Received Application	12-9-13
Sent for Stormwater Review	12-9-13
Stormwater Approved	3-14-14
Sent for Zoning Review	12-9-13
Zoning Approved	3-14-14
Applied for Variance	Jan. 2014
Variance Approved	2-25-14
Sent to BO for Review	3-14-14
Building Official Approved	

Comments

1. 12-9-13 sq emailed app to Keith for approval
2. 12-9-13 sq Keith needs construction plans + revised site plan showing setbacks. Also need FPA for window + door.
- 3.
4. 12-16-13 sq need plans, survey + FPA docs - emailed to Keith to review.
- 5.
6. 1-10-14 sq emailed Keith for status; applied for variance ^{mtg 01-28-14}
7. 2-12-14 sq emailed Keith for variance status. ^{mtg 02-25-14} must wait 15 days for final approval.
- 8.
9. 3-12-14 sq emailed up for status.
10. 3-14-14 sq need zoning / stormwater approval
11. 3-20-14 AP package is missing the structural plans.
12. Please provide a signed & sealed set (original) or provide Florida Prod. Approval documents of shed.



COBI Permit Fee Calculation Form



Reviewer Signature: AP, Date: 7-17-2014

Permit Type: Shed Job Cost: \$ 1300-

Permit Fee: \$ 29-X2 = \$58

Plans Review Fee: \$ 14.50 X 2 = \$29 (50% of permit fee - excluding ReRoofs)

1.5% State Fee: \$ 2100

1.5% State Fee: \$ 2100

TOTAL BUILDING FEE: \$ 47.50 91.00 (*SWO is already included*)
(does not include Zoning fees or Deposits)

Note: Total gets doubled for SWO/AFT permits

$25 + (\$4 \times 1) = 25 + 4 = \29
 $29 \times 50\% = 14.50 + 29 = \$43.50 \times 2 = \$87 + 4 = \91
 $\frac{58}{29} = \frac{87}{43.5}$
~~\$47.50~~
~~\$91.00~~
\$91.00 (STOP WORK-ORDER)



City of Belle Isle

Universal Engineering Sciences 3532 Maggie Blvd., Orlando, FL 32811
Tel 407-581-8161 * Fax 407-581-0313 * www.universalengineering.com

received
12-9-13

Building Permit (Land Use) Application

PERMIT # 2014-12-004

DATE: 12-2-13

PROJECT ADDRESS 2414 Hoffer Ave, Belle Isle, FL 32809 32812

PROPERTY OWNER Steve Gregory PHONE 787-649-7018 VALUE OF WORK (labor & material) \$ 1,300

PLEASE LIST THE NATURE OF YOUR PROPOSED IMPROVEMENTS

Shed for back yard

- Please provide information, if applicable.
- Survey specific foundation plan required to show compliance with zoning setbacks
- BOAT DOCK: DEP Clearance Required with Application (Call 407-897-4100); please provide a copy of their report
- SEPTIC SYSTEM (RESIDENTIAL): - Provide verification of OC Health Dept approval for on-site septic tank system, per FAC Chap. 64E-6
- Homeowners will be required to have a contractor on record for homes that are rented and/or not homestead

Please Complete for the City of Belle Isle Zoning Review: Parcel Id Number: 18-23-30-8856-05-261

To obtain this information, please visit <http://www.ocpafl.org/Searches/ParcelSearch.aspx>

Wind Exposure Category: B C D

SPECIAL CONDITIONS: STRUCTURES MAY NOT ENCROACH INTO ANY EASEMENT OR REQUIRED SETBACK. Note, this Zoning Approval MAY or MAY NOT be in conflict with your Deed Restrictions. For New Single Family Residence, a Traffic Impact Fee and School Impact will be assessed.

Attached Survey SETS and Construction Plans SETS

PLANNING & ZONING APPROVAL: _____ DATE _____

PLEASE COMPLETE for Building Review

CONSTRUCTION TYPE _____ Res: Single Fam Multi Fam _____

OCCUPANCY GROUP _____ Comm _____ # UNITS _____ # STORIES _____ TOTAL SQ.FT. _____

MAX. FLOOR LOAD _____ MAX. OCCUPANCY _____

MIN. FLOOR ELEV. _____ LOW FLOOR ELEV. _____

WATER SERVICE _____ WELL _____ SEPTIC _____

BUILDING REVIEWER Angela Perez DATE 8-01-2014

Per FSS 105.3.3: An enforcing authority may not issue a building permit for any building construction, erection, alteration, modification, repair or addition unless the permit either includes on its face or there is attached to the permit the following statement: "NOTICE: In addition to the requirements of this permit, there may be additional restrictions applicable to this property that may be found in the public records of this county, and there may be additional permits required from other governmental entities such as water management districts, state agencies, or federal agencies."

Republic Services is by legal contract the sole authorized provider of garbage, recycling, yard waste, and commercial garbage and construction debris collection and disposal services with the city limits of the City. Contractors, homeowners and commercial businesses may contact Republic Services at 407-293-8000 to setup accounts for Commercial, Construction Roll Off, or other services needed. Rates are fixed by contract and are available at City Hall or from Republic Services. The City enforces the contract through its code enforcement office. Failure to comply will result in a stop work order.

SEPARATE PERMITS ARE REQUIRED FOR ROOFING, ELECTRICAL, PLUMBING, GAS, MECHANICAL, SIGNS, POOLS, ENCLOSURES, ETC.

SPRINKLERS REQ'D	Y	N	RCD
IF Required - SUBMIT COPY OF PLANS FOR FIRE REVIEW			
ZONING	<input checked="" type="radio"/>		\$ <u>300.00</u>
CERT OF OCC	<input type="radio"/>		\$
TRAFFIC	<input type="radio"/>		\$
SCHOOL	<input type="radio"/>		\$
FIRE	<input type="radio"/>		\$
SWIMMING POOL	<input type="radio"/>		\$
SCREEN ENCLOSURE	<input type="radio"/>		\$
ROOFING	<input type="radio"/>		\$
BOAT DOCK	<input type="radio"/>		\$
BUILDING	<input type="radio"/>		\$
WINDOW(S)	<input type="radio"/>		\$
DOOR(S)	<input type="radio"/>		\$
FENCE	<input type="radio"/>		\$
SHED	<input checked="" type="radio"/>		\$ <u>87.00</u>
DRIVEWAY	<input type="radio"/>		\$
OTHER	<input type="radio"/>		\$
3% FL SURCHARGE			<u>4.00</u>
TOTAL			<u>\$ 151.00</u>
By Owner Form	Y	NA	
Notice of Commencement	Y	NA	
Power of Attorney	Y	NA	
Contractor Packet Included?	Y	N	
OTHER PERMITS REQUIRED:			
ELECTRICAL	Y	NA	
PREPOWER	Y	NA	
MECHANICAL	Y	NA	
PLUMBING	Y	NA	
ROOFING	Y	NA	
GAS	Y	NA	

AFT double fee



City of Belle Isle
 Universal Engineering Sciences 3532 Maggie Blvd., Orlando, FL 32811
 Tel 407-581-8161 * Fax 407-581-0313 * www.cityofbelleisle.com

Received
12-9-13

Building Permit (Land Use) Application

DATE 12-2-13 PERMIT # 2014-12-004

PROJECT ADDRESS 2414 Heffner Ave Belle Isle, FL 32809 32812

PROPERTY OWNER Steve Gregory OWNER 73-699-35 VALUE OF WORK (labor & material) \$ _____

PLEASE LIST THE NATURE OF YOUR PROPOSED IMPROVEMENTS

- Survey specific foundation plan required to show compliance with zoning setbacks
- **BOAT DOCK:** DEP Clearance Required with Application (Call 407-897-4100); please provide a copy of their report
- **SEPTIC SYSTEM (RESIDENTIAL):** - Provide verification of OC Health Dept approval for on-site septic tank system, per FAC Chap. 64E-6
- Homeowners will be required to have a contractor on record for homes that are rented and/or not homestead

Please provide information, if applicable.

Please Complete for the City of Belle Isle Zoning Review: Parcel Id Number: _____

To obtain this information, please visit <http://www.cityofbelleisle.com>

ZONING
APPROVED

SPECIAL CONDITIONS: STRUCTURES MAY NOT ENCRoACH INTO ANY EASEMENT OR REQUIRED SETBACK. Note, this Zoning Approval MAY or MAY NOT be in conflict with your Deed Restrictions. For New Single Family Residences, a Traffic Impact Fee and School Impact will be assessed.

Attached Survey SETS and Construction Plans SETS
 Date: 11-11-13
 PLANNING & ZONING APPROVAL: [Signature] City of Belle Isle
 DATE _____

Wind Exposure Category: B C D

SPRINKLERS REQ'D	Y	N	RCD
IF Required - SUBMIT COPY OF PLANS FOR FIRE REVIEW			
ZONING	<input checked="" type="checkbox"/>		\$ 30"
CERT OF OCC	<input checked="" type="checkbox"/>		\$
TRAFFIC	<input checked="" type="checkbox"/>		\$
SCHOOL	<input checked="" type="checkbox"/>		\$
FIRE	<input checked="" type="checkbox"/>		\$
SWIMMING POOL	<input checked="" type="checkbox"/>		\$
SCREEN ENCLOSURE	<input checked="" type="checkbox"/>		\$
ROOFING	<input checked="" type="checkbox"/>		\$
BOAT DOCK	<input checked="" type="checkbox"/>		\$
BUILDING	<input checked="" type="checkbox"/>		\$
WINDOW(S)	<input checked="" type="checkbox"/>		\$
DOOR(S)	<input checked="" type="checkbox"/>		\$
FENCE	<input checked="" type="checkbox"/>		\$
SHED	<input checked="" type="checkbox"/>		\$
DRIVEWAY	<input checked="" type="checkbox"/>		\$
OTHER	<input checked="" type="checkbox"/>		\$

PLEASE COMPLETE for Building Review

CONSTRUCTION TYPE _____ Res: _____ Single Farm _____ Multi Farm _____

OCCUPANCY GROUP _____ #UNITS_#STORIES _____ TOTAL SQ.FT. _____

MAX FLOOR LOAD _____ MAX OCCUPANCY _____

MIN FLOOD ELEV. _____ WELL _____ SEPTIC _____

WATER SERVICE _____ DATE _____

BUILDING REVIEWER _____ DATE _____

NOTES _____

Per FSS 105.3.3
 An enforcing authority may not issue a building permit for any building construction, erection, alteration, modification, repair or addition unless the permit either includes on its face or there is attached to the permit the following statement: "NOTICE: In addition to the requirements of this permit, there may be additional restrictions applicable to this property that may be found in the public records of this county, and there may be additional permits required from other governmental entities such as water management districts, state agencies, or federal agencies."

Retaining structures, as defined, shall be the sole authorized provider of adequate residential yard waste and commercial garbage and construction debris collection and disposal services within any limits of the City of Belle Isle. Homeowners and commercial businesses may contact Republic Services at 407-242-3000 to setup accounts for Commercial Construction Debris but no other services provided. Rates are listed by contract and are available at City Hall or from Republic Services. The City enforces the contract through its code enforcement office. Failure to comply will result in a stop work order.



City of Belle Isle
 Universal Engineering Sciences 3532 Maggie Blvd., Orlando, FL 32811
 Tel 407-581-8161 * Fax 407-581-0313 * www.universaleengineering.com

Building Permit (Land Use) Application
 To be completed as required by State Statute Section 713 and other applicable sections.

PERMIT # _____

Owner's Name Steve Gregory
 Owner's Address 2414 Hoffman Ave, Belle Isle, FL 32809

Contractor Name	Company Name
License #	Company Address
Contact Phone/Cell	City, State, ZIP
Contact Email	Contact Fax

WARNING TO OWNER: Your failure to record a Notice of Commencement may result in your paying twice for improvements to your property. A notice of commencement must be recorded if job is \$2500(+) or if A/C Replacement \$7500(+) and posted on the job site before the first inspection. If you intend to obtain financing, consult with your lender or an attorney before recording your Notice of Commencement.

I hereby make Application for Permit as outlined above, and if same is granted I agree to conform to all Division of Building Safety Regulations (www.floridabuilding.org) and City Ordinances (www.municode.com) regulating same and in accordance with plans submitted. The issuance of this permit does not grant permission to violate any applicable City and/or State of Florida codes and/or ordinances. Application is hereby made to obtain a permit to do the work and installations as indicated. I certify that no work or installation has commenced prior to the issuance of a permit and that all work will be performed to meet the standards of all laws regulating construction in this jurisdiction. I understand that a separate permit must be secured for all other construction including ROOFING, ELECTRICAL, MECHANICAL, PLUMBING, GAS, SIGNS, POOLS, SCREEN ENCLOSURES, ETC.

OWNER'S AFFIDAVIT: I certify that all the foregoing information is accurate and that all work will be done in compliance with all applicable laws regulating construction and zoning.

Owner Signature SG
 The foregoing instrument was acknowledged before me this 12/2/13
 by Steve Gregory who is personally known to me
 and who produced PL DL
 as identification and who did not take an oath.
 Notary as to Owner
 State of Florida
 County of Orange

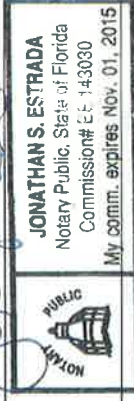

Contractor Signature _____
 COMPANY NAME _____
 The foregoing instrument was acknowledged before me this 1/1
 by _____ who is personally known to me
 and who produced _____
 as identification and who did not take an oath.
 Notary as to Owner
 State of Florida
 County of Orange

Impervious Surface Ratio Worksheet
 Development Zoned A-1, A-2, R-1-AAA, R-1-AA, R-1-A, R-1 per City Code, Section 50-74: Impervious Surface Ratio

1. Total Lot Area (sqft) X 0.35 = Allowable Impervious Area (BASE)
 Total Lot Area 18002 X 0.35 =
 Allowable Impervious Area (BASE) 6300.7

2. Calculate the "proposed" impervious area on the lot. This includes the sum of all areas that do not allow direct percolation of rainwater.
 Examples include house, pool, deck, driveway, accessory building, etc

- House 2392
- Driveway 2000
- Walkway 200
- Accessory Buildings _____
- Pool & Spa _____
- Deck & Patio 200
- Other _____

Actual Impervious Area (AIA) 4792

3. If AIA is less than BASE, subtract AIA from BASE to determine the amount of impervious area that may be added without providing onsite retention.

4. If AIA is greater than BASE, then onsite retention must be provided.

Assuming 7.5 inches of rainfall based on a 24hr 10 year Rain Event (TP40), the formula is: (7.5 inches rainfall/12 inches p/foot) X (result from line 4) = cubic feet of storage volume needed



City of Belle Isle

Universal Engineering Sciences 3532 Maggie Blvd., Orlando, FL 32811
Tel 407-581-8161 * Fax 407-581-0313 * www.universalsengineering.com

OWNER BUILDER DISCLOSURE STATEMENT

Per Florida Statute 455.228:

Homeowners hiring unlicensed Contractors may be subject a fine of up to \$5,000.00!

Before me this day personally appeared Steven Gregory who being duly sworn, deposes, and says as follows. "I hereby acknowledge that I have read and fully understand the individual provisions of this instrument."

1. I understand that state law requires construction to be done by a licensed contractor and have applied for an owner-builder permit under an exemption from the law. The exemption specifies that I, as the owner of the property listed, may act as my own contractor with certain restrictions even though I do not have a license
SCB Initial
2. I understand that building permits are not required to be signed by a property owner unless he or she is responsible for the construction and is not hiring a licensed contractor to assume responsibility. SCB Initial
3. I understand that, as an owner-builder, I am the responsible party of record on a permit. I understand that I may protect myself from potential financial risk by hiring a licensed contractor and having the permit filed in his or her name instead of my own name. I also understand that a contractor is required by law to be licensed in Florida and to list his or her license numbers on permits and contracts. SCB Initial
4. I understand that I may build or improve a one-family or two-family residence or a farm outbuilding. I may also build or improve a commercial building if the costs do not exceed \$75,000.00. The building or residence must be for my own use or occupancy. It may not be built or substantially improved for sale or lease. If a building or residence that I have built or substantially improved myself is sold or leased within 1 year after the construction is complete, the law will presume that I built or substantially improved it for sale or lease, which violates the exemption. SCB Initial
5. I understand that, as the owner-builder, I must provide direct, onsite supervision of the construction. SCB Initial
6. I understand that I may not hire an unlicensed person to act as my contractor or to supervise persons working on my building or residence. It is my responsibility to ensure that the persons whom I employ have the licenses required by law and by county or municipal ordinance. SCB Initial
7. I understand that it is a frequent practice of unlicensed persons to have the property owner obtain an owner-builder permit, that erroneously implies that the property owner is providing his or her own labor and materials. I, as an owner-builder, may be held liable and subjected to serious financial risk for any injuries sustained by an unlicensed person or his or her employees while working on my property. My homeowner's insurance may not provide coverage for those injuries. I am willfully acting as an owner-builder and am aware of the limits of my insurance coverage for injuries to workers on my property. SCB Initial
8. I understand that I may not delegate the responsibility for supervising work to a licensed contractor who is not licensed to perform the work being done. Any person working on my building who is not licensed must work under my direct supervision and must be employed by me, which means that I must comply with laws requiring the withholding of federal income tax and social security contributions under the Federal Insurance Contributions Act (FICA) and must provide workers' compensation for the employee. I understand that my failure to follow these laws may subject me to serious financial risk. SCB Initial

Owner Builder Disclosure Statement

9. I agree that, as the party legally and financially responsible for this proposed construction activity, I will abide by all applicable laws and requirements that govern owner-builders as well as employers. I also understand that the construction must comply with all applicable laws, ordinances, building codes, and zoning regulations. SCG Initial
10. I understand that I may obtain more information regarding my obligations as an employer from the Internal Revenue Service, the United States Small Business Administration, the Florida Department of Financial Services, and the Florida Department of Revenue. I also understand that I may contact the Florida Construction Industry Licensing Board at (850)487-1395 or www.CallCenter@dbpr.state.fl.us for more information about licensed contractors. SCG Initial
11. I am aware of, and consent to, an owner-builder building permit applied for in my name and understand that I am the party legally and financially responsible for the proposed construction activity at the following address:
Project Address: 2414 Hoffner Ave, Belle Isle, FL 32809 SCG Initial
12. I agree to notify the City of Belle Isle Building/Zoning Department immediately of any additions, deletions, or changes to any of the information that I have provided on this disclosure. SCG Initial

Licensed contractors are regulated by laws designed to protect the public. If you contract with a person who does not have a license, the Construction Industry Licensing Board and Department of Business and Professional Regulation may be unable to assist you with financial loss that you sustain as a result of a complaint. Your only remedy against an unlicensed contractor may be in civil court. It is also important for you to understand that, if any unlicensed contractor or employee of an individual or firm is injured while working on your property, you may be held liable for damages. If you obtain an owner-builder permit and wish to hire a licensed contractor, you will be responsible for verifying whether the contractor is properly licensed and the status of the contractor's workers' compensation coverage.

Before a building permit can be issued, this disclosure statement must be completed and signed by the property owner and returned to the local permitting agency responsible for issuing the permit. A copy of the property owner's driver license, the notarized signature of the property owner, or other type of verification acceptable to the local permitting agency is required when the permit is issued.

Signature: <u>SCG</u> (Signature of the property owner)	Print: <u>Steve Gregory</u> (Name of the property owner)
Signature: _____ (Signature of the property owner)	Print: _____ (Name of the property owner)
Owner's Address: <u>2414 Hoffner Ave, Belle Isle, FL 32809</u>	
The foregoing instrument was acknowledged before me this <u>12</u> / <u>2</u> / <u>13</u>	
by <u>Steven Gregory</u> who is personally known to me / who produced the following _____ as identification and who did not take an oath.	
State of Florida / County of _____	Seal:
Notary Signature <u>[Signature]</u>	

TO POINT OF BEGINNING ALONG SAID LINE; RUN THENCE FROM THE SAID POINT OF BEGINNING SOUTH 7°56'18" EAST 102.75 FEET; THENCE SOUTH 13°55'22" EAST 79.55 FEET, THENCE EASTERLY 4.6 FEET TO INTERSECT THE PREVIOUSLY DESCRIBED LINE.

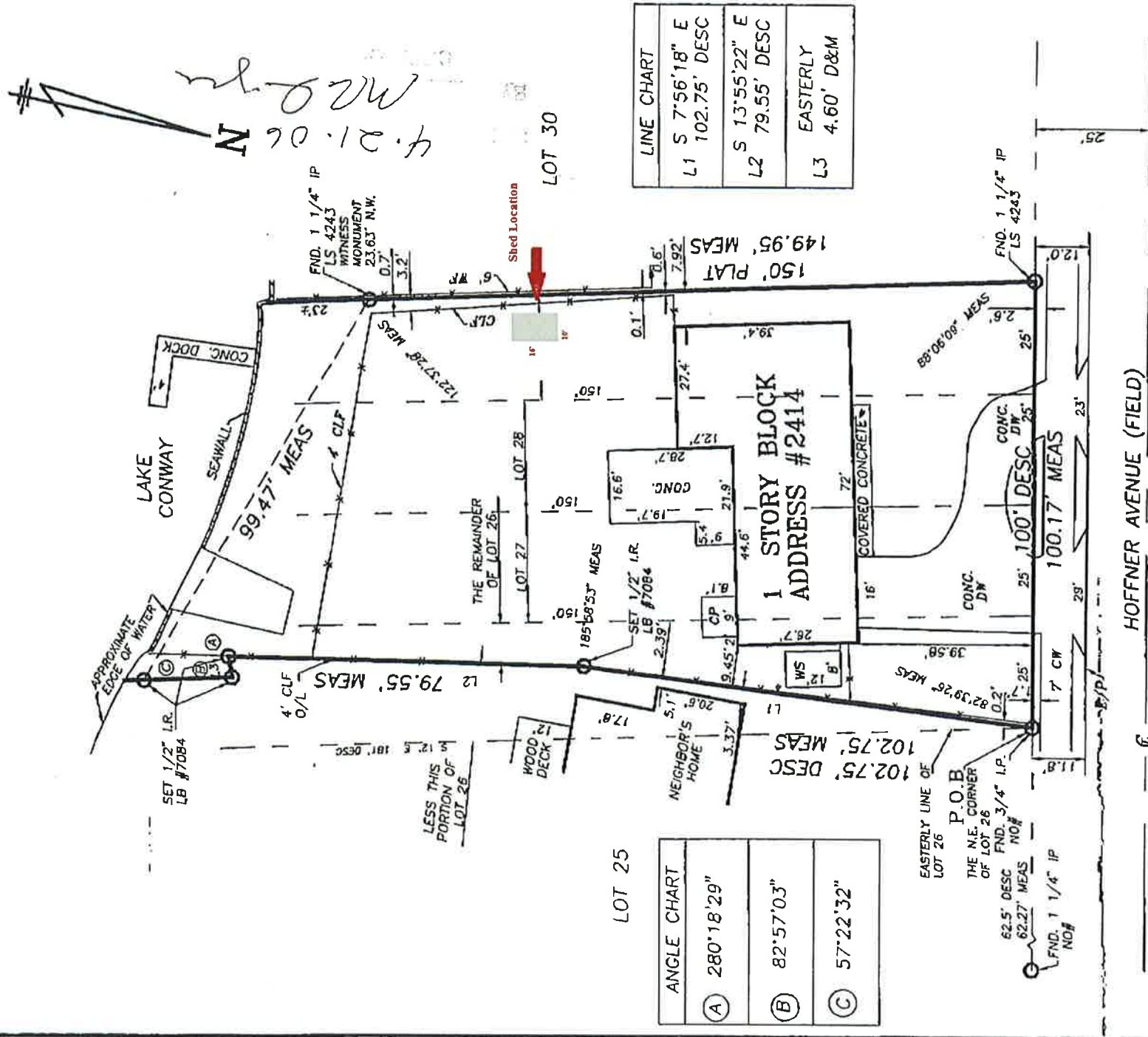

ANGLE CHART	
(A)	280°18'29"
(B)	82°57'03"
(C)	57°22'32"

LINE CHART	
L1	S 7°56'18" E 102.75' DESC
L2	S 13°55'22" E 79.55' DESC
L3	EASTERLY 4.60' D&M

HOFFNER AVENUE (FIELD)
CONWAY DRIVE (PER PLAT) (50' R/W)

DF# OCL-25-BLKE-LOTS25-28 NOTE: UNDERGROUND UTILITIES AND FOUNDATIONS HAVE NOT BEEN SHOWN.

BOUNDARY SURVEY CERTIFIED TO: STEVEN C. GREGORY; AMNET MORTGAGE, INC. d/b/a AMERICAN MORTGAG NETWORK OF FLORIDA ISADA ATIMA; TOWNSHIP TITLE SERVICES, LLC.; COMMONWEALTH LAND TITLE INSURANCE.

LEGEND

BC	BACK OF CURB	CBW	CONCRETE BLOCK WALL
CALC	CALCULATED	CM	CONCRETE MONUMENT
CLF	CENTERLINE	COVD	COVERED
CLF	CHAIN LINK FENCE	CW	CONCRETE WALKWAY
CONC	CONCRETE	DE	DRAINAGE EASEMENT
CP	CONCRETE PAD	ESMT	EASEMENT
DESC	DESCRIPTION	FFE	FINISHED FLOOR ELEVATION
E/P	EDGE OF PAVEMENT	IP	IRON PIPE
FND	FOUND	L	ARC LENGTH
		MS	METAL SHED

REVISIONS:

FIELD DATE: JULY 25, 2005
SCALE: 1"=30'
DRAWN BY: A.R./B.D.

THIS BUILDING IS IN FLOOD ZONE X, BASED ON FLD INSURANCE RATE MAP, NO.120181, 0430 E, CITY OF BELLE ISLE, FLORIDA.

BEARING STRUCTURE BASED ON: THE SOUTH R/ LINE OF HOFFNER AVENUE.

M.A.P. Land Surveying, Inc.

received
12-16-13

International energy star door. Swings outward from right to left.

10' x 16' and height = 89"

From floor to ceiling in all four corners and around window and door openings. Sunk 4" into ground with 2 bags of concrete

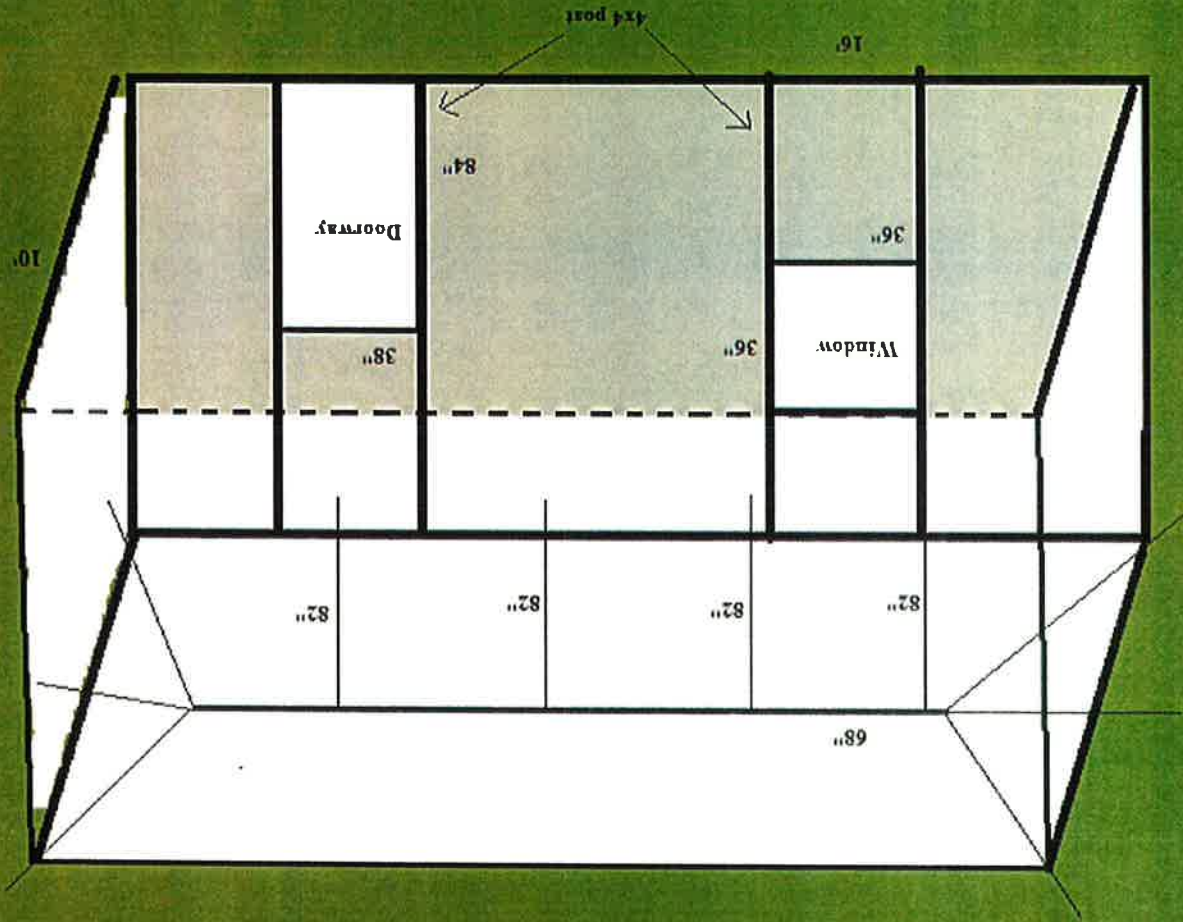

Plans

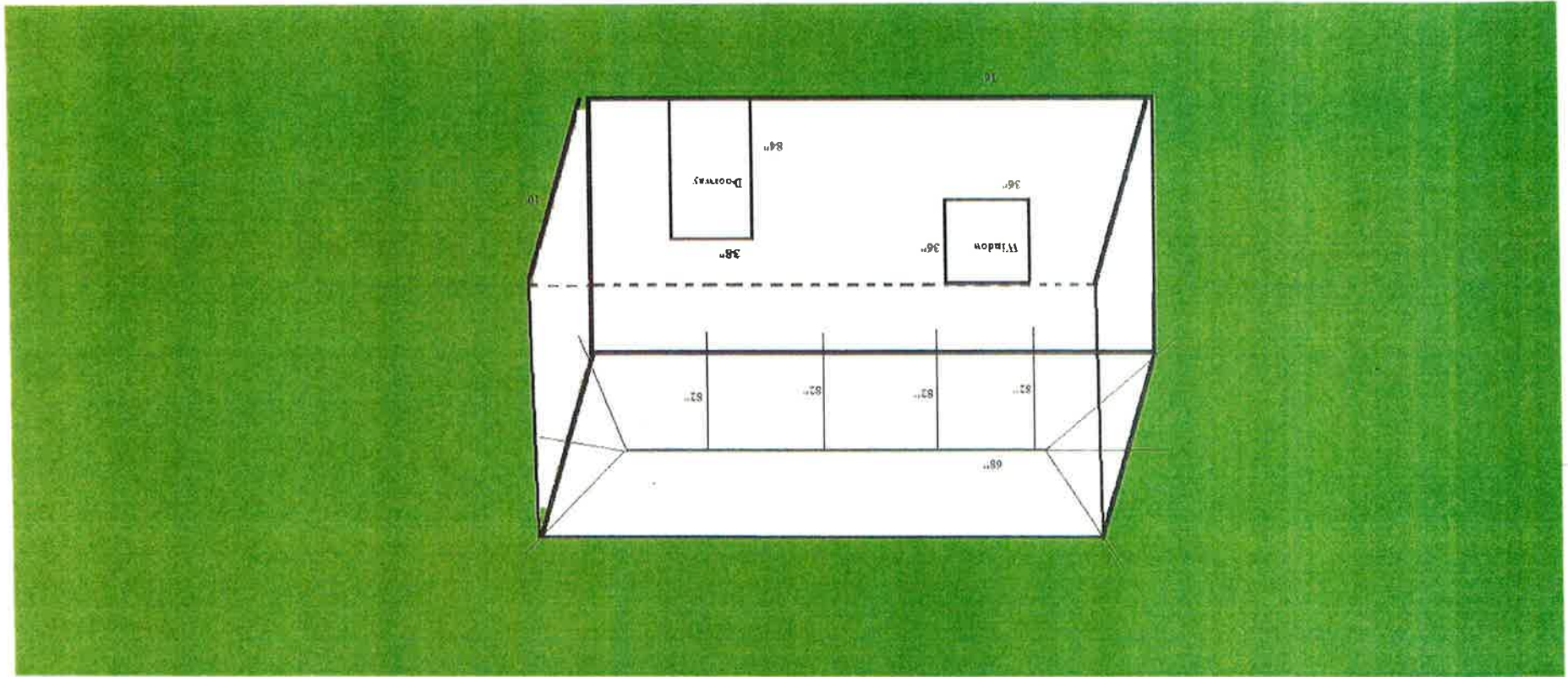

4x4 post as anchors from floor to ceiling in all four corners and around window and door openings. Sunk 1" into ground with 2 bags of concrete. Shed Dimensions: 10' x 16' and height = 89'



City of Belle Isle
 Universal Engineering Sciences 3532 Maggie Blvd., Orlando, FL 32811
 Tel 407-581-8161 * Fax 407-581-0313 * www.universalsengineering.com

Product Approval Form

DATE: 12-2-13 PERMIT # _____

PROJECT ADDRESS 2414 Holtzer Ave Belle Isle, FL 32809 32812

As required by Florida Statue 553.842 and Florida Administrative Code 9B-72m, please provide the information and approval numbers of the building components listed below if they will be utilized on the building or structure. FL Approved products are listed online at www.floridabuilding.org or can be obtained from the local product supplier. The following information must be turned in with permit application and available onsite for inspections:

1. This Product Approval Cover Sheet
2. Internet screen from FloridaBuilding.org showing PA#, approval and code edition stamped
3. Manufacturer's *installation* details from FloridaBuilding.org and requirements for each product stamped

Product Type	Manufacturer	Model/Series	FL Product Approval #	Product Type	Manufacturer	Model/Series	FL Product Approval #
EXTERIOR DOORS							
Swinging	Masprite	energy star	FL 16472	Sliding			
Sliding				Soffits			
Sectional/Rollup				Storefront			
Other				Glass Block			
				Other			
WINDOWS							
Single/Dbt Hung	Fella	10	FL 16336	Asphalt Shingles	Chorus Corning	Asphalt	FL 10674-06
Horizontal Slider				Non Struct Metal			
Casement				Roofing Tiles			
Fixed				Single Ply Roof			
Mullion				Other			
Skylights							
Other							
STRUCTURAL COMPONENTS							
Wood Connectors				OTHER			
Wood Anchors							
Truss Plates							
Insulation Forms							
Lintels							
Other							

It is the applicant's responsibility to verify that specific products have been installed in accordance with their limitations and with the minimum required design pressures for the structure. Specific compliance will be verified during field inspections.

Applicant Signature SOEL Date 12-2-13



BCIS Home | Log In | User Registration | Hot Topics | Submit Surcharge | Stats & Facts | Publications | FBC Staff | BCTS Site Map | Links | Search

Product Approval Menu > [Product or Application Search](#) > [Application List](#) > **Application Detail**

FL # **FL16236**
 Application Type **New**
 Code Version **2010**
 Application Status **Approved**

*Approved by DBPR. Approvals by DBPR shall be reviewed and ratified by the POC and/or the Commission if necessary.

Comments Archived

Product Manufacturer Address/Phone/Email
 Pella Corporation
 102 Main St.
 Pella, IA 50219
 (641) 621-6096
 pellaapproval@pella.com

Authorized Signature
 TROY FARR
 tfarr@pella.com

Technical Representative Address/Phone/Email
 Joseph Hayden
 102 Main Street
 Pella, IA 50219
 (641) 621-6096
 jahayden@pella.com

Quality Assurance Representative Address/Phone/Email
 TROY FARR
 18600 NE WILKES ROAD
 PORTLAND, OR 97230
 (503) 405-9176
 tfarr@pella.com

Category Subcategory
 Windows
 Single Hung

Compliance Method
 Certification Mark or Listing

Certification Agency Validated By
 Miami-Dade BCCO - CER
 Miami-Dade BCCO - VAL

Referenced Standard and Year (of Standard) **Standard** **Year**
 TAS 202 1994

Equivalence of Product Standards Certified By

Product Approval Method

Method 1 Option A

Date Submitted

03/01/2013

Date Validated

03/04/2013

Date Pending FBC Approval

03/12/2013

Date Approved

Summary of Products

FL #	Model, Number or Name	Description
16236.1	10 Series Flange Single Hung	10 Series 1/2" Flange Single Hung
<p>Limits of Use Approved for use in HVHZ: Yes Approved for use outside HVHZ: Yes Impact Resistant: No Design Pressure: +65/-82.5 Other: Configurations of glass conform to latest ASTM E1300 standard. (See table on engineering drawing for qualified sizes and pressures.)</p>		
<p>Certification Agency Certificate FL16236_R0_C_CAC_12-1108-02.pdf Quality Assurance Contract Expiration Date 01/31/2018 Installation Instructions FL16236_R0_II_12-1108-02.pdf Verified By: Miami-Dade BCCO - CER Created by Independent Third Party: Evaluation Reports FL16236_R0_AE_12-1108-02.pdf Created by Independent Third Party: Yes</p>		

[Back](#)

[Next](#)

Contact Us :: 1940 North Monroe Street, Tallahassee FL 32399 Phone: 850-487-1824

The State of Florida is an AA/EEO employer. Copyright 2007-2013 State of Florida. :: [Privacy Statement](#) :: [Accessibility Statement](#) :: [Refund Statement](#)

Under Florida law, email addresses are public records. If you do not want your e-mail address released in response to a public-records request, do not send electronic mail to this entity. Instead, contact the office by phone or by traditional mail. If you have any questions, please contact 850.487.1395.
 *Pursuant to Section 455.275(1), Florida Statutes, effective October 1, 2012, licensees licensed under Chapter 455, F.S. must provide the Department with an email address if they have one. The emails provided may be used for official communication with the licensee. However email addresses are public record. If you do not wish to supply a personal address, please provide the Department with an email address which can be made available to the public. To determine if you are a licensee under Chapter 455, F.S., please click [here](#).

Product Approval Accepts:





MIAMI-DADE COUNTY
DEPARTMENT OF REGULATORY AND ECONOMIC RESOURCES (RER)
BOARD AND CODE ADMINISTRATION DIVISION
NOTICE OF ACCEPTANCE (NOA)

MIAMI-DADE COUNTY, FLORIDA
PRODUCT CONTROL SECTION
11805 SW 26 Street, Room 208
T (786) 315-2590 F (786) 315-2599
www.miamidade.gov/economy

Pella Corporation
102 Main Street
Pella, IA 50219

SCOPE:

This NOA is being issued under the applicable rules and regulations governing the use of construction materials. The documentation submitted has been reviewed and accepted by Miami-Dade County RER-Product Control Section to be used in Miami-Dade County and other areas where allowed by the Authority Having Jurisdiction (AHJ).

This NOA shall not be valid after the expiration date stated below. The Miami-Dade County Product Control Section (In Miami-Dade County) and/or the AHJ (in areas other than Miami-Dade County) reserve the right to have this product or material tested for quality assurance purposes. If this product or material fails to perform in the accepted manner, the manufacturer will incur the expense of such testing and the AHJ may immediately revoke, modify, or suspend the use of such product or material within their jurisdiction. RER reserves the right to revoke this acceptance, if it is determined by Miami-Dade County Product Control Section that this product or material fails to meet the requirements of the applicable building code. This product is approved as described herein, and has been designed to comply with the Florida Building Code, including the High Velocity Hurricane Zone.

DESCRIPTION: Series "10 Vinyl ½" Flange" White PVC Single Hung Window – N.I.

APPROVAL DOCUMENT: Drawing No. 1840, titled "10 Series Vinyl Non-Impact Single Hung Window", sheets 1 through 4 of 4, dated 10/10/12 with the latest revision dated 01/10/13, prepared by W. W. Schaefer Engineering & Consulting, P.A., signed and sealed by Warren W. Schaefer, P. E., bearing the Miami-Dade County Product Control Section Approval stamp with the Notice of Acceptance number and Approval date by the Miami-Dade County Product Control Section.

MISSILE IMPACT RATING: None.

LIMITATION: The maximum anchor spacing at the Head and Sill shall NOT to exceed 12-inch on center if the design pressure is greater 50 psf.

LABELING: Each unit shall bear a permanent label with the manufacturer's name or logo, city, state, model/series, and following statement: "Miami-Dade County Product Control Approved", unless otherwise noted herein.

RENEWAL of this NOA shall be considered after a renewal application has been filed and there has been no change in the applicable building code negatively affecting the performance of this product.

TERMINATION of this NOA will occur after the expiration date or if there has been a revision or change in the materials, use, and/or manufacture of the product or process. Misuse of this NOA as an endorsement of any product, for sales, advertising or any other purposes shall automatically terminate this NOA. Failure to comply with any section of this NOA shall be cause for termination and removal of NOA.

ADVERTISEMENT: The NOA number preceded by the words Miami-Dade County, Florida, and followed by the expiration date may be displayed in advertising literature. If any portion of the NOA is displayed, then it shall be done in its entirety.

INSPECTION: A copy of this entire NOA shall be provided to the user by the manufacturer or its distributors and shall be available for inspection at the job site at the request of the Building Official. This NOA consists of this page 1 and evidence pages E-1 and E-2, as well as approval document mentioned above.

The submitted documentation was reviewed by **Jaime D. Gascon, P. E.**



NOA No. 12-1108.02
Expiration Date: January 31, 2018
Approval Date: January 31, 2013
Page 1

J. Gascon
1/25/13

Pella Corporation

NOTICE OF ACCEPTANCE: EVIDENCE SUBMITTED

A. DRAWINGS

1. Manufacturer's die drawings and sections.
2. Drawing No. 1840, titled "10 Series Vinyl Non-Impact Single Hung Window", sheets 1 through 4 of 4, dated 10/10/12 with the latest revision dated 01/10/13, prepared by W. W. Schaefer Engineering & Consulting, P.A., signed and sealed by Warren W. Schaefer, P. E.

B. TESTS

1. Test reports on: 1) Air Infiltration Test, per ASTM E 283-04 (12) and per FBC, TAS 202-94
2) Uniform Static Air Pressure Test, Loading per ASTM E 330-02 (10) and per FBC, TAS 202-94
3) Water Resistance Test, per ASTM E 547-00 (09), per ASTM E 331-00 (09) and per FBC, TAS 202-94
4) Forced Entry Test, per ASTM E 588-07, Type "A", Type "D", Grade "10" and per FBC 2411.3.2.1, TAS 202-94
along with marked-up drawings and installation diagram of single hung, prepared by National Certified Testing Laboratories, Inc., Test Reports No.'s NCTL-110-15216-1, NCTL-110-15215-1, NCTL-110-15212-1, NCTL-110-15211-1, NCTL-110-15198-1, NCTL-110-15195-1, NCTL-110-15196-1, NCTL-110-15198-1, NCTL-110-15197-1 and NCTL-110-15194-1, dated 10/28/12, signed and sealed by Harold E. Rupp, P. E.

C. CALCULATIONS

1. Anchor verification calculations and structural analysis, complying with **FBC-2010**, prepared by W. W. Schaefer Engineering & Consulting, P.A., dated 10/23/12, signed and sealed by Warren W. Schaefer, P. E.
2. **Glazing complies with ASTM E1300-04**

D. QUALITY ASSURANCE

1. Miami-Dade Department of Regulatory and Economic Resources (RER).

E. MATERIAL CERTIFICATIONS

1. Notice of Acceptance No. 11-0830.09 issued to Mikron Industries, Inc. for "**White Rigid PVC Exterior Extrusions for Windows and Doors**" dated 10/06/11, expiring on 12/26/16.



Jaime D. Gascon, P. E.

Product Control Section Supervisor

NOA No. 12-1108.02

Expiration Date: January 31, 2018

Approval Date: January 31, 2013

Pella Corporation

NOTICE OF ACCEPTANCE: EVIDENCE SUBMITTED

F. STATEMENTS

1. Statement letter of conformance and complying with FBC-2010 and ANSI/ AAMA/ NWWDA 101/ I.S.2-97, issued by W. W. Schaefer Engineering & Consulting, P.A., dated 10/15/12, signed and sealed by Warren W. Schaefer, P. E.
2. Statement letter of no financial interest and independence, issued by W. W. Schaefer Engineering & Consulting, P.A., dated 10/15/12, signed and sealed by Warren W. Schaefer, P. E.
3. Laboratory compliance letter for Test Reports No.'s NCTL-110-15216-1, NCTL-110-15215-1, NCTL-110-15212-1, NCTL-110-15211-1, NCTL-110-15198-1, NCTL-110-15195-1, NCTL-110-15196-1, NCTL-110-15198-1, NCTL-110-15197-1 and NCTL-110-15194-1, issued by National Certified Testing Laboratories, Inc., dated 10/28/12, signed and sealed by Harold E. Rupp, P. E.

G. OTHERS

1. None.



Jaime D. Gascon, P. E.

Product Control Section Supervisor
NOA No. 12-1108.02

Expiration Date: January 31, 2018

Approval Date: January 31, 2013

FLORIDA DEPARTMENT OF
Business & Professional Regulation



Florida Department of
Business & Professional Regulation
License efficiently. Regulate fairly.

BCTIS Home | Log In | User Registration | Hot Topics | Submit Surcharge | Stats & Facts | Publications | BCTIS Staff | BCTIS Site Map | Links | Search

Product Approval
USER: Public User

[Product Approval Menu](#) > [Product or Application Search](#) > [Application List](#) > [Application Detail](#)

FL # **FL16472**
Application Type **New**
Code Version **2010**
Application Status **Approved**
Comments ***Approved by DBPR. Approvals by DBPR shall be reviewed and ratified by the POC and/or the Commission if necessary.**

Archived

Product Manufacturer **Masonite International**
Address/Phone/Email **1955 Powis Road
West Chicago, IL 60185
(615) 441-4258
sschreiber@masonite.com**

Authorized Signature **Steve Schreiber
sschreiber@masonite.com**

Technical Representative Address/Phone/Email

Quality Assurance Representative Address/Phone/Email

Category **Exterior Doors**
Subcategory **Swinging Exterior Door Assemblies**

Compliance Method **Certification Mark or Listing**

Certification Agency Validated By **National Accreditation & Management Institute,
National Accreditation & Management Institute,**

Referenced Standard and Year (of Standard)	Standard	Year
TAS 201	TAS 201	1994
TAS 202	TAS 202	1994
TAS 203	TAS 203	1994

Equivalence of Product Standards Certified By

Product Approval Method **Method 1 Option A**

Date Submitted 07/10/2013
 Date Validated 11/12/2013
 Date Pending FBC Approval
 Date Approved 11/26/2013

Summary of Products

FL #	Model, Number or Name	Description
16472.1	Metal-edge Steel Door in Adjustable Steel Frame	6'-8" Opaque I/S or O/S Single Door Unit
<p>Limits of Use Approved for use in HVHZ: Yes Approved for use outside HVHZ: Yes Impact Resistant: Yes Design Pressure: +66.0/-66.0 Other: Evaluated for use in locations adhering to the Florida Building Code including the High Velocity Hurricane Zone, and where pressure requirements as determined by ASCE 7 do not exceed the design pressures listed. 3'-0" x 6'-8" max nominal size. See the single door details on drawing FL0178 for additional information. See FL16472.3 for double doors.</p>		
16472.2	Metal-edge Steel Door in Adjustable Steel Frame	8'-0" Opaque I/S or O/S Single Door Unit
<p>Limits of Use Approved for use in HVHZ: Yes Approved for use outside HVHZ: Yes Impact Resistant: Yes Design Pressure: +55.0/-55.0 Other: Evaluated for use in locations adhering to the Florida Building Code including the High Velocity Hurricane Zone, and where pressure requirements as determined by ASCE 7 do not exceed the design pressures listed. 3'-0" x 8'-0" max nominal size. See drawing FL0179 for details.</p>		
16472.3	Metal-edge Steel Door in Adjustable Steel Frame	6'-8" Opaque I/S or O/S Double Door Unit
<p>Limits of Use Approved for use in HVHZ: Yes Approved for use outside HVHZ: Yes Impact Resistant: Yes Design Pressure: +50.5/-50.5 Other: Evaluated for use in locations adhering to the Florida Building Code including the High Velocity Hurricane Zone, and where pressure requirements as determined by ASCE 7 do not exceed the design pressures listed. 6'-0" x 6'-8" max nominal size. See the double door details on drawing FL0178 for additional information.</p>		

[Back](#)

[Next](#)

Contact Us :: 1940 North Monroe Street, Tallahassee FL 32309 Phone: 850-487-1824

The State of Florida is an AA/IEEO employer. Copyright 2007-2013 State of Florida. :: Privacy Statement :: Accessibility Statement :: Refund Statement

Under Florida law, email addresses are public records. If you do not want your e-mail address released in response to a public-records request, do not send electronic mail to this entity. Instead, contact the office by phone or by traditional mail. If you have any questions, please contact 850.487.1395.
 *Pursuant to Section 455.275(1), Florida Statutes, effective October 1, 2012, licensees licensed under Chapter 455, F.S. must provide the Department with an email address if they have one. The emails provided may be used for official communication with the licensee. However email addresses are public record. If you do not wish to supply a personal address, please provide the Department with an email address which can be made available to the public. To determine if you are a licensee under Chapter 455, F.S., please click [here](#).

Product Approval Accepts:



Masonite

**SIDE-HINGED METAL-EDGE STEEL DOOR UNIT
6'-8" OPAQUE DOOR IN TWO-PIECE STEEL FRAME**

GENERAL NOTES

1. EVALUATED FOR USE IN LOCATIONS ADHERING TO THE FLORIDA BUILDING CODE AND WHERE PRESSURE REQUIREMENTS AS DETERMINED BY ASCE 7, MINIMUM DESIGN LOADS FOR BUILDINGS AND OTHER STRUCTURES, DOES NOT EXCEED THE DESIGN PRESSURES LISTED.
2. HURRICANE PROTECTIVE SYSTEM (SHUTTERS) IS NOT REQUIRED.
3. IN THE HVHZ, FACTORY PRIMED DOORS MUST BE PAINTED IN ACCORDANCE WITH SECTION 2220 OF THE FBC.
4. POLYURETHANE CORE FLAME SPREAD INDEX OF 50 AND SMOKE DEVELOPED INDEX OF 60 PER ASTM E84.

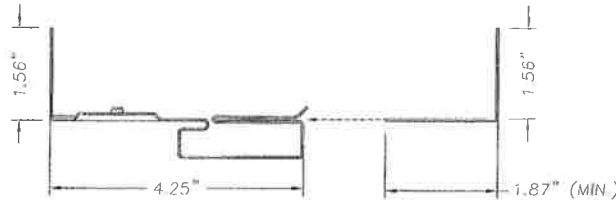

TWO-PIECE ADJUSTABLE STEEL FRAME (206A)

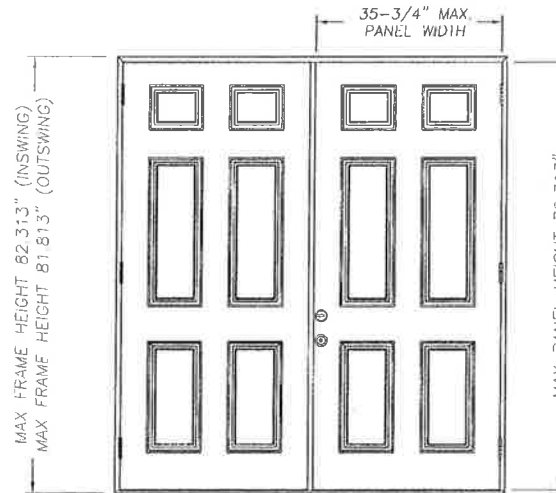

DOUBLE DOOR UNIT

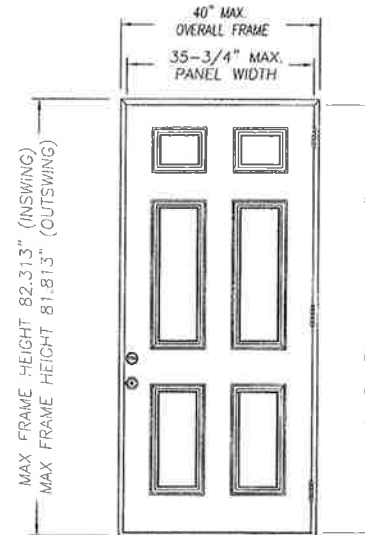

SINGLE DOOR UNIT

CONFIG	MAX. WIDTH	DESIGN PRESSURE RATING			WHERE WATER INFILTRATION PERFORMANCE IS REQUIRED TO BE 15% OF DESIGN PRESSURE		
		INSWING OR ADA	OUTSWING	BUMP O/S ADA*	INSWING OR ADA	OUTSWING	BUMP O/S ADA*
X	39.125"	+66.0 / -66.0	+66.0 / -66.0	+55.0 / -55.0	NA	+66.0 / -66.0	+55.0 / -55.0
XX	75.625	+50.5 / -50.5	+50.5 / -50.5	NA	NA	+50.5 / -50.5	NA

* REQUIRES THE ADDITION OF PEMKO S88 GASKET AND PEMKO 305CR TO FRAME JAMBS AND PEMKO 3452AV SWEEP APPLIED TO THE DOOR SLAB IN ACCORDANCE WITH PEMKO INSTRUCTIONS.

TABLE OF CONTENTS	
SHEET #	DESCRIPTION
1	TYPICAL ELEVATIONS & GENERAL NOTES
2	ANCHORING LOCATIONS & DETAILS

Attachment to NAM

Certification No.: N1006039-23
 Reviewed By: [Signature]
 Date Reviewed: 7/12/12

Kurt Balthazor

KURT BALTHAZOR
 FLORIDA P.E.
 #55533

MASONITE INTERNATIONAL CORP.
 1955 POWIS RD.
 WEST CHICAGO, IL 60185

PRODUCT: EXTERIOR DOOR PRODUCT*
 METAL-EDGE STEEL DOOR
 IN TWO-PIECE STEEL FRAME

PART OR ASSEMBLY:
 TYPICAL ELEVATIONS
 & GENERAL NOTES

NO.	DATE	REVISIONS	BY

DATE: 03/15/12
 SCALE: N.T.S.
 DWG. BY: TR
 CHK. BY:
 DRAWING NO.:
 DWG-MA-FLO178-11
 SHEET 1 OF 2

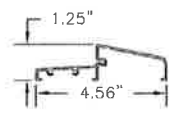
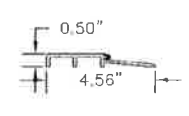
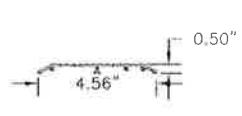
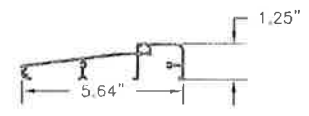
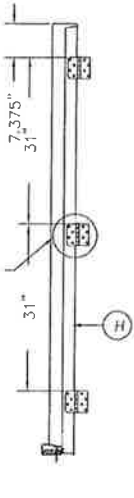
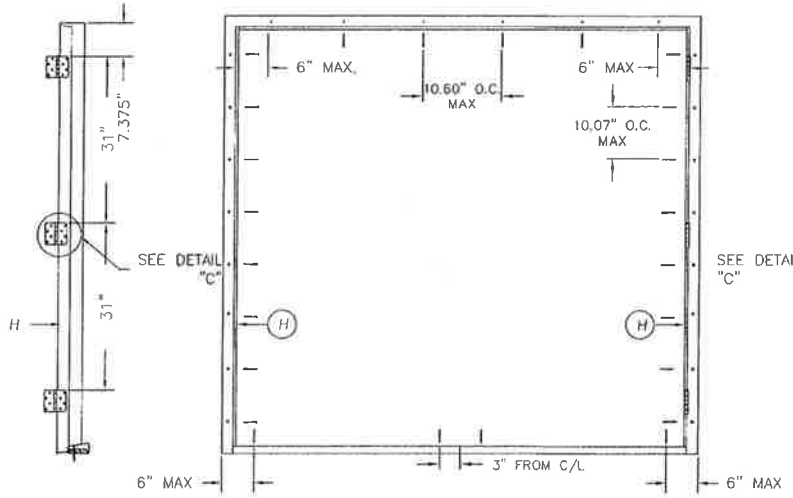
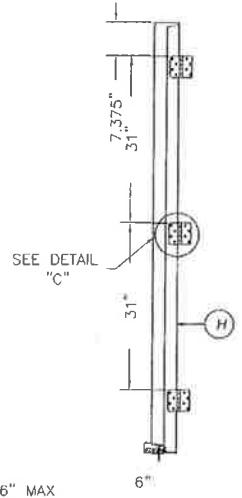
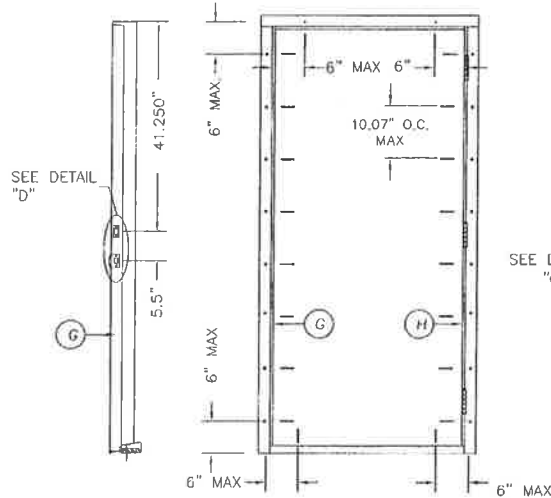

INSWING THRESHOLD

ADA IN/OUTSWING THRESHOLD

ADA OUTSWING BUMPER THRESHOLD

OUTSWING THRESHOLD

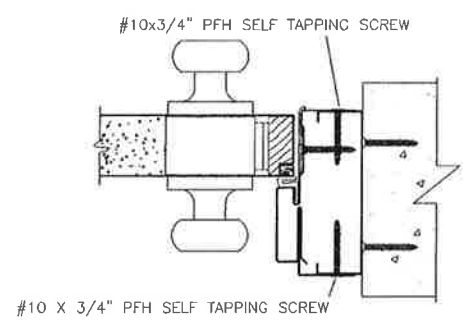
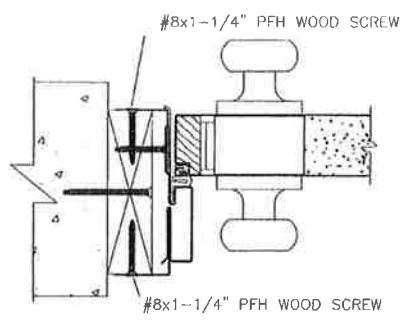

TYPICAL WOOD BUCK INSTALLATION

TYPICAL STEEL BUCK INSTALLATION

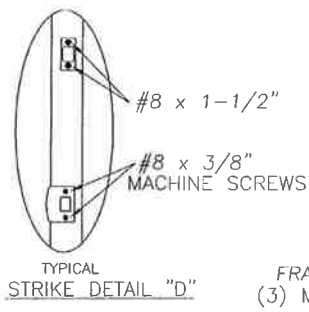

TYPICAL STRIKE DETAIL "D"

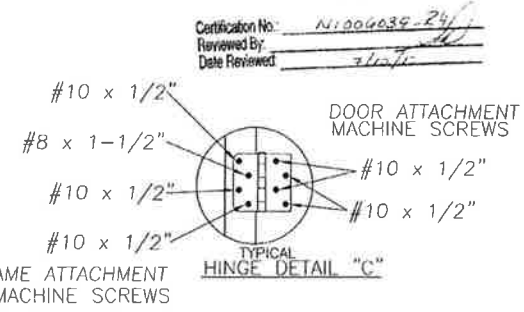

TYPICAL HINGE DETAIL "C"

HARDWARE SCHEDULE

1. KWIKSET SERIES 400 CYLINDRICAL AND SERIES 980 DEADLOCK OR SCHLEGE F-SERIES CYLINDRICAL AND B-SERIES DEADLOCK HARDWARE TO BE AT 5-1/2" CENTERLINE.
2. 4" X 4" FULL MORTISE BUTT HINGES.

- NOTES:
1. THRESHOLD ANCHORS ANALYZED ARE 1/4" TAPCONS WITH 1-1/4" MIN EMBEDMENT.
 2. EDGE DISTANCE MUST BE IN ACCORDANCE WITH ANCHOR MANUFACTURER SPECIFICATIONS.
 3. BUCKS BY OTHERS MUST BE PROPERLY ANCHORED TO TRANSFER LOAD TO STRUCTURE.

Addendum to NAMI
 Certification No: N1006039-24
 Reviewed By: [Signature]
 Date Reviewed: 2/15/11

MASONITE INTERNATIONAL CORP.
 1955 POWIS RD.
 WEST CHICAGO, IL 60185

PRODUCT: EXTERIOR DOOR PRODUCT
 6"-8" OPAQUE META-EDGE STEEL DOOR
 IN TWO-PIECE STEEL FRAME

PART OR ASSEMBLY: ANCHORING LOCATIONS
 DOOR TO BUCK

NO.	DATE	BY	REVISIONS

DATE: 02/15/11
 SCALE: N.T.S.
 DWG BY: TR
 CHK BY:
 DRAWING NO.:
 DWG-MA-FL0178-11
 SHEET 2 OF 2

[BCIS Home](#)
[Log In](#)
[User Registration](#)
[Hot Topics](#)
[Submit Surcharge](#)
[Stats & Facts](#)
[Publications](#)
[BCIS Staff](#)
[Links](#)
[Search](#)

Florida Department of
Business & Professional Regulation
License efficiently. Regulate fairly.



Product Approval

USER: Public User

► OFFICE OF THE SECRETARY

[Product Approval Menu](#) > [Product or Application Search](#) > [Application List](#) > [Application Detail](#)

FL #

FL10674-R8

Application Type

Revision

Code Version

2010

Application Status

Approved

Comments

Archived

Product Manufacturer
Address/Phone/Email

Owens Corning
One Owens Corning Parkway
Toledo, OH 43659
(740) 404-7829
greg.keeler@owenscorning.com

Authorized Signature

Greg Keeler
greg.keeler@owenscorning.com

Technical Representative
Address/Phone/Email

Mel Sancrant
1 Owens Corning PKWY
Toledo, OH 43659
(419) 376-8360
mel.sancrant@owenscorning.com

Quality Assurance Representative
Address/Phone/Email

Category
Subcategory

Roofing
Asphalt Shingles

Compliance Method

Evaluation Report from a Florida Registered Architect or a Licensed Florida Professional Engineer
✓ Evaluation Report - Hardcopy Received

Florida Engineer or Architect Name who developed the Evaluation Report

Robert J.M. Nieminen

Florida License

PE-59166

Quality Assurance Entity

UL LLC

Quality Assurance Contract Expiration Date

09/26/2014

Validated By

John W. Knezevich, PE

✓ Validation Checklist - Hardcopy Received

Certificate of Independence

[FL10674-R8_COI_Trinity.ERD_CI - Nieminen.pdf](#)

Referenced Standard and Year (of Standard)

Standard	Year
ASTM D3161, Class F	2006
ASTM D3462	2007
ASTM D7158, Class H	2007

Equivalence of Product Standards Certified By

http://www.floridabuilding.org/pr/pr_app_dtl.aspx?param=wGEVXQwtDqtBNbEY5V%... 12/16/2013

Sections from the Code

Product Approval Method

Method 1 Option D

Date Submitted

12/19/2012

Date Validated

12/20/2012

Date Pending FBC Approval

12/25/2012

Date Approved

02/04/2013

Summary of Products		
FL #	Model, Number or Name	Description
10674.1	Owens Corning Asphalt Roofing Shingles and Starters	3-tab, laminated, starter, and hip & ridge
Limits of Use Approved for use in HVHZ: No Approved for use outside HVHZ: Yes Impact Resistant: N/A Design Pressure: N/A Other: Refer to ER, Section 5.		
Installation Instructions FL10674_R8_II_er121912FINAL_OC_Aspphalt Shingles_FL10674-R8.pdf Verified By: Robert J. M. Nieminen PE - 59166 Created by Independent Third Party: Yes Evaluation Reports FL10674_R8_AE_er121912FINAL_OC_Aspphalt Shingles_FL10674-R8.pdf Created by Independent Third Party: Yes		

[Back](#)

[Next](#)

Contact Us :: 1940 North Monroe Street, Tallahassee, FL 32399 Phone: 850-487-1824

The State of Florida is an AA/EEO employer. Copyright 2007-2013 State of Florida. :: Privacy Statement :: Accessibility Statement :: Refund Statement

Under Florida law, email addresses are public records. If you do not want your e-mail address released in response to a public-records request, do not send electronic mail to this entity. Instead, contact the office by phone or by traditional mail. If you have any questions, please contact 850.487.1395.

*Pursuant to Section 455.275(1), Florida Statutes, effective October 1, 2012, licensees licensed under Chapter 455, F.S., must provide the Department with an email address if they have one. The email address provided may be used for official communication with the licensee. However email addresses are public record. If you do not wish to supply a personal address, please provide the Department with an email address which can be made available to the public. To determine if you are a licensee under Chapter 455, F.S., please click [here](#).

Product Approval Accepts:





EXTERIOR RESEARCH & DESIGN, LLC.
Certificate of Authorization #9503
353 CHRISTIAN STREET, UNIT #13
OXFORD, CT 06478
PHONE: (203) 262-9245
FAX: (203) 262-9243

EVALUATION REPORT

Owens Corning
One Owens Corning Parkway
Toledo, OH 43659

Evaluation Report **037940.02.12-R2**
FL10674-R8
Date of Issuance: **02/06/2012**
Revision 2: **12/19/2012**

SCOPE:

This Evaluation Report is issued under Rule 9N-3 and the applicable rules and regulations governing the use of construction materials in the State of Florida. The documentation submitted has been reviewed by Robert Nieminen, P.E. for use of the product under the Florida Building Code and Florida Building Code, Residential Volume. The products described herein have been designed to comply with the 2010 FBC and 2010 FBC Residential Volume sections noted herein.

DESCRIPTION: Owens Corning Asphalt Roof Shingles

LABELING: Each unit shall bear labeling in accordance with the requirements the Accredited Quality Assurance Agency noted herein.

CONTINUED COMPLIANCE: This Evaluation Report is valid until such time as the named product(s) changes, the referenced Quality Assurance documentation changes, or provisions of the Code that relate to the product change. Acceptance of this Evaluation Report by the named client constitutes agreement to notify Robert Nieminen, P.E. if the product changes or the referenced Quality Assurance documentation changes. Trinity|ERD requires a complete review of this Evaluation Report relative to updated Code requirements with each Code Cycle.

ADVERTISEMENT: The Evaluation Report number preceded by the words "Trinity|ERD Evaluated" may be displayed in advertising literature. If any portion of the Evaluation Report is displayed, then it shall be done in its entirety.

INSPECTION: Upon request, a copy of this entire Evaluation Report shall be provided to the user by the manufacturer or its distributors and shall be available for inspection at the job site at the request of the Building Official.

This Evaluation Report consists of pages 1 through 6.

Prepared by:

Robert J.M. Nieminen, P.E.
Florida Registration No. 59166, Florida DCA ANE1983

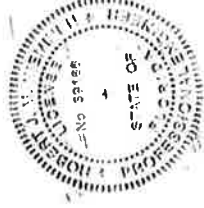

The facsimile seal appearing was authorized by Robert Nieminen, P.E. on 12/19/2012. This does not serve as an electronically signed document. Signed, sealed hardcopies have been transmitted to the Product Approval Administrator and to the named client.

CERTIFICATION OF INDEPENDENCE:

1. Trinity|ERD does not have, nor does it intend to acquire or will it acquire, a financial interest in any company manufacturing or distributing products it evaluates.
2. Trinity|ERD is not owned, operated or controlled by any company manufacturing or distributing products it evaluates.
3. Robert Nieminen, P.E. does not have nor will acquire, a financial interest in any company manufacturing or distributing products for which the evaluation reports are being issued.
4. Robert Nieminen, P.E. does not have, nor will acquire, a financial interest in any other entity involved in the approval process of the product.

ROOFING SYSTEMS EVALUATION:

1. SCOPE:

Product Category: Roofing
Sub-Category: Asphalt Shingles

Compliance Statement: Owens Corning Asphalt Roof Shingles, as produced by Owens Corning, have demonstrated compliance with the following sections of the Florida Building Code and Florida Building Code, Residential Volume through testing in accordance with the following Standards. Compliance is subject to the Installation Requirements and Limitations / Conditions of Use set forth herein.

2. STANDARDS:

Section	Property	Standard	Year
1507.2.5, R905.2.4	Physical Properties	ASTM D3462	2007
1507.2.7.1, R905.2.6.1	Wind Resistance	ASTM D3161, Class F	2006
1507.2.7.1, R905.2.6.1	Wind Resistance	ASTM D7158, Class H	2007

3. REFERENCES:

Entity	Examination	Reference	Date
UL LLC (CER9626)	Physicals & Wind Resistance	File R2453, Vol. 3	02/15/2007
UL LLC (CER9626)	Physicals & Wind Resistance	20120516-R2453	05/16/2012
UL LLC (TST9628)	Physical Properties	06CA20263	04/18/2006
UL LLC (TST9628)	Wind Resistance	11CA34308	02/18/2012
Miami-Dade (CER1592)	FBC HVHZ Compliance	07-1116.12	02/14/2008
Miami-Dade (CER1592)	FBC HVHZ Compliance	09-0915.12	12/16/2009
Miami-Dade (CER1592)	FBC HVHZ Compliance	10-0817.09	10/27/2010
Miami-Dade (CER1592)	FBC HVHZ Compliance	10-0817.10	10/27/2010
Miami-Dade (CER1592)	FBC HVHZ Compliance	10-0817.08	10/27/2010
Miami-Dade (CER1592)	FBC HVHZ Compliance	10-0817.07	10/27/2010
Miami-Dade (CER1592)	FBC HVHZ Compliance	11-0411.03	06/16/2011
Miami-Dade (CER1592)	FBC HVHZ Compliance	12-0309.01	07/19/2012
UL LLC (QJA9625)	Quality Control	Service Confirmation R2453	Exp. 09/26/2014

4. PRODUCT DESCRIPTION:

- 4.1 Asphalt Shingles:
 - 4.1.1 Classic® and Supreme® are fiberglass reinforced, 3-tab asphalt roof shingles.
 - 4.1.2 Berkshire® are fiberglass reinforced, 4-tab asphalt roof shingles.
 - 4.1.3 Duration®, TruDefinition® Duration®, Duration® Premium Cool, TruDefinition® Duration® Designer Color Collection, TruDefinition® Oakridge®, Oakridge® and WeatherGuard® HP are fiberglass reinforced, laminated asphalt roof shingles.
 - 4.2 Berkshire® Hip & Ridge Shingles, High Ridge, Hip & Ridge with Sealant, WeatherGuard® HP Hip & Ridge Shingles and ProEdge Hip & Ridge Shingles are fiberglass reinforced, hip and ridge asphalt roof shingles.
 - 4.3 Starter Strip Plus and Starter Shingle Roll are starter strips for asphalt roof shingles.

5. LIMITATIONS:

- 5.1 This Evaluation Report is not for use in the HVHZ.
- 5.2 Fire Classification is not part of this Evaluation Report; refer to current Approved Roofing Materials Directory for fire ratings of this product.
- 5.3 Wind Classification:

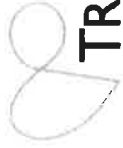

- 5.3.1 All Owens Corning shingles noted herein are Classified in accordance with FBC Tables 1507.2.7.1 and R905.2.6.1 to ASTM D3161, Class F and/or ASTM D7158, Class H, indicating the shingles are acceptable for us in all wind zones up to $V_{asd} = 150$ mph ($V_{ult} = 194$ mph). Refer to Section 6 for installation requirements to meet this wind rating.
- 5.3.2 All Owens Corning hip & ridge shingles and Starter Strip Plus noted herein are Classified in accordance with FBC Tables 1507.2.7.1 and R905.2.6.1 to ASTM D3161, Class F, indicating the shingles are acceptable for us in all wind zones up to $V_{asd} = 150$ mph ($V_{ult} = 194$ mph). Refer to Section 6 for installation requirements to meet this wind rating.
- 5.3.3 Classification by ASTM D7158 applies to exposure category B or C and a building height of 60 feet or less. Calculations by a qualified design professional are required for conditions outside these limitations. Contact the shingle manufacturer for data specific to each shingle.
- 5.3.4 Refer to Owens Corning published information on wind resistance and installation limitations.
- 5.4 All products in the roof assembly shall have quality assurance audit in accordance with the Florida Building Code and F.A.C. Rule 9N-3.

6. INSTALLATION:

6.1 Underlayment:

- 6.1.1 Underlayment shall be acceptable to Owens Corning and shall hold current Florida Statewide Product Approval, or be Locally Approved per Rule 9N-3, per FBC Sections 1507.2.3, 1507.2.4 or R905.2.3.

6.2 Asphalt Shingles:

- 6.2.1 Installation of asphalt shingles shall comply with the manufacturer's current published instructions, using minimum four (4) nails per shingle in accordance with FBC Sections 1507.2 or R905.2, with the following exceptions:
 - Berkshire® shingles require minimum five (5) nails per shingle.
 - WeatherGuard® HP shingles require minimum six (6) nails per shingle.
 - Starter Strip Plus requires minimum five (5) nails per strip.
 Refer to Owens Corning published information on wind resistance and installation limitations.
- 6.2.2 Fasteners shall be in accordance with the manufacturer's published requirements, but not less than FBC 1507.2.6 or R905.2.5. Staples are not permitted.
- 6.2.4 Where the roof slope exceeds 21 units vertical in 12 units horizontal, special methods of fastening are required. Contact the shingle manufacturer for details.
- 6.2.5 Minimum Nailing – Classic® & Supreme:

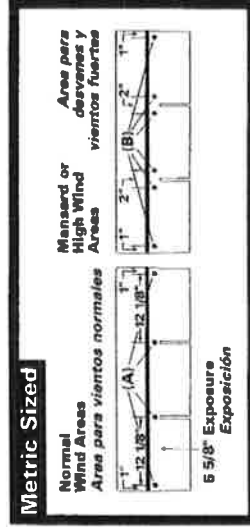
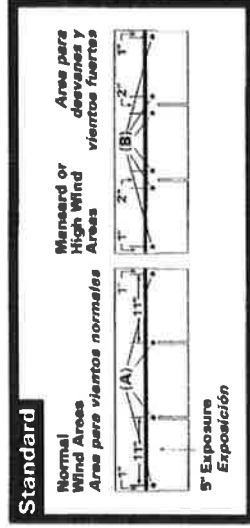

6.2.6 Minimum Nailing – Berkshire®:

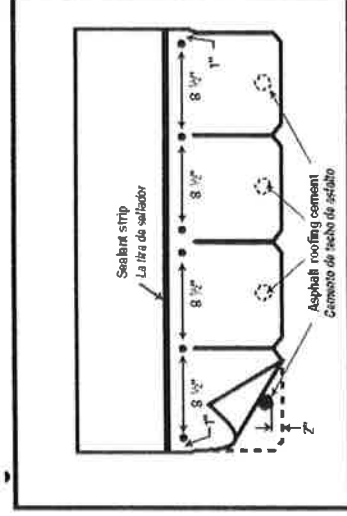
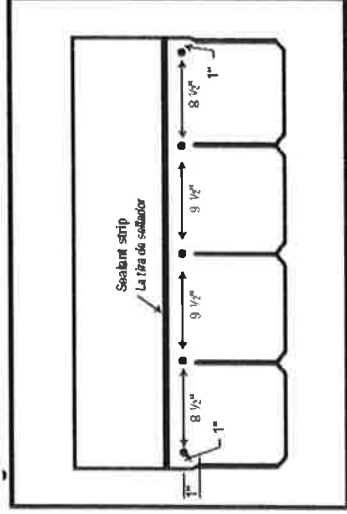

6.2.7 Minimum Nailing – Duration®, TruDefinition®, Duration® Premium Cool & TruDefinition® Duration® Designer Color Collection:

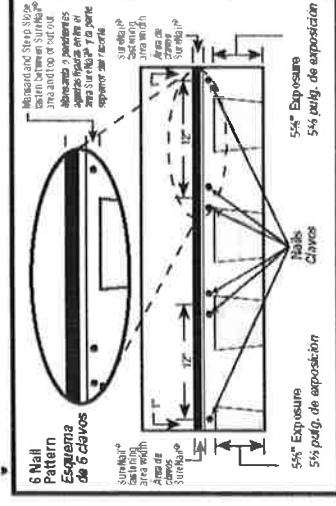
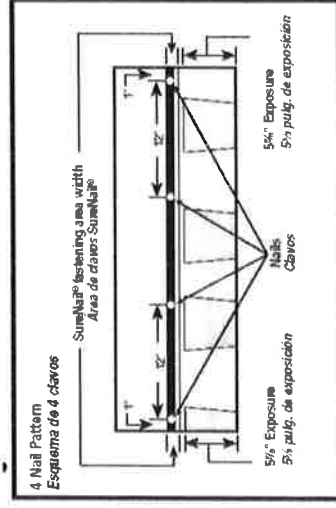

6.2.8 Minimum Nailing – TruDefinition® Oakridge®, Oakridge®:

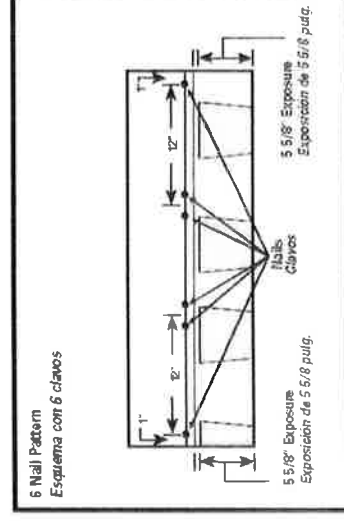
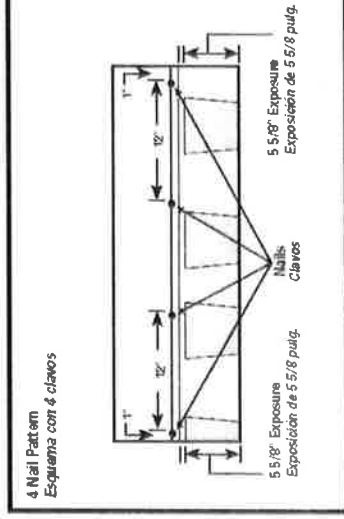

6.2.9 Minimum Nailing – WeatherGuard® HP:

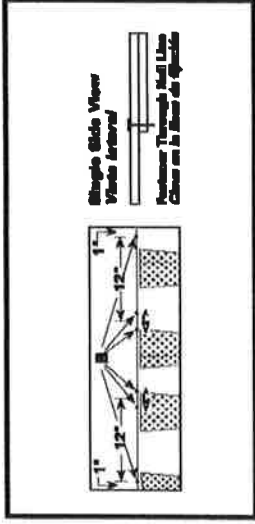

6.3 Hip & Ridge Shingles:

- 6.3.1 Installation of Berkshire® Hip and Ridge Shingles, High Ridge, Hip & Ridge with Sealant, WeatherGuard® HP Hip and Ridge Shingles and ProEdge Hip & Ridge Shingles shall comply with the manufacturer's current published instructions, using four (4) nails per shingle. Refer to Owens Corning published information on wind resistance and installation limitations, including the use of hand-sealing for wind warranties.
- 6.3.2 Fasteners shall be in accordance with the manufacturer's published requirements, but not less than FBC 1507.2.6 or R905.2.5. Staples are not permitted.
- 6.3.3 Minimum Nailing – Berkshire® Hip & Ridge and High Ridge:

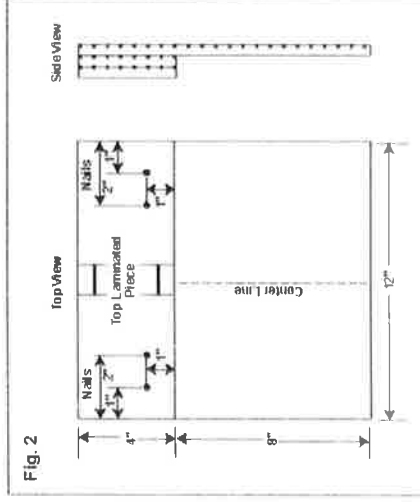
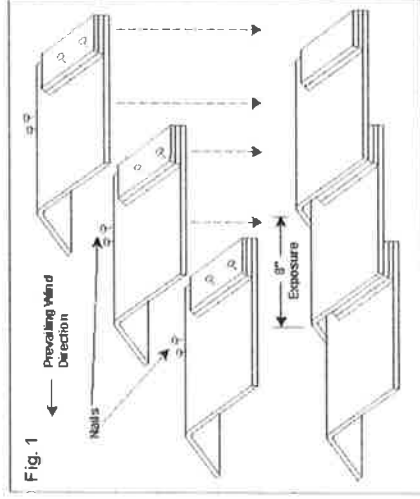

6.3.4 Minimum Nailing – Hip & Ridge with Sealant:

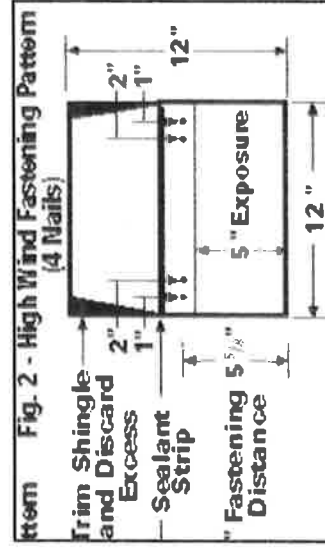

6.3.5 Minimum Nailing – WeatherGuard® HP Hip and Ridge:

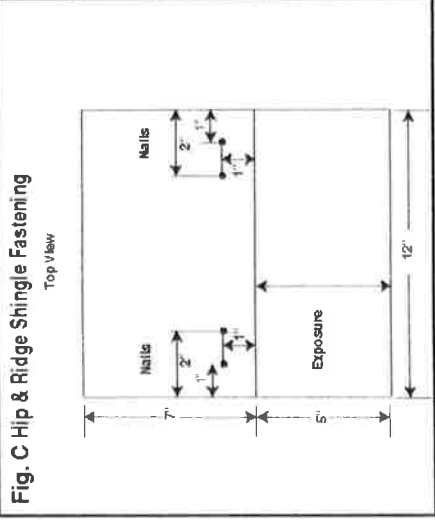
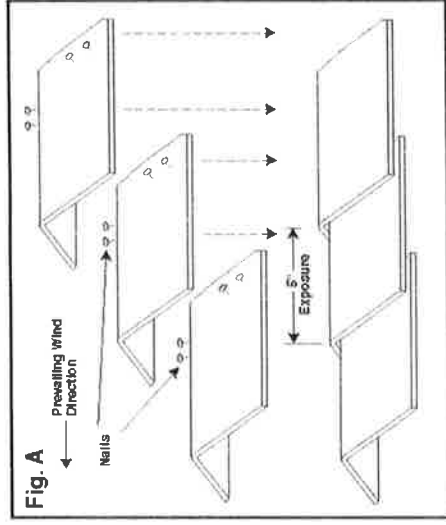

6.3.6 Minimum Nailing - ProEdge Hip & Ridge Shingles:

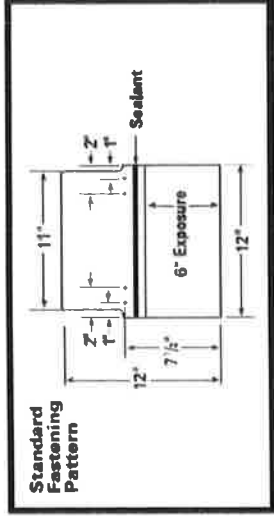
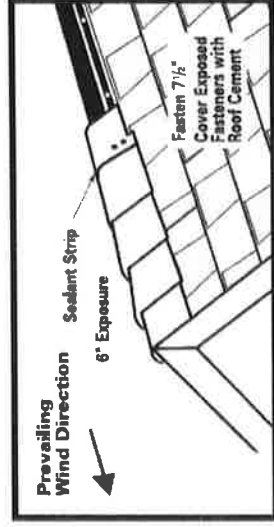

7. LABELING:

- 7.1 Each unit shall bear a permanent label with the manufacturer's name, logo, city, state and logo of the Accredited Quality Assurance Agency noted herein.
- 7.2 Asphalt shingle wrappers shall indicate compliance with one of the required classifications detailed in FBC Table 1507.2.7.1 / R905.2.6.1.

8. BUILDING PERMIT REQUIREMENTS:

As required by the Building Official or Authority Having Jurisdiction in order to properly evaluate the installation of this product.

9. MANUFACTURING PLANTS:

Contact the named QA entity for information on which plants produce products covered by Florida Rule 9N-3 QA requirements.

10. QUALITY ASSURANCE ENTITY:

UL LLC- QUA9625 ; (414) 248-6409; karen.buchmann@ul.com

- **END OF EVALUATION REPORT** -

ALLOWABLE SINGLE WINDOW SIZE/PRESSURE TABLE											
(WITH REINFORCEMENT CONDITION 1 & GLASS OPTION 1)			(WITH REINFORCEMENT CONDITION 2 & GLASS OPTION 1)			(WITH REINFORCEMENT CONDITION 1 OR 2 & GLASS OPTION 2)					
MAXIMUM FRAME HEIGHT (IN.)	MAXIMUM FRAME WIDTH (IN.)	ALLOWABLE PRESSURE (PSF)		MAXIMUM FRAME HEIGHT (IN.)	MAXIMUM FRAME WIDTH (IN.)	ALLOWABLE PRESSURE (PSF)		MAXIMUM FRAME HEIGHT (IN.)	MAXIMUM FRAME WIDTH (IN.)	ALLOWABLE PRESSURE (PSF)	
		POS.	NEG.			POS.	NEG.			POS.	NEG.
90	54	45.0	45.0	90	40	35.0	35.0	62	36	55.0	55.0
	52	46.7	46.7		36	40.0	40.0		30	60.0	66.0
	48	50.6	50.6		30	48.0	48.0		26	60.0	76.2
	42	57.9	57.9		26	55.4	55.4		24	60.0	82.5
	36	65.0	67.5		22	60.0	65.5		36	60.0	60.9
	30	65.0	81.0		18	60.0	80.0		30	60.0	73.1
73	54	45.0	45.0	73	40	35.0	35.0	56	27	60.0	81.2
	52	46.7	46.7		36	40.0	40.0		36	60.0	68.2
	48	50.6	50.6		30	48.0	48.0		30	60.0	81.8
	42	57.9	57.9		26	55.4	55.4		36	60.0	79.3
	36	65.0	67.5		22	60.0	65.5				
	30	65.0	81.0		18	60.0	80.0				
68	54	48.3	48.3	68	40	37.6	37.6	43	36	60.0	79.3
	52	50.2	50.2		36	42.9	42.9				
	48	54.3	54.3		30	51.5	51.5				
	42	62.1	62.1		26	59.5	59.5				
	36	65.0	72.5		22	60.0	70.3				
	32	65.0	81.5		19	60.0	81.4				
62	54	53.0	53.0	62	40	41.2	41.2				
	52	55.0	55.0		36	55.0	55.0				
	48	59.6	59.6		30	60.0	66.0				
	42	65.0	68.1		26	60.0	76.2				
	36	65.0	79.5		24	60.0	82.5				
	30	65.0	91.0		20	60.0	91.0				
56	54	58.7	58.7	56	40	45.6	45.6				
	52	60.9	60.9		36	60.0	60.9				
	48	65.0	66.0		30	60.0	73.1				
	42	65.0	75.4		27	60.0	81.2				
	39	65.0	81.2								
	36	65.0	88.0								
50	54	65.0	65.7	50	36	60.0	68.2				
	52	65.0	68.2		30	60.0	81.8				
	48	65.0	73.9		40	59.4	59.4				
	44	65.0	80.6		36	60.0	79.3				
43	54	65.0	76.4	43	37	40	60.0	69.1			
	52	65.0	79.3		31	40	60.0	82.4			
41	54	65.0	80.1								

FRAME ANCHOR REQUIREMENTS TABLE			
(1) FRAME & INSTALLATION CLIP SCREWS			
OPENING TYPE (SUBSTRATE)	FRAME TO OPENING FASTENER TYPE	MINIMUM EMBED	MINIMUM EDGE DIST.
(2) MIN. 2X WOOD FRAME OR BUCK (MIN. GR. 3 & G=0.55)	NO. 10 SMS OR WOOD SCREW	1 1/4"	3/4"
MIN. 18 GA. 33 KSI METAL STUD	NO. 10 GR. 5 SELF TAP/DRILL SCREW	FULL	1/2"
MIN. 1/8" THK A36 STEEL	NO. 10 GR. 5 SELF TAP/DRILL SCREW	FULL	1/2"
MIN 1/8" THK 6063-T5 ALUM.	NO. 10 GR. 5 SELF TAP/DRILL SCREW	FULL	1/2"
MIN. C-90 CMU OR 2500 PSI CONCRETE	(3) 1/4" CONCRETE SCREW	1 1/4"	2"

(1) SCREWS SHALL BE PAN HEAD OR HEX HEAD SCREW.
(2) MIN. 2X4 BUCKS REQUIRED AT HEAD & SIDES; MIN. 2X6 BUCKS REQUIRED AT SILL (SILL BUCK MAY BE RIPPED DOWN TO AS LITTLE AS 4" PROVING CLIP SCREW EDGE DISTANCE IS SATISFIED. BUCKS MAY BE TAPERED OR NOTCHED AT THEIR INTERIOR SIDE IF REQUIRED TO ALLOW INTERIOR DRYWALL, PANELING OR CASING TO BUTT AGAINST THE WINDOW FRAME EDGE.
(3) CONCRETE SCREWS SHALL BE ELCO ULTRACONS (C.S.), ELCO CRETE-FLEX (S.S.), ITW RAMSET/RED HEAD TAPCONS (C.S. OR S.S.) OR HILTI KWIK-CON II (C.S OR S.S.).

GENERAL NOTES:
1. THESE WINDOW SYSTEMS HAVE BEEN TESTED, ANALYZED & APPROVED FOR DESIGN PRESSURES NOT TO EXCEED THOSE SHOWN IN THE "ALLOWABLE DESIGN PRESSURE TABLE(S)".
2. OPENINGS, BUCKING & BUCKING FASTENERS MUST BE PROPERLY DESIGNED & INSTALLED TO TRANSFER WIND LOADS TO THE STRUCTURE.
3. ALL HARDWARE & FASTENERS SHALL BE IN ACCORDANCE WITH THESE DRAWINGS & SHALL NOT VARY UNLESS SPECIFICALLY MENTIONED ON THE DRAWINGS. SPECIFIED ANCHOR EMBED TO BASE MATERIAL SHALL BE BEYOND WALL FINISH OR STUCCO.
4. THE DETAILS & SPECIFICATIONS SHOWN HEREIN REPRESENT THE PRODUCTS TESTED & PROPOSED FOR WATER, AIR, FORCED ENTRY & UNIFORM STATIC AIR PRESSURE TESTING IN CONFORMANCE WITH THE FLORIDA BUILDING CODE PROTOCOL TAS-202 FOR NON-IMPACT WINDOWS.
5. THESE WINDOW SYSTEMS HAVE BEEN DESIGNED IN ACCORDANCE WITH AND MEET THE REQUIREMENTS OF THE FLORIDA BUILDING CODE (FBC) INCLUDING HIGH VELOCITY HURRICANE ZONES (HVHZ).
6. THESE WINDOWS ARE NON-IMPACT RATED & MUST BE SHUTTERED WITH A FLORIDA CODE APPROVED SHUTTER WHERE REQUIRED BY CODE.
7. ALL ANCHORS SECURING WINDOW FRAME TO PRESSURE TREATED BUCKS OR WOOD FRAMING SHALL BE CAPABLE OF RESISTING CORROSION CAUSED BY THE PRESSURE TREATING CHEMICALS IN THE WOOD.
8. DETERMINE THE POSITIVE & NEGATIVE DESIGN LOADS TO USE WHEN REFERENCING THESE DOCUMENTS IN ACCORDANCE WITH THE GOVERNING CODE AND GOVERNING WIND VELOCITY. FOR WIND LOAD CALCULATIONS IN ACCORDANCE WITH THE FLORIDA BUILDING CODE, A DIRECTIONALITY FACTOR OF Kd = 0.85 MAY BE APPLIED PER THE ASCE-7 STANDARD.
9. NO INCREASE IN ALLOWABLE STRESS HAS BEEN USED IN THE CERTIFICATION OF THIS PRODUCT. WIND LOAD DURATION FACTOR Cd = 1.6 WAS USED FOR WOOD SCREW ANALYSIS ONLY.
10. MATERIALS, INCLUDING BUT NOT LIMITED TO STEEL SCREWS, THAT COME INTO CONTACT WITH OTHER UNSIMILAR MATERIALS SHALL MEET THE REQUIREMENTS OF FLORIDA BUILDING CODE CHAPTER 20.

CORNER CONSTRUCTION:
FRAME: MEMBERS ARE MITERED & FULLY WELDED.
SASH: MEMBERS ARE MITERED & FULLY WELDED.

LOCK QUANTITY REQUIREMENTS	
FRAME WIDTH	QUANTITY PER PANEL
OVER 36"	2
36" & LESS	1

THESE DRAWINGS ARE APPLICABLE ONLY TO THE PRODUCT SPECIFIED. THEY MAY NOT BE USED FOR THE ASSEMBLY AND/OR INSTALLATION OF ANY OTHER PRODUCT NOR MAY THEY BE USED FOR NATIONAL AND/OR LOCAL APPROVAL OF ANY PRODUCT NOT PRODUCED BY THE MANUFACTURER STATED ON THESE DRAWINGS.

Approved as complying with the Florida Building Code
Date: 12-11-2013
NOVA
Major Project Control
By: [Signature]

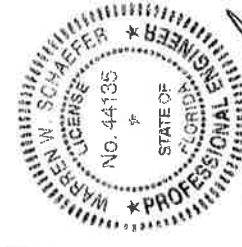

DRAWN BY: W.W.	CHECKED BY: W.W.S.
PLOT: 1-18	DATE: 10/10/12
DATE:	
BY:	
REVISION DESCRIPTION:	
NO.	
10 SERIES VINYL NON-IMPACT SINGLE HUNG WINDOW MANUFACTURER: PELLA CORPORATION 102 MAIN STREET PELLA, IA 50219 641-621-1000	
CONSULTANTS: W. W. SCHAEFER ENGINEERING & CONSULTING, P.A. (CA 6809) 7480 150TH COURT NORTH PALM BEACH GARDENS, FL 33418 PHONE: 561-744-3628	
CERTIFICATION: JAN 10 2013 W. W. SCHAEFER, P.E. No. 44135	
DRAWING NO. 1840	REV.
SHEET NO. 1	OF 4

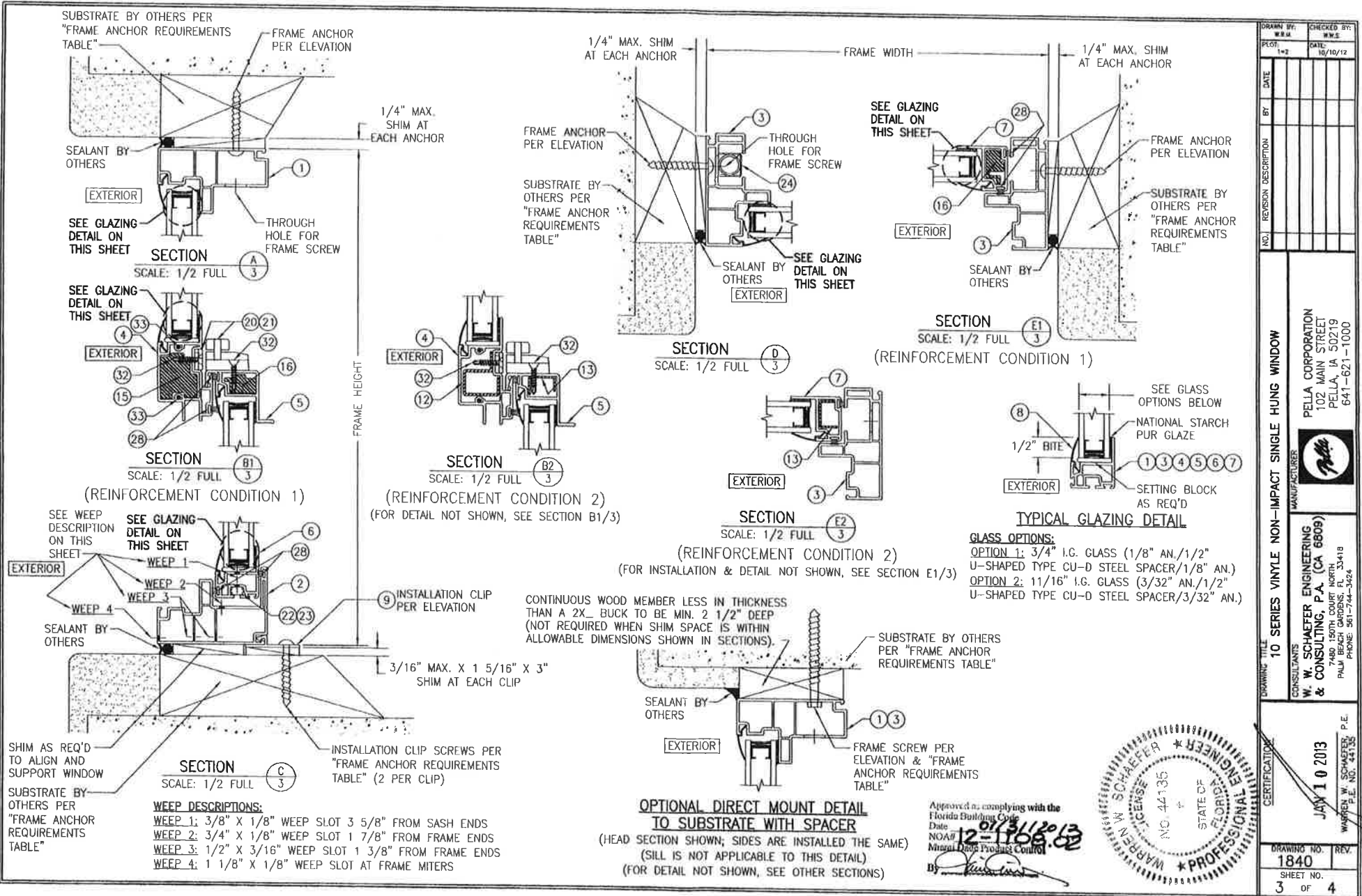

DRAWN BY: WWS	CHECKED BY: WWS
PLOT: 1=2	DATE: 10/10/12
BY: DATE:	
NO. REVISION DESCRIPTION:	
10 SERIES VINYL NON-IMPACT SINGLE HUNG WINDOW MANUFACTURER: PELLA CORPORATION 102 MAIN STREET PELLA, IA 50219 641-621-1000	
CONSULTANTS: W. W. SCHAEFER ENGINEERING & CONSULTING, P.A. (CA 6809) 7480 150TH COURT NORTH, 33418 PALM BEACH GARDENS, FL 33418 PHONE: 561-744-3424	
CERTIFICATE: JAN 10 2013 W. W. SCHAEFER, P.E. P.E. NO. 44135	
DRAWING NO. 1840	REV.
SHEET NO. 3	OF 4

Approved as complying with the Florida Building Code
 Date: 12/11/12
 NOA# 12-01166-03
 Nilgard Data Product Control
 By: [Signature]

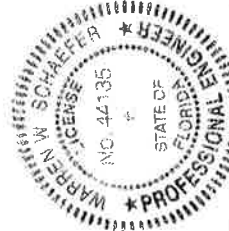

ITEM #	ITEM DESCRIPTION	MANUFACTURER/NOTES
PARTS		
1	HEAD FRAME	(*) VINYL
2	SILL FRAME	(*) VINYL
3	JAMB FRAME	(*) VINYL
4	FIXED CHECK-RAIL	(*) VINYL
5	ACTIVE SASH CHECK-RAIL	(*) VINYL
6	ACTIVE SASH BOTTOM RAIL	(*) VINYL
7	ACTIVE SASH STILE	(*) VINYL
8	GLAZING BEAD	(*) VINYL
9	INSTALLATION CLIP	(*) VINYL
12	FIXED CHECK-RAIL REINFORCEMENT (REINFORCEMENT CONDITION 2)	ASTM A653-05A TYPE A GALVANIZED STEEL
13	ACTIVE SASH CHECK-RAIL & STILE REINFORCEMENT (REINFORCEMENT CONDITION 2)	ASTM A653-05A TYPE A GALVANIZED STEEL
15	FIXED CHECK-RAIL REINFORCEMENT (REINFORCEMENT CONDITION 1)	6061-T6 ALUMINUM
16	ACTIVE SASH CHECK-RAIL & STILE REINFORCEMENT (REINFORCEMENT CONDITION 1)	6061-T6 ALUMINUM
HARDWARE		
20	SASH LOCK	PELLA V615002 DIE CAST ZINC
21	SASH LOCK KEEPER	PELLA V700123 DIE CAST ZINC
22	PIVOT BAR (1 PER EACH BOTTOM CORNER)	PELLA V615605 DIE CAST ZINC
23	TILT LATCH (1 PER EACH BOTTOM CORNER)	(*) PELLA V782401 RIGID VINYL
24	SASH BALANCE	PELLA V78243
SEALS & SEALANTS		
28	PILE WEATHERSTRIP	AMESBURY V420628
FASTENERS		
32	NO. 6 X 3/4 ZINC PLATED TEK SCREW	2 PER EACH SASH LOCK & SASH LOCK KEEPER INTO RAIL REINFORCEMENT
33	NO. 6 X 1 5/8" BUGLE HEAD COURSE THREAD 18-8 S.S. SCREW	2 PER EACH FIXED CHECK-RAIL END

(*) WHITE RIGID PVC EXTERIOR EXTRUSIONS FOR WINDOWS AND DOORS BY MIKRON INDUSTRIES, INC. PER AAMA CERTIFIED PVC EXTRUSION LISTING, MIAMI-DADE COUNTY PRODUCT CONTROL APPROVAL AND FBC 2010

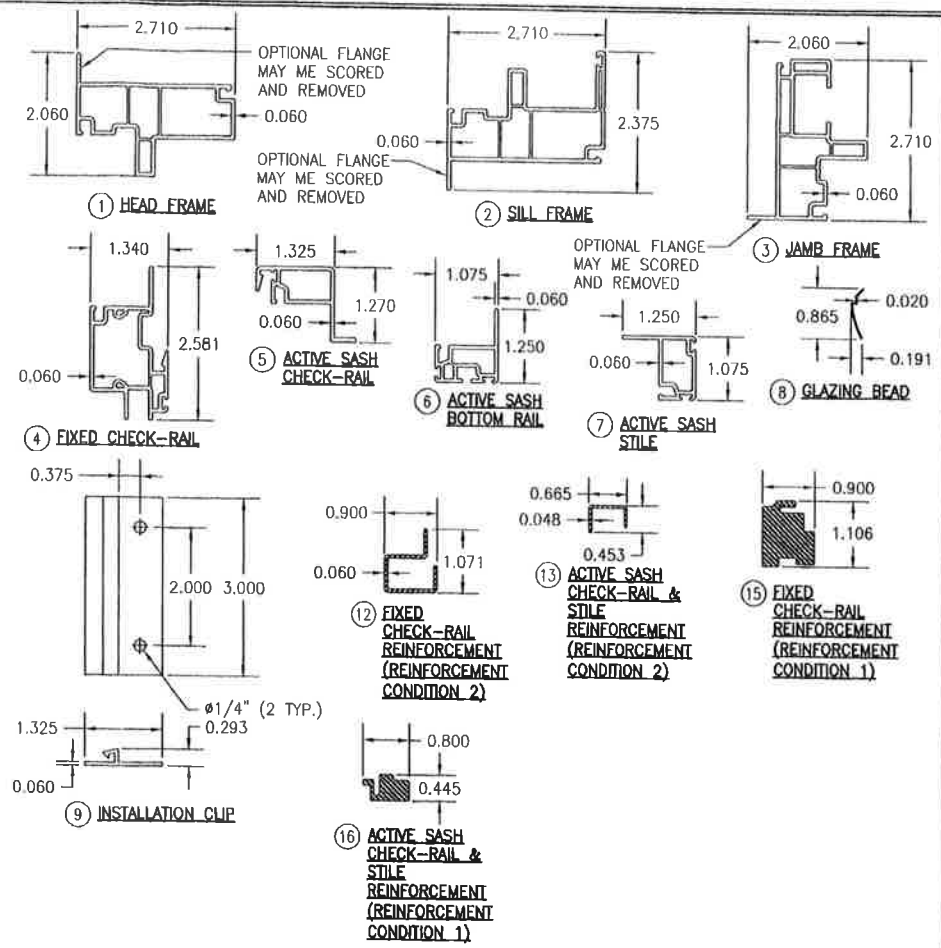

DRWN BY: W.S.	CHECKED BY: W.S.
PLT: 1-2	DATE: 10/10/12
DATE:	
BY:	
NO:	
REVISION DESCRIPTION:	
DRAWING TITLE: 10 SERIES VINYL NON-IMPACT SINGLE HUNG WINDOW	
MANUFACTURER: PELLA CORPORATION 102 MAIN STREET PELLA, IA 50219 641-621-1000	
CONSULTANTS: W. W. SCHAEFER ENGINEERING & CONSULTING, P.A. (CA 6809) 7480 15TH COURT NORTH, SUITE 18 PALM BEACH GARDENS, FL 33424 PHONE: 561-744-3424	
CERTIFICATION: WARBEN W. SCHAEFER, P.E. JAN 10 2013 WARBEN W. SCHAEFER, P.E. NO. 44155	
DRAWING NO. 1840	REV.
SHEET NO. 4	OF 4

Approved as complying with the Florida Building Code
Date: 01/13/2013
NOAR: 12-110812
Miami Dade Product Control
By: [Signature]

