



City of Belle Isle

Universal Engineering Sciences 3532 Maggie Blvd., Orlando, FL 32811
Tel 407-581-8161 * Fax 407-581-0313 * www.universalengineering.com

PERMIT CARD - PLEASE POST AT JOB SITE

THIS DOCUMENT BECOMES YOUR PERMIT WHEN PROPERLY VALIDATED

Per FBC 105.3.3: An enforcing authority may not issue a building permit for any building construction, erection, alteration, modification, repair or addition unless the permit either includes on its face or there is attached to the permit the following statement: "NOTICE: In addition to the requirements of this permit, there may be additional restrictions applicable to this property that may be found in the public records of this county, and there may be additional permits required from other governmental entities such as water management districts, state agencies, or federal agencies." The issuance of this permit does not grant permission to violate any applicable City, Orange County, State of Florida and/or Federal codes and/or ordinances. Separate permits are required for Signs, Roofing, Electrical, Gas, Plumbing and Mechanical services. This permit becomes VOID if the work authorized is not commenced within 6 months, or is suspended or abandoned for a period of 6 months after commencement. **WORK SHALL BE CONSIDERED SUSPENDED IF AN APPROVED INSPECTION HAS NOT BEEN MADE WITHIN A 6 MONTH PERIOD. PERMISSION IS GRANTED TO DO THE FOLLOWING WORK ACCORDING TO THE CONDITIONS HEREON AND THE APPROVED PLANS AND SPECIFICATIONS, SUBJECT TO COMPLIANCE WITH THE ORDINANCES OF THE CITY OF BELLE ISLE, FLORIDA.**

Scope of Work: BUILDING: Enclose existing Lanai to convert to a sun room category III

Comments: None

Project Information

Address: 6649 The Landings Dr, Belle Isle, FL 32812
Parcel ID: 20-23-30-4980-00-340
Property Owner: Purcell, Tiafau and Gloria
Phone Number: 407-353-2073

Company Name: Eden Construction Corp.
Contractor Name: Eden, Richard
License Number: CGC060047
Address: 10151 University Blvd Suite 137 Orlando, FL 32817
Phone Number: 407-671-9697

Permit Number: 2014-04-007

Date of Application: 03/28/2014

Date Permit Issued: 04/09/2014

WARNING TO OWNER: "YOUR FAILURE TO RECORD A NOTICE OF COMMENCEMENT MAY RESULT IN YOU PAYING TWICE FOR IMPROVEMENTS TO YOUR PROPERTY. IF YOU INTEND TO OBTAIN FINANCING, CONSULT WITH YOUR LENDER OR AN ATTORNEY BEFORE RECORDING YOUR NOTICE OF COMMENCEMENT." ON THE JOB INSPECTION(S) MUST BE MADE BEFORE PROCEEDING WITH SUBSEQUENT WORK. THIS CARD MUST BE DISPLAYED OUTSIDE AND BE PROTECTED FROM THE WEATHER WHILE BEING VISIBLE FROM THE STREET UNTIL THE FINAL INSPECTIONS HAVE BEEN APPROVED.

BUILDING FEATURES

IMPACT FEES

School \$
Traffic \$

ZONING FEES

Zoning Fee \$165.00

UNIVERSAL ENG - BUILDING FEES

Cert of Occ \$
Demo \$
Building \$
Fence \$
Driveway \$
Shed \$
Window(s) \$
Door(s) \$
PrePower \$
Electrical \$
Temp Pole \$
Plumbing \$
Mechanical \$
Gas \$
Roofing \$85.50
Boat Dock \$
Screen Encl \$
Swimming Pool \$
Sign \$

SURCHARGE FEES

Surcharge Fee \$2.00
Surcharge Fee \$2.00

TOTAL FEES \$254.50

Date Paid 4-14-14

CC or Check # VISA 7119

Amount Paid 254.50

The person accepting this permit shall conform to the terms of the application on file and construction shall conform to the requirements of the Florida Building Code (FS 553).

BUILDING INSPECTOR USE ONLY

IF APPLICABLE:

Have Zoning Approval Conditions Been Met? YES NO Have Stormwater Approval Conditions Been Met? YES NO Silt fencing in place? YES NO Turbidity Barrier in place? YES NO

BUILDING

1st _____ (Footing/Foundation)

Survey specific foundation plan must be onsite before slab pour. Approved Plan on Site? _____

2nd _____ (Slab)

3rd _____ (Lintel) (Wall Reinforcing on Masonry Building)

4th _____ (Exterior Framing) (Roof/Wall Sheathing)

5th _____ (Framing) (To be made after Plumbing/Mechanical/Electrical Rough-Ins & Windows/Doors Installed)

6th _____ (Insulation to be Made After Roof Installed)

7th _____ (Drywall)

8th _____ (Sidewalk/Driveway)

9th _____ (Other)

10th _____ (Final - After MEP and Other Applicable Finals)

ROOFING

1st ROOFING Deck Nailing/Dry-in/Flashing _____

2nd ROOFING Covering In-Progress _____

3rd ROOFING Covering Final _____

PLUMBING (Pool-Piping, Solar, Irrigation, Water Treatment Equip, Etc...)

1st _____ (Underground) 2nd _____ (Sewer)

3rd _____ (Rough-In/Tub Set) 4th _____ (Final)

CHECK APPROPRIATE BOX

GAS ___ Natural ___ LP ___ MECHANICAL ___ ELECTRICAL ___ LOW VOLTAGE

1st _____ (Rough-In) 2nd _____ (Final)

Inspection requests are to be emailed to BlDscheduling@UniversalEngineering.com; a confirmation email will be sent back to you upon scheduling. Next-Day Inspection requests must be made by 1pm. Please include the following in your request: Permit #, project address, type of inspection, date of the requested inspection, a contact name & a contact phone number. AM or PM may be requested but cannot be guaranteed.

For a copy of your permit, or to check inspection results, please visit <https://universalengineering.sharefile.com/ff094edc4-832d-44bd-9809-ecf32f9e2e63>

login ID = cobi@universalengineering.com

password = universal113

CITY OF BELLE ISLE
Permit Application Review Sheet

Permit Number	2014-04-007
Property Owner	PURCELL, Tiafa & Gloria
Address	6649 The Landings Dr.
Nature of Improvement	convert lanai into sunroom
Received Application	3-28-14
Sent for Stormwater Review	/
Stormwater Approved	/
Sent for Zoning Review	/
Zoning Approved	/
Applied for Variance	/
Variance Approved	/
Sent to BO for Review	3-31-14 (3:28-14 @ 4:00 pm)
Building Official Approved	4-09-14
Comments	
1.	Review w/o \$36015
2.	3/31/2014 AP Page 2 Code Analysis contradicts page 4 Code Analysis. Also, page 2 references incorrect windloads velocity. Page 4 has incorrect wind exposure Category C. Emailed above ↑ also need GH, W/C, bus lic (emailed)
3.	
4.	
5.	
6.	4/1/14 Susan add'l info added. PLS review Contractor Calling !!
7.	4/4/14 Susan NEED VOC - Emailed Rick
8.	4/9/14 Susan
9.	
10.	
11.	
12.	



City of Belle Isle

Universal Engineering Sciences 3532 Maggie Blvd., Orlando, FL 32811
Tel 407-581-8161 * Fax 407-581-0313 * www.universalengineering.com



Building Permit (Land Use) Application

DATE: 3/27/14

PERMIT # 2040407

PROJECT ADDRESS 6649 The Landings Dr, Belle Isle, FL 32809 42812

PROPERTY OWNER Tina & Gloria Praxell PHONE 407-353-2073 VALUE OF WORK (labor & material) \$ 9,000.00

PLEASE LIST THE NATURE OF YOUR PROPOSED IMPROVEMENTS

Enclose existing plans to convert to sun room category III
Per edencconstruction.com

- Survey specific foundation plan required to show compliance with zoning setbacks
- **BOAT DOCK:** DEP Clearance Required with Application (Call 407-897-4100); please provide a copy of their report
- **SEPTIC SYSTEM (RESIDENTIAL):** - Provide verification of OC Health Dept approval for on-site septic tank system, per FAC Chap. 64E-6
- Homeowners will be required to have a contractor on record for homes that are rented and/or not homestead

Please Complete for the City of Belle Isle Zoning Review: **Parcel Id Number:** 20-23-30-4980-00-340

To obtain this information, please visit <http://www.ocpafl.org/Searches/ParcelSearch.aspx>

SPECIAL CONDITIONS: STRUCTURES MAY NOT ENCRoACH INTO ANY EASEMENT OR REQUIRED SETBACK. Note, this Zoning Approval MAY or MAY NOT be in conflict with your Deed Restrictions. For New Single Family Residence, a Traffic Impact Fee and School Impact will be assessed.

Wind Exposure Category: B ___ C ___ D X

Attached Survey ___ SETS and Construction Plans 2 SETS

PLANNING & ZONING APPROVAL: _____ DATE _____

PLEASE COMPLETE for Building Review

CONSTRUCTION TYPE RESIDENTIAL

OCCUPANCY GROUP Comm Res: Single Fam Multi Fam

#BLDG. 1 #UNITS 1 #STORIES 1 TOTAL SQ.FT. 184

MAX. FLOOR LOAD _____ MAX. OCCUPANCY _____

MIN. FLOOD ELEV. _____ LOW FLOOR ELEV. _____

WATER SERVICE _____ WELL _____ SEPTIC _____

BUILDING REVIEWER Alfanz Buiss DATE 4/09/2014

NOTES _____

Per FSS 105.3.3:

An enforcing authority may not issue a building permit for any building construction, erection, alteration, modification, repair or addition unless the permit either includes on its face or there is attached to the permit the following statement: "NOTICE: In addition to the requirements of this permit, there may be additional restrictions applicable to this property that may be found in the public records of this county, and there may be additional permits required from other governmental entities such as water management districts, state agencies, or federal agencies."

Republic Services is by legal contract the sole authorized provider of garbage, recycling, yard waste, and commercial garbage and construction debris collection and disposal services with the city limits of the City. Contractors, homeowners and commercial businesses may contact Republic Services at 407-293-8000 to setup accounts for Commercial, Construction Roll Off, or other services needed. Rates are fixed by contract and are available at City Hall or from Republic Services. The City enforces the contract through its code enforcement office. Failure to comply will result in a stop work order.

SEPARATE PERMITS ARE REQUIRED FOR ROOFING, ELECTRICAL, PLUMBING, GAS, MECHANICAL, SIGNS, POOLS, ENCLOSURES, ETC.

SPRINKLERS REQ'D	Y	N	Date: Sent	RCD
IF Required - SUBMIT COPY OF PLANS FOR FIRE REVIEW	<input checked="" type="checkbox"/>	<input type="checkbox"/>		
ZONING	<input checked="" type="checkbox"/>	<input type="checkbox"/>		\$ <u>165.-</u>
CERT OF OCC	<input type="checkbox"/>	<input type="checkbox"/>		\$ _____
TRAFFIC	<input type="checkbox"/>	<input type="checkbox"/>		\$ _____
SCHOOL	<input type="checkbox"/>	<input type="checkbox"/>		\$ _____
FIRE	<input type="checkbox"/>	<input type="checkbox"/>		\$ _____
SWIMMING POOL	<input type="checkbox"/>	<input type="checkbox"/>		\$ _____
SCREEN ENCLOSURE	<input checked="" type="checkbox"/>	<input type="checkbox"/>		\$ <u>85.50</u>
ROOFING	<input type="checkbox"/>	<input type="checkbox"/>		\$ _____
BOAT DOCK	<input type="checkbox"/>	<input type="checkbox"/>		\$ _____
BUILDING	<input type="checkbox"/>	<input type="checkbox"/>		\$ _____
WINDOW(S)	<input type="checkbox"/>	<input type="checkbox"/>		\$ _____
DOOR(S)	<input type="checkbox"/>	<input type="checkbox"/>		\$ _____
FENCE	<input type="checkbox"/>	<input type="checkbox"/>		\$ _____
SHED	<input type="checkbox"/>	<input type="checkbox"/>		\$ _____
DRIVEWAY	<input type="checkbox"/>	<input type="checkbox"/>		\$ _____
OTHER	<input type="checkbox"/>	<input type="checkbox"/>		\$ _____
3% FLSURCHARGE				<u>4.00</u>
TOTAL				<u>254.00</u>
By Owner Form	<input type="checkbox"/>	<input type="checkbox"/>		NA
Notice of Commencement	<input type="checkbox"/>	<input type="checkbox"/>		NA
Power of Attorney	<input type="checkbox"/>	<input type="checkbox"/>		NA
Contractor Packet Included?	<input type="checkbox"/>	<input type="checkbox"/>		N
OTHER PERMITS REQUIRED:				
ELECTRICAL	<input type="checkbox"/>	<input type="checkbox"/>		NA
PREPOWER	<input type="checkbox"/>	<input type="checkbox"/>		NA
MECHANICAL	<input type="checkbox"/>	<input type="checkbox"/>		NA
PLUMBING	<input type="checkbox"/>	<input type="checkbox"/>		NA
ROOFING	<input type="checkbox"/>	<input type="checkbox"/>		NA
GAS	<input type="checkbox"/>	<input type="checkbox"/>		NA



City of Belle Isle
 Universal Engineering Sciences 3532 Maggie Blvd., Orlando, FL 32811
 Tel 407-581-8161 * Fax 407-581-0313 * www.universaleengineering.com

Building Permit (Land Use) Application
 To be completed as required by State Statute Section 713 and other applicable sections.

PERMIT # 2014-09-007

Owner's Name Tiafau & Gloria Purcell
 Owner's Address 6649 The Landings DR, ORLANDO, FL 32812

Contractor Name	<u>Richard Eden</u>	Company Name	<u>Eden Construction Corp.</u>
License #	<u>C6C060047</u>	Company Address	<u>10151 University Blvd, Ste 137</u>
Contact Phone/Cell	<u>407-671-9697</u>	City, State, ZIP	<u>Orlando, FL 32817</u>
Contact Email	<u>Rick@edenconstruction.com</u>	Contact Fax	<u>407-671-2223</u>

WARNING TO OWNER: Your failure to record a Notice of Commencement may result in your paying twice for improvements to your property. A notice of commencement must be recorded if job is \$2500(+) or if A/C Replacement \$7500(+) and posted on the job site before the first inspection. If you intend to obtain financing, consult with your lender or an attorney before recording your Notice of Commencement.

I hereby make Application for Permit as outlined above, and if same is granted I agree to conform to all Division of Building Safety Regulations (www.floridabuilding.org) and City Ordinances (www.municode.com) regulating same and in accordance with plans submitted. The issuance of this permit does not grant permission to violate any applicable City and/or State of Florida codes and /or ordinances. Application is hereby made to obtain a permit to do the work and installations as indicated. I certify that no work or installation has commenced prior to the issuance of a permit and that all work will be performed to meet the standards of all laws regulating construction in this jurisdiction. I understand that a separate permit must be secured for all other construction including ROOFING, ELECTRICAL, MECHANICAL, PLUMBING, GAS, SIGNS, POOLS, SCREEN ENCLOSURES, ETC.

OWNER'S AFFIDAVIT: I certify that all the foregoing information is accurate and that all work will be done in compliance with all applicable laws regulating construction and zoning.

Owner Signature Gloria J. Purcell
 The foregoing instrument was acknowledged before me this 3/13/14
 by Gloria Purcell who is personally known to me
 and who produced FL DL P624-290-47669-0
 as identification and who did not take an oath.
 Notary as to Owner
 State of Florida
 County of Orange

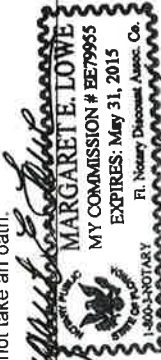

Contractor Signature [Signature]
 COMPANY NAME Eden Construction Corp.
 The foregoing instrument was acknowledged before me this 3/21/14
 by Richard Eden who is personally known to me
 and who produced _____
 as identification and who did not take an oath
 Notary as to Owner
 State of Florida
 County of Orange



Impervious Surface Ratio Worksheet

Development Zoned A-1, A-2, R-1-AAA, R-1-AA, R-1-A, R-1 per City Code, Section 50-74: Impervious Surface Ratio N/A

1. Total Lot Area (sqft) X 0.35 = Allowable Impervious Area (BASE),
 Total Lot Area _____ X 0.35 =
 Allowable Impervious Area (BASE) _____

2. Calculate the "proposed" impervious area on the lot. This includes the sum of all areas that do not allow direct percolation of rainwater. Examples include house, pool, deck, driveway, accessory building, etc

- House _____
- Driveway _____
- Walkway _____
- Accessory Buildings _____
- Pool & Spa _____
- Deck & Patio _____
- Other _____

Actual Impervious Area (AIA) _____

3. If AIA is less than BASE, subtract AIA from BASE to determine the amount of impervious area that may be added without providing onsite retention.

4. If AIA is greater than BASE, then onsite retention must be provided.
 Assuming 7.5 inches of rainfall based on a 24hr 10 year Rain Event (TP40), the formula is: (7.5 inches rainfall/12 inches p/foot) X (result from line 4) = cubic feet of storage volume needed



COBI Permit Fee Calculation Form



Reviewer Signature: AP. Date: 4-07-2014

Permit Type:	<u>Bldg.</u>	Job Cost:	<u>\$ 9,000-</u>
Permit Fee:	<u>\$ 57.00</u>		
Plans Review Fee:	<u>\$ 28.50</u>	(50% of permit fee – excluding ReRoofs)	
1.5% State Fee:	<u>\$ 2.00</u>		
1.5% State Fee:	<u>\$ 2.00</u>		
TOTAL BUILDING FEE:	\$ 89.50	(does not include Zoning fees or Deposits)	

Note: Total gets doubled for SWO/AFT permits

Permit Number: _____
Folio/Parcel ID #: 20-23-30-4980-00-390
Prepared by: _____
Rick Eden
495 Seminole Ave
Winter Park, Fl. 32792

DOCH 20140182033 B: 10729 P: 5908
04/10/2014 12:13:31 PM Page 1 of 1
Rec Fee: \$10.00
Martha O. Haynie, Comptroller
Orange County, FL
NB - Ret To: EDEN CONSTRUCTION CORP



NOTICE OF COMMENCEMENT

State of Florida, County of Orange

The undersigned hereby gives notice that improvement will be made to certain real property, and in accordance with Chapter 713, Florida Statutes, the following information is provided in this Notice of Commencement.

1. Description of property (legal description of the property, and street address if available)

The Landings AT LAKE CONWAY 9/25 LOT 34

2. General description of improvement

ENCLAVE GOLF CANAL

3. Owner information or Lessee information if the Lessee contracted for the improvement

Name Gloria Fucell
Address 6649 The Landings Dr. Del. Fl. 32812

Interest in Property _____

Name and address of fee simple titleholder (if different from Owner listed above)

Name _____

Address _____

4. Contractor

Name Eden Construction Corp. Telephone Number 407-671-9697

Address 10151 UNIVERSITY Blvd. Ste 107 Del. Fl. 32817

5. Surety (if applicable, a copy of the payment bond is attached)

Name _____

Address _____

6. Lender

Name _____

Address _____

7. Persons within the State of Florida designated by Owner upon whom notices or other documents may be served as provided by §713.13(1)(a)7, Florida Statutes.

Name _____

Address _____

8. In addition to himself or herself, Owner designates the following to receive a copy of the Lienor's Notice as provided in §713.13(1)(b), Florida Statutes.

Name _____

Address _____

9. Expiration date of notice of commencement (the expiration date may not be before the completion of construction and final payment to the contractor, but will be 1 year from the date of recording unless a different date is specified)

Name _____

Address _____

10. Signature of Owner or Lessee, or Owner's or Lessee's Authorized Officer/Director/Partner/Manager

Name _____

Address _____

11. Signature of Notary Public - State of Florida

Name _____

Address _____

12. Signature of Notary Public - State of Florida

Name _____

Address _____

13. Signature of Notary Public - State of Florida

Name _____

Address _____

14. Signature of Notary Public - State of Florida

Name _____

Address _____

15. Signature of Notary Public - State of Florida

Name _____

Address _____

16. Signature of Notary Public - State of Florida

Name _____

Address _____

17. Signature of Notary Public - State of Florida

Name _____

Address _____

18. Signature of Notary Public - State of Florida

Name _____

Address _____

WARNING TO OWNER: ANY PAYMENTS MADE BY THE OWNER AFTER THE EXPIRATION OF THE NOTICE OF COMMENCEMENT ARE CONSIDERED IMPROPER PAYMENTS UNDER CHAPTER 713, PART I, SECTION 713.13, FLORIDA STATUTES, AND CAN RESULT IN YOUR PAYING TWICE FOR IMPROVEMENTS TO YOUR PROPERTY. A NOTICE OF COMMENCEMENT MUST BE RECORDED AND POSTED ON THE JOB SITE BEFORE THE FIRST INSPECTION. IF YOU INTEND TO OBTAIN FINANCING, CONSULT WITH YOUR LENDER OR AN ATTORNEY BEFORE COMMENCING WORK OR RECORDING YOUR NOTICE OF COMMENCEMENT.

Gloria Fucell
Signature of Owner or Lessee, or Owner's or Lessee's Authorized Officer/Director/Partner/Manager

The foregoing instrument was acknowledged before me this 21 day of March by Gloria J. Fucell month/year name of person

as Owner for herself
Type of authority, e.g. officer, trustee, attorney in fact

Name of party on behalf of whom instrument was executed

Gloria Fucell
Signature of Notary Public - State of Florida

Print, type, or stamp commissioned name of Notary Public

Personally Known OR Produced ID
Type of ID Produced Pl 24-290-47-669-0



ALUMINUM SCREEN DESIGN

A DIVISION OF DB&C
DESIGN BUILD ENGINEERS & CONTRACTORS

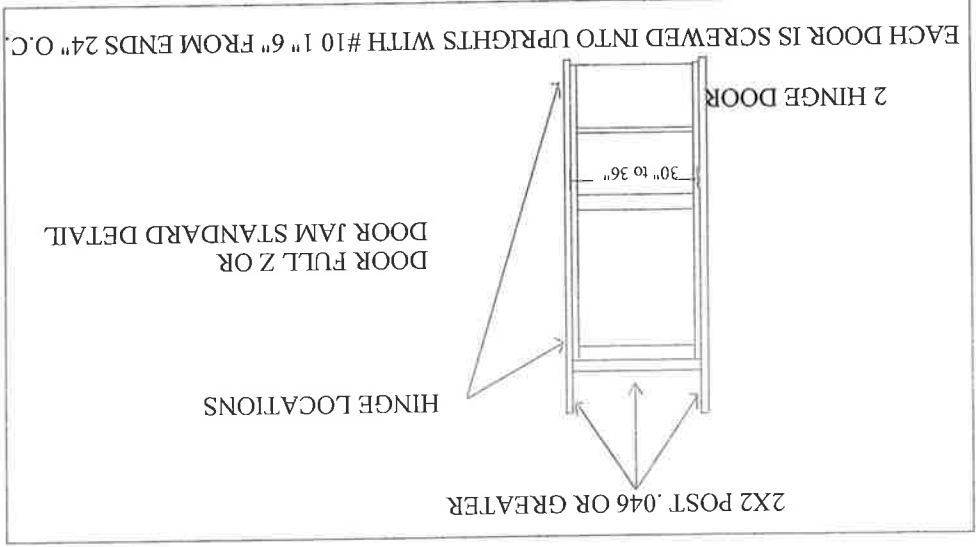

ATTACHMENT DETAIL
 CUSTOM WINDOW
 ALUMINUM FRAME
 WINDOW

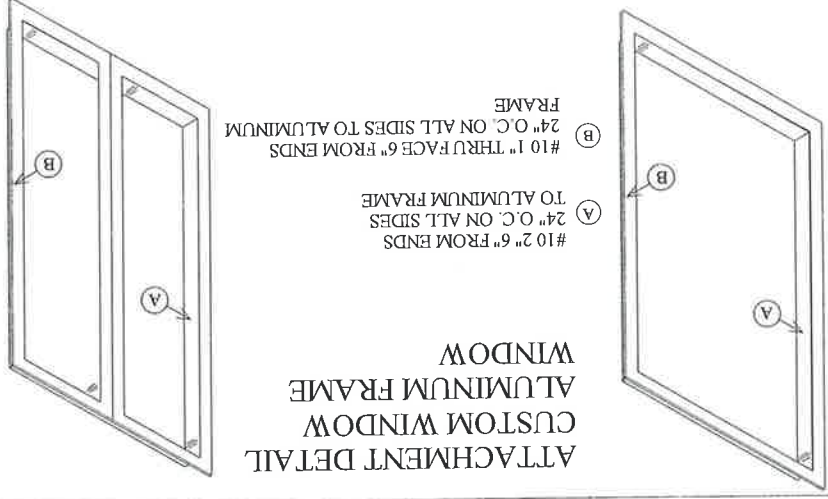

FILL IN DETAIL

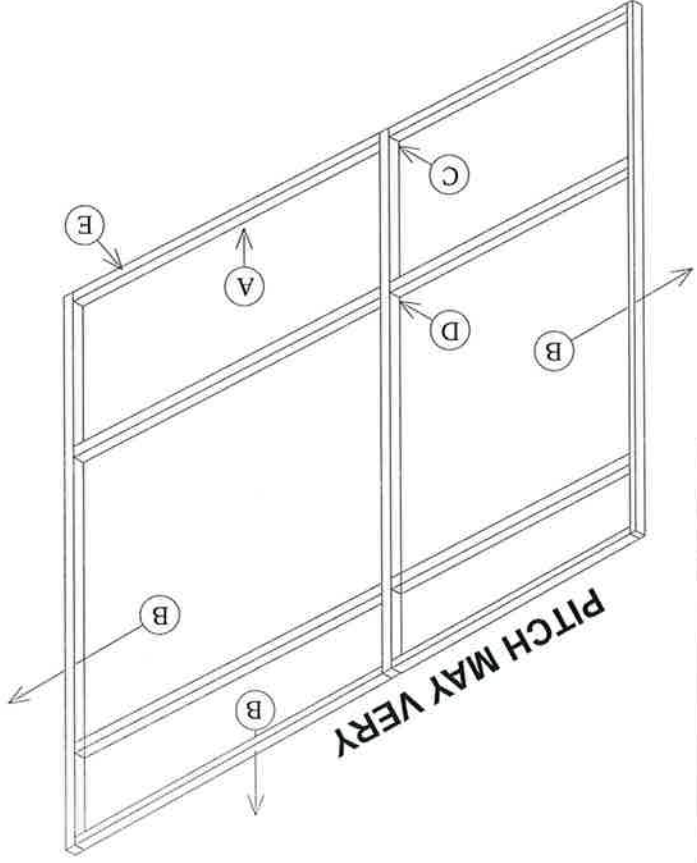

- (A) CONCRETE WITH 2-1/4" X 1/4" TAPCONS 6" FROM ENDS 24" O.C.
- (B) ALUMINUM FRAME IS ATTACHED TO BLOCK WITH 2-1/4" X 1/4" TAPCONS 6" FROM ENDS 24" O.C.
- (C) 2X2 ANGLE IS ATTACHED TO ALUMINUM FRAME WITH 2 #10 1" & 1-1/4" X 1/4" TAPCON PER SIDE WITH EITHER:
 BLIND SCREWED WITH (3) #10 3", CAPRI CLIPPED WITH (4) #10 1" PER CLIP OR INSULATED KICK PLATE IS ATTACHED TO C-CHANNEL WITH #10 1" 6" FROM ENDS 18" O.C.
- (D) CHAIR RAIL & UPRIGHTS ARE ATTACHED WITH EITHER:
 BLIND SCREWED WITH (3) #10 3", CAPRI CLIPPED WITH (4) #10 1" PER CLIP OR INSULATED KICK PLATE IS ATTACHED TO C-CHANNEL WITH #10 1" 6" FROM ENDS 18" O.C.
- (E)



MICHAEL THOMPSON

5200 VINELAND RD.

SUITE 250

ORLANDO, FL 32811

P.E. # 47509

CA#9103

DESIGN STATEMENT

METAL IS .046 THICKNESS OR GREATER, ALLOY IS 6005-T5
 ALL TAPCONS SHALL PROVIDE MINIMUM OF 1/8" EMBEDMENT DEPTH

THIS STRUCTURE HAS BEEN DESIGNED IN ACCORDANCE TO MEET THE REQUIREMENTS OF THE 2010 EDITION OF THE FLORIDA BUILDING CODE FOR OPEN AND SEMI-OPEN STRUCTURES AND SHALL WITHSTAND ULTIMATE WIND SPEEDS OF 140 MPH (FOR 3 SECOND GUSTS) NOMINAL SPEED 109.2 MPH UP TO A 15FT ROOF HEIGHT, FACTOR OF 1.0, AND EXPOSURE D RISK CATEGORY II. CONTRACTOR SHALL VERIFY ALL PLANS DIMENSIONS PRIOR TO MATERIAL PURCHASE, FABRICATION AND CONSTRUCTION. CONTRACTOR SHALL NOTIFY THE ENGINEER IMMEDIATELY SHOULD SITE CONDITIONS DIFFER FROM CONSTRUCTION PLANS.

ALUMINUMSCREENDESIGN.COM

ALUMINUMSCREENDESIGN

@YAHOO.COM

PHONE #: 386-320-0256

FAX #: 888-923-8181



BCIS Home Log In User Registration Hot Topics

Submit Surcharge

Status & Facts

Publications

F&C Staff

BCIS Site Map

Links

Search



Product Approval
USER: Public User

Product Approval Menu > Product or Application Search > Application List > Application Detail

FL # **FL5177-R12**
 Application Type **Revision**
 Code Version **2010**
 Application Status **Approved**

*Approved by DBPR. Approvals by DBPR shall be reviewed and ratified by the POC and/or the Commission if necessary.

Comments
Archived

Product Manufacturer
Address/Phone/Email

Simonton Windows
1 Cochran Ave
Pennsboro, WV 26415
(800) 746-6687 Ext 2329
tiffany_davies@simonton.com

Authorized Signature

Tiffany Davies
tiffany_davies@simonton.com

Technical Representative
Address/Phone/Email

Tiffany Davies
PO Box 1646
5300 Briscoe Road
Parkersburg, WV 26102
(800) 542-9118 Ext 9329
tiffany_davies@simonton.com

Quality Assurance Representative
Address/Phone/Email



AAMA
1827 Walden Office Square
Suite 550
Schaumburg, IL 60173
(847) 303-5664
webmaster@aamanet.org

Category
Subcategory

Windows
Fixed

Compliance Method

Certification Mark or Listing

Certification Agency
Validated By

American Architectural Manufacturers Association
American Architectural Manufacturers Association

Referenced Standard and Year (of Standard)

Standard	Year
AAMA 450	2010
AAMA/WDMA/CSA 101/I.S 2/A440	2005
AAMA/WDMA/CSA 101/I.S 2/A440	2008
ASTM E 1300	2004

Equivalence of Product Standards
Certified By

Product Approval Method

Method 1 Option A

Date Submitted

07/11/2013

Date Validated

07/15/2013

Date Pending FBC Approval

07/23/2013

Date Approved

Summary of Products

FL #	Model, Number or Name	Description
5177.1	07-09, 07-10, 07-20 (Retrofit Installation)	<p>Reflections 5500, Prism Platinum, Sears 9300, Impressions 9800, Generations, Grand Estates Premier, Grand Estates Premium Plus, Grandura Vinyl Fixed Window</p> <p>Certification Agency Certificate FL5177_R12_C_CAC_07-09_PW_37x84_R50.pdf FL5177_R12_C_CAC_07-09_PW_74x63_LC55.pdf FL5177_R12_C_CAC_10-20_walver_t0-09.pdf</p> <p>Quality Assurance Contract Expiration Date 07/23/2014</p> <p>Installation Instructions FL5177_R12_IL_IN0108_07-09_07-10_07-20_PW_2X.pdf FL5177_R12_IL_IN0111_07-09_07-10_07-20_PW_1X.pdf</p> <p>Verified By: American Architectural Manufacturers Association Created by Independent Third Party:</p> <p>Evaluation Reports FL5177_R12_AE_PER_2308_07-09_07-10_07-20_Fixed Window 1X.pdf Created by Independent Third Party: Yes</p>
5177.2	07-20 (Nailing Fin Installation)	<p>Reflections 5500, Prism Platinum, Sears 9300, Impressions 9800, Generations, Grand Estates Premier, Grand Estates Premium Plus, Grandura Vinyl Fixed Window</p> <p>Certification Agency Certificate FL5177_R12_C_CAC_07-20_PW_37x84_R50.pdf FL5177_R12_C_CAC_07-20_PW_74x63_R60.pdf FL5177_R12_C_CAC_07-20_PW_96x72_R45.pdf</p> <p>Quality Assurance Contract Expiration Date 11/01/2014</p> <p>Installation Instructions FL5177_R12_IL_IN0514_07-20_PW_2X.pdf</p> <p>Verified By: American Architectural Manufacturers Association Created by Independent Third Party:</p> <p>Evaluation Reports Created by Independent Third Party:</p>
5177.3	07-75, 07-09, 07-10, 07-20	<p>Reflections 5500, Prism Platinum, Sears 9300, Impressions 9800, Generations, Grand Estates Premier, Grand Estates Premium Plus, Grandura, THD 6500 Vantage Pointe Vinyl Fixed Window</p> <p>Certification Agency Certificate FL5177_R12_C_CAC_07-09_07-75_PW_63x63_LC50.pdf FL5177_R12_C_CAC_07-09_07-75_PW_72x63_LC60.pdf FL5177_R12_C_CAC_07-09_07-75_PW_96x72_LC45.pdf FL5177_R12_C_CAC_10-20_walver_t0-09.pdf</p> <p>Quality Assurance Contract Expiration Date 11/18/2013</p> <p>Installation Instructions FL5177_R12_IL_IN0221_07-75_PW_1X.pdf FL5177_R12_IL_IN0222_07-75_07-09_07-10_07-20_PW_2X.pdf</p> <p>Verified By: American Architectural Manufacturers Association Created by Independent Third Party:</p> <p>Evaluation Reports FL5177_R12_AE_PER_1613_07-75_Fixed Window 1X.pdf Created by Independent Third Party: Yes</p>

5177.4	08-08	<p>Limits of Use Approved for use in HVHZ: No Approved for use outside HVHZ: Yes Impact Resistant: No Design Pressure: N/A Other: 96x72 (+/-25 PSF), 74x63 (+/-55 PSF)</p>	<p>ProFinish Contractor/Master, Grand Estates New Construction Vinyl Fixed (No Hinge) Casement</p> <p>Certification Agency Certificate FL5177 R12 C CAC 08-08 PW (Fin) 74x63 LC PG55.pdf FL5177 R12 C CAC 08-08 PW (Fin) 96x72 LC PG25.pdf</p> <p>Quality Assurance Contract Expiration Date 04/26/2017</p> <p>Installation Instructions FL5177 R12 II IN0328 08-08 NH 2X.pdf Verified By: American Architectural Manufacturers Association Created by Independent Third Party: Evaluation Reports Created by Independent Third Party:</p>
5177.5	08-09, 08-10, 08-20	<p>Limits of Use Approved for use in HVHZ: No Approved for use outside HVHZ: Yes Impact Resistant: No Design Pressure: N/A Other: 96x72 (+/-40 PSF), 80x63 (+/-55 PSF)</p>	<p>Reflections 5500, Prism Platinum, Generations, Impressions 9400/9800, Sears 9300, THD 6100/6500 Vantage Pointe, Grand Estates Premium Plus, Grandura Vinyl Fixed (No Hinge) Casement</p> <p>Certification Agency Certificate FL5177 R12 C CAC 08-09 NH 80x63 R55.pdf FL5177 R12 C CAC 08-09 NH 96x72 R40.pdf FL5177 R12 C CAC -10-20 waiver to -09.pdf</p> <p>Quality Assurance Contract Expiration Date 10/15/2013</p> <p>Installation Instructions FL5177 R12 II IN0329 08-09 NH 2X.pdf FL5177 R12 II IN0456 08-09 NH 1X.pdf Verified By: American Architectural Manufacturers Association Created by Independent Third Party: Evaluation Reports Created by Independent Third Party: Yes</p>
5177.6	41-18	<p>Limits of Use Approved for use in HVHZ: No Approved for use outside HVHZ: Yes Impact Resistant: No Design Pressure: N/A Other: 96x72 (+/-30 PSF), 96x63 (+/-50 PSF), 80x48 (+/-55 PSF)</p>	<p>ProFinish Brickmould 300 Vinyl Fixed Window</p> <p>Certification Agency Certificate FL5177 R12 C CAC 41-18 PW 80x48 LC55.pdf FL5177 R12 C CAC 41-18 PW 96x63 C50.pdf FL5177 R12 C CAC 41-18 PW 96x72 LC30.pdf</p> <p>Quality Assurance Contract Expiration Date 05/21/2016</p> <p>Installation Instructions FL5177 R12 II IN0237 41-18 PW 2X.pdf Verified By: American Architectural Manufacturers Association Created by Independent Third Party: Evaluation Reports Created by Independent Third Party:</p>
5177.7	41-18	<p>Limits of Use Approved for use in HVHZ: No Approved for use outside HVHZ: Yes Impact Resistant: No Design Pressure: N/A Other: 89x63 (+/-30 PSF), 97x80 (+/-40 PSF), 73x74 (+/-50 PSF)</p>	<p>ProFinish Brickmould 300 Vinyl Fixed Window Twin</p> <p>Certification Agency Certificate FL5177 R12 C CAC 41-18 PW Twin 73x74 R50.pdf FL5177 R12 C CAC 41-18 PW Twin 89x63 R30.pdf FL5177 R12 C CAC 41-18 PW Twin 97x80 R25.pdf FL5177 R12 C CAC 41-18 PW Twin 97x80 R40.pdf</p> <p>Quality Assurance Contract Expiration Date 04/05/2016</p> <p>Installation Instructions FL5177 R12 II IN0240 41-18 PW Twin 2X.pdf Verified By: American Architectural Manufacturers Association Created by Independent Third Party: Evaluation Reports Created by Independent Third Party:</p>
5177.8	41-18	<p>Limits of Use Approved for use in HVHZ: No Approved for use outside HVHZ: Yes Impact Resistant: No Design Pressure: +35/-35</p>	<p>ProFinish Brickmould 300 Vinyl Fixed Window Triple</p> <p>Certification Agency Certificate FL5177 R12 C CAC 41-18 PW Triple 109x63 R35.pdf</p> <p>Quality Assurance Contract Expiration Date 10/14/2013</p> <p>Installation Instructions</p>

<p>Other: 109x63</p>	<p>FL5177_R12_II_IN0310_41-18_PW_Triple_2X.pdf Verified By: American Architectural Manufacturers Association Created by Independent Third Party: Evaluation Reports Created by Independent Third Party:</p>
<p>5177.9 42-19</p> <p>Limits of Use Approved for use in HVHZ: No Approved for use outside HVHZ: Yes Impact Resistant: No Design Pressure: N/A Other: 96x72 (+/-35 PSF), 74x63 (+/-50 PSF), 80x48 (+/-50 PSF)</p>	<p>ProFinish Brickmould 600 Vinyl Fixed Window</p> <p>Certification Agency Certificate FL5177_R12_C_CAC_42-19_PW_74x63_R50.pdf FL5177_R12_C_CAC_42-19_PW_80x48_R50.pdf FL5177_R12_C_CAC_42-19_PW_96x72_R35.pdf Quality Assurance Contract Expiration Date 09/08/2014 Installation Instructions FL5177_R12_II_IN0154_42-19_PW_2X.pdf Verified By: American Architectural Manufacturers Association Created by Independent Third Party: Evaluation Reports Created by Independent Third Party:</p>
<p>5177.10 42-19</p> <p>Limits of Use Approved for use in HVHZ: No Approved for use outside HVHZ: Yes Impact Resistant: No Design Pressure: +35/-35 Other: 97x80</p>	<p>ProFinish Brickmould 600 Vinyl Fixed Window Twin</p> <p>Certification Agency Certificate FL5177_R12_C_CAC_42-19_PW_T-Mull_Twin_97x80_R35.pdf Quality Assurance Contract Expiration Date 11/01/2014 Installation Instructions FL5177_R12_II_IN0155_42-19_PW_Twin_2X.pdf Verified By: American Architectural Manufacturers Association Created by Independent Third Party: Evaluation Reports Created by Independent Third Party:</p>
<p>5177.11 42-19</p> <p>Limits of Use Approved for use in HVHZ: No Approved for use outside HVHZ: Yes Impact Resistant: No Design Pressure: +35/-35 Other: 109x74</p>	<p>ProFinish Brickmould 600 Vinyl Fixed Window Triple</p> <p>Certification Agency Certificate FL5177_R12_C_CAC_42-19_PW_T-Mull_Triple_109x74_R35.pdf Quality Assurance Contract Expiration Date 11/01/2014 Installation Instructions FL5177_R12_II_IN0156_42-19_PW_Triple_2X.pdf Verified By: American Architectural Manufacturers Association Created by Independent Third Party: Evaluation Reports Created by Independent Third Party:</p>
<p>5177.12 43-06</p> <p>Limits of Use Approved for use in HVHZ: No Approved for use outside HVHZ: Yes Impact Resistant: No Design Pressure: N/A Other: 96x72 (+/-30 PSF), 96x63 (+/-45 PSF), 72x63 (+/-50 PSF)</p>	<p>ProFinish Builder, 6060 Vantage Pointe Vinyl Fixed Window</p> <p>Certification Agency Certificate FL5177_R12_C_CAC_43-06_PW_48x63_R50.pdf FL5177_R12_C_CAC_43-06_PW_72x63_R50.pdf FL5177_R12_C_CAC_43-06_PW_96x63_R45.pdf FL5177_R12_C_CAC_43-06_PW_96x72_LC30.pdf Quality Assurance Contract Expiration Date 04/02/2014 Installation Instructions FL5177_R12_II_IN0294_43-06_PW_2X.pdf Verified By: American Architectural Manufacturers Association Created by Independent Third Party: Evaluation Reports Created by Independent Third Party:</p>
<p>5177.13 43-17</p> <p>Limits of Use Approved for use in HVHZ: No Approved for use outside HVHZ: Yes Impact Resistant: No Design Pressure: N/A</p>	<p>ProFinish Contractor/Master, Grand Estates New Construction Vinyl Fixed Window</p> <p>Certification Agency Certificate FL5177_R12_C_CAC_43-17_PW_74x63_R50.pdf FL5177_R12_C_CAC_43-17_PW_80x48_R55.pdf FL5177_R12_C_CAC_43-17_PW_96x63_R35.pdf FL5177_R12_C_CAC_43-17_PW_96x72_C30.pdf</p>

<p>Other: 96x72 (+/-30 PSF), 96x63 (+/-35 PSF), 74x63 (+/-50 PSF), 80x48 (+/-55 PSF)</p>	<p>Quality Assurance Contract Expiration Date 12/07/2014 Installation Instructions FL5177_R12_II_IN0088_43-17_PW_1X.pdf FL5177_R12_II_IN0278_43-17_PW_2X.pdf Verified By: American Architectural Manufacturers Association Created by Independent Third Party: Evaluation Reports FL5177_R12_AE_PER_2309 - 43-17_Fixed_Window_1X_SS.pdf Created by Independent Third Party: Yes</p>
<p>5177.14</p> <p>43-35</p> <p>Limits of Use Approved for use in HVHZ: No Approved for use outside HVHZ: Yes Impact Resistant: No Design Pressure: N/A Other: 96x72 (+/-40 PSF), 74x63 (+/-50 PSF), 80x48 (+/-50 PSF)</p>	<p>6100 Vantage Pointe,ASURE, Prism Gold, Grand Estates, Vinyl Fixed Window</p> <p>Certification Agency Certificate FL5177_R12_C_CAC_43-35_PW_74x63_LC50.pdf FL5177_R12_C_CAC_43-35_PW_80x48_LC50.pdf FL5177_R12_C_CAC_43-35_PW_96x72_LC40.pdf 09/10/2016 Installation Instructions FL5177_R12_II_IN0094_43-35_PW_2X.pdf Verified By: American Architectural Manufacturers Association Created by Independent Third Party: Evaluation Reports Created by Independent Third Party:</p>
<p>5177.15</p> <p>43-35</p> <p>Limits of Use Approved for use in HVHZ: No Approved for use outside HVHZ: Yes Impact Resistant: No Design Pressure: +50/-50 Other: 109x72</p>	<p>6100 Vantage Pointe,ASURE, Prism Gold, Grand Estates Vinyl Fixed Window Triple</p> <p>Certification Agency Certificate FL5177_R12_C_CAC_43-35_PW_Triple_109x72_R50.pdf 01/25/2016 Installation Instructions FL5177_R12_II_IN0356_43-35_PW_Triple_2X.pdf Verified By: American Architectural Manufacturers Association Created by Independent Third Party: Evaluation Reports Created by Independent Third Party:</p>
<p>5177.16</p> <p>43-35</p> <p>Limits of Use Approved for use in HVHZ: No Approved for use outside HVHZ: Yes Impact Resistant: No Design Pressure: +35/-35 Other: 73x111</p>	<p>6100 Vantage Pointe,ASURE, Prism Gold, Grand Estates Vinyl Fixed Window Twin with Transom</p> <p>Certification Agency Certificate FL5177_R12_C_CAC_43-35_PW_Twin_w_Transom_73x111_R35.pdf 01/25/2016 Installation Instructions FL5177_R12_II_IN0355_43-35_PW_Twin_w_Transom_2X.pdf Verified By: American Architectural Manufacturers Association Created by Independent Third Party: Evaluation Reports Created by Independent Third Party:</p>
<p>5177.17</p> <p>43-40</p> <p>Limits of Use Approved for use in HVHZ: No Approved for use outside HVHZ: Yes Impact Resistant: No Design Pressure: N/A Other: 96x72 (+/-40 PSF), 74x63 (+/-50 PSF), 80x48 (+/-50 PSF)</p>	<p>Reflections 5050/5300, Prism Bronze/Ultra Gold, Impressions 9400, THD Vantage Pointe 6100, Grand Estates, Grand Estates Plus Vinyl Fixed Window</p> <p>Certification Agency Certificate FL5177_R12_C_CAC_43-40_PW_74x63_LC50.pdf FL5177_R12_C_CAC_43-40_PW_80x48_LC50.pdf FL5177_R12_C_CAC_43-40_PW_96x72_LC40.pdf 10/05/2016 Installation Instructions FL5177_R12_II_IN0094_43-40_PW_2X.pdf Verified By: American Architectural Manufacturers Association Created by Independent Third Party: Evaluation Reports Created by Independent Third Party:</p>

OVERALL SIZE		DP RATING	
WIDTH	HEIGHT	"W"	"H"
±25 PSF	±25 PSF	72"	96"
±55 PSF	±55 PSF	63"	74"

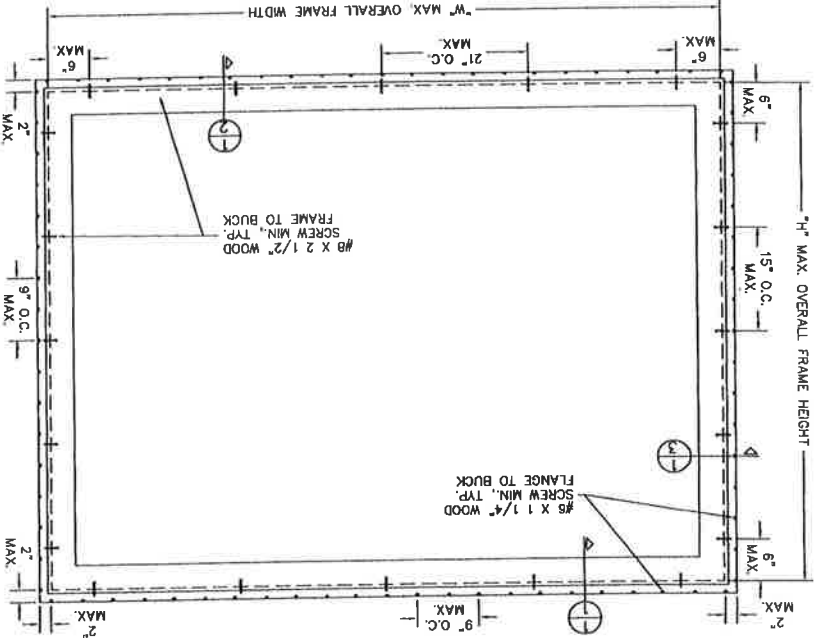

MODEL DESIGNATION: Simonton No Hinge Casement Series 08-08 Vinyl Window

MAXIMUM OVERALL NOMINAL SIZE: See Size Chart

DESIGN PRESSURE RATING: See Size Chart

USABLE CONFIGURATIONS: 0

GENERAL DESCRIPTION: The head, sill, and side jamba are extruded PVC. The wall thickness through which the anchor screw penetrates is a minimum of 0.70".

DISCLOSURE STATEMENT
This document is the property of Simonton Windows, which retains all proprietary and other rights to the subject matter. This document is provided to the recipient on the expressed condition that it is not to be duplicated, reproduced in whole or part, nor used in conjunction with the design, manufacture or repair of goods for anyone other than Simonton Windows without its consent. This restriction does not limit the recipient's right to utilize information contained in this document which is properly obtained from another source.

MATERIALS:	
FINISH:	Aluminum Anodized
ALLOY & TEMPER:	6061-T6
WEIGHT:	As Shown
VOLUME:	As Shown
PERMITS:	As Shown
SURFACE AREA:	As Shown
FINISH TREATMENT:	As Shown

DIMENSIONAL TOLERANCES	
Angles	±.03
Other	±.005

TITLE:	
08-08 NO HINGE CASEMENT	
2X BUCK INSTALLATION	

REVISIONS:		
REV	DATE	DESCRIPTION
1	01/04/10	CORRECTED SASH FRAME CODE
2	03/31/11	UPDATED ANCHOR LOCATIONS PER NEW TESTING

REVISED BY:	
DATE:	01/04/10
DATE:	03/31/11

NOTES:

- This installation has been evaluated for use in locations adhering to the Texas & Florida Building Codes and where pressure requirements as determined by ASCE 7 Minimum Design Loads for Buildings and Other Structures do not exceed the design pressure ratings herein, for use outside the H.V.H.Z.
- All interior and exterior perimeter surfaces of the window must be caulked.
- Anchor bolts shall be as specified and spaced as shown. Anchor embedment to base material shall be beyond wall dressing or stucco and into wood.
- The responsibility for selection of Simonton products to meet any applicable local laws, building codes, ordinances, or other safety requirements rests solely with the architect, building owner, or contractor.
- Shims are optional. Max. shim stock is 1/4".
- Wood bucks (by others) must be engineered and anchored properly to transfer loads to the structure.
- When used in areas requiring impact protection, this product REQUIRES the use of approved impact resistant shutters or other external protection.
- Flashing should be applied using the ASTM E 2112 method appropriate for the opening into which the window is being installed.
- Installation screws (excluding anchors through nailing fin) must be at least 3/4" from the edge of the wood.

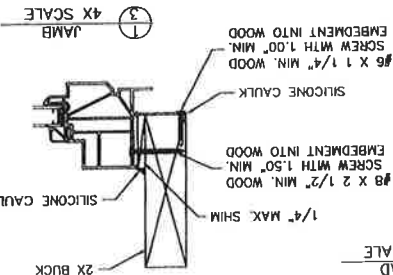
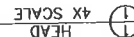

REVISED BY:	
DATE:	01/04/10
DATE:	03/31/11

FLORIDA DEPARTMENT OF
Business & Professional Regulation

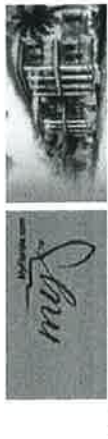

BCIS Home | Log In | User Registration | Hot Topics | Submit Surcharge | Stats & Facts | Publications | BCIS Site Map | Links | Search

Product Approval
USER: Public User

License Authority: Regulate Only

Product Approval Menu > Product or Application Search > Application List > **Application Detail**

OFFICE OF THE SECRETARY

FL # **FL5179-R12**
 Application Type **Revision**
 Code Version **2010**
 Application Status **Applied For**
 Comments **Reviewed 12/10/13, r-a 12/18/13**
 Archived

Product Manufacturer **Simonton Windows**
 Address/Phone/Email **1 Cochran Ave
 Pennsboro, WV 26415
 (800) 746-6687 Ext 2329
 tiffany_davies@simonton.com**

Authorized Signature **Tiffany Davies
 tiffany_davies@simonton.com**

Technical Representative Address/Phone/Email **Tiffany Davies
 PO Box 1646
 5300 Briscoe Road
 Parkersburg, WV 26102
 (800) 542-9118 Ext 9329
 tiffany_davies@simonton.com**

Quality Assurance Representative Address/Phone/Email **AAMA
 1827 Walden Office Square
 Suite 550
 Schaumburg, IL 60173
 (847) 303-5664
 webmaster@aamanet.org**



Category **Windows**
 Subcategory **Horizontal Slider**

Compliance Method **Certification Mark or Listing**
 Certification Agency Validated By **American Architectural Manufacturers Association
 American Architectural Manufacturers Association**

Referenced Standard and Year (of Standard) **Standard Year**
AAMA/WDMA/CSA 101/I.S.2/A440 2005
AAMA/WDMA/CSA 101/I.S.2/A440 2008

Equivalence of Product Standards Certified By

Product Approval Method

Method 1 Option A

Date Submitted

11/15/2013

Date Validated

Summary of Products	
FL #	Description
5179.1	<p>Reflections 5500, Prism Platinum, Generations, Impressions 9800, Sears 9300, Amcraft Grand Estates Premier, Amcraft Grand Estates Premium Plus, Grandura Vinyl 2-Lite Horizontal Slider</p> <p>Certification Agency Certificate FL5179_R12_C_CAC_07-09_HS_63x48_R_PG55.pdf FL5179_R12_C_CAC_07-09_HS_73x51_R_PG50.pdf FL5179_R12_C_CAC_07-09_HS_78x63_R_PG25.pdf FL5179_R12_C_CAC_07-10_07-20_to_07-09_Waiver.pdf</p> <p>Quality Assurance Contract Expiration Date 04/25/2017</p> <p>Installation Instructions FL5179_R12_II_IN0137_07-09_07-10_07-20_SL_2X.pdf Verified By: American Architectural Manufacturers Association Created by Independent Third Party: Evaluation Reports Created by Independent Third Party:</p>
5179.2	<p>Reflections 5500, Prism Platinum, Generations, Impressions 9800, Sears 9300, Amcraft Grand Estates Premier, Amcraft Grand Estates Premium Plus, Grandura Vinyl 3-Lite Endvent Slider</p> <p>Certification Agency Certificate FL5179_R12_C_CAC_07-09_EV_100x48_R_PG45.pdf FL5179_R12_C_CAC_07-09_EV_105x51_R_PG45.pdf FL5179_R12_C_CAC_07-09_EV_136x63_R_PG25.pdf FL5179_R12_C_CAC_07-09_EV_148x48_R_PG30.pdf FL5179_R12_C_CAC_07-09_EV_84x48_R_PG55.pdf FL5179_R12_C_CAC_07-09_EV_84x63_R_PG30.pdf FL5179_R12_C_CAC_07-10_07-20_to_07-09_Waiver.pdf</p> <p>Quality Assurance Contract Expiration Date 06/05/2017</p> <p>Installation Instructions FL5179_R12_II_IN0227_07-09_07-10_07-20_EV_2X.pdf FL5179_R12_II_IN0227_07-09_EV_2X.pdf Verified By: American Architectural Manufacturers Association Created by Independent Third Party: Evaluation Reports Created by Independent Third Party:</p>
5179.3	<p>Reflections 5500, Prism Platinum, Generations, Impressions 9800, Sears 9300, Amcraft Grand Estates Premium Plus, Grandura Vinyl 2-Lite Horizontal Slider</p> <p>Certification Agency Certificate FL5179_R12_C_CAC_07-20_HS_73x62_R_PG50_(ext.).pdf 07/27/2016</p> <p>Quality Assurance Contract Expiration Date 07/27/2016</p> <p>Installation Instructions FL5179_R12_II_IN0526_07-20_SL_2X.pdf Verified By: American Architectural Manufacturers Association Created by Independent Third Party: Evaluation Reports Created by Independent Third Party:</p>
5179.4	<p>THD 6500 Vantage Pointe Vinyl 3-Lite Endvent Slider</p> <p>Certification Agency Certificate FL5179_R12_C_CAC_07-75_EV_100x48_R_PG45.pdf FL5179_R12_C_CAC_07-75_EV_110x63_R_PG40.pdf FL5179_R12_C_CAC_07-75_EV_136x63_R_PG25.pdf FL5179_R12_C_CAC_07-75_EV_84x48_R_PG55.pdf FL5179_R12_C_CAC_07-75_EV_84x63_R_PG30.pdf</p> <p>Quality Assurance Contract Expiration Date 10/15/2017</p> <p>Installation Instructions</p>

5179.5	07-75	<p>FL5179_R12_II_IN0145_07-75_EV_2X.pdf Verified By: American Architectural Manufacturers Association Created by Independent Third Party: Evaluation Reports Created by Independent Third Party:</p> <p>THD 6500 Vantage Pointe Vinyl 2-Lite Horizontal Slider</p> <p>Certification Agency Certificate FL5179_R12_C_CAC_07-75_HS_63x48_R_PG55.pdf FL5179_R12_C_CAC_07-75_HS_72x48_R_PG45.pdf FL5179_R12_C_CAC_07-75_HS_78x63_R_PG25.pdf FL5179_R12_C_CAC_07-75_HS_78x63_R_PG40.pdf Quality Assurance Contract Expiration Date 10/15/2017</p> <p>Installation Instructions FL5179_R12_II_IN0225_07-75_SL_2X.pdf Verified By: American Architectural Manufacturers Association Created by Independent Third Party: Evaluation Reports Created by Independent Third Party:</p>
5179.6	41-18	<p>ProFinish BrickMould 300 Vinyl 2-Lite Horizontal Slider</p> <p>Certification Agency Certificate FL5179_R12_C_CAC_41-18_HS_73x63_R30.pdf Quality Assurance Contract Expiration Date 09/12/2016</p> <p>Installation Instructions FL5179_R12_II_IN0234_41-18_SL_2X.pdf Verified By: American Architectural Manufacturers Association Created by Independent Third Party: Evaluation Reports Created by Independent Third Party:</p>
5179.7	42-19	<p>ProFinish BrickMould 600 Vinyl 2-Lite Horizontal Slider</p> <p>Certification Agency Certificate FL5179_R12_C_CAC_42-19_HS_60x52_R_PG45.pdf FL5179_R12_C_CAC_42-19_HS_69x65_R_PG25 (ext.).pdf FL5179_R12_C_CAC_42-19_HS_72x36_R_PG40 (ext.).pdf FL5179_R12_C_CAC_42-19_HS_72x54_R_PG30 (ext.).pdf FL5179_R12_C_CAC_42-19_HS_78x63_R_PG25 (ext.).pdf Quality Assurance Contract Expiration Date 07/10/2015</p> <p>Installation Instructions FL5179_R12_II_IN0152_42-19_SL_2X.pdf Verified By: American Architectural Manufacturers Association Created by Independent Third Party: Evaluation Reports Created by Independent Third Party:</p>
5179.8	42-19	<p>Simonton ProFinish Brickmould 600 Vinyl 3-Lite Endvent Slider</p> <p>Certification Agency Certificate FL5179_R12_C_CAC_42-19_EV_84x36_R_PG40 (ext.).pdf Quality Assurance Contract Expiration Date 12/07/2016</p> <p>Installation Instructions FL5179_R12_II_IN0153_42-19_EV_2X.pdf Verified By: American Architectural Manufacturers Association Created by Independent Third Party: Evaluation Reports Created by Independent Third Party:</p>
5179.9	43-06 and 43-17	<p>THD 6060 Vantage Point, ProFinish Builder, ProFinish Contractor, ProFinish Master, Grand Estates New Construction Vinyl 3-Lite Endvent Slider</p> <p>Certification Agency Certificate FL5179_R12_C_CAC_43-06_EV (Fin)_96x63_R_PG30 (ext.).pdf FL5179_R12_C_CAC_43-17 to 43-06_Waiver.pdf Quality Assurance Contract Expiration Date 09/07/2016</p> <p>Installation Instructions FL5179_R12_II_IN0170_43-06_43-17_EV_2X.pdf Verified By: American Architectural Manufacturers</p>

PSF), 72x36 (+/-40 PSF)		05/12/2016 Installation Instructions FL5179_R12_II_IN0139_43-40_SL_2X.pdf Verified By: American Architectural Manufacturers Association Evaluation Reports Created by Independent Third Party: Created by Independent Third Party:
5179.15	43-40	Reflections 5050, Reflections 5300, Prism Bronze, Prism Ultra Gold, THD 6100 Vantage Pointe, Amcraft Grand Estates, Amcraft Grand Estates Plus Vinyl 3-Lite Endvent Slider
Limits of Use Approved for use in HVHZ: No Approved for use outside HVHZ: Yes Impact Resistant: No Design Pressure: +40/-40 Other: 84x36		
Certification Agency Certificate FL5179_R12_C_CAC_43-40_EV_84x36_R-PG40.pdf Quality Assurance Contract Expiration Date 11/20/2017 Installation Instructions FL5179_R12_II_IN0147_43-40_EV_2X.pdf Verified By: American Architectural Manufacturers Association Created by Independent Third Party: Evaluation Reports Created by Independent Third Party:		

Contact Us :: 1940 North Monroe Street, Tallahassee FL 32399 Phone: 850-487-1824

The State of Florida is an AA/EEO employer. Copyright 2007-2013 State of Florida. :: Privacy Statement :: Accessibility Statement :: Refund Statement

Under Florida law, email addresses are public records. If you do not want your e-mail address released in response to a public-records request, do not send electronic mail to this entity. Instead, contact the office by phone or by traditional mail. If you have any questions, please contact 850.487.1395.

*Pursuant to Section 455.275(1), Florida Statutes, effective October 1, 2012, licensees licensed under Chapter 455, F.S. must provide the Department with an email address if they have one. The emails provided may be used for official communication with the licensee. However email addresses are public record. If you do not wish to supply a personal address, please provide the Department with an email address which can be made available to the public. To determine if you are a licensee under Chapter 455, F.S., please click [here](#).

Product Approval Accepts:



MODEL DESIGNATION: Simonton Horizontal Slider Series 07-09 / 07-10 / 07-20 Vinyl Window

MAXIMUM OVERALL NOMINAL SIZE: See Size Chart

DESIGN PRESSURE RATING: See Size Chart

USABLE CONFIGURATIONS: XX, OX, or XO

GENERAL DESCRIPTION: The head, sill, and side jambs are extruded PVC. The wall thickness through which the anchor screw penetrates is a minimum of 0.070".

NO P.E. SEAL REQUIRED
INSTALLATION SUPPORTED
BY AAMA TEST REPORTS

REV. #	REVISIONS	REVISED BY	DATE
3	UPDATED NOTES AND GENERAL DESCRIPTION.	T.D.D.	07/08/10
4	ADDED FLASHING NOTE.	T.D.D.	04/07/11
5	UPDATED SIZES PER TESTING.	T.D.D.	05/24/11
6	ADDED GLAZING DETAILS.	T.D.D.	06/08/11
7	ADDED NOTE 10.	T.D.D.	01/09/12

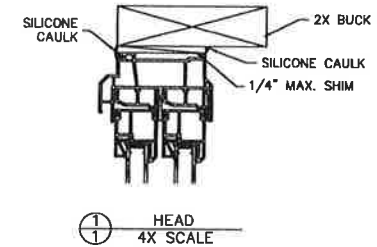
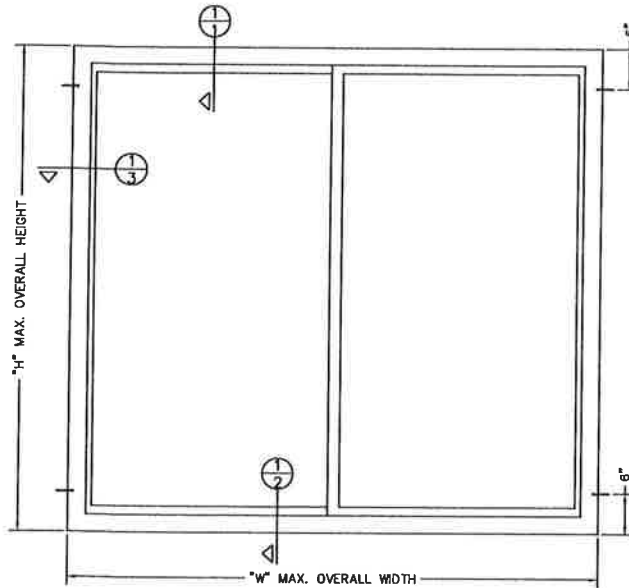

1 HEAD
4X SCALE

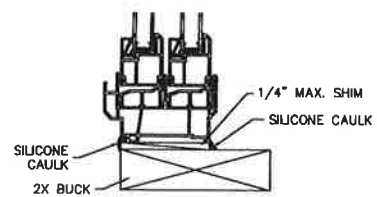

2 SILL
4X SCALE

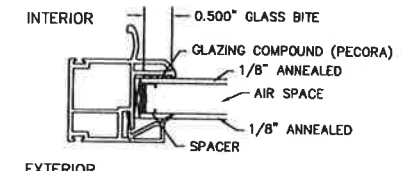

GLAZING DETAILS

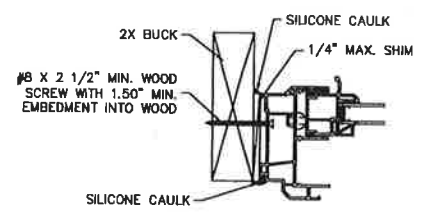

3 JAMB
4X SCALE

NOTES:

1. This installation has been evaluated for use in locations adhering to the Florida Building Code and where pressure requirements as determined by ASCE 7 Minimum Design Loads for Buildings and Other Structures do not exceed the design pressure ratings herein, for use outside the H.V.H.Z.
2. All exterior perimeter surfaces of the window must be caulked. Interior caulking is optional unless noted otherwise.
3. Anchors shall be specified and spaced as shown. Anchor embedment to base material shall be beyond wall dressing or stucco and into wood.
4. The responsibility for selection of Simonton products to meet any applicable local laws, building codes, ordinances, or other safety requirements rests solely with the architect, building owner, or contractor.
5. Shims are optional. Maximum shim stack is 1/4".
6. Wood bucks (by others) must be engineered and anchored properly to transfer loads to the structure.
7. When used in areas requiring impact protection, this product REQUIRES the use of approved impact resistant shutters or other external protection.
8. Flashing should be applied using the ASTM E 2112 method appropriate for the opening into which the window is being installed.
9. Installation screws must be at least 3/4" from the edge of the wood.
10. This product complies with ASTM E 1300-04.

SIZE CHART		
OVERALL SIZE		DP RATING
WIDTH "W"	HEIGHT "H"	
78"	63"	±25 PSF
73"	51"	±50 PSF
63"	48"	±55 PSF

<p>DISCLOSURE STATEMENT</p> <p>This document is the property of Simonton Windows, which retains all proprietary and other rights to its subject matter. This document is provided to the recipient on the expressed condition that it is not to be disclosed, reproduced in whole or part, nor used in conjunction with the design, manufacture or repair of goods for anyone other than Simonton Windows without its consent. This restriction does not limit the recipient's rights to utilize information contained in this document which is properly obtained from another source.</p> <p>FILE: IN0137</p>	<p>MATERIAL:</p> <p>KMS FINISH: _____</p> <p>EXPERT AS NOTED</p> <p>ALLOY & TEMPER: _____</p> <p>WEIGHT: _____</p> <p>VOLUME: _____</p> <p>SURFACE AREA: _____</p> <p>PERIMETER: _____</p> <p>FINISH TREATMENT: _____</p>	<p>Dimensional Tolerances Unless Otherwise Specified</p> <p>Decimals Angles</p> <p>.X ± .03 .XX ± .01 .XXX ± .005</p> <p>0' 30 min.</p>	<p>SIMONTON WINDOWS</p> <p>1 Cochrane Avenue Pennsboro, WV 26415</p> <p>SCALE: FT SHEET: 1 of 1</p> <p>SERIES: 07-09 / 07-10 / 07-20 HORIZONTAL SLIDER</p> <p>TITLE: 2X BUCK INSTALLATION</p>	<p>SIZE: DRAWING NO.: REV: _____</p> <p>B IN0137 7</p> <p>DRAWN BY: DATE: _____</p> <p>T.D.D. 06/10/08</p> <p>CHECKED BY: DATE: _____</p> <p>APPRVD BY: DATE: _____</p>
--	--	---	--	---

FLORIDA DEPARTMENT OF
Business & Professional Regulation



BCIS Home | Log In | User Registration | Hot Topics | Submit Surcharge | Stats & Facts | Publicat

Product Approval Menu > Product or Application Search > Application List > **Application Detail**

FL # **FL161-R4**
 Application Type **Revision**
 Code Version **2010**
 Application Status **Approved**
 Comments
 Archived

Product Manufacturer
 Address/Phone/Email

Custom Window Systems Ir
 1900 SW 44th Avenue
 Ocala, FL 34474
 (352) 368-6922 Ext 207
 mlafevre@cws.cc



Authorized Signature

Michael LaFevre
 mlafevre@cws.cc

Technical Representative
 Address/Phone/Email

Brian Tenace
 1900 SW 44th Ave.
 Ocala, FL 34474
 (352) 368-6922 Ext 291
 btenace@cws.cc

Quality Assurance Representative
 Address/Phone/Email

Jeff Thompson
 1900 SW 44th Ave.
 Ocala, FL 34474
 (352) 368-6922 Ext 221
 jthompson@cws.cc

Category
 Subcategory

Exterior Doors
 Swinging Exterior Door Ass

OFFICE OF THE
 SECRETARY

License Authority - Regulate Only

Compliance Method

Evaluation Report from a Florida Professional Engineer
 Evaluation Report - Har

Florida Engineer or Architect Name who developed the Evaluation Report
 Lucas A. Turner

Florida License
 PE-58201

Quality Assurance Entity
 Keystone Certifications, Inc

03/01/2014

Quality Assurance Contract Expiration Date
 Validated By

Steven M. Urlich, PE

Validation Checklist - Hi

Certificate of Independence

[FL161_R4_COI_EvalRep_CV](#)

Referenced Standard and Year (of Standard)

Standard

AAMA/101/I.S.2-97

ASTM E 1300-04

Equivalence of Product Standards Certified By

Sections from the Code

Product Approval Method

Method 1 Option D

Date Submitted

12/01/2011

Date Validated

12/16/2011

Date Pending FBC Approval

12/21/2011

Date Approved

01/31/2012

Summary of Products

FL #	Model, Number or Name	Description
161.1	Guardian Hinged Door	Guardian Hinged Fixed).
Limits of Use Approved for use in HVHZ: No Approved for use outside HVHZ: Yes Impact Resistant: No		Installation Ins FL161 R4 II CV Verified By: Lucas A. Turner Created by Index

Design Pressure: +40/-40 Other: Not for use in HVHZ. Primarily used with Screen Rooms.		Evaluation Repr FL161_R4_AE_E Created by Indef
161.2	Guardian Hinged Door	Guardian Hinged
Limits of Use Approved for use in HVHZ: No Approved for use outside HVHZ: Yes Impact Resistant: No Design Pressure: +40/-40 Other: Not for use in HVHZ. Primarily used with Screen Rooms.		Installation Ins FL161_R4_II_CV Verified By: Luca Created by Indef Evaluation Repr FL161_R4_AE_E (glass).pdf Created by Indef

[Back](#)

[Next](#)

Contact Us :: [1940 North Monroe Street, Tallahassee, FL 32399](#) [Photo](#)

The State of Florida is an AA/EEO employer. [Copyright 2007-2010, State of Florida.](#) :: [Privacy Statement](#)

Under Florida law, email addresses are public records. If you do not want your e-mail address released electronically to this entity, instead, contact the office by phone or by traditional mail. If you have any questions regarding this policy, please contact the office. [Section 455.275\(1\), Florida Statutes, effective October 1, 2012, licenses licensed under Chapter 455, F.S., they have one. The emails provided may be used for official communication with the licensee. However, to supply a personal address, please provide the Department with an email address which can be made available at Chapter 455, F.S., please click \[here\]\(#\).](#)

Product Approval Accepts:



PRIME DOOR ELEVATION (NON-IMPACT)

ALUMI

1. THE EDITIO
2. GLA
3. CON
4. ANC ANCHC
5. DES -NE -PO
6. NOT
7. ALL
8. REF
9. 1X C BUCK. ALUMI LOADS

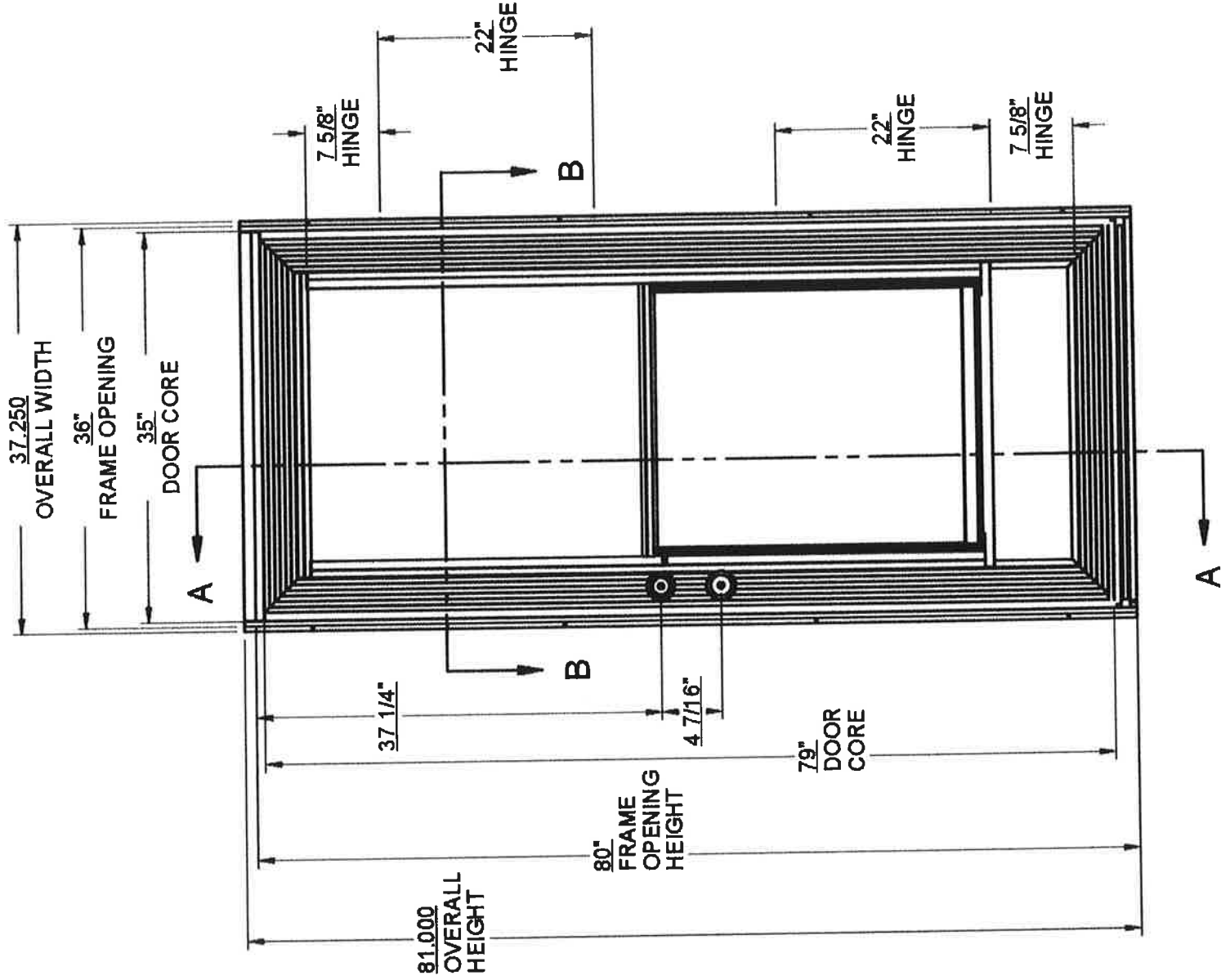

TABLE OF CONTENTS

GENERAL NOTES.....	1
ANCHOR SCHEDULE & NOTES.....	2
GLAZING DETAIL.....	3
SECTION VIEWS.....	4
EXTRUSIONS & B.O.M.....	5
INSTALLATION DETAIL.....	6-7

PROPRIETARY.
 THE INFORMATION CONTAINED IN THIS DR.
 WINDOW SYSTEMS, INC. ANY REPRODUCT
 WRITTEN PERMISSION OF CUSTOMER WINDC
 4/2/2013 4:33 P

INSTALL ONE #
EACH HINGE IN
(SEE SHTS 6, 7)

NOTES:

1. INSTALL ONE ANCHOR AT EACH LOCATION. SILL ANCHOR SPACING SAME AS HEAD.
2. SHIM AS REQ'D AT INSTALLATION ANCHOR USING LOAD BEARING SHIMS. MAX. ALLOWABLE SHIM STACK TO BE 1, GREATER THAN 1/16" IS PRESENT.
3. LOAD BEARING SHIMS SHALL BE CONSTRUCTED OF HIGH DENSITY PLASTIC OR BETTER. WOOD SHIMS ARE NOT /
4. 3/16" DIA. ELCO ULTRACON MASONRY ANCHORS MUST BE OF SUFFICIENT LENGTH TO ACHIEVE A MIN. EMBEDMEI THRU FRAME OR THRU 1 BY WOOD BUCK INTO MASONRY. A MINIMUM EDGE DISTANCE OF 2 1/2", IN ANY DIRECTION
5. #10 WOOD SCREW ANCHORS THRU FLANGE MUST BE OF SUFFICIENT LENGTH TO ACHIEVE A MIN. EMBEDMENT C BUCK. A MINIMUM EDGE DISTANCE OF 5/16", IN ANY DIRECTION, SHALL BE ACHIEVED.
6. #8 OR STRONGER WOOD SCREW ANCHORS THRU HINGE OR LOCK/DEADBOLT STRIKES MUST BE OF SUFFICIENT EMBEDMENT OF 1 3/8" INTO 2 BY WOOD BUCK. A MIN. EDGE DISTANCE OF 1/2" SHALL BE ACHIEVED IN EITHER DIRE
7. #10 SMS ANCHORS MUST BE OF SUFFICIENT LENGTH TO ACHIEVE A MIN. PENETRATION OF THREE THREADS BEY IN TUBE FRAME INSTALLATION.
8. GLAZED WINDOW FRAME ATTACHED TO DOOR LEAF OPENING IN ACCORDANCE WITH STRUCTURAL PERFORMAN NCTL-210-3251.1. ALL GLAZING IS TEMPERED GLASS ONLY.
9. SEAL CORNERS WITH SMALL JOINT SEAM SEALANT.
10. ALL INSTALLATION ANCHORS MUST BE MADE OF OR COATED WITH A CORROSION RESISTANT MATERIAL. DISSII MATERIALS IN CONTACT WITH PRESSURE TREATED WOOD MUST BE PROTECTED TO PREVENT REACTIONS.
11. INSTALLATION ANCHORS SHALL BE IN ACCORDANCE WITH ANCHOR MANUFACTURER'S INSTALLATION INSTRUC NOT BE USED IN SUBSTRATES WITH STRENGTHS LESS THAN THE MINIMUM STRENGTH SPECIFIED BELOW.
12. INSTALLATION ANCHOR CAPACITIES FOR PRODUCTS HEREIN ARE BASED ON SUBSTRATE MATERIAL WITH THE
 - A. WOOD - MINIMUM SPECIFIC GRAVITY OF G=0.55 (SOUTHERN PINE OR GREATER)
 - B. CONCRETE - MINIMUM COMPRESSIVE STRENGTH OF 3,200 PSI.
 - C. MASONRY - STRENGTH CONFORMANCE TO ASTM C-90, GRADE N, TYPE 1 (OR GREATER).
 - D. ALUMINUM - 6063-T5 (OR GREATER)
13. SEALING AND FLASHING STRATEGIES FOR OVERALL WATER RESISTANCE OF INSTALLATION SHALL BE DONE B) WITH THE CURRENT VERSION OF THE FOLLOWING REFERENCE DOCUMENTS:
FMA/AAMA 100 (FIN WINDOWS), FMA/AAMA 200 (FLANGE WINDOWS), FMA/AAMA 250 (BOX WINDOWS), PROPRIETARY /
FMA/AAMA/WDMA 300 (EXTERIOR DOORS). THE INFORMATION CONTAINED IN THIS DR,
WINDOW SYSTEMS, INC. ANY REPRODUCTI
WRITTEN PERMISSION OF CUSTOM WINDO

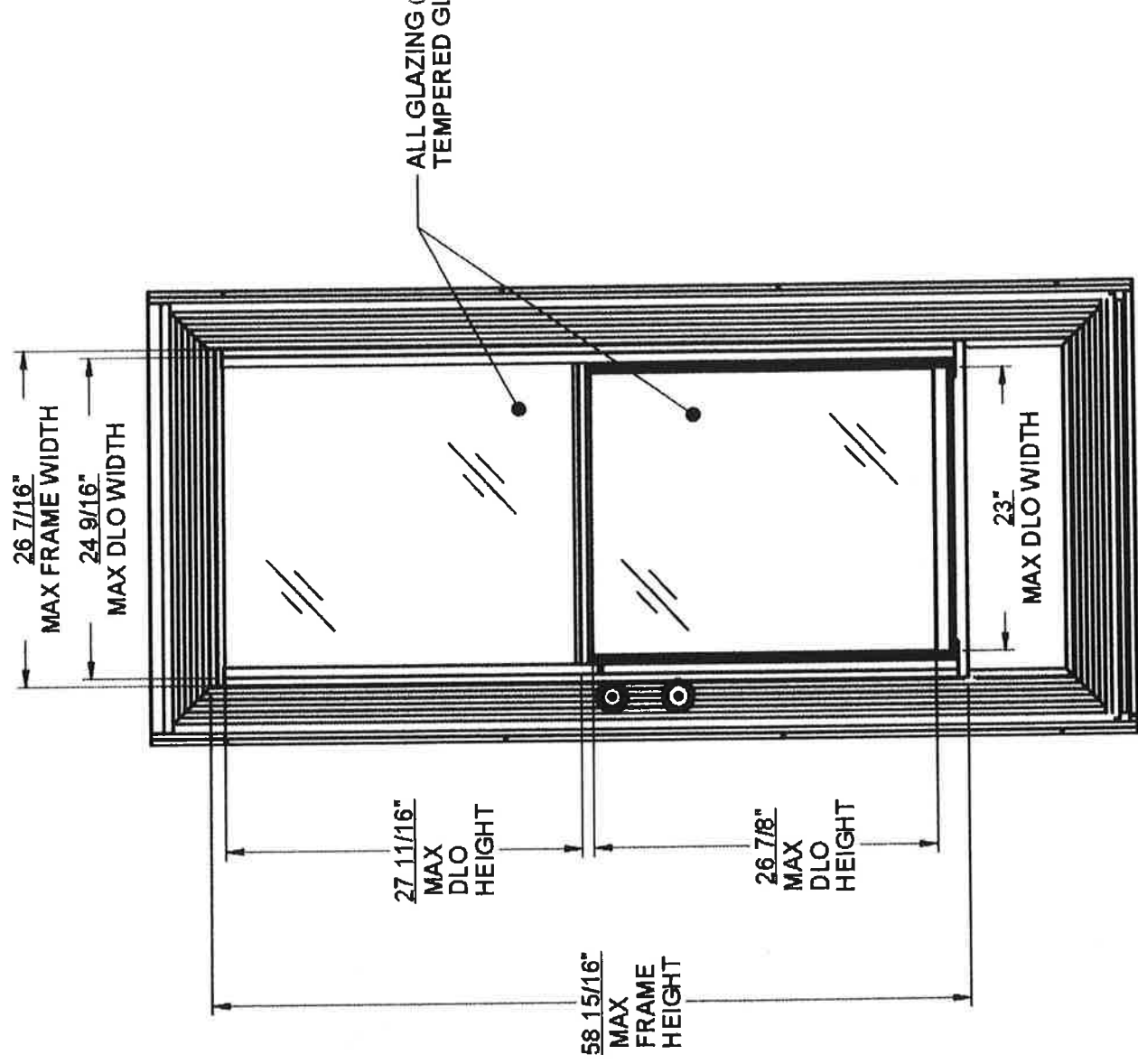

FULL VIEW
SINGLE HUNG

PROPRIETARY:
THE INFORMATION CONTAINED IN THIS DRAWING IS THE PROPERTY OF WINDOW SYSTEMS, INC. ANY REPRODUCTION OR TRANSMISSION WITHOUT WRITTEN PERMISSION OF WINDOW SYSTEMS, INC. IS PROHIBITED.
4/2/2013 4:33 PM

Building Details - 6649 The Landings Dr - Building #1



Courtesy Rick Singh, Orange County Property Appraiser

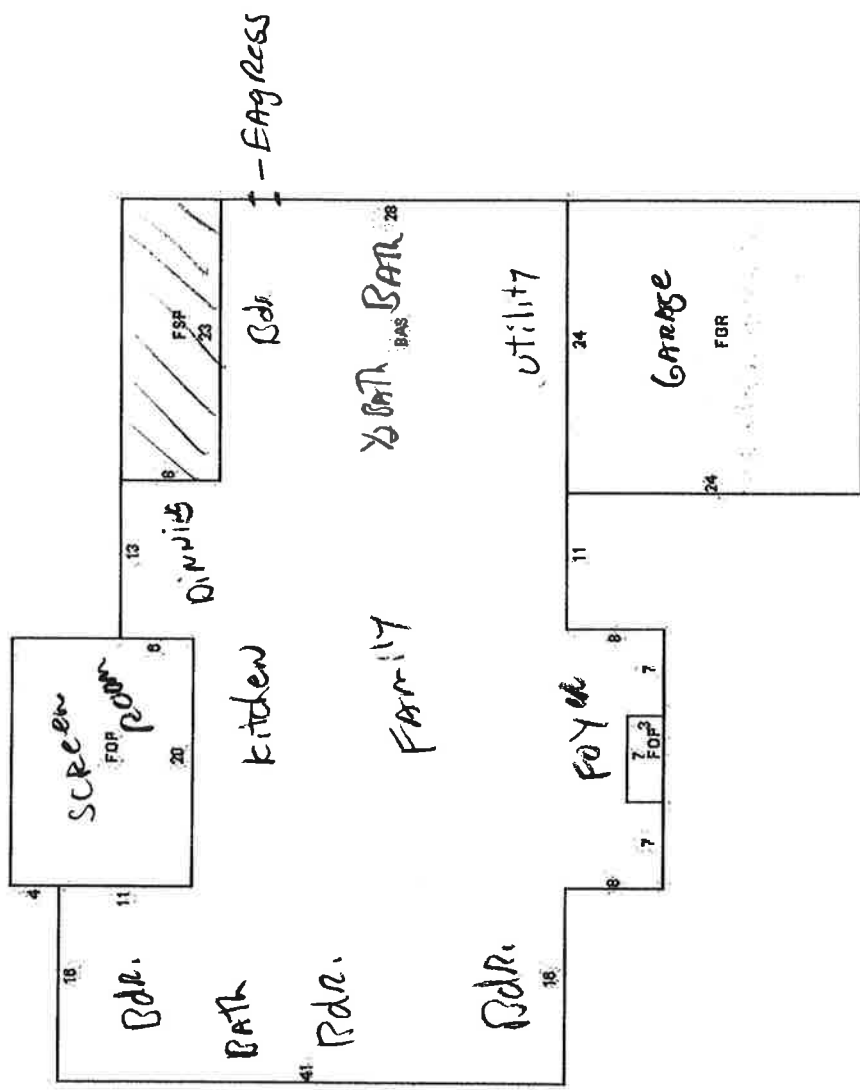

Sub Area	Sqft	Value
BAS - Base Area	2515	\$197,402
FGR - Fin Garage	576	\$22,605
FOP - F/Opn Prch	321	\$6,279
FSP - F/Scr Prch	184	\$5,023

Model Code: 01 - Single Fam Residence
Type Code: 0103 - Single Fam Class III
Building Value: \$138,785
Estimated New Cost: \$231,309
Actual Year Built: 1983
Beds: 4
Baths: 2.5
Floors: 1
Gross Area: 3596 sqft

ASD ALUMINUM SCREEN DESIGN

Aluminum & Construction Engineering

4/13/14



***Plan Types:**

CITY OF BELLE ISLE
 THE PLANS AND SPECIFICATIONS
 HAVE BEEN REVIEWED. FULL
 COMPLIANCE WITH CODES AND
 REGULATIONS ARE REQUIRED BY
 THE PERMIT HOLDER

- Screen Room
- Pool Screen/Cage
- Car Port
- Patio Cover

APPROVED 

Other:

Enclose Existing Louver Category III Sun Room

Reference:	<input checked="" type="checkbox"/> New	<input type="checkbox"/> Revision	3/19/14
Project Address:	6649 The Landings Dr.		
City:	Belle Isle		

- *Contractor Name: Eden Construction Corp.
- *Address: 10151 University Blvd. Ste. 137
- *City: Orlando
- *Zip Code: 32817
- *Phone/Fax: 407-671-9697 407 671-2223
- *Email: Pick • edenconstruction@earthlink.net
- *Choose One: Prepay Fed Ex* Prepay Mail* Prepay Pick up*
*(For delivery options go to www.aluminumscreenesign.com and provide delivery and payment)
- * Payment: Check Upon Pick Up Credit Card Online Only*
*(For Credit Card option go to www.aluminumscreenesign.com to pay by credit card)

Engineering prepared by:



DBE&C
 DESIGN-BUILD ENGINEERING & CONSTRUCTION
 Engineer: Michael Thompson, MSc, P.E. (P.E. # 47509)
 5200 Vineland Road - Suite 250 Orlando, FL 32811
 Off 407-529-3300 Cell 407-721-2292
 Project Manager: Paul Thomas 386-479-9504 Fax 888-923-8181
 Email: aluminumscreenesign@yahoo.com

Website: www.aluminumscreenesign.com (C.A. #9103)

ASD ALUMINUM SCREEN DESIGN

Aluminum & Construction Engineering

* Ultimate Wind Speed (mph): 39 Exposed Category: d Risk Category: 1
<http://www.atcouncil.org/windspeed>

Screen Room:

- Insulated Pan Roof
- Fascia Wall: Block Conventional
- Uprights Top Plate Kick Plate Fill In

Pool Screen/Cage:

- Dome Gable Mansard
- Gutter Wall: Block Conventional
- Beams Uprights Purlin
- Kick Plate Fill In

Car Port:

- Insulated Pan
- Fascia Wall: Block Conventional
- Beams Post

Patio Cover:

- Insulated Pan
- Fascia Wall: Block Conventional
- Beams Post

Concrete:

- Existing New: 4" Slab Pier Ribbon Footer Pavers

Other: 4x4 center post, 2x4 sub other part

3/19/14



Reviewed for Code Compliance
 Universal Engineering
 Sciences

6649 the Landings on
Rehe Isle
1/4" = 1'

Eden Construction Corporation
10151 University Blvd, Ste. 137
Orlando, FL 32817
(407) 671-9697

copy

