



City of Belle Isle

Universal Engineering Sciences 3532 Maggie Blvd., Orlando, FL 32811
Tel 407-581-8161 * Fax 407-581-0313 * www.universalengineering.com

REVISION APPLICATION

WARNING TO OWNER: YOUR FAILURE TO RECORD A NOTICE OF COMMENCEMENT MAY RESULT IN YOUR PAYING TWICE FOR IMPROVEMENTS TO YOUR PROPERTY. A NOTICE OF COMMENCEMENT MUST BE RECORDED AND POSTED ON THE JOB SITE BEFORE THE FIRST INSPECTION. IF YOU INTEND TO OBTAIN FINANCING, CONSULT WITH YOUR LENDER OR AN ATTORNEY BEFORE RECORDING YOUR NOTICE OF COMMENCEMENT.

Date: 4/15/19

Permit Number: 2019-01-023
Original Permit Number Issued

Contact Name Mark Bines Phone: 407-832-0055
Project Address 3215 Cullen Lake Shore Drive Belle Isle, FL 32809 X 32812
Nature of Change Truss Repairs
Change in Job Cost _____

Do revisions affect: Site Architectural Structural Mechanical Electrical Plumbing

Itemize below for each drawing specific proposed changes. Attach additional sheets, if necessary.

Examiner Approval: *Paul L...*

Date _____ Finalized/Inspected by: _____

Fee: \$ 32.-
Cash/Check #: 13007 Date Rec'd: 4-15-19 Rec'd By: *[Signature]*
AMEX

26 base + 2 pages x 3 (6) = 32.-

To schedule an inspection please email your request to: BDscheduling@UniversalEngineering.com

REVISION

UNIVERSAL ENGINEERING SCIENCES
PLAN REVIEW

These plans have been reviewed for conformance to the Florida Building Code. Our review of these plans is pursuant to Section 106 of the Florida Building Code and does not include any items outside of the stated codes nor shall it relieve the permit holder from compliance with provisions of these or any other state or local regulation.

Name: Randy [Signature]
 Lic. No. PX 4191 Date 4/15/19

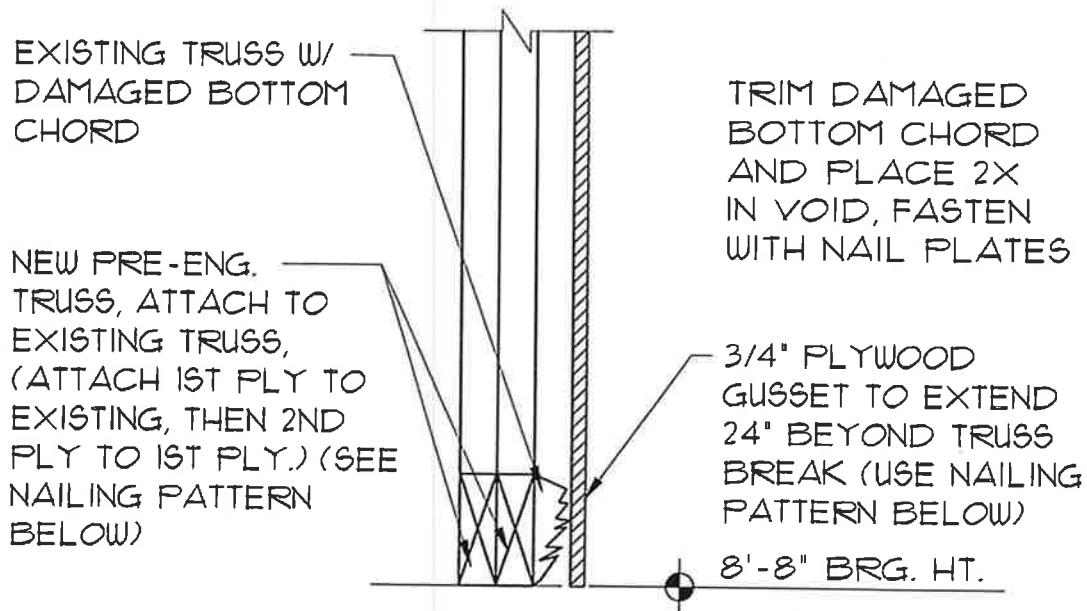

10d NAILS-
 TOP CHORD 2-ROWS STAGGERED @ 9" O.C.
 BOTTOM CHORD 2-ROWS STAGGERED @ 9" O.C.
 WEBS 1-ROW @ 9" O.C.

DAMAGED TRUSS REPAIR

TITLE: BINES RESIDENCE
DATE: 04/11/19
SCALE: 1/2" = 1'-0"

ARCHITECTS



1441 N. RONALD REAGAN BLVD.
 LONGWOOD, FL 32750
 PH: 407-774-6078
 FAX: 407-774-4078
 www.abdesigngroup.com
 AA #: 0003325

ENGINEER:
 STATE OF FLORIDA

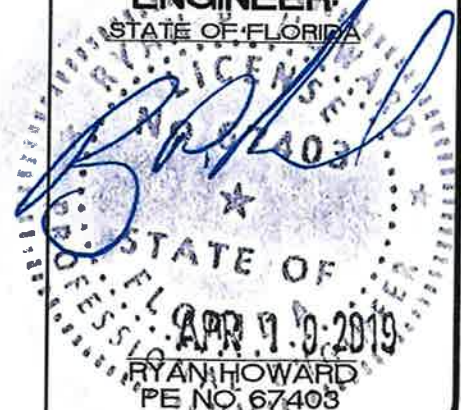

RECEIVED
 APR 15 2019

BY: _____

142198



These plans have been reviewed for conformance to the Florida Building Code. Our review of these plans is pursuant to Section 106 of the Florida Building Code and does not include any items outside of the stated codes nor shall it relieve the permit holder from compliance with provisions of these or any other state or local regulation.

Name

Rand Lail

Lic. No.

PE 1191

Date

4/15/19

REVISION

NEW 3-PLY 2X12 BEAM

BEAM TO CMU (2) MTSM16 EA. END

A

CUT EXISTING TRUSS BACK 4 1/2" TO FIT IN HANGER

EXISTING TRUSS

10'-8" BRG. HT.

3/4" PLYWOOD GUSSET NAILED TO EA. SIDE OF EXISTING TRUSS, PLYWOOD TO EXTEND 4'-0" FROM END OF TRUSS (USE NAILING PATTERN BELOW)

4'-0"

8'-8" BRG. HT.

A

TRUSS TO BEAM LUS26-2

NEW CMU BLOCK

ENTRY BEAM DETAIL

PLYWOOD GUSSET NAILING PATTERN:

10d NAILS-

-TOP CHORD 2-ROWS STAGGERED @ 9" O.C.

-BOTTOM CHORD 2-ROWS STAGGERED @ 9" O.C.

-WEBS 1-ROW @ 9" O.C.

3/4" PLYWOOD GUSSET NAILED TO EA. SIDE OF EXISTING TRUSS, PLYWOOD TO EXTEND 4'-0" FROM END OF TRUSS (USE NAILING PATTERN ABV.)

EXISTING TRUSS

NEW 3-PLY 2X12 BEAM

8'-8" BRG. HT.

EXISTING TRUSS TO BEAM LUS26-2

A-A BEAM DETAIL

TITLE: BINES RESIDENCE

DATE: 04/11/19

SCALE: 1/2" = 1'-0"

ARCHITECTS



1441 N. RONALD REAGAN BLVD.
LONGWOOD, FL 32750
PH: 407-774-6078
FAX: 407-774-4078
www.abdesigngroup.com
AA #: 0003325

ENGINEER:

STATE OF FLORIDA

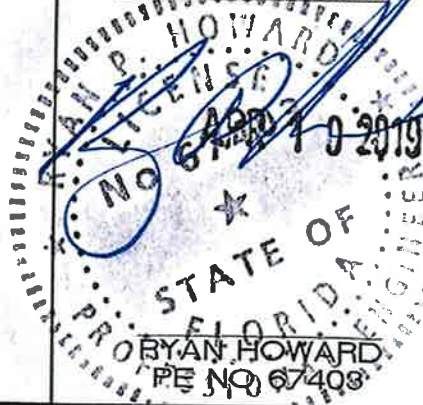

BY:

172198