



City of Belle Isle Job Site Card Window/Door PERMIT 2019-07-042

PERMIT MUST BE POSTED ON SITE - A permit expires in 6 months if approved inspections are not recorded /schedule within that time frame. **You are responsible for scheduling and keeping track of all inspections.**

Permit Number: 2019- 07-042

Issue Date: 07/25/2019

Site Address: 5858 Cove Dr 32812

Parcel #: 20-23-30-1660-00-110

Class: Residential **Subdivision:**

Description of Work: 3 **Door** (s) / Size for Size

Issued To: RENEWAL BY ANDERSEN OF CENTRAL FLORIDA

Business Phone: 407 535-6349

Name: MELICK, JARED LEE

Contractor License #: CGC1524135

Payment Date & Method: 8 / 2 / 2019 Picked up or sent by _____ Emailed
 Visa Master Card Amex Discover Check / Money Order # 9468

Schedule Inspections via Email at: BDscheduling@universalengineering.com

SCHEDULE INSPECTIONS BY 3:00 PM CUT OFF TIME

Inspection Results Will Be Sent Out the Following Business Day

"WARNING TO OWNER: YOUR FAILURE TO RECORD A NOTICE OF COMMENCEMENT MAY RESULT IN YOUR PAYING TWICE FOR IMPROVEMENTS TO YOUR PROPERTY. IF YOU INTEND TO OBTAIN FINANCING, CONSULT WITH YOUR LENDER OR AN ATTORNEY BEFORE RECORDING YOUR NOTICE OF COMMENCEMENT."

BUILDING	INSPECTOR	DATE	COMMENTS
900 In Progress			
910 Final			

Inspection requests are to be emailed to BDscheduling@UniversalEngineering.com; a confirmation email will be sent back to you upon scheduling. Next-Day Inspection requests must be made by 3pm. Please include the following in your request: Permit #, project address, type of inspection, date of the requested inspection, a contact name & a contact phone number. AM or PM may be requested but cannot be guaranteed. Inspection results will be sent out the following business day.

A permit expires in 6 months if approved inspections are not recorded /scheduled within that time frame. You are responsible for scheduling and keeping track of all your inspections –

Universal Engineering Sciences - 3532 Maggie Blvd., Orlando, FL 32811
Tel 407-581-8161 * Fax 407-581-0313 * www.universalengineering.com



City of Belle Isle
 Universal Engineering Sciences 3532 Maggie Blvd., Orlando, FL 32811
 Tel 407-581-8161 * Fax 407-581-0313 * www.universaleengineering.com

RECEIVED
 JUL 24 2019

**APPLICATION FOR SIZE-FOR-SIZE
 WINDOW / DOOR PERMIT**

WARNING TO OWNER: YOUR FAILURE TO RECORD A NOTICE OF COMMENCEMENT MAY RESULT IN YOUR PAYING TWICE FOR IMPROVEMENTS TO YOUR PROPERTY. A NOTICE OF COMMENCEMENT MUST BE RECORDED AND POSTED ON THE JOB SITE BEFORE THE FIRST INSPECTION. IF YOU INTEND TO OBTAIN FINANCING, CONSULT WITH YOUR LENDER OR AN ATTORNEY BEFORE RECORDING YOUR NOTICE OF COMMENCEMENT.

DATE OF APPLICATION: 7/15/19

PERMIT NUMBER 2019-07042

PLEASE PRINT. The undersigned hereby applies for a permit to make installations as indicated below:

Project Address 5858 Cove Dr. Belle Isle Belle Isle, FL 32809 ✓ 32812
 Property Owner Moss, Willie C. and Diana Phone 407-859-3783
 Property Owner's Mailing Address 5858 Cove Dr. City Belle Isle
 State FL Zip Code 32812 Parcel Id Number: 20-23-30-1660-00-110

REQUIRED! To obtain this information, please visit <http://www.ocpafl.org/Searches/ParcelSearch.aspx>

Type of Building: Residential Commercial Other

• **REQUIRED!** Florida Product Approval Form – NOTE: installation instructions must be posted on-site before your first inspection!!

Please indicate the nature of work by completing the information below:

Number of Size-for-Size Windows: _____ Number of Size-for-Size Doors: 3 Job Valuation: 13,839

I hereby certify that the above is true and correct to the best of my knowledge and make Application for Permit as outlined above, and if same is granted I agree to conform to all Florida Building Code Regulations and City Ordinances regulating same and in accordance with plans submitted. The issuance of this permit does not grant permission to violate any applicable Town and/or State of Florida codes and/or ordinances. By signing below, I recognize Republic Services is by legal contract the sole authorized provider of garbage, recycling, yard waste, and commercial garbage and construction debris collection and disposal services with the city limits of the City. Contractors, homeowners and commercial businesses may contact Republic Services at 407-293-8000 to setup accounts for Commercial, Construction Roll Off, or other services needed. Rates are fixed by contract and are available at City Hall or from Republic Services. The City enforces the contract through its code enforcement office. Failure to comply will result in a stop work order.

BY SIGNING THIS APPLICATION, YOU ARE CERTIFYING THAT YOU ARE ACTING AS THE OWNER'S AGENT FOR THIS PERMIT:

LICENSE HOLDER SIGNATURE [Signature] LICENSE # CGC1527613
 LICENSE HOLDER NAME Jared Mellick COMPANY NAME Renewal by Andersen of Florida
 Street Address 994 W. Kennedy Blvd
 City Orlando State FL Zip Code 32810 Phone Number 407-803-4723
 Email Address permitting@rbafla.com

Zoning Fee	\$	<u>0</u>
Permit Fee	\$	<u>77.-</u>
Review Fee	\$	<u>38.50</u>
1% BCAIB Fee	\$	<u>9. min</u>
1.5% DCA Fee	\$	<u>2 min</u>
Total Permit Fee	\$	<u>119.50</u>

Building Official: [Signature] Date 7-26-19
 Verified Contractor's Licenses & Insurance are on file [Signature] Date 7-26-19

PAID
 MC 9968
 8-2-19

State of FLORIDA, County of ORANGE,
Per §668.50, F.S., which defines and permits electronic signatures,
I certify that this is a true copy of the document as reflected in the
Official Records
PHIL DIAMOND, COUNTY COMPTROLLER



DOC # 20190405101
07/02/2019 09:10 AM Page 1 of 1
Rec Fee: \$10.00
Deed Doc Tax: \$0.00
Mortgage Doc Tax: \$0.00
Intangible Tax: \$0.00
Phil Diamond, Comptroller
Orange County, FL
Ret To: SIMPLIFILE LC

By B. Galagarza at 10:45 am, Jul 11, 2019

Deputy Comptroller

Date

Permit Number: _____
Folio/Parcel ID #: 20-23-30-1660-00-11
Prepared by: _____
5655 Carder Rd., Orlando, FL 32810
Return to: _____

NOTICE OF COMMENCEMENT

State of Florida, County of Orange

The undersigned hereby gives notice that improvement will be made to certain real property, and in accordance with Chapter 713, Florida Statutes, the following information is provided in this Notice of Commencement

1. **Description of property** (legal description of the property, and street address if available)
CONWAY GARDENS R/18 LOT 11 & LAND 86.4 CONTOUR LINE
2. **General description of improvement**
Replacing Windows and/or Doors Size for Size
3. **Owner information or Lessee information if the Lessee contracted for the improvement**
Name Moss Willie C Moss Diana
Address 5858 Cove Dr Belle Isle, FL 32812-2819
Interest in Property owner
Name and address of fee simple titleholder (if different from Owner listed above)
Name _____
Address _____
4. **Contractor**
Name Jared Mellick/Renewal by Andersen of Florida Telephone Number 407-803-4723
Address 997 W Kennedy Blvd. Orlando, FL 32810
5. **Surety** (if applicable, a copy of the payment bond is attached)
Name _____ Telephone Number _____
Address _____ Amount of Bond \$ _____
6. **Lender**
Name _____ Telephone Number _____
Address _____
7. **Persons within the State of Florida designated by Owner upon whom notices or other documents may be served as provided by §713.13(1)(a)7, Florida Statutes.**
Name _____ Telephone Number _____
Address _____
8. **In addition to himself or herself, Owner designates the following to receive a copy of the Lienor's Notice as provided in §713.13(1)(b), Florida Statutes.**
Name _____ Telephone Number _____
Address _____
9. **Expiration date of notice of commencement** (the expiration date will be 1 year from the date of recording unless a different date is specified) _____

WARNING TO OWNER: ANY PAYMENTS MADE BY THE OWNER AFTER THE EXPIRATION OF THE NOTICE OF COMMENCEMENT ARE CONSIDERED IMPROPER PAYMENTS UNDER CHAPTER 713, PART I, SECTION 713.13, FLORIDA STATUTES, AND CAN RESULT IN YOUR PAYING TWICE FOR IMPROVEMENTS TO YOUR PROPERTY. A NOTICE OF COMMENCEMENT MUST BE RECORDED AND POSTED ON THE JOB SITE BEFORE THE FIRST INSPECTION. IF YOU INTEND TO OBTAIN FINANCING, CONSULT WITH YOUR LENDER OR AN ATTORNEY BEFORE COMMENCING WORK OR RECORDING YOUR NOTICE OF COMMENCEMENT.

[Signature] _____ Signature of Owner or Lessee, or Owner's or Lessee's Authorized Officer/Director/Partner/Manager
[Signature] _____ Signatory's Title/Office

The foregoing instrument was acknowledged before me this 11 day of July, 2019 by Diana Moss
as owner for self _____
Type of authority, e.g., officer, trustee, attorney in fact Name of party on behalf of whom instrument was executed

Signature of Notary Public - State of Florida
Dustin Lindsey
Print, type, or stamp commissioned name of Notary Public

Personally Known OR Produced ID
Type of ID Produced M200-170-46-543-0



Dustin Lindsey
NOTARY PUBLIC
STATE OF FLORIDA
Comm# GG225713
Expires 6/6/2022



City of Belle Isle
 Universal Engineering Sciences 3532 Maggie Blvd., Orlando, FL 32811
 Tel 407-581-8161 * Fax 407-581-0313 * www.universalengineering.com

RECEIVED
 JUL 25 2019
 BY: _____

Product Approval Form

DATE: 07/15/2019

PERMIT # 2019-07-042

PROJECT ADDRESS 5858 Cove Dr., Belle Isle, FL 32809 32812

As required by Florida Statue 553.842 and Florida Administrative Code 9B-72m, please provide the information and approval numbers of the building components listed below if they will be utilized on the building or structure. FL Approved products are listed online at www.floridabuilding.org or can be obtained from the local product supplier. The following information must be turned in with permit application and available onsite for inspections:

1. This Product Approval Cover Sheet
2. Internet screen from FloridaBuilding.org showing PA#, approval and code edition stamped
3. Manufacturer's installation details from FloridaBuilding.org and requirements for each product stamped

Product Type	Manufacturer	Model/Series	FL Product Approval #	Product Type	Manufacturer	Model/Series	FL Product Approval #
EXTERIOR DOORS				WALL PANELS			
Swinging	Andersen Corp.	A Series Frenchwood	FL13074.9	Sliding			
Sliding				Soffits			
Sectional/Rollup				Storefront			
Other				Glass Block			
				Other			
WINDOWS				ROOFING PRODUCTS			
Single/Dbf Hung				Asphalt Shingles			
Horizontal Slider				Non Struct Metal			
Casement				Roofing Tiles			
Fixed				Single Ply Roof			
Mullion				Other			
Skylights							
Other							
STRUCTURAL COMPONENTS				OTHER			
Wood Connectors							
Wood Anchors							
Truss Plates							
Insulation Forms							
Lintels							
Other							

It is the applicant's responsibility to verify that specific products have been installed in accordance with their limitations and with the minimum required design pressures for the structure. Specific compliance will be verified during field inspections.

Applicant Signature Ashley Boew

Date 7/25/19

Product Approval
 USER: Public User

[Product Approval Menu](#) > [Product or Application Search](#) > [Application List](#) > **Application Detail**

 OFFICE OF THE
 SECRETARY

FL #	FL13074-R8
Application Type	Revision
Code Version	2017
Application Status	Approved
	*Approved by DBPR. Approvals by DBPR shall be reviewed and ratified by the POC and/or the Commission if necessary.
Comments	
Archived	
Product Manufacturer	Andersen Corporation
Address/Phone/Email	100 Fourth Avenue North Bayport, MN 55003 (651) 264-5308 alan.barstad@AndersenCorp.com
Authorized Signature	Alan Barstad alan.barstad@AndersenCorp.com
Technical Representative	
Address/Phone/Email	
Quality Assurance Representative	
Address/Phone/Email	
Category	Exterior Doors
Subcategory	Swinging Exterior Door Assemblies
Compliance Method	Certification Mark or Listing
Certification Agency	Window and Door Manufacturers Association
Validated By	Window and Door Manufacturers Association
Referenced Standard and Year (of Standard)	Standard 101/IS2/A440
	Year 2011
Equivalence of Product Standards Certified By	Approved Testing Lab FL13074 R8 Equiv AAMA 101-IS2-A440 Equivalence.pdf
Product Approval Method	Method 1 Option A
Date Submitted	12/06/2017
Date Validated	12/08/2017
Date Pending FBC Approval	
Date Approved	12/13/2017

Summary of Products

FL #	Model, Number or Name	Description
13074.1	A-Series Frenchwood Hinged Patio Door - Inswing/FWHID33100A IG	A-Series Frenchwood Hinged Patio Door - Inswing
Limits of Use Approved for use in HVHZ: No Approved for use outside HVHZ: Yes Impact Resistant: No Design Pressure: +45/-55 Other: Glass tested was 19.5 mm Insulated Glass consisting of two 3 mm tempered lites separated by a desiccant filled metal spacer. Other configurations comply with ASTM E1300. Hardware tested was a 4 point lock with a bolt.		Certification Agency Certificate FL13074_R8_C_CAC_FWHID33100A_IG.pdf Quality Assurance Contract Expiration Date 07/17/2026 Installation Instructions FL13074_R8_II_FL13074_R6_II_A-Series_Inswing_Door.pdf Verified By: Window and Door Manufacturers Association Created by Independent Third Party: Evaluation Reports Created by Independent Third Party:
13074.2	A-Series Frenchwood Hinged Patio Door - Inswing/FWHID33100S IG	A-Series Frenchwood Hinged Non - Operable Patio Door-Inswing
Limits of Use Approved for use in HVHZ: No Approved for use outside HVHZ: Yes Impact Resistant: No Design Pressure: +45/-55 Other: Glass tested was 19.5 mm Insulated Glass consisting of two 3 mm tempered lites separated by a desiccant filled metal spacer. Other configurations comply with ASTM E1300. No Hardware was utilized.		Certification Agency Certificate FL13074_R8_C_CAC_FWHID33100S_IG.pdf Quality Assurance Contract Expiration Date 08/19/2026 Installation Instructions FL13074_R8_II_FL13074_R6_II_A-Series_Inswing_Door.pdf Verified By: Window and Door Manufacturers Association Created by Independent Third Party: Evaluation Reports Created by Independent Third Party:
13074.3	A-Series Frenchwood Hinged Patio Door - Inswing/FWHID3380A IG	A Series Hinged Patio Door - Inswing - Single
Limits of Use Approved for use in HVHZ: No Approved for use outside HVHZ: Yes Impact Resistant: No Design Pressure: +45/-55 Other: Glass tested was 19.5 mm Insulated Glass consisting of two 3 mm tempered lites separated by a desiccant filled metal spacer. Other configurations comply with ASTM E1300. Hardware tested was a 3 point lock with a bolt.		Certification Agency Certificate FL13074_R8_C_CAC_FWHID3380A_IG.pdf Quality Assurance Contract Expiration Date 06/22/2026 Installation Instructions FL13074_R8_II_A-Series_Inswing_Door.pdf Verified By: Window and Door Manufacturers Association Created by Independent Third Party: Evaluation Reports Created by Independent Third Party:
13074.4	A-Series Frenchwood Hinged Patio Door - Inswing/FWHID3380S IG	A-Series Frenchwood Hinged Non-Operable Patio Door - Inswing/FWHID3380S IG (Screw-in-panel)
Limits of Use Approved for use in HVHZ: No Approved for use outside HVHZ: Yes Impact Resistant: No Design Pressure: +45/-55 Other: Glass tested was 19.5 mm Insulated Glass consisting of two 3 mm tempered lites separated by a desiccant filled metal spacer. Other configurations comply with ASTM E1300. No Hardware was utilized.		Certification Agency Certificate FL13074_R8_C_CAC_FWHID3380S_IG.pdf Quality Assurance Contract Expiration Date 03/17/2026 Installation Instructions FL13074_R8_II_A-Series_Inswing_Door.pdf Verified By: Window and Door Manufacturers Association Created by Independent Third Party: Evaluation Reports Created by Independent Third Party:
13074.5	A-Series Frenchwood Hinged Patio Door - Inswing/FWHID6080AS IG	A Series Hinged Patio Door - Inswing
Limits of Use Approved for use in HVHZ: No Approved for use outside HVHZ: Yes Impact Resistant: No Design Pressure: +45/-55 Other: Glass tested was 19.5 mm Insulated Glass consisting of two 3 mm tempered lites separated by a desiccant filled metal spacer. Other configurations comply with ASTM E1300. Hardware tested was a 3 point lock with a bolt.		Certification Agency Certificate FL13074_R8_C_CAC_FWHID6080AS_IG.pdf Quality Assurance Contract Expiration Date 07/17/2026 Installation Instructions FL13074_R8_II_A-Series_Inswing_Door.pdf Verified By: Window and Door Manufacturers Association Created by Independent Third Party: Evaluation Reports Created by Independent Third Party:
13074.6	A-Series Frenchwood Hinged Patio Door - Inswing/FWHID64100AP IG	A-Series Frenchwood Hinged Patio Door-Inswing
Limits of Use Approved for use in HVHZ: No Approved for use outside HVHZ: Yes Impact Resistant: No Design Pressure: +45/-55 Other: Glass tested was 19.5 mm Insulated Glass consisting of two 3 mm tempered lites separated by a desiccant filled		Certification Agency Certificate FL13074_R8_C_CAC_FWHID64100AP_IG.pdf Quality Assurance Contract Expiration Date 08/22/2026 Installation Instructions FL13074_R8_II_FL13074_R6_II_A-Series_Inswing_Door.pdf Verified By: Window and Door Manufacturers Association

	metal spacer. Other configurations comply with ASTM E1300. Hardware tested was a 4 point lock with a bolt on the active panel and two shoot bolts on the passive panel.	Created by Independent Third Party: Evaluation Reports Created by Independent Third Party:
13074.7	A-Series Frenchwood Hinged Patio Door - Inswing/FWHID6480AP IG	A Series Hinged Patio Doors - Inswing
	<p>Limits of Use Approved for use in HVHZ: No Approved for use outside HVHZ: Yes Impact Resistant: No Design Pressure: +45/-55 Other: Glass tested was 19.5 mm Insulated Glass consisting of two 3 mm tempered lites separated by a desiccant filled metal spacer. Other configurations comply with ASTM E1300. Hardware tested was a 3 point lock with a bolt.</p>	<p>Certification Agency Certificate FL13074_R8_C_CAC_FWHID6480AP_IG.pdf Quality Assurance Contract Expiration Date 07/09/2026 Installation Instructions FL13074_R8_II_A-Series Inswing Door.pdf Verified By: Window and Door Manufacturers Association Created by Independent Third Party: Evaluation Reports Created by Independent Third Party:</p>
13074.8	A-Series Frenchwood Hinged Patio Door - Inswing/FWHID81180ASA IG	A Series Frenchwood Hinged Patio Door - Inswing
	<p>Limits of Use Approved for use in HVHZ: No Approved for use outside HVHZ: Yes Impact Resistant: No Design Pressure: +45/-55 Other: Glass tested was 19.5 mm Insulated Glass consisting of two 3 mm tempered lites separated by a desiccant filled metal spacer. Other configurations comply with ASTM E1300. Hardware tested was a 3 point lock with a bolt on each operable panel.</p>	<p>Certification Agency Certificate FL13074_R8_C_CAC_FL13074_8_CCL.pdf Quality Assurance Contract Expiration Date 10/18/2023 Installation Instructions FL13074_R8_II_A-Series Inswing Door.pdf Verified By: Window and Door Manufacturers Association Created by Independent Third Party: Evaluation Reports Created by Independent Third Party:</p>
13074.9	A-Series Frenchwood Hinged Patio Door - Outswing/FWOD33100A IG	A-Series Frenchwood Hinged Patio Door-Outswing
	<p>Limits of Use Approved for use in HVHZ: No Approved for use outside HVHZ: Yes Impact Resistant: No Design Pressure: +45/-55 Other: Glass tested was 19.5 mm Insulated Glass consisting of two 3 mm tempered lites separated by a desiccant filled metal spacer. Other configurations comply with ASTM E1300. Hardware tested was a 4 point lock with a bolt.</p>	<p>Certification Agency Certificate FL13074_R8_C_CAC_FWOD33100A_IG.pdf Quality Assurance Contract Expiration Date 11/06/2026 Installation Instructions FL13074_R8_II_FL13074_R6_II_A-Series Outswing Door.pdf Verified By: Window and Door Manufacturers Association Created by Independent Third Party: Evaluation Reports Created by Independent Third Party:</p>
13074.10	A-Series Frenchwood Hinged Patio Door - Outswing/FWOD33100S IG	A-Series Frenchwood Hinged Non - Operable Patio Door - Outswing
	<p>Limits of Use Approved for use in HVHZ: No Approved for use outside HVHZ: Yes Impact Resistant: No Design Pressure: +45/-55 Other: Glass tested was 19.5 mm Insulated Glass consisting of two 3 mm tempered lites separated by a desiccant filled metal spacer. Other configurations comply with ASTM E1300. No hardware was utilized.</p>	<p>Certification Agency Certificate FL13074_R8_C_CAC_FWOD33100S_IG.pdf Quality Assurance Contract Expiration Date 03/01/2026 Installation Instructions FL13074_R8_II_FL13074_R6_II_A-Series Outswing Door.pdf Verified By: Window and Door Manufacturers Association Created by Independent Third Party: Evaluation Reports Created by Independent Third Party:</p>
13074.11	A-Series Frenchwood Hinged Patio Door - Outswing/FWOD3380A IG	A Series Hinged Patio Door - Outswing
	<p>Limits of Use Approved for use in HVHZ: No Approved for use outside HVHZ: Yes Impact Resistant: No Design Pressure: +45/-55 Other: Glass tested was 19.5 mm Insulated Glass consisting of two 3 mm tempered lites separated by a desiccant filled metal spacer. Other configurations comply with ASTM E1300. Hardware tested was a 3 point lock with a bolt.</p>	<p>Certification Agency Certificate FL13074_R8_C_CAC_FWOD3380A_IG.pdf Quality Assurance Contract Expiration Date 03/19/2026 Installation Instructions FL13074_R8_II_A-Series Outswing Door.pdf Verified By: Window and Door Manufacturers Association Created by Independent Third Party: Evaluation Reports Created by Independent Third Party:</p>
13074.12	A-Series Frenchwood Hinged Patio Door - Outswing/FWOD3380S IG	A Series Frenchwood Hinged Non-Operable Patio Door - Outswing
	<p>Limits of Use Approved for use in HVHZ: No Approved for use outside HVHZ: Yes Impact Resistant: No Design Pressure: +45/-55 Other: Glass tested was 19.5 mm Insulated Glass consisting of two 3 mm tempered lites separated by a desiccant filled</p>	<p>Certification Agency Certificate FL13074_R8_C_CAC_FWOD3380S_IG.pdf Quality Assurance Contract Expiration Date 03/12/2026 Installation Instructions FL13074_R8_II_A-Series Outswing Door.pdf Verified By: Window and Door Manufacturers Association</p>

	metal spacer. Other configurations comply with ASTM E1300. No hardware was utilized.	Created by Independent Third Party: Evaluation Reports Created by Independent Third Party:
13074.13	A-Series Frenchwood Hinged Patio Door - Outswing/FWOD64100AP IG	A-Series Frenchwood Hinged Patio Door-Outswing
	Limits of Use Approved for use in HVHZ: No Approved for use outside HVHZ: Yes Impact Resistant: No Design Pressure: +45/-45 Other: Glass tested was 19.5 mm Insulated Glass consisting of two 3 mm tempered lites separated by a desiccant filled metal spacer. Other configurations comply with ASTM E1300. Hardware tested was a 6 point lock on the active panel and two shoot bolts on the passive panel.	Certification Agency Certificate FL13074_R8_C_CAC_FWOD64100AP_IG.pdf Quality Assurance Contract Expiration Date 04/11/2026 Installation Instructions FL13074_R8_II_FL13074_R6_II_A-Series Outswing Door.pdf Verified By: Window and Door Manufacturers Association Created by Independent Third Party: Evaluation Reports Created by Independent Third Party:
13074.14	A-Series Frenchwood Hinged Patio Door - Outswing/FWOD6480AP IG	A-Series Hinged Patio Door - Outswing
	Limits of Use Approved for use in HVHZ: No Approved for use outside HVHZ: Yes Impact Resistant: No Design Pressure: +45/-45 Other: Glass tested was 19.5 mm Insulated Glass consisting of two 3 mm tempered lites separated by a desiccant filled metal spacer. Other configurations comply with ASTM E1300. Hardware tested was a 3 point lock with a bolt on the active panel and a 2 point lock on the passive panel.	Certification Agency Certificate FL13074_R8_C_CAC_FWOD6480AP_IG.pdf Quality Assurance Contract Expiration Date 03/12/2026 Installation Instructions FL13074_R8_II_A-Series Outswing Door Guide.pdf Verified By: Window and Door Manufacturers Association Created by Independent Third Party: Evaluation Reports Created by Independent Third Party:
13074.15	A-Series Frenchwood Sidelight Door/FWSLD17100 DPUP IG	A-Series Frenchwood Sidelight Door
	Limits of Use Approved for use in HVHZ: No Approved for use outside HVHZ: Yes Impact Resistant: No Design Pressure: +70/-70 Other: Glass tested was 19 mm Insulated Glass consisting of two 3 mm tempered lites separated by a desiccant filled metal spacer. Other configurations comply with ASTM E1300. No Hardware was utilized.	Certification Agency Certificate FL13074_R8_C_CAC_FL13074_15_CCL.pdf Quality Assurance Contract Expiration Date 11/21/2023 Installation Instructions FL13074_R8_II_FL13074_R6_II_A-Series Fixed Door.pdf Verified By: Window and Door Manufacturers Association Created by Independent Third Party: Evaluation Reports Created by Independent Third Party:
13074.16	A-Series Frenchwood Sidelight Door/FWSLD17100 IG	A-Series Frenchwood Sidelight Door
	Limits of Use Approved for use in HVHZ: No Approved for use outside HVHZ: Yes Impact Resistant: No Design Pressure: +45/-70 Other: Glass tested was 19 mm Insulated Glass consisting of two 3 mm tempered lites separated by a desiccant filled metal spacer. Other configurations comply with ASTM E1300. No Hardware was utilized.	Certification Agency Certificate FL13074_R8_C_CAC_FL13074_16_CCL.pdf Quality Assurance Contract Expiration Date 11/21/2023 Installation Instructions FL13074_R8_II_FL13074_R6_II_A-Series Fixed Door.pdf Verified By: Window and Door Manufacturers Association Created by Independent Third Party: Evaluation Reports Created by Independent Third Party:
13074.17	A-Series Frenchwood Transom Patio Door/FWTD-1-9624 IG	A-Series Frenchwood Transom Patio Door
	Limits of Use Approved for use in HVHZ: No Approved for use outside HVHZ: Yes Impact Resistant: No Design Pressure: +70/-80 Other: Glass tested was 19 mm Insulated Glass consisting of two 3 mm tempered lites separated by a desiccant filled metal spacer. Other configurations comply with ASTM E1300. No hardware was utilized.	Certification Agency Certificate FL13074_R8_C_CAC_FL13074_17_CCL.pdf Quality Assurance Contract Expiration Date 11/21/2023 Installation Instructions FL13074_R8_II_FL13074_R6_II_A-Series Fixed Door.pdf Verified By: Window and Door Manufacturers Association Created by Independent Third Party: Evaluation Reports Created by Independent Third Party:
13074.18	A-Series Frenchwood Transom Patio Door/FWTD-3-9624 IG	A-Series Frenchwood Transom Patio Door
	Limits of Use Approved for use in HVHZ: No Approved for use outside HVHZ: Yes Impact Resistant: No Design Pressure: +70/-80 Other: Glass tested was 19 mm Insulated Glass consisting of two 3 mm tempered lites separated by a desiccant filled metal	Certification Agency Certificate FL13074_R8_C_CAC_FL13074_18_CCL.pdf Quality Assurance Contract Expiration Date 11/21/2023 Installation Instructions FL13074_R8_II_FL13074_R6_II_A-Series Fixed Door.pdf Verified By: Window and Door Manufacturers Association

spacer. Other configurations comply with ASTM E1300. No hardware was utilized.		Created by Independent Third Party: Evaluation Reports Created by Independent Third Party:
13074.19	A-Series Frenchwood Transom Patio Door/FWTDS9624 IG	A-Series Frenchwood Transom Patio Door
Limits of Use Approved for use in HVHZ: No Approved for use outside HVHZ: Yes Impact Resistant: No Design Pressure: +70/-80 Other: Glass tested was 19 mm Insulated Glass consisting of two 3 mm tempered lites separated by a desiccant filled metal spacer. Other configurations comply with ASTM E1300. No hardware was utilized.		Certification Agency Certificate FL13074 R8 C CAC FL13074 19 CCL.pdf Quality Assurance Contract Expiration Date 11/21/2023 Installation Instructions FL13074 R8 II FL13074 R6 II A-Series Fixed Door.pdf Verified By: Window and Door Manufacturers Association Created by Independent Third Party: Evaluation Reports Created by Independent Third Party:

[Back](#) [Next](#)

Contact Us :: [2601 Blair Stone Road, Tallahassee FL 32399](#) Phone: 850-487-1824

The State of Florida is an AA/EEO employer. [Copyright 2007-2013 State of Florida](#). :: [Privacy Statement](#) :: [Accessibility Statement](#) :: [Refund Statement](#)

Under Florida law, email addresses are public records. If you do not want your e-mail address released in response to a public-records request, do not send electronic mail to this entity. Instead, contact the office by phone or by traditional mail. If you have any questions, please contact 850.487.1395. *Pursuant to Section 455.275(1), Florida Statutes, effective October 1, 2012, licensees licensed under Chapter 455, F.S. must provide the Department with an email address if they have one. The emails provided may be used for official communication with the licensee. However email addresses are public record. If you do not wish to supply a personal address, please provide the Department with an email address which can be made available to the public. To determine if you are a licensee under Chapter 455, F.S., please click [here](#).



Credit Card
Safe



Installation Guide/Guía de instalación



for Andersen® A-Series Hinged Outswing Patio Doors

para puertas de patio con bisagras de batiente hacia el exterior Serie A de Andersen®

Thank you for choosing Andersen. / Gracias por elegir Andersen.

Instructions are for typical, new wood-framed wall construction with weather protection in place.

Instructions may not be right for all installations due to building design, construction materials or methods used and/or building or site conditions. Consult a contractor or architect for recommendations.

Flanges on the unit alone will not properly flash and seal the window. Follow these instructions carefully.

For questions call 1-888-888-7020 Monday - Friday, 7 a.m. to 7 p.m. and Saturday, 8 a.m. to 4 p.m. central time.

For more information and/or guides visit andersenwindows.com.

Please leave this guide with building owner.

Las instrucciones son para construcción nueva en paredes con marco de madera que cuentan con protección contra la intemperie.

Es posible que las instrucciones no sean las adecuadas para todas las instalaciones debido al diseño del edificio, los materiales de construcción o los métodos utilizados, y/o las condiciones de la obra o el edificio. Consulte a un constructor o arquitecto para obtener recomendaciones.

Las bridas en la unidad no proporcionarán por sí mismas un flashing ni sellarán la ventana de manera adecuada. Siga las siguientes instrucciones cuidadosamente.

Si tiene alguna pregunta llame al 1-888-888-7020 de lunes a viernes, de 7 a.m. a 7 p.m., hora del centro, y los sábados de 8 a.m. a 4 p.m., hora del centro.

Para obtener más información y/o guías, visite andersenwindows.com.

Deje esta guía con el dueño de la construcción.

Read guide from beginning to end before starting installation. Read all warnings and cautions during unit installation.

Lea completamente la guía antes de comenzar la instalación. Lea y respete todas las advertencias y precauciones durante la instalación de la unidad.

Do not remove packing clips from door until instructed.

No retire los sujetadores de embalaje de la puerta hasta que se le indique.

⚠ WARNING / ADVERTENCIA

Metal fasteners and other hardware components may corrode when exposed to preservative treated and fire-retardant treated lumber. Obtain and use the appropriate metal fasteners and hardware as called out by the installation guide to fasten unit to any rough opening made from pressure treated and fire-retardant treated lumber. Failure to use the appropriate materials for the installation may cause a failure resulting in injury, property or product damage.

Los sujetadores y otros herrajes de metal pueden corroerse cuando quedan expuestos a madera tratada con retardador de fuego y con preservante. Obtenga y utilice los sujetadores e instrumentos metálicos apropiados, como se indica en la guía de instalación, para sujetar la unidad a cualquier abertura sin acabado de madera tratada con retardador de fuego y a presión. Si no utiliza los materiales apropiados para la instalación, se pueden producir lesiones o daños al producto o a la propiedad.

⚠ WARNING / ADVERTENCIA

Follow manufacturers' instructions for hand or power tools. Always wear safety glasses. Failure to do so may result in injury and/or product damage.

Siga las instrucciones del fabricante para el uso de herramientas eléctricas o manuales. Utilice siempre gafas de seguridad. Si no lo hiciera, podrían producirse lesiones y/o daños al producto.

⚠ WARNING / ADVERTENCIA

Use caution when working at elevated heights and around unit openings. Follow manufacturers' instructions for ladders and/or scaffolding. Failure to do so may result in injury or death.

Sea cauteloso al trabajar en lugares elevados y cerca de las aberturas de la unidad. Siga las instrucciones del fabricante para el uso de escaleras y/o andamios. Si no lo hiciera, podrían producirse lesiones o la muerte.

⚠ WARNING / ADVERTENCIA

Do not carry or lift unit by extension jambs. Doing so may result in injury, product or property damage.

No levante ó cargue la unidad cogiéndola de las jambas, esto puede ocasionar daño al producto y dañar su área de trabajo.

CAUTION / PRECAUCIÓN

Follow instructions of foam, sealant and flashing manufacturer regarding material application and compatibility with this product.

Siga las instrucciones del fabricante correspondientes al flashing y al sellador de espuma, con respecto a la aplicación y su compatibilidad con este producto.

Unit Identification / Identificación De La Unidad



Single Panel
Panel simple



Double Panel
Panel doble

Parts Included / Partes incluidas

- (1) Instruction Guide / Guía de instrucciones
- (1) Patio Door Unit / Unidad de puerta de patio
- (1) Screw Pack / Paquete de tornillos

Supplies Needed / Suministros necesarios

- (A) Formable Self-adhering Sill Flashing*
Flashing para riel auto-adherente moldeable*
- (B) Flashing* / Flashing*
Or other flashing method/material recommended by a contractor or architect. Unit flanges do not take the place of flashing.
O bien otro método/material de flashing recomendado por el contratista o arquitecto. Las bridas de la unidad no reemplazan el flashing.
- (C) House Wrap Tape / Cinta para sellar las uniones del house wrap exterior
- (D) Drip Cap (full width) / Tapa de goteo (ancho completo)
 - Extension Jamb (optional) / Jambas de extensión (opcional)
 - Low Expanding Foam / Espuma de baja expansión
 - Shims (waterproof) / Cuñas (impermeables)
 - Foam Backer Rod / Varilla de respaldo de espuma
 - Sealant / Sellador
 - Tape / Cinta
 - Staples / Grapas
 - Roofing Nails / Clavos para techado

Tools Needed / Herramientas necesarias

- Safety glasses / Gafas de seguridad
- Hammer / Martillo
- Tape measure / Cinta métrica
- Level / Nivel
- Utility knife / Cuchilla de uso general
- Putty Knife / Espátula
- Staple Gun / Pistola engrapadora
- Phillips Screwdriver / Destornillador Phillips
- Flat Blade Screwdriver / Destornillador de punta plana
- Drill/Driver / Taladro/Destornillador
- Caulk Gun / Pistola para calafatear

Screw Pack Contents: Contenido del paquete de tornillos:

-  (0-2) Hole Plugs (7/bag)
(0-2) Tapones para orificios (7/bolsa)
-  (0-1) Sill Clip
(0-1) Sujetador de riel
-  (0-4) 1" Stainless Steel Screws
(0-4) Tornillos de acero inoxidable de 1"
-  (9-20) 3" Steel Screws
(9-20) Tornillos de acero de 3"
-  (0-6) 3" Stainless Steel Screws
(0-6) Tornillos de acero inoxidable de 3"

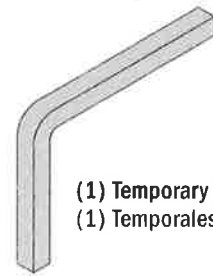

(1) Temporary Handle
(1) Temporales manejar

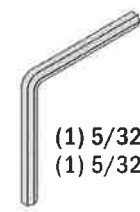

(1) 5/32" Allen Wrench
(1) 5/32" La llave allen

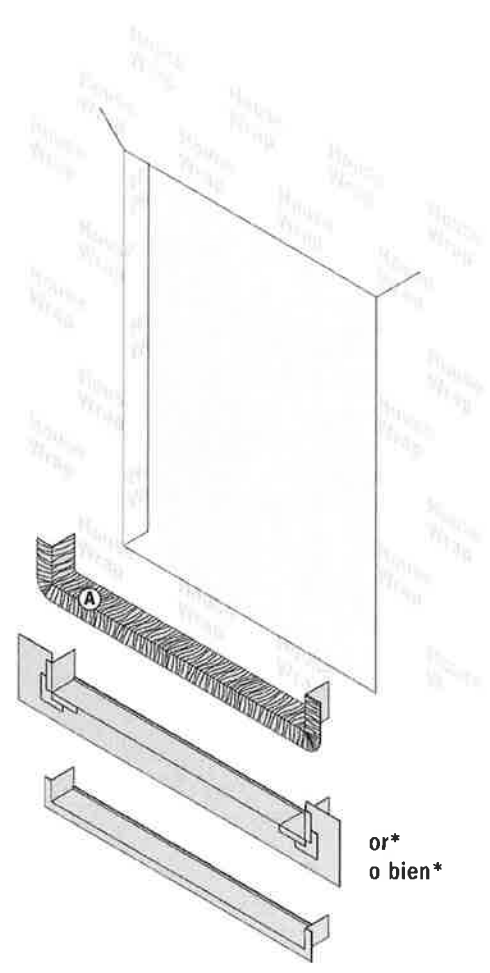

Glass / Vidrio

⚠ WARNING / ADVERTENCIA



Film Seam
Costura de la película

Suction Cup
Ventosa

Suction grips will not hold if placed over seam of film to lift or move unit. Unit will fall causing damage or injury.

Las ventosas no funcionarán si se colocan sobre la costura de la película al levantar o mover la unidad. La unidad se caerá y provocará daños y lesiones.

CAUTION / PRECAUCIÓN



Sealants will damage exterior coating on glass.

Los selladores dañarán el revestimiento exterior del vidrio.

- ▶ Laminated safety glass is not standard and must be special ordered. Check local building codes.
- ▶ Leave protective film in place until after construction is finished. Leave (NFRC) performance label in place until final inspection.
- ▶ Argon gas blend not available with high altitude glass.
- ▶ Los vidrios de seguridad laminados no son estándar y se requiere un pedido especial. Consulte los códigos de construcción locales.
- ▶ Deje la película protectora en su lugar hasta que finalice la construcción. Conserve la etiqueta de rendimiento (NFRC) en su lugar hasta que se realice la inspección final.
- ▶ La película protectora y el revestimiento exterior no se encuentran en todas las unidades.

Film Removal / Extracción de la película protectora

⚠ WARNING / ADVERTENCIA



Static created when removing film can ignite flammable materials or cause a shock.

See warning label on glass.

Al separar la película protectora, podría producirse una carga estática que podría causar un choque o chispa.



Consulte las etiquetas de advertencia sobre el vidrio.

⚠ WARNING / ADVERTENCIA

Dispose of film immediately after removing. Film may pose suffocation hazard to children.

Deseche la película inmediatamente después de retirarla ya que ésta puede ocasionar peligro de asfixia para los niños.

- ▶ Remove protective film from seam or corner using plastic scraper if needed.
- ▶ Remove protective film within nine months of installation and when temperature is above 32 degrees F.
- ▶ Retire la película protectora de la costura o la esquina con un raspador de plástico, de ser necesario.
- ▶ Retire la película protectora dentro de los nueve meses posteriores a la instalación y cuando la temperatura esté arriba de los 32 grados F.

Finishing / Acabado

CAUTION / PRECAUCIÓN

Finish wood surfaces immediately after installation. Unfinished wood will deteriorate, discolor, and/or may bow and split.

Do not stain or paint weatherstrip, vinyl, glass or hardware. Product damage may occur.

Aplique el acabado a las superficies de madera inmediatamente después de la instalación. Dejar la madera sin darle el acabado deteriorará, decolorará y/o puede pandearse o partirse.

No manche ni pinte los burletes, el vinilo, el vidrio y los herrajes. El producto se puede dañar.

- ▶ Apply interior casing to complete installation.
- ▶ Finish all hidden wood surfaces.
- ▶ Do not overload brush with stain/paint when finishing. Finish may wick between glass stop/grille on glass.
- ▶ **Read and follow finishing product instructions and warnings on finish material.**
- ▶ Aplique molduras interiores y/o peanas para completar la instalación.
- ▶ Aplique el acabado en las superficies de madera ocultas.
- ▶ No sobrecargue el cepillo con tintura/pintura cuando aplique el acabado. El acabado se puede hinchar entre el tope del vidrio y la retícula del vidrio.
- ▶ **Lea y siga las instrucciones para el producto terminado y las advertencias sobre el acabado en el material.**

- ▶ Film is not a substitute for masking.
- ▶ La película no es un sustituto del enmascarado.

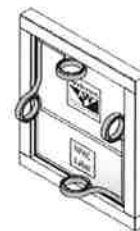

Cleaning / Limpieza

CAUTION / PRECAUCIÓN

Acid solutions used for cleaning masonry or concrete will damage glass, fasteners, hardware, and metal flashing. Protect unit and follow cleaning product instructions carefully. If acid contacts unit, wash all surfaces with water immediately.

Las soluciones ácidas que se utilizan para limpiar la mampostería o el concreto dañan el vidrio, los sujetadores, los herrajes y el flashing de metal. Proteja la unidad y siga las instrucciones de limpieza del producto con detenimiento. Si el ácido entra en contacto con la unidad, lave inmediatamente todas las superficies con agua.

CAUTION / PRECAUCIÓN

Abrasive cleaners will damage glass surface.

Los limpiadores abrasivos dañan la superficie del vidrio.

CAUTION / PRECAUCIÓN



Metal razor blades can damage glass surface and exterior coating.

Las hojas de filo metálico pueden dañar la superficie del vidrio y el revestimiento exterior.

- ▶ **Clean glass using liquid glass cleaner.**
- ▶ Clean exterior frame, sash, and insect screens using mild detergent and water with a soft cloth or brush.
- ▶ For hard to clean areas use a nonabrasive cleaner, alcohol-and-water or ammonia-and-water.
- ▶ Limpie el vidrio con un limpiador líquido para vidrios.
- ▶ Limpie el marco exterior, las hojas y los mosquiteros con detergente suave y agua usando un paño o cepillo suave.
- ▶ **Para las áreas difíciles de limpiar, use un limpiador no abrasivo, alcohol y agua o amoníaco y agua.**

Maintenance / Mantenimiento

- ▶ Do not apply any type of film to insulating glass. Thermal stress and glass damage can result. Shading devices (insulated coverings, shutters, etc.) may also cause thermal stress and condensation damage.
- ▶ No aplique ningún tipo de película a los vidrios aislantes. Se puede producir falla térmica y otros daños en los vidrios. Las cortinas aislantes, shutters, etc. pueden provocar falla térmica y daños por condensación.
- ▶ For more information, contact your local Andersen dealer or www.andersenwindows.com
- ▶ Para obtener más información, comuníquese con su distribuidor de Andersen local o visite www.andersenwindows.com

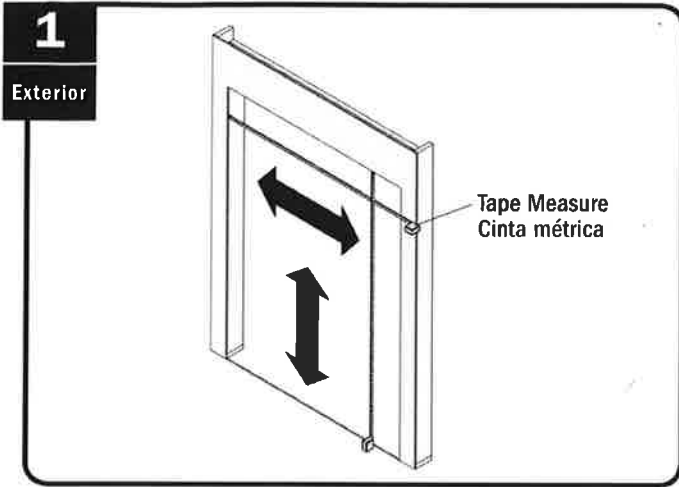

Check opening size. Allow for flashing thickness.
Verifique el tamaño de la abertura. Tenga en cuenta el espesor del flashing.

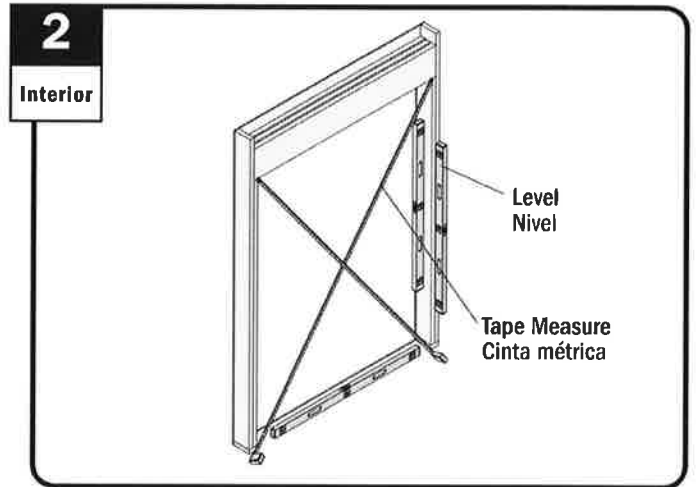

Check plumb, level, square. Diagonals must be within 1/8".
Verifique la plomada, el nivel y la cuadratura. Las diagonales deben estar entre 1/8".

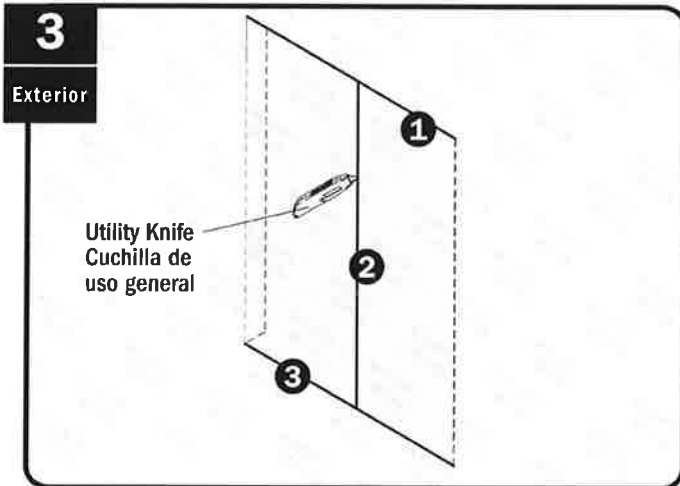

Cut opening in house wrap.
Corte una abertura en el house wrap.

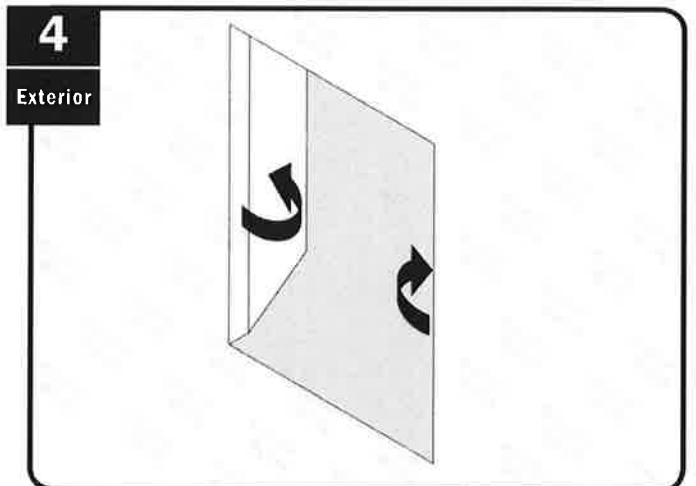

Fold in and staple.
Doble y engrape.

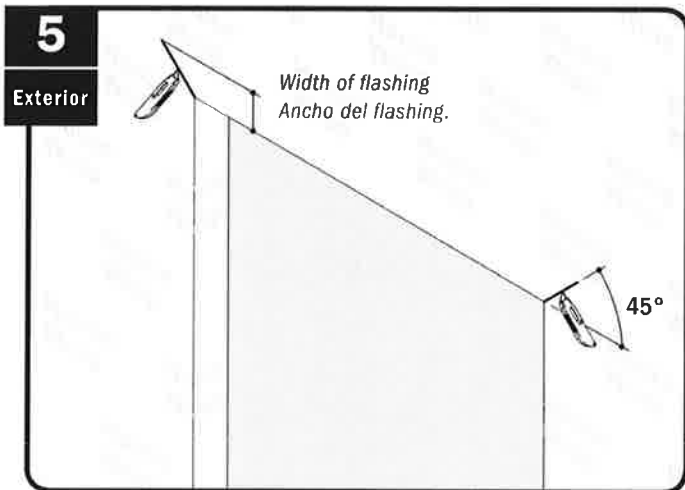

Cut and create top flap from house wrap.
Corte y cree una pestaña superior con el house wrap.

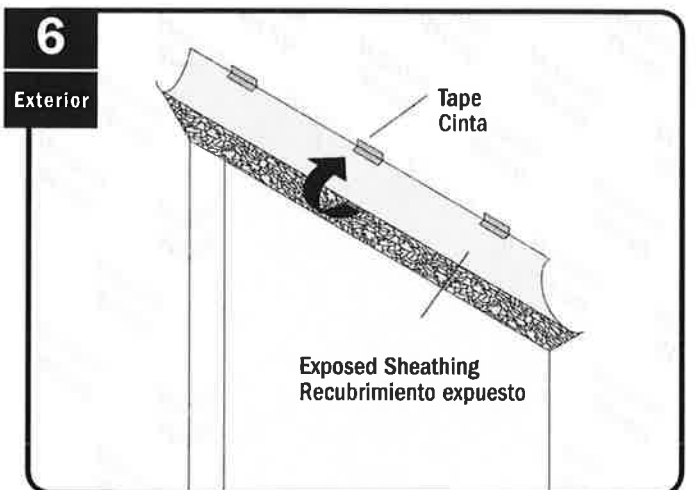

Fold flap up and tape.
Doble la pestaña hacia arriba y coloque cinta.

CAUTION / PRECAUCIÓN

7
Exterior

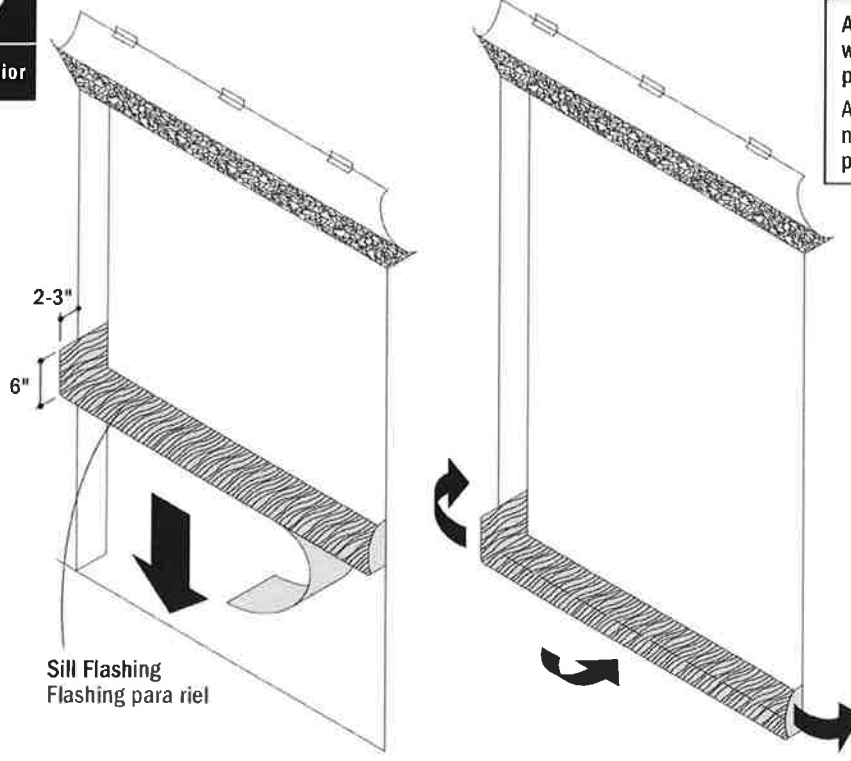

Apply formable flashing. Make sure there are no wrinkles or voids. Failure to do so may result in product / property damage.
 Aplique el flashing moldeable. Asegúrese de que no haya arrugas ni vacíos. De no hacerlo así, podrían producirse daños al producto/propiedad.

Apply using firm pressure.
 Aplique presionando firmemente.

J-roller
 Rodillo tipo J

Apply flashing at sill.
 Aplique el flashing en el riel.

8
Exterior

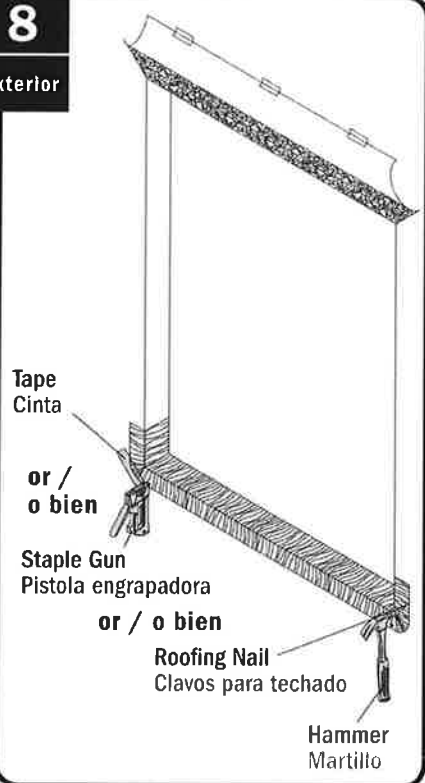

Staple, nail or tape corners.
 Engrape, clave o encinte las esquinas.

9
Exterior

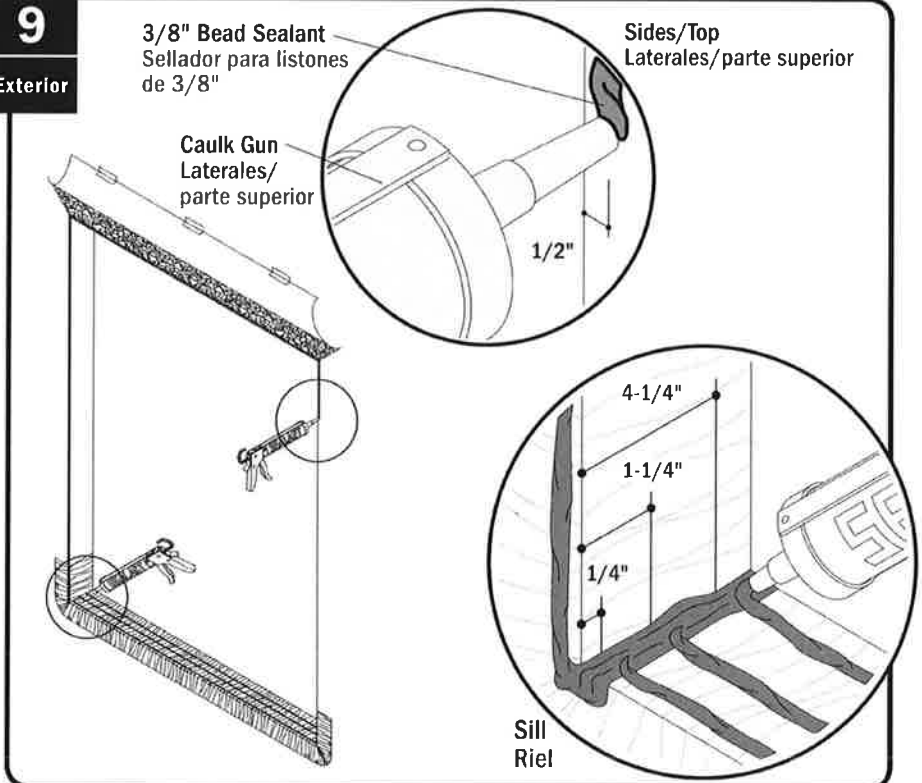

Apply sealant at sides and top. Apply three beads sealant at sill and liberally in bottom corner.
 Aplique el sellador en la parte superior y en los laterales. Aplique tres listones de sellador en el riel y libremente en la esquina inferior.

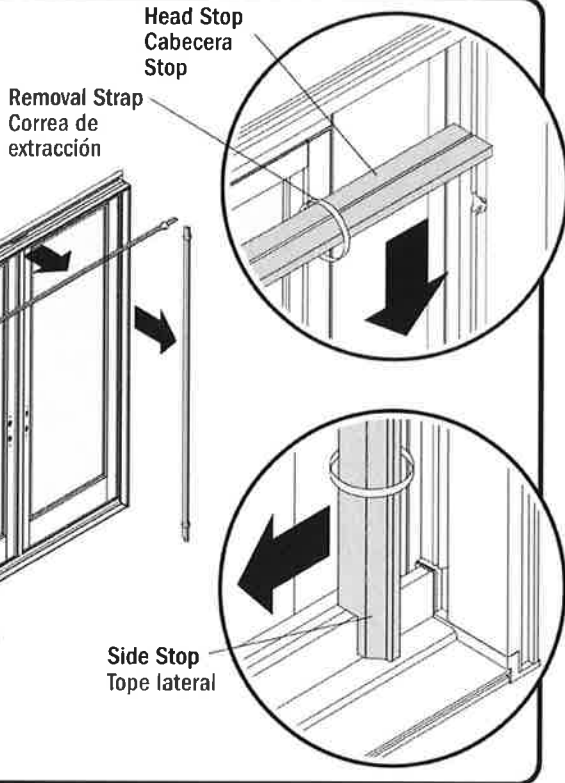
10**Interior**

Remove side stops, then head stop by pulling on removal strap. Discard straps. Save stops for reuse.
 Retire los topes laterales y luego el tope superior tirando de la correa de extracción. Deseche las correas. Guarde los topes para volver a usarlos.

11**Exterior****⚠ WARNING / ADVERTENCIA**

Windows and doors can be heavy. Use safe lifting techniques and a reasonable number of people with enough strength to lift, carry and install window and door products to avoid injury and/or product damage.

Las ventanas y puertas pueden ser pesadas. Utilice técnicas seguras de levantamiento de peso y un número razonable de personas con suficiente fuerza para levantar, cargar e instalar los productos de puertas y ventanas, a fin de evitar lesiones y/o daños al producto.

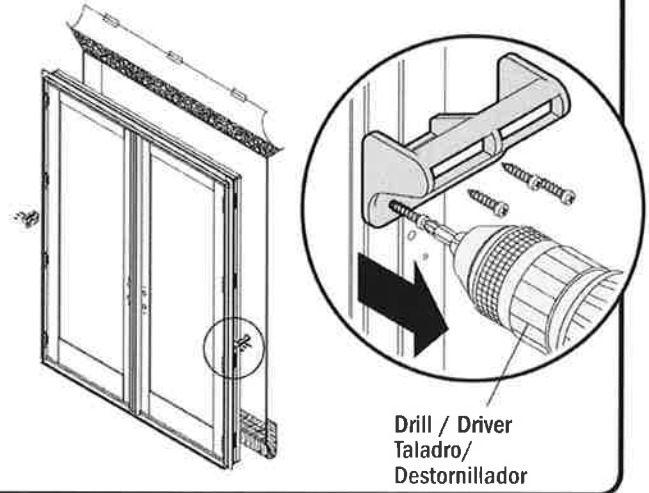

Remove handles and discard.
 Retire las manijas y descártelas.

12**Exterior****⚠ WARNING / ADVERTENCIA**

Support door in rough opening at all times until secured. Failure to do so may result in door falling out causing injury, property, and/or product damage.

Sostenga la puerta en una apertura no acabada siempre hasta que esté segura. Si no lo hace, la puerta se puede caer y provocar lesiones, daños al producto y/o a la propiedad.

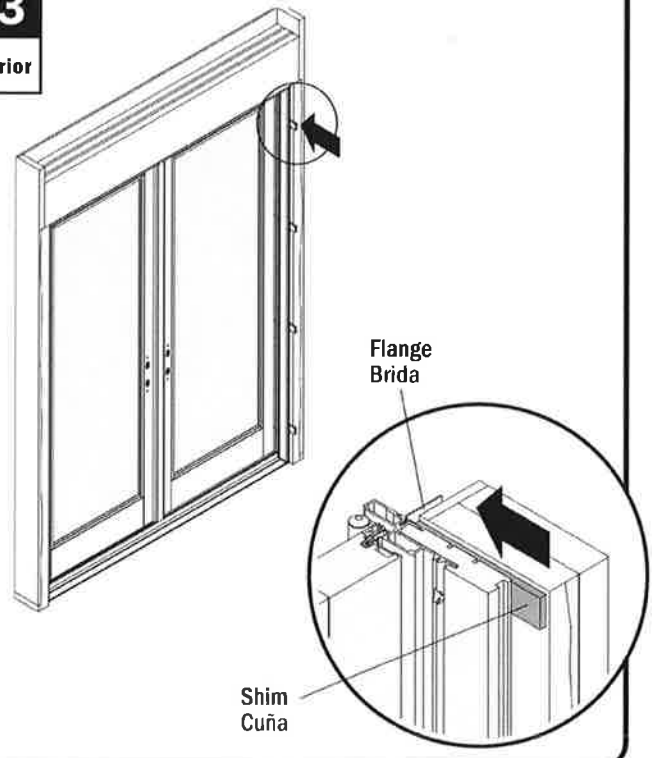

Center door in opening at sill and tip door into opening.
 Centre la puerta en la abertura del riel e incline la puerta dentro de la abertura.

13**Interior**

Shim behind hinges, lock receivers and installation screws. Shim must be tight to flange.
 Coloque cuñas detrás de las bisagras, receptores del cerrojo y tornillos de instalación. La cuña debe estar ajustada a la brida.

14
Interior

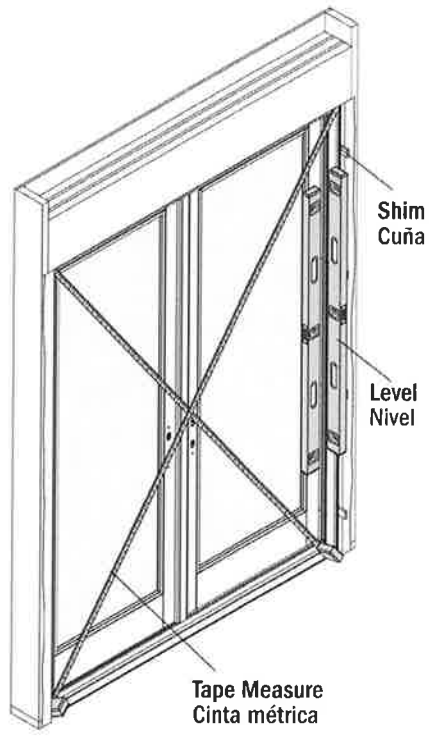

Check plumb, level and square. Adjust shims as needed until measurements are within 1/8".
 Verifique la plomada, el nivel y la cuadratura. Ajuste las cuñas según sea necesario hasta que las medidas estén entre los 1/8"..

15
Interior

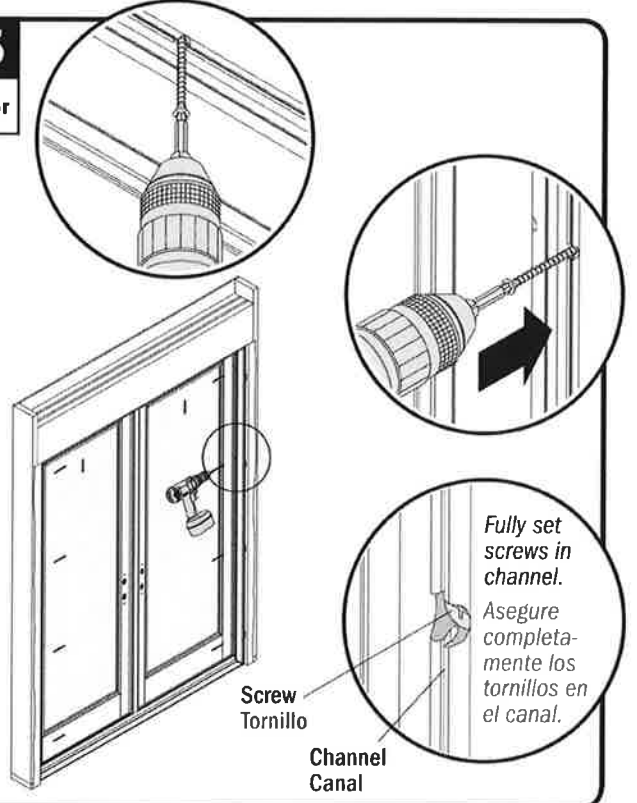

Fasten at head and sides in pre-drilled holes.
 Ajuste en la cabecera y los laterales por los orificios pretaladrados.

16
Interior

Apply head stop first.
 Coloque primero el tope de cabecera.

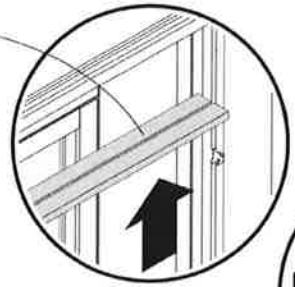

Apply side stops second.
 Coloque después los topes laterales.

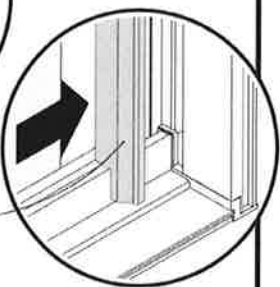

Barbed Fastener
 Sujetador dentado

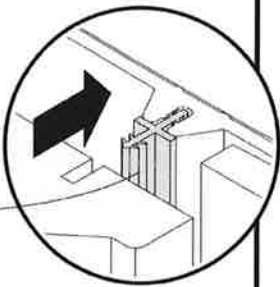

Position head stop, then side stops, to press fit fasteners and press into place.
 Coloque el tope superior y luego los topes laterales sobre los sujetadores de ajuste a presión y presiónelos hasta colocarlos en su lugar.

17
Interior

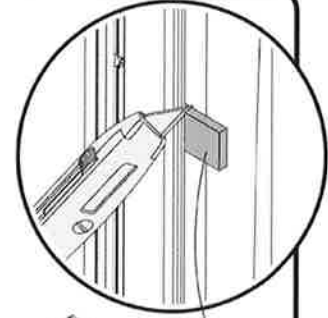

Shim
 Cuña

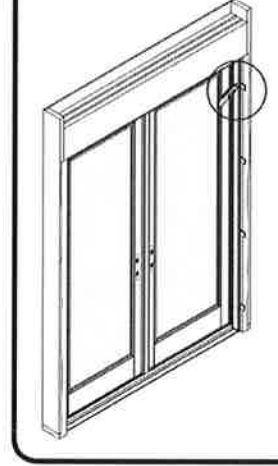

Cut shims flush.
 Corte las cuñas de manera plana.

18

Interior

Phillips Screwdriver
Destornillador
Phillips

Temporary Handle
Manija temporal

Unlock and open door.
Desbloquee y abra la puerta.

19

Interior

Packing Clip
Sujetador de embalaje

Remove packing clip(s).
Retire los sujetadores de embalaje.

20

Interior

3" Steel Screw
Tornillo

Fasten door at sides in pre-drilled holes.
Ajuste la puerta a los laterales por los orificios pretaladrados.

21

Interior

⚠ WARNING / ADVERTENCIA

Installation Hole Plugs are small parts and, if swallowed, could pose a choking hazard to young children. Remove and dispose of any loose or easily removed installation hole plugs.

Los tapones para orificios para la instalación son piezas pequeñas y, en caso de tragarse, podrían representar un peligro de sofocación para niños pequeños. Retire y deseche todos los tapones para orificios de instalación sueltos o que se puedan quitar fácilmente.

Hole Plug
Tapón para orificio

Apply hole plugs at all hole locations.
Coloque los tapones para orificios en todas las ubicaciones.

22
Interior

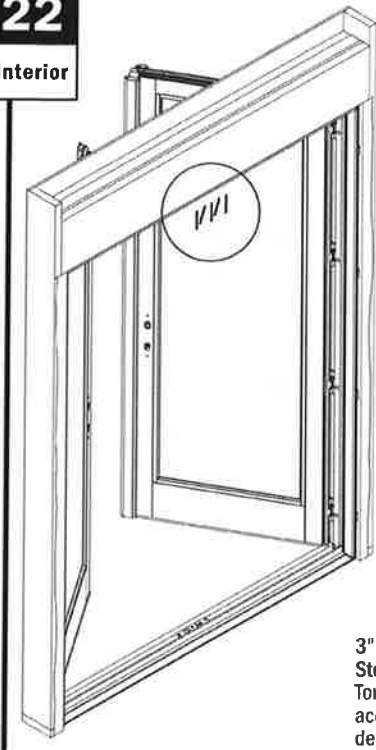

1st

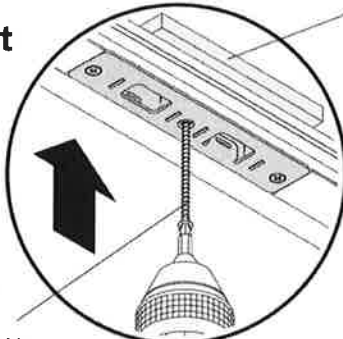

3" Stainless Steel Screw
Tornillos de acero inoxidable de 3"

Shim
Cuña

2nd

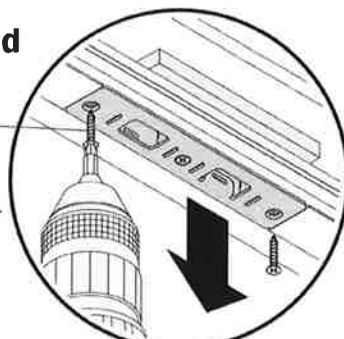

Remove and discard 1" screws.
Retire y deseche los tornillos de 1".

3rd

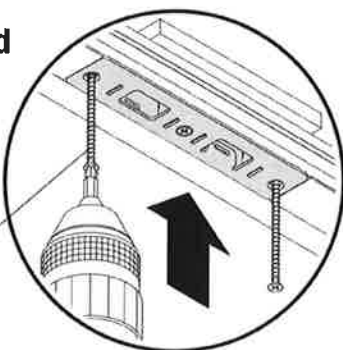

3" Stainless Steel Screw
Tornillos de acero inoxidable de 3"

4th

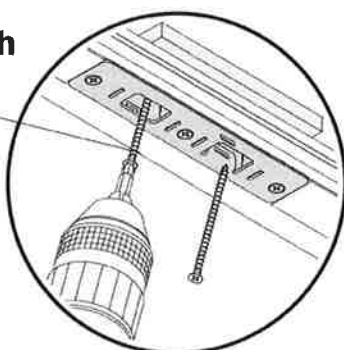

3" Stainless Steel Screw
Tornillos de acero inoxidable de 3"

Fasten through head jamb receiver in order indicated.
Ajuste a través del receptor de la jamba de cabecera en el orden indicado.

23
Exterior

Single Doors Only
Únicamente para puertas simples

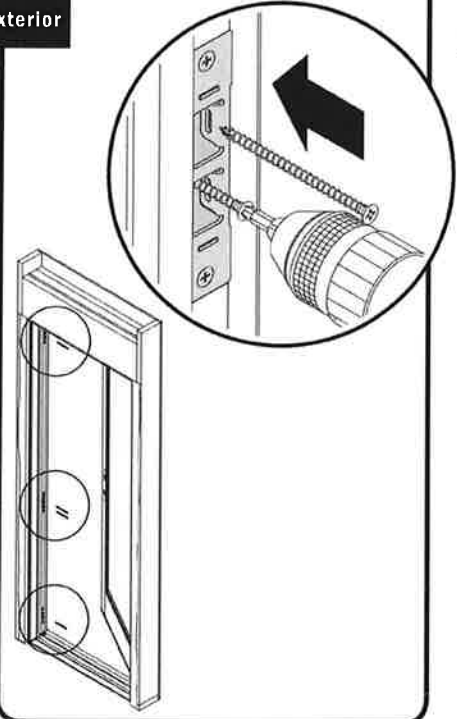

Fasten through latch and hook bolt receivers using #10 x 3" screws.
Ajuste a través del pasador y los receptores de pasador de gancho con tornillos No.10 de 3".

24
Exterior

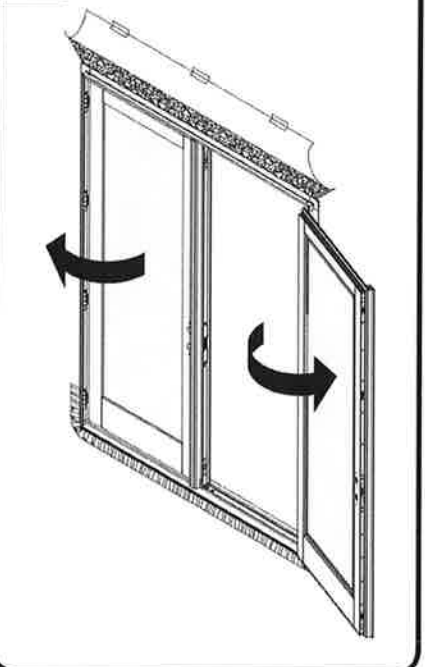

Check door operation. Refer to hinge and hardware adjustment guide, if needed.
Revise el funcionamiento de la puerta. Consulte la guía de instrucciones de ajuste de herrajes y bisagras, si fuera necesario.

25
Exterior

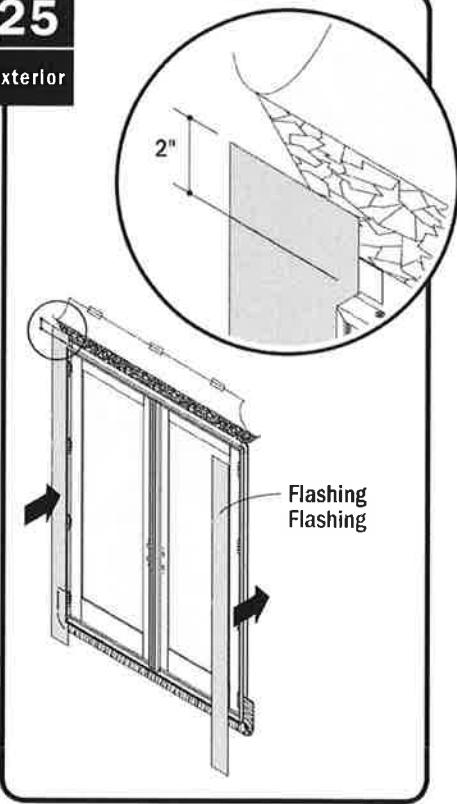

Apply flashing at sides, overlapping sill flashing.
Aplique flashing en los laterales, superponiéndolo sobre el flashing para riel.

26

Exterior

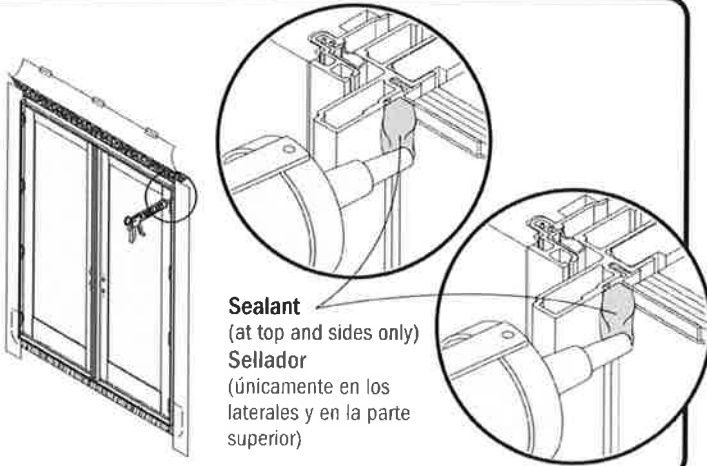

Sealant
(at top and sides only)
Sellador
(únicamente en los laterales y en la parte superior)

Seal sides and top only. Quickly go to next step.
Selle únicamente los laterales y la parte superior. Pase rápidamente al siguiente paso.

27

Exterior

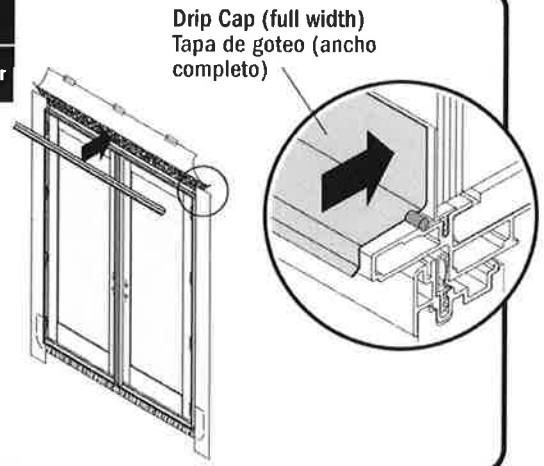

Drip Cap (full width)
Tapa de goteo (ancho completo)

Place drip cap (full width) in sealant.
Coloque la tapa de goteo (ancho completo) en sellador.

28

Exterior

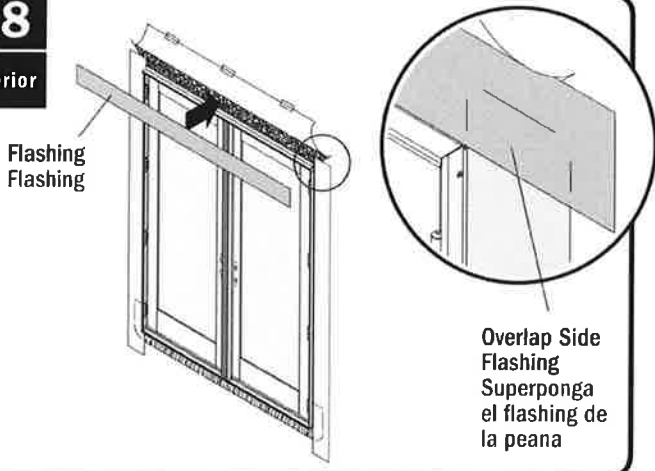

Flashing
Flashing

Overlap Side Flashing
Superponga el flashing de la peana

Apply flashing over drip cap leg, overlapping side flashing.
Aplique el flashing sobre la pata de la tapa de goteo, sobreponiéndolo sobre el flashing de la peana.

29

Exterior

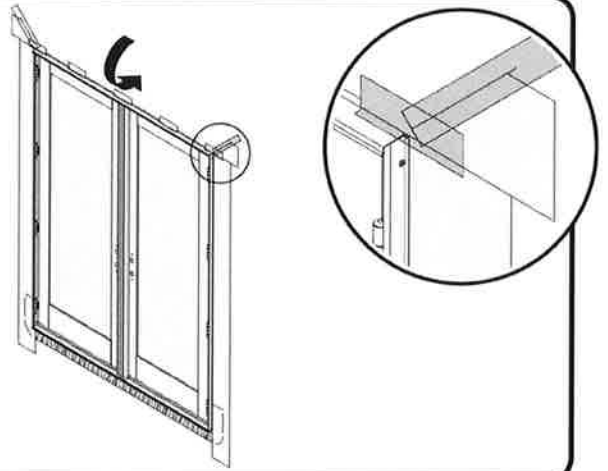

Fold house wrap down and tape.
Doble el house wrap hacia abajo y coloque cinta.

30

Interior

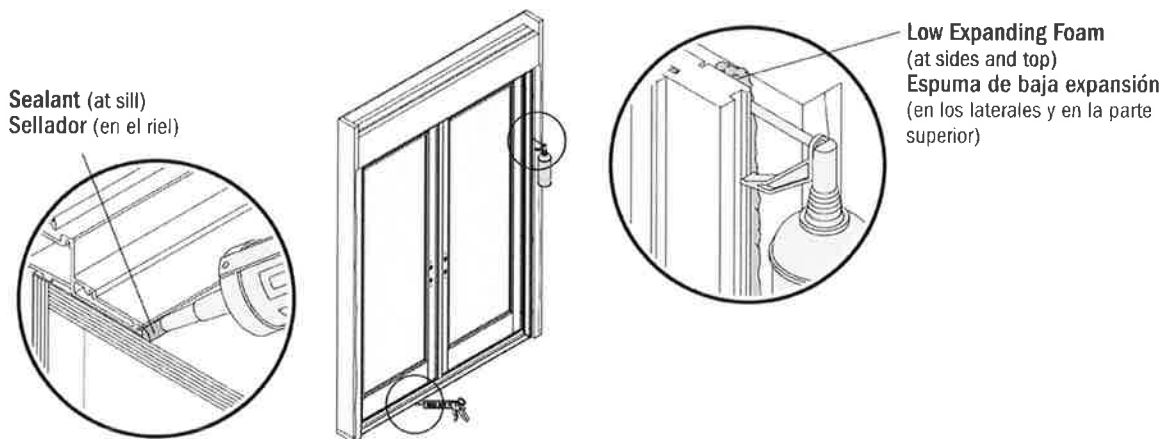

Sealant (at sill)
Sellador (en el riel)

Low Expanding Foam
(at sides and top)
Espuma de baja expansión
(en los laterales y en la parte superior)

Seal top and sides. Seal at sill and floor.
Selle la parte superior y los laterales. Selle el riel y el piso.

31**Double Doors Only / Puertas dobles solamente****Interior****CAUTION / PRECAUCIÓN**

Ridged sill pan modification may be required for sill clip anchoring and sealing. Failure to seal sill pan will result in water damage to property.

Puede ser necesaria la modificación de la placa del riel rígida para el anclaje y sellado del sujetador del riel. No sellar la placa del riel, puede provocar que el agua dañe la propiedad.

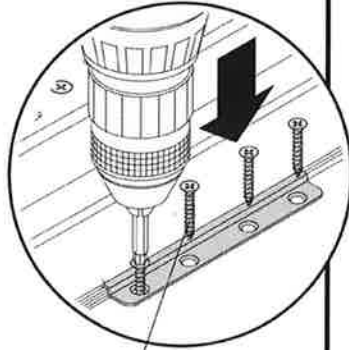
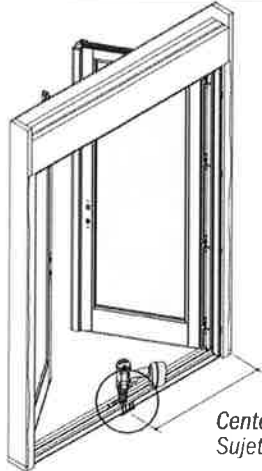

1" Stainless Steel Screw
Tornillos de acero inoxidable de 1"

Center Clip
Sujetador central

Position sill clip and fasten.
Ubique y ajuste el sujetador del riel.

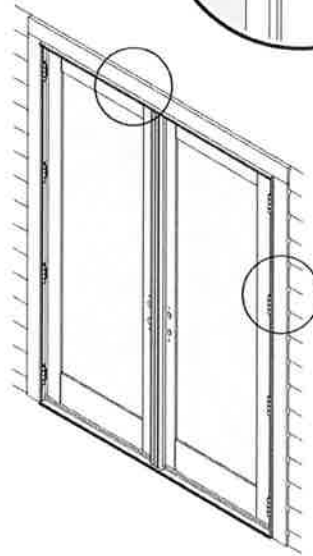
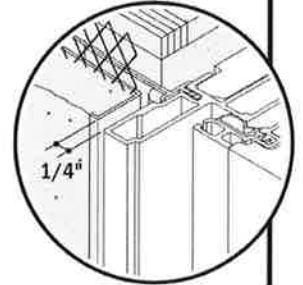
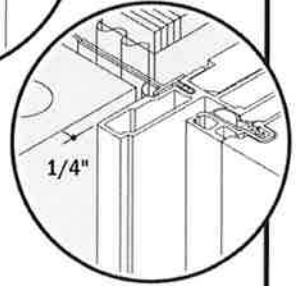
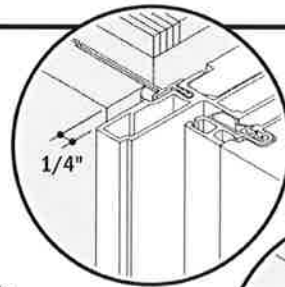
32**Exterior**

Leave 1/4" gap at head and sides between exterior trim/siding/stucco/brick and window for sealing.
Deje un espacio de 1/4" en la cabecera y en los laterales entre el contramarco/el revestimiento/el estuco/el ladrillo exterior y la ventana para el sellado.

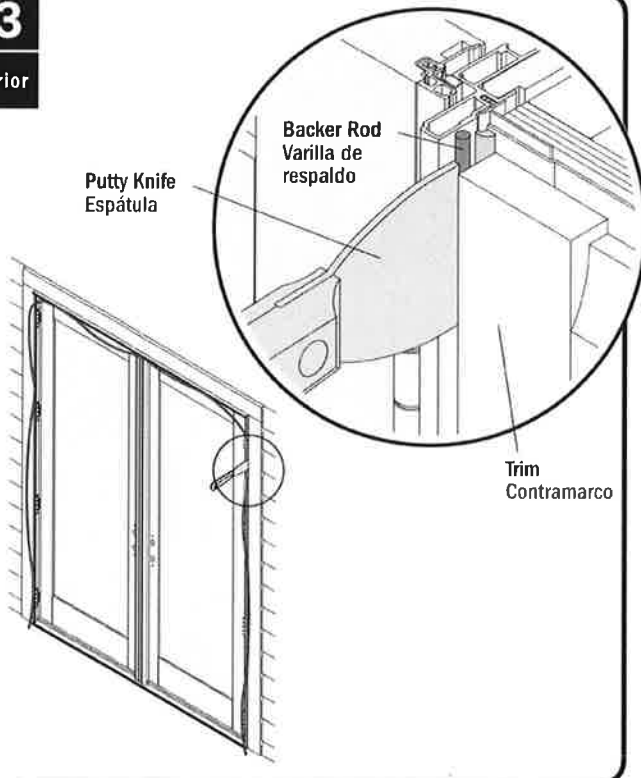
33**Exterior**

Putty Knife
Espátula

Backer Rod
Varilla de respaldo

Trim
Contramarco

Insert backer rod at sides and top between frame and finish material.
Introduzca la varilla de respaldo en los laterales y en la parte superior entre el marco y el material de acabado.

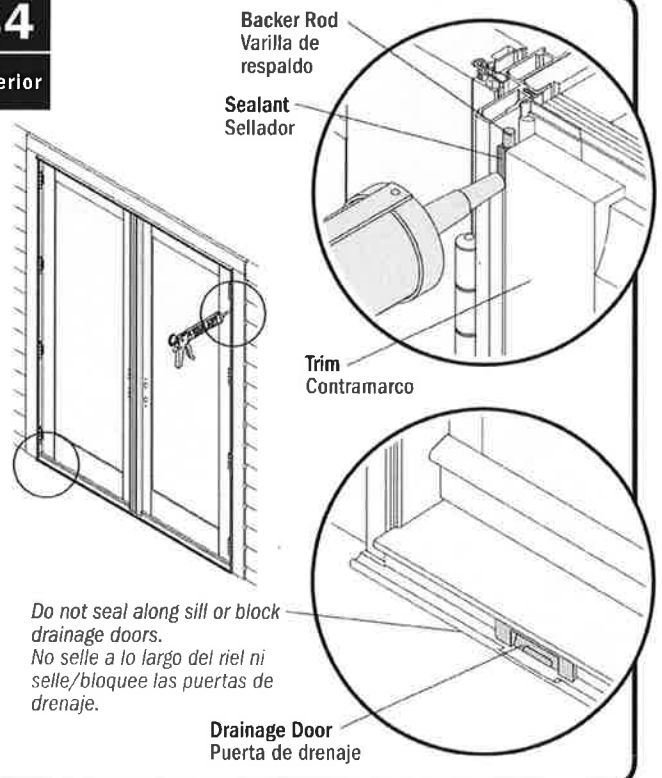
34**Exterior**

Backer Rod
Varilla de respaldo

Sealant
Sellador

Trim
Contramarco

Do not seal along sill or block drainage doors.
No selle a lo largo del riel ni selle/bloquee las puertas de drenaje.

Drainage Door
Puerta de drenaje

Seal on sides and top. **Do not** seal at sill or block drainage doors.
Selle en los laterales y la parte superior. **No** selle el riel ni selle/bloquee las puertas de drenaje.

► **Installation is complete.**
La instalación está completa.



Agreement Document and Payment Terms

dba: Renewal By Andersen of Florida
Legal Name: JLM Windows, LLC
CGC1524135
997 West Kennedy Blvd. Suite A18 | Orlando, FL 32810
Phone: 407-803-4723 | Fax: | Customerservice@rbafla.com

Diana Moss
5858 Cove Dr
Belle Isle, FL 32812
H: (407)859-3783
C: (407)247-2628

Buyer(s) Name: Diana Moss Contract Date: 06/07/19

Buyer(s) Street Address: 5858 Cove Dr, Belle Isle, FL 32812

Primary Telephone Number: (407)859-3783 Secondary Telephone Number: (407)247-2628

Primary Email: ddi1968@aol.com Secondary Email: _____

Buyer(s) hereby jointly and severally agrees to purchase the products and/or services of JLM Windows, LLC d/b/a Renewal By Andersen of Florida ("Contractor"), in accordance with the terms and conditions described in this Agreement Document and Payment Terms, any documents listed in the Table of Contents, and any other document attached to this Agreement Document, the terms of which are all agreed to by the parties and incorporated herein by reference (collectively, this "Agreement"). Buyer(s) hereby agrees to sign a completion certificate after Contractor has completed all work under this Agreement.

Total Job Amount:	\$13,839	By signing this Agreement, you acknowledge that the Balance Due, and the Amount Financed must be made by personal check, bank check, credit card, or cash.	
Deposit Received:	\$13,839		
Balance Due:	\$0	Estimated Start:	Estimated Completion:
Amount Financed:	\$0	10-12 weeks	1-2 Days
Method of Payment:	Credit Card	We schedule installations based on the date of the signed contract and secondarily on the date in which we complete the technical measurements. The installation date that we are providing at this time is only an estimate. We will communicate an official date and time at a later date. Rain and extreme weather are the most common causes for delay.	

Notes: **Paid in full**

Buyer(s) agrees and understands that this Agreement constitutes the entire understandings between the parties and that there are no verbal understandings changing or modifying any of the terms of this Agreement. No alterations to or deviations from this Agreement will be valid without the signed, written consent of both the Buyer(s) and Contractor. Buyer(s) hereby acknowledges that Buyer(s) 1) has read this Agreement, understands the terms of this Agreement, and has received a completed, signed, and dated copy of this Agreement, including the two attached Notices of Cancellation, on the date first written above and 2) was orally informed of Buyer's right to cancel this Agreement.

NOTICE TO BUYER: Do not sign this contract if blank. You are entitled to a copy of the contract at the time you sign.

YOU, THE BUYER, MAY CANCEL THIS TRANSACTION AT ANY TIME NOT LATER THAN MIDNIGHT OF 06/11/2019 OR THE THIRD BUSINESS DAY AFTER THE DATE OF THIS TRANSACTION, WHICHEVER DATE IS LATER. SEE THE ATTACHED NOTICE OF CANCELLATION FORM FOR AN EXPLANATION OF THIS RIGHT.

Legal Name: JLM Windows, LLC
dba: Renewal By Andersen of Florida

Signature of Sales Person
Alan Stokes
Print Name of Sales Person

Buyer(s)

Signature
Diana Moss
Print Name

Signature
Print Name



Order Summary

dba: RENEWAL BY ANDERSEN OF CENTRAL FLORIDA
Legal Name: Universal Roofing Group, Inc. | License # CGC1524135
997 West Kennedy blvd | Orlando, FL 32810
Phone: 407-803-4723 | Fax: 407-386-8262 | Customerservice@rbafla.com
Measure Tech: Alan Stokes, (407)717-4597

DIANA MOSS
5858 Cove Dr
Belle Isle, FL 32812
H: (407)859-3783 | C: (407)247-2628

FLOORPLAN - 1ST FLOOR

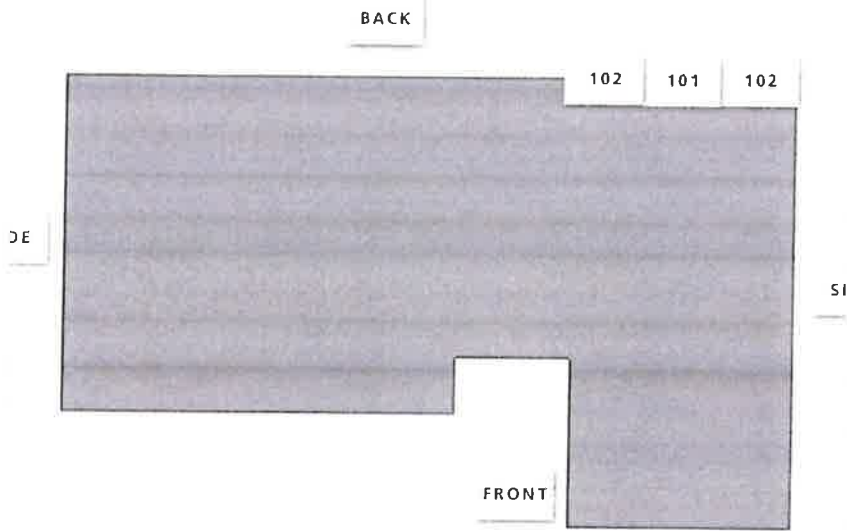

UNIT NOTES

JOB PHOTOS



Image 1



Itemized Order Receipt

dba: Renewal By Andersen of Florida
 Legal Name: JLM Windows, LLC
CGC1524135
 997 West Kennedy Blvd. Suite A18 | Orlando, FL 32810
 Phone: 407-803-4723 | Fax: | Customerservice@rbafla.com

Diana Moss
 5858 Cove Dr
 Belle Isle, FL 32812
 H: (407)859-3783
 C: (407)247-2628

ID#:	ROOM:	SIZE:	DETAILS:
------	-------	-------	----------

101 bed#1 30 1/8 W
 79 1/2 H

31 3/8 x 79 1/2

Patio Door: Outswing, A-Series Frenchwood, 1 Panel, Stationary, Bronze Sill, Exterior White, Interior Pine, Interior Pre-Finish White, **Glass:** All Sash: Tempered High Perf. SmartSun Glass, No Pattern, **Grille Style:** No Grille, **Misc:** None

96 3/4 x 79 3/4

102 Bed#1 32 1/8 W
 79 1/2 H

32 1/8 x 79 1/2

Patio Door: Outswing, A-Series Frenchwood, 1 Panel, Left, Bronze Sill, Exterior White, Interior Pine, Interior Pre-Finish White, **Glass:** All Sash: Tempered High Perf. SmartSun Glass, No Pattern, **Hardware:** Newbury®, Antique Brass, Exterior Keyed Lock, Corrosion Resistant Lock, Corrosion Resistant Hinges, **Screen:** Retractable, **Grille Style:** No Grille, **Misc:** Premium interior jamb extensions and casing

102 bed#1 30 1/8 W
 79 1/2 H

31 3/8 x 79 1/2

Patio Door: Outswing, A-Series Frenchwood, 1 Panel, Stationary, Bronze Sill, Exterior White, Interior Pine, Interior Pre-Finish White, **Glass:** All Sash: Tempered High Perf. SmartSun Glass, No Pattern, **Grille Style:** No Grille, **Misc:** None

WINDOWS: 0 PATIO DOORS: 3 SPECIALTY: 0 MISC: 0 TOTAL \$13,839

FL13074-R8

51.4375



Renewal by Andersen is committed to our customers' safety by complying with the rules and lead-safe work practices specified by the EPA.



NOCV
- need cert ✓

Searches

Sales Search

Results

Property Record Card

My Favorites

Sign up for e-Notify...

5858 Cove Dr < 20-23-30-1660-00-110 >

Name(s)
Moss Willie C
Moss Diana

Physical Street Address
5858 Cove Dr

Postal City and Zipcode
Orlando, Fl 32812

Mailing Address On File
5858 Cove Dr
Belle Isle, FL 32812-2819

Incorrect Mailing Address?

Property Use
0130 - Sfr - Lake Front

Municipality
Belle Isle



View 2018 Property Record Card

Property Features

Values, Exemptions and Taxes

Sales Analysis

Location Info

Market Stats

Update Information

2019 values will be available in August of 2019.

Property Description

View Plat

CONWAY GARDENS R/18 LOT 11 & LAND 86.4 CONTOUR LINE

Total Land Area 23,058 sqft (+/-) | 0.53 acres (+/-) GIS Calculated Notice

Land

Land Use Code	Zoning	Land Units	Unit Price	Land Value	Class Unit Price	Class Value
0130 - Sfr - Lake Front	R-1-AA	1 LOT(S)	working...	working...	working...	working...

Page 1 of 1 (1 total records)

Buildings

Important Information		Structure	
	Model Code:	01 - Single Fam Residence	Actual Year Built: 1959
	Type Code:	0103 - Single Fam Class III	Beds: 5
	Building Value:	working...	Baths: 2.0
	Estimated New Cost:	working...	Floors: 1
		Gross Area:	4524 sqft
		Living Area:	2920 sqft
		Exterior Wall:	Concrete Block Stucco
		Interior Wall:	Plastered

Page 1 of 1 (1 total records)

Extra Features

Description	Date Built	Units	XFOB Value
BC3 - Boat Cover 3	01/01/1995	1 Unit(s)	working...
BD3 - Boat Dock 3	02/18/1994	1 Unit(s)	working...
FPL2 - Average Fireplace	05/10/1994	1 Unit(s)	working...
3880 - Grnhs-W-P	05/10/1994	340 Unit(s)	working...
PT1 - Patio 1	01/01/2001	1 Unit(s)	working...
PT1 - Patio 1	01/01/2010	1 Unit(s)	working...
PTNV - Patio No Value	01/01/2010	1 Unit(s)	working...

Page 1 of 1 (7 total records)



Ron DeSantis, Governor

Halsey Beshears, Secretary



**STATE OF FLORIDA
DEPARTMENT OF BUSINESS AND PROFESSIONAL REGULATION**

CONSTRUCTION INDUSTRY LICENSING BOARD

THE GENERAL CONTRACTOR HEREIN IS CERTIFIED UNDER THE
PROVISIONS OF CHAPTER 489, FLORIDA STATUTES

MELLICK, JARED LEE

RENEWAL BY ANDERSEN OF FLA
997 W KENNEDY BLVD STE 18
ORLANDO FL 32810

LICENSE NUMBER: CGC1527613

EXPIRATION DATE: AUGUST 31, 2020

Always verify licenses online at MyFloridaLicense.com



Do not alter this document in any form.

This is your license. It is unlawful for anyone other than the licensee to use this document.



CERTIFICATE OF LIABILITY INSURANCE

DATE (MM/DD/YYYY)

5/14/2019

THIS CERTIFICATE IS ISSUED AS A MATTER OF INFORMATION ONLY AND CONFERS NO RIGHTS UPON THE CERTIFICATE HOLDER. THIS CERTIFICATE DOES NOT AFFIRMATIVELY OR NEGATIVELY AMEND, EXTEND OR ALTER THE COVERAGE AFFORDED BY THE POLICIES BELOW. THIS CERTIFICATE OF INSURANCE DOES NOT CONSTITUTE A CONTRACT BETWEEN THE ISSUING INSURER(S), AUTHORIZED REPRESENTATIVE OR PRODUCER, AND THE CERTIFICATE HOLDER.

IMPORTANT: If the certificate holder is an ADDITIONAL INSURED, the policy(ies) must have ADDITIONAL INSURED provisions or be endorsed. If SUBROGATION IS WAIVED, subject to the terms and conditions of the policy, certain policies may require an endorsement. A statement on this certificate does not confer rights to the certificate holder in lieu of such endorsement(s).

PRODUCER Bouchard Insurance 101 N Starcrest DR Clearwater FL 33765		CONTACT NAME: PHONE (A/C, No, Ext): 727-447-6481 FAX (A/C, No): 727-449-1267 E-MAIL ADDRESS: ciceris@bouchardinsurance.com	
INSURED JLM Windows, LLC dba Renewal by Andersen of Florida 5655 Carder Rd. Orlando FL 32810		INSURER(S) AFFORDING COVERAGE NAIC # INSURER A: United Specialty Insurance Co 12537 INSURER B: Ohio Security Insurance Co 24082 INSURER C: Bridgefield Employers Ins Co 10701 INSURER D: Lloyds of London INSURER E: Endurance Assurance Corporation INSURER F:	

COVERAGES

CERTIFICATE NUMBER: 1409002265

REVISION NUMBER:

THIS IS TO CERTIFY THAT THE POLICIES OF INSURANCE LISTED BELOW HAVE BEEN ISSUED TO THE INSURED NAMED ABOVE FOR THE POLICY PERIOD INDICATED. NOTWITHSTANDING ANY REQUIREMENT, TERM OR CONDITION OF ANY CONTRACT OR OTHER DOCUMENT WITH RESPECT TO WHICH THIS CERTIFICATE MAY BE ISSUED OR MAY PERTAIN, THE INSURANCE AFFORDED BY THE POLICIES DESCRIBED HEREIN IS SUBJECT TO ALL THE TERMS, EXCLUSIONS AND CONDITIONS OF SUCH POLICIES. LIMITS SHOWN MAY HAVE BEEN REDUCED BY PAID CLAIMS.

INSR LTR	TYPE OF INSURANCE	ADDL INSD	SUBR WVD	POLICY NUMBER	POLICY EFF (MM/DD/YYYY)	POLICY EXP (MM/DD/YYYY)	LIMITS
A	<input checked="" type="checkbox"/> COMMERCIAL GENERAL LIABILITY <input type="checkbox"/> CLAIMS-MADE <input checked="" type="checkbox"/> OCCUR GEN'L AGGREGATE LIMIT APPLIES PER <input type="checkbox"/> POLICY <input checked="" type="checkbox"/> PROJECT <input type="checkbox"/> LOC OTHER:	Y	Y	ATNATL1821708	11/30/2018	11/1/2019	EACH OCCURRENCE \$ 1,000,000 DAMAGE TO RENTED PREMISES (Ea occurrence) \$ 50,000 MED EXP (Any one person) \$ PERSONAL & ADV INJURY \$ 1,000,000 GENERAL AGGREGATE \$ 2,000,000 PRODUCTS - COMP/OP AGG \$ 2,000,000 \$
B	<input checked="" type="checkbox"/> AUTOMOBILE LIABILITY <input checked="" type="checkbox"/> ANY AUTO <input type="checkbox"/> OWNED AUTOS ONLY <input type="checkbox"/> SCHEDULED AUTOS <input checked="" type="checkbox"/> HIRED AUTOS ONLY <input checked="" type="checkbox"/> NON-OWNED AUTOS ONLY <input type="checkbox"/> AUTOS ONLY	Y	Y	BAS58307028	11/1/2018	11/1/2019	COMBINED SINGLE LIMIT (Ea accident) \$ 1,000,000 BODILY INJURY (Per person) \$ BODILY INJURY (Per accident) \$ PROPERTY DAMAGE (Per accident) \$ \$
A	<input type="checkbox"/> UMBRELLA LIAB <input checked="" type="checkbox"/> OCCUR <input checked="" type="checkbox"/> EXCESS LIAB <input type="checkbox"/> CLAIMS-MADE DEF RETENTIONS			BTN1825042	11/30/2018	11/1/2019	EACH OCCURRENCE \$ 5,000,000 AGGREGATE \$ 5,000,000 \$
C	WORKERS COMPENSATION AND EMPLOYERS' LIABILITY ANY PROPRIETOR/PARTNER/EXECUTIVE OFFICER/MEMBER EXCLUDED? (Mandatory in NH) If yes, describe under DESCRIPTION OF OPERATIONS below	Y	N/A	83056033	11/1/2018	11/1/2019	<input checked="" type="checkbox"/> PER STATUTE <input type="checkbox"/> OTHER E L EACH ACCIDENT \$ 1,000,000 E L DISEASE - EA EMPLOYEE \$ 1,000,000 E L DISEASE - POLICY LIMIT \$ 1,000,000
D	Leased/Rented Equip			567452R1	11/1/2018	11/1/2019	100,000
E	Excess Auto			EXC30000871300	11/30/2018	11/1/2019	5,000,000

DESCRIPTION OF OPERATIONS / LOCATIONS / VEHICLES (ACORD 101, Additional Remarks Schedule, may be attached if more space is required)

Certificate Holder and others as required in the contract documents are an additional insured on a primary and noncontributory basis with respect to General Liability and Auto policies including ongoing and completed operations, where required by written contract and subject to the terms, conditions and exclusions of the policy.

Per Project aggregate applies to the General Liability up to \$10,000,000.

Waiver of subrogation applies in favor of certificate holder as respects General Liability, Auto and See Attached...

CERTIFICATE HOLDER**CANCELLATION**

City of Belle Isle
 1600 Nela Avenue
 Belle Isle FL 32809

SHOULD ANY OF THE ABOVE DESCRIBED POLICIES BE CANCELLED BEFORE THE EXPIRATION DATE THEREOF, NOTICE WILL BE DELIVERED IN ACCORDANCE WITH THE POLICY PROVISIONS.

AUTHORIZED REPRESENTATIVE

© 1988-2015 ACORD CORPORATION. All rights reserved.

5000 BUSINESS OFFICE 2018 \$30.00 4 EMPLOYEES : 1801 CERT GENERAL CONTR \$30.00 5000-1164380 1 EMPLOYEE :

TOTAL TAX \$80.00
PREVIOUSLY PAID \$60.00
TOTAL DUE \$20.00

MELLICK JARED LEE

RENEWAL BY ANDERSEN OF CENTRAL FLORIDA
MELLICK JARED LEE
997 W KENNEDY BLVD#1800
ORLANDO FL 32810

997 W KENNEDY BLVD #1800
J - EATONVILLE, 32810

PAID: \$60.00 0098-00847047 8/7/2018

Tax Collector Scott Randolph

This local Business Tax Receipt is in addition to and not in lieu of any other tax required by law or municipal ordinance. Businesses are subject to regulation of zoning, health and other lawful authorities. This receipt is valid from October 1 through September 30 of receipt year. Delinquent penalty is added October 1.

Local Business Tax Receipt

Orange County, Florida

5000 BUSINESS OFFICE 2018 \$30.00 4 EMPLOYEES : 1801 CERT GENERAL CONTR \$30.00 5000-1164380 1 EMPLOYEE :

EXPIRES 9/30/2019

TOTAL TAX \$80.00
PREVIOUSLY PAID \$60.00
TOTAL DUE \$20.00

MELLICK JARED LEE

RENEWAL BY ANDERSEN OF CENTRAL FLORIDA
MELLICK JARED LEE
997 W KENNEDY BLVD#1800
ORLANDO FL 32810



PAID: \$60.00 0098-00847047 8/7/2018

997 W KENNEDY BLVD #1800
J - EATONVILLE, 32810

This receipt is official when validated by the Tax Collector.