



City of Belle Isle Job Site Card Window/Door PERMIT 2019-08-007

PERMIT MUST BE POSTED ON SITE - A permit expires in 6 months if approved inspections are not recorded /schedule within that time frame. **You are responsible for scheduling and keeping track of all inspections.**

Permit Number: 2019- 08-007

Issue Date: 08/01/2019

Site Address: 1517 Perkins Rd 32809

Parcel #: 25-23-29-5884-22-210

Class: Residential **Subdivision:**

Description of Work: Replace 17 **Window (s)** / Size for Size

Issued: Window World
Name: Tillman, Michael

Business Phone: 47 389-1400
Contractor License #: CGC1514205

Payment Date & Method: 8 / 1 / 2019 Picked up or sent by _____ Emailed
 Visa Master Card Amex Discover Check / Money Order # 11011

Schedule Inspections via Email at: BDscheduling@universalengineering.com
SCHEDULE INSPECTIONS BY 3:00 PM CUT OFF TIME
Inspection Results Will Be Sent Out the Following Business Day

"WARNING TO OWNER: YOUR FAILURE TO RECORD A NOTICE OF COMMENCEMENT MAY RESULT IN YOUR PAYING TWICE FOR IMPROVEMENTS TO YOUR PROPERTY. IF YOU INTEND TO OBTAIN FINANCING, CONSULT WITH YOUR LENDER OR AN ATTORNEY BEFORE RECORDING YOUR NOTICE OF COMMENCEMENT."

BUILDING	INSPECTOR	DATE	COMMENTS
900 In Progress			
910 Final			

Inspection requests are to be emailed to BDscheduling@UniversalEngineering.com; a confirmation email will be sent back to you upon scheduling. Next-Day Inspection requests must be made by 3pm. Please include the following in your request: Permit #, project address, type of inspection, date of the requested inspection, a contact name & a contact phone number. AM or PM may be requested but cannot be guaranteed. Inspection results will be sent out the following business day. A permit expires in 6 months if approved inspections are not recorded /scheduled within that time frame. You are responsible for scheduling and keeping track of all your inspections –

Universal Engineering Sciences - 3532 Maggie Blvd., Orlando, FL 32811
Tel 407-581-8161 * Fax 407-581-0313 * www.universalengineering.com



City of Belle Isle

Universal Engineering Sciences 3532 Maggie Blvd., Orlando, FL 32811
Tel 407-581-8161 * Fax 407-581-0313 * www.universalengineering.com

RECEIVED
AUG 01 2019

Building Permit (Land Use) Application

DATE: 7/29/19

PERMIT # 2019-08-007

PROJECT ADDRESS: 1577 Perkins Rd

Belle Isle, FL 32809 32812

PROPERTY OWNER: Raymond Maynard PHONE: 321-624-1157

VALUE OF WORK (labor & material) \$ 9765.92

PLEASE LIST THE NATURE OF YOUR PROPOSED IMPROVEMENTS

replace 17 windows size for size

Please provide information, if applicable.

- Survey specific foundation plan required to show compliance with zoning setbacks
- **BOAT DOCK:** DEP Clearance Required with Application (Call 407-897-4100); please provide a copy of their report
- **SEPTIC SYSTEM (RESIDENTIAL):** - Provide verification of OC Health Dept approval for on-site septic tank system, per FAC Chap. 64E-6
- Homeowners will be required to have a contractor on record for homes that are rented and/or not homestead

Please Complete for the City of Belle Isle Zoning Review: Parcel Id Number: 25-23-29-5884-27-210

To obtain this information, please visit <http://www.ocpal.org/Searches/ParcelSearch.aspx>

SPECIAL CONDITIONS: STRUCTURES MAY NOT ENCR OACH INTO ANY EASEMENT OR REQUIRED SETBACK. Note, this Zoning Approval MAY or MAY NOT be in conflict with your Deed Restrictions. For New Single Family Residence, a Traffic Impact Fee and School Impact will be assessed.

Wind Exposure Category: B C D

Attached Survey SETS and Construction Plans SETS

PLANNING & ZONING APPROVAL: _____
DATE _____

PLEASE COMPLETE for Building Review

CONSTRUCTION TYPE _____
 OCCUPANCY GROUP Comm Res: Single Fam Multi Fam
 #BLDG. _____ #UNITS _____ #STORIES _____ **TOTAL SQ.FT.** _____
 MAX. FLOOR LOAD _____ MAX. OCCUPANCY _____
 MIN. FLOOD ELEV. _____ LOW FLOOR ELEV. _____
 WATER SERVICE _____ WELL _____ SEPTIC _____

REVIEW	Date: Sent	RCD
ZONING	Y <input checked="" type="checkbox"/> N <input type="checkbox"/>	\$ _____
CERT OF OCC	Y <input type="checkbox"/> N <input type="checkbox"/>	\$ _____
TRAFFIC	Y <input type="checkbox"/> N <input type="checkbox"/>	\$ _____
SCHOOL	Y <input type="checkbox"/> N <input type="checkbox"/>	\$ _____
FIRE	Y <input type="checkbox"/> N <input type="checkbox"/>	\$ _____
SWIMMING POOL	Y <input type="checkbox"/> N <input type="checkbox"/>	\$ _____
SCREEN ENCLOSURE	Y <input type="checkbox"/> N <input type="checkbox"/>	\$ _____
ROOFING	Y <input type="checkbox"/> N <input type="checkbox"/>	\$ _____
BOAT DOCK	Y <input type="checkbox"/> N <input type="checkbox"/>	\$ _____
BUILDING	Y <input checked="" type="checkbox"/> N <input type="checkbox"/>	\$ _____
WINDOW(S)	Y <input checked="" type="checkbox"/> N <input type="checkbox"/>	\$ <u>91.50</u>
DOOR(S)	Y <input type="checkbox"/> N <input type="checkbox"/>	\$ _____
FENCE	Y <input type="checkbox"/> N <input type="checkbox"/>	\$ _____
SHED	Y <input type="checkbox"/> N <input type="checkbox"/>	\$ _____
DRIVEWAY	Y <input type="checkbox"/> N <input type="checkbox"/>	\$ _____
OTHER	Y <input type="checkbox"/> N <input type="checkbox"/>	\$ _____

BUILDING REVIEWER: (Signature) DATE: 8-1-19

VERIFIED CONTRACTOR'S LICENSE & INSURANCE ARE ON FILE (Signature) DATE: 8-1-19

Per FSS 105.3.3:

An enforcing authority may not issue a building permit for any building construction, erection, alteration, modification, repair or addition unless the permit either includes on its face or there is attached to the permit the following statement: "NOTICE: In addition to the requirements of this permit, there may be additional restrictions applicable to this property that may be found in the public records of this county, and there may be additional permits required from other governmental entities such as water management districts, state agencies, or federal agencies."

Republic Services is by legal contract the sole authorized provider of garbage, recycling, yard waste, and commercial garbage and construction debris collection and disposal services with the city limits of the City. Contractors, homeowners and commercial businesses may contact Republic Services at 407-293-8000 to setup accounts for Commercial, Construction Roll Off, or other services needed. Rates are fixed by contract and are available at City Hall or from Republic Services. The City enforces the contract through its code enforcement office. Failure to comply will result in a stop work order.

SEPARATE PERMITS ARE REQUIRED FOR ROOFING, ELECTRICAL, PLUMBING, GAS, MECHANICAL, SIGNS, POOLS, ENCLOSURES, ETC.

1571K
25
36
61.2
30.50
91.50

3% FL SURCHARGE 2 min / 2 min
TOTAL 95.50

By Owner Form Y NA
 Notice of Commencement Y NA
 Power of Attorney Y NA
 Contractor Packet Included? Y N

OTHER PERMITS REQUIRED:
 ELECTRICAL Y NA
 PREPOWER Y NA
 MECHANICAL Y NA
 PLUMBING Y NA
 ROOFING Y NA
 GAS Y NA

PAID
8-7-19
Arey 11/01/19



City of Belle Isle
 Universal Engineering Sciences 3532 Maggie Blvd., Orlando, FL 32811
 Tel 407-581-8161 * Fax 407-581-0313 * www.universalengineering.com

Building Permit (Land Use) Application

To be completed as required by State Statute Section 713 and other applicable sections.

Owner's Name Raymond Maynard
 Owner's Address 1577 Perkins Rd

PERMIT # 2019-08-07

Contractor Name <u>Window World</u>	Company Name <u>Michael Tillma</u>
License # <u>CGC1574205</u>	Company Address <u>3882 Centerlap</u>
Contact Phone/Cell <u>407-389-1400</u>	City, State, ZIP <u>Orlando FL 32805</u>
Contact Email <u>Jennifer@windowworld.com</u>	Contact Fax <u>407-389-1402</u>

WARNING TO OWNER: Your failure to record a Notice of Commencement may result in your paying twice for improvements to your property. A notice of commencement must be recorded if job is \$2500(+) or if A/C Replacement \$7500(+) and posted on the job site before the first inspection. If you intend to obtain financing, consult with your lender or an attorney before recording your Notice of Commencement.

I hereby make Application for Permit as outlined above, and if same is granted I agree to conform to all Division of Building Safety Regulations (www.floridabuilding.org) and City Ordinances (www.municode.com) regulating same and in accordance with plans submitted. The issuance of this permit does not grant permission to violate any applicable City and/or State of Florida codes and/or ordinances. Application is hereby made to obtain a permit to do the work and installations as indicated. I certify that no work or installation has commenced prior to the issuance of a permit and that all work will be performed to meet the standards of all laws regulating construction in this jurisdiction. I understand that a separate permit must be secured for all other construction including ROOFING, ELECTRICAL, MECHANICAL, PLUMBING, GAS, SIGNS, POOLS, SCREEN ENCLOSURES, ETC.

OWNER'S AFFIDAVIT: I certify that all the foregoing information is accurate and that all work will be done in compliance with all applicable laws regulating construction and zoning.

Owner Signature Raymond Maynard
 The foregoing instrument was acknowledged before me this 7/15/19
 by Raymond Maynard who is personally known to me
 and who produced [Signature]
 as identification and who did not take an oath.
 Notary as to Owner
 State of Florida
 County of Orange

Contractor Signature Michael Tillma
 COMPANY NAME Window World
 The foregoing instrument was acknowledged before me this 7/29/19
 by Michael Tillma who is personally known to me
 and who produced [Signature]
 as identification and who did not take an oath.
 Notary as to Owner
 State of Florida
 County of Orange

Impervious Surface Ratio Worksheet
 Development Zoned A-1, A-2, R-1-AAA, R-1-AA, R-1-A, R-1 per City Code, Section 50-74: Impervious Surface Ratio

- Total Lot Area (sqft) X 0.35 = Allowable Impervious Area (BASE).
 Total Lot Area _____ X 0.35 =
 Allowable Impervious Area (BASE) _____
- Calculate the "proposed" impervious area on the lot. This includes the sum of all areas that do not allow direct percolation of rainwater. Examples include house, pool, deck, driveway, accessory building, etc.
 - House _____
 - Driveway _____
 - Walkway _____
 - Accessory Buildings _____
 - Pool & Spa _____
 - Deck & Patio _____
 - Other _____
 Actual Impervious Area (AIA) _____
- If AIA is less than BASE, subtract AIA from BASE to determine the amount of impervious area that may be added without providing onsite retention.
- If AIA is greater than BASE, then onsite retention **must be provided**.

Assuming 7.5 inches of rainfall based on a 24hr 10 year Rain Event (TP40), the formula is: (7.5 inches rainfall/12 inches p/foot) X (result from line 4) = cubic feet of storage volume needed

Permit Number 2019-08-007
 Folio/Parcel ID #: 25-23-29-5884-22-210
 Prepared by: _____

 Return to: Window World
3582 Center Loop
Orlando FL 32808

DOCH 20190473068
 07/31/2019 01:48:54 PM Page 1 of 1
 Rec Fee: \$10.00
 Phil Diamond, Comptroller
 Orange County, FL
 IP - Ret To: WINDOW WORLD OF CENTRAL F



NOTICE OF COMMENCEMENT

State of Florida, County of Orange
 The undersigned hereby gives notice that improvement will be made to certain real property, and in accordance with Chapter 713, Florida Statutes, the following information is provided in this Notice of Commencement.

- Description of property** (legal description of the property, and street address if available)
4th hole miss lots 2122 B&V
- General description of improvement**
Window replacement
- Owner information or Lessee information if the Lessee contracted for the improvement**
 Name Raymond Roberts Maynard
 Address 157 Pelican Rd. Orlando, FL 32805
 Interest in Property _____
 Name and address of fee simple titleholder (if different from Owner listed above)
 Name _____
 Address _____
- Contractor**
 Name Window World Telephone Number 407-389-1400
 Address 3582 Center Loop Orlando, FL 32808
- Surety** (if applicable, a copy of the payment bond is attached)
 Name _____ Telephone Number _____
 Address _____ Amount of Bond \$ _____
- Lender**
 Name _____ Telephone Number _____
 Address _____
- Persons within the State of Florida designated by Owner upon whom notices or other documents may be served as provided by §713.13(1)(a)7, Florida Statutes.**
 Name _____ Telephone Number _____
 Address _____
- In addition to himself or herself, Owner designates the following to receive a copy of the Lienor's Notice as provided in §713.13(1)(b), Florida Statutes.**
 Name _____ Telephone Number _____
 Address _____
- Expiration date of notice of commencement** (the expiration date will be 1 year from the date of recording unless a different date is specified) _____

WARNING TO OWNER: ANY PAYMENTS MADE BY THE OWNER AFTER THE EXPIRATION OF THE NOTICE OF COMMENCEMENT ARE CONSIDERED IMPROPER PAYMENTS UNDER CHAPTER 713, PART I, SECTION 713.13, FLORIDA STATUTES, AND CAN RESULT IN YOUR PAYING TWICE FOR IMPROVEMENTS TO YOUR PROPERTY. A NOTICE OF COMMENCEMENT MUST BE RECORDED AND POSTED ON THE JOB SITE BEFORE THE FIRST INSPECTION. IF YOU INTEND TO OBTAIN FINANCING, CONSULT WITH YOUR LENDER OR AN ATTORNEY BEFORE COMMENCING WORK OR RECORDING YOUR NOTICE OF COMMENCEMENT.

Ray B. Maynard
 Signature of Owner or Lessee, or Owner's or Lessee's Authorized Officer/Director/Partner/Manager

 Signatory's Title/Office _____

FDL# _____
 MS63-722-43-442-0
 expires 12-02-24
 The foregoing instrument was acknowledged before me this 15 day of July 2019 by Raymond Maynard

 as _____ for _____
 Type of authority, e.g., officer, trustee, attorney in fact _____ Name of party on behalf of whom instrument was executed _____

[Signature]
 Signature of Notary Public - State of Florida

[Signature]
 Print, type, or stamp commissioned name of Notary Public

Personally Known _____ OR Produced ID _____
 Type of ID Produced _____



Form content revised: 01/23/14

State of FLORIDA, County of ORANGE
 I hereby certify that this is a true copy of the document as reflected in the Official Records
 PHIL DIAMOND, COUNTY COMPTROLLER
 BY: [Signature], D.C.
 DATED: 7/31/19





CITY OF BELLE ISLE, FLORIDA
Universal Engineering Sciences 3532 Maggie Blvd., Orlando, FL 32811
Tel 407-581-8161 * Fax 407-581-0313 * www.universalengineering.com

POWER OF ATTORNEY

Date: 07/29/19

Permit #: 209-08-007

I hereby name and appoint JORGE TORRES of
(print name)

WINDOW WORLD to be my lawful attorney-in-fact to act for
(company name)

me and apply to the City of Belle Isle Building Department for a WINDOW permit
(type of permit)

for work to be performed at the following location:

1517 PERKINS ROAD, Belle Isle, FL 32809 32812 and
(street address)

to sign my name and do all things necessary to this appointment.

Certified Contractor's Printed Name: MICHAEL TILLMAN

License Number: CGC1514205

Certified Contractor's Signature: _____

The foregoing instrument was acknowledged before me this 29 days of July of 2019

by Michael Tillman who is personally known to me or who produced

_____ as identification and who did not take an oath.

State of Florida
County of Orange
[Signature]
Notary Public, Orange County, Florida



(seal)

3882 Center Loop
Orlando, FL 32808
(407) 389-1400 • (407) 389-1402 Fax
windowworldorlando.com

2298 US Highway 1
Rockledge, Florida 32955
(321) 637-1533 • (321) 637-1518 Fax
windowworldofspacecoast.com



1-800-NEXT-WINDOW
windowworldorlando.com / CGC 1514205

906 North US 1
Ormond Beach, Florida 32174
(386) 763-1402 • (386) 310-8046 Fax
windowworldvolusia.com

4105 Highway 297A
Cantonment, Florida 32533
(850) 484-9998 • (850) 484-9914 Fax
windowworldorlando.com

Name: Raymond Maynard Phone (H): 321-624-1151
Install Address: 1517 Perkins Road Phone (W): _____
City, State, Zip: Belle Isle FL 32809 Email: _____

DOUBLE HUNG <u>17</u> Series 4000 DH Insulated 101UI \$ 189 <u>3213</u> Series 4000 DH Insulated 102-114UI \$ 240 Series 4000 DH Insulated over 114UI \$ 340 Series 6000 DH Insulated 114UI \$ 275 Series 6000 DH Insulated over 114UI \$ 375		FIXED GLASS Series 4000 Pic Insulated > 101UI \$ 349 Series 4000 Pic Insulated > 102 - 120 UI \$ 389 Series 4000 Pic Insulated > 120 + \$ 559	
SLIDING 2 Lite Slider Insulated < 90 UI \$ 349 2 Lite Slider Insulated > 90 UI \$ 519 3 Lite Slider Insulated < 121 UI \$ 649 3 Lite Slider Insulated > 121 UI \$ 899		SPECIALTY (.85 Multiplier) <u>Buck inspection & 11-openings @ 69 ea = 759</u>	
IMPACT WINDOWS / DOORS Double - Hung \$ 2 & 3 lite slider \$ Fixed Glass \$ Sliding Patio Door \$			
OPTIONS <u>17</u> Half Screens \$ 39 <u>3634</u> Full Screens \$ 59 <u>17</u> Solar Zone Elite Low-E Glass/Argon \$ 149 <u>2533</u> Tint Gray/Bronze \$ 69 Flat Colonial Grids \$ 89 Contoured Colonial Grids \$ 99 Beige Color \$ 89 Wood Grain, Interior (4000 or 6000) \$ 129 Architectural Exterior Color \$ 199		PATIO DOORS 3" Contemporary 5" Classic 7" French Vinyl Sliding Patio Door 5' x 6' 8" \$ 979 Vinyl Sliding Patio Door 6' x 6' 8" \$ 1089 Vinyl Sliding Patio Door 8' x 6' 8" \$ 1249 Vinyl Sliding Patio Door 9' x 6' 8" \$ 1609 Vinyl Sliding Patio Door 12' x 6' 8" \$ 2169 Vinyl Sliding Patio Door 5' x 8' \$ 1389 Vinyl Sliding Patio Door 6' x 8' \$ 1649 Vinyl Sliding Patio Door 8' x 8' \$ 2398 Vinyl Sliding Patio Door 9' x 8' \$ 2719 Vinyl Sliding Patio Door 12' x 8' \$ 3139 Sliding Door Screen \$ 169 Colonial Grids \$ 209 Solar Zone Elite Low-E / Argon \$ 339 Removal & Install \$ 389 Custom Exterior Trim \$ 179 Beige Color \$ 289 Architectural Exterior Color (6'-9') \$ 759 Specialty Sliding Door Blinds 5' - \$675 6' - \$850 8' - \$975 9' - \$1225 12' - \$1500	
MISCELLANEOUS J Channel Application \$ 89 Custom Exterior Cap & Wrap \$ 119 <u>17</u> Removal/ Installation/ Trim Packs \$ 129 <u>2192</u> <u>4</u> Mull to Form Multi-Unit \$ 79 <u>314</u> <u>4</u> Tempered DH Sash (BSO) (TSO) \$ 59 <u>236</u> Tempered (Fixed Units) \$ 12/Sq. Ft. <u>2</u> Obscured Glass \$ 69 <u>138</u> Engineering Fee \$ 589 DP50 High Performance upgrade \$ 65 60/40 Oriel Style \$ 69 Stucco Cut Outs \$30 per opening 2nd Story Install \$30 p/window/ \$125 p/door			

Customer agrees to make themselves available to the city and/or county inspectors for a final inspection

!! NO EXTRA WORK IF NOT IN WRITING !!
 ① 17-WINDOWS INSTALLED = \$9,450 before disposal fee & permit
 ② shed window \$ 506 extra
 ③ PROJECT MANAGER - LACTI-407-389-1400 ext: 100
 *Received plywood code _____

St. Jude's Donation \$ _____
 Other \$ _____
 Setup & Disposal Fee \$ ~~2,200~~ 29
 Permit & Fees \$ 329.00 ✓
 Total Amount \$ 9904 less 20%
 Custom Order Deposit 50% \$ 4852.96 - 198.08
 Balance Paid to Installer upon Completion \$ 4,852.96 9,705.92

CHECK RETURN FEE \$59
 Buyer agrees that he has read and understands all terms and conditions on front and back of this contract and agrees to every term and condition.
 Tony Foster 7-15-19 White Copy - Original
 Raymond 7-15-19 Yellow Copy - Customer

WINDOW MEASUREMENT ORDER FORM

Customer Name: RAYMOND MAYNARD	# OF STORIES : 1	MEASURED BY : TONY
TYPE OF CONSTRUCTION: BLOCK/STUCCO		DATE: 7-15-19
TYPE OF WINDOWS: ALUM		# WINDOWS: 17

SIZE (WXH)	MODEL	LEG	OBSCURED	TEMP	GRID	MULL	FS	RM LOC
1 36 7/8 x 36 3/8	3001							left bedroom
2 36 7/8 x 36 3/8	3001							left bedroom
3 35 x 23 1/2	3001		OF					left bath
4 34 1/8 x 36 1/8	3001							rear kitchen
5 35 1/2 x 37 1/8	3001		OF	TF				rear bath
6 72 5/8 x 36 7/8	3001					1		rear bedroom
7 35 1/2 x 36 7/8	3001							right bedroom
8 35 1/2 x 37	3001							right bedroom
9 72 7/8 x 37	3001					1		front bedroom
10 72 5/8 x 49 3/8	3001					1		front bedroom
11 143 3/4 x 61 1/2	3001					3		front living room
12								
13								
14								
15								
16								
17								
18								
19								
20								
21								
22								
23								
24								
25								
26								
27								
28								

DRAWING

SCREWED IN X STUCCO X BRICK

OTHER _____

INSTALLERS NOTES:

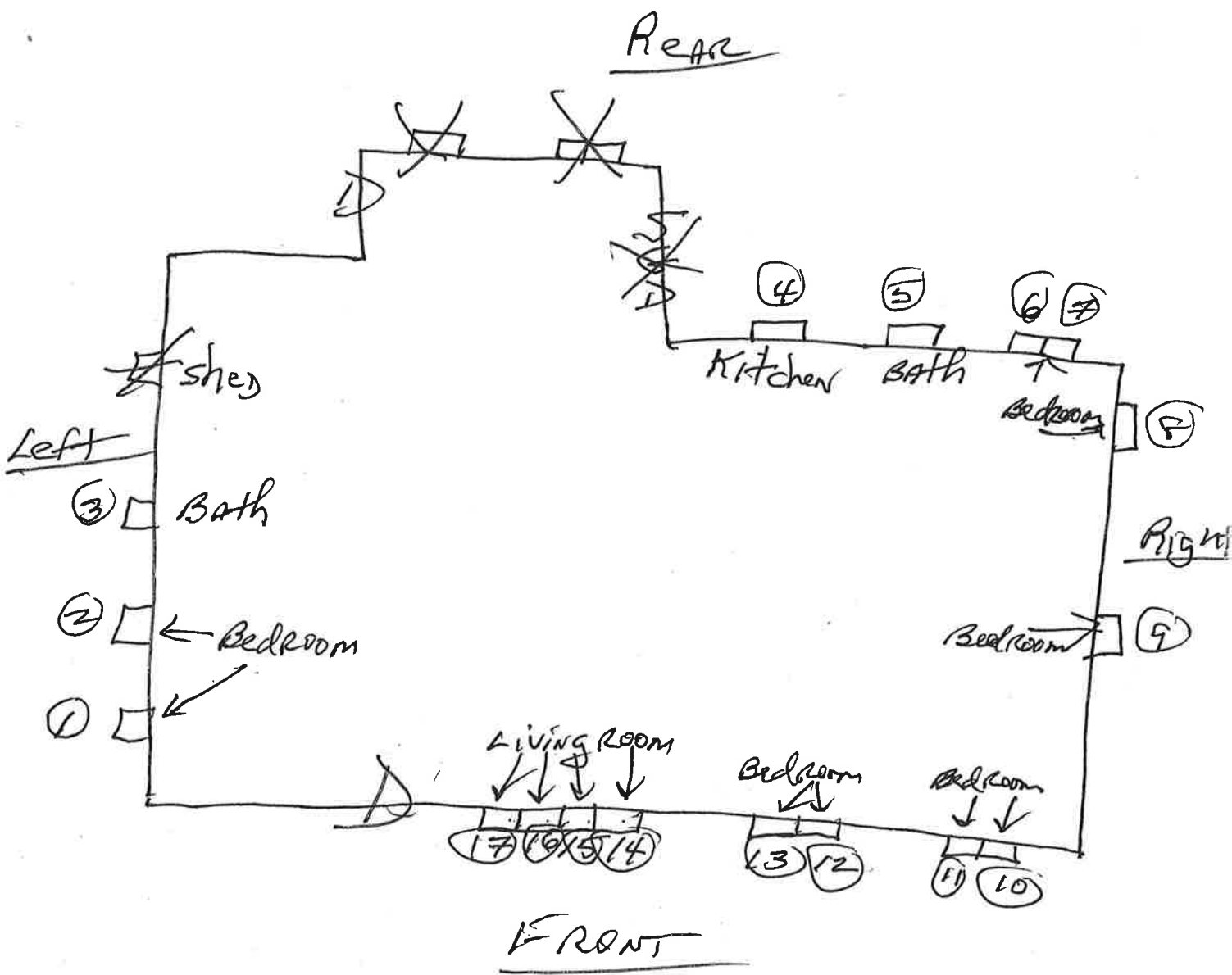

Raymond MAYNARD
 1517 Perkins Road
 Belle Isle, FL. 32809
 321-628-1151



Product Approval Form

DATE: 7-31-19

PERMIT # 2019-08-007

PROJECT ADDRESS 1517 Perkins Rd, Belle Isle, FL 32809 32812

As required by Florida Statue 553.842 and Florida Administrative Code 9B-72m, please provide the information and approval numbers of the building components listed below if they will be utilized on the building or structure. FL Approved products are listed online at www.floridabuilding.org or can be obtained from the local product supplier. The following information must be turned in with permit application and available onsite for inspections:

- NOTE: The Installation instructions must be posted on-site before your first inspection!!

Product Type	Manufacturer	Model/Series	FL Product Approval #	Product Type	Manufacturer	Model/Series	FL Product Approval #
EXTERIOR DOORS				WALL PANELS			
Swinging				Sliding			
Sliding				Soffits			
Sectional/Rollup				Storefront			
Other				Glass Block			
				Other			
WINDOWS				ROOFING PRODUCTS			
Single/DbI Hung	AME	3001	FI 11720.9	Asphalt Shingles			
Horizontal Slider				Non Struct Metal			
Casement				Roofing Tiles			
Fixed				Single Ply Roof	NA		
Mullion	AME	3100	FI-1208.1	Underlayment			
Skylights				Other			
Other							
STRUCTURAL COMPONENTS				OTHER			
Wood Connectors							
Wood Anchors							
Truss Plates							
Insulation Forms							
Lintels							
Other							

It is the applicant's responsibility to verify that specific products have been installed in accordance with their limitations and with the minimum required design pressures for the structure. Specific compliance will be verified during field inspections.

Applicant Signature 

Date 7-31-19



[BCIS Home](#) |
 [Log In](#) |
 [User Registration](#) |
 [Hot Topics](#) |
 [Submit Surcharge](#) |
 [Stats & Facts](#) |
 [Publications](#) |
 [FBC Staff](#) |
 [BCIS Site Map](#) |
 [Links](#) |
 [Search](#)



Product Approval
 USER: Public User

[Product Approval Menu](#) >
 [Product or Application Search](#) >
 [Application List](#) >
 Application Detail



FL #	FL12078-R6
Application Type	Revision
Code Version	2017
Application Status	Approved
Comments	
Archived	<input type="checkbox"/>
Product Manufacturer Address/Phone/Email	Associated Materials Inc. 3773 State Road Cuyahoga Falls, OH 44223 (330) 922-2108 rickw@rwbldgconsultants.com
Authorized Signature	Vivian Wright rickw@rwbldgconsultants.com
Technical Representative Address/Phone/Email	
Quality Assurance Representative Address/Phone/Email	
Category Subcategory	Windows Mullions
Compliance Method	Evaluation Report from a Florida Registered Architect or a Licensed Florida Professional Engineer <input type="checkbox"/> Evaluation Report - Hardcopy Received
Florida Engineer or Architect Name who developed the Evaluation Report	Lyndon F. Schmidt, P.E.
Florida License	PE-43409
Quality Assurance Entity	Architectural Testing, Inc.
Quality Assurance Contract Expiration Date	12/31/2020
Validated By	Ryan J. King, P.E. <input checked="" type="checkbox"/> Validation Checklist - Hardcopy Received
Certificate of Independence	FL12078_R6_COI (a) Certificate of Independence.pdf
Referenced Standard and Year (of Standard)	
Equivalence of Product Standards Certified By	
Sections from the Code	1709.9
Product Approval Method	Method 2 Option B

Date Submitted 07/29/2017
 Date Validated 07/31/2017
 Date Pending FBC Approval 08/02/2017
 Date Approved 10/10/2017

Summary of Products

FL #	Model, Number or Name	Description
12078.1	a. 3100 Structural Mullion	Extruded Aluminum Clipped Mullion for use on Masonry or Wood Openings utilizing the Goal Post (at head and sill) Style Mounting Bracket
Limits of Use Approved for use in HVHZ: No Approved for use outside HVHZ: Yes Impact Resistant: Yes Design Pressure: N/A Other: Mullion Design Pressure varies according to mullion window size. Refer to EVAL 12078.1 and INST 12078.1 for Mullion Design Pressure Ratings, any additional use limitations, installation instructions and product particulars.		Installation Instructions FL12078_R6_II (a) Inst 12078.1.pdf Verified By: Lyndon F. Schmidt, P.E. 43409 Created by Independent Third Party: Yes Evaluation Reports FL12078_R6_AE (a) Eval 12078.1.pdf Created by Independent Third Party: Yes
12078.2	b. 3100 Structural Mullion	Extruded Aluminum Clipped Mullion for use on Wood Openings utilizing the Goal Post (at Sill) and the Bull Nose (at head) Style Mounting Brackets
Limits of Use Approved for use in HVHZ: No Approved for use outside HVHZ: Yes Impact Resistant: Yes Design Pressure: N/A Other: Mullion Design Pressure varies according to mullion window size. Refer to EVAL 12078.2 and INST 12078.2 for Mullion Design Pressure Ratings, any additional use limitations, installation instructions and product particulars.		Installation Instructions FL12078_R6_II (a) Inst 12078.2.pdf Verified By: Lyndon F. Schmidt, P.E. 43409 Created by Independent Third Party: Yes Evaluation Reports FL12078_R6_AE (a) Eval 12078.2.pdf Created by Independent Third Party: Yes
12078.3	c. 3100 Structural Transom Mullion	Extruded Aluminum Clipped Mullion for use on Masonry or Wood Openings utilizing the Goal Post (at head and sill) Style Mounting Bracket
Limits of Use Approved for use in HVHZ: No Approved for use outside HVHZ: Yes Impact Resistant: Yes Design Pressure: N/A Other: Mullion Design Pressure varies according to mullion window size. Refer to EVAL 12078.3 and INST 12078.3 for Mullion Design Pressure Ratings, any additional use limitations, installation instructions and product particulars.		Installation Instructions FL12078_R6_II (a) Inst 12078.3.pdf Verified By: Lyndon F. Schmidt, P.E. 43409 Created by Independent Third Party: Yes Evaluation Reports FL12078_R6_AE (a) Eval 12078.3.pdf Created by Independent Third Party: Yes
12078.4	d. 3100 Structural Transom Mullion	Extruded Aluminum Clipped Mullion for use on Wood Openings utilizing the Goal Post (at Sill) and the Bull Nose (at head) Style Mounting Brackets
Limits of Use Approved for use in HVHZ: No Approved for use outside HVHZ: Yes Impact Resistant: Yes Design Pressure: N/A Other: Mullion Design Pressure varies according to mullion window size. Refer to EVAL 12078.4 and INST 12078.4 for Mullion Design Pressure Ratings, any additional use limitations, installation instructions and product particulars.		Installation Instructions FL12078_R6_II (a) Inst 12078.4.pdf Verified By: Lyndon F. Schmidt, P.E. 43409 Created by Independent Third Party: Yes Evaluation Reports FL12078_R6_AE (a) Eval 12078.4.pdf Created by Independent Third Party: Yes
12078.5	e. "I" Series Structural Mullion	Extruded Aluminum Clipped Mullion for use on Wood and Masonry Openings utilizing the Goal Post (at Head and Sill) Style Mounting Brackets
Limits of Use Approved for use in HVHZ: No Approved for use outside HVHZ: Yes Impact Resistant: Yes Design Pressure: N/A Other: Mullion Design Pressure varies according to mullion window size. Refer to EVAL 12078.5 and INST 12078.5 for Mullion Design Pressure Ratings, any additional use limitations, installation instructions and product particulars.		Installation Instructions FL12078_R6_II (a) Inst 12078.5.pdf Verified By: Lyndon F. Schmidt, P.E. 43409 Created by Independent Third Party: Yes Evaluation Reports FL12078_R6_AE (a) Eval 12078.5.pdf Created by Independent Third Party: Yes
12078.6	f. "I" Series Structural Transom Mullion	Extruded Aluminum Clipped Mullion for use on Wood and Masonry Openings utilizing the Goal Post Style Mounting Brackets

ASSOCIATED MATERIALS

3773 STATE ROAD
CUYAHOGA FALLS, OH 44223

3100 STRUCTURAL MULLION



GENERAL NOTES:

- This product has been evaluated and is in compliance with the 6th Edition (2017) Florida Building Code (FBC) excluding the "High Velocity Hurricane Zone" and conforms to the requirements of FBC Chapter 17.
- Wood bucks by others, must be anchored properly to transfer loads to the structure and be reviewed by the Building Official.
- Mullion anchor embedment to base material shall be beyond wall dressing or stucco.
- When used in areas requiring wind borne debris protection, this product does not require protection from an impact resistant covering when used in Wind Zones 1, 2 and 3 as defined by ASTM E 1996; in Wind Zone 4, as defined by ASTM E 1996, this product must be protected with an impact resistant covering complying with FBC Sections 1609.1.2 & R301.2.1.2.
- Separate product approvals for each glazing product used with these mullions must be submitted along with this mullion product approval.
- Anchoring of each glazing product to the mullion shall be as shown in each individual glazing product approval.
- Any conditions not covered in this evaluation are subject to separate engineering evaluation.
- Mullion Design Pressure Rating, see Load Rating Table Sheets 2 and 3 of this drawing.
- The design pressure rating of the assembly shall be the lesser of the load capacity of the mullion as determined using this approval or the design pressure rating of the individual glazing products used.
- Bounding box dimensions for geometric shapes must be equal to or less than the rectangular dimensions shown herein.

TABLE OF CONTENTS	
SHEET #	DESCRIPTION
1	TYPICAL ELEVATIONS & GENERAL NOTES
2	MULLION LOAD TABLE FOR WOOD SCREW ANCHORS
3	MULLION LOAD TABLE FOR CONCRETE SCREW ANCHORS
4	MULLION SECTION AND ANCHORING DETAILS

PROFESSIONAL ENGINEER
F. SCHMIDT
 No. 43409
 STATE OF FLORIDA
 License
 7-27-17

Documents Prepared By:
 Lyndon F. Schmidt
 P.E. No. 43409

BUILDING CONSULTANTS, INC.
 P.O. Box 230, Valrico, FL 33595
 Phone No.: 813.659.9197
 FBPE C.A. No. 8913

PRODUCT:	3100 STRUCTURAL MULLION	
TYPICAL ELEVATION AND GENERAL NOTES		
PART OR ASSEMBLY:		
REVISIONS		
NO.	DATE	BY
1	11/08/11	
2	3/03/15	
3	5/09/16	
4	7/27/17	

SCALE:	NTS
DATE:	12/11/08
DWG. BY:	DWS
CHK. BY:	LFS
DRAWING NO.:	FL-12078.1
SHEET	1 of 4

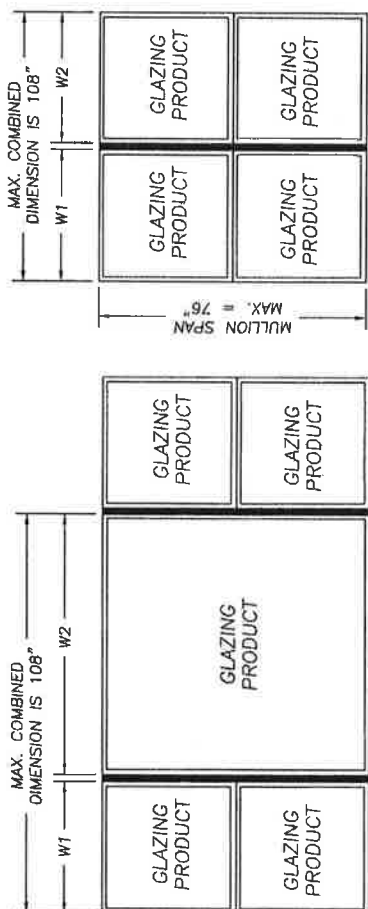
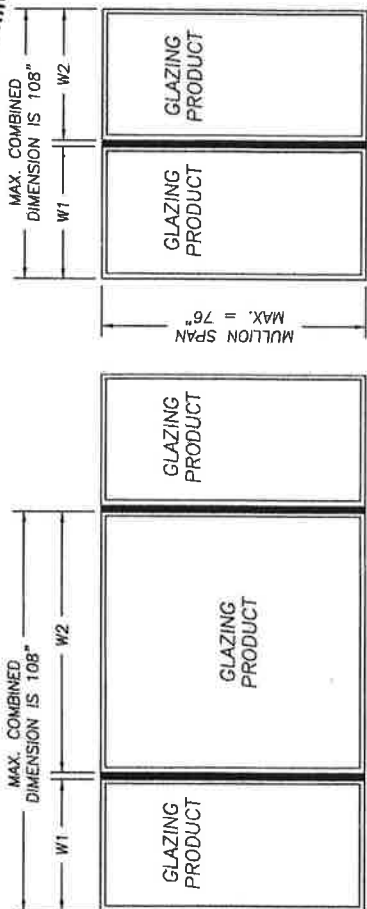

TYPICAL MULLION CONFIGURATIONS

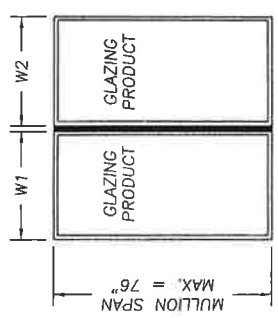

$$\text{TRIBUTARY WIDTH} = \frac{W1 + W2}{2}$$

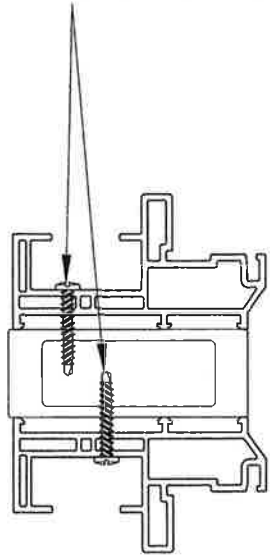
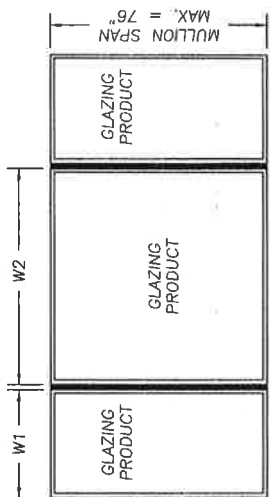

SECTION THRU MULLION & FRAME

3100 STRUCTURAL MULLION LOAD TABLE (PSF)

WOOD SCREW ANCHORS	TRIBUTARY WIDTH															
	28"	30"	32"	34"	36"	38"	40"	42"	44"	46"	48"	50"	54"			
76"	64.43	60.62	57.29	54.36	51.77	49.45	47.35	45.42	43.65	42.00	40.48	39.06	36.51			
72"	76.25	71.78	67.87	64.43	61.39	58.64	56.14	53.83	51.71	49.75	47.93	46.24	43.20			
70"	83.26	78.39	74.15	70.41	67.10	64.08	61.33	58.81	56.48	54.33	52.34	50.49	47.15			
68"	91.15	85.85	81.23	77.16	73.52	70.20	67.17	64.40	61.84	59.48	57.29	55.26	51.60			
66"	100.08	94.28	89.23	84.78	80.76	77.11	73.77	70.71	67.89	65.29	62.88	60.64	56.61			
64"	110.20	103.86	98.33	93.42	88.97	84.92	81.23	77.85	74.73	71.86	69.20	66.73	62.28			
62"	120.00	114.78	108.69	103.23	98.30	93.81	89.71	85.96	82.51	79.32	76.38	73.64	68.71			
60"	120.00	120.00	120.00	114.44	108.95	103.95	99.39	95.22	91.38	87.84	84.57	81.53	76.06			
58"	120.00	120.00	120.00	120.00	120.00	115.98	110.49	105.83	101.55	97.60	93.95	90.56	84.46			
56"	120.00	120.00	120.00	120.00	120.00	120.00	120.00	118.05	112.84	108.03	103.53	99.38	92.02			
54"	120.00	120.00	120.00	120.00	120.00	120.00	120.00	120.00	120.00	116.18	111.34	106.88	98.98			
52"	120.00	120.00	120.00	120.00	120.00	120.00	120.00	120.00	120.00	120.00	120.00	115.26	106.72			
50"	120.00	120.00	120.00	120.00	120.00	120.00	120.00	120.00	120.00	120.00	120.00	120.00	120.00			
48"	120.00	120.00	120.00	120.00	120.00	120.00	120.00	120.00	120.00	120.00	120.00	120.00	120.00			
46"	120.00	120.00	120.00	120.00	120.00	120.00	120.00	120.00	120.00	120.00	120.00	120.00	120.00			
44"	120.00	120.00	120.00	120.00	120.00	120.00	120.00	120.00	120.00	120.00	120.00	120.00	120.00			
42"	120.00	120.00	120.00	120.00	120.00	120.00	120.00	120.00	120.00	120.00	120.00	120.00	120.00			
40"	120.00	120.00	120.00	120.00	120.00	120.00	120.00	120.00	120.00	120.00	120.00	120.00	120.00			
38"	120.00	120.00	120.00	120.00	120.00	120.00	120.00	120.00	120.00	120.00	120.00	120.00	120.00			
36"	120.00	120.00	120.00	120.00	120.00	120.00	120.00	120.00	120.00	120.00	120.00	120.00	120.00			
34"	120.00	120.00	120.00	120.00	120.00	120.00	120.00	120.00	120.00	120.00	120.00	120.00	120.00			
32"	120.00	120.00	120.00	120.00	120.00	120.00	120.00	120.00	120.00	120.00	120.00	120.00	120.00			
30"	120.00	120.00	120.00	120.00	120.00	120.00	120.00	120.00	120.00	120.00	120.00	120.00	120.00			
28"	120.00	120.00	120.00	120.00	120.00	120.00	120.00	120.00	120.00	120.00	120.00	120.00	120.00			
26"	120.00	120.00	120.00	120.00	120.00	120.00	120.00	120.00	120.00	120.00	120.00	120.00	120.00			
24"	120.00	120.00	120.00	120.00	120.00	120.00	120.00	120.00	120.00	120.00	120.00	120.00	120.00			

INSTRUCTIONS FOR USE OF THE MULLION LOAD TABLE:

1. DETERMINE THE DESIGN LOAD REQUIREMENT FOR THE PARTICULAR OPENING AS SPECIFIED BY THE BUILDING DESIGNER (ARCHITECT OR ENGINEER OR RECORD).
2. FOR THE PARTICULAR OPENING, DETERMINE THE TRIBUTARY WIDTH AND MULLION SPAN. REFERENCE THE SKETCHES ON THIS SHEET FOR MULLION SPAN AND TRIBUTARY WIDTH DETERMINATION.
3. IN THE FIRST COLUMN OF THE TABLE, LOCATE THE MULLION SPAN. IN THE FIRST ROW OF THE TABLE, LOCATE THE TRIBUTARY WIDTH. AT THE INTERSECTION OF THE ROW CONTAINING THE MULLION SPAN AND THE COLUMN CONTAINING THE TRIBUTARY WIDTH, READ THE MULLION LOAD RATING GIVEN IN PSF. THE MULLION LOAD RATING MUST BE EQUAL TO OR GREATER THAN THE DESIGN LOAD REQUIREMENT DETERMINED IN STEP 1 ABOVE.

FOR ANCHORING GLAZING PRODUCTS TO THE MULLION, ANCHOR SIZE AND SPACING SHALL BE AS SPECIFIED IN ONE OF THE FOLLOWING:

1. SUBSTITUTE (1 FOR 1) 1/4"-14 SELF-DRILLING SCREWS FOR THE FASTENERS SHOWN IN THE INDIVIDUAL GLAZING PRODUCT APPROVAL.
2. SUBSTITUTE #8-18 PAN-HEAD SELF-DRILLING SCREWS FOR THE FASTENERS SHOWN IN THE INDIVIDUAL GLAZING PRODUCT APPROVAL. MAXIMUM FASTENER SPACING ALLOWED IS 6" FROM EACH END AND AT 15" O.C. MAX. SPACING.

NOTE: A MINIMUM OF 3 THREADS OF THE SELF-DRILLING SCREWS MUST PROTRUDE THROUGH THE WALL OF THE MULLION. THIS SECTION VIEW IS SHOWN FOR ILLUSTRATIVE PURPOSES; OTHER FRAME SECTIONS OF FLORIDA APPROVED WINDOWS BY ALSIDE WINDOWS CAN BE USED IN THIS FASHION.

L.F. SCHMIDT
No. 43409
STATE OF FLORIDA
PROFESSIONAL ENGINEER

2017 R.W. BUILDING CONSULTANTS INC.
BUILDING CONSULTANTS, INC.
P.O. Box 230, Vero Beach, FL 33595
Phone No.: 813.659.1917
FBPE C.A. No. 9813

DATE: 12/11/08
SCALE: NTS
DWG. BY: DWS
CHK. BY: LFS
DRAWING NO.: FL-12078.1
SHEET 2 OF 4

REVISIONS

NO.	DATE	DESCRIPTION
1	11/08/11	UPDATE TO 2010 FBC
2	3/03/15	UPDATE TO 5TH ED. (2014) FBC
3	5/09/16	ADD OFFSET ANCHOR BRACKET
4	7/27/17	UPDATE TO 6TH ED. (2017) FBC

PRODUCT: 3100 STRUCTURAL MULLION
PART OR ASSEMBLY: MULLION LOAD TABLE FOR WOOD SCREW ANCHORS

REVISIONS NO. DATE 1 11/08/11 UPDATE TO 2010 FBC 2 3/03/15 UPDATE TO 5TH ED. (2014) FBC 3 5/08/16 ADD OFFSET ANCHOR BRACKET 4 7/27/17 UPDATE TO 6TH ED. (2017) FBC		PART OR ASSEMBLY: 3100 STRUCTURAL MULLION
SCALE: NTS DWG. BY: DWS CHK. BY: LFS		DRAWING NO.: FL-1207B.1
DATE: 12/11/08		SHEET 4 OF 4

PRODUCT: 3100 STRUCTURAL MULLION
 Documents Prepared By: L.F. SCHMIDT
 License No. 43409
 LONDON F. SCHMIDT
 PROFESSIONAL ENGINEER
 LONDON, ONTARIO
 BUILDING CONSULTANTS, INC.
 P.O. Box 230, Vero Beach, FL 33595
 Phone No.: 813.659.9197
 FBPE C.A. No. 8813

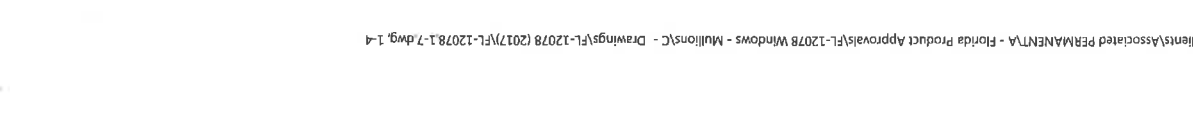
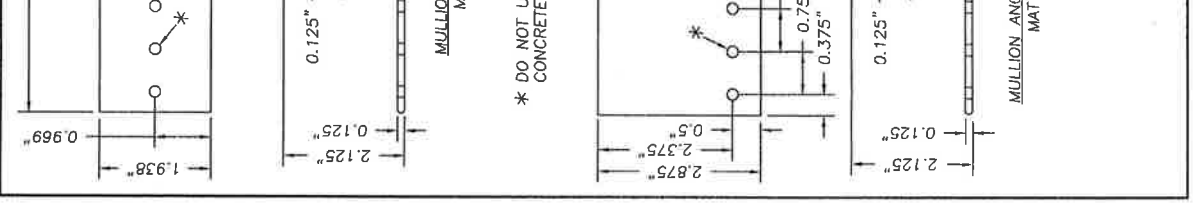
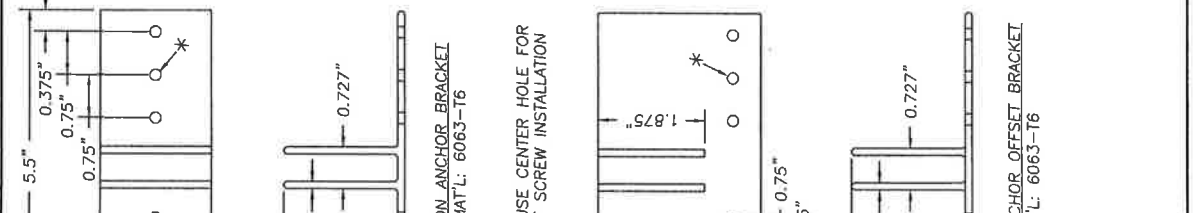
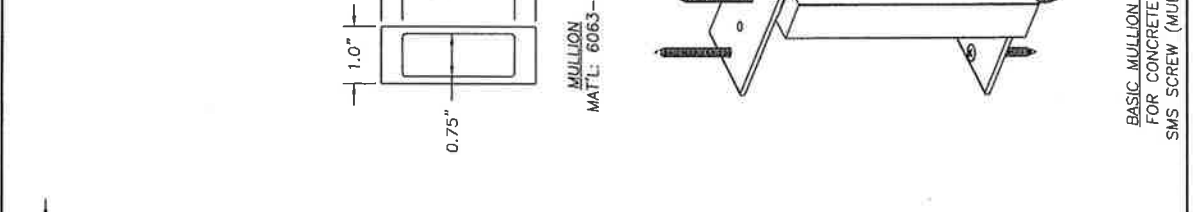
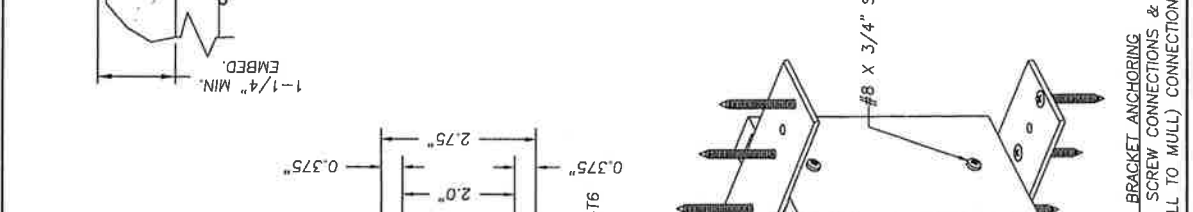
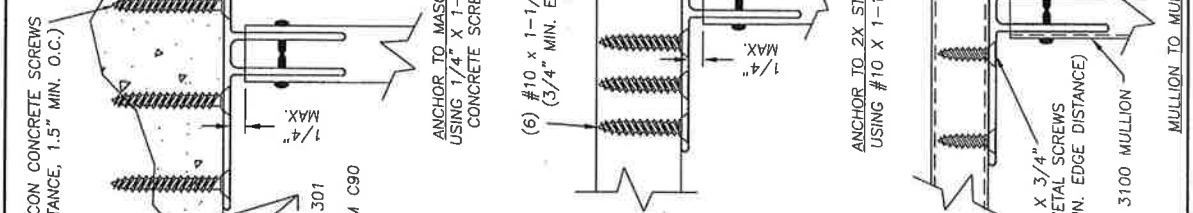
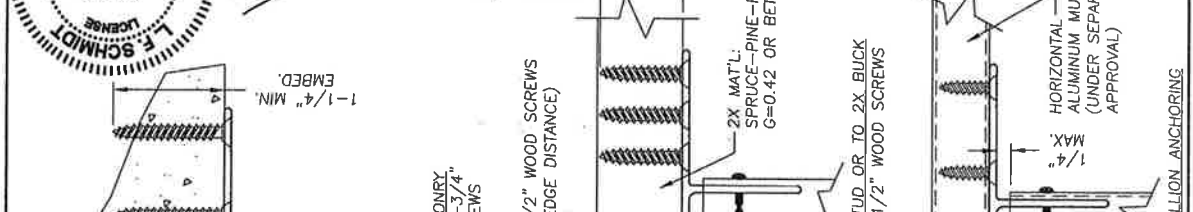

* DO NOT USE CENTER HOLE FOR CONCRETE SCREW INSTALLATION



[BCIS Home](#) |
 [Log In](#) |
 [User Registration](#) |
 [Hot Topics](#) |
 [Submit Surcharge](#) |
 [Stats & Facts](#) |
 [Publications](#) |
 [FBC Staff](#) |
 [BCIS Site Map](#) |
 [Links](#) |
 [Search](#)



Product Approval
USER: Public User

[Product Approval Menu](#) >
 [Product or Application Search](#) >
 [Application List](#) >
 [Application Detail](#)



FL #	FL11720-R16										
Application Type	Revision										
Code Version	2017										
Application Status	Approved										
Comments											
Archived	<input type="checkbox"/>										
Product Manufacturer Address/Phone/Email	Associated Materials Inc. 3773 State Road Cuyahoga Falls, OH 44223 (330) 922-2108 rickw@rwblgdconsultants.com										
Authorized Signature	Vivian Wright rickw@rwblgdconsultants.com										
Technical Representative Address/Phone/Email											
Quality Assurance Representative Address/Phone/Email											
Category Subcategory	Windows Double Hung										
Compliance Method	Evaluation Report from a Florida Registered Architect or a Licensed Florida Professional Engineer <input type="checkbox"/> Evaluation Report - Hardcopy Received										
Florida Engineer or Architect Name who developed the Evaluation Report	Lyndon F. Schmidt, P.E.										
Florida License	PE-43409										
Quality Assurance Entity	Architectural Testing, Inc.										
Quality Assurance Contract Expiration Date	12/31/2020										
Validated By	Ryan J. King, P.E. <input checked="" type="checkbox"/> Validation Checklist - Hardcopy Received										
Certificate of Independence	FL11720_R16_COI (a) Cert of Independence.pdf										
Referenced Standard and Year (of Standard)	<table border="0"> <thead> <tr> <th>Standard</th> <th>Year</th> </tr> </thead> <tbody> <tr> <td>ANSI/AAMA/NWWDA 101/I.S.2/A440</td> <td>2008</td> </tr> <tr> <td>ANSI/AAMA/NWWDA 101/I.S.2/A440</td> <td>2011</td> </tr> <tr> <td>ASTM E1886</td> <td>2005</td> </tr> <tr> <td>ASTM E1996</td> <td>2005</td> </tr> </tbody> </table>	Standard	Year	ANSI/AAMA/NWWDA 101/I.S.2/A440	2008	ANSI/AAMA/NWWDA 101/I.S.2/A440	2011	ASTM E1886	2005	ASTM E1996	2005
Standard	Year										
ANSI/AAMA/NWWDA 101/I.S.2/A440	2008										
ANSI/AAMA/NWWDA 101/I.S.2/A440	2011										
ASTM E1886	2005										
ASTM E1996	2005										
Equivalence of Product Standards Certified By											
Sections from the Code											

<p>Approved for use outside HVHZ: Yes Impact Resistant: No Design Pressure: N/A Other: See INST 11720.7 for Design Pressure Ratings, any additional use limitations, installation instructions and product particulars.</p>		<p>Verified By: Lyndon F. Schmidt, P.E. 43409 Created by Independent Third Party: Yes Evaluation Reports FL11720_R16_AE (a) EVAL 11720.7.pdf Created by Independent Third Party: Yes</p>
11720.8	h. Model "I" 201 / "I" 201HP	Extruded Vinyl "Tilt" Double Hung Window - "Impact"
<p>Limits of Use Approved for use in HVHZ: No Approved for use outside HVHZ: Yes Impact Resistant: Yes Design Pressure: N/A Other: See INST 11720.8 for Design Pressure Ratings, any additional use limitations, installation instructions and product particulars.</p>		<p>Installation Instructions FL11720_R16_II (b) INST 11720.8.pdf Verified By: Lyndon F. Schmidt, P.E. 43409 Created by Independent Third Party: Yes Evaluation Reports FL11720_R16_AE (c) Eval 11720.8.pdf Created by Independent Third Party: Yes</p>
11720.9	i. Model 3001 / 3B01 / 3A01 / 3AB1 "ST"	Extruded Vinyl Double Hung "Replacement" Window - "Non-Impact"
<p>Limits of Use Approved for use in HVHZ: No Approved for use outside HVHZ: Yes Impact Resistant: No Design Pressure: N/A Other: See INST 11720.9 for Design Pressure Ratings, any additional use limitations, installation instructions and product particulars.</p>		<p>Installation Instructions FL11720_R16_II (a) INST 11720.9.pdf Verified By: Lyndon F. Schmidt, P.E. 43409 Created by Independent Third Party: Yes Evaluation Reports FL11720_R16_AE (a) EVAL 11720.9.pdf Created by Independent Third Party: Yes</p>
11720.10	j. Model 3001 / 3A01 "ST"	Extruded Vinyl Double Hung "New Construction" (Wall Fin) Window - "Non-Impact"
<p>Limits of Use Approved for use in HVHZ: No Approved for use outside HVHZ: Yes Impact Resistant: No Design Pressure: N/A Other: See INST 11720.10 for Design Pressure Ratings, any additional use limitations, installation instructions and product particulars.</p>		<p>Installation Instructions FL11720_R16_II (a) INST 11720.10.pdf Verified By: Lyndon F. Schmidt, P.E. 43409 Created by Independent Third Party: Yes Evaluation Reports FL11720_R16_AE (a) EVAL 11720.10.pdf Created by Independent Third Party: Yes</p>
11720.11	k. Model "I" 301 / "I" 301HP	Extruded Vinyl "Tilt" Double Hung Window - "Non-Impact"
<p>Limits of Use Approved for use in HVHZ: No Approved for use outside HVHZ: Yes Impact Resistant: No Design Pressure: N/A Other: See INST 11720.11 for Design Pressure Ratings, any additional use limitations, installation instructions and product particulars.</p>		<p>Installation Instructions FL11720_R16_II (a) INST 11720.11.pdf Verified By: Lyndon F. Schmidt, P.E. 43409 Created by Independent Third Party: Yes Evaluation Reports FL11720_R16_AE (a) EVAL 11720.11.pdf Created by Independent Third Party: Yes</p>
11720.12	l. Model "I" 301 / "I" 301HP	Extruded Vinyl Double Hung Window with Nail Fin - "Impact"
<p>Limits of Use Approved for use in HVHZ: No Approved for use outside HVHZ: Yes Impact Resistant: Yes Design Pressure: N/A Other: See INST 11720.12 for Design Pressure Ratings, any additional use limitations, installation instructions and product particulars.</p>		<p>Installation Instructions FL11720_R16_II (b) INST 11720.12.pdf Verified By: Lyndon F. Schmidt, P.E. 43409 Created by Independent Third Party: Yes Evaluation Reports FL11720_R16_AE (c) Eval 11720.12.pdf Created by Independent Third Party: Yes</p>
11720.13	m. Model 8001 HP	Extruded Vinyl Double Hung Window - "Non-Impact"
<p>Limits of Use Approved for use in HVHZ: No Approved for use outside HVHZ: Yes Impact Resistant: No Design Pressure: N/A Other: See INST 11720.13 for Design Pressure Ratings, any additional use limitations, installation instructions and product particulars.</p>		<p>Installation Instructions FL11720_R16_II (a) INST 11720.13.pdf Verified By: Lyndon F. Schmidt, P.E. 43409 Created by Independent Third Party: Yes Evaluation Reports FL11720_R16_AE (a) EVAL 11720.13.pdf Created by Independent Third Party: Yes</p>

[Back](#) [Next](#)

Contact Us :: 2401 Blair Stone Road, Tallahassee FL 32309 Phone: 850-487-1824

The State of Florida is an AA/EEO employer. Copyright 2007-2013 State of Florida. :: [Privacy Statement](#) :: [Accessibility Statement](#) :: [Refund Statement](#)

Under Florida law, email addresses are public records. If you do not want your e-mail address released in response to a public-records request, do not send electronic mail to this entity. Instead, contact the office by phone or by traditional mail. If you have any questions, please contact 850.487.1395. *Pursuant to

ASSOCIATED MATERIALS
 A I N C O R P O R A T E D
 3773 STATE ROAD
 CUYAHOGA FALLS, OH 44223

**MODEL 3001/3B01/3A01/3AB1 "ST"
 EXTRUDED VINYL
 DOUBLE HUNG "Replacement" WINDOW
 "NON-IMPACT"**

GENERAL NOTES

1. This product has been evaluated and is in compliance with the 6th Edition (2017) Florida Building Code (FBC) structural requirements excluding the "High Velocity Hurricane Zone" (HVHZ).
2. Product anchors shall be as listed and spaced as shown on details. Anchor embedment to base material shall be beyond wall dressing or stucco.
3. When used in areas requiring wind borne debris protection this product is required to be protected with an impact resistant covering that complies with FBC Sections 1609.1.2 & R301.2.1.2.
4. For 2x stud framing construction, anchoring of these units shall be the same as that shown for 2x buck masonry construction.
5. Site conditions that deviate from the details of this drawing require further engineering analysis by a licensed engineer or registered architect.

TABLE OF CONTENTS	
SHEET#	DESCRIPTION
1	Typical elevations, design pressures & general notes
2	Horizontal cross sections
3	Vertical cross sections
4	Buck and frame anchoring
5	Bill of materials, components and glazing detail

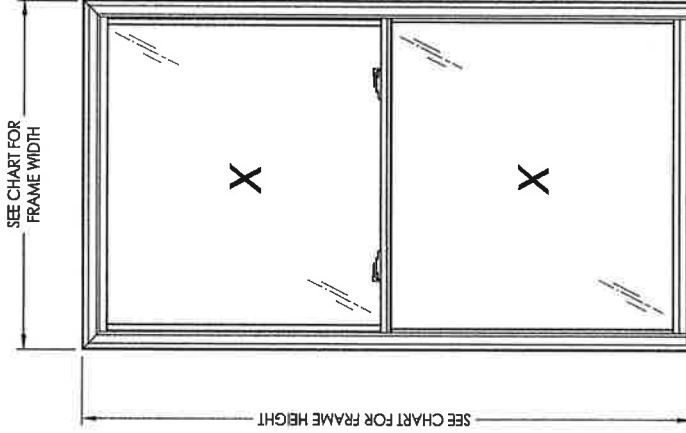

OVERALL FRAME DIMENSION	MAX. D.L.O. (TOP)	MAX. D.L.O. (BOTTOM)	GLASS TYPE	DESIGN PRESSURE (PSF)	
				POSITIVE	NEGATIVE
36.0" x 60.0"	29.12" x 25.75"	30.12" x 26.75"	G1	+50.0	-60.0
36.0" x 72.0"	29.12" x 31.75"	30.12" x 32.75"	G1	+50.0	-55.0
36.0" x 78.0"	29.12" x 34.75"	30.12" x 35.75"	G1	+45.0	-45.0
44.0" x 75.0"	37.12" x 33.25"	38.12" x 34.25"	G1	+35.0	-35.0
52.0" x 62.0"	45.12" x 26.75"	46.12" x 27.75"	G1	+35.0	-35.0
48.0" x 84.0"	41.12" x 37.75"	42.12" x 38.75"	G1	+30.0	-30.0
44.0" x 96.0"	37.12" x 43.75"	38.12" x 44.75"	G1	+25.0	-25.0
52.0" x 96.0"	45.12" x 43.75"	46.12" x 44.75"	G1	+15.0	-15.0

L.F. SCHMIDT
 No. 43409
 STATE OF FLORIDA
 LICENSE
 9617
 Documents Prepared By:
 Lyndon F. Schmidt
 P.E. No. 43409
 BUILDING CONSULTANTS, INC.
 P.O. Box 230, Vero Beach, FL 33595
 Phone No.: 813.859.9187
 FBPE C.A. No. 9813

PRODUCT: DOUBLE HUNG WINDOW
 PART OR ASSEMBLY:
 TYPICAL ELEVATION, DESIGN PRESSURES & GENERAL NOTES
 BY:

REVISIONS	
NO.	DATE
1	1/23/14
2	4/21/14
3	7/31/14
4	2/29/15
5	7/18/16
6	8/09/17

DATE: 11/12/13
 SCALE: N.T.S.
 DWG. BY: JK
 CHK. BY: LFS
 DRAWING NO.: FL-11720.9
 SHEET 1 OF 5

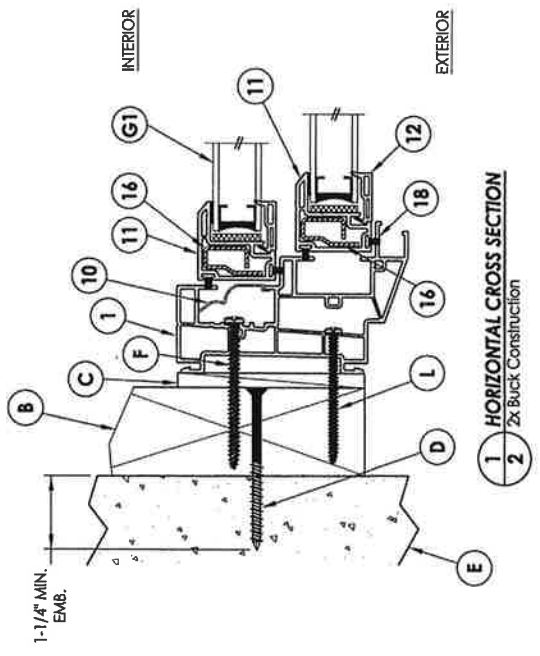
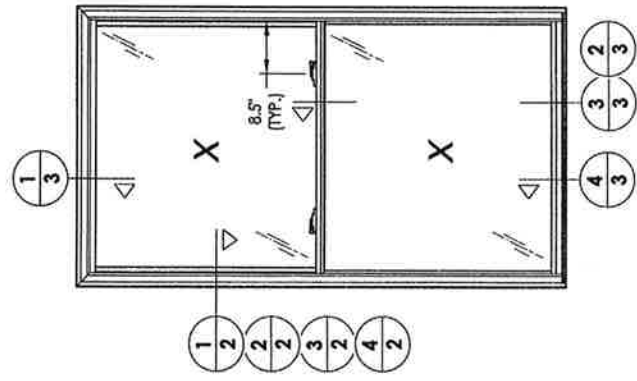

1 HORIZONTAL CROSS SECTION
2 2x Buck Construction

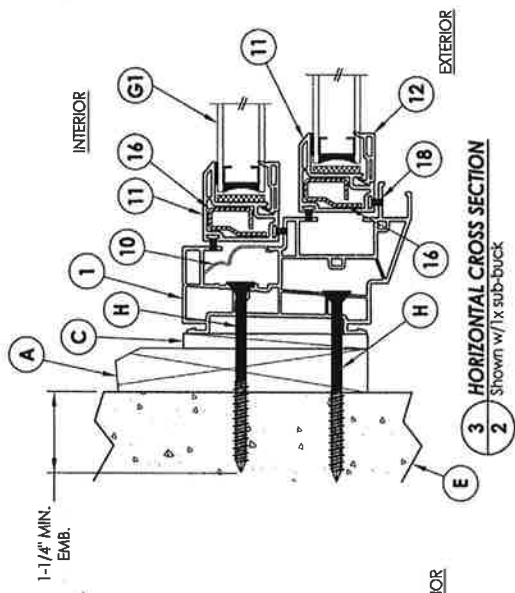

3 HORIZONTAL CROSS SECTION
2 Shown w/ 1x sub-buck

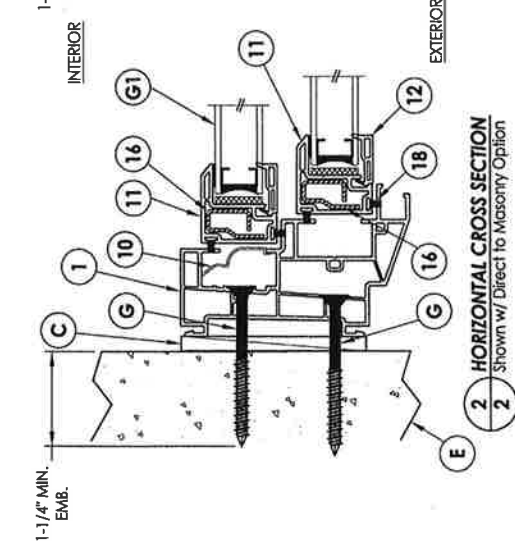

2 HORIZONTAL CROSS SECTION
2 Shown w/ Direct to Masonry Option

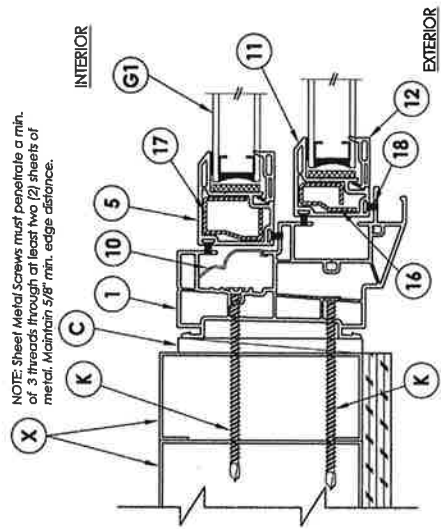

4 HORIZONTAL CROSS SECTION
2 Shown w/ Steel Stud Framing Option
2 Shown w/ MED Bottom Sash Shims

NOTE: Sheet Metal Screws must penetrate a min. of 3 threads through at least two (2) sheets of metal. Maintain 5/8" min. edge distance.

F. SCHMIDT
PROFESSIONAL ENGINEER
FLORIDA
LICENSE No. 43408

Documents Prepared By:
Lyndon F. Schmidt
P.E. No. 43408

BUILDING CONSULTANTS, INC.
P.O. Box 230, Vero Beach, FL 33595
Phone No.: 813.658.9197
FBPE C.A. No. 8813

REVISIONS	
NO.	DATE
1	1/23/14
2	4/21/14
3	7/3/14
4	2/25/15
5	7/18/16
6	8/09/17

BY: _____

DATE: 11/12/13

SCALE: N.T.S.

DWG. BY: JK

CHK. BY: LFS

DRAWING NO.: FL-11720.9

SHEET 2 of 5

REVISIONS	
NO.	DATE
1	1/23/14
2	4/21/14
3	7/3/14
4	2/25/15
5	7/18/16
6	8/09/17

1/23/14 ADDED FRAME SIZES
 4/21/14 UPDATED DESIGN PRESSURES
 7/3/14 UPDATED DESIGN PRESSURES
 2/25/15 UPDATE TO 5TH ED. (2014) FBC JK
 7/18/16 UPDATE B.O.M. & ADD COMP'S JK
 8/09/17 UPDATE TO 6TH ED. (2017) FBC LFS

DATE:	SCALE:	DWG. BY:	CHK. BY:	DRAWING NO.:	SHEET	OF
11/12/13	N.T.S.	JK	LFS	FL-11720.9	3	5

PRODUCT: DOUBLE HUNG WINDOW
 PART OR ASSEMBLY: VERTICAL CROSS SECTIONS
 BUILDING CONSULTANTS, INC.
 P.O. Box 230, Vero Beach, FL 33595
 Phone No.: 813.859.8187
 FBPE C.A. No. 8813

L.F. SCHMIDT
 No. 43409
 FLORIDA
 PROFESSIONAL ENGINEER
 L.F. SCHMIDT
 No. 43409
 FLORIDA
 PROFESSIONAL ENGINEER

Documents Prepared By: Lyndon F. Schmidt
 P.E. No. 43409

BLDG CONSULTANTS, INC.
 BUILDING CONSULTANTS, INC.
 P.O. Box 230, Vero Beach, FL 33595
 Phone No.: 813.859.8187
 FBPE C.A. No. 8813

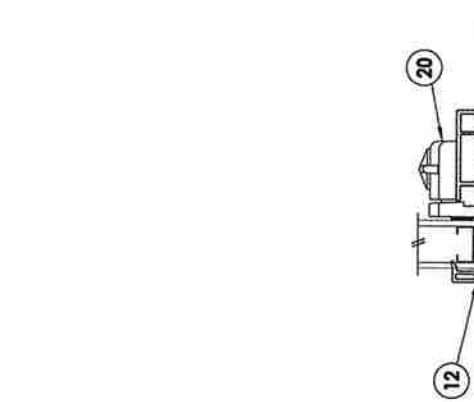

1 VERTICAL CROSS SECTION
 2x Buck Construction

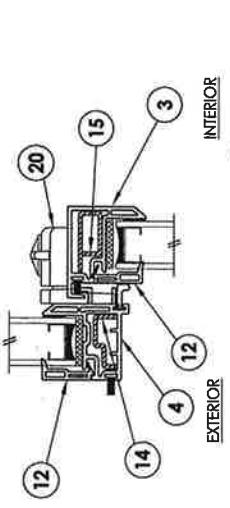

2 VERTICAL CROSS SECTION
 2x Buck Construction

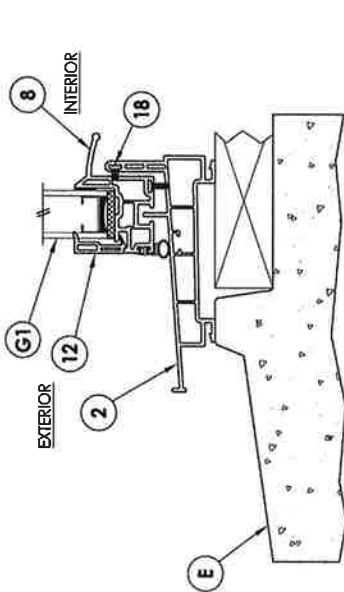

3 VERTICAL CROSS SECTION
 Optional masonry sill
 Shown w/ MED Bottom Sash Rails

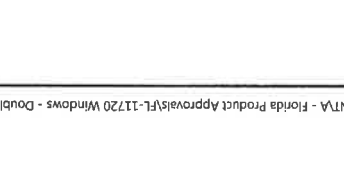

4 VERTICAL CROSS SECTION
 Optional masonry sill
 Shown w/ MED Bottom Sash Rails

PROFESSIONAL ENGINEER
 L.F. SCHMIDT
 No. 43409
 FLORIDA
 Documents Prepared by:
 Lyndon F. Schmidt
 P.E. No. 43409
 BUILDING CONSULTANTS, INC.
 P.O. Box 230, Vero Beach, FL 33595
 Phone No.: 813.659.9197
 FBPE C.A. No. 9813

REVISIONS	
NO.	DATE
1	1/23/14
2	4/21/14
3	7/3/14
4	2/25/15
5	7/18/16
6	8/09/17

DATE: 11/12/13
 SCALE: N.T.S.
 DWG. BY: JK
 CHK. BY: LFS
 DRAWING NO.: FL-11720.9
 SHEET 4 of 5

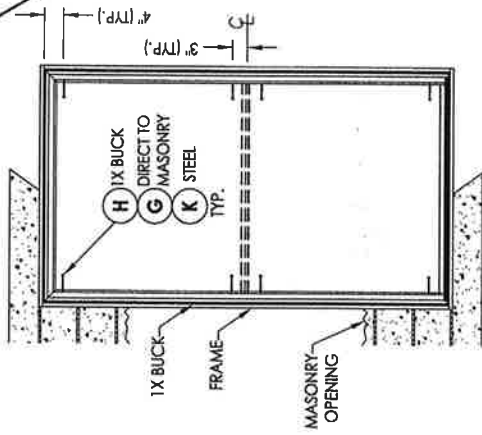

FRAME ANCHORING
(1X Buck, Direct to Masonry, Steel Stud)

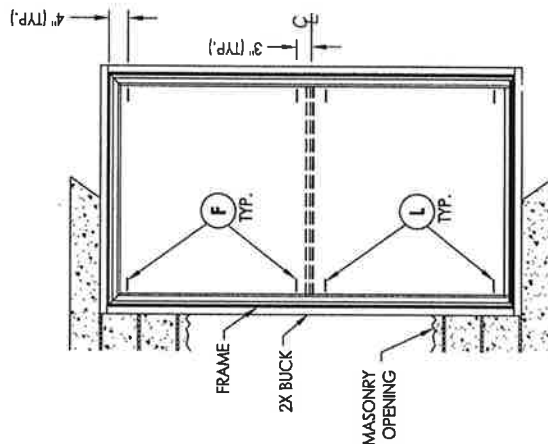

FRAME ANCHORING
(2X Buck)

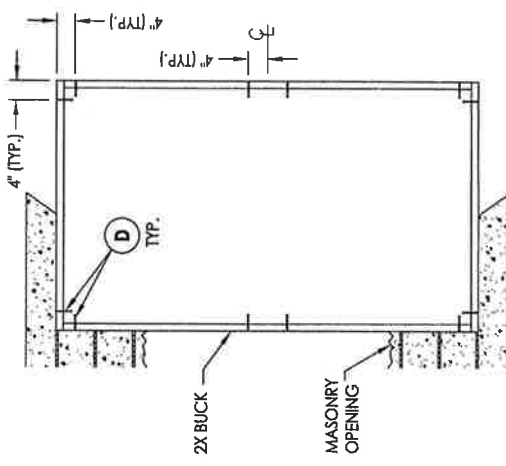

BUCK ANCHORING

- CONCRETE ANCHOR NOTES:**
- Concrete anchor locations at the corners may be adjusted to maintain the min. edge distance to mortar joints.
 - Concrete anchor locations noted as "MAX. ON CENTER" must be adjusted to maintain the min. edge distance to mortar joints; additional concrete anchors may be required to ensure the "MAX. ON CENTER" dimension are not exceeded.
 - Concrete anchor table:

ANCHOR TYPE	ANCHOR SIZE	MIN. EMBEDMENT	MIN. CLEARANCE TO MASONRY EDGE	MIN. CLEARANCE TO ADJACENT ANCHOR
ITW TAPCON®	1/4"	1-1/4"	2"	4"
ELCO ULTRACON®	1/4"	1-1/4"	1"	4"

- WOOD SCREW INSTALLATION NOTES:**
- Maintain a minimum 5/8" edge distance, 1" end distance, & 1" o.c. spacing of wood screws to prevent the splitting of wood.

PROFESSIONAL ENGINEER
F. SCHMIDT
 No. 43409
 FLORIDA

Documents Prepared By:
 Lyndon F. Schmidt
 P.E. No. 43409

BUILDING CONSULTANTS, INC.
 P.O. Box 230, Vero Beach, FL 33595
 Phone No.: 813.958.9187
 FBPE C.A. No. 9813

REVISIONS	
NO.	DATE
1	1/23/14
2	4/21/14
3	7/31/14
4	7/25/15
5	7/18/16
6	8/09/17

DATE: 11/12/13
 SCALE: N.T.S.
 DWG. BY: JK
 C.H. BY: LFS
 DRAWING NO.: FL-11720.9
 SHEET 5 OF 5

PRODUCT: DOUBLE HUNG WINDOW
 PART OR ASSEMBLY: BILL OF MATERIALS, COMPONENTS
 AND GLAZING DETAIL

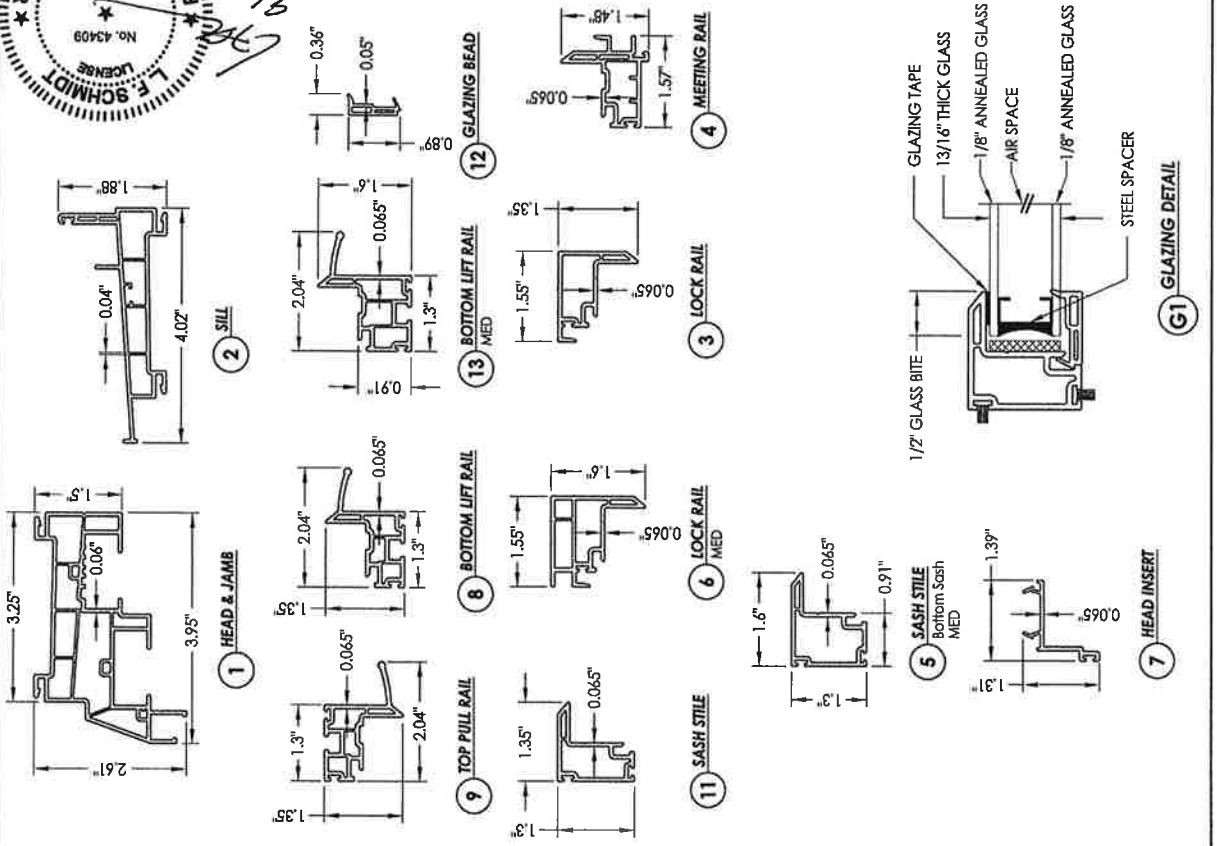

ITEM #	DESCRIPTION	MATERIAL
A	1X BUCK (SG >= 0.42)	WOOD
B	2X BUCK (SG >= 0.42)	WOOD
C	1/4" MAX. SHIM SPACE	-
D	1/4" X 2-3/4" PH ELCO OR ITW CONCRETE SCREW	STEEL
E	MASONRY - 3,000 PSI MIN. CONCRETE CONFORMING TO ACI 301 OR HOLLOW BLOCK CONFORMING TO ASTM C90	CONCRETE
F	# 10 X 2-1/2" PH WOOD SCREW (1-3/8" MIN. EMBEDMENT)	STEEL
G	1/4" X 2-3/4" PH ELCO OR ITW CONCRETE SCREW	STEEL
H	1/4" X 3-1/4" PH ELCO OR ITW CONCRETE SCREW	STEEL
K	# 10 PH SELF-DRILLING SMS	STEEL
L	# 10 X 2-1/4" PH WOOD SCREW (1-5/16" MIN. EMBEDMENT)	STEEL
X	STEEL STUD Min. Thk. .033" (ASTM A653 GRADE 33 Fy=33 Ksi Min, Fu=45 Ksi Min)	STEEL
1	EXTRUDED VINYL HEAD AND JAMB *	RIGID PVC
2	EXTRUDED VINYL SILL *	RIGID PVC
3	EXTRUDED VINYL LOCK RAIL *	RIGID PVC
4	EXTRUDED VINYL MEETING RAIL *	RIGID PVC
5	EXTRUDED VINYL SASH STILE (MED) *	RIGID PVC
6	EXTRUDED VINYL LOCK RAIL (MED) *	RIGID PVC
7	EXTRUDED VINYL HEAD INSERT *	RIGID PVC
8	EXTRUDED VINYL BOTTOM LIFT RAIL *	RIGID PVC
9	EXTRUDED VINYL TOP PULL RAIL *	RIGID PVC
10	BALANCE COVER	-
11	EXTRUDED VINYL SASH STILE *	RIGID PVC
12	GLAZING BEAD *	RIGID PVC
13	EXTRUDED VINYL BOTTOM LIFT RAIL (MED) *	RIGID PVC
14	REINFORCEMENT - MEETING RAIL	STEEL
15	REINFORCEMENT - LOCK RAIL	STEEL
16	REINFORCEMENT - SM. STILE	STEEL
17	REINFORCEMENT - MED. STILE	STEEL
18	WEATHERSTRIP (FIN PILE)	-
19	WEATHERSTRIP (VINYL BULB)	VINYL
20	CAM LOCK	STEEL

* THE APPROVED WHITE RIGID PVC EXTERIOR EXTRUSIONS FOR WINDOWS ARE TO BE PRODUCED BY EXTRUDERS LICENSEES IN "AAMA CERTIFICATION PROGRAMS FOR RIGID PVC EXTRUSIONS".

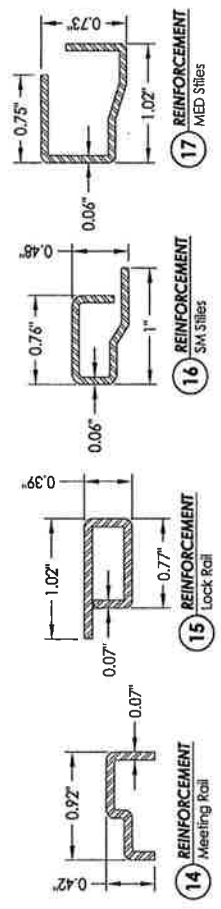

- [Searches](#)
- [Sales Search](#)
- [Results](#)
- [Property Record Card](#)
- [My Favorites](#)

[Sign up for e-Notify...](#)

1517 Perkins Rd < 25-23-29-5884-22-210 >

Name(s)	Physical Street Address
Maynard Raymond B	1517 Perkins Rd
Maynard Roberta G	Postal City and Zipcode
Mailing Address On File	Orlando, FL 32809
1517 Perkins Rd	Property Use
Belle Isle, FL 32809-6721	0103 - Single Fam Class III
Incorrect Mailing Address?	Municipality
	Belle Isle



View 2018 Property Record Card

- [Property Features](#)
- [Values, Exemptions and Taxes](#)
- [Sales Analysis](#)
- [Location Info](#)
- [Market Stats](#)
- [Update Information](#)

2019 values will be available in August of 2019.

Property Description [View Plat](#)

NELA ISLE M/55 LOTS 21 & 22 BLK V

Total Land Area 14,070 sqft (+/-) | 0.32 acres (+/-) [GIS Calculated](#) [Notice](#)

Land

Land Use Code	Zoning	Land Units	Unit Price	Land Value	Class Unit Price	Class Value
0100 - Single Family	R-1-A	1 LOT(S)	working...	working...	working...	working...

Page 1 of 1 (1 total records)

Buildings

Important Information		Structure				
	Model Code:	01 - Single Fam Residence	Actual Year Built:	1955	Gross Area:	1720 sqft
	Type Code:	0103 - Single Fam Class III	Beds:	3	Living Area:	1654 sqft
	Building Value:	working...	Baths:	1.0	Exterior Wall:	Concrete/Cinder Block
	Estimated New Cost:	working...	Floors:	1	Interior Wall:	Plastered

Page 1 of 1 (1 total records)

Extra Features

Description	Date Built	Units	XFOB Value
SCR1 - Scm Enc 1	01/01/2001	1 Unit(s)	working...

Page 1 of 1 (1 total records)



RICK SCOTT, GOVERNOR

IONATHAN ZACHEM, SECRETARY



STATE OF FLORIDA
DEPARTMENT OF BUSINESS AND PROFESSIONAL REGULATION
CONSTRUCTION INDUSTRY LICENSING BOARD

THE GENERAL CONTRACTOR HEREIN IS CERTIFIED UNDER THE
PROVISIONS OF CHAPTER 489, FLORIDA STATUTES

TILLMAN, MICHAEL BRIAN

WINDOW WORLD OF CENTRAL FLORIDA INC
3882 CENTER LOOP
ORLANDO FL 32808

LICENSE NUMBER: CGC1514205

EXPIRATION DATE: AUGUST 31, 2020

Always verify licenses online at MyFloridaLicense.com



Do not alter this document in any form.

This is your license. It is unlawful for anyone other than the licensee to use this document.



CERTIFICATE OF LIABILITY INSURANCE

DATE (MM/DD/YYYY)
04/17/2019

THIS CERTIFICATE IS ISSUED AS A MATTER OF INFORMATION ONLY AND CONFERS NO RIGHTS UPON THE CERTIFICATE HOLDER. THIS CERTIFICATE DOES NOT AFFIRMATIVELY OR NEGATIVELY AMEND, EXTEND OR ALTER THE COVERAGE AFFORDED BY THE POLICIES BELOW. THIS CERTIFICATE OF INSURANCE DOES NOT CONSTITUTE A CONTRACT BETWEEN THE ISSUING INSURER(S), AUTHORIZED REPRESENTATIVE OR PRODUCER, AND THE CERTIFICATE HOLDER.

IMPORTANT: If the certificate holder is an **ADDITIONAL INSURED**, the policy(ies) must have **ADDITIONAL INSURED** provisions or be endorsed. If **SUBROGATION IS WAIVED**, subject to the terms and conditions of the policy, certain policies may require an endorsement. A statement on this certificate does not confer rights to the certificate holder in lieu of such endorsement(s).

PRODUCER MATTHEW F. CARLUCCI STATE FARM INS. 3707 HENDRICKS AVE. JACKSONVILLE, FL 32207		CONTACT NAME: PHONE (A/C, No, Ext): 904-399-5544 FAX (A/C, No): 904-399-1536 E-MAIL: ADDRESS:	
INSURED WINDOW WORLD OF CENTRAL FL, INC. 3882 CENTER LOOP ORLANDO, FL 32808		INSURER(S) AFFORDING COVERAGE INSURER A: State Farm Fire and Casualty Company NAIC # 25143 INSURER B: INSURER C: INSURER D: INSURER E: INSURER F:	

COVERAGES

CERTIFICATE NUMBER:

REVISION NUMBER:

THIS IS TO CERTIFY THAT THE POLICIES OF INSURANCE LISTED BELOW HAVE BEEN ISSUED TO THE INSURED NAMED ABOVE FOR THE POLICY PERIOD INDICATED. NOTWITHSTANDING ANY REQUIREMENT, TERM OR CONDITION OF ANY CONTRACT OR OTHER DOCUMENT WITH RESPECT TO WHICH THIS CERTIFICATE MAY BE ISSUED OR MAY PERTAIN, THE INSURANCE AFFORDED BY THE POLICIES DESCRIBED HEREIN IS SUBJECT TO ALL THE TERMS, EXCLUSIONS AND CONDITIONS OF SUCH POLICIES. LIMITS SHOWN MAY HAVE BEEN REDUCED BY PAID CLAIMS.

INSR LTR	TYPE OF INSURANCE	ADDL INSD	SUBR WVD	POLICY NUMBER	POLICY EFF (MM/DD/YYYY)	POLICY EXP (MM/DD/YYYY)	LIMITS
A	<input checked="" type="checkbox"/> COMMERCIAL GENERAL LIABILITY <input type="checkbox"/> CLAIMS-MADE <input checked="" type="checkbox"/> OCCUR GEN'L AGGREGATE LIMIT APPLIES PER: <input type="checkbox"/> POLICY <input type="checkbox"/> PRO-JECT <input type="checkbox"/> LOC OTHER:			98-BE-W890-5 B	10/31/2018	10/31/2019	EACH OCCURRENCE \$ 2,000,000 DAMAGE TO RENTED PREMISES (Ea occurrence) \$ 300,000 MED EXP (Any one person) \$ 5,000 PERSONAL & ADV INJURY \$ GENERAL AGGREGATE \$ 4,000,000 PRODUCTS - COMPROP AGG \$ 4,000,000 \$ \$
	AUTOMOBILE LIABILITY <input type="checkbox"/> ANY AUTO <input type="checkbox"/> OWNED AUTOS ONLY <input type="checkbox"/> SCHEDULED AUTOS <input type="checkbox"/> HIRED AUTOS ONLY <input type="checkbox"/> NON-OWNED AUTOS ONLY						COMBINED SINGLE LIMIT (Ea accident) \$ BODILY INJURY (Per person) \$ BODILY INJURY (Per accident) \$ PROPERTY DAMAGE (Per accident) \$ \$ \$
	<input type="checkbox"/> UMBRELLA LIAB <input type="checkbox"/> OCCUR <input type="checkbox"/> EXCESS LIAB <input type="checkbox"/> CLAIMS-MADE DED RETENTION \$						EACH OCCURRENCE \$ AGGREGATE \$ \$
A	WORKERS COMPENSATION AND EMPLOYERS' LIABILITY ANY PROPRIETOR/PARTNER/EXECUTIVE OFFICER/MEMBER EXCLUDED? (Mandatory in FL) If yes, describe under DESCRIPTION OF OPERATIONS below	Y/N	N/A	98-CA-PB39-1 F	01/01/2019	01/01/2020	<input type="checkbox"/> PER STATUTE <input checked="" type="checkbox"/> OTHER E.L. EACH ACCIDENT \$ 1,000,000 E.L. DISEASE - EA EMPLOYEE \$ 1,000,000 E.L. DISEASE - POLICY LIMIT \$ 1,000,000

DESCRIPTION OF OPERATIONS / LOCATIONS / VEHICLES (ACORD 101, Additional Remarks Schedule, may be attached if more space is required)

CERTIFICATE HOLDER

CANCELLATION

CITY OF BELLE ISLE
1600 NEL AVE.
BELLE ISLE, FL 32809

SHOULD ANY OF THE ABOVE DESCRIBED POLICIES BE CANCELLED BEFORE THE EXPIRATION DATE THEREOF, NOTICE WILL BE DELIVERED IN ACCORDANCE WITH THE POLICY PROVISIONS.

AUTHORIZED REPRESENTATIVE

2018 - 2019



Local Business Tax Receipt

(Formerly known as "Business License"
changed per state law HB1269-2008)

Business Name
WINDOW WORLD OF CENTRAL FLORIDA
INC MICHAEL B TILLMAN CGC1514205
3882 CENTER LOOP
ORLANDO, FL 32808

Business Owner
WINDOW WORLD OF CENTRAL FLORIDA
INC MICHAEL B TILLMAN CGC1514205

Business Location
3882 CENTER LOOP
ORLANDO, FL

NOTICE-THIS TAX RECEIPT ONLY EVIDENCES
PAYMENT OF THE LOCAL BUSINESS TAX PURSUANT
TO CH.205, FLORIDA STATUTES. IT DOES NOT PERMIT
THE HOLDER TO OPERATE IN VIOLATION OF ANY CITY,
STATE, OR FEDERAL LAW. CITY PERMITTING MUST BE
NOTIFIED OF ANY MATERIAL CHANGE TO THE
INFORMATION FOUND HEREIN BELOW. THIS RECEIPT
DOES NOT CONSTITUTE AN ENDORSEMENT OR
APPROVAL OF THE HOLDER'S SKILL OR
COMPETENCY.

Case Number: BUS-0034480

Issued Date: 07/15/2018

Expiration Date: 09/30/2019



Business type(s):

Description	Year
CONTRA 1522 GENERAL CONTRACTOR	2019



Local Business Tax Receipt
City Hall, 400 South Orange Avenue, First Floor
Post Office Box 4990
Orlando, Florida 32802-4990

Phone: 407.246.2204 Fax: 407.246.3420

Email: BusinessTax@cityoforlando.net

Prompt! Interactive Voice Response System: 407.246.4444
Visit our website: cityoforlando.net/permits