



City of Belle Isle  
 Universal Engineering Sciences 3532 Maggie Blvd., Orlando, FL 32811  
 Tel 407-581-8161 \* Fax 407-581-0313 \* [www.universalengineering.com](http://www.universalengineering.com)

**PERMIT CARD - PLEASE POST AT JOB SITE**  
 THIS DOCUMENT BECOMES YOUR PERMIT WHEN PROPERLY VALIDATED

Per FBC 105.3.3: An enforcing authority may not issue a building permit for any building construction, erection, alteration, modification, repair or addition unless the permit either includes on its face or there is attached to the permit the following statement: "NOTICE: In addition to the requirements of this permit, there may be additional restrictions applicable to this property that may be found in the public records of this county, and there may be additional permits required from other governmental entities such as water management districts, state agencies, or federal agencies." The issuance of this permit does not grant permission to violate any applicable City, Orange County, State of Florida and/or Federal codes and/or ordinances. Separate permits are required for Signs, Roofing, Electrical, Gas, Plumbing and Mechanical services. This permit becomes VOID if the work authorized is not commenced within 6 months, or is suspended or abandoned for a period of 6 months after commencement. WORK SHALL BE CONSIDERED SUSPENDED IF AN APPROVED INSPECTION HAS NOT BEEN MADE WITHIN A 6 MONTH PERIOD. PERMISSION IS GRANTED TO DO THE FOLLOWING WORK ACCORDING TO THE CONDITIONS HEREON AND THE APPROVED PLANS AND SPECIFICATIONS, SUBJECT TO COMPLIANCE WITH THE ORDINANCES OF THE TOWN OF WINDERMERE, FLORIDA.

**Scope of Work:** Replace 12 windows and 1 door size for size  
**Comments:** None  
**Project Information**  
 Address: 6426 Stockbridge Ave  
 Parcel ID: 24-23-29-0600-04-241  
 Property Owner: Boals, James and Sally  
 Phone Number: 407-888-2906  
 \*\*\*\*\*  
 Company Name: The Home Depot At-Home Services  
 Contractor Name: Ramdial, Boysie  
 License Number: CRC046858  
 Address: 207 Kelsey Lane Suite K Tampa, FL 33619  
 Phone Number: 813-402-3702

**Permit Number: 2014-10-019**  
**Date of Application: 10/11/2013**  
**Date Permit Issued: 10/11/2013**  
**WARNING TO OWNER:** "YOUR FAILURE TO RECORD A NOTICE OF COMMENCEMENT MAY RESULT IN YOU PAYING TWICE FOR IMPROVEMENTS TO YOUR PROPERTY. IF YOU INTEND TO OBTAIN FINANCING, CONSULT WITH YOUR LENDER OR AN ATTORNEY BEFORE RECORDING YOUR NOTICE OF COMMENCEMENT." ON THE JOB INSPECTION(S) MUST BE MADE BEFORE PROCEEDING WITH SUBSEQUENT WORK. THIS CARD MUST BE DISPLAYED OUTSIDE AND BE PROTECTED FROM THE WEATHER WHILE BEING VISIBLE FROM THE STREET UNTIL THE FINAL INSPECTIONS HAVE BEEN APPROVED.

**BUILDING FEATURES**

**IMPACT FEES**  
 School \$  
**ZONING FEES**  
 Zoning Fee \$  
**UNIVERSAL ENG - BUILDING FEES**  
 Demo \$  
 Building \$  
 Fence \$  
 Driveway \$  
 Shed \$  
 Window(s) \$37.50  
 Door(s) \$42.00  
 PrePower \$  
 Electrical Fee \$  
 Temp Pole \$  
 Plumbing Fee \$  
 Mechanical Fee \$  
 Gas Fee \$  
 Roofing \$  
 Boat Dock \$  
 Screen Encl \$  
 Swimming Pool \$

**BUILDING INSPECTOR USE ONLY**  
 IF APPLICABLE:  
 Have Zoning Approval Conditions Been Met? YES NO Have Stormwater Approval Conditions Been Met? YES NO Silt fencing in place? YES NO Turbidity Barrier in place? YES NO  
 **BUILDING**  
 1<sup>st</sup> Survey specific foundation plan must be onsite before slab pour. Approved Plan on Site? \_\_\_\_\_  
 (Footing/Foundation)  
 2<sup>nd</sup> \_\_\_\_\_  
 (Slab)  
 3<sup>rd</sup> \_\_\_\_\_  
 (Lintel)(Wall Reinforcing on Masonry Building)  
 4<sup>th</sup> \_\_\_\_\_  
 (Exterior Framing)(Roof/Wall Sheathing)  
 5<sup>th</sup> \_\_\_\_\_  
 (Framing) (To be made after Plumbing/ Mechanical/ Electrical Rough-Ins & Windows/Doors Installed)  
 6<sup>th</sup> \_\_\_\_\_  
 (Insulation to be Made After Roof Installed)  
 7<sup>th</sup> \_\_\_\_\_  
 (Drywall)  
 8<sup>th</sup> \_\_\_\_\_  
 (Sidewalk/Driveway)  
 9<sup>th</sup> \_\_\_\_\_  
 (Other)  
 10<sup>th</sup> \_\_\_\_\_  
 (Final - After MEP and Other Applicable Finals)

**SURCHARGE FEES**  
 Surcharge Fee \$2.00  
 Surcharge Fee \$2.00  
**TOTAL FEES \$83.50**  
 Date Paid 10-15-13  
 CC or Check # 65259  
 Amount Paid 83.50

**ROOFING**  
 1<sup>ST</sup> ROOFING Deck Nailing/Dry-in/Flashing \_\_\_\_\_  
 2<sup>ND</sup> ROOFING Covering In-Progress \_\_\_\_\_  
 3<sup>RD</sup> ROOFING Covering Final \_\_\_\_\_  
 **PLUMBING** (Pool-Piping, Solar, Irrigation, Water Treatment Equip, Etc...)  
 1<sup>ST</sup> \_\_\_\_\_  
 (Underground) 2<sup>ND</sup> \_\_\_\_\_  
 (Sewer)  
 3<sup>RD</sup> \_\_\_\_\_  
 (Rough-In/Tub Set) 4<sup>th</sup> \_\_\_\_\_  
 (Final)  
**CHECK APPROPRIATE BOX**  
 GAS \_\_\_LP  MECHANICAL  ELECTRICAL  LOW VOLTAGE  
 1<sup>st</sup> \_\_\_\_\_  
 (Rough-In) 2<sup>nd</sup> \_\_\_\_\_  
 (Final)

The person accepting this permit shall conform to the terms of the application on file and construction shall conform to the requirements of the Florida Building Code (FS 553).

Inspection requests are to be emailed to [BDscheduling@UniversalEngineering.com](mailto:BDscheduling@UniversalEngineering.com); a confirmation email will be sent back to you upon scheduling. Next-Day Inspection requests must be made by 1pm. Please include the following in your request: Permit #, project address, type of inspection, date of the requested inspection, a contact name & a contact phone number. AM or PM may be requested but cannot be guaranteed.

PROJECT NUMBER 0115/300256.0000

TASK NUMBER 02

CITY OF BELLE ISLE  
Permit Application Review Sheet

Permit Number	2014-10-019
Property Owner	Boals, James & Sally
Address	6425 Stockbridge Ave
Nature of Improvement	Replace 12 Windows & 1 door size for size
Received Application	10-11-13
Sent for Stormwater Review	N/A
Stormwater Approved	
Sent for Zoning Review	N/A
Zoning Approved	
Applied for Variance	
Variance Approved	
Sent to BO for Review	10-11-2013
Building Official Approved	10-11-2013
Comments	
1.	10-14-13 No insurance or license info - left message
2.	10-15-13 Received
3.	
4.	
5.	
6.	
7.	
8.	
9.	
10.	
11.	
12.	

709884317103346



City of Belle Isle
1600 Nela Avenue, Belle Isle, FL 32809
Tel 407-851-7730 \* Fax 407-240-2222 \* www.cityofbelleislefl.org
Building Permit (Land Use) Application

DATE: PERMIT # 2014.10.019
PROJECT ADDRESS 6426 Stockbridge Ave. Belle Isle, FL 32809 32812
PROPERTY OWNER Sally Beals PHONE 407-888-2906 VALUE OF WORK (labor & material) \$ 7284

PLEASE LIST THE NATURE OF YOUR PROPOSED IMPROVEMENTS

Replacing 12 windows and 1 door size for size

- Please provide information, if applicable.
Survey specific foundation plan required to show compliance with zoning setbacks
BOAT DOCK: DEP Clearance Required with Application (Call 407-897-4100); please provide a copy of their report
PROVIDE SEPTIC RESIDENTAL SYSTEM VERIFICATION - OC DOCUMENT 64E-6, FOR NEW / ALTERED / ADDITIONS to Septic System
Homeowners will be required to have a contractor on record for homes that are rented and/or not homestead

Please Complete for the City of Belle Isle Zoning Review: Parcel Id Number: 24-23-29-0600-04-241
To obtain this information, please visit: http://www.ocpafl.org/Searches/ParcelSearch.aspx

SPECIAL CONDITIONS: STRUCTURES MAY NOT ENCR OACH INTO ANY EASEMENT OR REQUIRED SETBACK. Note, this Zoning Approval MAY or MAY NOT be in conflict with your Deed Restrictions. For New Single Family Residence, a Traffic Impact Fee and School Impact will be assessed.

Attached Survey SETS and Construction Plans SETS
PLANNING & ZONING APPROVAL: DATE

PLEASE COMPLETE for Building Review
CONSTRUCTION TYPE
OCCUPANCY GROUP #UNITS #STORIES Comm Res: Single Fam Multi Fam
#BLDG. #UNITS #STORIES TOTAL SQ.FT.
MAX. FLOOR LOAD MAX. OCCUPANCY
MIN. FLOOR ELEV. LOW FLOOR ELEV.
WATER SERVICE WELL SEPTIC

BUILDING REVIEWER: [Signature] DATE 10-11-2013
NOTES

Per FSS 105.3.3:
An enforcing authority may not issue a building permit for any building construction, erection, alteration, modification, repair or addition unless the permit either includes on its face or there is attached to the permit the following statement: "NOTICE: In addition to the requirements of this permit, there may be additional restrictions applicable to this property that may be found in the public records of this county, and there may be additional permits required from other governmental entities such as water management districts, state agencies, or federal agencies."

Waste Management is by legal contract the sole authorized provider of garbage, recycling, yard waste, and commercial garbage and construction debris collection and disposal services with the city limits of the City. Contractors, homeowners and commercial businesses may contact Waste Management at 407-788-0800 to setup accounts for Commercial, Construction Roll Off, or other services needed. Rates are fixed by contract and are available at City Hall or from Waste Management. The City enforces the contract through its code enforcement office. Failure to comply will result in a stop work order.

Table with columns: Wind Load Category, SPRINKLERS REQ'D, If Required - SUBMIT COPY OF PLANS FOR FIRE REVIEW, ZONING, CERT OF OCC, TRAFFIC, SCHOOL, FIRE, SWIMMING POOL, POOL ENCLOSURE, BOAT DOCK, BUILDING, WINDOW(S), DOOR(S), OTHER, 3% FL SURCHARGE, TOTAL, By Owner Form, Notice of Commencement, Power of Attorney, Contractor Packet On File?, OTHER PERMITS REQUIRED: ELECTRICAL, PREPOWER, MECHANICAL, PLUMBING, ROOFING, GAS, OTHER.



City of Belle Isle  
1600 Nela Avenue, Belle Isle, FL 32809  
Tel 407-851-7730 \* Fax 407-240-2222 \* [www.cityofbelleislefl.org](http://www.cityofbelleislefl.org)

70988413  
740 3346  
Boals

**Building Permit (Land Use) Application**

To be completed as required by State Statute Section 713 and other applicable sections.

**PERMIT #** 2014-10-019

Owner's Name Sally Boals  
Owner's Address 624 26 Stockbridge Ave Orlando FL 32809

Fee Simple Titleholder's Name (if other than owner's) \_\_\_\_\_

Address	City	State	Zip Code
Contractor's Name <u>Boysie Randial</u>	Architect/Engineer's Name		
Contractor's Address <u>207 Kelsey Ln Suite K</u>	Architect/Engineer's Address		
City, State, ZIP <u>Tampa, FL 33619</u>	City, State, ZIP		
License # <u>CR0146858</u>	License #		
Contact Phone/Cell <u>813-402-3702</u>	Contact Phone/Cell		
Contact Email <u>Heidi_Bishop@HomeDepot.com</u>	Contact Email		

**WARNING TO OWNER:** Your failure to record a Notice of Commencement may result in your paying twice for improvements to your property. A notice of commencement must be recorded if job is \$2500(+) or if A/C Replacement \$7500(+) and posted on the job site before the first inspection. If you intend to obtain financing, consult with your lender or an attorney before recording your Notice of Commencement.

I hereby make Application for Permit as outlined above, and if same is granted I agree to conform to all Division of Building Safety Regulations ([www.floridabuilding.org](http://www.floridabuilding.org)) and City Ordinances ([www.municode.com](http://www.municode.com)) regulating same and in accordance with plans submitted. The issuance of this permit does not grant permission to violate any applicable City and/or State of Florida codes and for ordinances. Application is hereby made to obtain a permit to do the work and installations as indicated. I certify that no work or installation has commenced prior to the issuance of a permit and that all work will be performed to meet the standards of all laws regulating construction in this jurisdiction. I understand that a separate permit must be secured for all other construction including ELECTRICAL, MECHANICAL, PLUMBING, GAS, SIGNS, POOLS, ENCLOSURES, ETC.

**OWNER'S AFFIDAVIT:** I certify that all the foregoing information is accurate and that all work will be done in compliance with all applicable laws regulating construction and zoning.

<p><b>Owner Signature</b> <u>Sally Boals</u> The foregoing instrument was acknowledged before me this <u>07/15/13</u> <u>Sally Boals</u> who is personally known to me as <u>Drivers License</u> as identification and who did <u>not</u> take an oath. Notary Public State of Florida County of Orange Comm# EE215692 Expires 7/11/2016</p>	<p><b>Contractor Signature</b> <u>Boysie Randial</u> The foregoing instrument was acknowledged before me this <u>07/11/13</u> by <u>Jonathan Thomas</u> who is personally known to me and who produced as identification and who did not take an oath. Notary as to Owner State of Florida County of Orange </p>
<p><b>Impervious Surface Ratio Worksheet</b> Development Zoned A-1, A-2, R-1-AAA, R-1-AA, R-1-A, R-1 per Section 50-74 Impervious Surface Ratio of the City Code</p> <p>1. Total Lot Area (sqft) X 0.35 = Allowable Impervious Area (BASE). Total Lot Area _____ X 0.35= _____ Allowable Impervious Area (BASE) _____</p> <p>Calculate the "proposed" impervious area on the lot. This includes the sum of all areas that do not allow direct percolation of rainwater. Examples include house, pool, deck, driveway, accessory building, etc</p> <ul style="list-style-type: none"> <li>• House _____</li> <li>• Driveway _____</li> <li>• Walkway _____</li> <li>• Accessory Buildings _____</li> <li>• Pool &amp; Spa _____</li> <li>• Deck &amp; Patio _____</li> <li>• Other _____</li> </ul> <p><b>Actual Impervious Area (AIA)</b> _____</p> <p>3. If AIA is less than BASE, subtract AIA from BASE to determine the amount of impervious area that may be added without providing onsite retention.</p> <p>4. If AIA is greater than BASE, then onsite retention <u>must be provided</u>. Assuming 7.5 inches of rainfall based on a 24hr 10 year Rain Event (TP40), the formula is: (7.5 inches rainfall/12 inches p/foot) X (result from line 4) = cubic feet of storage volume needed</p>	



To Whom It May Concern:

This letter will authorize the following person(s) to act as agent(s) on behalf of THD At-Home Services, INC, D/B/A The Home Depot At-Home Services, 3200 Cobb Galleria Parkway, Suite 200, Atlanta, GA 30339 to pull for permits and inspections with respect to the installation, maintenance and repair of windows, siding and fencing under Florida State Contractor license number CRC046858.

Authorized person(s):

- Brian Kirby
- Tim O'Malley
- Dennis Godsey
- Elizabeth Hutchinson
- John Hutchinson
- Amanda Horst
- Don Kirby
- Gary Barson
- Jonathan Thomas

Owner: Sally Boals

Address: 6426 Stockbridge Ave.

Belle Isle, FL 32809

Boysie G. Ramdial

Qualifier – Boysie G. Ramdial  
THD At-Home Services, INC

STATE OF FLORIDA  
COUNTY OF HILLSBOROUGH

The foregoing instrument was acknowledged before me this 7 day of October, 2013 by Boysie Ramdial.

Amber Flenker  
Notary Public – State of Florida

Amber Flenker  
Printed Name

07/11/2016  
My Commission Expires



Personally known x or Produced Identification \_\_\_\_\_

**THD At-Home Services, Inc.**  
207 Kelsey Lane • Suite K • Tampa, FL 33619  
Phone: 813-402-3700 • Fax: 813-630-4112 • Toll Free: 866-653-8438

This Instrument Prepared By:  
THD At-Home Services  
207 Kelsey Lane, Suite K  
Tampa, FL 33619



NOTICE OF COMMENCEMENT

Permit No. \_\_\_\_\_ Tax Folio No. 24-23-29-0600-04-241  
State of Florida  
County of Orange

THE UNDERSIGNED hereby gives notice that improvements will be made to certain real property, and in accordance with Chapter 713, Florida Statutes, the following information is provided in this Notice of Commencement:

- Description of property: (legal description of property, and street address if available) CH26 Stockbridge Ave. Orlando, Florida, 32809 Belle Isle Estates L58 The N 40 FT OF Lot 24 and 35 FT of Lot 25 BKED
- General description of improvement: Rephen windows & door
- Owner information
  - Name and address: Sally Boals CH26 Stockbridge Ave. Belle Isle, FL 32809
  - Interest in property: Owner
  - Name and address of fee simple titleholder (if other than owner): \_\_\_\_\_
- Contractor
  - Name and address: THD At-Home Services, Inc 207 Kelsey Lane, Suite K, Tampa, FL 33619
  - Phone number: 813-402-3700
- Surety
  - Name and address: \_\_\_\_\_
  - Amount of bond \_\_\_\_\_
  - Phone number: \_\_\_\_\_
- Lender
  - Name and address: \_\_\_\_\_
  - Phone number: \_\_\_\_\_
- Persons within the State of Florida designated by Owner upon whom notices or other documents may be served as provided by Section 713.13(1)(a)7., Florida Statutes:
  - Name and address: \_\_\_\_\_
  - Phone number: \_\_\_\_\_
- In addition to himself, Owner designates the following person(s) to receive a copy of the Lienor's Notice as provided in Section 713.13(1)(b), Florida Statutes:
  - Name and address: \_\_\_\_\_
  - Phone number: \_\_\_\_\_
- Expiration date of notice of commencement (the expiration date is 1 year from the date of recording unless a different date is specified) \_\_\_\_\_

WARNING TO OWNER: ANY PAYMENTS MADE BY THE OWNER AFTER THE EXPIRATION OF THE NOTICE OF COMMENCEMENT ARE CONSIDERED IMPROPER PAYMENTS UNDER CHAPTER 713, PART 1, SECTION 713.13, FLORIDA STATUTES, AND CAN RESULT IN YOUR PAYING TWICE FOR IMPROVEMENTS TO YOUR PROPERTY. A NOTICE OF COMMENCEMENT MUST BE RECORDED AND POSTED ON THE JOB SITE BEFORE THE FIRST INSPECTION. IF YOU INTEND TO OBTAIN FINANCING, CONSULT WITH YOUR LENDER OR AN ATTORNEY BEFORE COMMENCING WORK OR RECORDING YOUR NOTICE OF COMMENCEMENT.

10. Sally Boals  
Signature of Owner or Owner's Authorized Officer/Director  
Partne-Manager  
Signatory's Title/Office: Owner

The foregoing instrument was acknowledged before me this 5 day of September, 2013 by Sally Boals (type of authority, e.g. officer, trustee, attorney in fact) for Boals Self (name of party on behalf of whom instrument was executed).

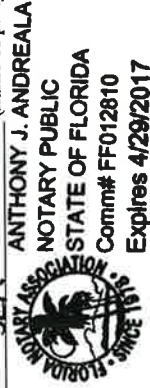

Signature of Notary Public - State of Florida  
Personally known \_\_\_ or Produced Identification pe

---AND---  
Verification Pursuant to Section 92.525, Florida Statutes

Under penalties of perjury, I declare that I have read the foregoing and that the facts stated in it are true to the best of my knowledge and belief. I hereby certify that this is a true copy of the document as reflected in the Official Records.



By: M. O. Haynie County Comptroller  
Date: 10/15/13  
Signature of Natural Person Signing (in Line#10) Above

# Property Record - 24-23-29-0600-04-241

Orange County Property Appraiser • <http://www.ocpafl.org>

1098843

## Property Summary

**Property Name**  
6426 Stockbridge Ave

**Names**  
Boals James E  
Boals Sally H

**Municipality**  
BI - Belle Isle

**Property Use**  
0101 - Single Family

**Mailing Address**  
6426 Stockbridge Ave  
Belle Isle, FL 32809-6166

**Physical Address**  
6426 Stockbridge Ave  
Orlando, FL 32809



QR Code For Mobile Phone

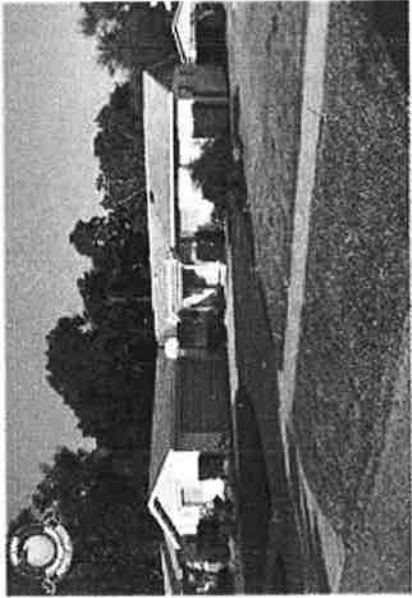

292324060004241 10/05/2006



## Property Features

### Property Description

BELLE ISLE ESTATES L/58 THE N 40 FT OF LOT 24 & S 35 FT OF LOT 25 BLK D

### Total Land Area

9,329 sqft (+/-) | 0.21 acres (+/-)

GIS Calculated

### Land

Land Use Code	Zoning	Land Units	Unit Price	Land Value	Class	Unit Price	Class Value

0100 - Single Family R-1-A 1 LOT(S) \$44,000.00 \$44,000 \$0.00 \$44,000

**Buildings**

<b>Model Code</b>	01 - Single Fam Residence	Subarea Description	Sqft	Value
<b>Type Code</b>	0101 - Single Family	BAS - Base Area	1274	\$71,471
<b>Building Value</b>	\$48,872	FGR - Fin Garage	440	\$12,342
<b>Estimated New Cost</b>	\$84,262	FOP - F/Opn Prch	32	\$449
<b>Actual Year Built</b>	1968			
<b>Beds</b>	3			
<b>Baths</b>	2.0			
<b>Floors</b>	1			
<b>Gross Area</b>	1746 sqft			
<b>Living Area</b>	1274 sqft			
<b>Exterior Wall</b>	Conc/Cindr			
<b>Interior Wall</b>	Drywall			

**Extra Features**

<b>Description</b>	<b>Date Built</b>	<b>Units</b>	<b>Unit Price</b>	<b>XFOB Value</b>
SCR1 - Scrn Enc 1	01/01/1997	1 Unit(s)	\$2,000.00	\$2,000



Boats/709843

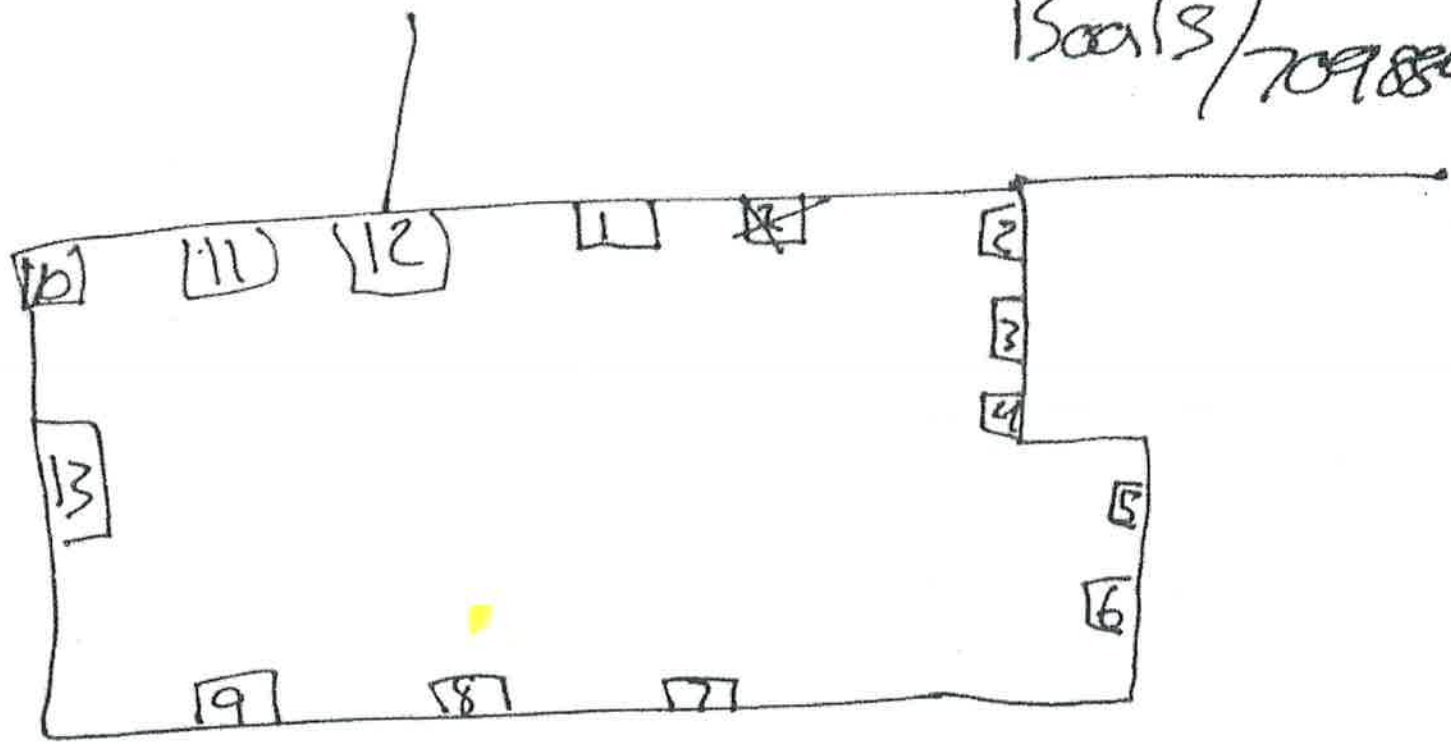

**CITY OF BELLE ISLE**  
THE PLANS AND SPECIFICATIONS  
HAVE BEEN REVIEWED. FULL  
COMPLIANCE WITH CODES AND  
REGULATIONS ARE REQUIRED BY  
THE PERMIT HOLDER  
APPROVED *[Signature]* BUI557  
10-11-2013



**WINDOW SPECIFICATION SHEET**

*(Copy for PSG)*

Customer: Ms. Sally Boals Date: 9/5/2013  
 Branch: Tampa Job #: 7103346  
 Consultant: Christopher Giroux

LINE #	DESCRIPTION	QTY	PRICE	EXTENDED
--------	-------------	-----	-------	----------

1.	Room: Living Floor: 1st Item Name: Living	1	\$55.00	\$55.00
----	---	---	---------	---------

Notes:  
Pre-existing Conditions:

\*\*\* Line Level Labor Codes  
 \*\*\*  
 Simonton 6500/6100E, 2  
 Panel Patio Door,  
 Assessed Width = 72,  
 Assessed Height = 72,  
 Living, No Window/Door  
 Wraps, New Interior Wood  
 Casing, Interior Wood  
 Casing Wood Type = Pine,  
 Interior Wood Casing Type  
 = Colonial, Misc Labor  
 Hours = 1, Misc Labor  
 Notes = labor

Additional Charges/Deductions:  
 Misc Labor \$55.00

LINE #	DESCRIPTION	QTY	PRICE	EXTENDED
--------	-------------	-----	-------	----------

2.	Room: Living Floor: 1st Item Name: Living Series: 6100 VantagePointe Narrow Patio Doors	1	\$1,763.78	\$1,763.78
----	---	---	------------	------------

Notes:  
Pre-existing Conditions:

LMS STYLE CODE: Patio Doors (PD05) 2 Pnl - Narrow Frame (PD05)

Simonton  
 6100 VantagePointe Narrow  
 Patio Doors Double Sliding  
 Door Right Opening (OX)  
 71.25 x 79.5

**Color Options:**  
 Exterior Color = White  
 Interior Color = White

**Rough Opening:**  
 71.75" X 80"

**Glass Options:**  
 Glass Packages = Standard  
 Low-E Glass Option = ProSolar Low I  
 Upper Window Strength =  
 Lower Window Strength =  
 Left Glass Strength =  
 Right Glass Strength =  
 Glass Style = None  
 Left Glass Style =  
 Right Glass Style =  
 Upper Glass Style =  
 Lower Glass Style =  
 Glass Strength = Tempered  
 Design Pressure = 50

**Window Design Options:**  
 Installation Type =  
 Replacement  
 Operation / Venting -  
 OUTSIDE LOOKING IN =  
 Right Opening (OX)

**Screen Options: Interior Hardware Options:**  
 Screen Lock Type = Keyed  
 Coverage = Half Multi-Point Lock  
 Mesh Style = Coastal Hardware = No  
 Fiberglass Exterior Hardware Finish =  
 Screen Frame = White  
 Extruded Interior Hardware Finish =  
 White  
 Rollers = Corrosion

Coverage = Finish = White  
 Half

**Grid Options:**

Flat  
 Colonial  
 Grid Color = White  
 2W3H  
 See Picture for Grids #W#H  
 For Grid count, you must  
 count bars not panes

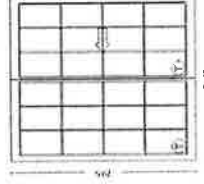

Grid Locations:  
 L = Left  
 R = Right  
 B = Bottom  
 T = Top  
 C = Center

LINE #	DESCRIPTION	QTY	PRICE	EXTENDED
--------	-------------	-----	-------	----------

3.	Room: Living	1	\$55.00	\$55.00
----	--------------	---	---------	---------

Notes:

WINDOW SPECIFICATION SHEET

(Copy for PSG)

Customer: Ms. Sally Boals  
 Branch: Tampa  
 Consultant: Christopher Giroux

Date: 8/31/2013  
 Job #: 7098843

LINE #	DESCRIPTION	QTY	PRICE	EXTENDED
1.	Room:Kitchen Floor: 1st	1	\$657.31	\$657.31

Notes: Grilles  
 Pre-existing Conditions:

Item Name:  
 Series: 6100 VantagePointe Windows LMS STYLE CODE: Double Hung Coastal (DHC)

Simonton  
 6100 VantagePointe Windows Double Hung Operating 36.75 x 37.5  
Color Options: Exterior Color = White  
 Interior Color = White  
Rough Opening: 37" X 38"  
Glass Options:  
 Glass Packages = Standard  
 Low-E Glass Option = ProSolar Low I  
 Upper Window Strength = Not Tempered  
 Lower Window Strength = Not Tempered  
 Left Glass Strength =  
 Right Glass Strength =  
 Glass Style = See Below  
 Left Glass Style =  
 Right Glass Style =  
 Upper Glass Style = None  
 Lower Glass Style = None  
 Glass Strength = Not Tempered  
 Design Pressure = 45

Window Design Options:  
 Installation Type =  
 Replacement  
 Operation / Venting -  
 OUTSIDE LOOKING IN =  
 Operating

Sash Split = Even  
 Number Wide = 1

Screen Options: Interior Hardware Options:  
 Screen  
 Number of Locks = 2  
 Lock Type = Cam  
 Coverage = Half  
 Mesh Style =  
 Number of Air Latches = 2  
 Fiberglass Interior Hardware Finish =  
 Screen Frame = White  
 Extruded Maximum Clearance  
 Screen Mullion Hardware = No  
 = No

Screen Interior Hardware  
 Coverage = Finish =White  
 Half

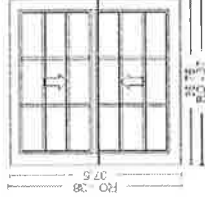

Grid Options:

Flat  
 Colonial  
 Grid Color = White  
 2W1H  
 See Picture for Grids #W#H  
 For Grid count, you must  
 count bars not panes

Grid Locations:

L = Left  
 R = Right  
 B = Bottom  
 T = Top  
 C = Center

LINE #	DESCRIPTION	QTY	PRICE	EXTENDED
2.	Room:Dining Room Floor: 1st	1	\$735.43	\$735.43

Notes:  
 Pre-existing Conditions:

Item Name:  
 Series: 6100 VantagePointe Windows LMS STYLE CODE: Picture Windows Coastal (PWC)

Simonton  
 6100 VantagePointe Windows Direct Set Fixed 71.75 x 49.5  
Color Options: Exterior Color = White  
 Interior Color = White  
Rough Opening: 72" X 50"  
Glass Options:  
 Glass Packages = Standard  
 Low-E Glass Option = ProSolar Low I  
 Upper Window Strength =  
 Lower Window Strength =  
 Left Glass Strength =  
 Right Glass Strength =

Glass Style = None  
 Left Glass Style =  
 Right Glass Style =  
 Upper Glass Style =  
 Lower Glass Style =  
 Glass Strength = Not Tempered  
 Design Pressure = 50

Window Design Options:  
 Installation Type =  
 Replacement  
 Operation / Venting -  
 OUTSIDE LOOKING IN =  
 Fixed

Sash Split =  
 Number Wide = 1

Screen Options: Interior Hardware Options:

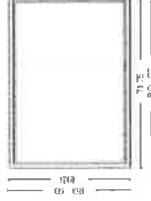

LINE #	DESCRIPTION	QTY	PRICE	EXTENDED
3.	Room:Dining Room Floor: 1st	1	\$735.43	\$735.43

Notes:  
 Pre-existing Conditions:

Item Name:  
 Series: 6100 VantagePointe Windows LMS STYLE CODE: Picture Windows Coastal (PWC)

Simonton  
 6100 VantagePointe  
 Windows Direct Set Fixed  
 71.75 x 49.5

Color Options:  
 Exterior Color = White  
 Interior Color = White

Rough Opening:  
 72" X 50"

Glass Options:  
 Glass Packages = Standard  
 Low-E Glass Option = ProSolar Low I  
 Upper Window Strength =  
 Lower Window Strength =  
 Left Glass Strength =  
 Right Glass Strength =  
 Glass Style = None  
 Left Glass Style =  
 Right Glass Style =  
 Upper Glass Style =  
 Lower Glass Style =  
 Glass Strength = Not Tempered  
 Design Pressure = 50

Window Design Options:  
 Installation Type =  
 Replacement  
 Operation / Venting -  
 OUTSIDE LOOKING IN =  
 Fixed

Sash Split =  
 Number Wide = 1

Screen Options: Interior Hardware Options:

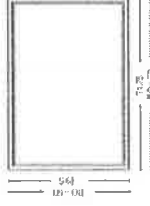

LINE #	DESCRIPTION	QTY	PRICE	EXTENDED
4.	Room:Living Room Floor: 1st	1	\$1,041.27	\$1,041.27

Notes:  
 Pre-existing Conditions:

Item Name:  
 Series: 6100 VantagePointe Windows LMS STYLE CODE: Picture Windows Coastal (PWC)

Simonton

Color Options:

Rough Opening:

Glass Options:

6100 VantagePointe  
Windows Direct Set Fixed /  
Fixed 101.75 x 49.5

Exterior Color = White  
Interior Color = White

102 X 50"

Glass Packages = Standard  
Low-E Glass Option = ProSolar Low I  
Upper Window Strength =  
Lower Window Strength =  
Left Glass Strength =  
Right Glass Strength =  
Glass Style = None  
Left Glass Style =  
Right Glass Style =  
Upper Glass Style =  
Lower Glass Style =  
Glass Strength = Not Tempered  
Design Pressure = 50

Window Design Options:  
Installation Type =  
Replacement  
Operation / Venting -  
OUTSIDE LOOKING IN =  
Fixed

Sash Split =

Number Wide = 2

Screen Options: Interior Hardware Options:

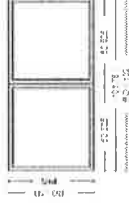

LINE #	DESCRIPTION	QTY	PRICE	EXTENDED
5.	Room:Bedroom 1 Floor: 1st Notes: Pre-existing Conditions:	1	\$599.87	\$599.87

Item Name:

Series: 6100 VantagePointe Windows LMS STYLE CODE: 2 Panel Slider Coastal (2PNLC)

Simonton

Color Options:

Exterior Color = White  
Interior Color = White

Rough Opening:

53" X 27"

Glass Options:

Glass Packages = Standard  
Low-E Glass Option = ProSolar Low I  
Upper Window Strength =  
Lower Window Strength =  
Left Glass Strength = Not Tempered  
Right Glass Strength = Not Tempered  
Glass Style = None  
Left Glass Style =  
Right Glass Style =  
Upper Glass Style =  
Lower Glass Style =  
Glass Strength = Not Tempered  
Design Pressure = 40

Window Design Options:  
Installation Type =  
Replacement  
Operation / Venting -  
OUTSIDE LOOKING IN =  
Left Opening - XO

Sash Split = Even

Number Wide = 1

Screen Options: Interior Hardware Options:  
Screen  
Coverage = Full  
Mesh Style =  
Fiberglass  
Screen Frame =  
Extruded  
Screen Mullion  
= No  
Lock Type = Cam  
Number of Air Latches =  
None  
Interior Hardware Finish =  
White  
Rollers = Corrosion  
Resistant Roller/Glide  
Interior Hardware  
Finish =White  
Screen  
Coverage =  
Full

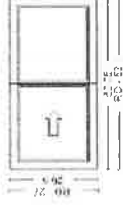

LINE #	DESCRIPTION	QTY	PRICE	EXTENDED
6.	Room:Bedroom 1 Floor: 1st	1	\$599.87	\$599.87

Notes:

Pre-existing Conditions:

Item Name:

Series: 6100 VantagePointe Windows LMS STYLE CODE: 2 Panel Slider Coastal (2PNLC)

Simonton

**Color Options:**  
 Exterior Color = White  
 Interior Color = White

**Rough Opening:**  
 53" X 27"

**Glass Options:**  
 Glass Packages = Standard  
 Low-E Glass Option = ProSolar Low  
 Upper Window Strength =  
 Lower Window Strength =  
 Left Glass Strength = Not Tempered  
 Right Glass Strength = Not Tempered  
 Glass Style = None  
 Left Glass Style =  
 Right Glass Style =  
 Upper Glass Style =  
 Lower Glass Style =  
 Glass Strength = Not Tempered  
 Design Pressure = 40

**Window Design Options:**

Installation Type =  
 Replacement  
 Operation / Venting -  
 OUTSIDE LOOKING IN =  
 Left Opening - XO

Sash Split = Even  
 Number Wide = 1

**Screen Options:**

Screen  
 Coverage = Full  
 Mesh Style =  
 Fiberglass  
 Screen Frame =  
 Extruded  
 Screen Mullion  
 = No

Screen  
 Coverage =  
 Full

**Interior Hardware Options:**

Number of Locks = 1  
 Lock Type = Cam  
 Number of Air Latches =  
 None  
 Interior Hardware Finish =  
 White  
 Rollers = Corrosion  
 Resistant Roller/Glide

Interior Hardware  
 Finish = White

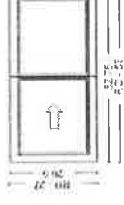

LINE #	DESCRIPTION	QTY	PRICE	EXTENDED
7.	Room:Bedroom 1 Floor: 1st	1	\$599.87	\$599.87

Notes:

Pre-existing Conditions:

Item Name:

Series: 6100 VantagePointe Windows LMS STYLE CODE: 2 Panel Slider Coastal (2PNLC)

Simonton

**Color Options:**  
 Exterior Color = White  
 Interior Color = White

**Rough Opening:**  
 53" X 27"

**Glass Options:**  
 Glass Packages = Standard  
 Low-E Glass Option = ProSolar Low  
 Upper Window Strength =  
 Lower Window Strength =  
 Left Glass Strength = Not Tempered  
 Right Glass Strength = Not Tempered  
 Glass Style = None  
 Left Glass Style =  
 Right Glass Style =  
 Upper Glass Style =  
 Lower Glass Style =  
 Glass Strength = Not Tempered  
 Design Pressure = 40

**Window Design Options:**  
 Installation Type =  
 Replacement  
 Operation / Venting -  
 OUTSIDE LOOKING IN =  
 Left Opening - XO

Sash Split = Even  
 Number Wide = 1

**Screen Options:** Interior Hardware Options:  
 Number of Locks = 1  
 Lock Type = Cam  
 Number of Air Latches =  
 None  
 Screen Frame =  
 Interior Hardware Finish =  
 White  
 Extruded  
 Screen Mullion  
 Rollers = Corrosion  
 Resistant Roller/Glide  
 = No  
 Screen  
 Coverage =  
 Full  
 Interior Hardware  
 Finish = White

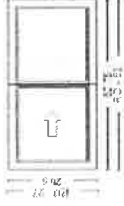

LINE.#	DESCRIPTION	QTY	PRICE	EXTENDED
8.	Room:Bedroom 1 Floor: 1st	1	\$599.87	\$599.87

Notes:  
 Pre-existing Conditions:

Item Name:  
 Series: 6100 VantagePointe Windows LMS STYLE CODE: 2 Panel Slider Coastal (2PNLC)

Simonton  
 6100 VantagePointe  
 Windows Double Slider Left  
 Opening - XO 52.75 x 26.5

**Color Options:** Exterior Color = White  
 Interior Color = White

**Rough Opening:** 53" X 27"

**Glass Options:**  
 Glass Packages = Standard  
 Low-E Glass Option = ProSolar Low I  
 Upper Window Strength =  
 Lower Window Strength =  
 Left Glass Strength = Not Tempered  
 Right Glass Strength = Not Tempered  
 Glass Style = None  
 Left Glass Style =  
 Right Glass Style =  
 Upper Glass Style =  
 Lower Glass Style =  
 Glass Strength = Not Tempered  
 Design Pressure = 40

**Window Design Options:**  
 Installation Type =  
 Replacement  
 Operation / Venting -  
 OUTSIDE LOOKING IN =  
 Left Opening - XO

Sash Split = Even  
 Number Wide = 1

**Screen Options:** Interior Hardware Options:  
 Number of Locks = 1  
 Lock Type = Cam  
 Number of Air Latches =  
 None  
 Screen Frame =  
 Interior Hardware Finish =  
 White  
 Extruded  
 Screen Mullion  
 Rollers = Corrosion  
 Resistant Roller/Glide  
 = No  
 Screen  
 Coverage =  
 Full  
 Interior Hardware  
 Finish = White

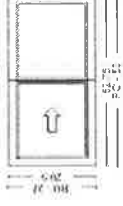

LINE.#	DESCRIPTION	QTY	PRICE	EXTENDED
9.	Room:Bedroom 3 Floor: 1st	1	\$599.87	\$599.87

Notes: Grilles  
 Pre-existing Conditions:

Item Name:  
 Series: 6100 VantagePointe Windows LMS STYLE CODE: 2 Panel Slider Coastal (2PNLC)

Simonton  
 Color Options:  
 Rough Opening:  
 Glass Options:

6100 VantagePointe  
Windows Double Slider Left  
Opening - XO 52.75 x 27.5

Exterior Color = White  
Interior Color = White

53" X 28"

Glass Packages = Standard  
Low-E Glass Option = ProSolar Low I  
Upper Window Strength =  
Lower Window Strength =  
Left Glass Strength = Not Tempered  
Right Glass Strength = Not Tempered  
Glass Style = None  
Left Glass Style =  
Right Glass Style =  
Upper Glass Style =  
Lower Glass Style =  
Glass Strength = Not Tempered  
Design Pressure = 40

Window Design Options:  
Installation Type =  
Replacement  
Operation / Venting -  
OUTSIDE LOOKING IN =  
Left Opening - XO

Sash Split = Even  
Number Wide = 1

Screen Options: Interior Hardware Options:  
Screen  
Number of Locks = 1  
Coverage = Full  
Lock Type = Cam  
Mesh Style =  
Number of Air Latches =  
Fiberglass  
None  
Screen Frame =  
Interior Hardware Finish =  
White  
Extruded  
Screen Mullion  
Rollers = Corrosion  
Resistant Roller/Glide  
= No

Screen  
Coverage =  
Full  
Interior Hardware  
Finish =White

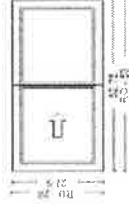

LINE #	DESCRIPTION	QTY	PRICE	EXTENDED
10.	Room:Bedroom 3 Floor: 1st Notes: Grilles, Obscure, Tempered Pre-existing Conditions:	1	\$638.26	\$638.26

Item Name:

Series: 6100 VantagePointe Windows LMS STYLE CODE: 2 Panel Slider Coastal (2PNLC)

Simonton

6100 VantagePointe  
Windows Double Slider Left  
Opening - XO 52.75 x 27.5

Color Options:

Exterior Color = White  
Interior Color = White

Rough Opening:

53" X 28"

Glass Options:

Glass Packages = Standard  
Low-E Glass Option = ProSolar Low I  
Upper Window Strength =  
Lower Window Strength =  
Left Glass Strength = Not Tempered  
Right Glass Strength = Not Tempered  
Glass Style = None  
Left Glass Style =  
Right Glass Style =  
Upper Glass Style =  
Lower Glass Style =  
Glass Strength = Not Tempered  
Design Pressure = 40

Window Design Options:  
Installation Type =  
Replacement  
Operation / Venting -  
OUTSIDE LOOKING IN =  
Left Opening - XO

Sash Split = Even  
Number Wide = 1

Screen Options: Interior Hardware Options:  
Screen  
Number of Locks = 1  
Coverage = Full  
Lock Type = Cam  
Mesh Style =  
Number of Air Latches =  
Fiberglass  
None  
Screen Frame =  
Interior Hardware Finish =  
White  
Extruded  
Screen Mullion  
Rollers = Corrosion  
Resistant Roller/Glide  
= No

Screen  
Coverage =  
Full  
Interior Hardware  
Finish =White

Grid Options:

Flat  
Colonial  
Grid Color = White





2W1H

See Picture for Grids #W#H  
For Grid count, you must  
count bars not panes



Grid Locations:  
L = Left  
R = Right  
B = Bottom  
T = Top  
C = Center

LINE #	DESCRIPTION	QTY	PRICE	EXTENDED
11.	Room:Garage Floor: 1st	1	\$526.51	\$526.51

Item Name:

Series: 6100 VantagePointe Windows LMS STYLE CODE: Picture Windows Coastal (PWC)

Simonton	Color Options:	Rough Opening:	Glass Options:
6100 VantagePointe Windows Direct Set Fixed 25.75 x 29.5	Exterior Color = White Interior Color = White	26" X 30"	Glass Packages = Standard Low-E Glass Option = ProSolar Low Upper Window Strength = Lower Window Strength = Left Glass Strength = Right Glass Strength = Glass Style = None Left Glass Style = Right Glass Style = Upper Glass Style = Lower Glass Style = Glass Strength = Not Tempered Design Pressure = 50

Window Design Options:  
Installation Type =  
Replacement  
Operation / Venting -  
OUTSIDE LOOKING IN =  
Fixed

Sash Split =

Number Wide = 1

Screen Options: Interior Hardware Options:

Grid Options:

Flat  
Colonial  
Grid Color = White  
2W1H  
See Picture for Grids #W#H  
For Grid count, you must  
count bars not panes

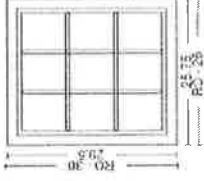

Grid Locations:

L = Left  
R = Right  
B = Bottom  
T = Top  
C = Center

LINE #	DESCRIPTION	QTY	PRICE	EXTENDED
12.	Room:Garage Floor: 1st	1	\$610.05	\$610.05

Notes: Grilles  
Pre-existing Conditions:

Item Name:

Series: 6100 VantagePointe Windows LMS STYLE CODE: Picture Windows Coastal (PWC)

Simonton	Color Options:	Rough Opening:	Glass Options:
6100 VantagePointe Windows Direct Set Fixed 53.75 x 38.5	Exterior Color = White Interior Color = White	54" X 39"	Glass Packages = Standard Low-E Glass Option = ProSolar Low Upper Window Strength = Lower Window Strength = Left Glass Strength = Right Glass Strength = Glass Style = None Left Glass Style = Right Glass Style = Upper Glass Style =

Lower Glass Style =  
 Glass Strength = Not Tempered  
 Design Pressure = 50

Window Design Options:  
 Installation Type =  
 Replacement  
 Operation / Venting -  
 OUTSIDE LOOKING IN =  
 Fixed

Screen Options: Interior Hardware Options:

Sash Split =  
 Number Wide = 1

Grid Options:

Flat  
 Colonial  
 Grid Color = White  
 4W1H  
 See Picture for Grids #W#H  
 For Grid count, you must  
 count bars not panes

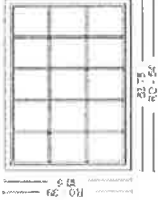

Grid Locations:

L = Left  
 R = Right  
 B = Bottom  
 T = Top  
 C = Center

LINE #	DESCRIPTION	QTY	PRICE	EXTENDED
13.	Room:Kitchen Floor: 1st	1	\$150.00	\$150.00

Notes: Grilles  
 Pre-existing Conditions:

Item Name:

\*\*\* Line Level Labor Codes  
 \*\*\*  
 Simonton 6500/6100E,  
 Double Hung, Assessed  
 Width = 37, Assessed  
 Height = 38, Kitchen, No  
 Window/Door Wraps, Misc  
 Labor Hours = 3, Misc  
 Labor Notes = temper  
 window in bath and obscure  
 glass



**Product Approval**  
 USER: Public User

Product Approval Menu > Product or Application Search > Application List > Application Detail

FL # **FL7612-R7**  
 Application Type **Revision**  
 Code Version **2010**  
 Application Status **Approved**

\* Approved by DCA. Approvals by DCA shall be reviewed and ratified by the POC and/or the Commission if necessary.

Comments Archived

Product Manufacturer **Simonton Windows**  
 Address/Phone/Email **1 Cochrane Ave  
 Pennsboro, WV 26415  
 (800) 746-6687 Ext 2329  
 tiffany\_davies@simonton.com**

Authorized Signature **Tiffany Davies  
 tiffany\_davies@simonton.com**

Technical Representative Address/Phone/Email **Tiffany Davies  
 PO Box 1646  
 5300 Briscoe Road  
 Parkersburg, WV 26102  
 (800) 542-9118 Ext. 9329  
 tiffany\_davies@simonton.com**

Quality Assurance Representative Address/Phone/Email **AAMA  
 1827 Walden Office Square  
 Suite 550  
 Schaumburg, IL 60173  
 (847) 303-5664  
 webmaster@aamanet.org**

Category Subcategory **Exterior Doors  
 Sliding Exterior Door Assemblies**

Compliance Method **Certification Mark or Listing**  
 Certification Agency **American Architectural Manufacturers Association  
 American Architectural Manufacturers Association**  
 Validated By

Referenced Standard and Year (of Standard) **Standard Year  
 AAMA 450 2006  
 AAMA/WDMA/CSA 101/1.S.2/A440 2005**

Equivalence of Product Standards Certified By

Product Approval Method **Method 1 Option A**  
 Date Submitted **03/11/2013**  
 Date Validated **03/14/2013**  
 Date Pending FBC Approval  
 Date Approved **03/20/2013**

7612.4	06-05	<p><b>Limits of Use</b>  <b>Approved for use in HVHZ:</b> No  <b>Approved for use outside HVHZ:</b> Yes  <b>Impact Resistant:</b> No  <b>Design Pressure:</b> +45/-45  <b>Other:</b> 71x116 Retrofit Installation</p>	<p>Created by Independent Third Party:                  Reflections 5300, Prism Ultra-Gold, THD 6100 Vantage Pointe, Grand Estates Plus, Sears 9300, Therma Tru (VSPD) Vinyl 2-Lite Sliding Patio Door with Transom (Retrofit Installation)</p> <p><b>Certification Agency Certificate</b>                  EL7612 R7 C CAC 06-05 SCD IR S410 Z1X116                  545.DM</p> <p><b>Quality Assurance Contract Expiration Date</b>                  01/29/2017</p> <p><b>Installation Instructions</b>                  EL7612 R7 I IN0413 06-05 2P PD W LTRN001 Z1 O01</p> <p>Verified By: American Architectural Manufacturers Association                  Created by Independent Third Party:  <b>Evaluation Reports</b>                  Created by Independent Third Party:</p>
7612.5	06-05	<p><b>Limits of Use</b>  <b>Approved for use in HVHZ:</b> No  <b>Approved for use outside HVHZ:</b> Yes  <b>Impact Resistant:</b> No  <b>Design Pressure:</b> N/A  <b>Other:</b> 95x80 (+/-35 PSF), 71x96 (+/-35 PSF), 71x80 (+/-50 PSF) Retrofit Installation</p>	<p><b>Certification Agency Certificate</b>                  EL7612 R7 C CAC 06-05 SCD R1260 R410 R50 DM                  EL7612 R7 C CAC 06-05 SCD 71X96 R410 DM                  EL7612 R7 L CAC 06-05 SCD R410 R50 R50 DM</p> <p><b>Quality Assurance Contract Expiration Date</b>                  03/30/2014</p> <p><b>Installation Instructions</b>                  EL7612 R7 I IN0412 06-05 2P PD 2X DM</p> <p>Verified By: American Architectural Manufacturers Association                  Created by Independent Third Party:  <b>Evaluation Reports</b>                  Created by Independent Third Party:</p>
7612.6	11-11		<p>Reflections 5500, Prism Platinum, Generations, Sears 9300, Impressions 9800, THD 6500 Vantage Pointe, Grand Estates Premier/Premium Plus, Grandura Vinyl 2-Lite Sliding Patio Door</p>
7612.7	11-11	<p><b>Limits of Use</b>  <b>Approved for use in HVHZ:</b> No  <b>Approved for use outside HVHZ:</b> Yes  <b>Impact Resistant:</b> No  <b>Design Pressure:</b> N/A  <b>Other:</b> 77x96 (+/-35 PSF), 96x80 (+/-50 PSF)</p>	<p><b>Certification Agency Certificate</b>                  EL7612 R7 C CAC 11-11 2P SCD 77X96 R35 DM                  EL7612 R7 C CAC 11-11 2P SCD 96X80 R50 DM</p> <p><b>Quality Assurance Contract Expiration Date</b>                  01/15/2014</p> <p><b>Installation Instructions</b>                  EL7612 R7 I IN0333 11-11 2P PD 2X DM</p> <p>Verified By: American Architectural Manufacturers Association                  Created by Independent Third Party:  <b>Evaluation Reports</b>                  Created by Independent Third Party:</p>
7612.8	11-11	<p><b>Limits of Use</b>  <b>Approved for use in HVHZ:</b> No  <b>Approved for use outside HVHZ:</b> Yes  <b>Impact Resistant:</b> No  <b>Design Pressure:</b> +35/-35  <b>Other:</b> 107X95</p>	<p>Reflections 5500, Prism Platinum, Generations, Sears 9300, Impressions 9800, THD 6500 Vantage Pointe, Grand Estates Premier/Premium Plus, Grandura Vinyl 3-Lite Sliding Patio Door</p> <p><b>Certification Agency Certificate</b>                  EL7612 R7 C CAC 11-11 3P SCD 107X95 R35 DM</p> <p><b>Quality Assurance Contract Expiration Date</b>                  05/13/2014</p> <p><b>Installation Instructions</b>                  EL7612 R7 I IN0334 11-11 3P PD 2X DM</p> <p>Verified By: American Architectural Manufacturers Association                  Created by Independent Third Party:  <b>Evaluation Reports</b>                  Created by Independent Third Party:</p>
7612.8	11-11		<p>Reflections 5500, Prism Platinum, Generations, Sears 9300, Impressions 9800, THD 6500 Vantage Pointe, Grand Estates Premier/Premium Plus, Grandura 4-Lite</p>

**MODEL DESIGNATION:** Simonton Series 06-05 2-Panel Vinyl Patio Door  
**MAXIMUM OVERALL NOMINAL SIZE:** See Size Chart  
**DESIGN PRESSURE RATING:** See Size Chart  
**USABLE CONFIGURATIONS:** XO, OX  
**GENERAL DESCRIPTION:** The head, sill, and side jambs are extruded PVC. The wall thickness through which the anchor screw penetrates is a minimum of 0.070".

NO P.E. SEAL REQUIRED  
 INSTALLATION SUPPORTED  
 BY AAMA TEST REPORTS

REV. #	REVISIONS:	REVISED BY:	DATE:
1	Revised Height Dim. to 95.5" from 79.5" & Width Dim. to 71.25" from 95.25"	JWW	4/17/09
2	UPDATED NOTES, GENERAL DESCRIPTION, AND ANCHOR LOCATIONS PER NEW TESTING.	T.D.D.	04/08/11
3	ADDED SIZES PER NEW TESTING.	T.D.D.	05/04/11
4	ADDED GLAZING DETAILS.	T.D.D.	06/20/11
5	ADDED GLAZING NOTE AND UPDATED SIZE CHART PER NEW TESTING.	T.D.D.	03/11/13

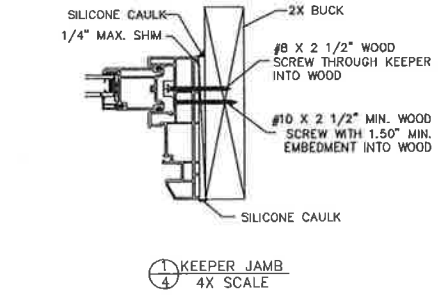
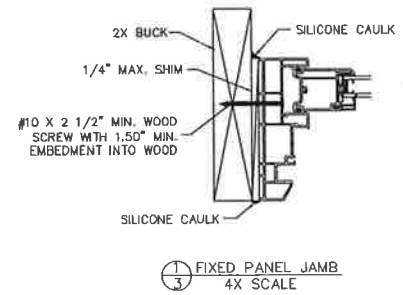
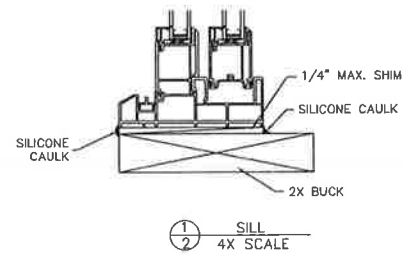
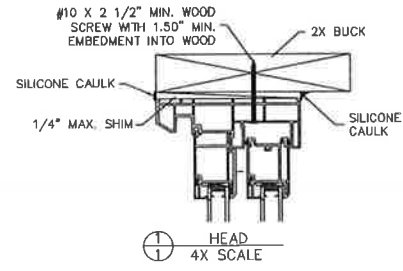
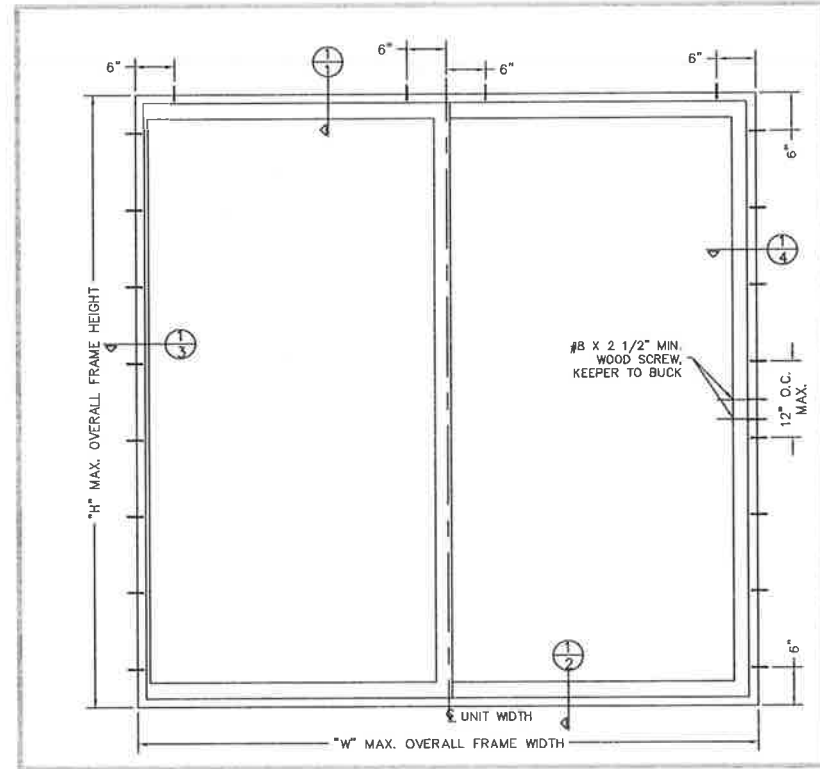

**NOTES:**

- This installation has been evaluated for use in locations adhering to the Texas & Florida Building Codes and where pressure requirements are determined by ASCE 7 Minimum Design Loads for Buildings and Other Structures do not exceed the design pressure ratings herein, for use outside the H.V.H.Z.
- All exterior perimeter surfaces of the door must be caulked. Interior caulking is optional unless noted otherwise.
- Anchors shall be specified and spaced as shown. Anchor embedment to base material shall be beyond wall dressing or stucco and into wood.
- The responsibility for selection of Simonton products to meet any applicable local laws, building codes, ordinances, or other safety requirements rests solely with the architect, building owner, or contractor.
- Shims are optional. Maximum shim stack is 1/4".
- Wood bucks (by others) must be engineered and anchored properly to transfer loads to the structure.
- When used in areas requiring impact protection, this product REQUIRES the use of approved impact resistant shutters or other external protection.
- Flashing should be applied using the ASTM E 2112 method appropriate for the opening into which the door is being installed.
- Installation anchors should be at least 3/4" from the edge of the wood.
- Glazing shall comply with ASTM E 1300-04 and safety glazing requirements per Florida Building Code section 2406.

SIZE CHART		
OVERALL SIZE	DP RATING	
WIDTH	HEIGHT	
"w"	"h"	
71"	96"	±35 PSF
95"	90"	±50 PSF
71"	80"	±50 PSF

**DISCLOSURE STATEMENT**  
 This document is the property of Simonton Windows, which retains all proprietary and other rights to its subject matter. This document is provided to the recipient on the expressed condition that it is not to be disclosed, reproduced in whole or part, nor used in conjunction with the design, manufacture or repair of goods for anyone other than Simonton Windows without its consent. This restriction does not limit the recipient's rights to utilize information contained in this document which is properly obtained from another source.

FILE: IN0412

MATERIAL:	
RMS FINISH:	EXCEPT AS NOTED
ALLOY & TEMPER:	
WEIGHT:	VOLUME:
SURFACE AREA:	PERIMETER:
FINISH TREATMENT:	

Dimensional Tolerances  
 Unless Otherwise Specified

Decimals	Angles
.X ± .03	0° 30 min.
.XX ± .01	
.XXX ± .005	

**SIMONTON**  
 WINDOWS  
 1 Cochran Avenue  
 Painsboro, WV 26415

SCALE: FIT SHEET: 1 of 1  
 SERIES: 06-05 2-PANEL PATIO DOOR  
 TITLE: 2X BUCK RETROFIT INSTALLATION (AS TESTED)

SIZE: DRAWING NO.: B IN0412 REV. 5  
 DRAWN BY: DATE: T.D.D. 04/10/09  
 CHECKED BY: DATE:  
 APPRVD BY: DATE:

6100 DH



[BCIS Home](#) | [Log In](#) | [User Registration](#) | [Hot Topics](#) | [Submit Surcharge](#) | [Stats & Facts](#) | [Publications](#) | [FBC Staff](#) | [BCIS Site Map](#) | [Links](#) | [Search](#)



**Product Approval**

USER: Public User

[Product Approval Details](#) > [Product of Jurisdiction Search](#) > [Administrative](#) > [Application Detail](#)

FL #

Application Type

Code Version

Application Status

FL167-R14  
 Revision  
 2010  
 Approved

Comments

Archived

\* Approved by DBPR. Approvals by DBPR shall be reviewed and ratified by the POC and/or the Commission if necessary.

Product Manufacturer  
Address/Phone/Email

Simonton Windows  
 1 Cochran Ave  
 Pennsboro, WV 26415  
 (800) 746-6687 Ext. 2329  
 tiffany\_davies@simonton.com

Authorized Signature

Tiffany Davies  
 tiffany\_davies@simonton.com

Technical Representative  
Address/Phone/Email

Tiffany Davies  
 PO Box 1646  
 5300 Briscoe Road  
 Parkersburg, WV 26102  
 (800) 542-9118 Ext. 9329  
 tiffany\_davies@simonton.com

Quality Assurance Representative  
Address/Phone/Email

AAMA  
 1827 Walden Office Square  
 Suite 550  
 Schaumburg, IL 60173  
 (847) 303-5664  
 webmaster@aamanet.org

Category  
Subcategory

Windows  
 Double Hung

Compliance Method

Certification Mark or Listing

Certification Agency  
Validated By

American Architectural Manufacturers Association  
 American Architectural Manufacturers Association

Referenced Standard and Year (of Standard)

Standard	Year
AAMA 450	2006
AAMA 450	2010
AAMA/WDMA/CSA 101/1.S.2 A440	2005
AAMA/WDMA/CSA 101/1.S.2 A440	2008

Equivalence of Product Standards  
Certified By

Product Approval Method

Method 1 Option A

Date Submitted 07/11/2013  
 Date Validated 08/29/2013  
 Date Pending FCC Approval  
 Date Approved 08/29/2013

Summary of Products	
FL #	Model, Number or Name
5167.1	07-09, 07-10 and 07-20 Reflections 5500, Prism Platinum, Sears 9300, Amcraft Grand Estates Premier Vinyl Double Hung <b>Certification Agency Certificate</b> Approved for use in HVHZ: No Approved for use outside HVHZ: Yes Impact Resistant: No Design Pressure: N/A Other: 48x80 (+/-25 PSF), 56x84 (+/-25 PSF), 53x76 (+/-50 PSF), 36x63 (+/-50 PSF), 44x64 (+/-50 PSF), 47x71 (+/-50 PSF), 37x84 (+/-60 PSF), 37x76 (+/-65 PSF)
5167.2	07-09, 07-10 and 07-20 Reflections 5500, Prism Platinum, Sears 9300, Amcraft Grand Estates Premier Vinyl Double Hung with Transom <b>Certification Agency Certificate</b> Approved for use in HVHZ: No Approved for use outside HVHZ: Yes Impact Resistant: No Design Pressure: N/A Other: 53x130 (+/-50 PSF) & 37x130 (+/-55 PSF)
5167.3	07-09, 07-10 and 07-20 Reflections 5500, Prism Platinum, Sears 9300, Amcraft Grand Estates Premier Vinyl Double Hung H-Multied Triple <b>Certification Agency Certificate</b> Approved for use in HVHZ: No Approved for use outside HVHZ: Yes Impact Resistant: No Design Pressure: N/A Other: 160x76 (+/-50 PSF), 126x76 (+/-50 PSF), 112x76 (+/-65 PSF)
5167.4	07-09, 07-10 and 07-20 Reflections 5500, Prism Platinum, Sears 9300, Amcraft Grand Estates Premier Vinyl Double Hung Triple with Transom Triple <b>Certification Agency Certificate</b> Approved for use in HVHZ: No Approved for use outside HVHZ: Yes Impact Resistant: No Design Pressure: +35/-35 Other: 109x88
5167.5	07-20 (Nailing Fin Installation) Reflections 5500, Prism Platinum, Sears 9300 Vinyl Double Hung <b>Certification Agency Certificate</b> Approved for use in HVHZ: No Approved for use outside HVHZ: Yes Impact Resistant: No Design Pressure: N/A Other: 56x84 (+/-25 PSF), 53x76 (+/-50 PSF) & 37x76 (+/-65 PSF)
5167.6	42-19 Profinish Brickmould 600 Vinyl Double Hung <b>Certification Agency Certificate</b> Approved for use in HVHZ: No Approved for use outside HVHZ: Yes Impact Resistant: No Design Pressure: N/A Other: 52x71 (+/-35 PSF), 48x80 (+/-35 PSF), 36x64 (+/-50 PSF), 36x74 (+/-50 PSF)

5167.7	42-19	<p><b>Evaluation Reports</b> Created by Independent Third Party: ProFinish Brickmould 600 Vinyl Double Hung Twin</p> <p><b>Certification Agency Certificate</b> 10/05/2014</p> <p><b>Quality Assurance Contract Expiration Date</b> 10/05/2014</p> <p><b>Installation Instructions</b> Verified By: American Architectural Manufacturers Association Created by Independent Third Party: <b>Evaluation Reports</b> Created by Independent Third Party:</p> <p><b>Certification Agency Certificate</b> ProFinish Brickmould 600 Vinyl Double Hung Triple</p> <p><b>Quality Assurance Contract Expiration Date</b> 10/05/2014</p> <p><b>Installation Instructions</b> Verified By: American Architectural Manufacturers Association Created by Independent Third Party: <b>Evaluation Reports</b> Created by Independent Third Party:</p> <p><b>Certification Agency Certificate</b> ProFinish Contractor, ProFinish Master and Amcraft Grand Estates New Construction Vinyl Double Hung</p>
5167.8	42-19	<p><b>Limits of Use</b> Approved for use in HVHZ: No Approved for use outside HVHZ: Yes Impact Resistant: No Design Pressure: N/A Other: 89x63 (+/-30 PSF), 97x80 (+/-30 PSF), 73x63 (+/-35), 73x76 (+/-50 PSF)</p> <p><b>Limits of Use</b> Approved for use in HVHZ: No Approved for use outside HVHZ: Yes Impact Resistant: No Design Pressure: +35/-35 Other: 109x74</p> <p><b>Certification Agency Certificate</b> ProFinish Contractor, ProFinish Master and Amcraft Grand Estates New Construction Vinyl Double Hung</p> <p><b>Quality Assurance Contract Expiration Date</b> 03/31/2014</p> <p><b>Installation Instructions</b> Verified By: American Architectural Manufacturers Association Created by Independent Third Party: <b>Evaluation Reports</b> Created by Independent Third Party:</p> <p><b>Certification Agency Certificate</b> ProFinish Contractor, ProFinish Master and Amcraft Grand Estates New Construction Vinyl Double Hung</p>
5167.9	43-17	<p><b>Limits of Use</b> Approved for use in HVHZ: No Approved for use outside HVHZ: Yes Impact Resistant: No Design Pressure: N/A Other: 36x72 (+/-30 PSF), 48x80 (+/-30 PSF), 53x71 (+/-35 PSF), 44x63 (+/-35 PSF), 48x80 (+/-35 PSF), 36x63 (+/-45 PSF), 44x63 (+/-45 PSF), 26x76 (+/-50 PSF) &amp; 36x74 (+/-50 PSF), 32x62 (+/-50 PSF)</p> <p><b>Limits of Use</b> Approved for use in HVHZ: No Approved for use outside HVHZ: Yes Impact Resistant: No Design Pressure: N/A Other: 96x80 (+/-25 PSF), 89x63 (+/-30 PSF), 73x63 (+/-35 PSF) &amp; 72x74 (+/-45 PSF)</p> <p><b>Certification Agency Certificate</b> ProFinish Contractor, ProFinish Master and Amcraft Grand Estates New Construction Vinyl Double Hung T-mulled Twin</p>
5167.10	43-17	<p><b>Limits of Use</b> Approved for use in HVHZ: No Approved for use outside HVHZ: Yes Impact Resistant: No Design Pressure: N/A Other: 96x80 (+/-25 PSF), 89x63 (+/-30 PSF), 73x63 (+/-35 PSF) &amp; 72x74 (+/-45 PSF)</p> <p><b>Certification Agency Certificate</b> ProFinish Contractor, ProFinish Master and Amcraft Grand Estates New Construction Vinyl Double Hung</p>
5167.11	43-35 (Two-Step Sill)	<p><b>Limits of Use</b> Approved for use in HVHZ: No Approved for use outside HVHZ: Yes Impact Resistant: No Design Pressure: N/A Other: 44x63 (+/-25 PSF), 46x84 (+/-25 PSF), 36x72 (+/-30 PSF), 48x80 (+/-35 PSF), 52x71 (+/-35 PSF)</p> <p><b>Certification Agency Certificate</b> ProFinish Contractor, ProFinish Master and Amcraft Grand Estates New Construction Vinyl Double Hung</p> <p><b>Quality Assurance Contract Expiration Date</b> 10/20/2016</p> <p><b>Installation Instructions</b> Verified By: American Architectural Manufacturers Association Created by Independent Third Party: <b>Evaluation Reports</b> Created by Independent Third Party:</p> <p><b>Certification Agency Certificate</b> ProFinish Contractor, ProFinish Master and Amcraft Grand Estates New Construction Vinyl Double Hung</p>
5167.12	43-35 (Two-Step Sill) and 43-50 (Three-Step Sill)	<p><b>Limits of Use</b> Approved for use in HVHZ: No Approved for use outside HVHZ: Yes Impact Resistant: No Design Pressure: +35/-35 Other: 73x111</p> <p><b>Certification Agency Certificate</b> ProFinish Contractor, ProFinish Master and Amcraft Grand Estates New Construction Vinyl Double Hung</p> <p><b>Quality Assurance Contract Expiration Date</b> 01/24/2016</p> <p><b>Installation Instructions</b> Verified By: American Architectural Manufacturers Association Created by Independent Third Party: <b>Evaluation Reports</b> Created by Independent Third Party:</p> <p><b>Certification Agency Certificate</b> ProFinish Contractor, ProFinish Master and Amcraft Grand Estates New Construction Vinyl Double Hung</p>
5167.13	43-40 and 43-45	<p><b>Limits of Use</b> Approved for use in HVHZ: No Approved for use outside HVHZ: Yes Impact Resistant: No</p> <p><b>Certification Agency Certificate</b> ProFinish Contractor, ProFinish Master and Amcraft Grand Estates New Construction Vinyl Double Hung</p> <p><b>Quality Assurance Contract Expiration Date</b> 01/24/2016</p> <p><b>Installation Instructions</b> Verified By: American Architectural Manufacturers Association Created by Independent Third Party: <b>Evaluation Reports</b> Created by Independent Third Party:</p> <p><b>Certification Agency Certificate</b> ProFinish Contractor, ProFinish Master and Amcraft Grand Estates New Construction Vinyl Double Hung</p>



**MODEL DESIGNATION:** Simonton Double Hung Series 43-40 Vinyl Window

**MAXIMUM OVERALL NOMINAL SIZE:** See Size Chart

**DESIGN PRESSURE RATING:** See Size Chart

**USABLE CONFIGURATIONS:**  
 X  
 X

**GENERAL DESCRIPTION:** The head, sill, and side jams are extruded PVC. The wall thickness through which the anchor screw penetrates is a minimum of 0.070".

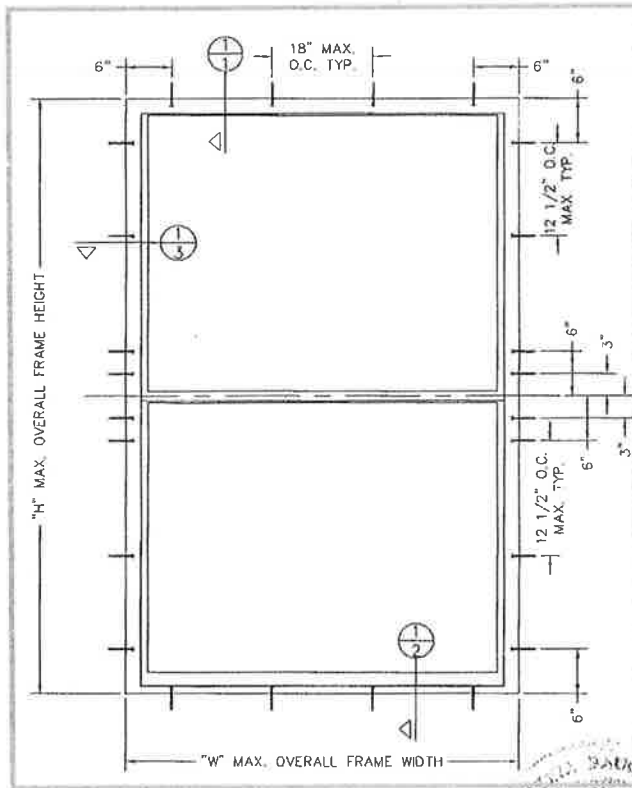

SIZE CHART		
OVERALL SIZE		DP RATING
WIDTH "W"	HEIGHT "H"	
48"	80"	±15 PSF
36"	72"	±30 PSF
48"	80"	±35 PSF
52"	71"	±35 PSF
36"	63"	±45 PSF
32"	62"	±50 PSF
36"	74"	±50 PSF

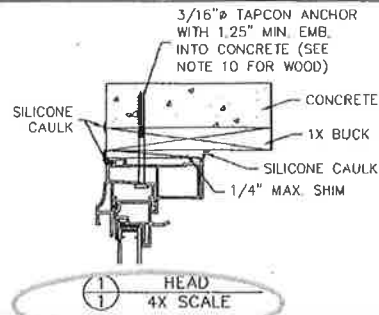

1  
1 HEAD  
4X SCALE

REV. #	REVISIONS:	REVISED BY:	DATE:
1	UPDATED NOTES, GENERAL DESCRIPTION, AND SIZE CHART	T.O.D.	12/23/09
2	ADDED BUCK FOR P.E. SEAL AND REMOVED 43-45 SASH-FRAME CODE	T.O.D.	02/01/10

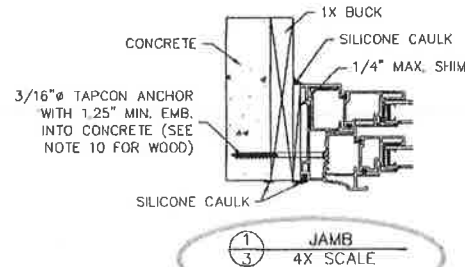

1  
3 JAMB  
4X SCALE

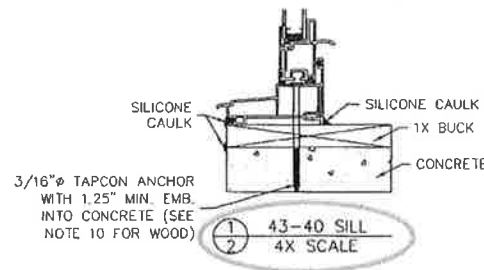

1  
2 43-40 SILL  
4X SCALE

**NOTES:**

- This information has been evaluated for use in locations adhering to the Florida Building Code and where design pressure requirements as determined by ASCE 7 Minimum Design Loads for Buildings and Other Structures do not exceed the design pressure ratings listed herein.
- For installation where the sub-buck is less than 1 1/2" (FBC section 1707.4.4 Anchorage Methods and subsections 1707.4.4.1 and 1707.4.4.2) Tapcon type concrete anchors must be used and the length must be such that a minimum of 1 1/4" embedment of the Tapcon into the concrete is obtained. Anchors should be a minimum of 2 1/2" from the edge of the concrete or concrete-filled block.
- All interior and exterior perimeter surfaces of the window must be caulked.
- Adjust Tapcon anchor head expanders, if necessary, to maintain a minimum 2.0" distance from mortar joints.
- When the optional head expander is used, the INSTALLER MUST ADJUST the anchor lengths to maintain the required minimum embedment into the substrate.
- Anchors shall be specified and spaced as shown. Anchor embedment to base material shall be beyond wall dressing or stucco and into wood or concrete.
- Wood bucks (by others) must be engineered and anchored properly to transfer loads to the structure.
- Follow ITW/Elco Tapcon anchoring instructions.
- The responsibility for selection of Simonton products to meet any applicable local laws, building codes, ordinances, or other safety requirements rests solely with the architect, building owner, or contractor.
- For woodbuck substrates, use #10 wood screws with 1 1/2" minimum embedment into wood. Screws should be a minimum of 3/4" from the edge of the wood.
- Concrete compressive strength = 3000 PSI at 28 days.
- Shims are optional. Maximum shim stack is 1/4".
- When using a 3/16" Tapcon or #10 wood screw through the window frame, pre-drill the thru hole at specified installation screw locations.
- When used in areas requiring impact protection, this product REQUIRES the use of approved impact resistant shutters or other external protection.

*Handwritten signature and date: 4/24/10*  
 DISTRICT S. Dougherty  
 License P.E. No. 66425  
 172 N. Foxboro Ave., Ste 430  
 Winter Park, FL 32789  
 FBCE Cert. of Authorization No. 26520

**DISCLOSURE STATEMENT**  
 This document is the property of Simonton Windows, which retains all proprietary and other rights to its subject matter. This document is provided to the recipient on the expressed condition that it is not to be disclosed, reproduced in whole or part, nor used in conjunction with the design, manufacture or repair of goods for anyone other than Simonton Windows without its consent. This restriction does not limit the recipient's rights to utilize information contained in this document which is properly obtained from another source.

MATERIAL:	
FINISH:	FINISH AS NOTED
WEIGHT:	VOLUME:
SURFACE AREA:	PERIMETER:
FINISH TREATMENT:	

Dimensional Tolerances Unless Otherwise Specified	
Decimals	Angles
X ± .03	1' 30 min.
.XX ± .01	
.XXX ± .005	

**SIMONTON WINDOWS**  
 1 Cochtone Avenue  
 Pennsboro, WV 26415

SIZE: 6	DRAWING NO.: IN0434	REV.: 2
DRAWN BY: T.O.D.	DATE: 09/16/09	CHECKED BY: DATE:
SCALE: FIT	SHEET: 1 of 1	APPRVD BY: DATE:
SERIES: 43-40	DOUBLE HUNG	
TITLE: 1X BUCK INSTALLATION		

MODEL DESIGNATION: Simonton Double Hung Series 43-35 Vinyl Window

MAXIMUM OVERALL NOMINAL SIZE: See Size Chart

DESIGN PRESSURE RATING: See Size Chart

USABLE CONFIGURATIONS:  $\frac{X}{X}$

GENERAL DESCRIPTION: The head, sill, and side jambs are extruded PVC. The wall thickness through which the anchor screw penetrates is a minimum of 0.070".

NO P.E. SEAL REQUIRED  
INSTALLATION SUPPORTED  
BY AAMA TEST REPORTS

REV. #	REVISIONS:	REVISED BY:	DATE:
1	UPDATED SIZE PER TEST REPORT #89924.01.	T.D.D.	01/04/10
2	UPDATED SASH-FRAME CODE, FRAME AND SIZES PER NEW TESTING.	T.D.D.	02/23/12
-	-	-	-
-	-	-	-

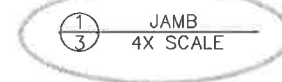
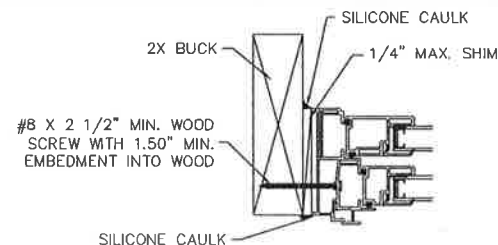
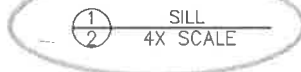
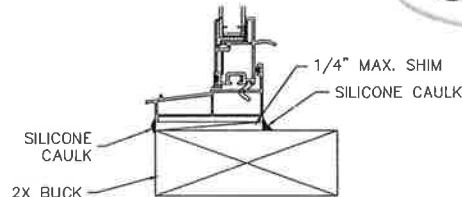
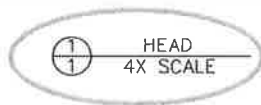
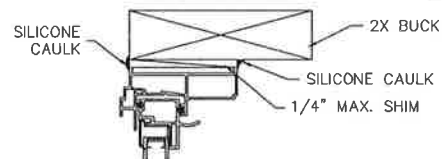
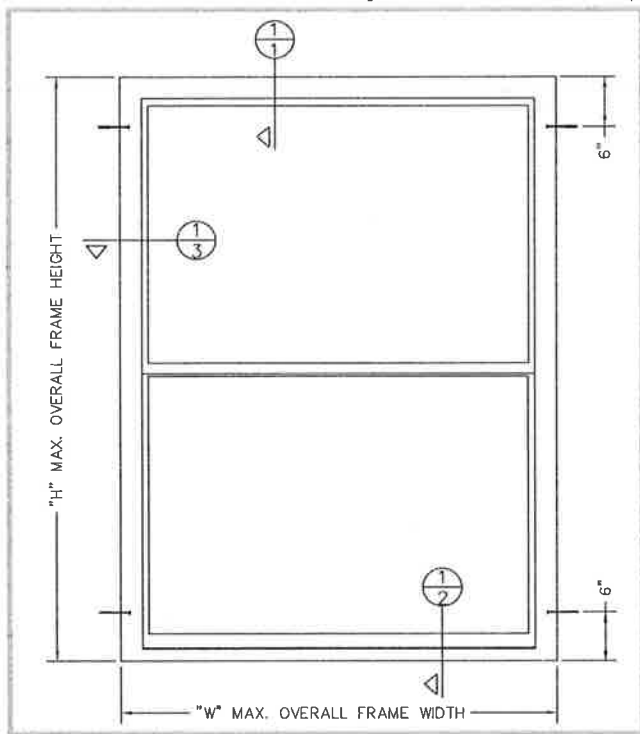

NOTES:

1. This installation has been evaluated for use in locations adhering to the Texas & Florida Building Codes and where pressure requirements as determined by ASCE 7 Minimum Design Loads for Buildings and Other Structures do not exceed the design pressure ratings herein, for use outside the H.V.H.Z.
2. All exterior perimeter surfaces of the window must be caulked. Interior caulking is optional unless noted otherwise.
3. Anchors shall be as specified and spaced as shown. Anchor embedment to base material shall be beyond wall dressing or stucco and into wood.
4. The responsibility for selection of Simonton products to meet any applicable local laws, building codes, ordinances, or other safety requirements rests solely with the architect, building owner, or contractor.
5. Shims are optional. Max. shim stack is 1/4".
6. Wood bucks (by others) must be engineered and anchored properly to transfer loads to the structure.
7. When used in areas requiring impact protection this product REQUIRES the use of approved impact resistant shutters or other external protection.
8. Flashing should be applied using the ASTM E 2112 methodology appropriate for the opening into which the window is being installed.
9. Installation screws must be at least 3/4" from the edge of the wood.
10. Installation screws may be placed in the interior or exterior track of the jamb. Screws should be flush with the vinyl.
11. Glazing shall comply with ASTM E 1300-04.

SIZE CHART		
OVERALL SIZE		DP RATING
WIDTH "W"	HEIGHT "H"	
46"	84"	±25 PSF
44"	83"	
36"	72"	±30 PSF
48"	80"	
52"	71"	±35 PSF

DISCLOSURE STATEMENT		MATERIAL		Dimensional Tolerances Unless Otherwise Specified		SIMINTON WINDOWS		SIZE DRAWING NO.:		REV.
This document is the property of Simonton Windows, which retains all proprietary and other rights to its subject matter. This document is provided to the recipient on the expressed condition that it is not to be disclosed, reproduced in whole or part, nor used in conjunction with the design, manufacture or repair of goods for anyone other than Simonton Windows without its consent. This restriction does not limit the recipient's rights to utilize information contained in this document which is properly obtained from another source.		KWS FINISH: EXCEPT AS NOTED		Decimals Angle		1 Cochran Avenue Pennsboro, WV 26415		A IN0105		2
FILE: IN0105		ALLOY & TEMPER:		.X ± .03 .XX ± .01 .XXX ± .005		1 Cochran Avenue Pennsboro, WV 26415		DRAWN BY: DATE: GLS 11/16/06		
		WEIGHT: VOLUME:		0' 30 min.		1 Cochran Avenue Pennsboro, WV 26415		CHECKED BY: DATE:		
		SURFACE AREA: PERIMETER:				1 Cochran Avenue Pennsboro, WV 26415		APPRVD BY: DATE:		
		FINISH TREATMENT:				1 Cochran Avenue Pennsboro, WV 26415		SERIES: 43-35 DOUBLE HUNG		
						1 Cochran Avenue Pennsboro, WV 26415		SHEET: 1 of 1		
						1 Cochran Avenue Pennsboro, WV 26415		TITLE: 2X BUCK INSTALLATION (AS TESTED)		

6100 Fixed



[BCIS Home](#) | [Log In](#) | [User Registration](#) | [Hot Topics](#) | [Submit Surcharge](#) | [Stats & Facts](#) | [Publications](#) | [FBC Staff](#) | [BCIS Site Map](#) | [Links](#) | [Search](#)



**Product Approval**

USER: Public User

[Product Approval Menu](#) > [Product or Application Search](#) > [Application List](#) > [Application Detail](#)



FL #

Application Type

Code Version

Application Status

FL5177-R12

Revision

2010

Approved

Comments

Archived

\*Approved by DBPR. Approvals by DBPR shall be reviewed and ratified by the POC and/or the Commission if necessary.

Product Manufacturer Address/Phone/Email

Simonton Windows  
1 Cochrane Ave  
Pennsboro, WV 26415  
(800) 746-6687 Ext 2329  
tiffany\_davies@simonton.com

Authorized Signature

Tiffany Davies  
tiffany\_davies@simonton.com

Technical Representative Address/Phone/Email

Tiffany Davies  
PO Box 1646  
5300 Briscoe Road  
Parkersburg, WV 26102  
(800) 542-9118 Ext 9329  
tiffany\_davies@simonton.com

Quality Assurance Representative Address/Phone/Email

AAMA  
1827 Walden Office Square  
Suite 550  
Schaumburg, IL 60173  
(847) 303-5664  
webmaster@aamanet.org

Category Subcategory

Windows Fixed

Compliance Method

Certification Mark or Listing

Certification Agency Validated By

American Architectural Manufacturers Association  
American Architectural Manufacturers Association

Referenced Standard and Year (of Standard)

Standard	Year
AAMA 450	2010
AAMA/WDMA/CSA 101/I.S 2/A440	2005
AAMA/WDMA/CSA 101/I.S 2/A440	2008
ASTM E 1300	2004

Equivalence of Product Standards Certified By

Product Approval Method

Method 1 Option A

Date Submitted

07/11/2013

Date Validated

07/15/2013

Date Pending FBC Approval

07/23/2013

Date Approved

Summary of Products	
FL #	Model, Number or Name
5177.1	07-09, 07-10, 07-20 (Retrofit Installation)
<p><b>Limits of Use</b>                      Approved for use in HVHZ: No                      Approved for use outside HVHZ: Yes                      Impact Resistant: No                      Design Pressure: N/A                      Other: 74x63 (+/-55 PSF), 37x84 (+/-50 PSF)</p>	
<p><b>Description</b>                      Reflections 5500, Prism Platinum, Sears 9300, Impressions 9800, Generations, Grand Estates Premier, Grand Estates Premium Plus, Grandura Vinyl Fixed Window</p> <p><b>Certification Agency Certificate</b>                      FLS177_R12_C_CAC_07-09_PV_37X84_550.pdf                      FLS177_R12_C_CAC_07-09_PV_74X63_P60.pdf                      FLS177_R12_C_CAC_10_20_WAIVER_10_09.pdf</p> <p><b>Quality Assurance Contract Expiration Date</b>                      07/23/2014</p> <p><b>Installation Instructions</b>                      FLS177_R12_IL_IN0108_07-09_07-10_07-20_PV_1X.pdf                      FLS177_R12_IL_IN0111_07-09_07-10_07-20_PV_1X.pdf                      Verified By: American Architectural Manufacturers Association                      Created by Independent Third Party:  <b>Evaluation Reports</b>                      FLS177_R12_AE_PER_2208_07-09_07-10_07-20_Fixed Window_1X.pdf                      Created by Independent Third Party: Yes</p>	
5177.2	07-20 (Nailing Fin Installation)
<p><b>Limits of Use</b>                      Approved for use in HVHZ: No                      Approved for use outside HVHZ: Yes                      Impact Resistant: No                      Design Pressure: N/A                      Other: 96x72 (+/-45 PSF), 37x84 (+/-50 PSF), 74x63 (+/-60 PSF)</p>	
<p><b>Description</b>                      Reflections 5500, Prism Platinum, Sears 9300, Impressions 9800, Generations, Grand Estates Premier, Grand Estates Premium Plus, Grandura Vinyl Fixed Window</p> <p><b>Certification Agency Certificate</b>                      FLS177_R12_C_CAC_07-20_PV_74X63_550.pdf                      FLS177_R12_C_CAC_07-20_PV_74X63_P60.pdf                      FLS177_R12_C_CAC_07-20_PV_96X72_945.pdf</p> <p><b>Quality Assurance Contract Expiration Date</b>                      11/01/2014</p> <p><b>Installation Instructions</b>                      FLS177_R12_IL_IN0114_07-20_PV_2X.pdf                      Verified By: American Architectural Manufacturers Association                      Created by Independent Third Party:  <b>Evaluation Reports</b>                      Created by Independent Third Party:</p>	
5177.3	07-75, 07-09, 07-10, 07-20
<p><b>Limits of Use</b>                      Approved for use in HVHZ: No                      Approved for use outside HVHZ: Yes                      Impact Resistant: No                      Design Pressure: N/A                      Other: 96x72 (+/-45 PSF), 63x63 (+/-50 PSF), 72x63 (+/-60 PSF)</p>	
<p><b>Description</b>                      Reflections 5500, Prism Platinum, Sears 9300, Impressions 9800, Generations, Grand Estates Premier, Grand Estates Premium Plus, Grandura, THD 6500 Vantage Pointe Vinyl Fixed Window</p> <p><b>Certification Agency Certificate</b>                      FLS177_R12_C_CAC_07-09_07-25_PV_63X63_LC50.pdf                      FLS177_R12_C_CAC_07-09_07-25_PV_72X63_LC50.pdf                      FLS177_R12_C_CAC_07-09_07-25_PV_96X72_LC50.pdf                      FLS177_R12_C_CAC_10_20_WAIVER_10_09.pdf</p> <p><b>Quality Assurance Contract Expiration Date</b>                      -11/18/2013</p> <p><b>Installation Instructions</b>                      FLS177_R12_IL_IN0224_07-25_PV_1X.pdf                      FLS177_R12_IL_IN0224_07-25_07-09_07-10_07-20_PV_2X.pdf</p> <p>Verified By: American Architectural Manufacturers Association                      Created by Independent Third Party:  <b>Evaluation Reports</b>                      FLS177_R12_AE_PER_1013_07-25_Fixed Window</p>	

Association Created by Independent Third Party: <b>Evaluation Reports</b> FL5177_R12_AE_PER_2309-43-17_FixedWindow_1X_SS.pdf Created by Independent Third Party: Yes	
5177.14	43-35  <b>Limits of Use</b> Approved for use in HVHZ: No Approved for use outside HVHZ: Yes Impact Resistant: No Design Pressure: N/A Other: 96x72 (+/-40 PSF), 74x63 (+/-50 PSF), 80x48 (+/-50 PSF)
6100 Vantage Pointe,ASURE, Prism Gold, Grand Estates, Vinyl Fixed Window  <b>Certification Agency Certificate</b> FL5177_R12_C_CAC_43-35_PV_74x63_1C50.pdf FL5177_R12_C_CAC_43-35_PV_80x48_1C50.pdf FL5177_R12_C_CAC_43-35_PV_96x72_1C40.pdf <b>Quality Assurance Contract Expiration Date</b> 09/10/2016 <b>Installation Instructions</b> FL5177_R12_I_IN08443-35_PV_2X.pdf Verified By: American Architectural Manufacturers Association Created by Independent Third Party: <b>Evaluation Reports</b> Created by Independent Third Party:	
5177.15	43-35  <b>Limits of Use</b> Approved for use in HVHZ: No Approved for use outside HVHZ: Yes Impact Resistant: No Design Pressure: +50/-50 Other: 109x72
6100 Vantage Pointe,ASURE, Prism Gold, Grand Estates Vinyl Fixed Window Triple  <b>Certification Agency Certificate</b> FL5177_R12_C_CAC_43-35_PV_Trip_109x72_80.pdf <b>Quality Assurance Contract Expiration Date</b> 01/25/2016 <b>Installation Instructions</b> FL5177_R12_I_IN035643-35_PV_Trip_2X.pdf Verified By: American Architectural Manufacturers Association Created by Independent Third Party: <b>Evaluation Reports</b> Created by Independent Third Party:	
5177.16	43-35  <b>Limits of Use</b> Approved for use in HVHZ: No Approved for use outside HVHZ: Yes Impact Resistant: No Design Pressure: +35/-35 Other: 73x111
6100 Vantage Pointe,ASURE, Prism Gold, Grand Estates Vinyl Fixed Window Twin with Transom  <b>Certification Agency Certificate</b> FL5177_R12_C_CAC_43-35_PV_Twin_VL_T80_73x111_835.pdf <b>Quality Assurance Contract Expiration Date</b> 01/25/2016 <b>Installation Instructions</b> FL5177_R12_I_IN025543-35_PV_InVn_VL_T80_2X.pdf Verified By: American Architectural Manufacturers Association Created by Independent Third Party: <b>Evaluation Reports</b> Created by Independent Third Party:	
5177.17	43-40  <b>Limits of Use</b> Approved for use in HVHZ: No Approved for use outside HVHZ: Yes Impact Resistant: No Design Pressure: N/A Other: 96x72 (+/-40 PSF), 74x63 (+/-50 PSF), 80x48 (+/-50 PSF)
Reflections 5050/5300, Prism Bronze/Ultra Gold, Impressions 9400, THD Vantage Pointe 6100, Grand Estates, Grand Estates Plus Vinyl Fixed Window  <b>Certification Agency Certificate</b> FL5177_R12_C_CAC_43-40_PV_ZA62_1C50.pdf FL5177_R12_C_CAC_43-40_PV_S048_1C50.pdf FL5177_R12_C_CAC_43-40_PV_96x72_1C40.pdf <b>Quality Assurance Contract Expiration Date</b> 10/05/2016 <b>Installation Instructions</b> FL5177_R12_I_IN018443-40_PV_2X.pdf Verified By: American Architectural Manufacturers Association Created by Independent Third Party: <b>Evaluation Reports</b> Created by Independent Third Party:	

[Back](#)

[Next](#)

Contact Us :: 1940 North Monroe Street, Tallahassee, FL 32399 Phone: 850-487-1824

The State of Florida is an AA/EEO employer. Copyright 2007-2010 State of Florida. :: [Privacy Statement](#) :: [Accessibility Statement](#) :: [Refund Statement](#)

MODEL DESIGNATION: Simonton Series 43-40 Vinyl Fixed Window

MAXIMUM OVERALL NOMINAL SIZE: See Size Chart

DESIGN PRESSURE RATING: See Size Chart

USABLE CONFIGURATIONS: 0

GENERAL DESCRIPTION: The head, sill, and side jambs are extruded PVC. The wall thickness through which the anchor screw penetrates is a minimum of 0.120".

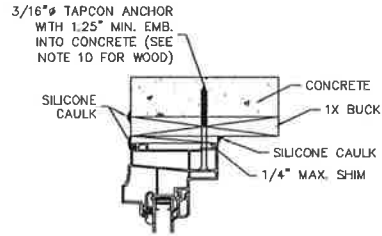
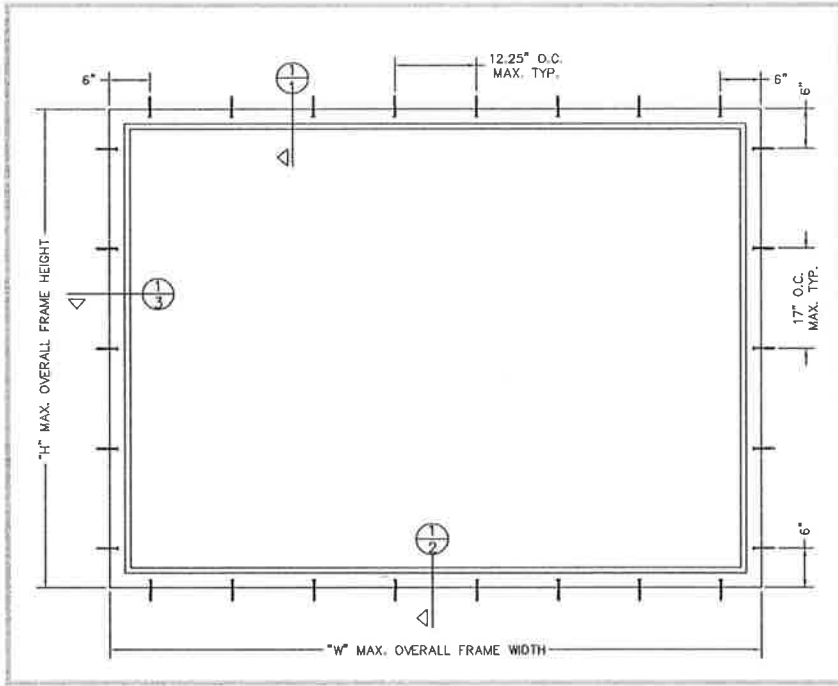

HEAD  
4X SCALE

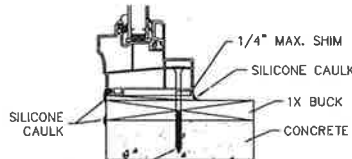

SILL  
4X SCALE

REV. #	REVISIONS:	REVISED BY:	DATE:
1	UPDATED GENERAL DESCRIPTION, NOTES AND SIZE CHART.	T.D.D.	03/02/10
2	UPDATED ANCHOR SPACING AND ADDED NOTES 15 & 16.	T.D.D.	11/27/11

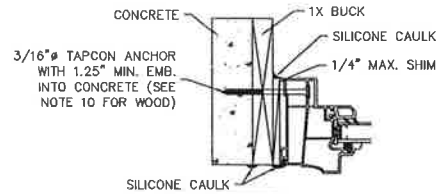

JAMB  
4X SCALE

- NOTES:
- This installation has been evaluated for use in locations adhering to the Florida Building Code and where design pressure requirements as determined by ASCE 7 Minimum Design Loads for Buildings and Other Structures do not exceed the design pressure ratings listed herein.
  - For installation where the sub-buck is less than 1 1/2" (FBC chapter 17 Anchorage Methods) Tapcon type concrete anchors must be used and the length must be such that a minimum 1 1/4" embedment of the Tapcon into the concrete or concrete block is obtained, unless otherwise noted. Anchors should be a minimum of 2 1/2" from the edge of the concrete, hollow block CMU, or concrete block.
  - All interior and exterior perimeter surfaces of the window must be caulked.
  - Adjust Tapcon anchor locations, if necessary, to maintain a minimum of 2.0" clearance from mortar joints.
  - When the optional head expanders are used, the INSTALLER MUST ADJUST the anchor lengths to maintain the required minimum embedment into the substrate.
  - Anchors shall be specified and spaced as shown. Anchor embedment to base material shall be beyond wall dressing or stucco and into wood or concrete.
  - Wood bucks (by others) must be engineered and anchored properly to transfer loads to the structure. Bucks shall extend beyond interior face of frame such that full support of the frame is provided.
  - Follow ITW/Elco Tapcon anchoring instructions.
  - The responsibility for selection of Simonton Products to meet any applicable local laws, building codes, ordinances, or other safety requirements rests solely with the architect, building owner, or contractor.
  - For woodbuck substrates, use #10 wood screws with 1 1/2" min. embedment into wood, unless otherwise noted. Screws should be a minimum of 3/4" from the edge of the wood.
  - A. Concrete compressive strength = 3000 PSI at 28 days.  
B. Concrete Masonry Units shall conform with strength requirements of ASTM C90.  
C. Wood Minimum Specific Gravity = 0.55
  - Shims are optional. Max shim stack is 1/4".
  - When using a 3/16" Tapcon or #10 wood screw through the window frame, pre-drill the thru hole at specified installation screw locations.
  - When used in areas requiring impact protection, this product REQUIRES the use of approved impact resistant shutters or other external protection.
  - Flashing should be applied using the ASTM E 2112 method appropriate for the opening into which the window is being installed.
  - Glazing shall comply with ASTM E 1300-04.

SIZE CHART		
OVERALL SIZE		DP RATING
WIDTH "W"	HEIGHT "H"	
96"	72"	±40 PSF
74"	63"	±50 PSF
60"	48"	±50 PSF



ALEX SPYROU  
2012.02.06 17:58:42  
-05'00'

**DISCLOSURE STATEMENT**  
This document is the property of Simonton Windows, which retains all proprietary and other rights to its subject matter. This document is provided to the recipient on the expressed condition that it is not to be disclosed, reproduced in whole or in part, nor used in conjunction with the design, manufacture or repair of goods for anyone other than Simonton Windows without its consent. This restriction does not limit the recipient's rights to utilize information contained in this document which is properly obtained from another source.

MATERIALS:	
RMS FINISH:	EXCEPT AS NOTED
ALLOY & TEMPER:	
WEIGHT:	VOLUME:
SURFACE AREA:	PERIMETER:
FINISH TREATMENT:	

Dimensional Tolerances Unless Otherwise Specified.	
Decimals	Angles
.X ± .03	0° 30 min.
.XX ± .01	
.XXX ± .005	

**SIMONTON**  
WINDOWS  
1 Cochran Avenue  
Pennsboro, WV 26415

SCALE: FT	SHEET: 1 of 1	APPRVD BY: DATE:
SERIES: 43-40 PICTURE (FIXED) WINDOW		
TITLE: 1X BUCK INSTALLATION		

FILE: IN0095

MODEL DESIGNATION: Simonton Series 43-40 Vinyl Fixed Window  
 MAXIMUM OVERALL NOMINAL SIZE: See Size Chart  
 DESIGN PRESSURE RATING: See Size Chart  
 USABLE CONFIGURATIONS: 0  
 GENERAL DESCRIPTION: The head, sill, and side jambs are extruded PVC. The wall thickness through which the anchor screw penetrates is a minimum of 0.070".

NO P.E. SEAL REQUIRED  
 INSTALLATION SUPPORTED  
 BY AAMA TEST REPORTS

REV. #	REVISIONS:	REVISED BY:	DATE:
1	REMOVED "CONCRETE" FROM TITLE.	T.D.D.	11/02/07
2	ADDED "NO PE SEAL REQUIRED" & "43-40 ONLY" NOTES	T.D.D.	10/17/08
3	UPDATED SIZE CHART PER TEST REPORT #BB427.01	T.D.D.	11/23/09
4	UPDATED NOTES AND GENERAL DESCRIPTION.	T.D.D.	03/31/11

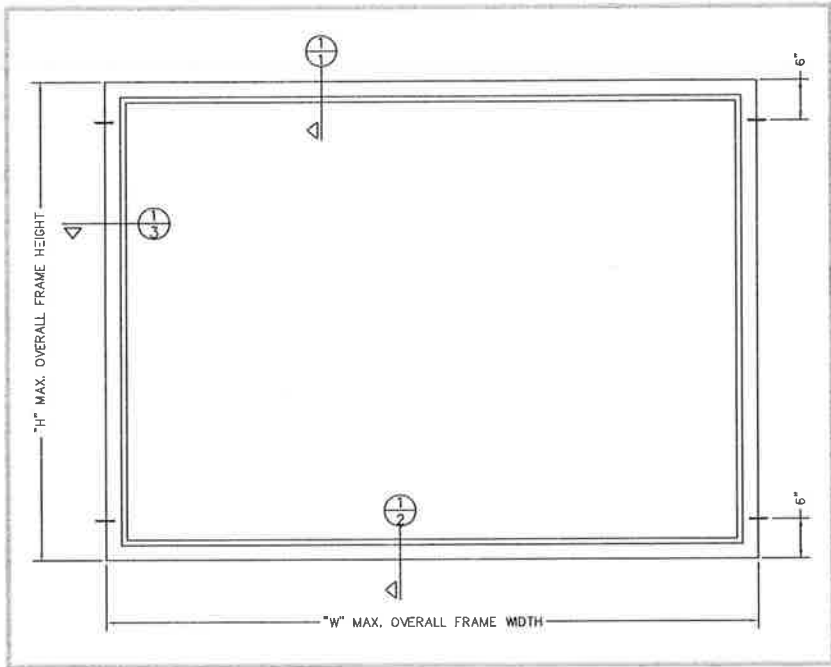

SIZE CHART		
OVERALL SIZE		DP RATING
WIDTH "W"	HEIGHT "H"	
96"	72"	±40 PSF
74"	63"	±50 PSF
80"	48"	±50 PSF

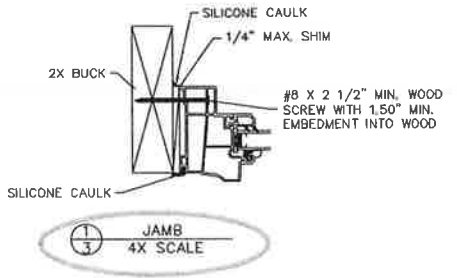
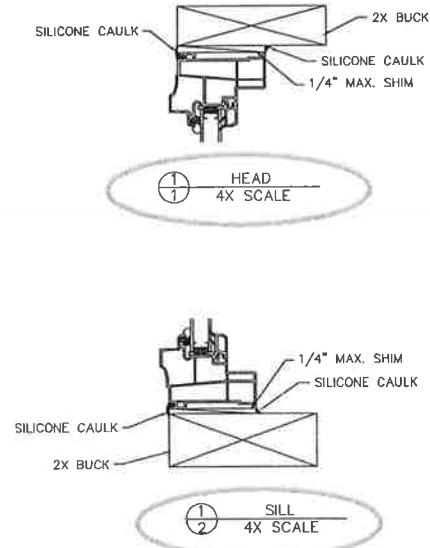

- NOTES:
- This installation has been evaluated for use in locations adhering to the Florida Building Codes and where pressure requirements as determined by ASCE 7 Minimum Design Loads for Buildings and Other Structures do not exceed the design pressure ratings herein, for use outside the H.V.H.Z.
  - All exterior perimeter surfaces of the window must be caulked. Interior caulking is optional unless noted otherwise.
  - Anchors shall be as specified and spaced as shown. Anchor embedment to base material shall be beyond wall dressing or stucco and into wood.
  - The responsibility for selection of Simonton products to meet any applicable local laws, building codes, ordinances, or other safety requirements rests solely with the architect, building owner, or contractor.
  - Shims are optional. Max. shim stack is 1/4".
  - Wood bucks (by others) must be engineered and anchored properly to transfer loads to the structure.
  - When used in areas requiring impact protection this product REQUIRES the use of approved impact resistant shutters or other external protection.
  - Flashing should be applied using the ASTM E 2112 methodology appropriate for the opening into which the window is being installed.
  - Installation screws must be at least 3/4" from the edge of the wood.
  - Glazing shall comply with ASTM E 1300-04.

<b>DISCLOSURE STATEMENT</b> This document is the property of Simonton Windows, which retains all proprietary and other rights to its subject matter. This document is provided to the recipient on the expressed condition that it is not to be disclosed, reproduced in whole or part, nor used in conjunction with the design, manufacture or repair of goods for anyone other than Simonton Windows without its consent. This restriction does not limit the recipient's rights to utilize information contained in this document which is properly obtained from another source.	MATERIAL: RMS FINISH: _____ ALLOY & TEMPER: _____ WEIGHT: _____ VOLUME: _____ SURFACE AREA: _____ PERIMETER: _____ FINISH TREATMENT: _____	Dimensional Tolerances <i>Unless Otherwise Specified.</i>  Decimals    Angles .X ± .03 .XX ± .01 .XXX ± .005 0' 30 min.	<b>SIMONTON</b> WINDOWS 1 Cochrane Avenue Pennsylvania, WV 26415 SCALE: FIT    SHEET: 1 of 1 SERIES: 43-40 PICTURE (FIXED) WINDOW TITLE: 2X BUCK INSTALLATION	SIZE DRAWING NO.: B1 INDD94 DRAWN BY: G.L.S. CHECKED BY: _____ DATE: 11/9/06 APPROVD BY: _____ DATE: _____	REV. 4
	FILE: IN0094	2	4		



Florida Department of Business & Professional Regulation  
**Product Approval**  
 USER: Public User

BCIS Home | Log In | User Registration | Hot Topics | Submit Surcharge | Stats & Facts | Publications | FBC Staff | BCIS Site Map | Links | Search

Product Approval Search > Product or Application Search > Application List > **Application Detail**

FL # **FL5179-R11**  
 Application Type Revision  
 Code Version 2010  
 Application Status **Approved**

\*Approved by DCA. Approvals by DCA shall be reviewed and ratified by the POC and/or the Commission if necessary.

Comments Archived  
 Product Manufacturer  
 Address/Phone/Email  
 Simonton Windows  
 1 Cochrane Ave  
 Pennsboro, WV 26415  
 (800) 746-6687 Ext 2329  
 tiffany\_davies@simonton.com

Authorized Signature  
 Tiffany Davies  
 tiffany\_davies@simonton.com

Technical Representative  
 Address/Phone/Email  
 Tiffany Davies  
 PO Box 1646  
 5300 Briscoe Road  
 Parkersburg, WV 26102  
 (800) 542-9118 Ext 9329  
 tiffany\_davies@simonton.com

Quality Assurance Representative  
 Address/Phone/Email  
 AAMA  
 1827 Walden Office Square  
 Suite 550  
 Schaumburg, IL 60173  
 (847) 303-5664  
 webmaster@aamanet.org

Category Subcategory  
 Windows  
 Horizontal Slider

Compliance Method  
 Certification Agency Validated By  
 Certification Mark or Listing  
 American Architectural Manufacturers Association  
 American Architectural Manufacturers Association

Referenced Standard and Year (of Standard)  
 Standard Year  
 AAMA/WDMA/CSA 101/1.S.2/A440 2005

Equivalence of Product Standards  
 Certified By  
 Product Approval Method  
 Method 1 Option A



5179.10	<p>43-06 and 43-17</p> <p><b>Limits of Use</b>  <b>Approved for use in HVHZ:</b> No  <b>Approved for use outside HVHZ:</b> Yes  <b>Impact Resistant:</b> No  <b>Design Pressure:</b> N/A  <b>Other:</b> 72x63 (+/-30 PSF), 72x48 (+/-35 PSF)</p>	<p><u>FL5179_R11_AE_PER_1630_43-06_43-17_Vent_Slides</u>  <u>1X.DWG</u></p> <p>Created by Independent Third Party: Yes</p> <p>THD 6060 Vantage Pointe, ProFinish Builder, ProFinish Contractor, ProFinish Master, Grand Estates New Construction Vinyl 2-Lite Horizontal Slider</p> <p><b>Certification Agency Certificate</b>  <u>FL5179_R11_C_CAC_43-06_HS_72x48_R35.DWG</u>  <u>FL5179_R11_C_CAC_43-06_HS_72x48_R35.DWG</u>  <u>FL5179_R11_C_CAC_43-17_C_43-06_WAIVER.DWG</u></p> <p><b>Quality Assurance Contract Expiration Date</b>  07/11/2016</p> <p><b>Installation Instructions</b>  <u>FL5179_R11_I_IN0197_43-06_43-17_Sl_2X.DWG</u></p> <p>Verified By: American Architectural Manufacturers Association  Created by Independent Third Party:  <b>Evaluation Reports</b>  Created by Independent Third Party:</p> <p>ProFinish Contractor, Amcraft Grand Estates New Construction Vinyl 2-Lite Horizontal Slider</p>
5179.11	<p>43-17</p> <p><b>Limits of Use</b>  <b>Approved for use in HVHZ:</b> No  <b>Approved for use outside HVHZ:</b> Yes  <b>Impact Resistant:</b> No  <b>Design Pressure:</b> N/A  <b>Other:</b> 72x63 (+/-30 PSF), 72x48 (+/-35 PSF)</p>	<p><b>Certification Agency Certificate</b>  <u>FL5179_R11_C_CAC_43-17_HS_72x48_R35.DWG</u>  <u>FL5179_R11_C_CAC_43-17_HS_72x48_R35.DWG</u></p> <p><b>Quality Assurance Contract Expiration Date</b>  08/02/2015</p> <p><b>Installation Instructions</b>  <u>FL5179_R11_I_IN0191_43-17_Sl_2X.DWG</u>  <u>FL5179_R11_I_IN0262_43-17_Sl_2X.DWG</u></p> <p>Verified By: American Architectural Manufacturers Association  Created by Independent Third Party:  <b>Evaluation Reports</b>  <u>FL5179_R11_AE_PER_2611_43-17_Horizontal_Slides_1X_5S.DWG</u></p> <p>Created by Independent Third Party: Yes</p>
5179.12	<p>43-35</p> <p><b>Limits of Use</b>  <b>Approved for use in HVHZ:</b> No  <b>Approved for use outside HVHZ:</b> Yes  <b>Impact Resistant:</b> No  <b>Design Pressure:</b> N/A  <b>Other:</b> 69x65 (+/-25 PSF), 78x63 (+/-25 PSF), 72x64 (+/-30 PSF), 72x36 (+/-35 PSF)</p>	<p>6100 Vantage Pointe, Asure, Prism Gold, Grand Estates Vinyl 2-Lite Horizontal Slider</p> <p><b>Certification Agency Certificate</b>  <u>FL5179_R11_C_CAC_43-35_HS_72x36_R35.DWG</u>  <u>FL5179_R11_C_CAC_43-35_HS_72x36_R35.DWG</u>  <u>FL5179_R11_C_CAC_43-35_HS_72x64_R30.DWG</u>  <u>FL5179_R11_C_CAC_43-35_HS_76x63_R25.DWG</u>  <u>FL5179_R11_C_CAC_43-35_HS_43-40_Sl_Waiver.DWG</u>  <u>FL5179_R11_C_CAC_43-40_HS_69x65_R25.DWG</u>  <u>FL5179_R11_C_CAC_43-40_HS_72x36_R40.DWG</u></p> <p><b>Quality Assurance Contract Expiration Date</b>  06/16/2013</p> <p><b>Installation Instructions</b>  <u>FL5179_R11_I_IN0138_43-30_43-40_Sl_1X.DWG</u>  <u>FL5179_R11_I_IN0139_43-35_Sl_2X.DWG</u></p> <p>Verified By: American Architectural Manufacturers Association  Created by Independent Third Party:  <b>Evaluation Reports</b>  <u>FL5179_R11_AE_PER_1630_43-35_43-40_Horizontal_Slides_1X.DWG</u>  <u>FL5179_R11_AE_PER_1630_43-35_IN0139_Addendum.DWG</u></p> <p>Created by Independent Third Party: Yes</p>
5179.13	<p>43-35</p> <p><b>Limits of Use</b>  <b>Approved for use in HVHZ:</b> No  <b>Approved for use outside HVHZ:</b> Yes  <b>Impact Resistant:</b> No  <b>Design Pressure:</b> +35/-35  <b>Other:</b></p>	<p>6100 Vantage Pointe, Asure, Prism Gold, Grand Estates Vinyl 3-Lite Endvent Slider</p> <p><b>Certification Agency Certificate</b>  <u>FL5179_R11_C_CAC_43-35_EV_EA306_R35.DWG</u></p> <p><b>Quality Assurance Contract Expiration Date</b>  01/23/2016</p> <p><b>Installation Instructions</b>  <u>FL5179_R11_I_43-35_TO_43-40_Waiver.DWG</u>  <u>FL5179_R11_I_IN0145_43-35_43-40_EV_1X.DWG</u>  <u>FL5179_R11_I_IN0147_43-35_EV_2X.DWG</u></p> <p>Verified By: American Architectural Manufacturers Association  Created by Independent Third Party:  <b>Evaluation Reports</b>  <u>FL5179_R11_AE_43-35_19_43-40_Waiver.DWG</u>  <u>FL5179_R11_AE_PER_1633_43-35_43-40_End_Vent_Slides_1X.DWG</u>  <u>FL5179_R11_AE_PER_1633_43-35_IN0146_Addendum.DWG</u></p> <p>Created by Independent Third Party: Yes</p>
5179.14	<p>43-40</p> <p><b>Reflections</b> 5050, Reflections 5300, Prism Bronze, Prism Ultra Gold, THD 6100 Vantage Pointe, Amcraft Grand</p>	<p>Created by Independent Third Party: Yes</p>

**MODEL DESIGNATION:** Simonton Horizontal Slider Series 43-40 Vinyl Window  
**MAXIMUM OVERALL NOMINAL SIZE:** See Size Chart  
**DESIGN PRESSURE RATING:** See Size Chart  
**USABLE CONFIGURATIONS:** XX, OX, or XO  
**GENERAL DESCRIPTION:** The head, sill, and side jambs are extruded PVC. The wall thickness through which the anchor screw penetrates is a minimum of 0.070".

REV. #	REVISIONS:	REVISED BY:	DATE:
1	REMOVED "CONCRETE" FROM TITLE	T.D.D.	11/02/07
2	ADDED 76 X 63 AND 65 X 65 TO SIZE CHART & REMOVED 43-46 FROM SERIES	T.D.D.	01/24/08
3	REMOVED TAPCON FROM SILL	T.D.D.	06/11/08
4	UPDATED NOTES, GENERAL DESCRIPTION & SIZE CHART	T.D.D.	03/16/10
5	UPDATED SIZES PER NEW TESTING AND ADDED NOTES 15 & 16.	T.D.D.	11/30/11

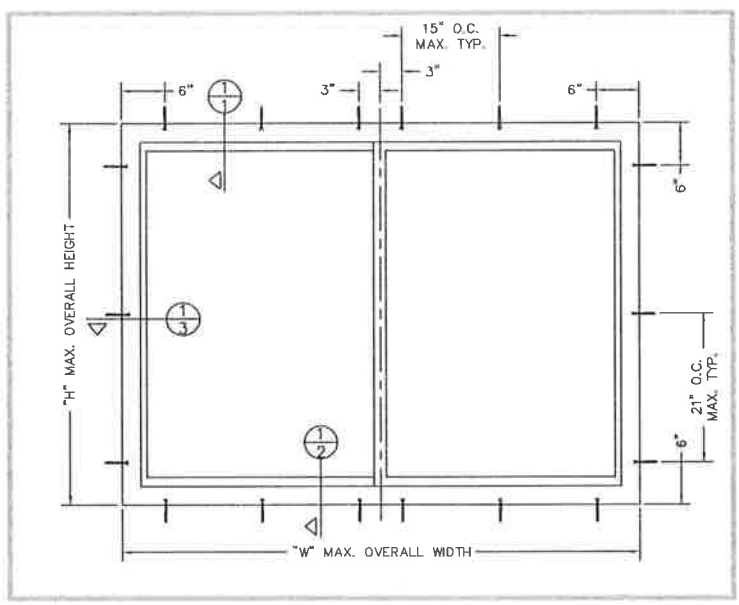
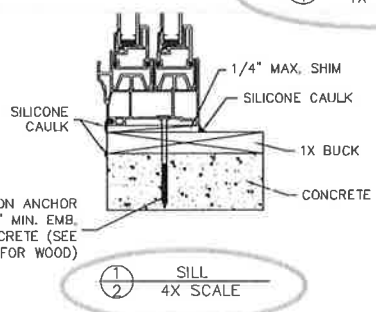
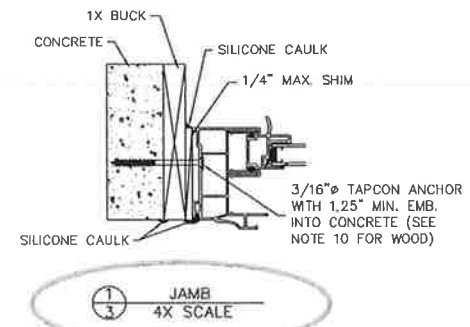
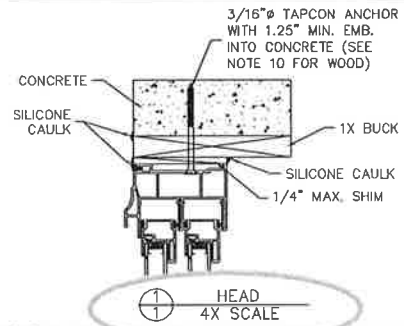

3/16" TAPCON ANCHOR WITH 1.25" MIN. EMB. INTO CONCRETE (SEE NOTE 10 FOR WOOD)

**NOTES:**

- This installation has been evaluated for use in locations adhering to the Florida Building Code and where design pressure requirements as determined by ASCE 7 Minimum Design Loads for Buildings and Other Structures do not exceed the design pressure ratings listed herein.
- For installation where the sub-buck is less than 1 1/2" (FBC chapter 17 Anchorage Methods) Tapcon type concrete anchors must be used and the length must be such that a minimum 1 1/4" embedment of the Tapcon into the concrete or concrete block is obtained, unless otherwise noted. Anchors should be a minimum of 2 1/2" from the edge of the concrete, hollow block CMU, or concrete block.
- All interior and exterior perimeter surfaces of the window must be caulked.
- Adjust Tapcon anchor locations, if necessary, to maintain a minimum of 2.0" clearance from mortar joints.
- When the optional head expanders are used, the INSTALLER MUST ADJUST the anchor lengths to maintain the required minimum embedment into the substrate.
- Anchors shall be specified and spaced as shown. Anchor embedment to base material shall be beyond wall dressing or stucco and into wood or concrete.
- Wood bucks (by others) must be engineered and anchored properly to transfer loads to the structure. Bucks shall extend beyond interior face of frame such that full support of the frame is provided.
- Follow ITW/Elco Tapcon anchoring instructions.
- The responsibility for selection of Simonton Products to meet any applicable local laws, building codes, ordinances, or other safety requirements rests solely with the architect, building owner, or contractor.
- For woodbuck substrates, use #10 wood screws with 1 1/2" min. embedment into wood, unless otherwise noted. Screws should be a minimum of 3/4" from the edge of the wood.
- A. Concrete compressive strength = 3000 PSI at 28 days.  
 B. Concrete Masonry Units shall conform with strength requirements of ASTM C90.  
 C. Wood Minimum Specific Gravity = 0.55
- Shims are optional. Max. shim stack is 1/4".
- When using a 3/16" Tapcon or #10 wood screw through the window frame, pre-drill the thru hole at specified installation screw locations.
- When used in areas requiring impact protection, this product REQUIRES the use of approved impact resistant shutters or other external protection.
- Flashing should be applied using the ASTM E 2112 method appropriate for the opening into which the window is being installed.
- Glazing shall comply with ASTM E 1300-04.

SIZE CHART		
OVERALL SIZE	DP RATING	
WIDTH "W"	HEIGHT "H"	
78"	63"	±25 PSF
69"	65"	±30 PSF
72"	36"	±40 PSF

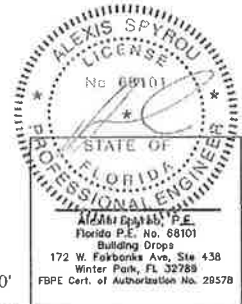

ALEX SPYROU  
 2012.02.13 14:35:58 -05'00'

**DISCLOSURE STATEMENT**  
 This document is the property of Simonton Windows, which retains all proprietary and other rights to its subject matter. This document is provided to the recipient on the expressed condition that it is not to be disclosed, reproduced in whole or part, nor used in conjunction with the design, manufacture or repair of goods for anyone other than Simonton Windows without its consent. This restriction does not limit the recipient's rights to utilize information contained in this document which is properly obtained from another source.

MATERIAL:	
RMS FINISH:	EXCEPT AS NOTED
ALLOY & TEMPER:	
WEIGHT:	VOLUME:
SURFACE AREA:	PERIMETER:
FINISH TREATMENT:	

Dimensional Tolerances Unless Otherwise Specified	
Decimals	Angles
.X ± .03	0° 30 min.
.XX ± .01	
.XXX ± .005	

 1 Cochran Avenue Pannasburg, WV 26415	SIZE: DRAWING NO.:	REV.:
	E   IN0138	5
	DRAWN BY: DATE:	
	T.D.D.   10/24/07	
	CHECKED BY: DATE:	
	APPRVD BY: DATE:	
SCALE: FIT	SHEET: 1 of 1	
SERIES: 43-40 HORIZONTAL SLIDER		
TITLE: 1X BUCK INSTALLATION		

FILE: IN0138

MODEL DESIGNATION: Simonton Horizontal Slider Series 43-35 Vinyl Window  
 MAXIMUM OVERALL NOMINAL SIZE: See Size Chart  
 DESIGN PRESSURE RATING: See Size Chart  
 USABLE CONFIGURATIONS: XX, OX, or XO  
 GENERAL DESCRIPTION: The head, sill, and side jambs are extruded PVC. The wall thickness through which the anchor screw penetrates is a minimum of 0.070".

NO P.E. SEAL REQUIRED  
 INSTALLATION SUPPORTED  
 BY AAMA TEST REPORTS

REV. #:	REVISIONS:	REVISED BY:	DATE:
5	ADDED FLASHING NOTE.	T.D.D.	04/07/11
6	UPDATED SIZES PER TESTING.	T.D.D.	05/24/11
7	ADDED GLAZING DETAILS.	T.D.D.	06/09/11
8	REMOVED GLAZING DETAILS AND ADDED NOTE 10.	T.D.D.	01/11/12
9	CHANGED SASH-FRAME CODE AND FRAME PROFILES PER NEW TESTING.	T.D.D.	02/23/12

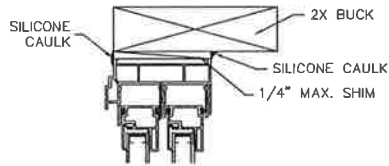

1 HEAD  
 1 4X SCALE

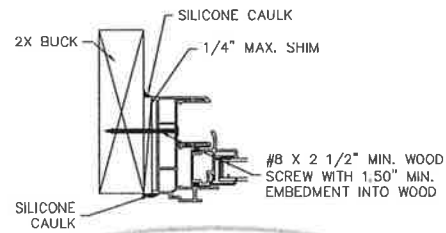

1 JAMB  
 3 4X SCALE

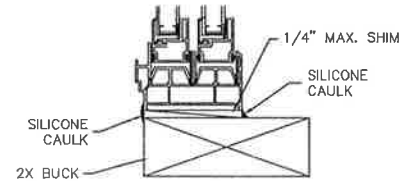

1 SILL  
 2 4X SCALE

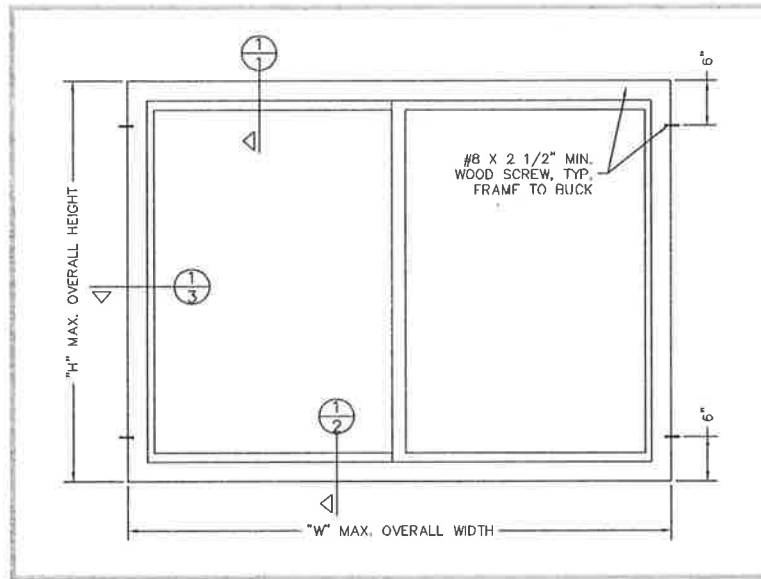

NOTES:

- This installation has been evaluated for use in locations adhering to the Florida Building Code and where pressure requirements as determined by ASCE 7 Minimum Design Loads for Buildings and Other Structures do not exceed the design pressure ratings listed herein, for use outside the H.V.H.Z.
- All exterior perimeter surfaces of the window must be caulked. Interior caulking is optional unless noted otherwise.
- Anchors shall be specified and spaced as shown. Anchor embedment to base material shall be beyond wall dressing or stucco and into wood.
- The responsibility for selection of Simonton products to meet any applicable local laws, building codes, ordinances, or other safety requirements rests solely with the architect, building owner, or contractor.
- Shims are optional. Maximum shim stack is 1/4".
- Wood bucks (by others) must be engineered and anchored properly to transfer loads to the structure.
- When used in areas requiring impact protection, this product REQUIRES the use of approved impact resistant shutters or other external protection.
- Flashing should be applied using the ASTM E 2112 method appropriate for the opening into which the window is being installed.
- Installation screws must be at least 3/4" from the edge of the wood.
- Glazing shall comply with ASTM E 1300-04.

SIZE CHART		
OVERALL SIZE		DP RATING
WIDTH "W"	HEIGHT "H"	
78"	63"	±25 PSF
69"	65"	
72"	54"	±30 PSF
72"	36"	±35 PSF
72"	36"	±40 PSF

**DISCLOSURE STATEMENT**  
 This document is the property of Simonton Windows, which retains all proprietary and other rights to its subject matter. This document is provided to the recipient on the expressed condition that it is not to be disclosed, reproduced in whole or in part, nor used in conjunction with the design, manufacture or repair of goods for anyone other than Simonton Windows without its consent. This restriction does not limit the recipient's rights to utilize information contained in this document which is properly obtained from another source.

FILE: IN0139

MATERIAL:	
RMS FINISH:	
ALLOY & TEMPER:	EXCEPT AS NOTED
WEIGHT:	VOLUME:
SURFACE AREA:	PERIMETER:
FINISH TREATMENT:	

Dimensional Tolerances  
 Unless Otherwise Specified

Decimals	Angles
.X ± .03	0° 30 min.
.XX ± .01	
.XXX ± .005	

 1 Cochrane Avenue Pensboro, WV 26415		SIZE/DRAWING NO.:	REV.:
		B   IN0139	8
SCALE: FIT		DRAWN BY: T.D.D.	DATE: 10/24/07
SHEET: 1 of 1		CHECKED BY:	DATE:
SERIES: 43-35 HORIZONTAL SLIDER		APPRVD BY:	DATE:
TITLE: 2X BUCK INSTALLATION (AS TESTED)			



Florida Department of Business & Professional Regulation  
**Product Approval**  
 USER: Public User

BCIS Home | Log In | User Registration | Hot Topics | Submit Surchage | Stats & Facts | Publications | FBC Staff | BCIS Site Map | Links | Search

[Product Approval Search](#) > [Product or Application Search](#) > [Application List](#) > **Application Detail**

FL #

FL12119-R1

Application Type

Revision

Code Version

2010

Application Status

Approved

Comments

Archived

Product Manufacturer  
 Address/Phone/Email

Simonton Windows  
 1 Cochrane Ave  
 Pennsboro, WV 26415  
 (800) 746-6687 Ext 2329  
 tiffany\_davies@simonton.com

Authorized Signature

Tiffany Davies  
 tiffany\_davies@simonton.com

Technical Representative  
 Address/Phone/Email

Tiffany Davies  
 PO Box 1646  
 5300 Briscoe Road  
 Parkersburg, WV 26102  
 (800) 542-9118 Ext 9329  
 tiffany\_davies@simonton.com

Quality Assurance Representative  
 Address/Phone/Email

AAMA  
 1827 Walden Office Square  
 Suite 550  
 Schaumburg, IL 60173  
 (847) 303-5664  
 webmaster@aamanet.org

Category  
 Subcategory

Windows  
 Mullions

Compliance Method

Evaluation Report from a Florida Registered Architect or a Licensed Florida Professional Engineer  
 Evaluation Report - Hardcopy Received

Florida Engineer or Architect Name who developed the Evaluation Report  
 Florida License  
 Quality Assurance Entity  
 Quality Assurance Contract Expiration Date  
 Validated By

Lucas Andrew Turner  
 PE-58201  
 Architectural Testing, Inc.  
 12/31/2014  
 Shawn G. Collins, PE  
 Validation Checklist - Hardcopy Received

Certificate of Independence

[FL12119\\_R1\\_COI\\_EvalRptX01-RMD051-HVH7.pdf](#)

Referenced Standard and Year (of Standard)

Equivalence of Product Standards  
 Certified By

Sections from the Code

1715.5.5

Product Approval Method

Method 2 Option B

Date Submitted 02/21/2012  
 Date Validated 03/27/2012  
 Date Pending FBC Approval 04/11/2012  
 Date Approved 06/11/2012

Summary of Products		Description
FL #	Model, Number or Name	
12119.1	07-09 StormBreaker Plus 300VL (for HVHZ)	Large Reinforced Impact Resistant Mullion
<b>Limits of Use</b> Approved for use in HVHZ: Yes Approved for use outside HVHZ: Yes Impact Resistant: Yes Design Pressure: N/A Other: Design pressure rating varies by unit size. Missile Impact Rating: Large		
12119.2	07-09 StormBreaker Plus 300VL (for HVHZ)	Medium Reinforced Impact Resistant Mullion
<b>Limits of Use</b> Approved for use in HVHZ: Yes Approved for use outside HVHZ: Yes Impact Resistant: Yes Design Pressure: N/A Other: Design pressure rating varies by unit size. Missile Impact Rating: Large		
12119.3	07-09 StormBreaker Plus 300VL (Outside HVHZ)	Large Reinforced Impact Resistant Mullion
<b>Limits of Use</b> Approved for use in HVHZ: No Approved for use outside HVHZ: Yes Impact Resistant: Yes Design Pressure: N/A Other: Design pressure rating varies by unit size. Missile Impact Rating: Large		
12119.4	07-09 StormBreaker Plus 300VL (Outside HVHZ)	Medium Reinforced Impact Resistant Mullion
<b>Limits of Use</b> Approved for use in HVHZ: No Approved for use outside HVHZ: Yes Impact Resistant: Yes Design Pressure: N/A Other: Design pressure rating varies by unit size. Missile Impact Rating: Large		

[Back](#)

[Next](#)

Contact Us :: 1940 North Monroe Street, Tallahassee, FL 32399 Phone: 850-487-1824

The State of Florida is an AA/EEO employer. Copyright 2007-2010 State of Florida. :: [Privacy Statement](#) :: [Accessibility Statement](#) :: [Refund Statement](#)  
 Under Florida law, email addresses are public records. If you do not want your e-mail address released in response to a public-records request, do not send electronic mail to this entity. Instead, contact the office by phone or by traditional mail. If you have any questions, please contact 850.487.1395. \*Pursuant to Section 455.275(1), Florida Statutes, effective October 1, 2012, licensees licensed under Chapter 455, F.S. must provide the Department with an email address if they have one. The emails provided may be used for official communication with the licensee. However email addresses are public record. If you do not wish to supply a personal address, please provide the Department with an email address which can be made available to the public. To determine if you are a licensee under Chapter 455, F.S., please click [here](#).

Product Approval Accepts:





1 COCHRANE AVE. PENNSBORO, WV 26415 PH.  
800-426-2249

**STORMBREAKER PLUS 300VL SERIES  
MULLIONS WITH LARGE ALUMINUM  
REINFORCEMENT - NON-HVHZ  
FOR IMPACT RESISTANT ASSEMBLIES**

**GENERAL NOTES:**

1. THE PRODUCT SHOWN HEREIN IS DESIGNED AND MANUFACTURED TO COMPLY WITH THE 2010 FLORIDA BUILDING CODE REQUIREMENTS EXCLUDING HVHZ.
2. THIS MULLION IS ONLY VALID WHEN USED IN CONJUNCTION WITH APPLICABLE WINDOW SYSTEMS.
3. ALL WINDOWS USED WITH THIS MULLION SHALL BE QUALIFIED UNDER SEPARATE APPROVAL. ALL GLAZING PRODUCTS USED WITH THESE MULLIONS MUST MEET THE APPLICABLE FLORIDA BUILDING CODE REQUIREMENTS.
4. ADEQUACY OF EXISTING STRUCTURAL CONCRETE/MASONRY, 2X AND STEEL STUD FRAMING AS A MAIN WIN FORCE RESISTING SYSTEM CAPABLE OF WITHSTANDING AND TRANSFERRING APPLIED PRODUCT LOADS TO THE FOUNDATION IS THE RESPONSIBILITY OF THE ENGINEER OR ARCHITECT OF RECORD FOR THE PROJECT INSTALLATION.
5. 2X BUCKS (WHEN USED) SHALL BE DESIGNED AND ANCHORED TO PROPERLY TRANSFER ALL LOADS TO THE STRUCTURE. BUCK DESIGN AND INSTALLATION IS THE RESPONSIBILITY OF THE ENGINEER OR ARCHITECT OF RECORD FOR THE PROJECT INSTALLATION.
6. THE INSTALLATION DETAILS DESCRIBED HEREIN ARE GENERIC AND MAY NOT REFLECT ACTUAL CONDITIONS FOR A SPECIFIC SITE. IF SITE CONDITIONS CAUSE INSTALLATION TO DEVIATE FROM THE REQUIREMENTS DETAILED HEREIN, A LICENSED ENGINEER OR ARCHITECT SHALL PREPARE SITE SPECIFIC DOCUMENTS FOR USE WITH THIS DOCUMENT.
7. THIS MULLION SYSTEM IS SUITABLE FOR ASSEMBLY OF IMPACT RESISTANT PRODUCTS AND DOES NOT REQUIRE AN EXTERNAL IMPACT PROTECTIVE DEVICE IN WINDBORNE DEBRIS REGIONS.

REV. #	REVISIONS:	REVISED BY:	DATE:
3	UPDATED DRAWINGS TO 2010 FBC	C.P.	01-24-12
-	-	-	-
-	-	-	-
-	-	-	-
-	-	-	-

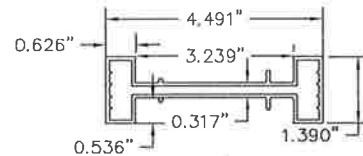
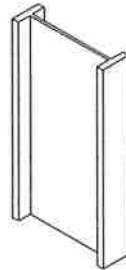

**RETROFIT FRAME MULLION**  
① LARGE VINYL MULLION COVER #VPI - 354  
EXTRUDED VINYL .070" MIN.

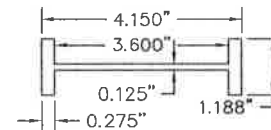

② LARGE MULLION REINFORCEMENT #16991  
ALUMINUM 6063-T6

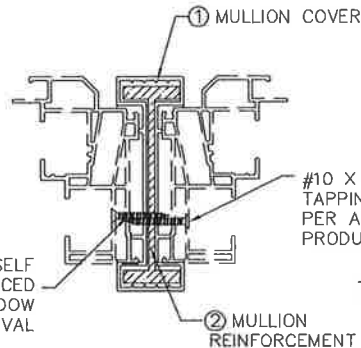

#10 X 1 1/8" SELF TAPPING SCREWS SPACED PER APPLICABLE WINDOW PRODUCT APPROVAL

② MULLION REINFORCEMENT

DOUBLE HUNG HORIZONTAL CROSS SECTION

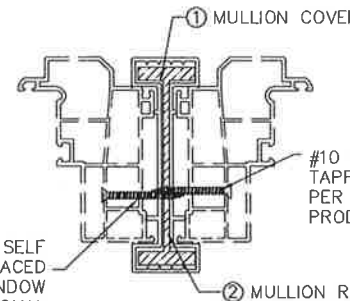

#10 X 1 1/8" SELF TAPPING SCREWS SPACED PER APPLICABLE WINDOW PRODUCT APPROVAL

② MULLION REINFORCEMENT

PICTURE (FIXED) HORIZONTAL CROSS SECTION

PARTS LIST			
NUMBER	DESCRIPTION	PART NO	MATERIAL
1	MEDIUM MULLION COVER	VPI-354	PVC
2	MEDIUM MULLION REINFORCEMENT	T699T	6063-T6
3	BASE PLATE		STEEL
4	MULLION L-BRACKET		STAINLESS STEEL

TABLE OF CONTENTS	
PAGE NO	DESCRIPTION
1	GENERAL NOTES, PARTS LIST AND CROSS SECTIONS
2	ELEVATION AND DESIGN PRESSURE CHARTS
3	MULLION DETAILS & SILL CROSS SECTIONS

Lucas Turner  
2012-03-17 23:07-04:00

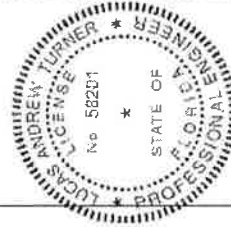

 1 Cochrane Avenue Pennsboro, WV 26415 3/17/2012	SCALE: FT	SHEET: 1 of 3	APPRVD BY: C.P.	DATE: 01-24-12
	SERIES: STORMBREAKER PLUS 300VL MULLION TITLE: GENERAL NOTES & CROSS SECTIONS			



1 COCHRANE AVE. PENNSBORO, WV 26415 PH.  
800-426-2249

STORMBREAKER PLUS 300VL SERIES  
MULLIONS WITH LARGE ALUMINUM  
REINFORCEMENT - NON-HVHZ  
FOR IMPACT RESISTANT ASSEMBLIES

REV.	REVISIONS:	REVISED BY:	DATE:
1	UPDATED DRAWINGS TO 2010 FBC	C.P.	01-24-12

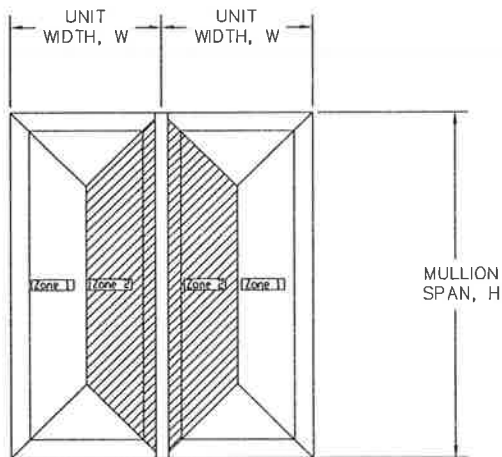

MULL SPAN, H (in)	INDIVIDUAL UNIT WIDTH, W (in)			
	0.0000	30.0000	33.0000	36.0000
26.0000	50.0	50.0	50.0	50.0
36.0000	50.0	50.0	50.0	50.0
42.0000	50.0	50.0	50.0	50.0
52.0000	50.0	50.0	50.0	50.0
60.0000	50.0	50.0	50.0	50.0
65.0000	50.0	50.0	50.0	50.0
74.0000	50.0	50.0	50.0	50.0

DESIGN PRESSURE CHART FOR MULLING  
DOUBLE HUNG WINDOWS, UNITS IN PSF, MULLION #16991

MULL SPAN, H (in)	INDIVIDUAL UNIT WIDTH, W (in)					
	0.0000	30.0000	33.0000	37.0000	40.0000	53.0000
26.0000	50.0	50.0	50.0	50.0	50.0	50.0
36.0000	50.0	50.0	50.0	50.0	50.0	50.0
42.0000	50.0	50.0	50.0	50.0	50.0	50.0
52.0000	50.0	50.0	50.0	50.0	50.0	50.0
60.0000	50.0	50.0	50.0	50.0	50.0	50.0
65.0000	50.0	50.0	50.0	50.0	50.0	50.0
71.0000	50.0	50.0	50.0	50.0	50.0	48.8
76.0000	50.0	50.0	50.0	50.0	50.0	43.8
84.0000	50.0	50.0	47.3	44.8	37.7	

DESIGN PRESSURE CHART FOR MULLING  
FIXED WINDOWS, UNITS IN PSF, MULLION #16991

NOTE:  
The pressure charts show the design pressures for the selected mullion span and panel width for achieving bending capacity, deflection and concentrated load limits specified in the Florida Building Code, 2010 edition.

Adhere to fastening instructions provided in this document to achieve the tabulated design pressures.

DIRECTIONS:  
Select the module width and mullion span from the chart to determine the allowable design pressure for the product. When panel sizes are not equal on both sides of the mullion, use the larger of the panel widths from the chart.

ZZ	3/17/2012		SCALE: FIT	SHEET: 2 of 3	APPRVD BY: C.P.	DATE: 01-24-12	SIZE: DRAWING NO.: B   RM0051	REV: 3
	LUCAS A. TURNER, P.E. FL PE #58201 TURNER ENGINEERING & CONSULTING, INC. FBPE C.O.A. #29779 Ph. 941-380-1574 2080 MAUVE TER., NORTH PORT, FL 34286						DRAWN BY: GLS	DATE: 12/18/08
					<b>TITLE: STORMBREAKER PLUS 300VL MULLION</b> ELEVATION AND DESIGN PRESSURE CHARTS			



1 COCHRANE AVE. PENNSBORO, WV 26415 PH. 800-426-2249

**STORMBREAKER PLUS 300VL SERIES MULLIONS WITH LARGE ALUMINUM REINFORCEMENT - NON-HVHZ FOR IMPACT RESISTANT ASSEMBLIES**

REV. #:	REVISIONS:	REVISED BY:	DATE:
3	UPDATED DRAWINGS TO 2010 FBC	C.P.	01-24-12

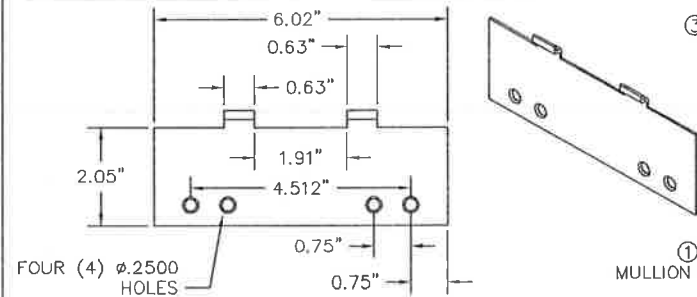

③ REINFORCEMENT BASE PLATE DETAIL  
.060" MIN. STEEL

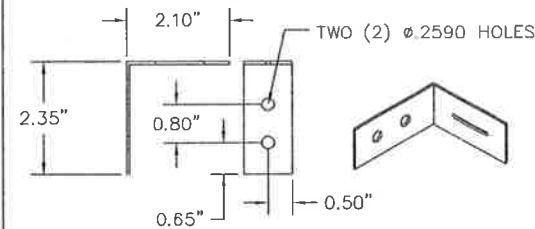

④ MULLION L-BRACKET  
.076" MIN. STAINLESS STEEL

**ANCHOR NOTES:**  
To achieve the required design pressures, adhere to the following fastener requirements:

**INSTALLATION ON WOOD BUCK:**  
Four (4) #10 wood screws for each base plate with min. 1-1/2" embedment and min. 7/8" wood edge distance.

**INSTALLATION ON CONCRETE/MASONRY**  
Two (2) 1/4" ITW Tapcon Screws for each base plate with min. 1-1/4" embedment. Install Tapcon anchors at the outermost holes of the base plate with tapcon concrete edge distance greater than 2.00".

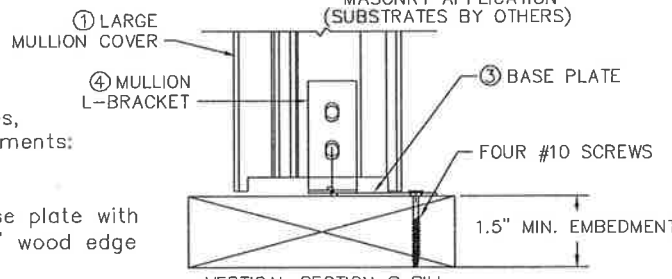
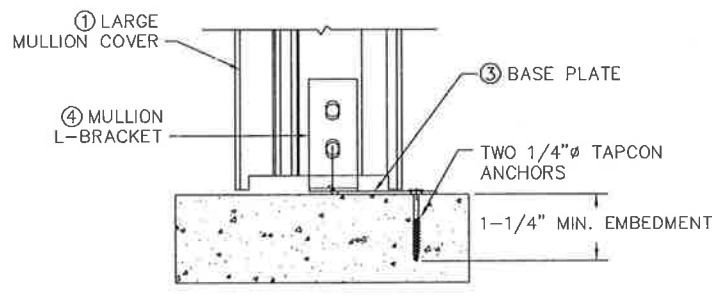
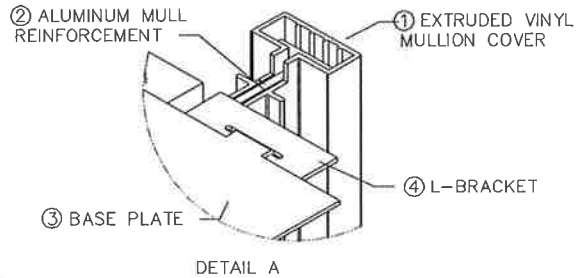

RIVET	.25 DIA. STEEL RIVET WITH A GRIP LENGTH OF .50 MAX.
BARREL NUT	#10-24 DR #10-32 STAINLESS STEEL BARREL NUT, .250 O.D. X .25" LG WITH .125 MIN ENGAGEMENT

SEE NOTES BELOW AND MANUFACTURER'S ATTACHMENT INSTRUCTIONS FOR ATTACHING REINFORCED MULLIONS TO WINDOW UNITS

SEE NOTES BELOW AND MANUFACTURER'S ATTACHMENT INSTRUCTIONS FOR ATTACHING REINFORCED MULLIONS TO WINDOW UNITS

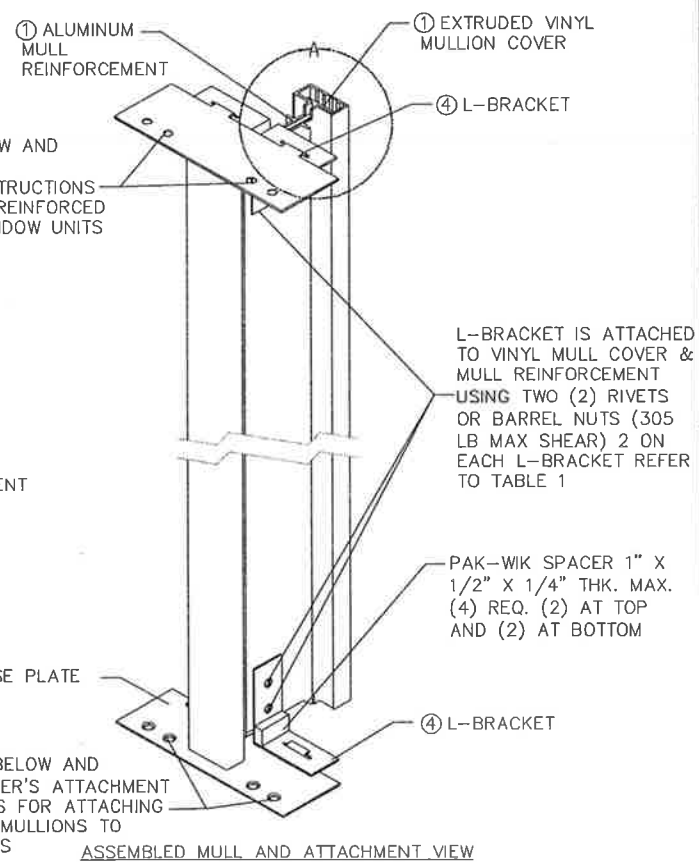

L-BRACKET IS ATTACHED TO VINYL MULL COVER & MULL REINFORCEMENT USING TWO (2) RIVETS OR BARREL NUTS (305 LB MAX SHEAR) 2 ON EACH L-BRACKET REFER TO TABLE 1

<p>1 COCHRANE AVENUE PENNSBORO, WV 26415</p>	SCALE: FIT	SHEET: 3 of 3	APPRVD BY: C.P.	DATE: 01-24-12
	<p>3/17/2012</p> <p>LUCAS A. TURNER, P.E. FL PE #58201 TURNER ENGINEERING &amp; CONSULTING, INC. FBPE C.O.A. #29779 Ph. 941-380-1574 2080 MAUVE TER., NORTH PORT, FL 34286</p>			
<p>SIZE: DRAWING NO. B RM0051</p> <p>DRAWN BY: GLS DATE: 12/18/08</p> <p>CHECKED BY: DATE:</p>		<p>SERIES: STORMBREAKER PLUS 300VL MULLION</p> <p>TITLE: MULLION DETAILS AND SILL CROSS SECTIONS</p>		





# CERTIFICATE OF LIABILITY INSURANCE

DATE (MM/DD/YYYY)  
07/22/2013

THIS CERTIFICATE IS ISSUED AS A MATTER OF INFORMATION ONLY AND CONFERS NO RIGHTS UPON THE CERTIFICATE HOLDER. THIS CERTIFICATE DOES NOT AFFIRMATIVELY OR NEGATIVELY AMEND, EXTEND OR ALTER THE COVERAGE AFFORDED BY THE POLICIES BELOW. THIS CERTIFICATE OF INSURANCE DOES NOT CONSTITUTE A CONTRACT BETWEEN THE ISSUING INSURER(S), AUTHORIZED REPRESENTATIVE OR PRODUCER, AND THE CERTIFICATE HOLDER.

**IMPORTANT:** If the certificate holder is an ADDITIONAL INSURED, the policy(ies) must be endorsed. If SUBROGATION IS WAIVED, subject to the terms and conditions of the policy, certain policies may require an endorsement. A statement on this certificate does not confer rights to the certificate holder in lieu of such endorsement(s).

PRODUCER MARSH USA, INC. TWO ALLIANCE CENTER 3550 LENOX ROAD, SUITE 2400 ATLANTA, GA 30326	CONTACT NAME: PHONE (A/C, No. Ext): E-MAIL: ADDRESS:	FAX (A/C, No):
100492-HomeD-GW-FL-13-14 MU	INSURER(S) AFFORDING COVERAGE	NAIC #
INSURED THE HOME DEPOT, INC. HOME DEPOT U.S.A., INC. 2455 PAGES FERRY ROAD, NW BUILDING C-20 ATLANTA, GA 30339	INSURER A: Steadfast Insurance Company	26387
	INSURER B: Illinois National Insurance Company	23817
	INSURER C:	
	INSURER D:	
	INSURER E:	
	INSURER F:	

### COVERAGES

ATL-003148803-03

REVISION NUMBER: 0

THIS IS TO CERTIFY THAT THE POLICIES OF INSURANCE LISTED BELOW HAVE BEEN ISSUED TO THE INSURED NAMED ABOVE FOR THE POLICY PERIOD INDICATED. NOTWITHSTANDING ANY REQUIREMENT, TERM OR CONDITION OF ANY CONTRACT OR OTHER DOCUMENT WITH RESPECT TO WHICH THIS CERTIFICATE MAY BE ISSUED OR MAY PERTAIN, THE INSURANCE AFFORDED BY THE POLICIES DESCRIBED HEREIN IS SUBJECT TO ALL THE TERMS, EXCLUSIONS AND CONDITIONS OF SUCH POLICIES. LIMITS SHOWN MAY HAVE BEEN REDUCED BY PAID CLAIMS.

INSR LTR	TYPE OF INSURANCE	ADDL SUBR INSR. WVD	POLICY NUMBER	POLICY EFF (MM/DD/YYYY)	POLICY EXP (MM/DD/YYYY)	LIMITS
A	GENERAL LIABILITY X COMMERCIAL GENERAL LIABILITY CLAIMS-MADE <input checked="" type="checkbox"/> OCCUR		GLO4887714-03 "LIMITS OF POLICY XS" "OF SIR: \$1M PER OCC"	03/01/2013	03/01/2014	EACH OCCURRENCE \$ 9,000,000 DAMAGE TO RENTED PREMISES (Ea occurrence) \$ 1,000,000 MED EXP (Any one person) \$ EXCLUDED PERSONAL & ADV INJURY \$ 9,000,000 GENERAL AGGREGATE \$ 9,000,000 PRODUCTS - COMP/OP ASS \$ 9,000,000
	GEN'L AGGREGATE LIMIT APPLIES PER: X POLICY <input type="checkbox"/> PRO.JECT <input type="checkbox"/> LOC <input type="checkbox"/>					
	AUTOMOBILE LIABILITY ANY AUTO ALL OWNED AUTOS SCHEDULED AUTOS NON-OWNED AUTOS HIRED AUTOS					COMBINED SINGLE LIMIT (Ea accident) \$ BODILY INJURY (Per person) \$ BODILY INJURY (Per accident) \$ PROPERTY DAMAGE (Per accident) \$
	UMBRELLA LIAB EXCESS LIAB					EACH OCCURRENCE \$ AGGREGATE \$
	WORKERS COMPENSATION AND EMPLOYERS' LIABILITY ANY PROPRIETOR/PARTNER/EXECUTIVE OFFICER/EMBER EXCLUDED? (Mandatory in NH) If yes, describe under DESCRIPTION OF OPERATIONS below		WC033575316 (FL)	03/01/2013	03/01/2014	X WC STATU-TORY LIMITS OTHER E.L. EACH ACCIDENT \$ 1,000,000 E.L. DISEASE - EA EMPLOYEE \$ 1,000,000 E.L. DISEASE - POLICY LIMIT \$ 1,000,000

DESCRIPTION OF OPERATIONS / LOCATIONS / VEHICLES (Attach ACORD 101, Additional Remarks Schedule, if more space is required)

### CERTIFICATE HOLDER

CITY OF BELLE ISLE  
1600 NELA AVENUE  
BELLE ISLE, FL 32809

### CANCELLATION

SHOULD ANY OF THE ABOVE DESCRIBED POLICIES BE CANCELLED BEFORE THE EXPIRATION DATE THEREOF, NOTICE WILL BE DELIVERED IN ACCORDANCE WITH THE POLICY PROVISIONS.

AUTHORIZED REPRESENTATIVE  
of Marsh USA Inc.

Manashi Mukherjee

*Manashi Mukherjee*

ACORD 25 (2010/05)

The ACORD name and logo are registered marks of ACORD

© 1988-2010 ACORD CORPORATION. All rights reserved.



# ADDITIONAL REMARKS SCHEDULE

AGENCY MARSH USA, INC.		NAMED INSURED THE HOME DEPOT, INC. HOME DEPOT U.S.A., INC. 2455 PAGES FERRY ROAD, NW BUILDING C-20 ATLANTA, GA 30039	
POLICY NUMBER		EFFECTIVE DATE:	
CARRIER	NAIC CODE		

## ADDITIONAL REMARKS

THIS ADDITIONAL REMARKS FORM IS A SCHEDULE TO ACORD FORM,

FORM NUMBER: 25 FORM TITLE: Certificate of Liability Insurance

BOYSIE GANGA RAMDIAL - CRC046858  
 BOYD A LIPHAM - CCC1323818  
 EDWARD LYNN GUILLORY - CGC1507093  
 QUINN M ROBERTS - CCC068327  
 EDUARDO ESCUZA - CGC1518835  
 MICHAEL JAMES HOLEVA - CCC1325540  
 STEPHEN A. THOMPSON - CRC1330510  
 CHARLES F. HICKEY - CGC035844  
 JAMES P. DRAGO - CGC025763

WORKERS COMPENSATION IS COVERED IN THE STATE OF FLORIDA

### \*\*\* HOME DEPOT INSURED\*\*\*

Home Depot U.S.A., The Home Depot, Inc. Entity List

Home Depot USA, Inc. dba The Home Depot  
 THD At Home Services, Inc. dba The Home Depot At-Home Services  
 THD At-Home Services, Inc.  
 The Home Depot, Inc.  
 The Home Depot, Inc. Home Depot USA, Inc.  
 Your Other Warehouse, LLC  
 U.S. Home Systems, Inc.  
 U.S. Remodelers, Inc.



**STATE OF FLORIDA**  
**DEPARTMENT OF BUSINESS AND PROFESSIONAL REGULATION**  
**CONSTRUCTION INDUSTRY LICENSING BOARD**  
 1940 NORTH MONROE STREET  
 TALLAHASSEE FL 32399-0783

(850) 487-1395

**RAMDIAL, BOYSIE GANGA**  
**THE HOME DEPOT AT-HOME SERVICES**  
 2690 CUMBERLAND PKWY  
 SUITE 300  
 ATLANTA GA 30339

STATE OF FLORIDA AC# E154636  
 DEPARTMENT OF BUSINESS AND PROFESSIONAL REGULATION

CRC046858 06/06/12 118199306

CERTIFIED RESIDENTIAL CONTRACTOR  
 RAMDIAL, BOYSIE GANGA  
 THE HOME DEPOT AT-HOME SERVICES

IS CERTIFIED under the provisions of Ch. 489 FS  
 Expiration date: AUG 31, 2014 IL2060601558

Congratulations! With this license you become one of the nearly one million Floridians licensed by the Department of Business and Professional Regulation. Our professionals and businesses range from architects to yacht brokers, from boxers to barbeque restaurants, and they keep Florida's economy strong.

Every day we work to improve the way we do business in order to serve you better. For information about our services, please log onto [www.myfloridalicense.com](http://www.myfloridalicense.com). There you can find more information about our divisions and the regulations that impact you, subscribe to department newsletters and learn more about the Department's initiatives.

Our mission at the Department is: License Efficiently, Regulate Fairly. We constantly strive to serve you better so that you can serve your customers. Thank you for doing business in Florida, and congratulations on your new license!

DETACH HERE

THIS DOCUMENT HAS A COLORED BACKGROUND - MICROPRINTING - LINEAR - PATENTED PAPER

AC# 6154636

STATE OF FLORIDA

DEPARTMENT OF BUSINESS AND PROFESSIONAL REGULATION  
 CONSTRUCTION INDUSTRY LICENSING BOARD

SEQ# LI2060601558

DATE	BATCH NUMBER	LICENSE NBR
06/06/2012	118199306	CRC046858

The RESIDENTIAL CONTRACTOR  
 Named below IS CERTIFIED  
 Under the provisions of Chapter 489 FS.  
 Expiration date: AUG 31, 2014

RAMDIAL, BOYSIE GANGA  
 THE HOME DEPOT AT-HOME SERVICES  
 2690 CUMBERLAND PKWY  
 SUITE 300  
 ATLANTA GA 30339

RICK SCOTT  
 GOVERNOR

KEN LAWSON  
 SECRETARY

2013-2014 HILLSBOROUGH COUNTY BUSINESS TAX RECEIPT FOLIO NO. **EXPIRES 9-30-2014**

STATE	PROFESSOR OR MEMBER	RENTS	0	RENTS	0	EMPLOYERS	1	RENEWAL	182589.0000	TAX	18.00
OCC. CODE 090.022 BUSINESS TYPE RESIDENTIAL CONTRACTOR											

BUSINESS LOCATION  
 207 KELSEY LN K TAMPA 33619

NAME  
 RAMDIAL BOYSIE GANVA  
 DBA/THE HOME DEPOT AT-HOME SERVICES  
 2690 CUMBERLAND PKWY STE 300  
 ADDRESS ATLANTA GA 30339

**BUSINESS TAX RECEIPT**

DOUG BRIDEN, TAX COLLECTOR  
 6-15-636-5200  
 THIS BECOMES A TAX RECEIPT WHEN VALIDATED.

PAID - 28641 - 6  
 07/16/2013 \*\*\* 58.00

THIS RECEIPT IS VALID FOR BUSINESS, PROFESSION, OR OCCUPATION SPECIFIED HEREON