



# City of Belle Isle

Universal Engineering Sciences 3532 Maggie Blvd., Orlando, FL 32811  
 Tel 407-581-8161 \* Fax 407-581-0313 \* [www.universalengineering.com](http://www.universalengineering.com)

## PERMIT CARD – PLEASE POST AT JOB SITE

THIS DOCUMENT BECOMES YOUR PERMIT WHEN PROPERLY VALIDATED

Per FBC 105.3.3: An enforcing authority may not issue a building permit for any building construction, erection, alteration, modification, repair or addition unless the permit either includes on its face or there is attached to the permit the following statement: **"NOTICE: In addition to the requirements of this permit, there may be additional restrictions applicable to this property that may be found in the public records of this county, and there may be additional permits required from other governmental entities such as water management districts, state agencies, or federal agencies."** The issuance of this permit does not grant permission to violate any applicable City, Orange County, State of Florida and/or Federal codes and/or ordinances. Separate permits are required for Signs, Roofing, Electrical, Gas, Plumbing and Mechanical services. This permit becomes VOID if the work authorized is not commenced within 6 months, or is suspended or abandoned for a period of 6 months after commencement. **WORK SHALL BE CONSIDERED SUSPENDED IF AN APPROVED INSPECTION HAS NOT BEEN MADE WITHIN A 6 MONTH PERIOD.** PERMISSION IS GRANTED TO DO THE FOLLOWING WORK ACCORDING TO THE CONDITIONS HEREON AND THE APPROVED PLANS AND SPECIFICATIONS, SUBJECT TO COMPLIANCE WITH THE ORDINANCES OF THE CITY OF BELLE ISLE, FLORIDA.

<p><b>Scope of Work:</b> BUILDING: ONE DOOR SIZE FOR SIZE</p> <p><b>Comments:</b> None</p> <p><b>Project Information</b>          Address: 3606 Quando Dr, Belle Isle, FL 32812          Parcel ID: 20-23-30-1646-00-910          Property Owner: Bergman, Jon          Phone Number: 440 334 3432          *****          Company Name: Lowe's Home Centers, Inc          Contractor Name: Cafaro, Peter          License Number: CGC1508417          Address: PO Box 781993, Orlando, FL 32878          Phone Number: 407-468-1010</p>	<p style="text-align: right;"><b>Permit Number: 2017-04-054</b></p> <p style="text-align: right;"><b>Date of Application: 04/18/2017</b>  <b>Date Permit Issued: 04/18/2017</b></p> <p><b>WARNING TO OWNER:</b> "YOUR FAILURE TO RECORD A NOTICE OF COMMENCEMENT MAY RESULT IN YOU PAYING TWICE FOR IMPROVEMENTS TO YOUR PROPERTY. IF YOU INTEND TO OBTAIN FINANCING, CONSULT WITH YOUR LENDER OR AN ATTORNEY BEFORE RECORDING YOUR NOTICE OF COMMENCEMENT." ON THE JOB INSPECTION(S) MUST BE MADE BEFORE PROCEEDING WITH SUBSEQUENT WORK. THIS CARD MUST BE DISPLAYED OUTSIDE AND BE PROTECTED FROM THE WEATHER WHILE BEING VISIBLE FROM THE STREET UNTIL THE FINAL INSPECTIONS HAVE BEEN APPROVED.</p>
--	--

### BUILDING FEATURES

<p><b>IMPACT FEES</b></p> <p>Traffic \$          School \$</p> <p><b>ZONING FEES</b></p> <p>Zoning Fee \$</p> <p><b>UNIVERSAL ENG - BUILDING FEES</b></p> <p>Boat Dock \$          Boat House \$          Building \$          Demo \$          Door(s) \$          Driveway \$          Electrical \$          Fence \$          Gas \$          Irrigation \$          Low Voltage \$          Mechanical \$          Plumbing \$          Pool \$          Roofing \$          Screen Encl \$          Shed \$          Temp Pole \$          Window/Door \$49.50</p> <p><b>SURCHARGE FEES</b></p> <p>Surcharge Fee \$2.00          Surcharge Fee \$2.00</p> <p style="text-align: center;"><b>TOTAL FEES \$53.50</b></p> <p><b>Date Paid</b> 4-19-17</p> <p><b>CC or Check #</b> DISC 8678</p> <p><b>Amount Paid</b> 53.50</p> <p>The person accepting this permit shall conform to the terms of the application on file and construction shall conform to the requirements of the Florida Building Code (FS 553).</p>	<p style="text-align: center;"><b>BUILDING INSPECTOR USE ONLY</b></p> <p>IF APPLICABLE:  <b>Have Zoning Approval Conditions Been Met? YES NO    Have Stormwater Approval Conditions Been Met? YES NO    Silt fencing in place? YES NO    Turbidity Barrier in place? YES NO</b></p> <p><input type="checkbox"/> <b>BUILDING</b></p> <p>1<sup>st</sup> _____ (Footing/Foundation)  <b>Survey specific foundation plan must be onsite before slab pour. Approved Plan on Site? ____</b></p> <p>2<sup>nd</sup> _____ (Slab)</p> <p>3<sup>rd</sup> _____ (Lintel)(Wall Reinforcing on Masonry Building)</p> <p>4<sup>th</sup> _____ (Exterior Framing)(Roof/Wall Sheathing)</p> <p>5<sup>th</sup> _____ (Framing) (To be made after Plumbing/ Mechanical/ Electrical Rough-Ins &amp; Windows/Doors Installed)</p> <p>6<sup>th</sup> _____ (Insulation to be Made After Roof Installed)</p> <p>7<sup>th</sup> _____ (Drywall)</p> <p>8<sup>th</sup> _____ (Sidewalk/Driveway)</p> <p>9<sup>th</sup> _____ (Other)</p> <p>10<sup>th</sup> _____ (Final – After MEP and Other Applicable Finals)</p> <p><input type="checkbox"/> <b>ROOFING    OSHA APPROVED ACCESS MUST BE MADE AVAILABLE TO INSPECTOR</b></p> <p>1<sup>ST</sup> ROOFING Deck Nailing/Dry-in/Flashing _____</p> <p>2<sup>nd</sup> ROOFING Covering In-Progress _____</p> <p>3<sup>rd</sup> ROOFING Covering Final _____</p> <p><input type="checkbox"/> <b>PLUMBING (Pool-Piping, Solar, Irrigation, Water Treatment Equip, Etc...)</b></p> <p><input type="checkbox"/></p> <p>1<sup>ST</sup> _____ (Underground)      2<sup>nd</sup> _____ (Sewer)</p> <p>3<sup>rd</sup> _____ (Rough-In/Tub Set)      4<sup>th</sup> _____ (Final)</p> <p><b>CHECK APPROPRIATE BOX</b></p> <p><input type="checkbox"/> <b>GAS</b> ___ Natural ___ LP    <input type="checkbox"/> <b>MECHANICAL</b>    <input type="checkbox"/> <b>ELECTRICAL</b>    <input type="checkbox"/> <b>LOW VOLTAGE</b></p> <p>1<sup>st</sup> _____ (Rough-In)      2<sup>nd</sup> _____ (Final)</p>
--	--

Inspection requests are to be emailed to [BDscheduling@UniversalEngineering.com](mailto:BDscheduling@UniversalEngineering.com); a confirmation email will be sent back to you upon scheduling. **Next-Day Inspection requests must be made by 4pm.** Please include the following in your request: Permit #, project address, type of inspection, date of the requested inspection, a contact name & a contact phone number. AM or PM may be requested but cannot be guaranteed.

For a copy of your permit, or to check inspection results, please visit <https://universalengineering.sharefile.com>

login ID = [cobi@universalengineering.com](mailto:cobi@universalengineering.com)

password = universal13



**City of Belle Isle**  
 Universal Engineering Sciences 3532 Maggie Blvd., Orlando, FL 32811  
 Tel 407-581-8161 \* Fax 407-581-0313 \* [www.universalengineering.com](http://www.universalengineering.com)

**RECEIVED**  
**APR 18 2017**

**APPLICATION FOR SIZE-FOR-SIZE:  
 WINDOW / DOOR PERMIT**

WARNING TO OWNER: YOUR FAILURE TO RECORD A NOTICE OF COMMENCEMENT MAY RESULT IN YOUR PAYING TWICE FOR IMPROVEMENTS TO YOUR PROPERTY. A NOTICE OF COMMENCEMENT MUST BE RECORDED AND POSTED ON THE JOB SITE BEFORE THE FIRST INSPECTION. IF YOU INTEND TO OBTAIN FINANCING, CONSULT WITH YOUR LENDER OR AN ATTORNEY BEFORE RECORDING YOUR NOTICE OF COMMENCEMENT.

DATE OF APPLICATION: 3/22/17

PERMIT NUMBER 207-04-054

PLEASE PRINT. The undersigned hereby applies for a permit to make installations as indicated below:

Project Address 3606 QUANDO DR, Belle Isle, FL  32809  32812  
 Property Owner JON BERGMAN Phone 440-334-3432  
 Property Owner's Mailing Address SAME City \_\_\_\_\_  
 State \_\_\_\_\_ Zip Code \_\_\_\_\_ Parcel Id Number: 20-23-30-1646-00-910

REQUIRED! To obtain this information, please visit <http://www.ocpafl.org/Searches/ParcelSearch.aspx>

Type of Building: Residential  Commercial  Other

- REQUIRED! Florida Product Approval Screen Printout from [www.floridabuilding.org](http://www.floridabuilding.org) showing the Code Version
- REQUIRED! Florida Product Approval Installation Instructions from [www.floridabuilding.org](http://www.floridabuilding.org) (not the manufacturer instructions)
- REQUIRED! Copies of your General Liability & Worker's Comp Insurance Certificate & State and Local Licenses

Please indicate the nature of work by completing the information below:

Number of Size-for-Size Windows: \_\_\_\_\_ Number of Size-for-Size Doors: 1 Job Valuation: \$2220.85

I hereby certify that the above is true and correct to the best of my knowledge and make Application for Permit as outlined above, and if same is granted I agree to conform to all Florida Building Code Regulations and City Ordinances regulating same and in accordance with plans submitted. The issuance of this permit does not grant permission to violate any applicable Town and/or State of Florida codes and/or ordinances. By signing below, I recognize Republic Services is by legal contract the sole authorized provider of garbage, recycling, yard waste, and commercial garbage and construction debris collection and disposal services with the city limits of the City. Contractors, homeowners and commercial businesses may contact Republic Services at 407-293-8000 to setup accounts for Commercial, Construction Roll Off, or other services needed. Rates are fixed by contract and are available at City Hall or from Republic Services. The City enforces the contract through its code enforcement office. Failure to comply will result in a stop work order.

BY SIGNING THIS APPLICATION, YOU ARE CERTIFYING THAT YOU ARE ACTING AS THE OWNER'S AGENT FOR THIS PERMIT:

LICENSE HOLDER SIGNATURE [Signature] LICENSE # CGC1508417  
 LICENSE HOLDER NAME PETER A CAFARO III COMPANY NAME LOWE'S HOME CENTERS, LLC  
 Street Address PO BOX 781993  
 City ORLANDO State FL Zip Code 32878-1993 Phone Number 407-468-1010  
 Email Address NANHOLMESPERMITS@GMAIL.COM

Building Official: [Signature] Date 4-18-17  
 Verified Contractor's Licenses & Insurance are on file [Signature] Date 4-18-17

Zoning Fee \$ 0  
 Permit Fee \$ 33  
 Review Fee \$ 16.50 ✓  
 3% Florida Surcharge \$ 4.  
 Total Permit Fee \$ 53.50

33  
 16.50  
 4.950  
 15.1K  
 4x2  
 25  
 33 + 2 = 16.50



**City of Belle Isle**  
 Universal Engineering Sciences 3532 Maggie Blvd., Orlando, FL 32811  
 Tel 407-581-8161 \* Fax 407-581-0313 \* [www.universaleengineering.com](http://www.universaleengineering.com)



**Product Approval Form**

BY: \_\_\_\_\_  
 PERMIT # 2017-04-054

DATE: 3/22/17

PROJECT ADDRESS 3606 QUANDO DR., Belle Isle, FL  32809  32812

As required by Florida Statute 553.842 and Florida Administrative Code 9B-72m, please provide the information and approval numbers of the building components listed below if they will be utilized on the building or structure. FL Approved products are listed online at [www.floridabuilding.org](http://www.floridabuilding.org) or can be obtained from the local product supplier. The following information must be turned in with permit application and available onsite for inspections:

1. **This Product Approval Cover Sheet**
2. **Internet screen from FloridaBuilding.org showing PA#, approval and code edition stamped**
3. **Manufacturer's installation details from FloridaBuilding.org and requirements for each product stamped**

Product Type	Manufacturer	Model/Series	FL Product Approval #	Product Type	Manufacturer	Model/Series	FL Product Approval #
<b>EXTERIOR DOORS</b>				<b>WALL PANELS</b>			
Swinging	JELD WEN	FIBERGL	13541.4- <input type="checkbox"/>	Sliding			
Sliding				Soffits			
Sectional/Rollup				Storefront			
Other				Glass Block			
				Other			
<b>WINDOWS</b>				<b>ROOFING PRODUCTS</b>			
Single/Dbf Hung				Asphalt Shingles			
Horizontal Slider				Non Struct Metal			
Casement				Roofing Tiles			
Fixed				Single Ply Roof			
Mullion				Underlayment			
Skylights				Other			
Other							
<b>STRUCTURAL COMPONENTS</b>				<b>OTHER</b>			
Wood Connectors							
Wood Anchors							
Truss Plates							
Insulation Forms							
Lintels							
Other							

It is the applicant's responsibility to verify that specific products have been installed in accordance with their limitations and with the minimum required design pressures for the structure. Specific compliance will be verified during field inspections.

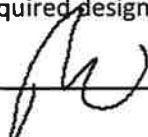
Applicant Signature 

Date 3/24/17



[BCIS Home](#) | [Log In](#) | [User Registration](#) | [Hot Topics](#) | [Submit Surcharge](#) | [Stats & Facts](#) | [Publications](#) | [FBC Staff](#) | [BCIS Site Map](#) | [Links](#) | [Search](#)



**Product Approval**  
USER: Public User

[Product Approval Menu](#) > [Product or Application Search](#) > [Application List](#) > [Application Detail](#)

OFFICE OF THE SECRETARY

**FL #** FL13541-R12  
**Application Type** Editorial Change  
**Code Version** 2014  
**Application Status** Approved



\*Approved by DBPR. Approvals by DBPR shall be reviewed and ratified by the POC and/or the Commission if necessary.

**Comments**  
 Archived

**Product Manufacturer** JELD-WEN  
**Address/Phone/Email** 3737 Lakeport Blvd  
 Klamath Falls, OR 97601  
 (800) 535-3936  
 fbc1@jeld-wen.com

**Authorized Signature** Kaede McLaughlin  
 fbc1@jeld-wen.com

**Technical Representative** JELD-WEN Corporate Customer Service  
**Address/Phone/Email** 3737 Lakeport Blvd.  
 Klamath Falls, OR 97601  
 (800) 535-3936  
 customerserviceagents@jeld-wen.com

**Quality Assurance Representative**  
**Address/Phone/Email**

**Category** Exterior Doors  
**Subcategory** Swinging Exterior Door Assemblies

**Compliance Method** Certification Mark or Listing

**Certification Agency** National Accreditation & Management Institute  
**Validated By** National Accreditation & Management Institute

Referenced Standard and Year (of Standard)	Standard	Year
	AAMA 1304	2002
	ASTM E283	2004
	ASTM E330	2002
	TAS 202	1994

**Equivalence of Product Standards**  
**Certified By**

**Product Approval Method** Method 1 Option A

Date Submitted 03/15/2017  
 Date Validated 03/17/2017  
 Date Pending FBC Approval  
 Date Approved 03/21/2017

**Summary of Products**

FL #	Model, Number or Name	Description
13541.1	A. Design Pro / Smooth Pro / Studio Fiberglass	Single (X) Opaque Fiberglass Door, 3'-0" x 6'-8" and 3'-0" x 8'-0", Inswing and Outswing
<b>Limits of Use</b> Approved for use in HVHZ: No Approved for use outside HVHZ: Yes Impact Resistant: No Design Pressure: +50/-50 Other:		<b>Certification Agency Certificate</b> <a href="#">FL13541 R12 C CAC NI011906.01-R7.pdf</a> <a href="#">FL13541 R12 C CAC NI011906-R6.pdf</a> <b>Quality Assurance Contract Expiration Date</b> 03/30/2026 <b>Installation Instructions</b> <a href="#">FL13541 R12 II A010831A SS 2014-09-26.pdf</a> Verified By: Hermes F. Norero 73778 Created by Independent Third Party: Yes <b>Evaluation Reports</b> <a href="#">FL13541 R12 AE PER2742 SS 2014-09-26.pdf</a> Created by Independent Third Party: Yes
13541.2	B. Design Pro / Smooth Pro Fiberglass	Single (X) Glazed Fiberglass Door, 3'-0" x 6'-8" and 3'-0" x 8'-0", Inswing and Outswing
<b>Limits of Use</b> Approved for use in HVHZ: No Approved for use outside HVHZ: Yes Impact Resistant: No Design Pressure: +50/-50 Other:		<b>Certification Agency Certificate</b> <a href="#">FL13541 R12 C CAC NI011921.01-R4.pdf</a> <a href="#">FL13541 R12 C CAC NI011921-R5.pdf</a> <b>Quality Assurance Contract Expiration Date</b> 03/30/2018 <b>Installation Instructions</b> <a href="#">FL13541 R12 II A010832A SS 2014-09-26.pdf</a> Verified By: Hermes F. Norero, P.E. 73778 Created by Independent Third Party: Yes <b>Evaluation Reports</b> <a href="#">FL13541 R12 AE PER2743 SS 2014-09-26.pdf</a> Created by Independent Third Party: Yes
13541.3	C. Design Pro / Smooth Pro / Studio Fiberglass	Double (XX) Opaque Fiberglass Door, 6'-0" x 6'-8" and 6'-0" x 8'-0", Inswing and Outswing
<b>Limits of Use</b> Approved for use in HVHZ: No Approved for use outside HVHZ: Yes Impact Resistant: No Design Pressure: +50/-50 Other:		<b>Certification Agency Certificate</b> <a href="#">FL13541 R12 C CAC NI011907.01-R6.pdf</a> <a href="#">FL13541 R12 C CAC NI011907-R6.pdf</a> <b>Quality Assurance Contract Expiration Date</b> 03/30/2026 <b>Installation Instructions</b> <a href="#">FL13541 R12 II A010833A SS 2014-09-26.pdf</a> Verified By: Hermes F. Norero 73778 Created by Independent Third Party: Yes <b>Evaluation Reports</b> <a href="#">FL13541 R12 AE PER2744 SS 2014-09-26.pdf</a> Created by Independent Third Party: Yes
13541.4	D. Design Pro / Smooth Pro Fiberglass	Double (XX) Glazed Fiberglass Door, 6'-0" x 6'-8" and 6'-0" x 8'-0", Inswing and Outswing
<b>Limits of Use</b> Approved for use in HVHZ: No Approved for use outside HVHZ: Yes Impact Resistant: No Design Pressure: +50/-50 Other:		<b>Certification Agency Certificate</b> <a href="#">FL13541 R12 C CAC NI011908.01-R5.pdf</a> <a href="#">FL13541 R12 C CAC NI011908-R5.pdf</a> <b>Quality Assurance Contract Expiration Date</b> 03/30/2018 <b>Installation Instructions</b> <a href="#">FL13541 R12 II A010834A SS 2014-09-26.pdf</a> Verified By: Hermes F. Norero 73778 Created by Independent Third Party: Yes <b>Evaluation Reports</b> <a href="#">FL13541 R12 AE PER2745 SS 2014-09-26.pdf</a> Created by Independent Third Party: Yes
13541.5	E. Design Pro / Smooth Pro / Studio Fiberglass	Single with side lite(s) (X,O/ O,X/ O,X,O) Opaque Fiberglass Door, 9'-0" x 6'-8" and 9'-0" x 8'-0", Inswing and Outswing
<b>Limits of Use</b> Approved for use in HVHZ: No Approved for use outside HVHZ: Yes Impact Resistant: No Design Pressure: N/A Other:		<b>Certification Agency Certificate</b> <a href="#">FL13541 R12 C CAC NI011910.01-R7.pdf</a> <a href="#">FL13541 R12 C CAC NI011910-R7.pdf</a> <b>Quality Assurance Contract Expiration Date</b> 03/30/2026 <b>Installation Instructions</b> <a href="#">FL13541 R12 II A010835A SS 2014-09-26.pdf</a> Verified By: Hermes F. Norero 73778

		Created by Independent Third Party: Yes <b>Evaluation Reports</b> <a href="#">FL13541_R12_AE_PER2746_SS_2014-09-26.pdf</a> Created by Independent Third Party: Yes
13541.6	F. Design Pro / Smooth Pro Fiberglass	Single with side lite(s) (X,O/ O,X/ O,X,O) Glazed Fiberglass Door, 9'-0" x 6'-8" and 9'-0" x 8'-0", Inswing and Outswing
<b>Limits of Use</b> Approved for use in HVHZ: No Approved for use outside HVHZ: Yes Impact Resistant: No Design Pressure: N/A Other:		<b>Certification Agency Certificate</b> <a href="#">FL13541_R12_C_CAC_NI011923.01-R5.pdf</a> <a href="#">FL13541_R12_C_CAC_NI011923-R5.pdf</a> <b>Quality Assurance Contract Expiration Date</b> 03/30/2018 <b>Installation Instructions</b> <a href="#">FL13541_R12_II_13541.6.pdf</a> Verified By: Hermes F. Norero 73778 Created by Independent Third Party: Yes <b>Evaluation Reports</b> <a href="#">FL13541_R12_AE_PER2747_SS_2014-09-26.pdf</a> Created by Independent Third Party: Yes
13541.7	G. Design Pro / Smooth Pro / Studio Fiberglass	Double with side lite(s) (XX,O/ O,XX/ O,XX,O) Opaque Fiberglass Door, 12'-0" x 6'-8" and 12'-0" x 8'-0", Inswing and Outswing
<b>Limits of Use</b> Approved for use in HVHZ: No Approved for use outside HVHZ: Yes Impact Resistant: No Design Pressure: N/A Other:		<b>Certification Agency Certificate</b> <a href="#">FL13541_R12_C_CAC_NI011911.01-R7.pdf</a> <a href="#">FL13541_R12_C_CAC_NI011911-R7.pdf</a> <b>Quality Assurance Contract Expiration Date</b> 03/30/2026 <b>Installation Instructions</b> <a href="#">FL13541_R12_II_A010837A_SS_2014-09-26.pdf</a> Verified By: Hermes F. Norero 73778 Created by Independent Third Party: Yes <b>Evaluation Reports</b> <a href="#">FL13541_R12_AE_PER2748_SS_2014-09-26.pdf</a> Created by Independent Third Party: Yes
13541.8	H. Design Pro / Smooth Pro Fiberglass	Double with side lite(s) (XX,O/ O,XX/ O,XX,O) Glazed Fiberglass Door, 12'-0" x 6'-8" and 12'-0" x 8'-0", Inswing and Outswing
<b>Limits of Use</b> Approved for use in HVHZ: No Approved for use outside HVHZ: Yes Impact Resistant: No Design Pressure: N/A Other:		<b>Certification Agency Certificate</b> <a href="#">FL13541_R12_C_CAC_NI011912.01-R5.pdf</a> <a href="#">FL13541_R12_C_CAC_NI011912-R5.pdf</a> <b>Quality Assurance Contract Expiration Date</b> 03/30/2018 <b>Installation Instructions</b> <a href="#">FL13541_R12_II_A010838A_SS_2014-09-26.pdf</a> Verified By: Hermes F. Norero, P.E. 73778 Created by Independent Third Party: Yes <b>Evaluation Reports</b> <a href="#">FL13541_R12_AE_PER2749_SS_2014-09-26.pdf</a> Created by Independent Third Party: Yes

[Back](#) [Next](#)

Contact Us :: 2601 Blair Stone Road, Tallahassee FL 32399 Phone: 850-487-1824

The State of Florida is an AA/EEO employer. Copyright 2007-2013 State of Florida. :: [Privacy Statement](#) :: [Accessibility Statement](#) :: [Refund Statement](#)

Under Florida law, email addresses are public records. If you do not want your e-mail address released in response to a public-records request, do not send electronic mail to this entity. Instead, contact the office by phone or by traditional mail. If you have any questions, please contact 850.487.1395. \*Pursuant to Section 455.275(1), Florida Statutes, effective October 1, 2012, licensees licensed under Chapter 455, F.S. must provide the Department with an email address if they have one. The emails provided may be used for official communication with the licensee. However email addresses are public record. If you do not wish to supply a personal address, please provide the Department with an email address which can be made available to the public. To determine if you are a licensee under Chapter 455, F.S., please click [here](#).

Product Approval Accepts:



Credit Card  
**Safe**





April 14, 2015

Ms. Susan Manchester  
Universal Engineering Sciences, Inc.  
3532 Maggie Blvd.  
Orlando, FL 32811

Via Email: [SManchester@universalengineering.com](mailto:SManchester@universalengineering.com)

Re: Lowe's Home Centers, LLC Competency License Florida General Contractor's License # CGC1508417,  
Peter Anthony Cafaro, III, Certified General Contractor.  
Florida Contractor's License # CCC1326824, Peter Anthony Cafaro, III, Certified Roofing Contractor.

Dear Sir/Madam:

This letter will confirm that Lowe's Home Centers, LLC (a wholly owned subsidiary of Lowe's Companies, Inc. (hereinafter "Lowe's")) intends to satisfy the general liability insurance requirement through a program of self-insurance. Lowe's self insures for each general liability claim in an amount up to and including \$5,000,000 which is the attachment point for Lowe's excess liability policy which is written through Steadfast Insurance Company as evidenced on our certificate of insurance. Lowe's Companies, LLC maintains reserves to support this program of self insurance based on a review (performed at least annually) by a certified casualty actuary.

Lowe's Companies, Inc. is a Fortune 50 company and operates more than 1,750 stores in the US, Canada and Mexico. Lowe's sales in 2014 were in excess of \$53 billion. You may access Lowe's financial information at [www.lowes.com](http://www.lowes.com).

Please feel free to contact me at (704) 758-3123 or [Shonna.M.Splain@lowes.com](mailto:Shonna.M.Splain@lowes.com) if you have any questions.

Very truly yours,

A handwritten signature in black ink that reads "Shonna Splain". The signature is written in a cursive, flowing style.

Shonna Splain  
Insurance & Risk Administrator  
Risk Management Dept



# CERTIFICATE OF LIABILITY INSURANCE

DATE(MM/DD/YYYY)  
03/10/2017

THIS CERTIFICATE IS ISSUED AS A MATTER OF INFORMATION ONLY AND CONFERS NO RIGHTS UPON THE CERTIFICATE HOLDER. THIS CERTIFICATE DOES NOT AFFIRMATIVELY OR NEGATIVELY AMEND, EXTEND OR ALTER THE COVERAGE AFFORDED BY THE POLICIES BELOW. THIS CERTIFICATE OF INSURANCE DOES NOT CONSTITUTE A CONTRACT BETWEEN THE ISSUING INSURER(S), AUTHORIZED REPRESENTATIVE OR PRODUCER, AND THE CERTIFICATE HOLDER.

IMPORTANT: If the certificate holder is an ADDITIONAL INSURED, the policy(ies) must have ADDITIONAL INSURED provisions or be endorsed. If SUBROGATION IS WAIVED, subject to the terms and conditions of the policy, certain policies may require an endorsement. A statement on this certificate does not confer rights to the certificate holder in lieu of such endorsement(s).

<b>PRODUCER</b> Aon Risk Services South, Inc. Charlotte NC Office 1111 Metropolitan Avenue, Suite 400 Charlotte NC 28204 USA	<b>CONTACT NAME:</b> PHONE (A/C. No. Ext): (866) 283-7122      FAX (A/C. No.): (800) 363-0105	
	<b>E-MAIL ADDRESS:</b>	
<b>INSURED</b> Lowe's Companies, Inc. and its subsidiaries 1000 Lowe's Boulevard Mooresville NC 28117 USA	<b>INSURER(S) AFFORDING COVERAGE</b>	
	INSURER A: National Union Fire Ins Co of Pittsburgh	19445
	INSURER B: New Hampshire Ins Co	23841
	INSURER C: Great American Insurance Co.	16691
	INSURER D:	
	INSURER E:	

REVISION NUMBER: 5734960

THE POLICIES LISTED BELOW HAVE BEEN ISSUED TO THE INSURED NAMED ABOVE FOR THE POLICY PERIOD INDICATED. NOTWITHSTANDING ANY REQUIREMENT, TERM OR CONDITION OF ANY CONTRACT OR OTHER DOCUMENT WITH RESPECT TO WHICH THIS CERTIFICATE MAY BE ISSUED OR MAY PERTAIN, THE INSURANCE AFFORDED BY THE POLICIES DESCRIBED HEREIN IS SUBJECT TO ALL THE TERMS, EXCLUSIONS AND CONDITIONS OF SUCH POLICIES. LIMITS SHOWN MAY HAVE BEEN REDUCED BY PAID CLAIMS. Limits shown are as requested

INSR LTR	TYPE OF INSURANCE	ADDL SUBR INSDI WVD	POLICY NUMBER	POLICY EFF (MM/DD/YYYY)	POLICY EXP (MM/DD/YYYY)	LIMITS
	<b>COMMERCIAL GENERAL LIABILITY</b> <input type="checkbox"/> CLAIMS-MADE <input type="checkbox"/> OCCUR  GEN'L AGGREGATE LIMIT APPLIES PER: <input type="checkbox"/> POLICY <input type="checkbox"/> PRO-JECT <input type="checkbox"/> LOC OTHER:					EACH OCCURRENCE DAMAGE TO RENTED PREMISES (Ea occurrence) <b>MED EXP (Any one person)</b> PERSONAL & ADV INJURY GENERAL AGGREGATE PRODUCTS - COMP/OP AGG
A	<input checked="" type="checkbox"/> ANY AUTO <input type="checkbox"/> OWNED AUTOS ONLY <input type="checkbox"/> SCHEDULED AUTOS <input type="checkbox"/> HIRED AUTOS ONLY <input type="checkbox"/> NON-OWNED AUTOS ONLY		AOS CA 1921889 MA CA 1921891 VA	04/01/2017	04/01/2018	COMBINED SINGLE LIMIT (Ea accident) \$5,000,000 <b>BODILY INJURY (Per person)</b> BODILY INJURY (Per accident) PROPERTY DAMAGE (Per accident)
C	<input checked="" type="checkbox"/> UMBRELLA LIAB <input checked="" type="checkbox"/> OCCUR <input type="checkbox"/> EXCESS LIAB <input type="checkbox"/> CLAIMS-MADE <input type="checkbox"/> RETENTION		UMB1603335	04/01/2017	04/01/2018	EACH OCCURRENCE \$5,000,000 AGGREGATE \$5,000,000
B	<b>WORKERS COMPENSATION AND EMPLOYERS' LIABILITY</b> ANY PROPRIETOR / PARTNER / EXECUTIVE OFFICER/MEMBER EXCLUDED? (Mandatory in NH) If yes, describe under "DESCRIPTION OF OPERATIONS" below	Y/N N	WC023102416 AOS SIR applies per policy terms & conditions	04/01/2017	04/01/2018	<input checked="" type="checkbox"/> PER STATUTE <input type="checkbox"/> OTHER E.L. EACH ACCIDENT \$2,000,000 E.L. DISEASE-EA EMPLOYEE \$2,000,000 E.L. DISEASE-POLICY LIMIT \$2,000,000 E.L. Each Accident \$3,000,000 EL Disease - Policy \$3,000,000 EL Disease - Ea Emp \$3,000,000
			AOS SIR applies per policy terms & conditions			E.L. Each Accident \$3,000,000 EL Disease - Policy \$3,000,000 EL Disease - Ea Emp \$3,000,000

DESCRIPTION OF OPERATIONS / LOCATIONS / VEHICLES (ACORD 101, Additional Remarks Schedule, may be attached if more space is required)  
 Commercial General Liability is Self-Insured.  
 Lowe's Home Centers, Inc. and Lowe's Home Centers, LLC is a named insured under the captioned policies. Florida General Contractor's License # GC1508417, Peter Anthony Cafaro, III, Certified General Contractor. Florida Contractor's License # CCC1326824, Peter Anthony Cafaro, III, Certified Roofing Contractor.

<b>CERTIFICATE HOLDER</b>  City of Belle Isle 1600 Nela Avenue Belle Isle FL 32809 USA	<b>CANCELLATION</b> SHOULD ANY OF THE ABOVE DESCRIBED POLICIES BE CANCELLED BEFORE THE EXPIRATION DATE, NOTICE SHALL BE DELIVERED IN ACCORDANCE WITH THE POLICY PROVISIONS.  AUTHORIZED REPRESENTATIVE  <i>Aon Risk Services South, Inc.</i>
--	---





# DESIGN PRO / SMOOTH PRO FULL LITE NON-IMPACT

FOR USE OUTSIDE THE HIGH VELOCITY HURRICANE ZONE (HVHZ)

**GENERAL NOTES:**

- THE PRODUCT SHOWN HEREIN IS DESIGNED AND MANUFACTURED TO COMPLY WITH THE CURRENT INTERNATIONAL BUILDING CODE (IBC), INTERNATIONAL RESIDENTIAL CODE (IRC), AND FLORIDA BUILDING CODE (FBC), **EXCLUDING** HVHZ AND HAS BEEN EVALUATED ACCORDING TO THE FOLLOWING:
  - ASTM E330-02
  - ASTM E283-04
  - AAMA 1304-02
  - TAS 202-94
- ADEQUACY OF THE EXISTING STRUCTURAL CONCRETE/MASONRY OR 2X FRAMING AS A MAIN WIND FORCE RESISTING SYSTEM CAPABLE OF WITHSTANDING AND TRANSFERRING APPLIED PRODUCT LOADS TO THE FOUNDATION IS THE RESPONSIBILITY OF THE ENGINEER OR ARCHITECT OF RECORD FOR THE PROJECT OF INSTALLATION.
- THE INSTALLATION DETAILS DESCRIBED HEREIN ARE GENERIC AND MAY NOT REFLECT ACTUAL CONDITIONS FOR A SPECIFIC SITE. IF SITE CONDITIONS CAUSE INSTALLATION TO DEVIATE FROM THE REQUIREMENTS DETAILED HEREIN, A LICENSED ENGINEER OR ARCHITECT SHALL PREPARE SITE SPECIFIC DOCUMENTS FOR USE WITH THIS DOCUMENT.
- APPROVED IMPACT PROTECTIVE SYSTEM **IS REQUIRED** ON THIS PRODUCT IN AREAS REQUIRING IMPACT RESISTANCE.
- GLASS MEETS THE REQUIREMENTS OF ASTM E 1300 GLASS CHARTS. SEE SHEET 6 FOR GLAZING DETAILS.
- FULL LITE APPROVAL COVERS USE OF FRACTIONAL GLAZING, INCLUDING INTERNAL GRID, BLINDS BETWEEN GLASS, DECORATIVE, AND EXTERNAL AND INTERNAL WROUGHT IRON. RADIUS (SHAPED) LITES ARE QUALIFIED FOR 6'-8" DOORS AT DP +/-50 PSF ONLY.
- NOTE: AFCO H-497 SILL MEETS WATER INFILTRATION AT WATER TEST PRESSURE (WTP) OF 9.0 PSF. REMAINING SILLS NOT RATED FOR WATER INFILTRATION. IF AUTHORITY HAVING JURISDICTION REQUIRES THAT PRODUCT MEETS THIS REQUIREMENT, PRODUCT SHALL BE USED WHEN INSTALLED AT LOCATION PROTECTED BY OVERHANG SUCH THAT OVERHANG (OH) RATIO = OH LENGTH ÷ OH HEIGHT IS ≥ 1.0

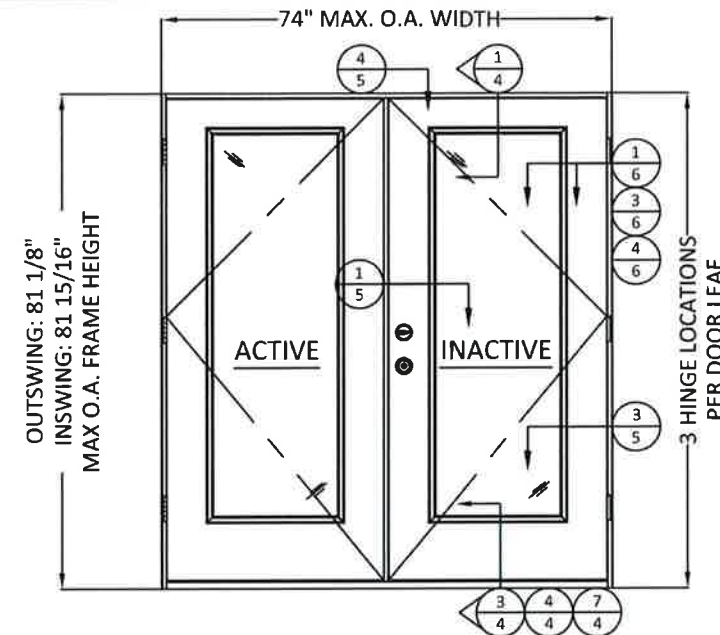

**1** TYP. ELEVATION 1  
6'-8" DOOR HEIGHT

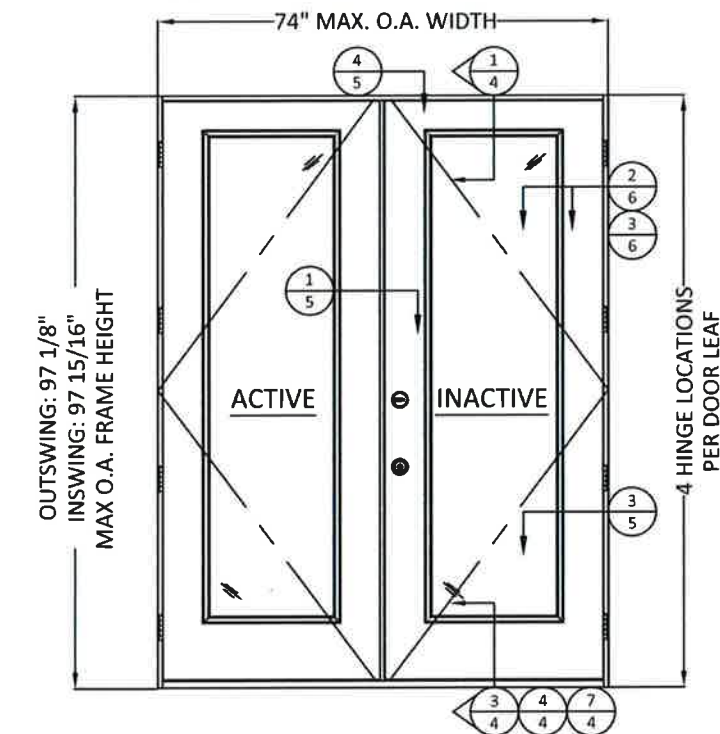

**2** TYP. ELEVATION 2  
8'-0" DOOR HEIGHT

NOTE:  
INACTIVE AND ACTIVE DOOR PANEL  
ORIENTATION IS INTERCHANGEABLE.

TABLE OF CONTENTS		
SHEET	REVISION	SHEET DESCRIPTION
1	B	TYPICAL ELEVATIONS, DESIGN PRESSURES, AND GENERAL NOTES
2	A	TYPICAL ANCHOR LAYOUTS AND NOTES
3	A	OPTIONAL 2X BUCK ANCHORING DETAILS
4	A	VERTICAL ASSEMBLIES
5	A	HORIZONTAL ASSEMBLIES
6	A	GLAZING DETAILS
7	A	WOOD SUBSTRATES
8	A	CONCRETE SUBSTRATES
9	A	COMPONENTS & BILL OF MATERIALS

CONFIGURATION	MAX. OVERALL NOMINAL SIZE		DESIGN PRESSURE (PSF)				MISSILE IMPACT RATING
	WIDTH	HEIGHT	INSWING		OUTSWING		
			POS.	NEG.	POS.	NEG.	
XX	6'-0"	6'-8"	50*	50	50*	50	NON-IMPACT
XX RADIUS	6'-0"	6'-8"	50*	50	50*	50	NON-IMPACT
XX	6'-0"	8'-0"	50*	50	50*	50	NON-IMPACT

\*SEE GENERAL NOTE 7, SHEET 1, FOR WATER INFILTRATION APPROVED SILLS.

PREPARED BY:  
  
**BUILDING DROPS, INC.**  
 398 E. DANIA BEACH BLVD., STE. 338  
 DANIA BEACH, FL 33004  
 PH: (954)399-8478  
 FAX: (954)744-4738  
 WEB: www.buildingdrops.com

TITLE: DESIGN PRO/SMOOTH PRO FULL LITE  
NON-IMPACT  
TYPICAL ELEVATIONS, DESIGN PRESSURES, AND GENERAL NOTES

3737 LAKEPORT BLVD.,  
KLAMATH FALLS, OR 97601  
PH: (541)882-3451  
FAX: (541)850-2609

**JELD WEN**  
WINDOWS & DOORS

REMARKS	BY	DATE
Add Multi-Point Lock	GL	06/12/14
Add TAS 202-94 Standard	SM	09/22/14

THIS DOCUMENT IS THE PROPERTY OF BUILDING DROPS, INC. AND SHALL NOT BE REPRODUCED IN WHOLE OR PART WITHOUT WRITTEN CONSENT OF BUILDING DROPS, INC. ALTERATIONS, ADDITIONS, HIGHLIGHTING, OR OTHER MARKINGS TO THIS DOCUMENT ARE NOT PERMITTED AND INVALIDATE THIS DOCUMENT.

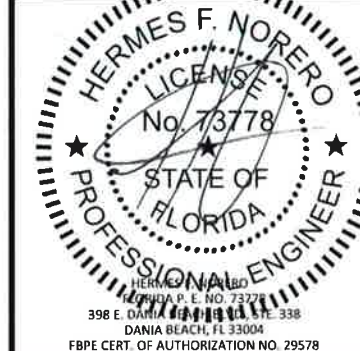

Digitally signed by Hermes F. Norero, P.E.  
Reason: I am approving this document  
Date: 2014.09.26 14:55:17 -04'00'

DATE: 02.05.14  
 DWG. BY: GL/TJM  
 CHK. BY: SS/MSS  
 SCALE: NTS  
 DWG. #: A010834A  
 SHEET: OF 9



**INSTALLATION NOTES:**

- ONE (1) INSTALLATION ANCHOR IS REQUIRED AT EACH ANCHOR LOCATION SHOWN.
- SHIM AS REQUIRED AT EACH INSTALLATION ANCHOR WITH LOAD BEARING SHIM(S). MAXIMUM ALLOWABLE SHIM STACK TO BE 1/4 INCH. SHIM WHERE SPACE OF 1/16 INCH OR GREATER OCCURS. SHIM(S) SHALL BE A NON-COMPRESSIBLE COMPOSITE OR BETTER.
- MINIMUM EMBEDMENT AND EDGE DISTANCE EXCLUDE WALL FINISHES, INCLUDING BUT NOT LIMITED TO STUCCO, FOAM, BRICK VENEER, AND SIDING.
- INSTALLATION ANCHORS AND ASSOCIATED HARDWARE MUST BE MADE OF CORROSION RESISTANT MATERIAL OR HAVE A CORROSION RESISTANT COATING, AND SHALL BE INSTALLED IN ACCORDANCE WITH ANCHOR MANUFACTURER'S INSTALLATION INSTRUCTIONS.
- FOR HOLLOW BLOCK AND GROUT FILLED BLOCK, DO NOT INSTALL INSTALLATION ANCHORS INTO MORTAR JOINTS. EDGE DISTANCE IS MEASURED FROM FREE EDGE OF BLOCK OR EDGE OF MORTAR JOINT INTO FACE SHELL OF BLOCK.
- FOR 2X STUD CONSTRUCTION, ANCHORING OF THESE PRODUCTS SHALL BE THE SAME AS FOR 2X BUCK CONCRETE/MASONRY CONSTRUCTION.
- INSTALLATION ANCHOR CAPACITIES FOR PRODUCTS HEREIN ARE BASED ON SUBSTRATE MATERIALS WITH THE FOLLOWING PROPERTIES:
  - WOOD - MINIMUM SPECIFIC GRAVITY OF 0.55.
  - CONCRETE - MINIMUM COMPRESSIVE STRENGTH OF 3000 PSI.
  - GROUT-FILLED CMU- UNIT STRENGTH CONFORMS TO ASTM C-90 WITH MINIMUM COMPRESSIVE STRENGTH OF 2000 PSI AND GROUT CONFORMS TO ASTM C 476, MINIMUM GROUT COMPRESSIVE STRENGTH OF 2000 PSI.
  - HOLLOW BLOCK CMU - UNIT STRENGTH CONFORMS TO ASTM C-90 WITH MINIMUM COMPRESSIVE STRENGTH OF 2000 PSI.
- SEE SHEETS 7 AND 8 FOR MORE DETAILS OF THE INSTALLATION REQUIREMENTS, INCLUDING ANCHOR LOCATIONS, EDGE DISTANCES, EMBEDMENTS, AND SHIM SPACING.
- OPTIONALLY, ANCHORS CAN BE PLACED IN NARROW SECTION OF HEAD OR JAMB AS LONG AS MINIMUM EMBEDMENT AND EDGE DISTANCE ARE ACHIEVED.

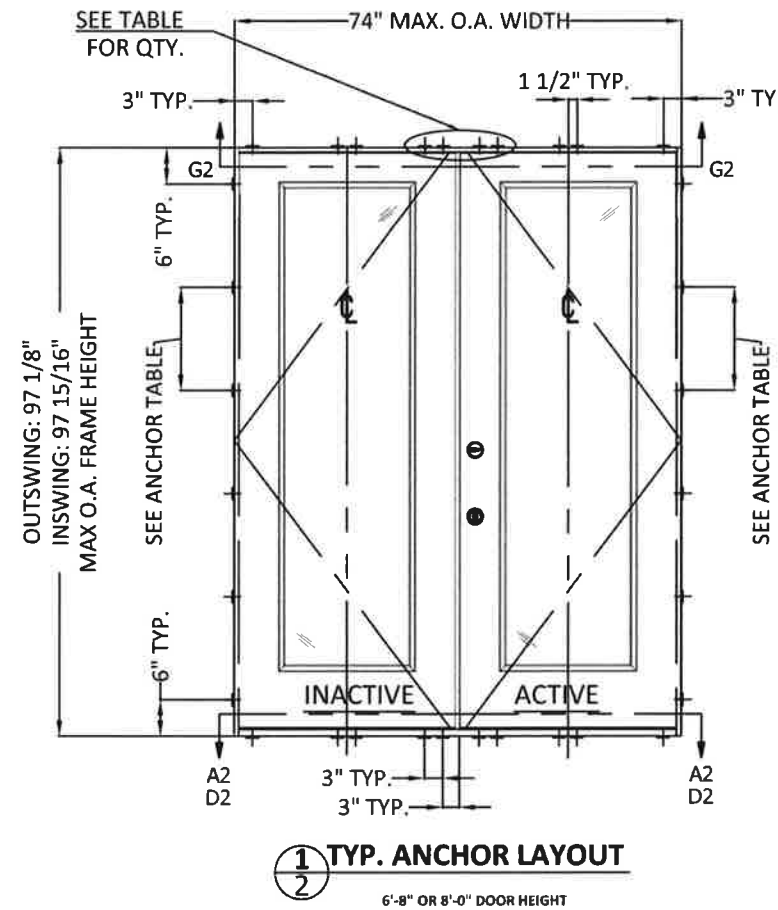

ANCHOR TABLE								
ANCHOR TYPE	ANCHOR SIZE	SUBSTRATE	MIN. EMBEDMENT	MIN. EDGE DISTANCE	6'8\" DOORS		8'0\" DOORS	
					MAX. O.C. SPACING AT JAMBS	# OF ANCHORS AT HEAD/SILL CLUSTERS	MAX. O.C. SPACING AT JAMBS	# OF ANCHORS AT HEAD/SILL CLUSTERS
WOOD SCREW	#10	2X WOOD BUCK OR FRAMING	1-1/2"	3/4"	17-1/2"	4	17-1/4"	4
ITW TAPCON	3/16"	CONCRETE/CMU	1-1/4"	2-1/2"	17-1/2"	4	17-1/4"	4
ELCO ULTRACON	1/4"	CONCRETE/CMU	1-3/8" - CONC. 1-1/4" - CMU	1"	17-1/2"	4	17-1/4"	4
ITW TAPCON	3/16"	CONCRETE/CMU	1-1/4"	1"	11-5/8"	8	14-3/8"	6

**NOTE:**  
INACTIVE AND ACTIVE DOOR PANEL ORIENTATION IS INTERCHANGEABLE.

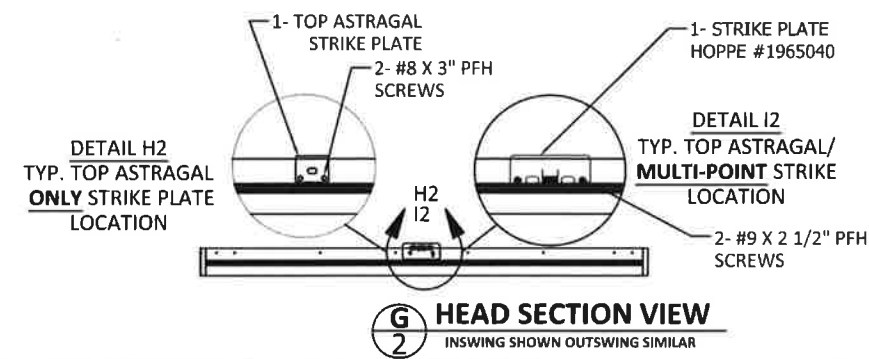
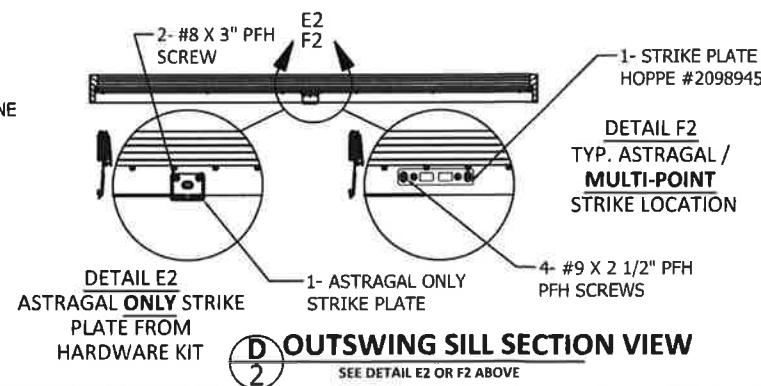
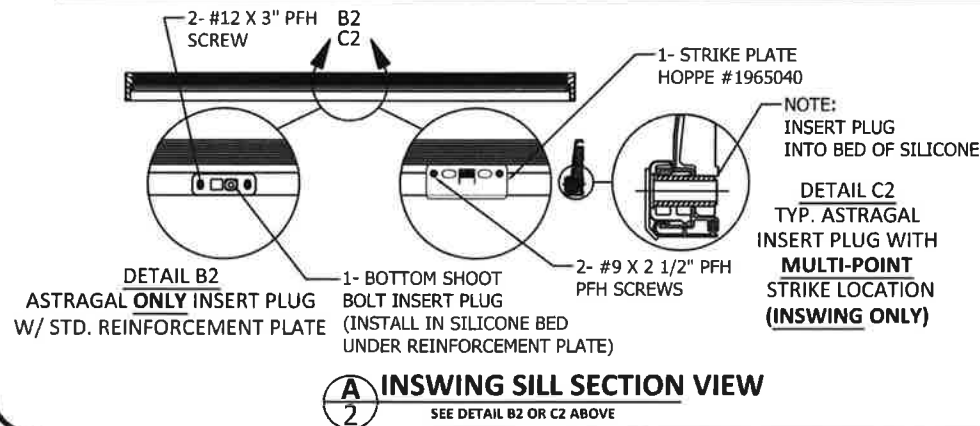

PREPARED BY:  
  
**BUILDING DROPS, INC.**  
398 E. DANIA BEACH BLVD., STE. 338  
DANIA BEACH, FL 33004  
PH: (954)399-8478  
FAX: (954)744-4738  
WEB: www.buildingdrops.com

TITLE: DESIGN PRO/SMOOTH PRO FULL LITE NON-IMPACT  
**ANCHOR LAYOUTS AND NOTES**  
3737 LAKEPORT BLVD.,  
KLAMATH FALLS, OR 97601  
PH: (541)882-3451  
FAX: (541)850-2609  
**JELBOWEN**  
WINDOWS & DOORS

REMARKS	BY	DATE
Add Multi-Point Lock	GL	06/12/14

THIS DOCUMENT IS THE PROPERTY OF BUILDING DROPS, INC. AND SHALL NOT BE REPRODUCED IN WHOLE OR PART WITHOUT WRITTEN CONSENT OF BUILDING DROPS, INC. ALTERATIONS, ADDITIONS, HIGHLIGHTING, OR OTHER MARKINGS TO THIS DOCUMENT ARE NOT PERMITTED AND INVALIDATE THIS DOCUMENT.

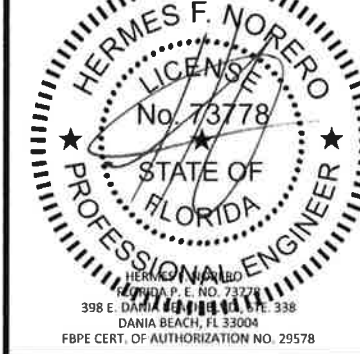

DATE: 02.05.14  
DWG. BY: GL/TJM | CHK. BY: SS/MSS  
SCALE: NTS  
DWG. #: A010834A  
SHEET: 2 OF 9

PREPARED BY:



**BUILDING DROPS, INC.**

398 E. DANIA BEACH BLVD., STE. 338  
 DANIA BEACH, FL 33004  
 PH: (954)399-8478  
 FAX: (954)744-4738  
 WEB: www.buildingdrops.com

TITLE: DESIGN PRO/SMOOTH PRO FULL LITE  
 NON-IMPACT

OPTIONAL 2X BUCK  
 ANCHORING DETAILS

3737 LAKEPORT BLVD.,  
 KLAMATH FALLS, OR 97601  
 PH: (541)882-3451  
 FAX: (541)850-2609

**JELD-WEN**  
 WINDOWS & DOORS

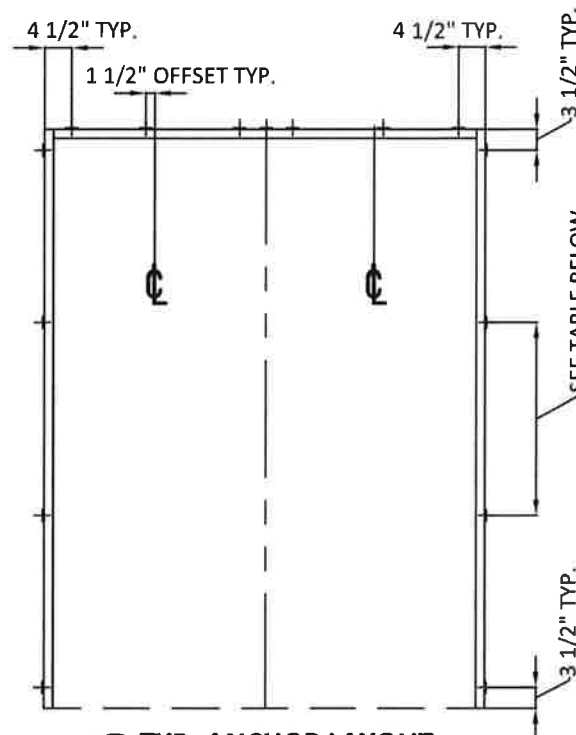

1 TYP. ANCHOR LAYOUT  
 3 OPTIONAL 2X BUCK IN CONCRETE/MASONRY

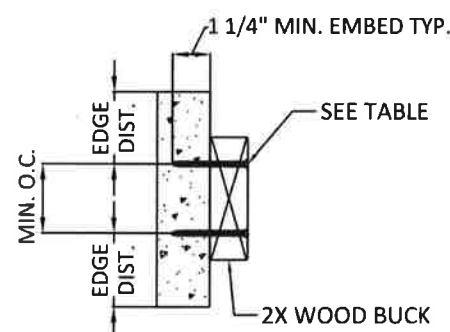

3 2X WOOD BUCK INSTALL.  
 CROSS SECTION

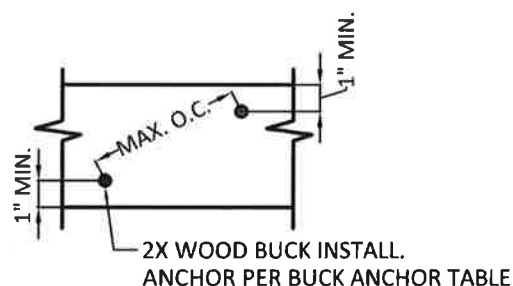

4 2X WOOD BUCK INSTALL.  
 SIDE VIEW

2X BUCK ANCHOR TABLE							
ANCHOR TYPE	ANCHOR SIZE	SUBSTRATE	MIN. EMBEDMENT	MIN. EDGE DIST. TO SUBSTRATE	MIN. CENTER TO CENTER DISTANCE	6'8" DOORS	8'0" DOORS
						MAX. O.C. SPACING AT JAMBS	MAX. O.C. SPACING AT JAMBS
ITW TAPCON	1/4"	CONCRETE/CMU	1-1/4"	2-1/2"	4"	25"	30-1/4"
ELCO ULTRACON	1/4"	CONCRETE/CMU	1-3/8" - CONC. 1-1/4" - CMU	1"	4"	25"	30-1/4"

REMARKS	BY	DATE
Add Multi-Point Lock	GL	06/12/14

THIS DOCUMENT IS THE PROPERTY OF BUILDING DROPS, INC. AND SHALL NOT BE REPRODUCED IN WHOLE OR PART WITHOUT WRITTEN CONSENT OF BUILDING DROPS, INC. ALTERATIONS, ADDITIONS, HIGHLIGHTING, OR OTHER MARKINGS TO THIS DOCUMENT ARE NOT PERMITTED AND INVALIDATION.

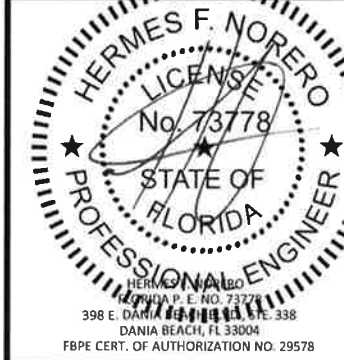

DATE: 02.05.14

DWG. BY: GL/TJM  
 CHK. BY: SS/MSS

SCALE: NTS

DWG. #: A010834A

SHEET: OF 9

NOTES:

- 2X BUCK IS NOT FOR INSTALLATION AT SILL. THRESHOLD SHALL BE FASTENED IN ACCORDANCE WITH ANCHOR LOCATIONS SHOWN ON SHEET 2.
- ANCHORS MAY BE STAGGERED AS SHOWN IN DETAIL 4/3.

PREPARED BY:



**BUILDING DROPS, INC.**

398 E. DANIA BEACH BLVD., STE. 338  
DANIA BEACH, FL 33004  
PH: (954)399-8478  
FAX: (954)744.4738  
WEB: www.buildingdrops.com

DESIGN PRO/SMOOTH PRO FULL LITE  
NON-IMPACT

VERTICAL ASSEMBLIES

3737 LAKEPORT BLVD.,  
KLAMATH FALLS, OR 97601  
PH: (541)882-3451  
FAX: (541)850-2609

**JELD-WEN**  
WINDOWS & DOORS

TITLE:

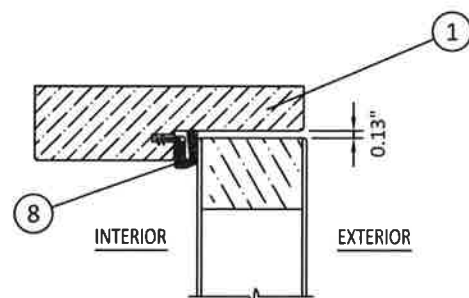

**1**  
**4** OPERABLE HEAD  
OUTSWING SHOWN - INSWING SIMILAR

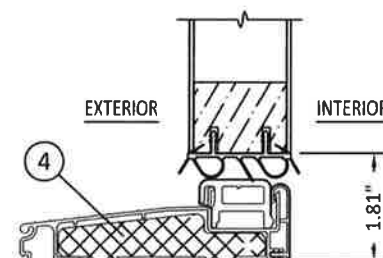

**3**  
**4** OPERABLE SILL  
INSWING  
ENDURA ZAIL4565F

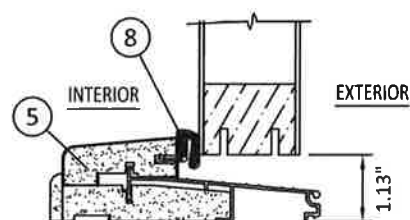

**4**  
**4** OPERABLE SILL  
OUTSWING  
AFCO J-2297

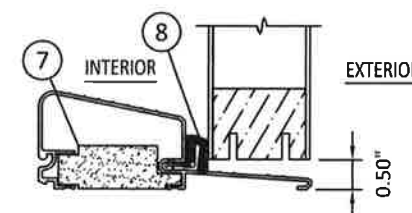

**7**  
**4** OPERABLE SILL  
OUTSWING  
OPTIONAL AFCO H-497

REMARKS	BY	DATE
Add Multi-Point Lock	GL	06/12/14

THIS DOCUMENT IS THE PROPERTY OF BUILDING DROPS, INC. AND SHALL NOT BE REPRODUCED IN WHOLE OR PART WITHOUT WRITTEN CONSENT OF BUILDING DROPS, INC. ALTERATIONS, ADDITIONS, HIGHLIGHTING, OR OTHER MARKINGS TO THIS DOCUMENT ARE NOT PERMITTED AND INVALIDATION.

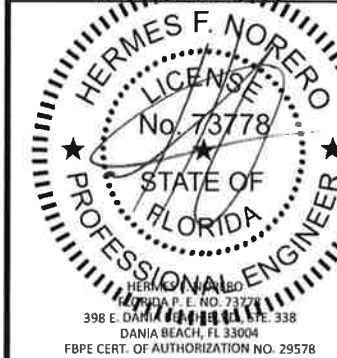

DATE: 02.05.14

DWG. BY: GL/TJM      CHK. BY: SS/MSS

SCALE: NTS

DWG. #: A010834A

SHEET:                      OF 9

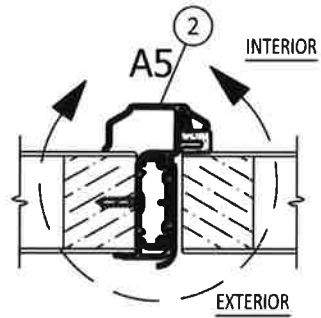

**1**  
**5** MEETING STILE  
OUTSWING SHOWN - INSWING SIMILAR

HINGE SCHEDULE	
DOOR HEIGHT	QUANTITY
6'-8"	3
8'-0"	4

HINGE DETAIL AT JAMB:  
PLACE #9 X 2-1/2" PFH SCREW NEXT TO WEATHERSTRIP

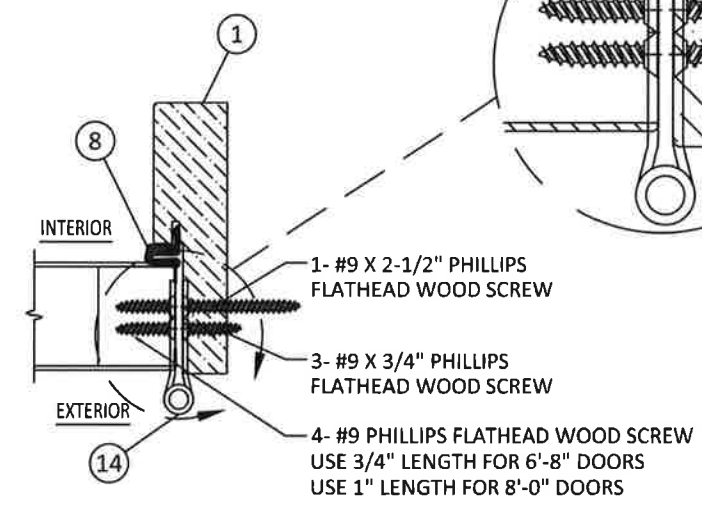
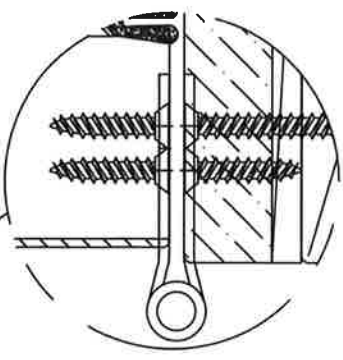

**3**  
**5** HINGE JAMB  
OUTSWING SHOWN - INSWING SIMILAR

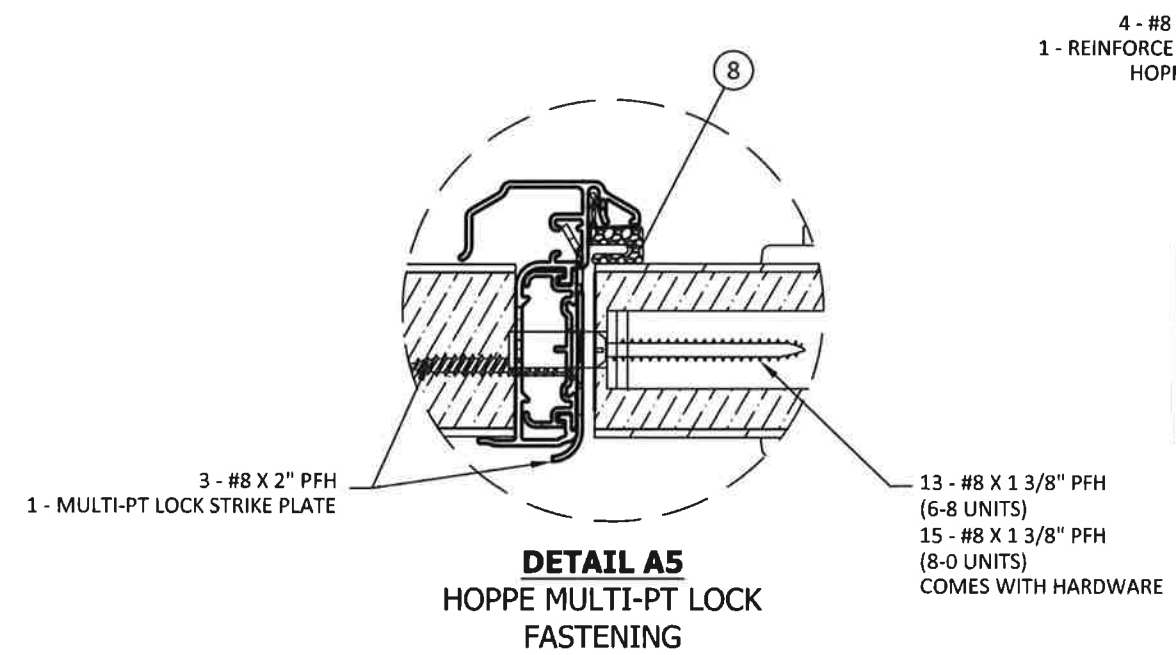

**DETAIL A5**  
HOPPE MULTI-PT LOCK  
FASTENING

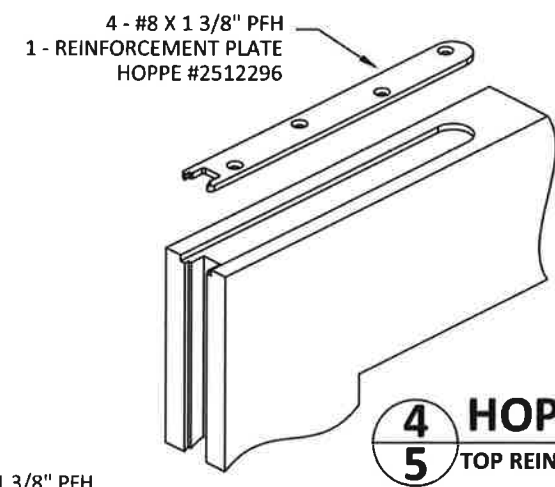

**4**  
**5** HOPPE MULTI-POINT LOCK  
TOP REINFORCEMENT PLATE - ACTIVE PANEL ONLY

PREPARED BY:  
  
**BUILDING DROPS, INC.**  
398 E. DANIA BEACH BLVD., STE. 338  
DANIA BEACH, FL 33004  
PH: (954)399-8478  
FAX: (954)744-4738  
WEB: www.buildingdrops.com

TITLE: DESIGN PRO/SMOOTH PRO FULL LITE  
NON-IMPACT  
HORIZONTAL ASSEMBLIES

3737 LAKEPORT BLVD.,  
KLAMATH FALLS, OR 97601  
PH: (541)882-3451  
FAX: (541)850-2609

**JELD-WEN**  
WINDOWS & DOORS

REMARKS	BY	DATE
Add Multi-Point Lock	GL	06/12/14

THIS DOCUMENT IS THE PROPERTY OF BUILDING DROPS, INC. AND SHALL NOT BE REPRODUCED IN WHOLE OR PART WITHOUT WRITTEN CONSENT OF BUILDING DROPS, INC. ALTERATIONS, ADDITIONS, HIGHLIGHTING, OR OTHER MARKINGS TO THIS DOCUMENT ARE NOT PERMITTED AND INVALID.

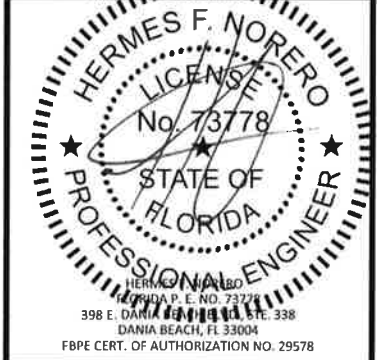

HERMES F. NORERO  
FLORIDA P. E. NO. 73778  
398 E. DANIA BEACH, STE. 338  
DANIA BEACH, FL 33004  
FBPE CERT. OF AUTHORIZATION NO. 29578

DATE: 02.05.14  
DWG. BY: GL/TJM    CHK. BY: SS/MSS  
SCALE: NTS  
DWG. #: A010834A  
SHEET:            OF 9

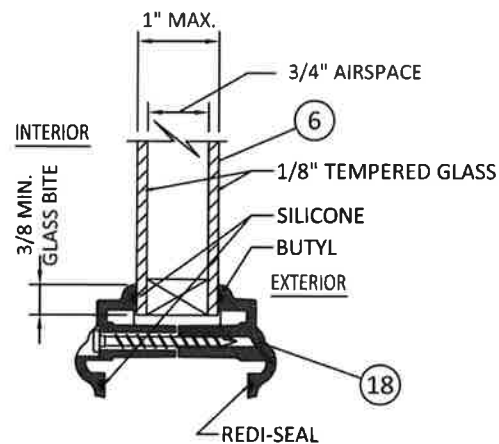

**1** **6'-8" GLAZING DETAIL**  
**6** 20 1/2" MAX. D.L.O. WIDTH  
 62 1/2" MAX. D.L.O. HEIGHT

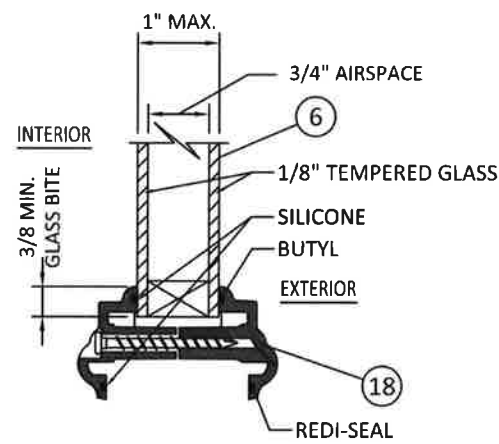

**2** **8'-0" GLAZING DETAIL**  
**6** 20 1/2" MAX. D.L.O. WIDTH  
 78 1/2" MAX. D.L.O. HEIGHT

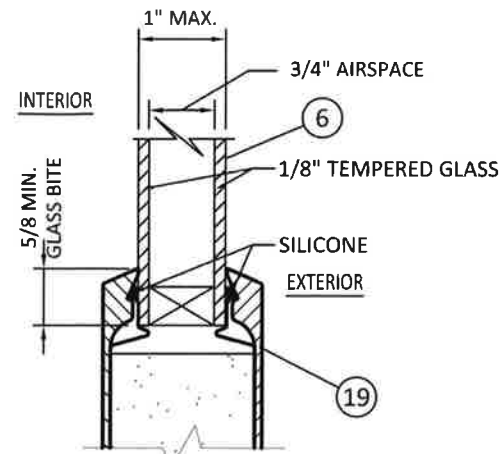

**3** **FLUSH GLAZE DETAIL**  
**6** 23 7/8" MAX. D.L.O. WIDTH  
 78 7/8" MAX. D.L.O. HEIGHT

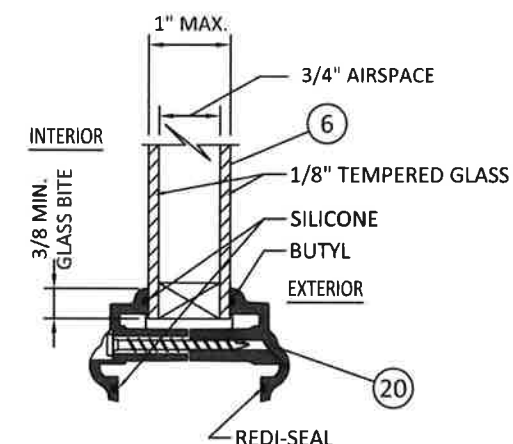

**4** **GLAZING DETAIL**  
**6** FOR OVAL, SUNBURST, AND ROUND TOPS  
 ONLY IN 6'8" UNITS AT DP+/- 50 PSF

NOTE:  
 FRACTIONAL GLAZING, INCLUDING INTERNAL GRID, BLINDS  
 BETWEEN GLASS, DECORATIVE, EXTERNAL AND INTERNAL  
 WROUGHT IRON AND RADIUS (SHAPED) LITES ARE APPROVED  
 IN ALL GLAZING DETAILS SHOWN ABOVE.

PREPARED BY:



**BUILDING DROPS, INC.**  
 398 E. DANIA BEACH BLVD., STE. 338  
 DANIA BEACH, FL 33004  
 PH: (954)399-8478  
 FAX: (954)744.4738  
 WEB: www.buildingdrops.com

DESIGN PRO/SMOOTH PRO FULL LITE  
 NON-IMPACT  
 GLAZING DETAILS

3737 LAKEPORT BLVD.,  
 KLAMATH FALLS, OR 97601  
 PH: (541)882-3451  
 FAX: (541)850-2609

**JELD-WEN**  
 WINDOWS & DOORS

TITLE:

REMARKS	BY	DATE
Add Multi-Point Lock	GL	06/12/14

THIS DOCUMENT IS THE PROPERTY OF BUILDING DROPS, INC. AND SHALL NOT BE REPRODUCED IN WHOLE OR PART WITHOUT WRITTEN CONSENT OF BUILDING DROPS, INC. ALTERATIONS, ADDITIONS, HIGHLIGHTING, OR OTHER MARKINGS TO THIS DOCUMENT ARE NOT PERMITTED AND INVALIDATION.

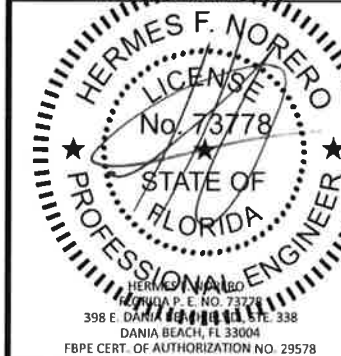

DATE: 02.05.14

DWG. BY: GL/TJM      CHK. BY: SS/MSS

SCALE: NTS

DWG. #: A010834A

SHEET: 6 OF 9

6

PREPARED BY:



**BUILDING DROPS, INC.**

398 E. DANIA BEACH BLVD., STE. 338  
 DANIA BEACH, FL 33004  
 PH: (954)399-8478  
 FAX: (954)744-4738  
 WEB: www.buildingdrops.com

TITLE: DESIGN PRO/SMOOTH PRO FULL LITE  
 NON-IMPACT  
 WOOD INSTALLATION

3737 LAKEPORT BLVD.,  
 KLAMATH FALLS, OR 97601  
 PH: (541)882-3451  
 FAX: (541)850-2609

**JELD-WEN**  
 WINDOWS & DOORS

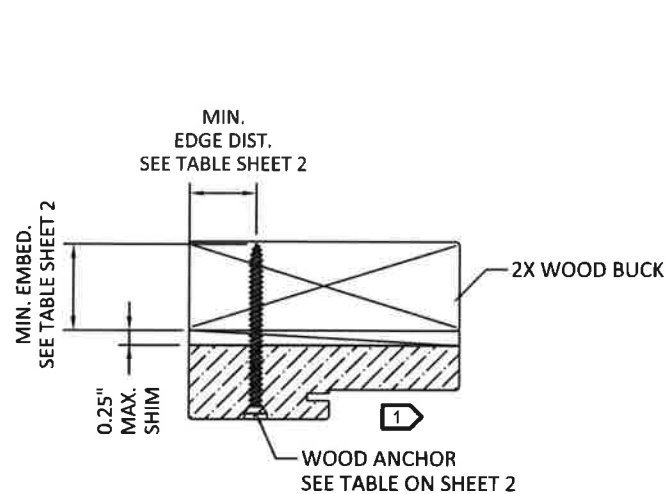

**1**  
**7** HEAD (TYPICAL)  
 OUTSWING SHOWN - INSWING SIMILAR

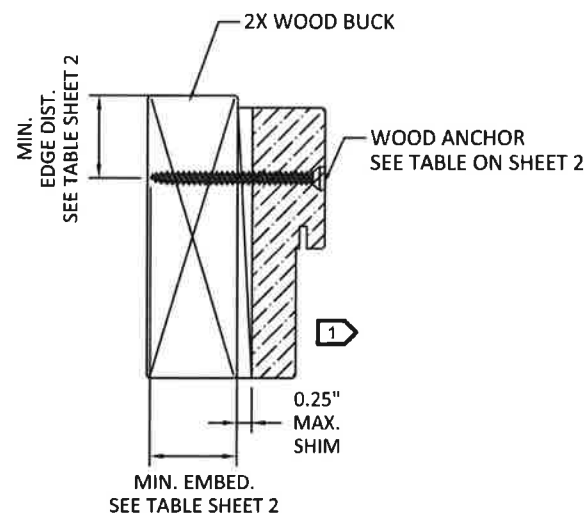

**2**  
**7** JAMB (TYPICAL)  
 OUTSWING SHOWN - INSWING SIMILAR

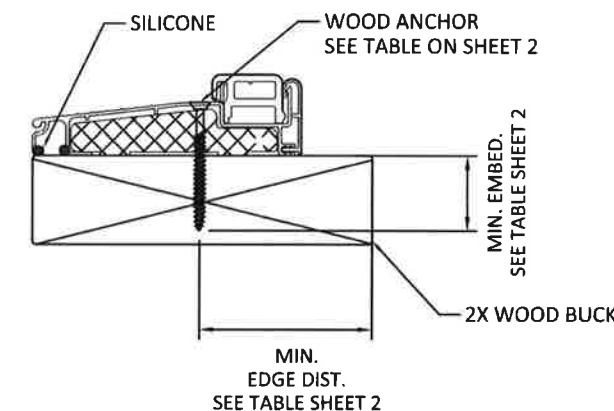

**3**  
**7** OPERABLE SILL  
 INSWING  
 ENDURA ZAIL4565F

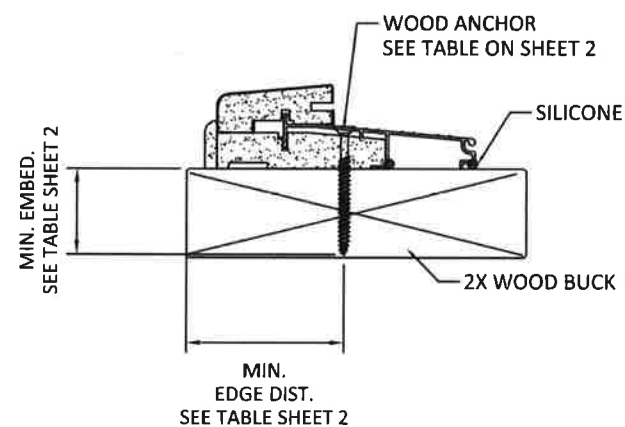

**4**  
**7** OPERABLE SILL  
 OUTSWING  
 AFCO J-2297

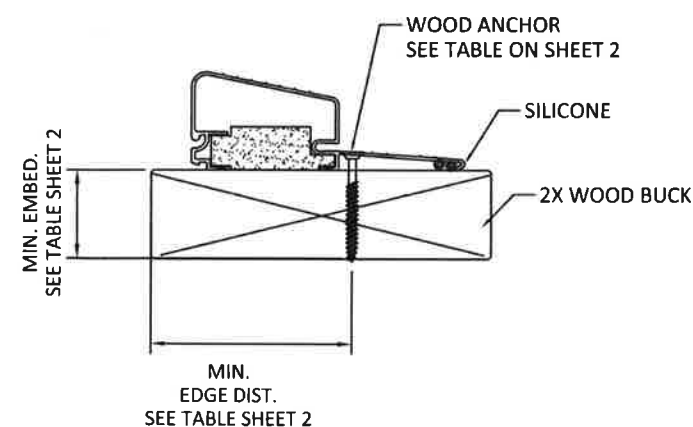

**5**  
**7** OPERABLE SILL  
 HIGH BUMP OUTSWING  
 AFCO H-497

1 OPTIONALLY, ANCHOR CAN BE PLACED IN NARROW SECTION OF HEAD OR JAMB AS LONG AS MINIMUM EMBEDMENT AND EDGE DISTANCE ARE ACHIEVED.

REMARKS	BY	DATE
Add Multi-Point Lock	GL	06/12/14

THIS DOCUMENT IS THE PROPERTY OF BUILDING DROPS, INC. AND SHALL NOT BE REPRODUCED IN WHOLE OR PART WITHOUT WRITTEN CONSENT OF BUILDING DROPS, INC. ALTERATIONS, ADDITIONS, HIGHLIGHTING, OR OTHER MARKINGS TO THIS DOCUMENT ARE NOT PERMITTED AND INVALIDATE THIS DOCUMENT.

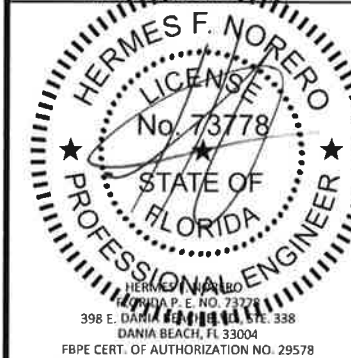

DATE: 02.05.14

DWG. BY: GL/TJM      CHK. BY: SS/MSS

SCALE: NTS

DWG. #: A010834A

SHEET:                      OF 9

PREPARED BY:



**BUILDING DROPS, INC.**  
 398 E. DANIA BEACH BLVD., STE. 338  
 DANIA BEACH, FL 33004  
 PH: (954)399-8478  
 FAX: (954)744-4738  
 WEB: www.buildingdrops.com

TITLE: DESIGN PRO/SMOOTH PRO FULL LITE  
 NON-IMPACT

CONCRETE INSTALLATION

3737 LAKEPORT BLVD.,  
 KLAMATH FALLS, OR 97601  
 PH: (541)882-3451  
 FAX: (541)850-2609

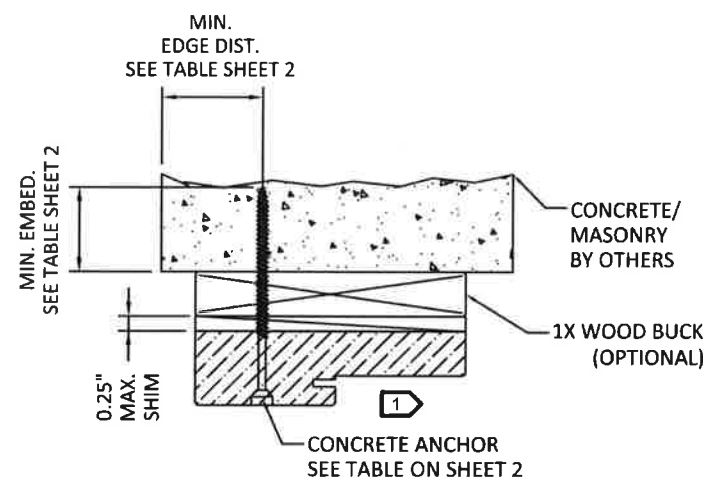

**1**  
**8** HEAD (TYPICAL)  
 OUTSWING SHOWN - INSWING SIMILAR

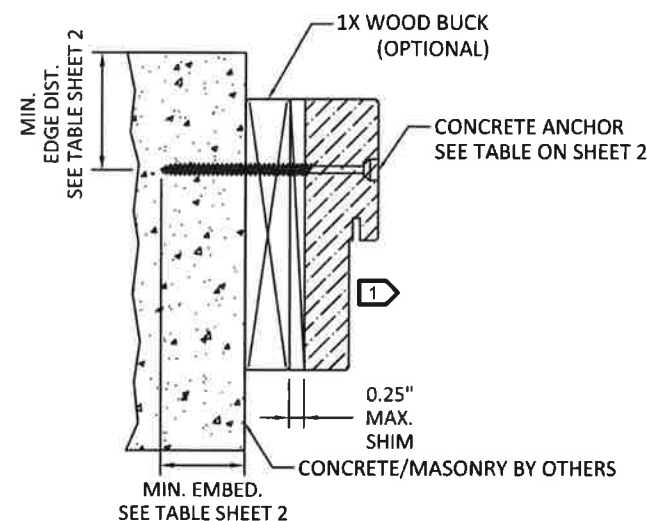

**2**  
**8** JAMB (TYPICAL)  
 OUTSWING SHOWN - INSWING SIMILAR

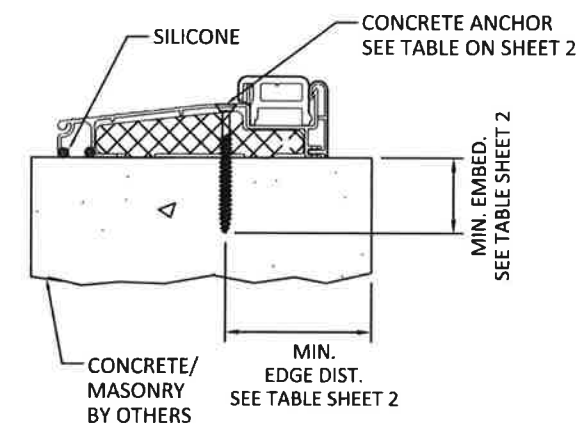

**3**  
**8** OPERABLE SILL  
 INSWING  
 ENDURA ZAIL4565F

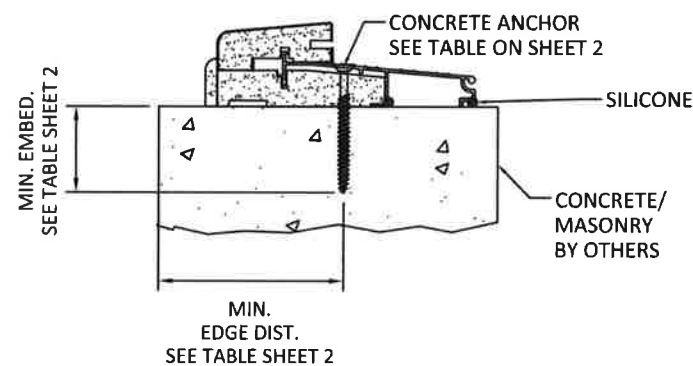

**4**  
**8** OPERABLE SILL  
 OUTSWING  
 AFCO J-2297

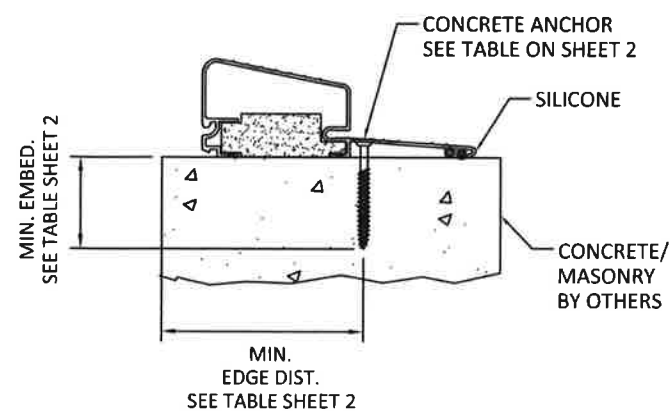

**7**  
**8** OPERABLE SILL  
 HIGH BUMP OUTSWING  
 AFCO H-497

REMARKS	BY	DATE
Add Multi-Point Lock	GL	06/12/14

THIS DOCUMENT IS THE PROPERTY OF BUILDING DROPS, INC. AND SHALL NOT BE REPRODUCED IN WHOLE OR PART WITHOUT WRITTEN CONSENT OF BUILDING DROPS, INC. ALTERATIONS, ADDITIONS, HIGHLIGHTING, OR OTHER MARKINGS TO THIS DOCUMENT ARE NOT PERMITTED AND INVALIDATE THIS DOCUMENT.

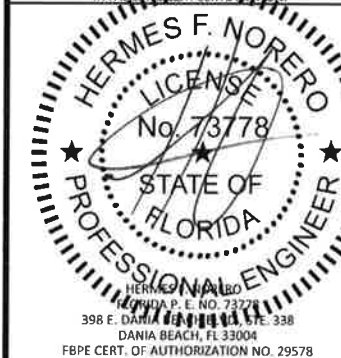

DATE:	02.05.14
DWG. BY:	GL/TJM
CHK. BY:	SS/MSS
SCALE:	NTS
DWG. #:	A010834A
SHEET:	OF 9

1 OPTIONALLY, ANCHOR CAN BE PLACED IN NARROW SECTION OF HEAD OR JAMB AS LONG AS MINIMUM EMBEDMENT AND EDGE DISTANCE ARE ACHIEVED.



BILL OF MATERIALS		
ITEM#	DESCRIPTION	MATERIAL
1	FRAME HEAD/JAMBS	FINGER-JOINTED PINE
		SOLID PINE
		LAMINATED VENEER LUMBER
		COMPOSITE
2	ASTRAGAL, ENDURA ULTIMATE HURRICANE (SEE SHEET 2 FOR HARDWARE AND FASTENING DETAILS)	6063-T6 ALUMINUM
3	(NOT USED)	-
4	ENDURA ZAIL4565F THRESHOLD	-
5	AFCO J-2297 THRESHOLD	-
6	1" O.A. IG TEMPERED NON-IMPACT GLASS	-
7	AFCO H-497 THRESHOLD	-
8	WEATHERSTRIP	URETHANE FOAM & POLYETHYLENE
9	NON-COMPRESSION SHIM (0.25" MAX. THK.)	COMPOSITE
10	2X WOOD (S.G. MUST BE 0.55 OR GREATER)	WOOD
11	1X WOOD (S.G. MUST BE 0.55 OR GREATER)	WOOD
12	#10 WOOD INSTALLATION SCREW W/ 1 1/2" MIN. EMBEDMENT	STEEL
13	CONC./CMU ANCHOR (SEE ANCHOR TABLE SHEETS 2 & 3)	STEEL
14	BUTT HINGE (SEE SCHEDULE SHEET 5)	-
15	KWIKSET LOCK SERIES 400	STEEL
16	KWIKSET DEADBOLT SERIES 780	STEEL
17	HOPPE MULTI-POINT HARDWARE HLS9000 (SEE SHEET 2 FOR HARDWARE AND FASTENING DETAILS)	STEEL
18	ODL LIPLITE KIT (NI)	PLASTIC
19	FLUSH GLAZING LEG	FIBERGLASS
20	ODL LIPLITE KIT (RADIUS LITES)	PLASTIC

17 HOPPE MULTI-POINT LOCK

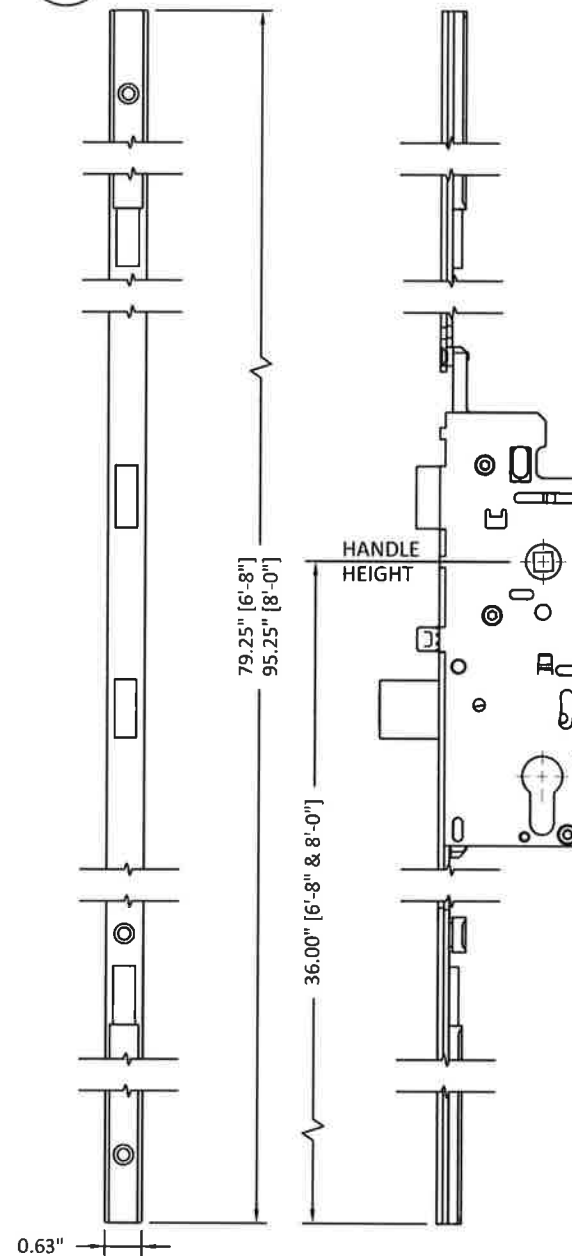

1 FRAME HEAD/JAMBS VARIES, SEE BOM ABOVE

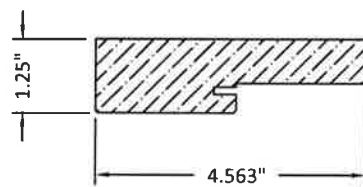

2 ENDURA ASTRAGAL ALUMINUM

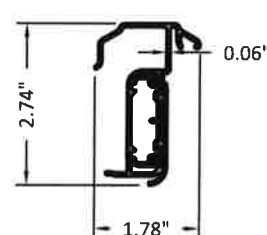

4 ENDURA ZAIL4565F THRESHOLD

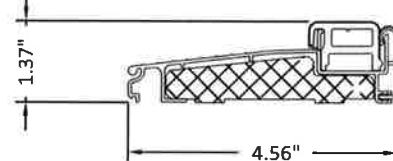

5 AFCO J-2297 THRESHOLD

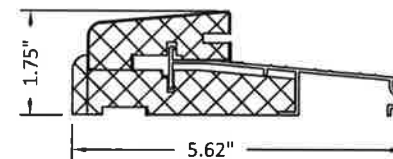

7 AFCO H-497 THRESHOLD

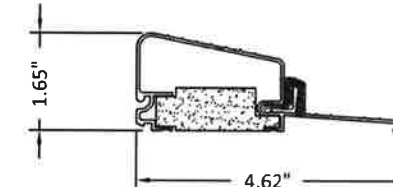

PREPARED BY:



**BUILDING DROPS, INC.**  
 398 E. DANIA BEACH BLVD., STE. 338  
 DANIA BEACH, FL 33004  
 PH: (954)399-8478  
 FAX: (954)744-4738  
 WEB: www.buildingdrops.com

TITLE: DESIGN PRO/SMOOTH PRO FULL LITE NON-IMPACT

COMPONENTS AND BILL OF MATERIALS

3737 LAKEPORT BLVD.,  
 KLAMATH FALLS, OR 97601  
 PH: (541)882-3451  
 FAX: (541)850-2609



REMARKS	BY	DATE
Add Multi-Point Lock	GL	06/12/14

THIS DOCUMENT IS THE PROPERTY OF BUILDING DROPS, INC. AND SHALL NOT BE REPRODUCED IN WHOLE OR PART WITHOUT WRITTEN CONSENT OF BUILDING DROPS, INC. ALTERATIONS, ADDITIONS, HIGHLIGHTING, OR OTHER MARKINGS TO THIS DOCUMENT ARE NOT PERMITTED AND INVALIDATE THIS DOCUMENT.

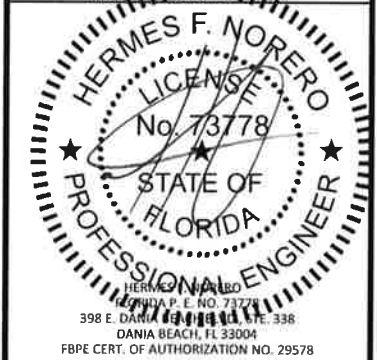

HERMES F. NORERO  
 LICENSED PROFESSIONAL ENGINEER  
 No. 73778  
 STATE OF FLORIDA  
 398 E. DANIA BEACH BLVD., STE. 338  
 DANIA BEACH, FL 33004  
 FBPE CERT. OF AUTHORIZATION NO. 29578

DATE: 02.05.14	
DWG. BY: GL/TJM	CHK. BY: SS/MSS
SCALE: NTS	
DWG. #: A010834A	
SHEET: 9 OF 9	

1598 2 24 07  
 Bergman, Jon  
 440-334-3432  
 44591342 Darrell/407-923-6401

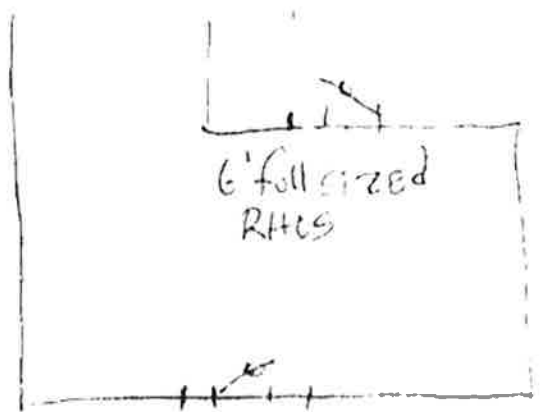

36" LHIS  
 2-10 1/2" sidelites - for SE

Back  
 Door ONLY  
 permit Added

Unit	Finish	Color	Material	Weight	Height	Width	Depth	Notes
36 LHIS	PH	Front	unattached	37 1/2	8 1/2	4 9/16	Finish	Smooth
2x10 1/2"		Back		12	8 1/2	4 9/16	White	Smooth
AI				74	80 1/2	4 9/16	Full lite	

JON BERGMAN  
 3606 QUANDO DR  
 ORLANDO, FL 32812

STORE 1598



**STATE OF FLORIDA  
DEPARTMENT OF BUSINESS AND PROFESSIONAL REGULATION**

**CONSTRUCTION INDUSTRY LICENSING BOARD  
2601 BLAIR STONE ROAD  
TALLAHASSEE FL 32399-0783**

**(850) 487-1395**

**CAFARO, PETER ANTHONY III  
LOWE'S HOME CENTERS, LLC  
PO BOX 781993  
ORLANDO FL 32878-1993**

**Congratulations! With this license you become one of the nearly one million Floridians licensed by the Department of Business and Professional Regulation. Our professionals and businesses range from architects to yacht brokers, from boxers to barbeque restaurants, and they keep Florida's economy strong.**

**Every day we work to improve the way we do business in order to serve you better. For information about our services, please log onto [www.myfloridalicense.com](http://www.myfloridalicense.com). There you can find more information about our divisions and the regulations that impact you, subscribe to department newsletters and learn more about the Department's initiatives.**

**Our mission at the Department is: License Efficiently, Regulate Fairly. We constantly strive to serve you better so that you can serve your customers. Thank you for doing business in Florida, and congratulations on your new license!**

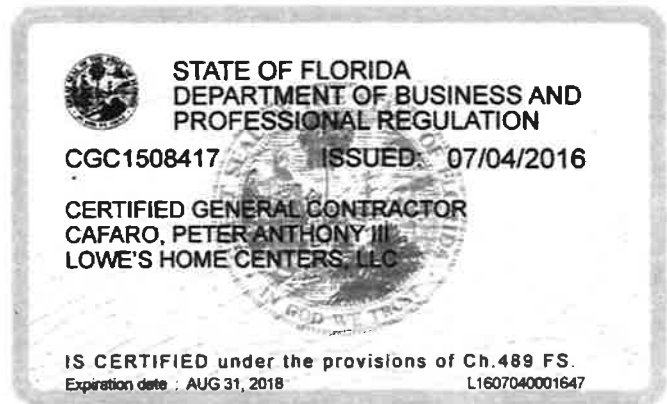

**DETACH HERE**

**RICK SCOTT, GOVERNOR**

**KEN LAWSON, SECRETARY**

**STATE OF FLORIDA  
DEPARTMENT OF BUSINESS AND PROFESSIONAL REGULATION  
CONSTRUCTION INDUSTRY LICENSING BOARD**

<b>LICENSE NUMBER</b>	
CGC1508417	

**The GENERAL CONTRACTOR  
Named below IS CERTIFIED  
Under the provisions of Chapter 489 FS.  
Expiration date: AUG 31, 2018**

**CAFARO, PETER ANTHONY III  
LOWE'S HOME CENTERS, LLC  
1605 CURTIS BRIDGE RD  
WILKESBORO NC 28697**



**ISSUED: 07/04/2016**

**DISPLAY AS REQUIRED BY LAW**

**SEQ # L1607040001647**

**Scott Randolph, Tax Collector      Local Business Tax Receipt      Orange County, Florida**

This local business tax receipt is in addition to and not in lieu of any other tax required by law or municipal ordinance. Businesses are subject to regulation of zoning, health and other lawful authorities. This receipt is valid from October 1 through September 30 of receipt year. Delinquent penalty is added October 1.

	<b>2016</b>		<b>EXPIRES</b>	<b>9/30/2017</b>		1801-0590711	
1801	CERTIFIED GENERAL C	\$30.00	2 EMPLOYEES	5000	BUSINESS OFFICE	\$30.00	2 EMPLOYEES
1806	CERTIFIED ROOFING CO	\$30.00	2 EMPLOYEES				

TOTAL TAX	\$90.00
PREVIOUSLY PAID	\$90.00
TOTAL DUE	\$0.00

12200 LAKE UNDERHILL RD  
U - ORLANDO, 32825

PAID: \$90.00 2501-02350175 9/14/2016

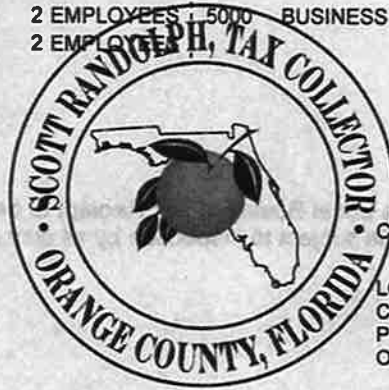

CAFARO PETER ANTHONY III QUALIFIER

LOWES HOME CENTERS LLC  
CAFARO PETER ANTHONY III  
P O BOX 781993  
ORLANDO FL 32878

This receipt is official when validated by the Tax Collector.