



City of Belle Isle

Universal Engineering Sciences 3532 Maggie Blvd., Orlando, FL 32811
Tel 407-581-8161 * Fax 407-581-0313 * www.universalengineering.com

PERMIT CARD - PLEASE POST AT JOB SITE

THIS DOCUMENT BECOMES YOUR PERMIT WHEN PROPERLY VALIDATED

Per FBC 105 3.3: An enforcing authority may not issue a building permit for any building construction, erection, alteration, modification, repair or addition unless the permit either includes on its face or there is attached to the permit the following statement: "NOTICE: In addition to the requirements of this permit, there may be additional restrictions applicable to this property that may be found in the public records of this county, and there may be additional permits required from other governmental entities such as water management districts, state agencies, or federal agencies." The issuance of this permit does not grant permission to violate any applicable City, Orange County, State of Florida and/or Federal codes and/or ordinances. Separate permits are required for Signs, Roofing, Electrical, Gas, Plumbing and Mechanical services. This permit becomes VOID if the work authorized is not commenced within 6 months, or is suspended or abandoned for a period of 6 months after commencement. **WORK SHALL BE CONSIDERED SUSPENDED IF AN APPROVED INSPECTION HAS NOT BEEN MADE WITHIN A 6 MONTH PERIOD.** PERMISSION IS GRANTED TO DO THE FOLLOWING WORK ACCORDING TO THE CONDITIONS HEREON AND THE APPROVED PLANS AND SPECIFICATIONS, SUBJECT TO COMPLIANCE WITH THE ORDINANCES OF THE CITY OF BELLE ISLE, FLORIDA.

Scope of Work: BUILDING: 10 size for size windows
Comments: None
Project Information
Address: 7410 Gondola Drive, Belle Isle, FL 32809
Parcel ID: 25-23-29-5884-22-012
Property Owner: Thomas, Brittany
Phone Number: none

Company Name: New South Window Solutions Inc
Contractor Name: Ochstein, Samuel
License Number: CRC1330822
Address: 820 E. Altamonte Dr, Altamonte Springs, FL 32701
Phone Number: 407-261-2278

Permit Number: 2015-04-004

Date of Application: 04/01/2015
Date Permit Issued: 04/03/2015

WARNING TO OWNER: "YOUR FAILURE TO RECORD A NOTICE OF COMMENCEMENT MAY RESULT IN YOU PAYING TWICE FOR IMPROVEMENTS TO YOUR PROPERTY. IF YOU INTEND TO OBTAIN FINANCING, CONSULT WITH YOUR LENDER OR AN ATTORNEY BEFORE RECORDING YOUR NOTICE OF COMMENCEMENT." ON THE JOB INSPECTION(S) MUST BE MADE BEFORE PROCEEDING WITH SUBSEQUENT WORK. THIS CARD MUST BE DISPLAYED OUTSIDE AND BE PROTECTED FROM THE WEATHER WHILE BEING VISIBLE FROM THE STREET UNTIL THE FINAL INSPECTIONS HAVE BEEN APPROVED.

BUILDING FEATURES

IMPACT FEES

School \$
Traffic \$

ZONING FEES

Zoning Fee \$

UNIVERSAL ENG - BUILDING FEES

Cert of Occ \$
Demo \$
Building \$
Fence \$
Driveway \$
Shed \$
Window(s) \$61.50
Door(s) \$
PrePower \$
Electrical \$
Temp Pole \$
Plumbing \$
Mechanical \$
Gas \$
Roofing \$
Boat Dock \$
Screen Encl \$
Swimming Pool \$
Sign \$

SURCHARGE FEES

Surcharge Fee \$2.00
Surcharge Fee \$2.00

TOTAL FEES \$65.50

Date Paid 4-6-15
CC or Check # MC 5044
Amount Paid 65.50

The person accepting this permit shall conform to the terms of the application on file and construction shall conform to the requirements of the Florida Building Code (FS 553).

BUILDING INSPECTOR USE ONLY

IF APPLICABLE:
Have Zoning Approval Conditions Been Met? YES NO Have Stormwater Approval Conditions Been Met? YES NO Silt fencing in place? YES NO Turbidity Barrier in place? YES NO

BUILDING
1st _____ (Footing/Foundation)
Survey specific foundation plan must be onsite before slab pour. Approved Plan on Site? ____
2nd _____ (Slab)
3rd _____ (Lintel)(Wall Reinforcing on Masonry Building)
4th _____ (Exterior Framing)(Roof/Wall Sheathing)
5th _____ (Framing) (To be made after Plumbing/ Mechanical/ Electrical Rough-Ins & Windows/Doors Installed)
6th _____ (Insulation to be Made After Roof Installed)
7th _____ (Drywall)
8th _____ (Sidewalk/Driveway)
9th _____ (Other)
10th _____ (Final - After MEP and Other Applicable Finals)

ROOFING
1ST ROOFING Deck Nailing/Dry-in/Flashing _____
2nd ROOFING Covering In-Progress _____
3rd ROOFING Covering Final _____

PLUMBING (Pool-Piping, Solar, Irrigation, Water Treatment Equip, Etc...)
1ST _____ (Underground) 2nd _____ (Sewer)
3rd _____ (Rough-In/Tub Set) 4th _____ (Final)

CHECK APPROPRIATE BOX
 GAS Natural LP MECHANICAL ELECTRICAL LOW VOLTAGE
1st _____ (Rough-In) 2nd _____ (Final)

Inspection requests are to be emailed to IDScheduling@UniversalEngineering.com; a confirmation email will be sent back to you upon scheduling. **Next-Day Inspection requests must be made by 1pm.** Please include the following in your request: Permit #, project address, type of inspection, date of the requested inspection, a contact name & a contact phone number. AM or PM may be requested but cannot be guaranteed.



City of Belle Isle

Universal Engineering Sciences 3532 Maggie Blvd., Orlando, FL 32811
Tel 407-581-8161 * Fax 407-581-0313 * www.universalengineering.com

RECEIVED
4-1-15

Building Permit (Land Use) Application

DATE: _____

PERMIT # 2015-04-004

PROJECT ADDRESS 7410 Gonzalez Dr, Belle Isle, FL 32809 32812

PROPERTY OWNER Thomas Brittany N PHONE _____ VALUE OF WORK (labor & material) \$ 4753.5

PLEASE LIST THE NATURE OF YOUR PROPOSED IMPROVEMENTS

Replacing 10 windows size for size

Please provide information, if applicable.

- Survey specific foundation plan required to show compliance with zoning setbacks
- **BOAT DOCK:** DEP Clearance Required with Application (Call 407-897-4100); please provide a copy of their report
- **SEPTIC SYSTEM (RESIDENTIAL):** - Provide verification of OC Health Dept approval for on-site septic tank system, per FAC Chap. 64E-6
- Homeowners will be required to have a contractor on record for homes that are rented and/or not homestead

Please Complete for the City of Belle Isle Zoning Review: Parcel Id Number: 25-23-29-5884-22-012

To obtain this information, please visit <http://www.ocpaf.org/Searches/ParcelSearch.aspx>

SPECIAL CONDITIONS: STRUCTURES MAY NOT ENCROACH INTO ANY EASEMENT OR REQUIRED SETBACK. Note, this Zoning Approval MAY or MAY NOT be in conflict with your Dead Restrictions. For New Single Family Residence, a Traffic Impact Fee and School Impact will be assessed.

Attached Survey _____ SETS and Construction Plans _____ SETS

PLANNING & ZONING APPROVAL: _____
DATE _____

PLEASE COMPLETE for Building Review

CONSTRUCTION TYPE Repair/Replace

OCCUPANCY GROUP Comm Res: Single Fam Multi Fam

#BLDG. _____ #UNITS _____ #STORIES _____ TOTAL SQ.FT. _____

MAX. FLOOR LOAD _____ MAX. OCCUPANCY _____

MIN. FLOOD ELEV. _____ LOW FLOOR ELEV. _____

WATER SERVICE _____ WELL _____ SEPTIC _____

BUILDING REVIEWER ca DATE 4-2-15

VERIFIED CONTRACTOR'S LICENSE & INSURANCE ARE ON FILE (SM) DATE 4-2-15

Per FSS 105.3.3:

An enforcing authority may not issue a building permit for any building construction, erection, alteration, modification, repair or addition unless the permit either includes on its face or there is attached to the permit the following statement: "NOTICE: In addition to the requirements of this permit, there may be additional restrictions applicable to this property that may be found in the public records of this county, and there may be additional permits required from other governmental entities such as water management districts, state agencies, or federal agencies."

Republic Services is by legal contract the sole authorized provider of garbage, recycling, yard waste, and commercial garbage and construction debris collection and disposal services with the city limits of the City. Contractors, homeowners and commercial businesses may contact Republic Services at 407-293-8000 to setup accounts for Commercial, Construction Roll Off, or other services needed. Rates are fixed by contract and are available at City Hall or from Republic Services. The City enforces the contract through its code enforcement office. Failure to comply will result in a stop work order.

SEPARATE PERMITS ARE REQUIRED FOR ROOFING, ELECTRICAL, PLUMBING, GAS, MECHANICAL, SIGNS, POOLS, ENCLOSURES, ETC.

Wind Exposure Category: B C D

SPRINKLERS REQ'D Y N

If Required - SUBMIT COPY OF PLANS FOR FIRE

REVIEW Date: Sent _____ RCD _____

ZONING	Y	N	\$ _____
CERT OF OCC	Y	N	\$ _____
TRAFFIC	Y	N	\$ _____
SCHOOL	Y	N	\$ _____
FIRE	Y	N	\$ _____
SWIMMING POOL	Y	N	\$ _____
SCREEN ENCLOSURE	Y	N	\$ _____
ROOFING	Y	N	\$ _____
BOAT DOCK	Y	N	\$ _____
BUILDING	Y	N	\$ _____
WINDOW(S)	<input checked="" type="radio"/>	N	\$ <u>41.00 + 20.50</u>
DOOR(S)	Y	N	\$ _____
FENCE	Y	N	\$ _____
SHED	Y	N	\$ _____
DRIVEWAY	Y	N	\$ _____
OTHER	Y	N	\$ _____

3% FL SURCHARGE 4.00
TOTAL 65.50

By Owner Form Y NA
 Notice of Commencement NA
 Power of Attorney NA
 Contractor Packet Included? Y N

OTHER PERMITS REQUIRED:

ELECTRICAL	Y	NA
PREPOWER	Y	NA
MECHANICAL	Y	NA
PLUMBING	Y	NA
ROOFING	Y	NA
GAS	Y	NA



City of Belle Isle
 Universal Engineering Sciences 3532 Maggie Blvd., Orlando, FL 32811
 Tel 407-581-8161 * Fax 407-581-0313 * www.universalengineering.com

Building Permit (Land Use) Application

To be completed as required by State Statute Section 713 and other applicable sections.

PERMIT # 2015-04-004

Owner's Name Thomas Brittany N
 Owner's Address 7410 Gondola Dr Belle Isle, FL 32809

Contractor Name	Company Name
License #	Company Address
Contact Phone/Cell	City, State, ZIP
Contact Email	Contact Fax

Samuel Ochstein CRC #1330822
 New South Window Solutions Inc
 820 E. Altamonte Dr. Altamonte Springs, FL 32701
 Phone: 407-261-2277 ~ Fax 407-261-2278
justinshaw@newsouthwindow.com

WARNING TO OWNER: Your failure to record a Notice of Commencement may result in your paying twice for improvements to your property. A notice of commencement must be recorded if job is \$2500(+) or if A/C Replacement \$7500(+) and posted on the job site before the first inspection. If you intend to obtain financing, consult with your lender or an attorney before recording your Notice of Commencement.

I hereby make Application for Permit as outlined above, and if same is granted I agree to conform to all Division of Building Safety Regulations (www.floridabuilding.org) and City Ordinances (www.municode.com) regulating same and in accordance with plans submitted. The issuance of this permit does not grant permission to violate any applicable City and/or State of Florida codes and /or ordinances. Application is hereby made to obtain a permit to do the work and installations as indicated. I certify that no work or installation has commenced prior to the issuance of a permit and that all work will be performed to meet the standards of all laws regulating construction in this jurisdiction. I understand that a separate permit must be secured for all other construction including ROOFING, ELECTRICAL, MECHANICAL, PLUMBING, GAS, SIGNS, POOLS, SCREEN ENCLOSURES, ETC.

OWNER'S AFFIDAVIT: I certify that all the foregoing information is accurate and that all work will be done in compliance with all applicable laws regulating construction and zoning.

Owner Signature [Signature]
 The foregoing instrument was acknowledged before me this 4/11/15
 by Brittany Thomas who is personally known to me
 and who produced FL DL
 as identification and who did not take an oath.

Notary as to Owner
 State of Florida
 County of Orange

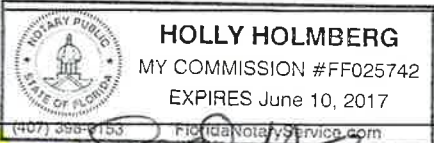

Contractor Signature [Signature]
 COMPANY NAME New South Window Solutions
 The foregoing instrument was acknowledged before me this 4/11/15
 by Samuel Ochstein who is personally known to me
 and who produced _____
 as identification and who did not take an oath.

Notary as to Owner
 State of Florida
 County of Orange



Impervious Surface Ratio Worksheet
 Development Zoned A-1, A-2, R-1-AAA, R-1-AA, R-1-A, R-1

City Code, Section 50-74: Impervious Surface Ratio

- Total Lot Area (sqft) X 0.35 = Allowable Impervious Area (BASE).
 Total Lot Area _____ X 0.35 =
 Allowable Impervious Area (BASE) _____
- Calculate the "proposed" impervious area on the lot. This includes the sum of all areas that do not allow direct percolation of rainwater. Examples include house, pool, deck, driveway, accessory building, etc.
 - House _____
 - Driveway _____
 - Walkway _____
 - Accessory Buildings _____
 - Pool & Spa _____
 - Deck & Patio _____
 - Other _____
 Actual Impervious Area (AIA) _____
- If AIA is less than BASE, subtract AIA from BASE to determine the amount of impervious area that may be added without providing onsite retention.
- If AIA is greater than BASE, then onsite retention **must be provided**.

Assuming 7.5 inches of rainfall based on a 24hr 10 year Rain Event (TP40), the formula is: (7.5 inches rainfall/12 inches p/foot) X (result from line 4) = cubic feet of storage volume needed

FL.D.L. TS20094-87-946-0

marisolmajica@newsouthwindow.com

Permit Number: _____
 Folio/Parcel Identification Number: _____
 Prepared by: Marisol Morica
820 E Altamonte Dr
Altamonte Springs, FL 32701
 Return to: Marisol Morica
820 E Altamonte Dr
Altamonte Springs, FL 32701



NOTICE OF COMMENCEMENT

State of Florida, County of Orange
 The undersigned hereby gives notice that improvement will be made to certain real property, and in accordance with Chapter 713, Florida Statutes, the following information is provided in this Notice of Commencement.

- Description of property (legal description of the property, and street address if available)
Nela Isle m55 The S 50ft lot 1 & S 50ft of E 25 FL lot 2 BLK V
- General description of improvement
Replacing 10 windows size per size
- Owner information or Lessee information if the Lessee contracted for the improvement
 Name Brittany Thomas
 Address 7410 Gondola Dr Orlando, FL 32809
 Interest in Property owner
 Name and address of fee simple titleholder (if different from Owner listed above)
 Name _____
 Address _____
- Contractor
 Name _____ Telephone Number _____
 Address Samuel Ochstein CRC #1330822
New South Window Solutions Inc
820 E. Altamonte Dr. Altamonte Springs, FL 32701
- Surety (if applicable)
 Name justinshaw@newsouthwindow.com Telephone Number _____
 Address _____ Phone: 407-261-2277 ~ Fax 407-261-2278
 Amount of Bond \$ _____
- Lender
 Name _____ Telephone Number _____
 Address _____
- Persons within the State of Florida designated by Owner upon whom notices or other documents may be served as provided by §713.13(1)(a)7, Florida Statutes.
 Name _____ Telephone Number _____
 Address _____
- In addition to himself or herself, Owner designates the following to receive a copy of the Lienor's Notice as provided in §713.13(1)(b), Florida Statutes.
 Name _____ Telephone Number _____
 Address _____
- Expiration date of notice of commencement (the expiration date may not be before the completion of construction and final payment to the contractor, but will be 1 year from the date of recording unless a different date is specified)



State of Florida, County of Orange
 I hereby certify that this is a true copy of
 the document as reflected in the Official Records.
 MARTHA O. HAYNIE, COUNTY COMPTROLLER
 By: Martha O. Haynie
 Deputy Comptroller
 Date: 3/30/15

WARNING TO OWNER: ANY PAYMENTS MADE BY THE OWNER AFTER THE EXPIRATION OF THE NOTICE OF COMMENCEMENT ARE CONSIDERED IMPROPER PAYMENTS UNDER CHAPTER 713, PART I, SECTION 713.13, FLORIDA STATUTES, AND CAN RESULT IN YOUR PAYING TWICE FOR IMPROVEMENTS TO YOUR PROPERTY. A NOTICE OF COMMENCEMENT MUST BE RECORDED AND POSTED ON THE JOB SITE BEFORE THE FIRST INSPECTION. IF YOU INTEND TO OBTAIN FINANCING, CONSULT WITH YOUR LENDER OR AN ATTORNEY BEFORE COMMENCING WORK OR RECORDING YOUR NOTICE OF COMMENCEMENT.

Under penalty of perjury, I declare that I have read the foregoing notice of commencement and that the facts stated in it are true to the best of my knowledge and belief.

X Brittany Thomas
 Signature of Owner or Lessee, or Owner's or Lessee's Authorized Officer/Director/Partner/Manager _____ Signatory's Title/Office _____

The foregoing instrument was acknowledged before me this 30 day of 3/15 by Brittany Thomas
 as owner for _____
 Type of authority, e.g., officer, trustee, attorney in fact _____ Name of party on behalf of whom instrument was executed _____

Signature of Notary Public - State of Florida _____
 Print, type, or stamp commissioned name of Notary Public Holly Holmberg

Personally Known _____ OR Produced ID
 Type of ID Produced Driver license





820 E. Altamonte Springs Dr.
Altamonte Springs, FL 32701

Phone: (407) 261-2277
Fax: (407) 261-2278
Contact Email:
hollyholmberg@newsouthwindow.com

To Whom It May Concern:

I, Samuel Eli Ochstein, hereby authorize the following named person (s) to sign, apply for and purchase permits and/or licenses for New South Window Solutions of Orlando.

This list is to replace all others previously issued, which are now to be considered null and void.

Tim Nagle
Fred Brown
Tyler Lee
Chris Zona
Justin Shaw

Job Address: 7410 GONDOLA DR ORLANDO FL 32809

Sincerely,

A handwritten signature in black ink, appearing to read "S. Ochstein", written in a cursive style.

Samuel Eli Ochstein
CRC1330822

State of Florida, County of ORANGE

Sworn to and subscribed before me, this 1ST day of APRIL, 2015, by Samuel Eli Ochstein, who is personally known to me and did not take an oath.

A handwritten signature in black ink, appearing to read "Holly E. Holmberg", written in a cursive style.

Holly E. Holmberg
Notary Public
State of Florida
My commission Expires: June 10th, 2017

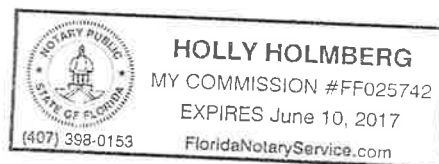



City of Belle Isle

Universal Engineering Sciences 3532 Maggie Blvd., Orlando, FL 32811
 Tel 407-581-8161 * Fax 407-581-0313 * www.universalengineering.com

Product Approval Form

DATE: 4/1/15

PERMIT # _____

PROJECT ADDRESS 7410 GONDOLA DR ORLANDO

, Belle Isle, FL 32809 32812

As required by Florida Statue 553.842 and Florida Administrative Code 9B-72m, please provide the information and approval numbers of the building components listed below if they will be utilized on the building or structure. FL Approved products are listed online at www.floridabuilding.org or can be obtained from the local product supplier. The following information must be turned in with permit application and available onsite for inspections:

1. This Product Approval Cover Sheet
2. Internet screen from FloridaBuilding.org showing PA#, approval and code edition stamped
3. Manufacturer's installation details from FloridaBuilding.org and requirements for each product stamped

Product Type	Manufacturer	Model/Series	FL Product Approval #	Product Type	Manufacturer	Model/Series	FL Product Approval #
EXTERIOR DOORS				WALL PANELS			
Swinging				Sliding			
Sliding				Soffits			
Sectional/Rollup				Storefront			
Other				Glass Block			
				Other			
WINDOWS				ROOFING PRODUCTS			
Single/Dbf Hung	NEWSOUTH WINDOW	EVANTAGE VINYL	15378	Asphalt Shingles			
Horizontal Slider				Non Struct Metal			
Casement				Roofing Tiles			
Fixed				Single Ply Roof			
Mullion				Other			
Skylights							
Other							
STRUCTURAL COMPONENTS				OTHER			
Wood Connectors							
Wood Anchors							
Truss Plates							
Insulation Forms							
Lintels							
Other							

It is the applicant's responsibility to verify that specific products have been installed in accordance with their limitations and with the minimum required design pressures for the structure. Specific compliance will be verified during field inspections.

Applicant Signature 

Date _____



- [BCIS Home](#) | [Log In](#) | [User Registration](#) | [Hot Topics](#) | [Submit Surcharge](#) | [Stats & Facts](#) | [Publications](#) | [FBC Staff](#) | [BCIS Site Map](#) | [Links](#) | [Search](#)



Product Approval
USER: Public User

License efficiently. Regulate fairly.
OFFICE OF THE SECRETARY

[Product Approval Menu](#) > [Product or Application Search](#) > [Application List](#) > [Application Detail](#)

FL # FL15378
Application Type New ✓
Code Version 2010
Application Status Approved
 *Approved by DBPR. Approvals by DBPR shall be reviewed and ratified by the POC and/or the Commission if necessary.

Comments This product application has Expired Certification Agency Certificates and/or Quality Assurance Contracts. RR

Archived

Product Manufacturer NewSouth Window Solutions
Address/Phone/Email 4901 oak fair blvd
 tampa, FL 33610
 (513) 284-0129
 danochstein@newsouthwindow.com

Authorized Signature Vivian Wright
 rickw@rwbldgconsultants.com

Technical Representative
Address/Phone/Email

Quality Assurance Representative
Address/Phone/Email

Category Windows
Subcategory Double Hung

Compliance Method Certification Mark or Listing

Certification Agency Keystone Certfcatlons, Inc.
Validated By Ryan J. King, P.E.
 Validation Checklist - Hardcopy Received

Referenced Standard and Year (of Standard)	Standard	Year
	AAMA/WDMA/CSA101/I.S.2/A440	2005
	AAMA/WDMA/CSA101/I.S.2/A440	2008
	ASTM E1886	2005
	ASTM E1996	2005

Equivalence of Product Standards Certified By Florida Licensed Professional Engineer or Architect
[FL15378_R0_Equiv_of STANDARDS.pdf](#)

Product Approval Method Method 1 Option A

Date Submitted 03/26/2012
 Date Validated 04/04/2012
 Date Pending FBC Approval
 Date Approved 04/18/2012

Summary of Products

FL #	Model, Number or Name	Description
15378.1	a. Vantage Vinyl Double Hung	Vantage New Construction (Nail Fin) Vinyl Double Hung Window utilizes Aluminum Reinforcement (X/X - configuration; Max Size 44 x 75)
Limits of Use Approved for use in HVHZ: No Approved for use outside HVHZ: Yes Impact Resistant: No Design Pressure: N/A Other: See INST 15378.1 for Design Pressure Ratings, any additional use limitations, installation instructions and product particulars.		Certification Agency Certificate FL15378_RO_C_CAC_818-109.0_KS_CERT.pdf FL15378_RO_C_CAC_818-111.0_KS_CERT.pdf Quality Assurance Contract Expiration Date 06/17/2012 Installation Instructions FL15378_RO_II_INST_15378.1.pdf Verified By: Lyndon F. Schmidt, P.E. 43409 Created by Independent Third Party: Yes Evaluation Reports FL15378_RO_AE_EVAL_15378.1.pdf Created by Independent Third Party: Yes
15378.2	b. Vantage Vinyl Double Hung	Vantage New Construction (Nail Fin) Vinyl Double Hung Window utilizes Composite Reinforcement (X/X - configuration; Max Size 44 x 75)
Limits of Use Approved for use in HVHZ: No Approved for use outside HVHZ: Yes Impact Resistant: No Design Pressure: N/A Other: See INST 15378.2 for Design Pressure Ratings, any additional use limitations, installation instructions and product particulars.		Certification Agency Certificate FL15378_RO_C_CAC_818-112.0_KS_CERT.pdf FL15378_RO_C_CAC_818-113.0_KS_CERT.pdf Quality Assurance Contract Expiration Date 02/04/2014 Installation Instructions FL15378_RO_II_Inst_15378.2.pdf Verified By: Lyndon F. Schmidt, P.E. 43409 Created by Independent Third Party: Yes Evaluation Reports FL15378_RO_AE_EVAL_15378.2.pdf Created by Independent Third Party: Yes
15378.3	c. Vantage Vinyl Double Hung	Vantage New Construction (Nail Fin) Vinyl Double Hung Window utilizes Composite Reinforcement (X/X - configuration; Max Size 54 x 75)
Limits of Use Approved for use in HVHZ: No Approved for use outside HVHZ: Yes Impact Resistant: No Design Pressure: N/A Other: See INST 15378.3 for Design Pressure Ratings, any additional use limitations, installation instructions and product particulars.		Certification Agency Certificate FL15378_RO_C_CAC_818-124.0_KS_CERT.pdf Quality Assurance Contract Expiration Date 01/18/2015 Installation Instructions FL15378_RO_II_INST_15378.3.pdf Verified By: Lyndon F. Schmidt, P.E. 43409 Created by Independent Third Party: Yes Evaluation Reports FL15378_RO_AE_EVAL_15378.3.pdf Created by Independent Third Party: Yes
15378.4	d. Vantage Vinyl Double Hung	Vantage Replacement Vinyl Double Hung Window utilizes Aluminum Reinforcement (X/X - configuration; Max Size 44 x 75)
Limits of Use Approved for use in HVHZ: No Approved for use outside HVHZ: Yes Impact Resistant: No Design Pressure: N/A Other: See INST 15378.4 for Design Pressure Ratings, any additional use limitations, installation instructions and product particulars.		Certification Agency Certificate FL15378_RO_C_CAC_818-109.0_KS_CERT.pdf FL15378_RO_C_CAC_818-111.0_KS_CERT.pdf Quality Assurance Contract Expiration Date 06/17/2012 Installation Instructions FL15378_RO_II_INST_15378.4.pdf Verified By: Lyndon F. Schmidt, P.E. 43409 Created by Independent Third Party: Yes Evaluation Reports FL15378_RO_AE_EVAL_15378.4.pdf Created by Independent Third Party: Yes
15378.5	e. Vantage Vinyl Double Hung	Vantage Replacement Vinyl Double Hung Window utilizes Aluminum Reinforcement (X/X - configuration; Max Size 54 x 75)
Limits of Use Approved for use in HVHZ: No		Certification Agency Certificate FL15378_RO_C_CAC_818-126.0_KS_CERT.pdf

	<p>Approved for use outside HVHZ: Yes Impact Resistant: No Design Pressure: N/A Other: See INST 15378.5 for Design Pressure Ratings, any additional use limitations, installation instructions and product particulars.</p>	<p>Quality Assurance Contract Expiration Date 01/18/2015 Installation Instructions FL15378_RO_II_INST_15378.5.pdf Verified By: Lyndon F. Schmidt, P.E. 43409 Created by Independent Third Party: Yes Evaluation Reports FL15378_RO_AE_EVAL_15378.5.pdf Created by Independent Third Party: Yes</p>
15378.6	f. Vantage Vinyl Double Hung	Vantage Replacement Vinyl Double Hung Window utilizes Composite Reinforcement (X/X - configuration; Max Size 44 x 75)
	<p>Limits of Use Approved for use in HVHZ: No Approved for use outside HVHZ: Yes Impact Resistant: No Design Pressure: N/A Other: See INST 15378.6 for Design Pressure Ratings, any additional use limitations, installation instructions and product particulars.</p>	<p>Certification Agency Certificate FL15378_RO_C_CAC_818-112.0_KS_CERT.pdf FL15378_RO_C_CAC_818-113.0_KS_CERT.pdf Quality Assurance Contract Expiration Date 02/04/2014 Installation Instructions FL15378_RO_II_INST_15378.6.pdf Verified By: Lyndon F. Schmidt, P.E. 43409 Created by Independent Third Party: Yes Evaluation Reports FL15378_RO_AE_EVAL_15378.6.pdf Created by Independent Third Party: Yes</p>
15378.7	g. Vantage Vinyl Double Hung	Vantage Replacement Vinyl Double Hung Window utilizes Composite Reinforcement (X/X - configuration; Max Size 54 x 75)
	<p>Limits of Use Approved for use in HVHZ: No Approved for use outside HVHZ: Yes Impact Resistant: No Design Pressure: N/A Other: See INST 15378.7 for Design Pressure Ratings, any additional use limitations, installation instructions and product particulars.</p>	<p>Certification Agency Certificate FL15378_RO_C_CAC_818-125.0_KS_CERT.pdf Quality Assurance Contract Expiration Date 01/18/2015 Installation Instructions FL15378_RO_II_INST_15378.7.pdf Verified By: Lyndon F. Schmidt, P.E. 43409 Created by Independent Third Party: Yes Evaluation Reports FL15378_RO_AE_EVAL_15378.7.pdf Created by Independent Third Party: Yes</p>
15378.8	h. eVantage Vinyl Double Hung	Vantage Replacement Vinyl Double Hung Window utilizes Aluminum Reinforcement (X/X - configuration; Max Size 54 x 75)
	<p>Limits of Use Approved for use in HVHZ: No Approved for use outside HVHZ: Yes Impact Resistant: No Design Pressure: N/A Other: See INST 15378.8 for Design Pressure Ratings, any additional use limitations, installation instructions and product particulars.</p>	<p>Certification Agency Certificate FL15378_RO_C_CAC_818-129.0_KS_CERT.pdf FL15378_RO_C_CAC_818-130.0_KS_CERT.pdf FL15378_RO_C_CAC_818-131.0_KS_CERT.pdf Quality Assurance Contract Expiration Date 03/14/2015 Installation Instructions FL15378_RO_II_INST_15378.8.pdf Verified By: Lyndon F. Schmidt, P.E. 43409 Created by Independent Third Party: Yes Evaluation Reports FL15378_RO_AE_EVAL_15378.8.pdf Created by Independent Third Party: Yes</p>
15378.9	i. iVantage Vinyl Double Hung	Vantage Replacement Vinyl Double Hung Window utilizes Composite Reinforcement (X/X - configuration; Max Size 40 x 72)
	<p>Limits of Use Approved for use in HVHZ: No Approved for use outside HVHZ: Yes Impact Resistant: Yes Design Pressure: N/A Other: See INST 15378.9 for Design Pressure Ratings, any additional use limitations, installation instructions and product particulars. (Excludes Wind Zone 4)</p>	<p>Certification Agency Certificate FL15378_RO_C_CAC_818-116.0_KS_CERT.pdf FL15378_RO_C_CAC_818-202_KS_CERT.pdf Quality Assurance Contract Expiration Date 09/09/2014 Installation Instructions FL15378_RO_II_INST_15378.9.pdf Verified By: Lyndon F. Schmidt, P.E. 43409 Created by Independent Third Party: Yes Evaluation Reports FL15378_RO_AE_EVAL_15378.9.pdf Created by Independent Third Party: Yes</p>

Contact Us :: 1940 North Monroe Street, Tallahassee, FL 32399 Phone: 850-487-1824

The State of Florida is an AA/EEO employer. Copyright 2007-2013 State of Florida. :: Privacy Statement :: Accessibility Statement :: Refund Statement

Under Florida law, email addresses are public records. If you do not want your e-mail address released in response to a public-records request, do not send electronic mail to this entity. Instead, contact the office by phone or by traditional mail. If you have any questions, please contact 850.487.1395. *Pursuant to Section 455.275(1), Florida Statutes, effective October 1, 2012, licensees licensed under Chapter 455, F.S. must provide the Department with an email address if they have one. The emails provided may be used for official communication with the licensee. However email addresses are public record. If you do not wish to supply a personal address, please provide the Department with an email address which can be made available to the public. To determine if you are a licensee under Chapter 455, F.S., please click [here](#).

Product Approval Accepts:





4901 Oak Fair Blvd, Tampa, FL 33610

eVantage Double Hung Window "NON-IMPACT"

GENERAL NOTES

1. This product has been evaluated and is in compliance with the 2010 Florida Building Code (FBC) structural requirements excluding the "High Velocity Hurricane Zone" (HVHZ). See the Certification Agency Certificate for sizes, specifications and ratings.
2. Product anchors shall be as listed and spaced as shown on details. Anchor embedment to base material shall be beyond wall dressing or stucco.
3. When used in areas requiring wind borne debris protection this product is required to be protected with an impact resistant covering that complies with Section 1609.1.2 of the FBC.
4. For 2x stud framing construction, anchoring of these units shall be the same as that shown for 2x buck masonry construction.
5. Site conditions that deviate from the details of this drawing require further engineering analysis by a licensed engineer or registered architect.

TABLE OF CONTENTS	
SHEET#	DESCRIPTION
1	Typical elevations, design pressures & general notes
2	Vertical & horizontal cross sections
3	Vertical & horizontal cross sections
4	Buck & frame anchoring
5	Components
6	Bill of materials and glazing details

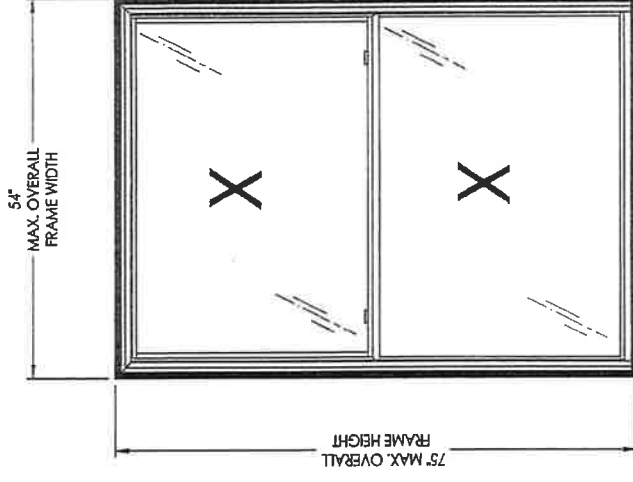

MAX FRAME DIMENSION	MAX DILO. DIMENSION	GLASS TYPE	DESIGN PRESSURE (PSF)		REINFORCEMENT
			POS.	NEG.	
40.0" X 63.0"	33.13" X 27.5"	G1	+45.0	-45.0	STANDARD
44.0" X 75.0"	37.13" X 33.57"	G1	+40.0	-40.0	ADDITIONAL
54.0" X 75.0"	47.13" X 33.57"	G1	+35.0	-35.0	ADDITIONAL

2012 R.W. BUILDING CONSULTANTS INC.

Documents Prepared By: **RM**
 BUILDING CONSULTANTS, INC.
 P.O. Box 230 Venice FL 33595
 Phone No.: 813.658.8197
 Florida Board of Professional Engineers
 Certificate Of Authorization No. 0813
 7/28/12

DATE: 3/19/12
 SCALE: N.T.S.
 DWR. BY: JK
 CHK. BY: LFS
 DRAWING NO.: FL-15378-8
 SHEET 1 OF 6

PRODUCT: DOUBLE HUNG WINDOW
 PART OR ASSEMBLY:
 TYPICAL ELEVATION, DESIGN PRESSURES & GENERAL NOTES

REVISIONS

NO.	DATE	BY

BUILDING CONSULTANTS, INC. P.O. Box 230 Venice FL 33595 Phone No.: 813.059.9197 Florida Board of Professional Engineers Certificate of Authorization No. 9813 Lyndon F. Schmidt, P.E. No. 43409 1-1-2012		REVISIONS NO. DATE BY
PART OR ASSEMBLY: DOUBLE HUNG WINDOW CROSS SECTIONS		DATE: 3/19/12 SCALE: N.T.S. DWS. BY: JK CHK. BY: LFS DRAWING NO.: FL-15378.8 SHEET: 2 OF 6

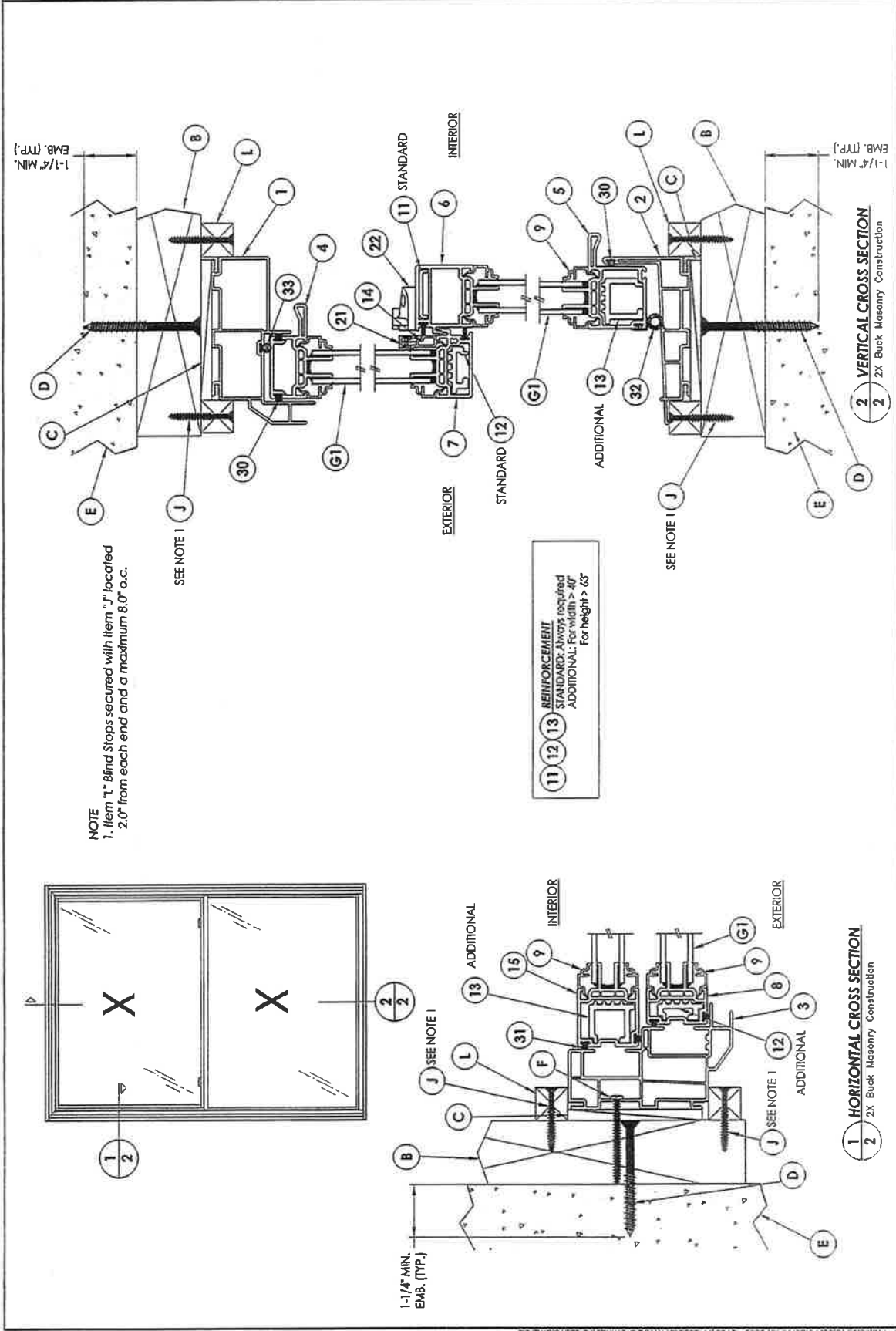

Building Prepared By:
 Rm BUILDING CONSULTANTS, INC.
 P.O. Box 230 Vero Beach, FL 33595
 Phone No.: 813.659.0177
 Florida Board of Professional Engineers
 Certificate Of Authorization No. 2813
 Lynden F. Schmidt, P.E. No. 43408
 3/28/12

PRODUCT: DOUBLE HUNG WINDOW
 PART OR ASSEMBLY: BUCK & FRAME ANCHORING

NO.	DATE	BY	REVISIONS

DATE: 3/19/12
 SCALE: N.T.S.
 DWS. BY: JK
 CHK. BY: LFS
 DRAWING NO.: FL-15378.B
 SHEET 4 OF 6

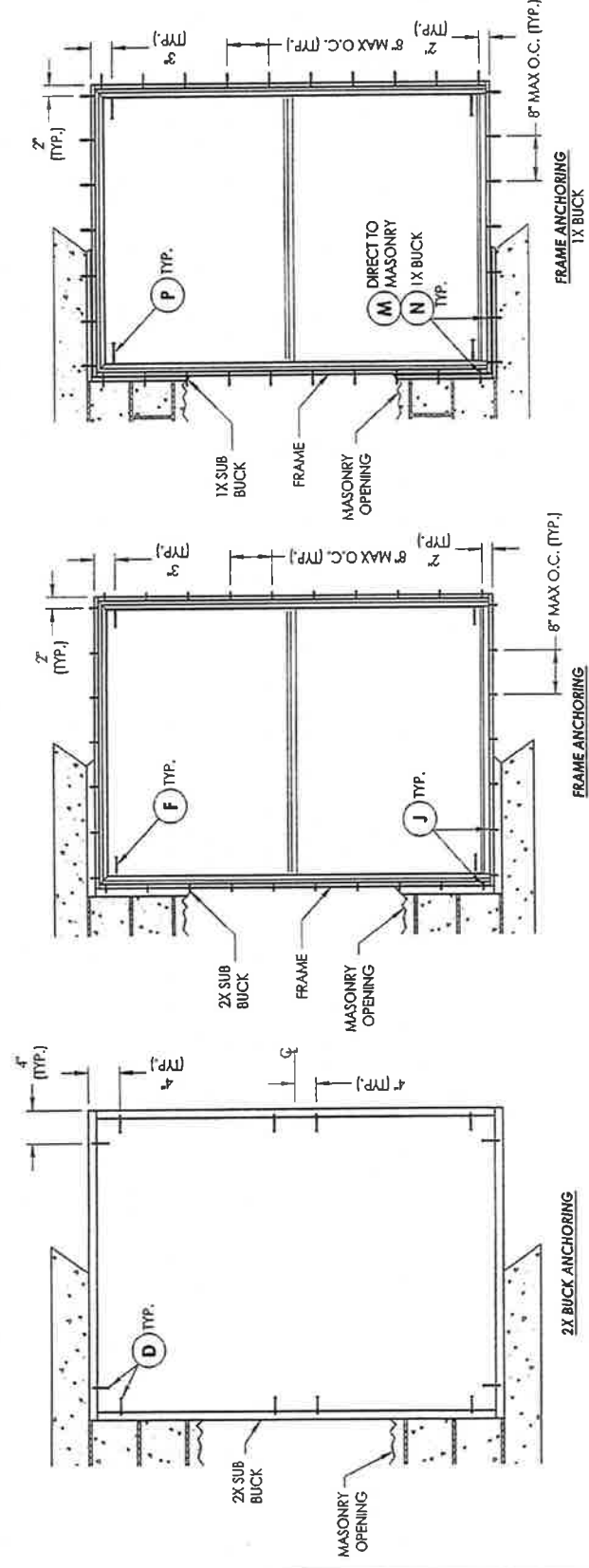

- CONCRETE ANCHOR NOTES:**
1. Substitution of equal concrete anchors from a different supplier may have different edge distance and center distance requirements.
 2. Concrete anchor locations at the corners may be adjusted to maintain the min. edge distance to mortar joints. If concrete anchor locations noted as "MAX. ON CENTER" must be adjusted to maintain the min. edge distance to mortar joints, additional concrete anchors may be required to ensure the "MAX. ON CENTER" dimensions are not exceeded.
 3. Concrete anchor table:

ANCHOR TYPE	ANCHOR SIZE	MIN. EMBEDMENT	MIN. CLEARANCE TO MASONRY EDGE	MIN. CLEARANCE TO ADJACENT ANCHOR
ITW	1/4"	1-1/4"	2-1/2"	3"
ELCO	1/4"	1-1/4"	1"	4"
ITW	3/16"	1-1/4"	2-5/8"	2-1/4"

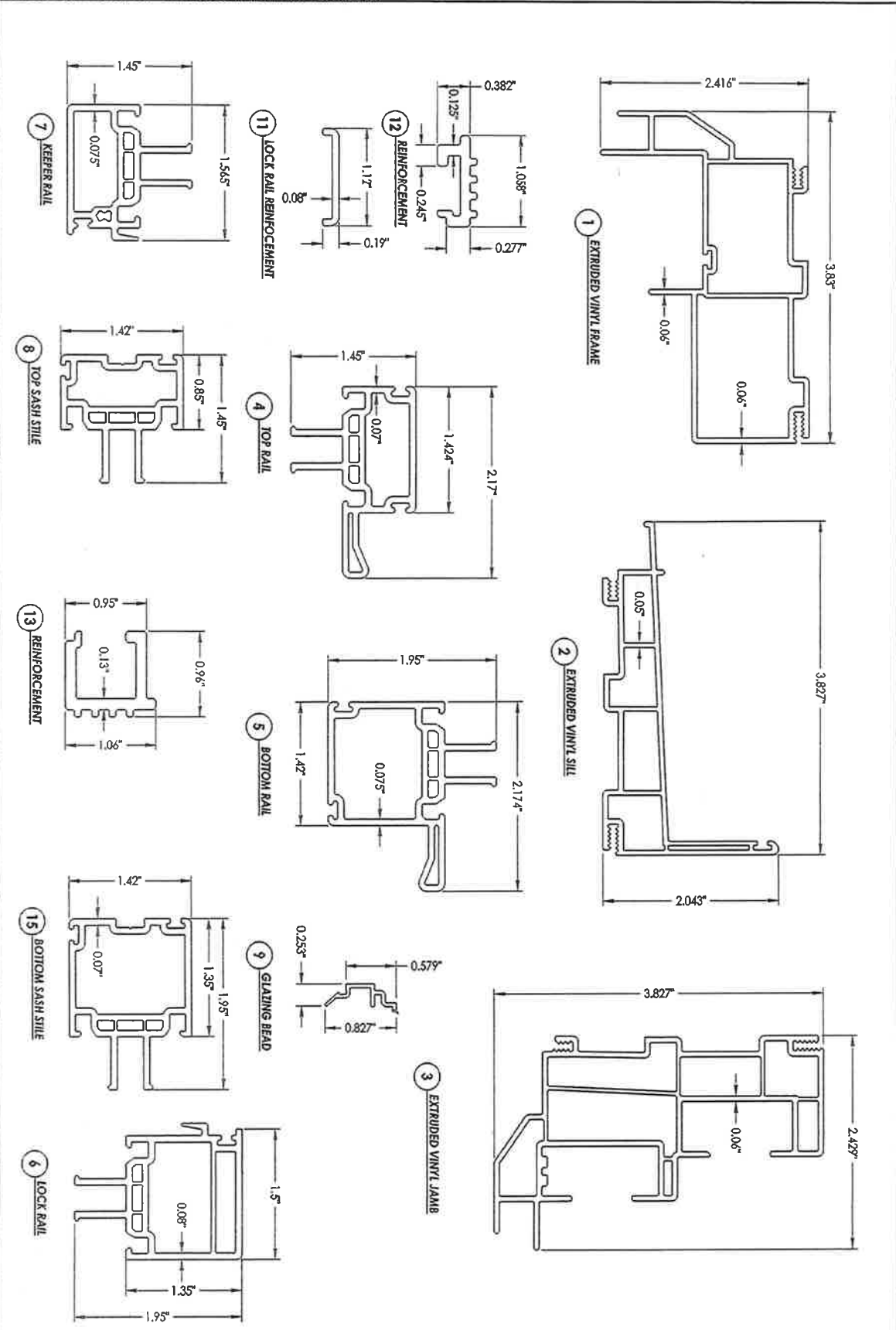

PRODUCT: DOUBLE HUNG WINDOW		Documents Prepared By: RW BUILDING CONSULTANTS, INC. P.O. Box 230 Valrico FL 33595 Phone No.: 813.659.9197 Florida Board of Professional Engineers Certificate Of Authorization No. 9813 <i>LFS 2.28.12</i> Lyndon F. Schmidt, P.E. No. 43409
PART OR ASSEMBLY: COMPONENTS		
NO.	DATE	BY
REVISIONS		

DATE: 3/19/12
 SCALE: N.T.S.
 DWG. BR: JK
 CHK. BY: LFS
 DRAWING NO.: FL-15378.8
 SHEET 5 OF 6

- Searches
- Sales Search
- Results
- Property Record Card**
- My Favorites

Sign up for e-Notify...

7410 Gondola Dr < 25-23-29-5884-22-012 >

Name(s) Thomas Brittany N	Physical Street Address 7410 Gondola Dr
Mailing Address On File 7410 Gondola Dr	Postal City and Zipcode Orlando, FL 32809
Belle Isle, FL 32809-6815	Property Use 0103 - Single Fam Class III
Incorrect Mailing Address?	Municipality Belle Isle



- Values, Exemptions and Taxes**
- Property Features
- Sales Analysis
- Location Info
- Market Stats

Update Information

Property Description

NELA ISLE M/55 THE S 50 FT LOT 1 & S 50 FT OF E 25 FT LOT 2 BLK V

View Plat

Total Land Area 4,233 sqft (+/-) | 0.10 acres (+/-) GIS Calculated Notice

Land

Land Use Code	Zoning	Land Units	Unit Price	Land Value	Class Unit Price	Class Value
0100 - Single Family	R-1-A	1 LOT(S)	\$25,000.00	\$25,000	\$0.00	\$25,000

Page 1 of 1 (1 total records)

Buildings

Important Information		Structure			
	Model Code: 01 - Single Fam Residence	Actual Year Built: 1959	Gross Area: 1343 sqft		
	Type Code: 0103 - Single Fam Class III	Beds: 2	Living Area: 990 sqft		
	Building Value: \$55,239	Baths: 1.0	Exterior Wall: Concrete/Cinder Block		
	Estimated New Cost: \$73,164	Floors: 1	Interior Wall: Plastered		

Page 1 of 1 (1 total records)

Extra Features

Description	Date Built	Units	XFOB Value
FPL2 - Average Fireplace	01/01/1982	1 Unit(s)	\$2,500
SHED - Shed	01/01/2001	1 Unit(s)	\$500

Page 1 of 1 (2 total records)

This Data Printed on 03/03/2015 and System Data Last Refreshed on 03/02/2015

Site Notice • About Us • Contact Us • OCPAFL Home • Property Search • Exemption **FRAUD** Hotline
 Orange County Property Appraiser • 200 S. Orange Avenue, Suite 1700 • Orlando, FL 32801
 Office Hours: 8:00 a.m. to 5:00 p.m. Monday - Friday • Phone: 407.836.5044
 Copyright © 2010 Orange County Property Appraiser. All rights reserved.