



**City of Belle Isle**  
 Universal Engineering Sciences 3532 Maggie Blvd., Orlando, FL 32811  
 Tel 407-581-8161 \* Fax 407-581-0313 \* [www.universalengineering.com](http://www.universalengineering.com)

**PERMIT CARD - PLEASE POST AT JOB SITE**

THIS DOCUMENT BECOMES YOUR PERMIT WHEN PROPERLY VALIDATED

Per FBC 105.3.3: An enforcing authority may not issue a building permit for any building construction, erection, alteration, modification, repair or addition unless the permit either includes on its face or there is attached to the permit the following statement: "NOTICE: In addition to the requirements of this permit, there may be additional restrictions applicable to this property that may be found in the public records of this county, and there may be additional permits required from other governmental entities such as water management districts, state agencies, or federal agencies." The issuance of this permit does not grant permission to violate any applicable City, Orange County, State of Florida and/or Federal codes and/or ordinances. Separate permits are required for Signs, Roofing, Electrical, Gas, Plumbing and Mechanical services. This permit becomes VOID if the work authorized is not commenced within 6 months, or is suspended or abandoned for a period of 6 months after commencement. WORK SHALL BE CONSIDERED SUSPENDED IF AN APPROVED INSPECTION HAS NOT BEEN MADE WITHIN A 6 MONTH PERIOD. PERMISSION IS GRANTED TO DO THE FOLLOWING WORK ACCORDING TO THE CONDITIONS HEREON AND THE APPROVED PLANS AND SPECIFICATIONS, SUBJECT TO COMPLIANCE WITH THE ORDINANCES OF THE TOWN OF WINDERMERE, FLORIDA.

**Scope of Work:** WINDOWS/DOORS: 9 windows & 2 doors, size-for-size

**Comments:** None

**Project Information**  
 Address: 3307 Trentwood Blvd, Belle Isle, FL 32812  
 Parcel ID: 29-23-30-1876-04-040  
 Property Owner: Edwards, Steve  
 Phone Number: 407-489-6817  
 \*\*\*\*\*  
 Company Name: FAS Windows & Doors LLC  
 Contractor Name: Varga, Scott  
 License Number: CGC1518212  
 Address: 3020 Mercy Drive, Orlando, FL 32808  
 Phone Number: 407-489-8683

**Permit Number: 2014-11-006**  
**Date of Application: 11/07/2013**  
**Date Permit Issued: 11/07/2013**

**WARNING TO OWNER:** "YOUR FAILURE TO RECORD A NOTICE OF COMMENCEMENT MAY RESULT IN YOU PAYING TWICE FOR IMPROVEMENTS TO YOUR PROPERTY. IF YOU INTEND TO OBTAIN FINANCING, CONSULT WITH YOUR LENDER OR AN ATTORNEY BEFORE RECORDING YOUR NOTICE OF COMMENCEMENT." ON THE JOB INSPECTION(S) MUST BE MADE BEFORE PROCEEDING WITH SUBSEQUENT WORK. THIS CARD MUST BE DISPLAYED OUTSIDE AND BE PROTECTED FROM THE WEATHER WHILE BEING VISIBLE FROM THE STREET UNTIL THE FINAL INSPECTIONS HAVE BEEN APPROVED.

**BUILDING FEATURES**

**IMPACT FEES**

School \$

**ZONING FEES**

Zoning Fee \$

**UNIVERSAL ENG - BUILDING FEES**

Demo \$  
 Building \$  
 Fence \$  
 Driveway \$  
 Shed \$  
 Window(s) \$79.50  
 Door(s) \$  
 PrePower \$  
 Electrical Fee \$  
 Temp Pole \$  
 Plumbing Fee \$  
 Mechanical Fee \$  
 Gas Fee \$  
 Roofing \$  
 Boat Dock \$  
 Screen Encl \$  
 Swimming Pool \$

**SURCHARGE FEES**

Surcharge Fee \$2.00  
 Surcharge Fee \$2.00

**TOTAL FEES \$83.50**

**Date Paid 11-7-13**

**CC or Check # 1000 4147**

**Amount Paid 83.50**

The person accepting this permit shall conform to the terms of the application on file and construction shall conform to the requirements of the Florida Building Code (FS 553).

**BUILDING INSPECTOR USE ONLY**

IF APPLICABLE:

Have Zoning Approval Conditions Been Met? YES NO Have Stormwater Approval Conditions Been Met? YES NO Silt fencing in place? YES NO Turbidity Barrier in place? YES NO

**BUILDING**

1<sup>st</sup> Survey specific foundation plan must be onsite before slab pour. Approved Plan on Site? \_\_\_\_\_ (Footing/Foundation)

2<sup>nd</sup> \_\_\_\_\_ (Slab)

3<sup>rd</sup> \_\_\_\_\_ (Lintel) Wall Reinforcing on Masonry Building)

4<sup>th</sup> \_\_\_\_\_ (Exterior Framing) (Roof/Wall Sheathing)

5<sup>th</sup> \_\_\_\_\_ (Framing) (To be made after Plumbing/Mechanical/Electrical Rough-Ins & Windows/Doors Installed)

6<sup>th</sup> \_\_\_\_\_ (Insulation to be Made After Roof Installed)

7<sup>th</sup> \_\_\_\_\_ (Drywall)

8<sup>th</sup> \_\_\_\_\_ (Sidewalk/Driveway)

9<sup>th</sup> \_\_\_\_\_ (Other)

10<sup>th</sup> \_\_\_\_\_ (Final - After MEP and Other Applicable Finals)

**ROOFING**

1<sup>st</sup> ROOFING Deck Nailing/Dry-in/Flashing \_\_\_\_\_

2<sup>nd</sup> ROOFING Covering In-Progress \_\_\_\_\_

3<sup>rd</sup> ROOFING Covering Final \_\_\_\_\_

PLUMBING (Pool-Piping, Solar, Irrigation, Water Treatment Equip, Etc...)

1<sup>st</sup> \_\_\_\_\_ (Underground) 2<sup>nd</sup> \_\_\_\_\_ (Sewer)

3<sup>rd</sup> \_\_\_\_\_ (Rough-In/Tub Set) 4<sup>th</sup> \_\_\_\_\_ (Final)

**CHECK APPROPRIATE BOX**

GAS \_\_\_ Natural \_\_\_ LP  MECHANICAL  ELECTRICAL  LOW VOLTAGE

1<sup>st</sup> \_\_\_\_\_ (Rough-In) 2<sup>nd</sup> \_\_\_\_\_ (Final)

Inspection requests are to be emailed to [BidScheduling@UniversalEngineering.com](mailto:BidScheduling@UniversalEngineering.com); a confirmation email will be sent back to you upon scheduling. Next-Day Inspection requests must be made by 1pm. Please include the following in your request: Permit #, project address, type of inspection, date of the requested inspection, a contact name & a contact phone number. AM or PM may be requested but cannot be guaranteed.

For a copy of your permit, or to check inspection results, please visit <https://universalengineering.sharefile.com/f/fo94edc4-832d-44bd-9809-ecf32f9e2e63>  
 login ID = [cobi@universalengineering.com](mailto:cobi@universalengineering.com) password = universal13



City of Belle Isle  
Universal Engineering Sciences 3532 Maggie Blvd., Orlando, FL 32811  
Tel 407-581-8161 \* Fax 407-581-0313 \* [www.universaleengineering.com](http://www.universaleengineering.com)

**Received**  
11-7-13

### Building Permit (Land Use) Application

DATE: PERMIT # 2014-11-006  
PROJECT ADDRESS 3307 Trentwood Blvd. Belle Isle, FL  32809  32812  
PROPERTY OWNER Sere Edwards PHONE 407-484-6817 VALUE OF WORK (Labor & Material) \$ 7,035.00  
*Con Taylor*

**PLEASE LIST THE NATURE OF YOUR PROPOSED IMPROVEMENTS**

Replacing 4 windows & 2 doors same size

- Survey specific foundation plan required to show compliance with zoning setbacks
- **BOAT DOCS:** DEP Clearance Required with Application (Call 407-897-4100); please provide a copy of their report
- **SEPTIC SYSTEM (RESIDENTIAL):** - Provide verification of OC Health Dept approval for on-site septic tank system, per FAG Chap. 64E-6
- Homeowners will be required to have a contractor on record for homes that are rented and/or not homestead

Please provide information, if applicable.

Please Complete for the City of Belle Isle Zoning Review: Parcel Id Number: 29-23-30-1876-04-040

To obtain this information, please visit <http://www.ocpafl.org/Searches/ParcelSearch.aspx>

**SPECIAL CONDITIONS: STRUCTURES MAY NOT ENCRoACH INTO ANY EASEMENT OR REQUIRED SETBACK.** Note, this Zoning Approval MAY or MAY NOT be in conflict with your Deed Restrictions. For New Single Family Residence, a Traffic Impact Fee and School Impact will be assessed.

Attached Survey      SETS and Construction Plans      SETS

PLANNING & ZONING APPROVAL:      DATE     

**PLEASE COMPLETE for Building Review**

CONSTRUCTION TYPE      Comm      Res:      Single Fam      Multi Fam  
OCCUPANCY GROUP      #UNITS      #STORIES      TOTAL SQ.FT.       
MAX. FLOOR LOAD      MAX OCCUPANCY       
MIN. FLOOD ELEV.      LOW FLOOR ELEV.       
WATER SERVICE      WELL      SEPTIC     

BUILDING REVIEWER      DATE       
NOTES 25  
28  
53-26.50

Per FSS 105.3.3:  
An enforcing authority may not issue a building permit for any building construction, erection, alteration, modification, repair or addition unless the permit either includes on its face or there is attached to the permit the following statement: "NOTICE: In addition to the requirements of this permit, there may be additional restrictions applicable to this property that may be found in the public records of this county, and there may be additional permits required from other governmental entities such as water management districts, state agencies, or federal agencies."

Republic Services is by legal contract the sole authorized provider of garbage, recycling, yard waste, and commercial garbage and construction debris collection and disposal services with the city limits of the City. Contractors, homeowners and commercial businesses may contact Republic Services at 407-293-9000 to setup accounts for Commercial, Construction Roll Off, or other services needed. Rates are fixed by contract and are available at City Hall or from Republic Services. The City enforces the contract through its code enforcement office. Failure to comply will result in a stop work order.

**SEPARATE PERMITS ARE REQUIRED FOR ROOFING, ELECTRICAL, PLUMBING, GAS, MECHANICAL, SIGNS, POOLS, ENCLOSURES, ETC.**

Wind Exposure Category: B  C  D

SPRINKLERS REQ'D	Y	N
# Required - SUBMIT COPY OF PLANS FOR FIRE REVIEW		RCD
ZONING	Y	N
CERT OF OCC	Y	N
TRAFFIC	Y	N
SCHOOL	Y	N
FIRE	Y	N
SWIMMING POOL	Y	N
SCREEN ENCLOSURE	Y	N
ROOFING	Y	N
BOAT DOCK	Y	N
BUILDING	Y	N
WINDOW(S)	Y	N
DOOR(S)	Y	N
FENCE	Y	N
SHED	Y	N
DRIVEWAY	Y	N
OTHER	Y	N
3% FL SURCHARGE		4.00
TOTAL		83.50
By Owner Form	Y	NA
Notice of Commencement	Y	NA
Power of Attorney	Y	NA
Contractor Packet Included?	Y	N
OTHER PERMITS REQUIRED:		
ELECTRICAL	Y	NA
PREPOWER	Y	NA
MECHANICAL	Y	NA
PLUMBING	Y	NA
ROOFING	Y	NA
GAS	Y	NA



City of Belle Isle  
 Universal Engineering Sciences 3632 Maggie Blvd., Orlando, FL 32811  
 Tel 407-681-8161 \* Fax 407-681-0313 \* [www.universalsengineering.com](http://www.universalsengineering.com)

Building Permit (Land Use) Application  
 To be completed as required by State Statute Section 713 and other applicable sections.

PERMIT # \_\_\_\_\_

Owner's Name Stephen Edwards  
 Owner's Address 3307 Trentwood Blvd. Belle Isle, FL 32872

Contractor Name <u>Scott Varga</u>	Company Name <u>FASWD, LLC</u>
License # <u>CGC 1518212</u>	Company Address <u>3020 MERCY DR</u>
Contact Phone/Cell <u>JEANA YOUNG 407-489-8683</u>	City, State, Zip <u>ORLANDO, FL 32808</u>
Contact Email <u>jeana.mail@gmail.com</u>	Contact Fax <u>407-830-5602</u>

**WARNING TO OWNER:** Your failure to record a Notice of Commencement may result in your paying twice for improvements to your property. A notice of commencement must be recorded if job is \$2500(+) or if A/C Replacement \$7500(+) and posted on the job site before the first inspection. If you intend to obtain financing, consult with your lender or an attorney before recording your Notice of Commencement.

I hereby make Application for Permit as outlined above, and if same is granted I agree to conform to all Division of Building Safety Regulations ([www.floridabuilding.org](http://www.floridabuilding.org)) and City Ordinances ([www.municode.com](http://www.municode.com)) regulating same and in accordance with plans submitted. The issuance of this permit does not grant permission to violate any applicable City and/or State of Florida codes and for ordinances. Application is hereby made to obtain a permit to do the work and installations as indicated. I certify that no work or installation has commenced prior to the issuance of a permit and that all work will be performed to meet the standards of all laws regulating construction in this jurisdiction. I understand that a separate permit must be secured for all other construction including ROOFING, ELECTRICAL, MECHANICAL, PLUMBING, GAS, SIGNS, POOLS, SCREEN ENCLOSURES, ETC.

**OWNER'S AFFIDAVIT:** I certify that all the foregoing information is accurate and that all work will be done in compliance with all applicable laws regulating construction and zoning.

Owner Signature Stephen R. Edwards  
 The foregoing instrument was acknowledged before me this 11/16/13  
 by Stephen R. Edwards who is personally known to me  
 and who produced  
 as identification and who did not take an oath.  
 Notary's to Owner  
 State of Florida  
 County of Orange



Contractor Signature Scott A. Varga  
 COMPANY NAME FASWD, LLC  
 The foregoing instrument was acknowledged before me this 11/17/13  
 by Scott A. Varga who is personally known to me  
 and who produced  
 as identification and who did not take an oath.  
 Notary as to Owner  
 State of Florida  
 County of Orange

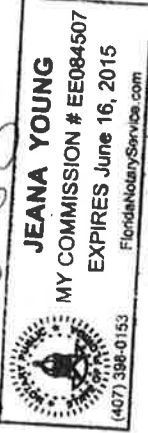

Impervious Surface Ratio Worksheet  
 Development Zoned A-1, A-2, R-1-AAA, R-1-AA, R-1-A, R-1, R-1 per City Code, Section 50-74: Impervious Surface Ratio

1. Total Lot Area (sqft) X 0.35 = Allowable Impervious Area (BASE).  
 Total Lot Area \_\_\_\_\_ X 0.35 = \_\_\_\_\_  
 Allowable Impervious Area (BASE) \_\_\_\_\_

2. Calculate the "proposed" impervious area on the lot. This includes the sum of all areas that do not allow direct percolation of rainwater. Examples include house, pool, deck, driveway, accessory building, etc

- House \_\_\_\_\_
- Driveway \_\_\_\_\_
- Walkway \_\_\_\_\_
- Accessory Buildings \_\_\_\_\_
- Pool & Spa \_\_\_\_\_
- Deck & Patio \_\_\_\_\_
- Other \_\_\_\_\_

Actual Impervious Area (AIA) \_\_\_\_\_

3. If AIA is less than BASE, subtract AIA from BASE to determine the amount of impervious area that may be added without providing onsite retention.

4. If AIA is greater than BASE, then onsite retention must be provided. Assuming 7.5 inches of rainfall based on a 24hr 10 year Rain Event (TP40), the formula is: (7.5 inches rainfall/12 inches pfoot) X (result from line 4) = cubic feet of storage volume needed



DOC# 20130572745 B: 10555 P: 5140  
 10/28/2013 11:37:54 AM Page 1 of 1  
 Rec Fee: \$10.00  
 Martha O. Haynis, Comptroller  
 Orange County FL  
 PU - Ret To: FAS WINDOWS & DOORS LLC

Prepared By: J. RUPEN  
 Return to: FASWD, LLC  
 3020 Mercy Dr. Orlando, FL 32808

**NOTICE OF COMMENCEMENT**

State of Florida  
 County of Orange  
 Parcel ID: 29-23-30-1870-01-040 Permit #: \_\_\_\_\_

The undersigned hereby gives notice that improvement will be made to certain real property. In accordance with Chapter 713, Florida Statutes, the following information is provided in the Notice of Commencement:

1. Legal description of Property (and street address if available): DAEMLER SHORES WIDE LOT 4 BLD 3307 TRENHAM DRIVE, BELLEVILLE
2. General description of improvement: RAMPS & DOOR REPAIRMENT
- 3 a. Owner name/address: Steve Edwards & Len Taylor 3307 Trentwood  
 b. Interest in property: \_\_\_\_\_  
 c. Name and address of fee simple title holder (if other than owner): Same Belleville, FL 32812

4. Contractor Name and Address: FASWD, LLC  
3020 MERCY DRIVE, ORLANDO, FL 32808  
 Phone: 407-770-0184 Fax: 407-770-0187

5. Surety - Name and Address: N/A  
 Amount of bond: \$ \_\_\_\_\_

6. Lender - Name and Address: N/A



7. Persons within the State of Florida designated by Owner upon whom notices or other documents may be served as provided by Section 713.13(1)(a) 7, Florida Statutes: \_\_\_\_\_

8. In addition to him/herself, Owner designates the following person(s) to receive a copy of the Lienor's Notice as provided in Section 713.13(1)(b), Florida Statutes [Provide Name/Mailing Address]: \_\_\_\_\_

9. NOC expiration date (one full year from the date of recording unless different date is specified): \_\_\_\_\_

**WARNING TO OWNER: ANY PAYMENTS MADE BY THE OWNER AFTER THE EXPIRATION OF THE NOTICE OF COMMENCEMENT ARE CONSIDERED IMPROPER PAYMENTS UNDER CHAPTER 713, PART 1, SECTION 713.13, FLORIDA STATUTES, AND CAN RESULT IN YOUR PAYING TWICE FOR IMPROVEMENTS TO YOUR PROPERTY. A NOTICE OF COMMENCEMENT MUST BE RECORDED AND POSTED ON THE JOB SITE BEFORE THE FIRST INSPECTION. IF YOU INTEND TO OBTAIN FINANCING, CONSULT WITH YOUR LENDER OR AN ATTORNEY BEFORE COMMENCING WORK OR RECORDING YOUR NOTICE OF COMMENCEMENT.**

Verification pursuant to Section 92.525, Florida Statutes: Under penalties of perjury, I declare that I have read the foregoing and that the facts stated in it are true to the best of my knowledge and belief.

(X) Stephen Edwards  
 Signature of Owner/A Natural Person (or Owner's Authorized Officer/Director/Partner/Manager)

The foregoing instrument was acknowledged before me this 11 day of Oct, 2013 by Stephen Edwards (print name of person) as owner (type of authority) for Self (name of party on behalf of whom instrument was executed).

Roger Andrews  
 Notary Public Personally Known      -OR- Produced Identification X



*Handwritten notes:*  
 1305  
 10/28/13  
 FASWD  
 10/28/13

**LIMITED POWER OF ATTORNEY**

Date: 10-24-13

Leana Knifer

I hereby name and appoint Young Knifer to be my lawful attorney in fact to act for me and apply for a Building permit for work to be performed at the location described as:

3307 Trentwood Blvd Belle Isle, FL

(Address of Job)

32812

Steve Edwards & Lori Taylor  
(Owner of Property)

And to sign my name and do all things necessary to this appointment.

[Signature]  
(Signature of Certified Contractor)

Scott A Varga (CGC1518212)  
(Printed Name of Contractor and License Number)

STATE OF FLORIDA  
COUNTY OF Orange

The foregoing instrument was acknowledged before me this 24 day of Oct, 2013 by Scott A Varga who is personally known to me or has  produced \_\_\_\_\_ (type of identification) as identification.

[Signature]  
Signature of Notary Public, State of Florida

STUART G. EARLY  
Print/Type/Stamp Name of Notary Public

(SEAL)

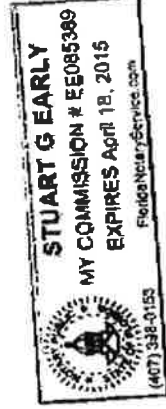



Division of Building Regulation

BCRS Home Log In User Registration Hot Topics Submit Surcharge Stats & Facts Publications POC Staff BCRS Site Map Links Search

Product Approval Usage: Public User

Product Approval Menu > Product or Application Search > Application List > Application Detail

FL # Application Type Code Version Application Status

FLS177-R11 Revision 2010

5177.15

Approved

\*Approved by DBPR. Approvals by DBPR shall be reviewed and ratified by the POC and/or the Commission if necessary.

Comments Archived

Product Manufacturer Address/Phone/Email

Simonton Windows  
1 Cochrane Ave  
Pennsboro, WV 26415  
(800) 746-6687 Ext 2329  
tiffany\_davies@simonton.com

Authorized Signature

Tiffany Davies  
tiffany\_davies@simonton.com

Technical Representative Address/Phone/Email

Tiffany Davies  
PO Box 1646  
5300 Briscoe Road  
Parkersburg, WV 26102  
(800) 542-9118 Ext 9329  
tiffany\_davies@simonton.com

Quality Assurance Representative Address/Phone/Email

AAMA  
1827 Walden Office Square  
Suite 550  
Schaumburg, IL 60173  
(847) 303-5664  
webmaster@aamanet.org

Category Subcategory

Windows Fixed **Asure**

Compliance Method

Certification Mark or Listing

Certification Agency Validated By

American Architectural Manufacturers Association  
American Architectural Manufacturers Association

Referenced Standard and Year (of Standard)

Standard	Year
AAMA 450	2010
AAMA/WDMA/CSA 101/1.5 2/A440	2005
ASTM E 1300	2004

Equivalence of Product Standards Certified By

5177.14	43-17	<p>Created by Independent Third Party: Evaluation Reports <a href="#">FL5177 R11 AE PER 2309 - 43-17 Fixed Window 1X 55.pdf</a></p> <p>Created by Independent Third Party: Yes</p> <p>Professional Contractor/Master, Grand Estates New Construction Vinyl Fixed Window Twin</p> <p><b>Certification Agency Certificate</b>  <a href="#">FL5177 R11 C CAC 43-17 PW Twin 97x80 840.pdf</a>  <b>Quality Assurance Contract Expiration Date</b>  06/15/2013</p> <p><b>Installation Instructions</b>  <a href="#">FL5177 R11 II IN0089 43-17 PW Twin 2X.pdf</a>  <a href="#">FL5177 R11 II IN0302 43-17 PW T-Mull Twin 1X.pdf</a>  Verified By: American Architectural Manufacturers Association</p> <p>Created by Independent Third Party: Evaluation Reports <a href="#">FL5177 R11 AE PER 1612 - 43-17 Fixed Window I-Mulled Twin 1X.pdf</a></p> <p>Created by Independent Third Party: Yes</p> <p>6100 Vantage Pointe,ASURE, Prism Gold, Grand Estates, Vinyl Fixed Window</p>
5177.15	43-35	<p><b>Certification Agency Certificate</b>  <a href="#">FL5177 R11 C CAC 43-35 PW 74x63 LC50.pdf</a>  <a href="#">FL5177 R11 C CAC 43-35 PW 80x48 LC50.pdf</a>  <a href="#">FL5177 R11 C CAC 43-35 PW 96x72 LC40.pdf</a>  <b>Quality Assurance Contract Expiration Date</b>  09/10/2016</p> <p><b>Installation Instructions</b>  <a href="#">FL5177 R11 II IN0094 43-35 PW 2X.pdf</a>  Verified By: American Architectural Manufacturers Association</p> <p>Created by Independent Third Party: Evaluation Reports</p> <p>Created by Independent Third Party:</p> <p>6100 Vantage Pointe,ASURE, Prism Gold, Grand Estates Vinyl Fixed Window Triple</p>
5177.16	43-35	<p><b>Certification Agency Certificate</b>  <a href="#">FL5177 R11 C CAC 43-35 PW Triple 109x72 R50.pdf</a>  <b>Quality Assurance Contract Expiration Date</b>  01/25/2016</p> <p><b>Installation Instructions</b>  <a href="#">FL5177 R11 II IN0356 43-35 PW Triple 2X.pdf</a>  Verified By: American Architectural Manufacturers Association</p> <p>Created by Independent Third Party: Evaluation Reports</p> <p>Created by Independent Third Party:</p> <p>6100 Vantage Pointe,ASURE, Prism Gold, Grand Estates Vinyl Fixed Window Twin with Transom</p>
5177.17	43-35	<p><b>Certification Agency Certificate</b>  <a href="#">FL5177 R11 C CAC 43-35 PW Twin w-Trans 73x111 835.pdf</a>  <b>Quality Assurance Contract Expiration Date</b>  01/25/2016</p> <p><b>Installation Instructions</b>  <a href="#">FL5177 R11 II IN0355 43-35 PW Twin w-Transom 2X.pdf</a>  Verified By: American Architectural Manufacturers Association</p> <p>Created by Independent Third Party: Evaluation Reports</p> <p>Created by Independent Third Party:</p> <p>6100 Vantage Pointe,ASURE, Prism Gold, Grand Estates Vinyl Fixed Window Twin with Transom</p>
5177.18	43-40	<p><b>Certification Agency Certificate</b>  <a href="#">FL5177 R11 C CAC 43-40 PW 74x63 LC50.pdf</a>  <a href="#">FL5177 R11 C CAC 43-40 PW 80x48 LC50.pdf</a>  <a href="#">FL5177 R11 C CAC 43-40 PW 96x72 LC40.pdf</a>  <b>Quality Assurance Contract Expiration Date</b>  10/05/2016</p> <p><b>Installation Instructions</b>  <a href="#">Reflections 50505300, Prism Bronze/Ultra Gold, Impressions 9400, THD Vantage Pointe 6100, Grand Estates, Grand Estates Plus Vinyl Fixed Window</a></p> <p><b>Certification Agency Certificate</b>  <a href="#">FL5177 R11 C CAC 43-40 PW 74x63 LC50.pdf</a>  <a href="#">FL5177 R11 C CAC 43-40 PW 80x48 LC50.pdf</a>  <a href="#">FL5177 R11 C CAC 43-40 PW 96x72 LC40.pdf</a>  <b>Quality Assurance Contract Expiration Date</b>  10/05/2016</p> <p><b>Installation Instructions</b></p>

SIZE CHART		
OVERALL SIZE	HEIGHT	DP RATING
80"	48"	±50 PSF
74"	42"	±40 PSF
68"	36"	±40 PSF



ALEX SPROU  
2012.02.06 17-5842  
-09:00

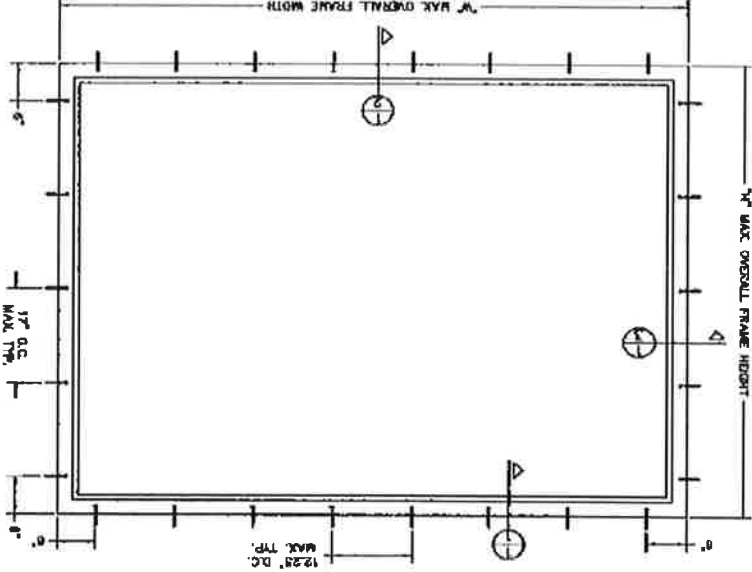

**MODEL DESIGNATION:** Simonson Series 43-40 Vinyl Fined Window  
**MATERIAL OVERALL NOMINAL SIZE:** See Size Chart  
**DESIGN PRESSURE RATING:** See Size Chart  
**INSTALL CONFIGURATIONS:** See Size Chart  
**GENERAL DESCRIPTION:** The head, sill, and side jamba are extruded PVC. The wall thickness through which the anchor screw penetrates is a minimum of 0.120".

MATERIALS		FINISH TREATMENT	
WOOD	Aluminum	PAINT	Aluminum
GLASS	Aluminum	GLASS	Aluminum
INSULATION	Aluminum	INSULATION	Aluminum
SEALS	Aluminum	SEALS	Aluminum
OPERATING MECHANISMS	Aluminum	OPERATING MECHANISMS	Aluminum
DRYING MECHANISMS	Aluminum	DRYING MECHANISMS	Aluminum

**NOTES:**  
 1. The installation has been evaluated for use in locations referring to the Florida Building Code and where design pressure requirements as determined by ASCE 7 Minimum Design Loads for Buildings and Other Structures do not exceed the design pressure ratings listed herein.  
 2. For installation where the sub-frame is less than 1 1/2" (38C chapter 17 Anchorage Methods) Tapes the concrete anchors must be used and the length must be such that a minimum of 1 1/8" embedment of the anchor into the concrete or concrete block is obtained unless otherwise noted. Anchors should be at interior and exterior periphery, otherwise, if necessary, to maintain a minimum of 2.0" edge distance from corner joints.  
 3. When the optional head anchor is used, the INSTALLER MUST ADJUST the anchor lengths to maintain the required minimum embedment into the substrate.  
 4. Anchor and exterior periphery, otherwise, if necessary, to maintain a minimum of 2.0" edge distance from corner joints.  
 5. For wood substrate, use #10 wood screws with 1 1/2" min. embedment into wood. Unless otherwise noted, screws should be a minimum of 3/4" from the edge of the wood.  
 6. The responsibility for selection of Simonson Products to meet any opposite load level, building code, ordinance, or other safety requirements rests solely with the installer.  
 7. Wood knots (by others) must be removed and anchored properly to transfer loads to the structure. Double end studs beyond exterior face of frame shall not be used.  
 8. Follow ITW/Johns for installation instructions.  
 9. For wood substrate, use #10 wood screws with 1 1/2" min. embedment into wood. Unless otherwise noted, screws should be a minimum of 3/4" from the edge of the wood.  
 10. For concrete substrate, use #10 wood screws with 1 1/2" min. embedment into wood. Unless otherwise noted, screws should be a minimum of 3/4" from the edge of the wood.  
 11. A. Concrete compressive strength = 3000 PSI at 28 days.  
 B. Concrete strength shall conform with strength requirements of ASTM C90.  
 12. Drive and tighten the wood screws with strength requirements of ASTM C90.  
 13. When using 3/16" Tapon Anchors or #10 wood screws through the window frame, provide the use of approved impact resistant sealant or other protection.  
 14. When used in areas requiring impact protection, this product RESISTS the use of approved impact resistant sealant or other protection.  
 15. Flashing should be applied using the ASTM E 2112 method appropriate for the opening into which the window is being installed.  
 16. Glazing shall comply with ASTM E 1300-04.

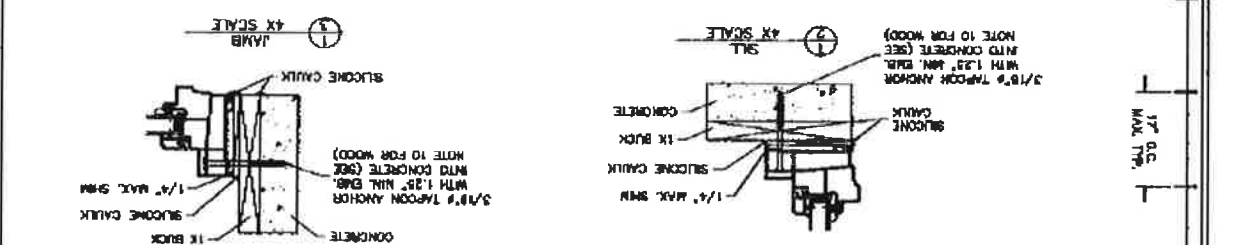

REV	DESCRIPTION	DATE	BY
1	ISSUED GENERAL DESCRIPTION WORK AND T.O.D.	02/22/10	
2	ISSUED ANCHOR TAPPING AND ADDITIONAL NOTES	11/27/11	
3	ISSUED TAPPING AND ADDITIONAL NOTES	T.O.D.	



OFFICE OF THE SECRETARY OF  
**Business & Professional Regulation**



Publications | eBC Staff | eBC Site Map | Links | Search

Home | User Registration | Help Topics | Submit Surcharges | Stats & Exits

**Product Approval**  
 User: PUBLIC User

Product Approval Menu > Product or Application Search > Application List > Application Detail

FL #  
 Application Type  
 Code Version  
 Application Status

FL5167-R14  
 Revision  
 2010

*5167.11*

Approved  
 \*Approved by DEPR. Approvals by DEPR shall be reviewed and ratified by the POC and/or the Commission if necessary.

Comments  
 Archived

Product Manufacturer  
 Address/Phone/Email

Simonon Windows  
 1 Cochran Ave  
 Pennsboro, WV 26415  
 (800) 746-6687 Ext. 2329  
 tiffany\_davies@simonon.com

Authorized Signature

Tiffany Davies  
 tiffany\_davies@simonon.com

Technical Representative  
 Address/Phone/Email

Tiffany Davies  
 PO Box 1646  
 5300 Brinkco Road  
 Parkersburg, WV 26102  
 (800) 542-9118 Ext 9329  
 tiffany\_davies@simonon.com

Quality Assurance Representative  
 Address/Phone/Email

AAMA  
 1827 Walden Office Square  
 Suite 550  
 Schaumburg, IL 60173  
 (847) 303-5664  
 waamastand@aamainet.org

Category  
 Subcategory

Windows  
 Double Hung

*ASURE*

Compliance Method

Certification Mark or Listing

Certification Agency  
 Validated By

American Architectural Manufacturers Association  
 American Architectural Manufacturers Association

Referenced Standard and Year (of Standard)

Standard  
 AAMA 450  
 AAMA 450  
 AAMA/WDMA/CSA 101/1.5.2 A440  
 AAMA/WDMA/CSA 101/1.5.2 A440

Year  
 2006  
 2010  
 2005  
 2008

Equivalence of Product Standards  
 Certified By

Product Approval Method

Method 1 Option A

http://floridabuilding.org/pr/pr\_app\_dtl.aspx?param=wGEVXQwDqZMlu87q0KmClAC... 10/1/2013

<p>5167.7 Limits of Use Approved for use in HVHZ: No Approved for use outside HVHZ: Yes Impact Resistance: No Design Pressure: N/A Other: 69x63 (+/-30 PSF), 97x60 (+/-30 PSF), 73x63 (+/-95), 73x76 (+/-50 PSF)</p>	<p>Evaluation Reports Created by Independent Third Party: ProFinish Brickmould 600 Vinyl Double Hung Twin Certification Agency Certificate E15167_R14_C_CAC_42-19_DH_Twin_73x63_R35.pdf E15167_R14_C_CAC_42-19_DH_Twin_73x76_R50.pdf E15167_R14_C_CAC_42-19_DH_Twin_89x63_R30.pdf E15167_R14_C_CAC_42-19_DH_Twin_97x60_R30.pdf Quality Assurance Contract Expiration Date 10/05/2014 Installation Instructions E15167_R14_IL_IN0150_42-19_DH_Twin_2X.pdf Verified By: American Architectural Manufacturers Association Created by Independent Third Party: Evaluation Reports Created by Independent Third Party: ProFinish Brickmould 600 Vinyl Double Hung Triple</p>
<p>5167.8 Limits of Use Approved for use in HVHZ: No Approved for use outside HVHZ: Yes Impact Resistance: No Design Pressure: +35/-35 Other: 109x74</p>	<p>Certification Agency Certificate E15167_R14_C_CAC_42-19_DH_Triples_109x74_R35.pdf Quality Assurance Contract Expiration Date 10/05/2014 Installation Instructions E15167_R14_IL_IN0151_42-19_DH_Triples_2X.pdf Verified By: American Architectural Manufacturers Association Created by Independent Third Party: Evaluation Reports Created by Independent Third Party: ProFinish Contractor, ProFinish Master and Amcraft Grand Estates New Construction Vinyl Double Hung</p>
<p>5167.9 Limits of Use Approved for use in HVHZ: No Approved for use outside HVHZ: Yes Impact Resistance: No Design Pressure: N/A Other: 36x72 (+/-30 PSF), 48x60 (+/-30 PSF), 53x71 (+/-35 PSF), 44x63 (+/-35 PSF), 48x60 (+/-35 PSF), 36x63 (+/-45 PSF), 44x65 (+/-45 PSF), 36x76 (+/-50 PSF) &amp; 36x74 (+/-50 PSF), 32x62 (+/-50 PSF)</p>	<p>Certification Agency Certificate E15167_R14_C_CAC_43-17_DH_36x72_R50.pdf E15167_R14_C_CAC_43-17_DH_32x62_R50.pdf E15167_R14_C_CAC_43-17_DH_36x63_R_P635.pdf E15167_R14_C_CAC_43-17_DH_36x74_R30.pdf E15167_R14_C_CAC_43-17_DH_36x74_R50.pdf E15167_R14_C_CAC_43-17_DH_48x60_R35.pdf E15167_R14_C_CAC_43-17_DH_48x60_R45.pdf E15167_R14_C_CAC_43-17_DH_48x60_R30.pdf E15167_R14_C_CAC_43-17_DH_48x60_R35.pdf Quality Assurance Contract Expiration Date 03/31/2014 Installation Instructions E15167_R14_IL_IN0086_43-17_DH_2X.pdf Verified By: American Architectural Manufacturers Association Created by Independent Third Party: Evaluation Reports Created by Independent Third Party: ProFinish Contractor, ProFinish Master and Amcraft Grand Estates New Construction Vinyl Double Hung T-mulled Twin</p>
<p>5167.10 Limits of Use Approved for use in HVHZ: No Approved for use outside HVHZ: Yes Impact Resistance: No Design Pressure: N/A Other: 69x60 (+/-30 PSF), 69x63 (+/-30 PSF) &amp; 72x74 (+/-45 PSF)</p>	<p>Certification Agency Certificate E15167_R14_C_CAC_43-17_DH_Twin_72x74_R_P635.pdf E15167_R14_C_CAC_43-17_DH_Twin_72x63_R_P635.pdf E15167_R14_C_CAC_43-17_DH_Twin_69x63_R30.pdf E15167_R14_C_CAC_43-17_DH_Twin_69x60_R_P635.pdf Quality Assurance Contract Expiration Date 10/30/2016 Installation Instructions E15167_R14_IL_IN0099_43-17_DH_Twin_2X.pdf Verified By: American Architectural Manufacturers Association Created by Independent Third Party: Evaluation Reports Created by Independent Third Party: 6100 Vantage Points, Aurea, Prism Gold, Grand Estates Vinyl Double Hung</p>
<p>5167.11 Limits of Use Approved for use in HVHZ: No Approved for use outside HVHZ: Yes Impact Resistance: No Design Pressure: N/A Other: 44x63 (+/-25 PSF), 46x64 (+/-25 PSF), 36x72 (+/-30 PSF), 48x60 (+/-35 PSF), 52x71 (+/-35 PSF)</p>	<p>Certification Agency Certificate E15167_R14_C_CAC_43-35_DH_36x72_R30.pdf E15167_R14_C_CAC_43-35_DH_46x64_R25.pdf E15167_R14_C_CAC_43-35_DH_48x60_R35.pdf E15167_R14_C_CAC_43-35_DH_48x60_R35.pdf E15167_R14_C_CAC_43-35_DH_32x71_R35.pdf Quality Assurance Contract Expiration Date 01/24/2016 Installation Instructions E15167_R14_IL_IN0535_43-35_43-50_DH_Twin_with_Trapdoor_2X.pdf Verified By: American Architectural Manufacturers Association Created by Independent Third Party: Evaluation Reports Created by Independent Third Party: 6100 Vantage Points, Aurea, Prism Gold, Grand Estates Vinyl Double Hung Twin with Trapdoor</p>
<p>5167.12 Limits of Use Approved for use in HVHZ: No Approved for use outside HVHZ: Yes Impact Resistance: No Design Pressure: +35/-35 Other: 73x111</p>	<p>Certification Agency Certificate E15167_R14_C_CAC_S1M_43-50_DH_ALPHA_650_73x111_R35.pdf E15167_R14_C_CAC_S1M_43-50_DH_ALPHA_650_73x111_R35.pdf Quality Assurance Contract Expiration Date 01/24/2016 Installation Instructions E15167_R14_IL_IN0535_43-35_43-50_DH_Twin_with_Trapdoor_2X.pdf Verified By: American Architectural Manufacturers Association Created by Independent Third Party: Evaluation Reports Created by Independent Third Party: Reflections 5300, Reflections 5300, Prism Bronze, Prism Ultra Gold Amcraft Grand Estates, Amcraft Grand Estates Plus, THD 6100 Vantage Points Vinyl Double Hung</p>
<p>5167.13 Limits of Use Approved for use in HVHZ: No Approved for use outside HVHZ: Yes Impact Resistance: No</p>	<p>Certification Agency Certificate E15167_R14_C_CAC_43-40_DH_36x74_R50.pdf E15167_R14_C_CAC_43-40_DH_36x74_R30.pdf</p>

NO.	REVISION	DATE
1	ISSUED FOR GENERAL DISCUSSION AND TO BE OBTAINED FROM THE MANUFACTURER	10/22/08
2	ISSUED FOR P.E. SEAL AND APPROVAL	08/04/10
3	ISSUED FOR P.E. SEAL AND APPROVAL	11/20/11
4	ISSUED FOR P.E. SEAL AND APPROVAL	11/20/11

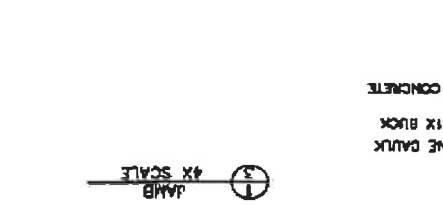
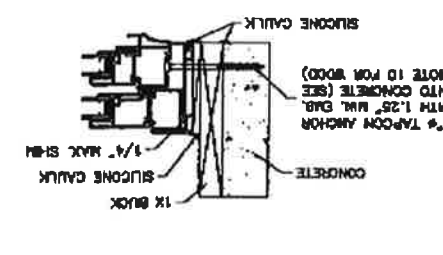

**NOTES:**

- This installation has been evaluated for use in locations adhering to the Florida Building Code and where design pressure requirements as established by ASCE 7 Medium Risk Load (or Building and Other Structures do not exceed the design pressure ratings listed herein).
- For installation where the end-buck is less than 1 1/2" (BPC chapter 17 Anchorage Methods) Topcon (Type concrete anchors must be used and the length must be such that a minimum 1 1/4" embedment of the Topcon into the concrete or concrete block is obtained, unless otherwise noted. Anchors should be a minimum of 2 1/2" from the edge of the concrete, masonry block, or concrete block.
- All interior and exterior perimeter surfaces of the window must be caulked.
- Adjust Topcon anchor locations, if necessary, to maintain a minimum of 2.0" clearances from mortar joints.
- Use the optional head spacers (see note) if used, the installer MUST ADJUST the anchor lengths to maintain the required minimum embedment into the substrate.
- Anchors shall be specified and spaced as shown. Anchor embedment to base material shall be beyond wall dressing or stucco and into wood or concrete.
- Wood studs (by others) must be engaged and anchored properly to transfer loads to the structure. Bucks shall extend beyond interior face of frame such that they are supported by the frame as provided.
- Follow IBC/EBC Topcon anchoring instructions.
- The responsibility for selection of Simonton Products to meet any applicable local laws, building codes, ordinances, or other entity requirements rests solely with the architect, building owner, or contractor.
- For product substrates, use #10 wood screws with 1 1/2" min. embedment into wood, unless otherwise noted. Screws should be a minimum of 3/4" from the edge of the wood.
- Concrete compressive strength = 3000 PSI at 28 days.
- Concrete Minimum U-tite steel conform with strength requirements of ASTM C81.
- Most Minimum Specific Gravity = 0.00.
- Stems are optional. Max. stem stock is 1/4".
- When using a 3/16" Topcon or #10 wood screw through the window frame, pre-drill the thru hole at specified installation screw locations.
- Finishing shall be applied using the ASTM E 2112 method appropriate for the opening into which the window is being installed.
- Caulking shall comply with ASTM E 1300-D4.

NO.	REVISION	DATE
1	ISSUED FOR GENERAL DISCUSSION AND TO BE OBTAINED FROM THE MANUFACTURER	10/22/08
2	ISSUED FOR P.E. SEAL AND APPROVAL	08/04/10
3	ISSUED FOR P.E. SEAL AND APPROVAL	11/20/11
4	ISSUED FOR P.E. SEAL AND APPROVAL	11/20/11

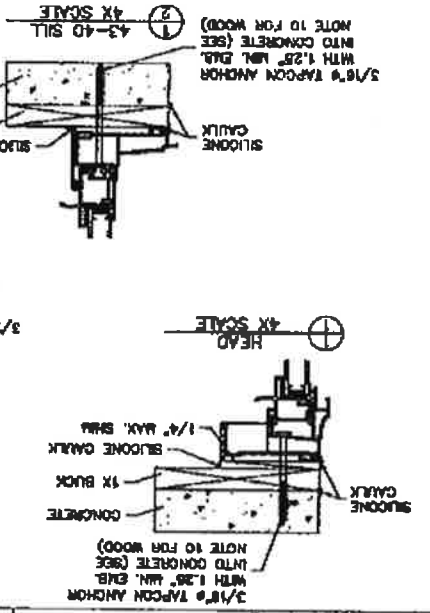

**NOTES:**

- This installation has been evaluated for use in locations adhering to the Florida Building Code and where design pressure requirements as established by ASCE 7 Medium Risk Load (or Building and Other Structures do not exceed the design pressure ratings listed herein).
- For installation where the end-buck is less than 1 1/2" (BPC chapter 17 Anchorage Methods) Topcon (Type concrete anchors must be used and the length must be such that a minimum 1 1/4" embedment of the Topcon into the concrete or concrete block is obtained, unless otherwise noted. Anchors should be a minimum of 2 1/2" from the edge of the concrete, masonry block, or concrete block.
- All interior and exterior perimeter surfaces of the window must be caulked.
- Adjust Topcon anchor locations, if necessary, to maintain a minimum of 2.0" clearances from mortar joints.
- Use the optional head spacers (see note) if used, the installer MUST ADJUST the anchor lengths to maintain the required minimum embedment into the substrate.
- Anchors shall be specified and spaced as shown. Anchor embedment to base material shall be beyond wall dressing or stucco and into wood or concrete.
- Wood studs (by others) must be engaged and anchored properly to transfer loads to the structure. Bucks shall extend beyond interior face of frame such that they are supported by the frame as provided.
- Follow IBC/EBC Topcon anchoring instructions.
- The responsibility for selection of Simonton Products to meet any applicable local laws, building codes, ordinances, or other entity requirements rests solely with the architect, building owner, or contractor.
- For product substrates, use #10 wood screws with 1 1/2" min. embedment into wood, unless otherwise noted. Screws should be a minimum of 3/4" from the edge of the wood.
- Concrete compressive strength = 3000 PSI at 28 days.
- Concrete Minimum U-tite steel conform with strength requirements of ASTM C81.
- Most Minimum Specific Gravity = 0.00.
- Stems are optional. Max. stem stock is 1/4".
- When using a 3/16" Topcon or #10 wood screw through the window frame, pre-drill the thru hole at specified installation screw locations.
- Finishing shall be applied using the ASTM E 2112 method appropriate for the opening into which the window is being installed.
- Caulking shall comply with ASTM E 1300-D4.

NO.	REVISION	DATE
1	ISSUED FOR GENERAL DISCUSSION AND TO BE OBTAINED FROM THE MANUFACTURER	10/22/08
2	ISSUED FOR P.E. SEAL AND APPROVAL	08/04/10
3	ISSUED FOR P.E. SEAL AND APPROVAL	11/20/11
4	ISSUED FOR P.E. SEAL AND APPROVAL	11/20/11

OVERALL SIZE	WINDM HEIGHT	DP RATING
46"	84"	±25 PSF
48"	80"	±30 PSF
44"	83"	±35 PSF
52"	71"	±40 PSF
58"	63"	±45 PSF
56"	63"	±45 PSF
44"	63"	±45 PSF
38"	74"	±50 PSF
32"	82"	±50 PSF

**GENERAL DESCRIPTION:**  
The head, sill, and side jamb are extruded PVC. The wall thickness through which the anchor screw penetrates is a minimum of 0.120".

NO.	REVISION	DATE
1	ISSUED FOR GENERAL DISCUSSION AND TO BE OBTAINED FROM THE MANUFACTURER	10/22/08
2	ISSUED FOR P.E. SEAL AND APPROVAL	08/04/10
3	ISSUED FOR P.E. SEAL AND APPROVAL	11/20/11
4	ISSUED FOR P.E. SEAL AND APPROVAL	11/20/11

**MODEL DESIGNATION:** Simonton Double Hung Series 43-40 / 43-45 Vinyl Window

**MAXIMUM OVERALL NOMINAL SIZE:** See Size Chart

**DESIGN PRESSURE RATING:** See Size Chart

**USABLE CONFIGURATIONS:** X

**GENERAL DESCRIPTION:**  
The head, sill, and side jamb are extruded PVC. The wall thickness through which the anchor screw penetrates is a minimum of 0.120".

**SIZE CHART**

OVERALL SIZE	WINDM HEIGHT	DP RATING
46"	84"	±25 PSF
48"	80"	±30 PSF
44"	83"	±35 PSF
52"	71"	±40 PSF
58"	63"	±45 PSF
56"	63"	±45 PSF
44"	63"	±45 PSF
38"	74"	±50 PSF
32"	82"	±50 PSF

**NOTES:**

- This installation has been evaluated for use in locations adhering to the Florida Building Code and where design pressure requirements as established by ASCE 7 Medium Risk Load (or Building and Other Structures do not exceed the design pressure ratings listed herein).
- For installation where the end-buck is less than 1 1/2" (BPC chapter 17 Anchorage Methods) Topcon (Type concrete anchors must be used and the length must be such that a minimum 1 1/4" embedment of the Topcon into the concrete or concrete block is obtained, unless otherwise noted. Anchors should be a minimum of 2 1/2" from the edge of the concrete, masonry block, or concrete block.
- All interior and exterior perimeter surfaces of the window must be caulked.
- Adjust Topcon anchor locations, if necessary, to maintain a minimum of 2.0" clearances from mortar joints.
- Use the optional head spacers (see note) if used, the installer MUST ADJUST the anchor lengths to maintain the required minimum embedment into the substrate.
- Anchors shall be specified and spaced as shown. Anchor embedment to base material shall be beyond wall dressing or stucco and into wood or concrete.
- Wood studs (by others) must be engaged and anchored properly to transfer loads to the structure. Bucks shall extend beyond interior face of frame such that they are supported by the frame as provided.
- Follow IBC/EBC Topcon anchoring instructions.
- The responsibility for selection of Simonton Products to meet any applicable local laws, building codes, ordinances, or other entity requirements rests solely with the architect, building owner, or contractor.
- For product substrates, use #10 wood screws with 1 1/2" min. embedment into wood, unless otherwise noted. Screws should be a minimum of 3/4" from the edge of the wood.
- Concrete compressive strength = 3000 PSI at 28 days.
- Concrete Minimum U-tite steel conform with strength requirements of ASTM C81.
- Most Minimum Specific Gravity = 0.00.
- Stems are optional. Max. stem stock is 1/4".
- When using a 3/16" Topcon or #10 wood screw through the window frame, pre-drill the thru hole at specified installation screw locations.
- Finishing shall be applied using the ASTM E 2112 method appropriate for the opening into which the window is being installed.
- Caulking shall comply with ASTM E 1300-D4.

**DECLARATION STATEMENT:**  
The designer is the property of Simonton Windows, which reserves all proprietary and other rights in its subject matter. This document is provided to the recipient in whole or in part, and is not to be disclosed, reproduced in whole or in part, or used in conjunction with the design, fabrication or repair of goods for anyone other than Simonton Windows without its consent. This restriction does not affect the recipient's right to make alterations contained in the document made in property obtained from another source.

**FILE PROJECT:**  
173 W. Parkside Ave. #1000  
P.O. Box 111111  
Tampa, FL 33611  
813.288.1111  
www.simonton.com

**DESIGNER:** ALEX SPYROU  
173 W. Parkside Ave. #1000  
P.O. Box 111111  
Tampa, FL 33611  
813.288.1111  
www.simonton.com

**PROFESSIONAL ENGINEER:**  
ALEX SPYROU  
No. 69101  
FLORIDA  
EXPIRES 12/31/2013

**DATE:** 2012.02.12 20:34:42 -05'00'

**ALEX SPYROU**

NO.	REVISION	DATE
1	ISSUED FOR GENERAL DISCUSSION AND TO BE OBTAINED FROM THE MANUFACTURER	10/22/08
2	ISSUED FOR P.E. SEAL AND APPROVAL	08/04/10
3	ISSUED FOR P.E. SEAL AND APPROVAL	11/20/11
4	ISSUED FOR P.E. SEAL AND APPROVAL	11/20/11



Florida Department of  
**Business & Professional  
Regulation**

11 South Woodland Drive, Tallahassee, FL 32304

OFFICE OF THE  
SECRETARY

BCIS Home Log In User Registration Hot Topics Submit Surcharges Slabs & Facts Publications FBC Staff BCIS Site Map Links Search

**Product Approval**  
USER: Public User

Product Approval Home > Product of Application Search > Analysis/Qual. > Application Detail

FL #

FL1179-R11

Application Type

Revision

Code Version

2010

Application Status

Approved

5179.12

Comments

\* Approved by DBPR. Approvals by DBPR shall be reviewed and ratified by the POC and/or the Commission if necessary.

Archived

Product Manufacturer

Simonton Windows

Address/Phone/Email

1 Cochrane Ave  
Pennsauken, NJ 08109  
(856) 746-6687 Ext 2329  
tiffany\_davies@simonton.com

Authorized Signature

Tiffany Davies  
tiffany\_davies@simonton.com

Technical Representative

Tiffany Davies

Address/Phone/Email

PO Box 1646  
5300 Briscoe Road  
Parkersburg, WV 26102  
(800) 542-9118 Ext 9329  
tiffany\_davies@simonton.com

Quality Assurance Representative

AAMA

Address/Phone/Email

1827 Walden Office Square  
Suite 550  
Schaumburg, IL 60173  
(847) 303-5664  
webmaster@aamanet.org

Category

Windows

Subcategory

Horizontal Slider

ASURE

Compliance Method

Certification Mark or Listing

Certification Agency

American Architectural Manufacturers Association

Validated By

American Architectural Manufacturers Association

Referenced Standard and Year (of Standard)

**Standard**  
AAMA/WDMA/CSA 101/1.S.2/A440

Year

2005

Equivalence of Product Standards

Certified By

http://www.floridabuilding.org/pr/pr\_app\_dtl.aspx?param=wGEVXQwtDqtQcIn%2bCtW... 6/25/2013

5179.9	43-06 and 43-17	<p>Created by Independent Third Party: Evaluation Reports Created by Independent Third Party:</p> <p>THD 6060 Vantage Point, ProFinish Builder, ProFinish Contractor, ProFinish Master, Grand Estates New Construction Vinyl 3-Lite Endvent Slider</p> <p><b>Certification Agency Certificate</b> FL5179_R11_C_CAC_43-06_EV_96x63_R30.pdf FL5179_R11_C_CAC_43-17_EV_43-06_Waiver.pdf Quality Assurance Contract Expiration Date 09/07/2014</p> <p><b>Installation Instructions</b> FL5179_R11_IL_IN0170_43-06_43-17_EV_2X.pdf FL5179_R11_IL_IN0269_43-06_EV_1X.pdf Verified By: American Architectural Manufacturers Association Created by Independent Third Party:</p> <p><b>Evaluation Reports</b> FL5179_R11_AE_43-17_TO_43-06_Waiver.pdf FL5179_R11_AE_PER_1636 - 43-06_End Vent Slidg IX.pdf Created by Independent Third Party: Yes</p>
5179.10	43-06 and 43-17	<p>THD 6060 Vantage Pointe, ProFinish Builder, ProFinish Contractor, ProFinish Master, Grand Estates New Construction Vinyl 2-Lite Horizontal Slider</p> <p><b>Certification Agency Certificate</b> FL5179_R11_C_CAC_43-06_HS_72x48_R35.pdf FL5179_R11_C_CAC_43-06_HS_72x63_R30.pdf FL5179_R11_C_CAC_43-17_EV_43-06_Waiver.pdf Quality Assurance Contract Expiration Date 07/11/2016</p> <p><b>Installation Instructions</b> FL5179_R11_IL_IN0142_43-06_43-17_SL_2X.pdf Verified By: American Architectural Manufacturers Association Created by Independent Third Party:</p> <p><b>Evaluation Reports</b> Created by Independent Third Party:</p> <p>ProFinish Contractor, Aircraft Grand Estates New Construction Vinyl 2-Lite Horizontal Slider</p>
5179.11	43-17	<p>ProFinish Contractor, Aircraft Grand Estates New Construction Vinyl 2-Lite Horizontal Slider</p> <p><b>Certification Agency Certificate</b> FL5179_R11_C_CAC_43-17_HS_72x48_R35.pdf FL5179_R11_C_CAC_43-17_HS_72x63_R30.pdf Quality Assurance Contract Expiration Date 08/02/2015</p> <p><b>Installation Instructions</b> FL5179_R11_IL_IN0141_43-17_SL_2X.pdf FL5179_R11_IL_IN0262_43-17_SL_1X.pdf Verified By: American Architectural Manufacturers Association Created by Independent Third Party:</p> <p><b>Evaluation Reports</b> FL5179_R11_AE_PER_2311 - 43-17_Horizontal Slider 1X SS.pdf Created by Independent Third Party: Yes</p>
5179.12	43-35	<p>6100 Vantage Pointe, Asure, Prism Gold, Grand Estates Vinyl 2-Lite Horizontal Slider</p> <p><b>Certification Agency Certificate</b> FL5179_R11_C_CAC_43-35_HS_72x36_R35.pdf FL5179_R11_C_CAC_43-35_HS_72x54_R30.pdf FL5179_R11_C_CAC_43-35_HS_78x63_R35.pdf FL5179_R11_C_CAC_43-35_TO_43-40_SL_Waiver.pdf FL5179_R11_C_CAC_43-40_HS_69x65_R25.pdf FL5179_R11_C_CAC_43-40_HS_72x36_R40.pdf Quality Assurance Contract Expiration Date 06/16/2013</p> <p><b>Installation Instructions</b> FL5179_R11_IL_IN0138_43-35_43-40_SL_1X.pdf FL5179_R11_IL_IN0139_43-35_SL_2X.pdf Verified By: American Architectural Manufacturers Association Created by Independent Third Party:</p> <p><b>Evaluation Reports</b> FL5179_R11_AE_PER_1630 - 43-35_43-40_Horizontal</p>



SIZE CHART

OVERALL SIZE	DP RATING	W	H
72"	±40 PSF	30"	72"
72"	±30 PSF	54"	72"
60"	±25 PSF	63"	60"
78"		63"	78"

ALEX SPYROU  
2012.02.13 14:35:58-0500

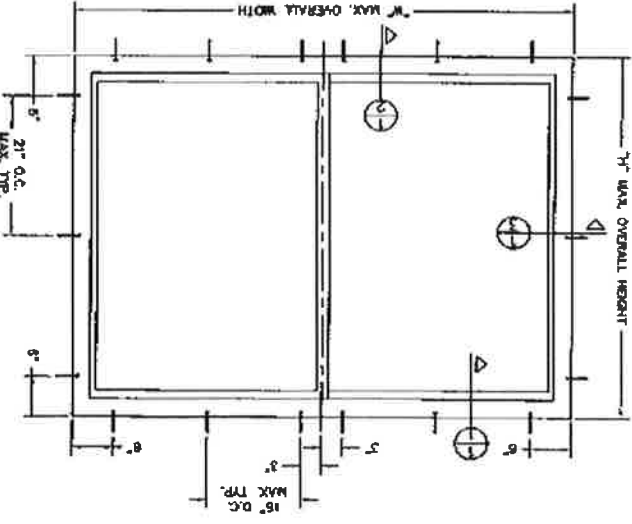

MODEL DESIGNATION: Simonon Horizontal Slider Series 43-40 Vinyl Window

See Size Chart

DESIGN PRESSURE RATING: See Size Chart

USABLE CONFIGURATIONS: XX, OX, or XO

GENERAL DESCRIPTION: The head, sill, and side jambs are extruded PVC. The wall thickness through which the anchor screws are extruded is a minimum of 0.070\"/>

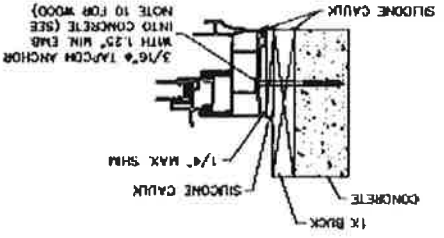
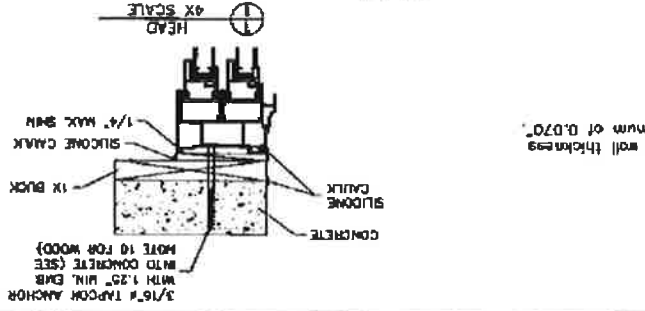

#	REVISIONS	REVISIONS BY	DATE
1	REMOVED CONCRETE FROM TITLE	T.O.D.	11/29/07
2	CHANGED TO 3/16\"/>	T.O.D.	01/24/08
3	REMOVED TAPCON FROM SILL	T.O.D.	08/21/08
4	UPDATED HOWTO GENERAL DESCRIPTION & LEGEND SHEET FOR NEW TESTING AND ANCHOR	T.O.D.	03/20/10
5	NOTES 15 & 16	T.O.D.	11/20/11

NOTES:  
1. This installation has been evaluated for use in locations subject to Florida Building Code and where design pressure requirements as determined by ASCE 7 Minimum Design Loads and Other Structures do not exceed the design pressure ratings listed herein.  
2. For installation where the sub-bulk is less than 1 1/2\"/>

- Anchor shall be specified and spaced as shown. Anchor embedment shall be designed and anchored properly to transfer loads to the structure. Bolts shall extend beyond interior face of frame girth. That full support of the frame is provided.
- Follow 18W/100 Tappcon anchoring instructions.
- The responsibility for selection of Simonon Products to meet any applicable local laws, building codes, ordinances, or other safety requirements rests solely with the architect, building owner, or contractor.
- For woodback substrates, use #10 wood screws with 1 1/2\"/>

DATE: 11/29/07	PROJECT: 1024/07	CLIENT: SIMONON
DESIGNER: T.O.D.	DATE: 10/24/07	PROJECT: 1024/07
REVISIONS BY: T.O.D.	DATE: 11/29/07	PROJECT: 1024/07
REVISIONS BY: T.O.D.	DATE: 11/29/07	PROJECT: 1024/07
REVISIONS BY: T.O.D.	DATE: 11/29/07	PROJECT: 1024/07

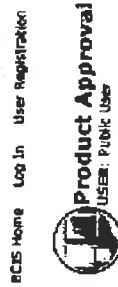
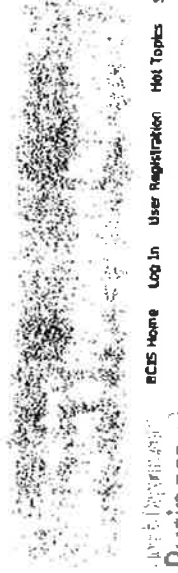

BCS Home Log In Use Registration Hot Topics Submit Surcharge Status & Facts Publications FRC Staff BCS Site Map Links Search

Product Approval Home > Product or Application Search > Application List > Application Detail

FL #  
Application Type  
Code Version  
Application Status  
Comments  
Archived

7612.5  
FL7612-R6  
Affirmation  
2010  
Approved

Product Manufacturer  
Address/Phone/Email

Simonton Windows  
1 Cochran Ave  
Pennsboro, WV 26415  
(800) 746-6687 Ext 2329  
tiffany\_davies@simonton.com

Authorized Signature

Tiffany Davies  
tiffany\_davies@simonton.com

Technical Representative  
Address/Phone/Email

Tiffany Davies  
PO Box 1646  
5300 Briscoe Road  
Parkersburg, WV 26102  
(800) 542-9118 Ext 9329  
tiffany\_davies@simonton.com

Quality Assurance Representative  
Address/Phone/Email

AAAMA  
1827 Walden Office Square  
Suite 530  
Schaumburg, IL 60173  
(847) 303-5664  
webmaster@aaamanet.org

Category  
Subcategory

5300/Asure

Compliance Method

Exterior Doors  
Sliding Exterior Door Assemblies

Certification Agency  
Validated By

Certification Mark or Listing  
American Architectural Manufacturers Association  
American Architectural Manufacturers Association

Referenced Standard and Year (of Standard)

Standard	Year
AAAMA 450	2006
AAAMA/WDMA/CSA 101/1.S.2/A440	2005

Equivalence of Product Standards  
Certified By

http://www.floridabuilding.org/pr/pr\_app\_dtl.aspx?param=wGEVXQwDqu10Gqs3mdW1... 3/15/2012

## Documentation from approved Evaluation or Validation Entity

[FL7612\\_R6\\_COC\\_Florida\\_Self\\_Affirmation\\_Letter\\_of\\_Equivalence.pdf](#)

## Product Approval Method

Method 1 Option A

Date Submitted

02/02/2012

Date Validated

02/02/2012

Date Pending FBC Approval

02/07/2012

Date Approved

Summary of Products		Description
PL #	Model, Number or Name	
7612.1	06-05	<p>Professional Contractor, ProFinish Master, Grand Estates New Construction, Therma Tru (VSPD) 2-Lite Sliding Patio Door</p> <p><b>Certification Agency Certificate</b>            FL7612_R6_C_CAC_06-05_2P_SGD_71x80_R35.pdf            FL7612_R6_C_CAC_06-05_2P_SGD_71x80_R50.pdf            FL7612_R6_C_CAC_06-05_2P_SGD_71x96_R35.pdf            FL7612_R6_C_CAC_06-05_2P_SGD_77x84_R30.pdf            FL7612_R6_C_CAC_06-05_2P_SGD_95x80_R35.pdf</p> <p><b>Quality Assurance Contract Expiration Date</b>            03/09/2013</p> <p><b>Installation Instructions</b>            FL7612_R6_II_IM0340_06-05_2P_PP_2X.pdf</p> <p>Verified By: American Architectural Manufacturers Association            Created by Independent Third Party:            Evaluation Reports            Created by Independent Third Party:</p>
7612.2	06-05	<p>Professional Contractor, ProFinish Master, Grand Estates New Construction, Therma Tru (VSPD) Vinyl 3-Lite Sliding Patio Door</p> <p><b>Certification Agency Certificate</b>            FL7612_R6_C_CAC_06-05_3P_SGD_107x80_R30.pdf            FL7612_R6_C_CAC_06-05_3P_SGD_107x80_R45.pdf</p> <p><b>Quality Assurance Contract Expiration Date</b>            03/12/2014</p> <p><b>Installation Instructions</b>            FL7612_R6_II_IM0341_06-05_3P_PD_2X.pdf</p> <p>Verified By: American Architectural Manufacturers Association            Created by Independent Third Party:            Evaluation Reports            Created by Independent Third Party:</p>
7612.3	06-05	<p>Professional Contractor, Grand Estates New Construction, ThermaTru (VSPD) Vinyl 2-Lite Sliding Patio Door with Transom</p> <p><b>Certification Agency Certificate</b>            FL7612_R6_C_CAC_06-05_SGD-FP_71x116_R45.pdf</p> <p><b>Quality Assurance Contract Expiration Date</b>            11/02/2014</p> <p><b>Installation Instructions</b>            FL7612_R6_II_IM0349_06-05_PW_ever_2P_PD_2X.pdf</p> <p>Verified By: American Architectural Manufacturers Association            Created by Independent Third Party:            Evaluation Reports            Created by Independent Third Party:</p>
7612.4	06-05	<p>Reflections 5300, Prism Ultra-Gold, TMD 6100 Vantage Pointe, Grand Estates Plus, Sears 9300, Therma Tru (VSPD) Vinyl 2-Lite Sliding Patio Door with Transom (Retrofit Installation)</p> <p><b>Certification Agency Certificate</b></p>
<b>Limits of Use</b>		
<p>Approved for use in HVHZ: No            Approved for use outside HVHZ: Yes            Impact Resistant: No            Design Pressure: N/A            Other: 77x84 (+/-30 PSF), 71x80 (+/-35 PSF), 71x96 (+/-35 PSF), 95x80 (+/-35 PSF), 71x80 (+/-50 PSF)</p>		
<b>Limits of Use</b>		
<p>Approved for use in HVHZ: No            Approved for use outside HVHZ: Yes            Impact Resistant: No            Design Pressure: +45/-45            Other: 71x116</p>		

<p>Approved for use in HVHZ: No Approved for use outside HVHZ: Yes Impact Resistant: No Design Pressure: +45/-45 Other: 71x116 Retrofit Installation</p>	<p>EL7612_R6_C_CAC_06-05_SGD_FP_71x116_R45 <u>retro.pdf</u> Quality Assurance Contract Expiration Date 03/31/2013 Installation Instructions EL7612_R6_IL_IN0413_06-05_PW_Over_PD_Retrofit ZX.pdf Verified By: American Architectural Manufacturers Association Created by Independent Third Party: Evaluation Reports Created by Independent Third Party:</p>
<p>7612.5</p> <p>Limits of Use Approved for use in HVHZ: No Approved for use outside HVHZ: Yes Impact Resistant: No Design Pressure: N/A Other: 95x80 (+/-35 PSF), 71x96 (+/-35 PSF), 71x80 (+/-35 PSF), 71x80 (+/-50 PSF) Retrofit Installation</p>	<p>06-05</p> <p>Certification Agency Certificate EL7612_R6_C_CAC_06-05_2P_SGD_71x80_R35_retro.pdf EL7612_R6_C_CAC_06-05_2P_SGD_71x80_R50_retro.pdf EL7612_R6_C_CAC_06-05_2P_SGD_71x96_R35_retro.pdf EL7612_R6_C_CAC_06-05_2P_SGD_95x80_R35_retro.pdf Quality Assurance Contract Expiration Date 03/31/2013 Installation Instructions EL7612_R6_IL_IN0412_06-05_2P_PD_Retrofit_ZX.pdf Verified By: American Architectural Manufacturers Association Created by Independent Third Party: Evaluation Reports Created by Independent Third Party:</p>
<p>7612.6</p> <p>Limits of Use Approved for use in HVHZ: No Approved for use outside HVHZ: Yes Impact Resistant: No Design Pressure: N/A Other: 77x96 (+/-35 PSF), 96x80 (+/-50 PSF)</p>	<p>11-11</p> <p>Reflections 5500, Prism Platinum, Generations, Sears 9300, Impressions 9800, THD 6500 Vantage Pointe, Grand Estates Premium Plus, Grandura Vinyl 2-Lite Sliding Patio Door Certification Agency Certificate EL7612_R6_C_CAC_11-11_2P_SGD_77x96_R35.pdf EL7612_R6_C_CAC_11-11_2P_SGD_96x80_R50.pdf Quality Assurance Contract Expiration Date 01/15/2014 Installation Instructions EL7612_R6_IL_IN0333_11-11_2P_PD_2X.pdf Verified By: American Architectural Manufacturers Association Created by Independent Third Party: Evaluation Reports Created by Independent Third Party:</p>
<p>7612.7</p> <p>Limits of Use Approved for use in HVHZ: No Approved for use outside HVHZ: Yes Impact Resistant: No Design Pressure: +35/-35 Other: 107x95</p>	<p>11-11</p> <p>Reflections 5500, Prism Platinum, Generations, Sears 9300, Impressions 9800, THD 6500 Vantage Pointe, Grand Estates Premium Plus, Grandura Vinyl 3-Lite Sliding Patio Door Certification Agency Certificate EL7612_R6_C_CAC_11-11_3P_SGD_107x95_R35.pdf Quality Assurance Contract Expiration Date 05/13/2014 Installation Instructions EL7612_R6_IL_IN0334_11-11_3P_PD_2X.pdf Verified By: American Architectural Manufacturers Association Created by Independent Third Party: Evaluation Reports Created by Independent Third Party:</p>
<p>7612.8</p> <p>Limits of Use Approved for use in HVHZ: No Approved for use outside HVHZ: Yes Impact Resistant: No Design Pressure: +35/-35 Other: 143x79</p>	<p>11-11</p> <p>Reflections 5500, Prism Platinum, Generations, Sears 9300, Impressions 9800, THD 6500 Vantage Pointe, Grand Estates Premium Plus, Grandura 4-Lite Sliding Patio Door Certification Agency Certificate EL7612_R6_C_CAC_11-11_4P_SGD_143x79_R35.pdf Quality Assurance Contract Expiration Date 03/12/2014 Installation Instructions EL7612_R6_IL_IN0337_11-11_4P_PD_2X.pdf Verified By: American Architectural Manufacturers Association Created by Independent Third Party: Evaluation Reports</p>

SIZE CHART	
OVERALL SIZE	DP RATING
71"	71"
80"	80"
87"	87"
94"	94"
101"	101"
108"	108"
115"	115"
122"	122"
129"	129"
136"	136"
143"	143"
150"	150"
157"	157"
164"	164"
171"	171"
178"	178"
185"	185"
192"	192"
199"	199"
206"	206"
213"	213"
220"	220"
227"	227"
234"	234"
241"	241"
248"	248"
255"	255"
262"	262"
269"	269"
276"	276"
283"	283"
290"	290"
297"	297"
304"	304"
311"	311"
318"	318"
325"	325"
332"	332"
339"	339"
346"	346"
353"	353"
360"	360"
367"	367"
374"	374"
381"	381"
388"	388"
395"	395"
402"	402"
409"	409"
416"	416"
423"	423"
430"	430"
437"	437"
444"	444"
451"	451"
458"	458"
465"	465"
472"	472"
479"	479"
486"	486"
493"	493"
500"	500"
507"	507"
514"	514"
521"	521"
528"	528"
535"	535"
542"	542"
549"	549"
556"	556"
563"	563"
570"	570"
577"	577"
584"	584"
591"	591"
598"	598"
605"	605"
612"	612"
619"	619"
626"	626"
633"	633"
640"	640"
647"	647"
654"	654"
661"	661"
668"	668"
675"	675"
682"	682"
689"	689"
696"	696"
703"	703"
710"	710"
717"	717"
724"	724"
731"	731"
738"	738"
745"	745"
752"	752"
759"	759"
766"	766"
773"	773"
780"	780"
787"	787"
794"	794"
801"	801"
808"	808"
815"	815"
822"	822"
829"	829"
836"	836"
843"	843"
850"	850"
857"	857"
864"	864"
871"	871"
878"	878"
885"	885"
892"	892"
899"	899"
906"	906"
913"	913"
920"	920"
927"	927"
934"	934"
941"	941"
948"	948"
955"	955"
962"	962"
969"	969"
976"	976"
983"	983"
990"	990"
997"	997"
1004"	1004"
1011"	1011"
1018"	1018"
1025"	1025"
1032"	1032"
1039"	1039"
1046"	1046"
1053"	1053"
1060"	1060"
1067"	1067"
1074"	1074"
1081"	1081"
1088"	1088"
1095"	1095"
1102"	1102"
1109"	1109"
1116"	1116"
1123"	1123"
1130"	1130"
1137"	1137"
1144"	1144"
1151"	1151"
1158"	1158"
1165"	1165"
1172"	1172"
1179"	1179"
1186"	1186"
1193"	1193"
1200"	1200"
1207"	1207"
1214"	1214"
1221"	1221"
1228"	1228"
1235"	1235"
1242"	1242"
1249"	1249"
1256"	1256"
1263"	1263"
1270"	1270"
1277"	1277"
1284"	1284"
1291"	1291"
1298"	1298"
1305"	1305"
1312"	1312"
1319"	1319"
1326"	1326"
1333"	1333"
1340"	1340"
1347"	1347"
1354"	1354"
1361"	1361"
1368"	1368"
1375"	1375"
1382"	1382"
1389"	1389"
1396"	1396"
1403"	1403"
1410"	1410"
1417"	1417"
1424"	1424"
1431"	1431"
1438"	1438"
1445"	1445"
1452"	1452"
1459"	1459"
1466"	1466"
1473"	1473"
1480"	1480"
1487"	1487"
1494"	1494"
1501"	1501"
1508"	1508"
1515"	1515"
1522"	1522"
1529"	1529"
1536"	1536"
1543"	1543"
1550"	1550"
1557"	1557"
1564"	1564"
1571"	1571"
1578"	1578"
1585"	1585"
1592"	1592"
1599"	1599"
1606"	1606"
1613"	1613"
1620"	1620"
1627"	1627"
1634"	1634"
1641"	1641"
1648"	1648"
1655"	1655"
1662"	1662"
1669"	1669"
1676"	1676"
1683"	1683"
1690"	1690"
1697"	1697"
1704"	1704"
1711"	1711"
1718"	1718"
1725"	1725"
1732"	1732"
1739"	1739"
1746"	1746"
1753"	1753"
1760"	1760"
1767"	1767"
1774"	1774"
1781"	1781"
1788"	1788"
1795"	1795"
1802"	1802"
1809"	1809"
1816"	1816"
1823"	1823"
1830"	1830"
1837"	1837"
1844"	1844"
1851"	1851"
1858"	1858"
1865"	1865"
1872"	1872"
1879"	1879"
1886"	1886"
1893"	1893"
1900"	1900"
1907"	1907"
1914"	1914"
1921"	1921"
1928"	1928"
1935"	1935"
1942"	1942"
1949"	1949"
1956"	1956"
1963"	1963"
1970"	1970"
1977"	1977"
1984"	1984"
1991"	1991"
1998"	1998"
2005"	2005"
2012"	2012"
2019"	2019"
2026"	2026"
2033"	2033"
2040"	2040"
2047"	2047"
2054"	2054"
2061"	2061"
2068"	2068"
2075"	2075"
2082"	2082"
2089"	2089"
2096"	2096"
2103"	2103"
2110"	2110"
2117"	2117"
2124"	2124"
2131"	2131"
2138"	2138"
2145"	2145"
2152"	2152"
2159"	2159"
2166"	2166"
2173"	2173"
2180"	2180"
2187"	2187"
2194"	2194"
2201"	2201"
2208"	2208"
2215"	2215"
2222"	2222"
2229"	2229"
2236"	2236"
2243"	2243"
2250"	2250"
2257"	2257"
2264"	2264"
2271"	2271"
2278"	2278"
2285"	2285"
2292"	2292"
2299"	2299"
2306"	2306"
2313"	2313"
2320"	2320"
2327"	2327"
2334"	2334"
2341"	2341"
2348"	2348"
2355"	2355"
2362"	2362"
2369"	2369"
2376"	2376"
2383"	2383"
2390"	2390"
2397"	2397"
2404"	2404"
2411"	2411"
2418"	2418"
2425"	2425"
2432"	2432"
2439"	2439"
2446"	2446"
2453"	2453"
2460"	2460"
2467"	2467"
2474"	2474"
2481"	2481"
2488"	2488"
2495"	2495"
2502"	2502"
2509"	2509"
2516"	2516"
2523"	2523"
2530"	2530"
2537"	2537"
2544"	2544"
2551"	2551"
2558"	2558"
2565"	2565"
2572"	2572"
2579"	2579"
2586"	2586"
2593"	2593"
2600"	2600"
2607"	2607"
2614"	2614"
2621"	2621"
2628"	2628"
2635"	2635"
2642"	2642"
2649"	2649"
2656"	2656"
2663"	2663"
2670"	2670"
2677"	2677"
2684"	2684"
2691"	2691"
2698"	2698"
2705"	2705"
2712"	2712"
2719"	2719"
2726"	2726"
2733"	2733"
2740"	2740"
2747"	2747"
2754"	2754"
2761"	2761"
2768"	2768"
2775"	2775"
2782"	2782"
2789"	2789"
2796"	2796"
2803"	2803"
2810"	2810"
2817"	2817"
2824"	2824"
2831"	2831"
2838"	2838"
2845"	2845"
2852"	2852"
2859"	2859"
2866"	2866"
2873"	2873"
2880"	2880"
2887"	2887"
2894"	2894"
2901"	2901"
2908"	2908"
2915"	2915"
2922"	2922"
2929"	2929"
2936"	2936"
2943"	2943"
2950"	2950"
2957"	2957"
2964"	2964"
2971"	2971"
2978"	2978"
2985"	2985"
2992"	2992"
2999"	2999"
3006"	3006"
3013"	3013"
3020"	3020"
3027"	3027"
3034"	3034"
3041"	3041"
3048"	3048"
3055"	3055"
3062"	3062"
3069"	3069"
3076"	3076"
3083"	3083"
3090"	3090"
3097"	3097"
3104"	3104"
3111"	3111"
3118"	3118"
3125"	3125"
3132"	3132"
3139"	3139"
3146"	3146"
3153"	3153"
3160"	3160"
3167"	3167"
3174"	3174"
3181"	3181"
3188"	3188"
3195"	3195"
3202"	3202"
3209"	3209"
3216"	3216"
3223"	3223"
3230"	3230"
3237"	3237"
3244"	3244"
3251"	3251"
3258"	3258"
3265"	3265"
3272"	3272"
3279"	3279"
3286"	3286"
3293"	3293"
3300"	3300"
3307"	3307"
3314"	3314"
3321"	3321"
3328"	



REV	REVISIONS	APPROVED BY	DATE
1	Initial height den. to R.S. from W.S. & note den. to R.S. from S.D.	AM	04/17/10
2	UPDATED WORKS, GENERAL DIMENSIONS, AND T.O.D.	T.O.D.	04/08/11
3	ADDED SIZES FOR NEW TESTING	T.O.D.	08/04/11
4	ADDED GLAZING DETAILS	T.O.D.	08/29/11

**MODEL RESERVATION:** Simonson Series 06-08 2-Panel Vinyl Patio Door  
See Size Chart

**DESIGN PRESSURE RATING:** See Size Chart

**USAGE CONDITIONS:** KO, OK

**GENERAL DESCRIPTION:** The head, sill, and side jambs are extruded PVC. The wall thickness through which the anchor screw penetrates is a minimum of 0.070".

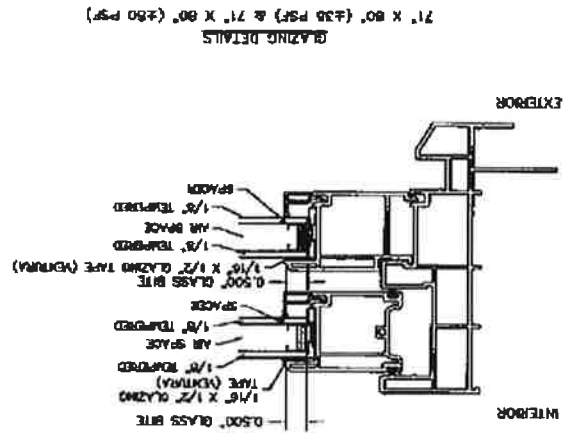
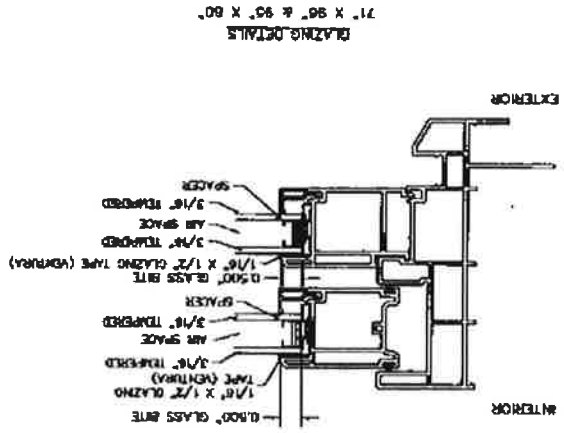

TITLE		PROJECT		SCALE		DATE	
GLAZING DETAILS		06-08 2-PANEL PATIO DOOR		1/4" = 1'-0"		04/17/10	
DRAWN BY: B. INOUE		CHECKED BY: DATE: 04/17/10		PROJECT NO: 1000 & 008		SHEET NO: 2 of 2	
DESIGNED BY: DATE: 04/17/10		PROJECT NO: 1000 & 008		SHEET NO: 2 of 2		PROJECT NO: 1000 & 008	
DRAWING NO: 1000 & 008		PROJECT NO: 1000 & 008		SHEET NO: 2 of 2		PROJECT NO: 1000 & 008	
DRAWING NO: 1000 & 008		PROJECT NO: 1000 & 008		SHEET NO: 2 of 2		PROJECT NO: 1000 & 008	

**DISCLAIMER:** This document is the property of Simonson Windows, which reserves all proprietary and other rights to the subject matter. This document is provided to the recipient in whole or in part, not used in conjunction with the company, nor shall it be reproduced, stored in a retrieval system, or transmitted in any form or by any means, electronic, mechanical, photocopying, recording, or by any information storage and retrieval system, without the prior written permission of Simonson Windows. The recipient agrees to indemnify Simonson Windows from and hold it harmless from any and all claims, damages, and expenses, including reasonable attorneys' fees, that may be incurred by Simonson Windows as a result of the recipient's use of this document.

**REVISIONS:**

NO.	DATE	DESCRIPTION
1	04/17/10	Initial height den. to R.S. from W.S. & note den. to R.S. from S.D.
2	04/08/11	UPDATED WORKS, GENERAL DIMENSIONS, AND T.O.D.
3	08/04/11	ADDED SIZES FOR NEW TESTING
4	08/29/11	ADDED GLAZING DETAILS

JOB#  
33563  
EDWARDS  
3357 Trendwood Blvd  
Orlando FL  
32812

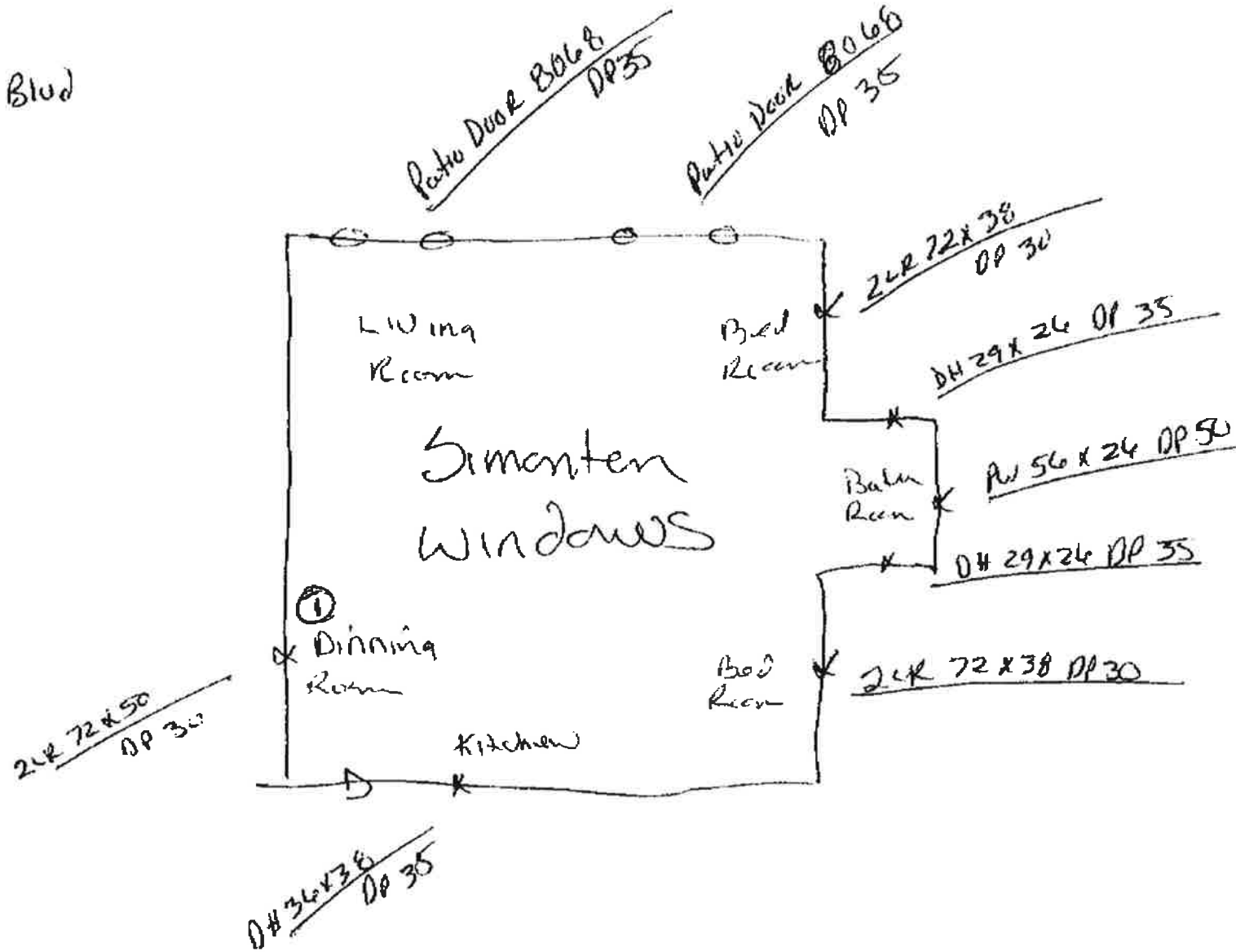

2013-10-28 14:12

33

P 7/21

3020 Macey Drive  
Orlando, FL 32808  
(407)770-0184



7715 Anderson Rd.  
Tampa, FL 33634  
(813)514-9490

Name: Yevie Edwards  
Title: 407489-6017  
Below for use at the printer located at:

FL Lic # CGC1518212

Form # \_\_\_\_\_  
To be filled in by FASWD. In case of a Homeowner Association?

3307 Textural Blvd Bal Harbour FL 33161

Congratulations on your purchase of the finest home improvement products in the industry today! Below are the names and contact information of key people involved with your purchase. We believe that communication is the pathway to success. Please contact the people listed below at any time regarding your purchase and installation.

You will be contacted by a member of your Installation Team to discuss the following:

1. Confirm receipt of your contract and review specifications.
2. Schedule a time for the light recess.
3. Identify an approximate installation start or delivery date.
4. Answer any concerns you may have related to the project.

Customer Care  
In the event that you have any questions or concerns regarding the window or door installation, please do not hesitate to contact Kyle your Production Coordinator, at 521-447-8282 your Production Manager, at Theresa your Project Manager, at 407-770-0184 If you feel that we did not deliver on any of our promises to you, please contact us at 407-770-0184

Qty	Manufacturer	Series	Model	Color	Size	Grab	Impact	Mixed	Used	Obscur/ Tinted	Swing/ Slab	Unit Notes
1	3	Summit	Aluor	3-R	White	Push						
1	2	Summit	Aluor	Patio Doors	Dark	Push						
1												
1												

\*Please note all grid specifications, finish, hardware, trim and hinge details in line notes

Special Instructions: Life Time Leiber Warranty

Please read the following bold type and initial corresponding line. Verbal understandings and agreements with representatives shall not be binding. All understandings and agreements must be set forth in writing on this Contract and recognized and acknowledge receipt of this contract and all exhibiting to indicate my complete understanding and recognition of all terms and conditions on the front and reverse of this contract. Buyer Initials: [Signature]

HURRICANE PROTECTION I acknowledge that I am the owner of the residence and have contracted with FASWD to replace windows/doors. The home is located in an impact zone and I have existing hurricane protection equipment that complies with local jurisdiction. FASWD will not be liable if my existing protection equipment is deemed inadequate by the local government inspector after my windows are installed. In the event that my hurricane protection equipment fails inspection, I understand that FASWD will supply appropriate material at a cost to me of \$37.00 per opening. I am initialing to indicate my understanding. Buyer Initials: [Signature] Not Applicable

NOTE: The warranty provisions as stated on the reverse have been explained and I/we understand them fully. Additional provisions and warranties are attached to the reverse side and are part of this contract.

The TOTAL PRICE for all  Cash  Materials (including any applicable amount) in  Credit (Subject to the approval of the Credit Department) Credit Approval Code: \_\_\_\_\_

1) Credit (Cash) Payment payable to Installer upon completion

SUB TOTAL: 76,356  
TAX (DELIVERY OR PICK UP ONLY): 70,350  
GRAND TOTAL: 146,706  
DEPOSIT REQUIRED: 35,173  
BALANCE DUE: 35,173

If this is a credit transaction, the agreement for credit is subject to a separate agreement which is incorporated herein by reference and made a part hereof. IN WITNESS WHEREOF, Buyer has signed their name(s) this 11 day of SEP and acknowledge receipt of a true copy of this Contract and unless otherwise specified, it is understood that the Buyer is ready for work to begin.

You, the Buyer(s), may cancel this transaction at any time prior to the date of the third day after the date of this transaction. Statement affixed below acts as a receipt for the Buyer(s) received applicable construction items. See reverse side for details.

INITIALED BY: [Signature] Date: 10/2/13  
ACCEPTED BY: [Signature] Date: \_\_\_\_\_

BUYER  
S I C N  
BY: [Signature] Date: 10/1/13  
BUYER

Buyer(s) acknowledge that their document does not constitute a valid and binding Contract for any purpose unless and until it is signed and accepted by an authorized representative of FASWD. All amounts due under this agreement shall be paid upon the date specified herein, if no set out, or upon the day the last of the work or products was furnished to the Buyer. This document is subject to a service charge of 15% per month from the date due. Buyer agrees to pay FASWD all costs of collection or collection, including reasonable attorney fees, whether or not a lawsuit is commenced as a part of the collection process. This Contract and the agreement for credit, if any, shall constitute the entire agreement between the parties, which unless specified in writing shall not be altered or modified except by written agreement between the parties hereto.

IN THE EVENT THIS CONTRACT IS NOT ACCEPTED BY FASWD, ANY PAYMENT MADE HEREUNDER SHALL BE REFUNDED TO THE BUYER(S) AND THE CONTRACT SHALL BE NULL AND VOID AND OF NO EFFECT. FASWD IS NOT RESPONSIBLE FOR EXISTING STRUCTURAL DEFECTS, DRY ROT OR CODE VIOLATIONS, REPAIRING, PLASTERING, CARPENTRY AND/OR DECORATING ARE NOT INCLUDED (UNLESS SPECIFICALLY CHARGED FOR AND SPECIFIED IN WRITING HEREIN)

THIS CERTIFICATE IS ISSUED AS A MATTER OF INFORMATION ONLY AND CONFERS NO RIGHTS UPON THE CERTIFICATE HOLDER. THIS CERTIFICATE DOES NOT AFFIRMATIVELY OR NEGATIVELY AMEND, EXTEND OR ALTER THE COVERAGE AFFORDED BY THE POLICIES BELOW. THIS CERTIFICATE OF INSURANCE DOES NOT CONSTITUTE A CONTRACT BETWEEN THE ISSUING INSURER(S), AUTHORIZED REPRESENTATIVE OR PRODUCER, AND THE CERTIFICATE HOLDER.

**IMPORTANT:** If the certificate holder is an ADDITIONAL INSURED, the policy(ies) must be endorsed. If SUBROGATION IS WAIVED, subject to the terms and conditions of the policy, certain policies may require an endorsement. A statement on this certificate does not confer rights to the certificate holder in lieu of such endorsement(s).

<b>PRODUCER</b>		<b>CONTACT NAME:</b>	
BB&T - J. Rolfe Davis		PHONE (A/C, No. Ext):	FAX (A/C, No.):
PO Box 4927		407 691-9600 888-635-4183	
Orlando, FL 32802-4927		E-MAIL ADDRESS:	
407 691-9600		INSURER(S) AFFORDING COVERAGE	
INSURED		NAIC #	
FASWD LLC dba		19488	
FAS Windows & Doors		23396	
3020 Mercy Dr			
Orlando, FL 32808			
		INSURER A : Amerisure Insurance Company	
		INSURER B : Amerisure Mutual Insurance Co	
		INSURER C :	
		INSURER D :	
		INSURER E :	
		INSURER F :	

INSR LTR	TYPE OF INSURANCE	ADDL SUBR INSR WVD	POLICY NUMBER	POLICY EFF. (MM/DD/YYYY)	POLICY EXP (MM/DD/YYYY)	LIMITS
B	GENERAL LIABILITY <input checked="" type="checkbox"/> COMMERCIAL GENERAL LIABILITY <input type="checkbox"/> CLAIMS-MADE <input checked="" type="checkbox"/> OCCUR GENL AGGREGATE LIMIT APPLIES PER: <input checked="" type="checkbox"/> POLICY <input type="checkbox"/> PRO-JECT <input type="checkbox"/> LOC AUTOMOBILE LIABILITY <input checked="" type="checkbox"/> ANY AUTO <input type="checkbox"/> ALL OWNED AUTOS <input type="checkbox"/> SCHEDULED AUTOS <input checked="" type="checkbox"/> HIRED AUTOS <input checked="" type="checkbox"/> NON-OWNED AUTOS UMBRELLA LIAB <input type="checkbox"/> OCCUR EXCESS LIAB <input type="checkbox"/> CLAIMS-MADE DED <input checked="" type="checkbox"/> RETENTION \$0	X	CPP20536570502	04/12/2013	04/12/2014	EACH OCCURRENCE \$1,000,000 DAMAGE TO RENTED PREMISES (Ea occurrence) \$300,000 MED EXP (Any one person) \$10,000 PERSONAL & ADV INJURY \$1,000,000 GENERAL AGGREGATE \$2,000,000 PRODUCTS - COMPIOF AGG \$2,000,000 COMBINED SINGLE LIMIT \$1,000,000 BODILY INJURY (Per person) \$ BODILY INJURY (Per accident) \$ PROPERTY DAMAGE (Per accident) \$ AGGREGATE \$1,000,000 EACH OCCURRENCE \$1,000,000
A	WORKERS COMPENSATION ANY PROPRIETOR/PARTNER/EXECUTIVE OFFICER/MEMBER EXCLUDED? (Mandatory in NH) If yes, describe under DESCRIPTION OF OPERATIONS below	X	CA20531940502	04/12/2013	04/12/2014	E.L. EACH ACCIDENT \$1,000,000 E.L. DISEASE - EA EMPLOYEE \$1,000,000 E.L. DISEASE - POLICY LIMIT \$1,000,000
A	WORKERS COMPENSATION ANY PROPRIETOR/PARTNER/EXECUTIVE OFFICER/MEMBER EXCLUDED? (Mandatory in NH) If yes, describe under DESCRIPTION OF OPERATIONS below	X	CU20531970502	04/12/2013	04/12/2014	EACH OCCURRENCE \$1,000,000 AGGREGATE \$1,000,000
A	WORKERS COMPENSATION ANY PROPRIETOR/PARTNER/EXECUTIVE OFFICER/MEMBER EXCLUDED? (Mandatory in NH) If yes, describe under DESCRIPTION OF OPERATIONS below	X	WC205306407	04/12/2013	04/12/2014	E.L. EACH ACCIDENT \$1,000,000 E.L. DISEASE - EA EMPLOYEE \$1,000,000 E.L. DISEASE - POLICY LIMIT \$1,000,000

**COVERAGES** CERTIFICATE NUMBER: 13/14 Master BAI/BWO REVISION NUMBER:

THIS IS TO CERTIFY THAT THE POLICIES OF INSURANCE LISTED BELOW HAVE BEEN ISSUED TO THE INSURED NAMED ABOVE FOR THE POLICY PERIOD INDICATED. NOTWITHSTANDING ANY REQUIREMENT, TERM OR CONDITION OF ANY CONTRACT OR OTHER DOCUMENT WITH RESPECT TO WHICH THIS CERTIFICATE MAY BE ISSUED OR MAY PERTAIN, THE INSURANCE AFFORDED BY THE POLICIES DESCRIBED HEREIN IS SUBJECT TO ALL THE TERMS, EXCLUSIONS AND CONDITIONS OF SUCH POLICIES. LIMITS SHOWN MAY HAVE BEEN REDUCED BY PAID CLAIMS.

DESCRIPTION OF OPERATIONS / LOCATIONS / VEHICLES (Attach ACORD 101, Additional Remarks Schedule, if more space is required)

Additional Insured status is granted with respects to General Liability if required by written contract per endorsement Contractors Blanket Additional Insured Endorsement Form #CG7048 03 04.

Waiver of Subrogation status is granted with respects to General Liability if required by written contract per endorsement "Contractors General Liability Extension Endorsement" Form #CG7049 0905.  
(See Attached Descriptions)

<b>CERTIFICATE HOLDER</b>		<b>CANCELLATION</b>	
City of Belle Isle 1600 Nela Avenue Belle Isle, FL 32809		SHOULD ANY OF THE ABOVE DESCRIBED POLICIES BE CANCELLED BEFORE THE EXPIRATION DATE THEREOF, NOTICE WILL BE DELIVERED IN ACCORDANCE WITH THE POLICY PROVISIONS.  AUTHORIZED REPRESENTATIVE 	



STATE OF FLORIDA  
 DEPARTMENT OF BUSINESS AND PROFESSIONAL REGULATION  
 CONSTRUCTION INDUSTRY LICENSING BOARD  
 1940 NORTH MONROE STREET  
 TALLAHASSEE FL 32399-0783

(850) 487-1395

VARGA, SCOTT ALEXANDER  
 FASWD, LLC  
 2939 BOWER ROAD  
 WINTER PARK FL 32792



STATE OF FLORIDA  
 DEPARTMENT OF BUSINESS AND  
 PROFESSIONAL REGULATION

CGC1518212 05/10/12 118183598

CERTIFIED GENERAL CONTRACTOR  
 VARGA, SCOTT ALEXANDER  
 FASWD LLC

Congratulations! With this license you become one of the nearly one million Floridians licensed by the Department of Business and Professional Regulation. Our professionals and businesses range from architects to yacht brokers, from boxers to barbecue restaurants, and they keep Florida's economy strong.

Every day we work to improve the way we do business in order to serve you better. For information about our services, please log onto [www.myfloridalicense.com](http://www.myfloridalicense.com). There you can find more information about our divisions and the regulations that impact you, subscribe to department newsletters and learn more about the Department's initiatives.

Our mission at the Department is: License Efficiently, Regulate Fairly. We constantly strive to serve you better so that you can serve your customers. Thank you for doing business in Florida, and congratulations on your new license!

IS CERTIFIED under the provisions of Ch.489 FS  
 Expiration date: AUG 31, 2014 L12051001089

DETACH HERE

THIS DOCUMENT HAS A COLORED BACKGROUND • MICROPRINTING • LINEMARK™ PATENTED PAPER

AC# 6124478

STATE OF FLORIDA

DEPARTMENT OF BUSINESS AND PROFESSIONAL REGULATION  
 CONSTRUCTION INDUSTRY LICENSING BOARD

SEQ# L12051001089

DATE	BATCH NUMBER	LICENSE NBR
05/10/2012	118183598	CGC1518212

The GENERAL CONTRACTOR  
 Named below IS CERTIFIED  
 Under the provisions of Chapter 489 FS.  
 Expiration date: AUG 31, 2014

VARGA, SCOTT ALEXANDER  
 FASWD, LLC  
 3020 MERCY DR  
 ORLANDO FL 32808

RICK SCOTT  
 GOVERNOR

KEN LAWSON  
 SECRETARY

DISPLAY AS REQUIRED BY LAW



# Scott Randolph, Tax Collector      Local Business Tax Receipt      Orange County, Florida

This local business tax receipt is in addition to and not in lieu of any other tax required by law or municipal ordinance. Businesses are subject to regulation of zoning, health and other lawful authorities. This receipt is valid from October 1 through September 30 of receipt year. **Delinquent penalty is added October 1.**

\*\*\*ORIGINAL\*\*\*

2013

EXPIRES 9/30/2014

3502-0595820

3502 WHOLESALE BUILDING SUPP \$30.00 6

EMPLOYEE

TOTAL TAX \$30.00  
PREVIOUSLY PAID \$30.00  
TOTAL DUE \$0.00

3020 MERCY DR #F  
A - ORLANDO, 32808



WILDING ERNEST

FASWD LLC  
3020 MERCY DR #F  
ORLANDO FL 32808

PAID: \$30.00 098-00610758 10/1/2013

This receipt is official when validated by the Tax Collector.

# Scott Randolph, Tax Collector      Local Business Tax Receipt      Orange County, Florida

This local business tax receipt is in addition to and not in lieu of any other tax required by law or municipal ordinance. Businesses are subject to regulation of zoning, health and other lawful authorities. This receipt is valid from October 1 through September 30 of receipt year. **Delinquent penalty is added October 1.**

\*\*\*ORIGINAL\*\*\*

2013

EXPIRES 9/30/2014

1801-1076521

1801 CERT GENERAL CONTR \$30.00 1

EMPLOYEE

TOTAL TAX \$30.00  
PREVIOUSLY PAID \$30.00  
TOTAL DUE \$0.00

3020 MERCY DR #F  
A - ORLANDO, 32808



VARGA SCOTT A - QUALIFIER

FASWD LLC  
3020 MERCY DR #F  
ORLANDO FL 32808

PAID: \$30.00 098-00610759 10/1/2013

This receipt is official when validated by the Tax Collector.