



# City of Belle Isle

Universal Engineering Sciences 3532 Maggie Blvd., Orlando, FL 32811  
Tel 407-581-8161 \* Fax 407-581-0313 \* [www.universalengineering.com](http://www.universalengineering.com)

## PERMIT CARD – PLEASE POST AT JOB SITE

THIS DOCUMENT BECOMES YOUR PERMIT WHEN PROPERLY VALIDATED

Per FBC 105.3.3: An enforcing authority may not issue a building permit for any building construction, erection, alteration, modification, repair or addition unless the permit either includes on its face or there is attached to the permit the following statement: "NOTICE: In addition to the requirements of this permit, there may be additional restrictions applicable to this property that may be found in the public records of this county, and there may be additional permits required from other governmental entities such as water management districts, state agencies, or federal agencies." The issuance of this permit does not grant permission to violate any applicable City, Orange County, State of Florida and/or Federal codes and/or ordinances. Separate permits are required for Signs, Roofing, Electrical, Gas, Plumbing and Mechanical services. This permit becomes VOID if the work authorized is not commenced within 6 months, or is suspended or abandoned for a period of 6 months after commencement. **WORK SHALL BE CONSIDERED SUSPENDED IF AN APPROVED INSPECTION HAS NOT BEEN MADE WITHIN A 6 MONTH PERIOD.** PERMISSION IS GRANTED TO DO THE FOLLOWING WORK ACCORDING TO THE CONDITIONS HEREON AND THE APPROVED PLANS AND SPECIFICATIONS, SUBJECT TO COMPLIANCE WITH THE ORDINANCES OF THE CITY OF BELLE ISLE, FLORIDA.

**Scope of Work:** BUILDING: replace size for size door (front door)  
**Comments:** None

### Project Information

**Address:** 2488 Trentwood Blvd, Belle Isle, FL 32812  
**Parcel ID:** 30-23-30-1696-00-060  
**Property Owner:** Salamat, Julia  
**Phone Number:** 407 851 8538

**Company Name:** Lowe's Home Centers Inc.  
**Contractor Name:** Cafaro, Peter  
**License Number:** CGC1508417  
**Address:** PO Box 781993, Orlando, FL 32878-1993  
**Phone Number:** 407-832 8085

**Permit Number: 2015-04-001**

**Date of Application: 03/31/2015**

**Date Permit Issued: 04/13/2015**

**WARNING TO OWNER:** "YOUR FAILURE TO RECORD A NOTICE OF COMMENCEMENT MAY RESULT IN YOU PAYING TWICE FOR IMPROVEMENTS TO YOUR PROPERTY. IF YOU INTEND TO OBTAIN FINANCING, CONSULT WITH YOUR LENDER OR AN ATTORNEY BEFORE RECORDING YOUR NOTICE OF COMMENCEMENT." ON THE JOB INSPECTION(S) MUST BE MADE BEFORE PROCEEDING WITH SUBSEQUENT WORK. THIS CARD MUST BE DISPLAYED OUTSIDE AND BE PROTECTED FROM THE WEATHER WHILE BEING VISIBLE FROM THE STREET UNTIL THE FINAL INSPECTIONS HAVE BEEN APPROVED.

### BUILDING FEATURES

#### IMPACT FEES

School \$  
Traffic \$

#### ZONING FEES

Zoning Fee \$

#### UNIVERSAL ENG - BUILDING FEES

Cert of Occ \$  
Demo \$  
Building \$  
Fence \$  
Driveway \$  
Shed \$  
Window(s) \$  
Door(s) \$43.50  
PrePower \$  
Electrical \$  
Temp Pole \$  
Plumbing \$  
Mechanical \$  
Gas \$  
Roofing \$  
Boat Dock \$  
Screen Encl \$  
Swimming Pool \$  
Sign \$

#### SURCHARGE FEES

Surcharge Fee \$2.00  
Surcharge Fee \$2.00

**TOTAL FEES \$47.50**

**Date Paid** 4-14-15

**CC or Check #** VISA 9707

**Amount Paid** 47.50

The person accepting this permit shall conform to the terms of the application on file and construction shall conform to the requirements of the Florida Building Code (FS 553).

#### BUILDING INSPECTOR USE ONLY

IF APPLICABLE:

Have Zoning Approval Conditions Been Met? YES NO Have Stormwater Approval Conditions Been Met? YES NO Silt fencing in place? YES NO Turbidity Barrier in place? YES NO

#### BUILDING

1<sup>st</sup> \_\_\_\_\_ (Footing/Foundation)  
Survey specific foundation plan must be onsite before slab pour. Approved Plan on Site? \_\_\_\_  
2<sup>nd</sup> \_\_\_\_\_ (Slab)  
3<sup>rd</sup> \_\_\_\_\_ (Lintel)(Wall Reinforcing on Masonry Building)  
4<sup>th</sup> \_\_\_\_\_ (Exterior Framing)(Roof/Wall Sheathing)  
5<sup>th</sup> \_\_\_\_\_ (Framing) (To be made after Plumbing/ Mechanical/ Electrical Rough-Ins & Windows/Doors Installed)  
6<sup>th</sup> \_\_\_\_\_ (Insulation to be Made After Roof Installed)  
7<sup>th</sup> \_\_\_\_\_ (Drywall)  
8<sup>th</sup> \_\_\_\_\_ (Sidewalk/Driveway)  
9<sup>th</sup> \_\_\_\_\_ (Other)  
10<sup>th</sup> \_\_\_\_\_ (Final – After MEP and Other Applicable Finals)

#### ROOFING

1<sup>ST</sup> ROOFING Deck Nailing/Dry-in/Flashing \_\_\_\_\_  
2<sup>nd</sup> ROOFING Covering In-Progress \_\_\_\_\_  
3<sup>rd</sup> ROOFING Covering Final \_\_\_\_\_

#### PLUMBING (Pool-Piping, Solar, Irrigation, Water Treatment Equip, Etc...)

1<sup>ST</sup> \_\_\_\_\_ (Underground) 2<sup>nd</sup> \_\_\_\_\_ (Sewer)  
3<sup>rd</sup> \_\_\_\_\_ (Rough-In/Tub Set) 4<sup>th</sup> \_\_\_\_\_ (Final)

#### CHECK APPROPRIATE BOX

GAS  Natural  LP  MECHANICAL  ELECTRICAL  LOW VOLTAGE

1<sup>st</sup> \_\_\_\_\_ (Rough-In) 2<sup>nd</sup> \_\_\_\_\_ (Final)

Inspection requests are to be emailed to [BIDScheduling@UniversalEngineering.com](mailto:BIDScheduling@UniversalEngineering.com); a confirmation email will be sent back to you upon scheduling. **Next-Day Inspection requests must be made by 1pm.** Please include the following in your request: Permit #, project address, type of inspection, date of the requested inspection, a contact name & a contact phone number. AM or PM may be requested but cannot be guaranteed.

For a copy of your permit, or to check inspection results, please visit <https://universalengineering.sharefile.com/f/fo94edc4-832d-44bd-9809-ecf32f9e2e63>

login ID = [cobi@universalengineering.com](mailto:cobi@universalengineering.com)

password = universal13

CITY OF BELLE ISLE  
Permit Application Review Sheet

Permit Number	2015-04-001
Property Owner	Salamat
Address	2488 Trentwood Blvd
Nature of Improvement	Front Door
Received Application	3-30-15
Sent for Stormwater Review	
Stormwater Approved	/
Sent for Zoning Review	
Zoning Approved	/
Applied for Variance	
Variance Approved	
Sent to BO for Review	4-13-15
Building Official Approved	
Comments	
1.	3-30-15 ccq app missing home owner signature
2.	+ is outdated; emailed Nan.
3.	Susan 4-14-15 Rec'd letter of insurance in
4.	lieu of cert - Collins says OK.
5.	
6.	
7.	
8.	
9.	
10.	
11.	
12.	



# City of Belle Isle

Universal Engineering Sciences 3532 Maggie Blvd., Orlando, FL 32811  
Tel 407-581-8161 \* Fax 407-581-0313 \* [www.universalengineering.com](http://www.universalengineering.com)

## Building Permit (Land Use) Application

DATE: 3/31/15

PERMIT # 2015-04-001

PROJECT ADDRESS 2488 Trentwood Blvd Belle Isle, FL 32809 32812

PROPERTY OWNER Salamat, Julia PHONE 407 851 8528 VALUE OF WORK (labor & material) \$ 1524.66

PLEASE LIST THE NATURE OF YOUR PROPOSED IMPROVEMENTS

**REMOVE & REPLACE SIZE for SIZE FRONT DOOR**

Please provide information, if applicable.

- Survey specific foundation plan required to show compliance with zoning setbacks
- **BOAT DOCK:** DEP Clearance Required with Application (Call 407-897-4100); please provide a copy of their report
- **SEPTIC SYSTEM (RESIDENTIAL):** - Provide verification of OC Health Dept approval for on-site septic tank system, per FAC Chap. 64E-6
- Homeowners will be required to have a contractor on record for homes that are rented and/or not homestead

Please Complete for the City of Belle Isle Zoning Review: Parcel Id Number: 30-23-30-1696-00-060

To obtain this information, please visit <http://www.ocpaf.org/Searches/ParcelSearch.aspx>

SPECIAL CONDITIONS: STRUCTURES MAY NOT ENCROACH INTO ANY EASEMENT OR REQUIRED SETBACK. Note, this Zoning Approval MAY or MAY NOT be in conflict with your Deed Restrictions. For New Single Family Residence, a Traffic Impact Fee and School Impact will be assessed.

Wind Exposure Category: B \_\_\_ C \_\_\_ D \_\_\_

Attached Survey \_\_\_ SETS and Construction Plans \_\_\_ SETS

PLANNING & ZONING APPROVAL: \_\_\_\_\_  
DATE \_\_\_\_\_

PLEASE COMPLETE for Building Review

CONSTRUCTION TYPE REMOVE & REPLACE SIZE for SIZE FRONT DOOR

OCCUPANCY GROUP R-1-AA Comm Res: XX Single Fam Multi Fam

#BLDG \_\_\_\_\_ #UNITS \_\_\_\_\_ #STORIES \_\_\_\_\_ TOTAL SQ. FT. \_\_\_\_\_

MAX. FLOOR LOAD \_\_\_\_\_ MAX. OCCUPANCY \_\_\_\_\_

MIN. FLOOR ELEV \_\_\_\_\_ LOW FLOOR ELEV \_\_\_\_\_

WATER SERVICE \_\_\_\_\_ WELL \_\_\_\_\_ SEPTIC \_\_\_\_\_

REVIEW	Date: Sent _____	RCD _____	Y	N	\$
SPRINKLERS REQ'D			Y	N	
If Required - SUBMIT COPY OF PLANS FOR FIRE					
ZONING	Y	N			\$
CERT OF OCC	Y	N			\$
TRAFFIC	Y	N			\$
SCHOOL	Y	N			\$
FIRE	Y	N			\$
SWIMMING POOL	Y	N			\$
SCREEN ENCLOSURE	Y	N			\$
ROOFING	Y	N			\$
BOAT DOCK	Y	N			\$
BUILDING	Y	N			\$
WINDOW(S)	Y	N			\$
DOOR(S)	<u>Y</u>	N			\$ <u>43.50</u>
FENCE	Y	N			\$
SHED	Y	N			\$
DRIVEWAY	Y	N			\$
OTHER	Y	N			\$

BUILDING REVIEWER \_\_\_\_\_ DATE \_\_\_\_\_

VERIFIED CONTRACTOR'S LICENSE & INSURANCE ARE ON FILE \_\_\_\_\_ DATE \_\_\_\_\_

Per FSS 105 3.3:

An enforcing authority may not issue a building permit for any building construction, erection, alteration, modification, repair or addition unless the permit either includes on its face or there is attached to the permit the following statement: "NOTICE: in addition to the requirements of this permit, there may be additional restrictions applicable to this property that may be found in the public records of this county, and there may be additional permits required from other governmental entities such as water management districts, state agencies, or federal agencies."

Republic Services is by legal contract the sole authorized provider of garbage, recycling, yard waste, and commercial garbage and construction debris collection and disposal services with the city limits of the City. Contractors, homeowners and commercial businesses may contact Republic Services at 407-293-8000 to setup accounts for Commercial, Construction Roll Off, or other services needed. Rates are fixed by contract and are available at City Hall or from Republic Services. The City enforces the contract through its code enforcement office. Failure to comply will result in a stop work order.

SEPARATE PERMITS ARE REQUIRED FOR ROOFING, ELECTRICAL, PLUMBING, GAS, MECHANICAL, SIGNS, POOLS, ENCLOSURES, ETC.

Page 1 of 2

3% FL SURCHARGE

TOTAL

By Owner Form Y NA

Notice of Commencement Y NA

Power of Attorney Y NA

Contractor Packet included? Y N

OTHER PERMITS REQUIRED:

ELECTRICAL	Y	NA
PREPOWER	Y	NA
MECHANICAL	Y	NA
PLUMBING	Y	NA
ROOFING	Y	NA
GAS	Y	NA

4.00

47.50



City of Belle Isle  
 Universal Engineering Sciences 3532 Maggie Blvd., Orlando, FL 32811  
 Tel 407-581-8161 \* Fax 407-581-0313 \* [www.universalengineering.com](http://www.universalengineering.com)

**Building Permit (Land Use) Application**  
 To be completed as required by State Statute Section 713 and other applicable sections.

PERMIT # 2015-04-001

Owner's Name Salamat, Julia  
 Owner's Address 2488 Trentwood Blvd Orlando, FL 32812

Contractor Name	PETER A CAFARO	Company Name	Lowe's Home Centers, LLC
License #	CGC1508417	Company Address	PO Box 781993
Contact Phone/Cell	407 832 8085	City, State, ZIP	Orlando, FL 32878-1993
Contact Email	Pete.A.Cafaro@Lowes.com	Contact Fax	407 296-2960

**WARNING TO OWNER:** Your failure to record a Notice of Commencement may result in your paying twice for improvements to your property. A notice of commencement must be recorded if job is \$2500(+) or if A/C Replacement \$7500(+) and posted on the job site before the first inspection. If you intend to obtain financing, consult with your lender or an attorney before recording your Notice of Commencement.

I hereby make Application for Permit as outlined above, and if same is granted I agree to conform to all Division of Building Safety Regulations ([www.floridabuilding.org](http://www.floridabuilding.org)) and City Ordinances ([www.municode.com](http://www.municode.com)) regulating same and in accordance with plans submitted. The issuance of this permit does not grant permission to violate any applicable City and/or State of Florida codes and/or ordinances. Application is hereby made to obtain a permit to do the work and installations as indicated. I certify that no work or installation has commenced prior to the issuance of a permit and that all work will be performed to meet the standards of all laws regulating construction in this jurisdiction. I understand that a separate permit must be secured for all other construction including ROOFING, ELECTRICAL, MECHANICAL, PLUMBING, GAS, SIGNS, POOLS, SCREEN ENCLOSURES, ETC.

**OWNER'S AFFIDAVIT:** I certify that all the foregoing information is accurate and that all work will be done in compliance with all applicable laws regulating construction and zoning.

**Owner Signature** Julia Salamat  
 The foregoing instrument was acknowledged before me this 3/31/15  
 by Julia Salamat who is personally known to me  
 and who produced drivers license  
 as identification and who did not take an oath.

Notary as to Owner  
 State of Florida  
 County of Orange

---

**Contractor Signature** [Signature]  
 COMPANY NAME Lowe's Home Centers, LLC  
 The foregoing instrument was acknowledged before me this 3/31/15  
 by Peter A Cafaro who is personally known to me  
 and who produced personally known  
 as identification and who did not take an oath.

Notary as to Owner  
 State of Florida  
 County of Orange

**Impervious Surface Ratio Worksheet**  
 Development Zoned A-1, A-2, R-1-AAA, R-1-AA, R-1-A, R-1 per  
 City Code, Section 50-74: Impervious Surface Ratio

- Total Lot Area (sqft) X 0.35 = Allowable Impervious Area (BASE).  
 Total Lot Area \_\_\_\_\_ X 0.35 = \_\_\_\_\_  
 Allowable Impervious Area (BASE) \_\_\_\_\_
- Calculate the "proposed" impervious area on the lot. This includes the sum of all areas that do not allow direct percolation of rainwater. Examples include house, pool, deck, driveway, accessory building, etc.
  - House \_\_\_\_\_
  - Driveway \_\_\_\_\_
  - Walkway \_\_\_\_\_
  - Accessory Buildings \_\_\_\_\_
  - Pool & Spa \_\_\_\_\_
  - Deck & Patio \_\_\_\_\_
  - Other \_\_\_\_\_
 Actual Impervious Area (AIA) \_\_\_\_\_
- If AIA is less than BASE, subtract AIA from BASE to determine the amount of impervious area that may be added without providing onsite retention.
- If AIA is greater than BASE, then onsite retention **must be provided**.

Assuming 7.5 inches of rainfall based on a 24hr 10 year Rain Event (TP40), the formula is: (7.5 inches rainfall/12 inches p/foot) X (result from line 4) = cubic feet of storage volume needed



**Lowe's Home Centers LLC**  
**Permit & License Administration**  
**PO Box 781993**  
**Orlando, FL 32878 – 1993**  
**Bus. 407/832-8085**  
**Fax. 407/393-9151**

**Limited Power of Attorney**

Date: 3/27/15

To: Building Department

From: Peter Anthony Cafaro III

I hereby name and appoint Nan Holmes, Mindy Holmes, Raymond Holmes and Jackie Caines, a permit service for Lowe's, to be my lawful attorney in fact to act for me and apply to

Belle Isle for a Door permit for work to be performed at a location described as:

(Address of Job) 2488 Trentwood Blvd  
 (Owner of Property) Julia SALAMAT

And to sign my name and do all things necessary to this appointment.

Thank you for your assistance.

Sincerely,

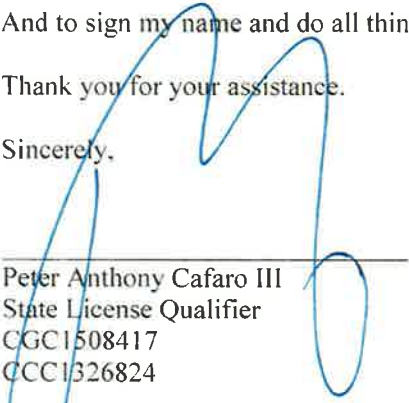
  
 Peter Anthony Cafaro III  
 State License Qualifier  
 CGC1508417  
 CCC1326824

State of Florida County of Orange

The forgoing instrument was acknowledged before me as Peter Anthony Cafaro III, who is personally known to me and who did not take an oath.

Sworn to and subscribed before me this 27 day of March, 2015

  
 Notary Public  
 My commission expires





**City of Belle Isle**  
 1600 Nela Avenue, Belle Isle, FL 32809  
 Tel 407-851-7730 \* Fax 407-240-2222 \* [www.cityofbelleislefl.org](http://www.cityofbelleislefl.org)

## Product Approval Form

DATE: 3/30/15

PERMIT # \_\_\_\_\_

PROJECT ADDRESS 2488 Trentwood Blvd

Belle Isle, FL \_\_\_\_\_ 32812

As required by Florida Statue 553.842 and Florida Administrative Code 9B-72m, please provide the information and approval numbers of the building components listed below if they will be utilized on the building or structure. FL Approved products are listed online at [www.floridabuilding.org](http://www.floridabuilding.org) or can be obtained from the local product supplier. The following information must be turned in with permit application and available onsite for inspections:

1. **This Product Approval Cover Sheet**
2. **Internet screen showing PA#, approval and code edition stamped**
3. **Manufacturer's installation details and requirements for each product stamped**

Product Type	Manufacturer	Model/Series	FL Product Approval #	Product Type	Manufacturer	Model/Series	FL Product Approval #
<b>EXTERIOR DOORS</b>				<b>WALL PANELS</b>			
Swinging	MASONITE	FIBERGLASS	FL8228 7-R6	Sliding			
Sliding				Soffits			
Sectional/Rollup				Storefront			
Other				Glass Block			
				Other			
<b>WINDOWS</b>				<b>ROOFING PRODUCTS</b>			
Single/Dbl Hung				Asphalt Shingles			
Horizontal Slider				Non Struct Metal			
Casement				Roofing Tiles			
Fixed				Single Ply Roof			
Mullion				Other			
Skylights							
Other							
<b>STRUCTURAL COMPONENTS</b>				<b>OTHER</b>			
Wood Connectors							
Wood Anchors							
Truss Plates							
Insulation Forms							
Lintels							
Other							

It is the applicant's responsibility to verify that specific products have been installed in accordance with their limitations and with the minimum required design pressures for the structure. Specific compliance will be verified during field inspections.

Applicant Signature \_\_\_\_\_

Date 3/30/15

**RETAIN A COPY FOR OFFICE USE AND RETURN ORIGINAL TO APPLICANT**  
 Updated 12-2012 **FORM #PRODAPP012**

FLORIDA DEPARTMENT OF  
**Business & Professional Regulation**



[DBPR HOME](#) | [ABOUT DBPR](#) | [DBPR DIVISIONS](#) | [CONTACT DBPR](#)



[BCIS Home](#) | [Log In](#) | [User Registration](#) | [Hot Topics](#) | [Submit Surcharge](#) | [Stats & Facts](#) | [Publications](#) | [FBC Staff](#) | [BCIS Site Map](#) | [Links](#) | [Search](#)



**Product Approval**  
USER: Public User

License efficiently. Regulate fairly.

[Product Approval Menu](#) > [Product or Application Search](#) > [Application List](#) > **Application Detail**

OFFICE OF THE SECRETARY

FL #	FL8228-R6	
Application Type	Editorial Change	
Code Version	2010	
Application Status	Approved	
	*Approved by DBPR. Approvals by DBPR shall be reviewed and ratified by the POC and/or the Commission if necessary.	
Comments	Archived	
Product Manufacturer	Masonite International	
Address/Phone/Email	1955 Powis Road West Chicago, IL 60185 (615) 441-4258 sschreiber@masonite.com	
Authorized Signature	Steve Schreiber sschreiber@masonite.com	
Technical Representative	Address/Phone/Email	
Quality Assurance Representative	Address/Phone/Email	
Category	Exterior Doors	
Subcategory	Swinging Exterior Door Assemblies	
Compliance Method	Certification Mark or Listing	
Certification Agency	National Accreditation & Management Institute	
Validated By	National Accreditation & Management Institute,	
Referenced Standard and Year (of Standard)	<b>Standard</b>	<b>Year</b>
	ASTM E1886	2002
	ASTM E1996	2002
	ASTM E330	2002
	TAS 202	1994
Equivalence of Product Standards	Certified By	

Product Approval Method Method 1 Option A  
 Date Submitted 12/08/2014  
 Date Validated 12/10/2014  
 Date Pending FBC Approval  
 Date Approved 12/15/2014

Summary of Products		
FL #	Model, Number or Name	Description
8228.1	Fiberglass Side-Hinged Door Unit	6'-8" Opaque I/S and O/S Single Door
<b>Limits of Use</b> <b>Approved for use in HVHZ:</b> Yes <b>Approved for use outside HVHZ:</b> Yes <b>Impact Resistant:</b> Yes <b>Design Pressure:</b> +85.0/-85.0 <b>Other:</b> Evaluated for use in locations adhering to the Florida Building Code including the High Velocity Hurricane Zone, and where pressure requirements as determined by ASCE 7, does not exceed the design pressures listed. 3'-0" x 6'-8" max nominal size. Hurricane protective system required in HVHZ, but not required in the Wind Borne Debris Region. See DWG-MA-FL0160-07 for additional information.		<b>Certification Agency Certificate</b> <a href="#">FL8228_R6_C_CAC_NI006900.01.pdf</a> <b>Quality Assurance Contract Expiration Date</b> 12/31/2020 <b>Installation Instructions</b> <a href="#">FL8228_R6_II_FL0160Dx.pdf</a> Verified By: National Accreditation & Management Institute Created by Independent Third Party: <b>Evaluation Reports</b> <a href="#">FL8228_R6_AE_504A.pdf</a> Created by Independent Third Party: Yes
8228.2	Fiberglass Side-Hinged Door Unit	8'-0" Opaque I/S and O/S Single Door
<b>Limits of Use</b> <b>Approved for use in HVHZ:</b> Yes <b>Approved for use outside HVHZ:</b> Yes <b>Impact Resistant:</b> Yes <b>Design Pressure:</b> +70.0/-70.0 <b>Other:</b> Evaluated for use in locations adhering to the Florida Building Code including the High Velocity Hurricane Zone, and where pressure requirements as determined by ASCE 7, does not exceed the design pressures listed. 3'-0" x 8'-0" max nominal size. Hurricane protective system required in HVHZ, but not required in the Wind Borne Debris Region. See DWG-MA-FL0161-07 for additional information.		<b>Certification Agency Certificate</b> <a href="#">FL8228_R6_C_CAC_NI006900.02.pdf</a> <b>Quality Assurance Contract Expiration Date</b> 12/31/2020 <b>Installation Instructions</b> <a href="#">FL8228_R6_II_FL0161Dx.pdf</a> Verified By: National Accreditation & Management Institute Created by Independent Third Party: <b>Evaluation Reports</b> <a href="#">FL8228_R6_AE_503A.pdf</a> Created by Independent Third Party: Yes
8228.3	Fiberglass Side-Hinged Door Unit	6'-8" Opaque Inswing Single or Double Door w/or w/o Sidelites
<b>Limits of Use</b> <b>Approved for use in HVHZ:</b> Yes <b>Approved for use outside HVHZ:</b> Yes <b>Impact Resistant:</b> Yes <b>Design Pressure:</b> +50.5/-50.5 <b>Other:</b> Evaluated for use in locations adhering to the Florida Building Code including the High Velocity Hurricane Zone, and where pressure requirements as determined by ASCE 7, does not exceed the design pressures listed. 12'-0" x 6'-8" max nominal size. Hurricane protective system required in HVHZ, but not required in the Wind Borne Debris Region. See DWG-MA-FL0160-07 for additional information.		<b>Certification Agency Certificate</b> <a href="#">FL8228_R6_C_CAC_NI006900.01.pdf</a> <b>Quality Assurance Contract Expiration Date</b> 12/31/2020 <b>Installation Instructions</b> <a href="#">FL8228_R6_II_FL0160Dx.pdf</a> Verified By: National Accreditation & Management Institute Created by Independent Third Party: <b>Evaluation Reports</b> <a href="#">FL8228_R6_AE_502A.pdf</a> Created by Independent Third Party: Yes
8228.4	Fiberglass Side-Hinged Door Unit	6'-8" Opaque Outswing Single or Double Door w/ or w/o Sidelites
<b>Limits of Use</b> <b>Approved for use in HVHZ:</b> Yes <b>Approved for use outside HVHZ:</b> Yes <b>Impact Resistant:</b> Yes <b>Design Pressure:</b> +55.0/-50.5 <b>Other:</b> Evaluated for use in locations adhering to the Florida Building Code including the High Velocity Hurricane Zone, and where pressure requirements as determined by ASCE 7, does not exceed the design pressures listed. 12'-0" x 6'-8" max nominal size. Hurricane protective system required in HVHZ, but not required in the Wind Borne Debris Region. See DWG-MA-FL0160-07 for additional information.		<b>Certification Agency Certificate</b> <a href="#">FL8228_R6_C_CAC_NI006900.01.pdf</a> <b>Quality Assurance Contract Expiration Date</b> 12/31/2020 <b>Installation Instructions</b> <a href="#">FL8228_R6_II_FL0160Dx.pdf</a> Verified By: National Accreditation & Management Institute Created by Independent Third Party: <b>Evaluation Reports</b> <a href="#">FL8228_R6_AE_502A.pdf</a> Created by Independent Third Party: Yes
8228.5	Fiberglass Side-Hinged Door Unit	8'-0" Opaque Inswing Single or Double Door w/ or w/o Sidelites
<b>Limits of Use</b> <b>Approved for use in HVHZ:</b> Yes		<b>Certification Agency Certificate</b> <a href="#">FL8228_R6_C_CAC_NI006900.02.pdf</a>



<p><b>Approved for use outside HVHZ:</b> Yes  <b>Impact Resistant:</b> Yes  <b>Design Pressure:</b> +50.5/-50.5  <b>Other:</b> Evaluated for use in locations adhering to the Florida Building Code including the High Velocity Hurricane Zone, and where pressure requirements as determined by ASCE 7, does not exceed the design pressures listed. 12'-0" x 8'-0" max nominal size. Hurricane protective system required in HVHZ, but not required in the Wind Borne Debris Region. See DWG-MA-FL0161-07 for additional information.</p>		<p><b>Quality Assurance Contract Expiration Date</b>                  12/31/2020  <b>Installation Instructions</b>  <a href="#">FL8228_R6_II_FL0161Dx.pdf</a>                  Verified By: National Accreditation &amp; Management Institute                  Created by Independent Third Party:  <b>Evaluation Reports</b>  <a href="#">FL8228_R6_AE_501A.pdf</a>                  Created by Independent Third Party: Yes</p>
<p>8228.6</p>	<p>Fiberglass Side-Hinged Door Unit</p>	<p>8'-0" Opaque Outswing Single or Double Door w/ or w/o Sidelites</p>
<p><b>Limits of Use</b>  <b>Approved for use in HVHZ:</b> Yes  <b>Approved for use outside HVHZ:</b> Yes  <b>Impact Resistant:</b> Yes  <b>Design Pressure:</b> +55.0/-50.5  <b>Other:</b> Evaluated for use in locations adhering to the Florida Building Code including the High Velocity Hurricane Zone, and where pressure requirements as determined by ASCE 7, does not exceed the design pressures listed. 12'-0" x 8'-0" max nominal size. Hurricane protective system required in HVHZ, but not required in the Wind Borne Debris Region. See DWG-MA-FL0161-07 for additional information.</p>		<p><b>Certification Agency Certificate</b>  <a href="#">FL8228_R6_C_CAC_NI006900.02.pdf</a>  <b>Quality Assurance Contract Expiration Date</b>                  12/31/2020  <b>Installation Instructions</b>  <a href="#">FL8228_R6_II_FL0161Dx.pdf</a>                  Verified By: National Accreditation &amp; Management Institute                  Created by Independent Third Party:  <b>Evaluation Reports</b>  <a href="#">FL8228_R6_AE_501A.pdf</a>                  Created by Independent Third Party: Yes</p>
<p>8228.7</p>	<p>Fiberglass Side-Hinged Door Unit</p>	<p>6'-8" Glazed Inswing Single or Double Door w/ or w/o Sidelites</p>
<p><b>Limits of Use</b>  <b>Approved for use in HVHZ:</b> Yes  <b>Approved for use outside HVHZ:</b> Yes  <b>Impact Resistant:</b> No  <b>Design Pressure:</b> +52.0/-52.0  <b>Other:</b> Evaluated for use in locations adhering to the Florida Building Code including the High Velocity Hurricane Zone, and where pressure requirements as determined by ASCE 7, does not exceed the design pressures listed. 12'-0" x 6'-8" max nominal size. Hurricane protective system required in HVHZ and the Wind Borne Debris Region. See DWG-MA-FL0162-07 for additional information.</p>		<p><b>Certification Agency Certificate</b>  <a href="#">FL8228_R6_C_CAC_NI006900.03.pdf</a>  <b>Quality Assurance Contract Expiration Date</b>                  12/31/2020  <b>Installation Instructions</b>  <a href="#">FL8228_R6_II_FL0162Dx.pdf</a>                  Verified By: National Accreditation &amp; Management Institute                  Created by Independent Third Party:  <b>Evaluation Reports</b>  <a href="#">FL8228_R6_AE_502A.pdf</a>                  Created by Independent Third Party: Yes</p>
<p>8228.8</p>	<p>Fiberglass Side-Hinged Door Unit</p>	<p>6'-8" Glazed Outswing Single or Double Door w/ or w/o Sidelites</p>
<p><b>Limits of Use</b>  <b>Approved for use in HVHZ:</b> Yes  <b>Approved for use outside HVHZ:</b> Yes  <b>Impact Resistant:</b> No  <b>Design Pressure:</b> +55.0/-55.0  <b>Other:</b> Evaluated for use in locations adhering to the Florida Building Code including the High Velocity Hurricane Zone, and where pressure requirements as determined by ASCE 7, does not exceed the design pressures listed. 12'-0" x 6'-8" max nominal size. Hurricane protective system required in HVHZ and the Wind Borne Debris Region. See DWG-MA-FL0162-07 for additional information.</p>		<p><b>Certification Agency Certificate</b>  <a href="#">FL8228_R6_C_CAC_NI006900.03.pdf</a>  <b>Quality Assurance Contract Expiration Date</b>                  12/31/2020  <b>Installation Instructions</b>  <a href="#">FL8228_R6_II_FL0162Dx.pdf</a>                  Verified By: National Accreditation &amp; Management Institute                  Created by Independent Third Party:  <b>Evaluation Reports</b>  <a href="#">FL8228_R6_AE_502A.pdf</a>                  Created by Independent Third Party: Yes</p>
<p>8228.9</p>	<p>Fiberglass Side-Hinged Door Unit</p>	<p>8'-0" Glazed Inswing Single or Double Door w/ or w/o Sidelites</p>
<p><b>Limits of Use</b>  <b>Approved for use in HVHZ:</b> Yes  <b>Approved for use outside HVHZ:</b> Yes  <b>Impact Resistant:</b> No  <b>Design Pressure:</b> +40.0/-45.0  <b>Other:</b> Evaluated for use in locations adhering to the Florida Building Code including the High Velocity Hurricane Zone, and where pressure requirements as determined by ASCE 7, does not exceed the design pressures listed. 12'-0" x 8'-0" max nominal size. Hurricane protective system required in HVHZ and the Wind Borne Debris Region. See DWG-MA-FL0163-07 for additional information.</p>		<p><b>Certification Agency Certificate</b>  <a href="#">FL8228_R6_C_CAC_NI006900.04.pdf</a>  <b>Quality Assurance Contract Expiration Date</b>                  12/31/2020  <b>Installation Instructions</b>  <a href="#">FL8228_R6_II_FL0163Dx.pdf</a>                  Verified By: National Accreditation &amp; Management Institute                  Created by Independent Third Party:  <b>Evaluation Reports</b>  <a href="#">FL8228_R6_AE_501A.pdf</a>                  Created by Independent Third Party: Yes</p>
<p>8228.10</p>	<p>Fiberglass Side-Hinged Door Unit</p>	<p>8'-0" Glazed Outswing Single or Double Door w/ or w/o Sidelites</p>
<p><b>Limits of Use</b></p>		<p><b>Certification Agency Certificate</b></p>

<p><b>Approved for use in HVHZ:</b> Yes  <b>Approved for use outside HVHZ:</b> Yes  <b>Impact Resistant:</b> No  <b>Design Pressure:</b> +43.0/-47.0  <b>Other:</b> Evaluated for use in locations adhering to the Florida Building Code including the High Velocity Hurricane Zone, and where pressure requirements as determined by ASCE 7, does not exceed the design pressures listed. 12'-0" x 8'-0" max nominal size. Hurricane protective system required in HVHZ and the Wind Borne Debris Region. See DWG-MA-FL0163-07 for additional information.</p>		<p><a href="#">FL8228_R6_C_CAC_NI006900.04.pdf</a>  <b>Quality Assurance Contract Expiration Date</b>                  12/31/2020  <b>Installation Instructions</b>  <a href="#">FL8228_R6_II_FL0163Dx.pdf</a>                  Verified By: National Accreditation &amp; Management Institute                  Created by Independent Third Party:  <b>Evaluation Reports</b>  <a href="#">FL8228_R6_AE_501A.pdf</a>                  Created by Independent Third Party: Yes</p>
<p>8228.11</p>	<p>Fiberglass Side-Hinged Door Unit</p>	<p>6'-8" Impact Glazed Inswing Single or Double Door w/ or w/o Sidelites</p>
<p><b>Limits of Use</b>  <b>Approved for use in HVHZ:</b> No  <b>Approved for use outside HVHZ:</b> Yes  <b>Impact Resistant:</b> Yes  <b>Design Pressure:</b> +52.0/-52.0  <b>Other:</b> Evaluated for use in locations adhering to the Florida Building Code not including the High Velocity Hurricane Zone, and where pressure requirements as determined by ASCE 7 do not exceed the design pressures listed. 12'-0" x 6'-8" max nominal size. See DWG-MA-FL0162-07 for additional information.</p>		<p><b>Certification Agency Certificate</b>  <a href="#">FL8228_R6_C_CAC_NI006900.05.pdf</a>  <b>Quality Assurance Contract Expiration Date</b>                  12/31/2020  <b>Installation Instructions</b>  <a href="#">FL8228_R6_II_FL0162Dx.pdf</a>                  Verified By: National Accreditation &amp; Management Institute                  Created by Independent Third Party:  <b>Evaluation Reports</b>  <a href="#">FL8228_R6_AE_502A.pdf</a>                  Created by Independent Third Party: Yes</p>
<p>8228.12</p>	<p>Fiberglass Side-Hinged Door Unit</p>	<p>6'-8" Impact Glazed Outswing Single or Double Door w/ or w/o Sidelites</p>
<p><b>Limits of Use</b>  <b>Approved for use in HVHZ:</b> No  <b>Approved for use outside HVHZ:</b> Yes  <b>Impact Resistant:</b> Yes  <b>Design Pressure:</b> +55.0/-55.0  <b>Other:</b> Evaluated for use in locations adhering to the Florida Building Code not including the High Velocity Hurricane Zone, and where pressure requirements as determined by ASCE 7 do not exceed the design pressures listed. 12'-0" x 6'-8" max nominal size. See DWG-MA-FL0162-07 for additional information.</p>		<p><b>Certification Agency Certificate</b>  <a href="#">FL8228_R6_C_CAC_NI006900.05.pdf</a>  <b>Quality Assurance Contract Expiration Date</b>                  12/31/2020  <b>Installation Instructions</b>  <a href="#">FL8228_R6_II_FL0162Dx.pdf</a>                  Verified By: National Accreditation &amp; Management Institute                  Created by Independent Third Party:  <b>Evaluation Reports</b>  <a href="#">FL8228_R6_AE_502A.pdf</a>                  Created by Independent Third Party: Yes</p>
<p>8228.13</p>	<p>Fiberglass Side-Hinged Door Unit</p>	<p>8'-0" Impact Glazed Inswing Single or Double Door w/ or w/o Sidelites</p>
<p><b>Limits of Use</b>  <b>Approved for use in HVHZ:</b> No  <b>Approved for use outside HVHZ:</b> Yes  <b>Impact Resistant:</b> Yes  <b>Design Pressure:</b> +40.0/-45.0  <b>Other:</b> Evaluated for use in locations adhering to the Florida Building Code not including the High Velocity Hurricane Zone, and where pressure requirements as determined by ASCE 7 do not exceed the design pressures listed. 12'-0" x 8'-0" max nominal size. See DWG-MA-FL0163-07 for additional information.</p>		<p><b>Certification Agency Certificate</b>  <a href="#">FL8228_R6_C_CAC_NI006900.06.pdf</a>  <b>Quality Assurance Contract Expiration Date</b>                  12/31/2020  <b>Installation Instructions</b>  <a href="#">FL8228_R6_II_FL0163Dx.pdf</a>                  Verified By: National Accreditation &amp; Management Institute                  Created by Independent Third Party:  <b>Evaluation Reports</b>  <a href="#">FL8228_R6_AE_501A.pdf</a>                  Created by Independent Third Party: Yes</p>
<p>8228.14</p>	<p>Fiberglass Side-Hinged Door Unit</p>	<p>8'-0" Impact Glazed Outswing Single or Double Door w/ or w/o Sidelites</p>
<p><b>Limits of Use</b>  <b>Approved for use in HVHZ:</b> No  <b>Approved for use outside HVHZ:</b> Yes  <b>Impact Resistant:</b> Yes  <b>Design Pressure:</b> +43.0/-47.0  <b>Other:</b> Evaluated for use in locations adhering to the Florida Building Code not including the High Velocity Hurricane Zone, and where pressure requirements as determined by ASCE 7 do not exceed the design pressures listed. 12'-0" x 8'-0" max nominal size. See DWG-MA-FL0163-07 for additional information.</p>		<p><b>Certification Agency Certificate</b>  <a href="#">FL8228_R6_C_CAC_NI006900.06.pdf</a>  <b>Quality Assurance Contract Expiration Date</b>                  12/31/2020  <b>Installation Instructions</b>  <a href="#">FL8228_R6_II_FL0163Dx.pdf</a>                  Verified By: National Accreditation &amp; Management Institute                  Created by Independent Third Party:  <b>Evaluation Reports</b>  <a href="#">FL8228_R6_AE_501A.pdf</a>                  Created by Independent Third Party: Yes</p>

Back

Next

[Contact Us](#) :: [1940 North Monroe Street, Tallahassee FL 32399](#) Phone: 850-487-1824

The State of Florida is an AA/EEO employer. [Copyright 2007-2013 State of Florida](#). :: [Privacy Statement](#) :: [Accessibility Statement](#) :: [Refund Statement](#)

Under Florida law, email addresses are public records. If you do not want your e-mail address released in response to a public-records request, do not send electronic mail to this entity. Instead, contact the office by phone or by traditional mail. If you have any questions, please contact 850.487.1395. \*Pursuant to Section 455.275(1), Florida Statutes, effective October 1, 2012, licensees licensed under Chapter 455, F.S. must provide the Department with an email address if they have one. The emails provided may be used for official communication with the licensee. However email addresses are public record. If you do not wish to supply a personal address, please provide the Department with an email address which can be made available to the public. To determine if you are a licensee under Chapter 455, F.S., please click [here](#).

**Product Approval Accepts:**



Store: 1598 Date: 31/1/2015

Customer: Julia Salamat

Customer phone #: 321-888-9285

Installer: Brodt Home Installations, Inc.  
PO # 2843037

Measured by Zack  
C #407-462-0705  
Customer must be home for installation  
Customer to apply finish (paint / stain)



Verify swing w/customer  
Exterior - Note finish of jamb

Door units to measure - one door per row - All measurements must be in inches

Storm	Entry	Sidelight	Transom	Patio Swing	Patio Slider	Interior	Finishing or Slab	Location Comment	Rough Opening		Unit Size		
									Width	Height	Width	Height	
1	36"						PH	Front			37 1/2	81 1/2	49 1/16



**SIDE-HINGED FIBERGLASS DOOR UNIT  
6'-8" GLAZED DOUBLE DOOR WITH / WITHOUT SIDELITES**

**GENERAL NOTES**

- EVALUATED FOR USE IN LOCATIONS ADHERING TO THE FLORIDA BUILDING CODE AND WHERE PRESSURE REQUIREMENTS AS DETERMINED BY ASCE 7, MINIMUM DESIGN LOADS FOR BUILDINGS AND OTHER STRUCTURES, DOES NOT EXCEED THE DESIGN PRESSURES LISTED.
- WHEN INSTALLED IN THE HIGH VELOCITY HURRICANE ZONE (HVHZ), HURRICANE PROTECTIVE SYSTEM (SHUTTERS) IS REQUIRED.
- WHEN INSTALLED IN THE WIND-BORNE DEBRIS REGION, EXCLUDING THE HIGH VELOCITY HURRICANE ZONE (HVHZ), HURRICANE PROTECTIVE SYSTEM IS NOT REQUIRED ON PANELS WITH IMPACT GLASS, BUT IS REQUIRED ON PANELS WITH NON-IMPACT GLASS.
- POLYURETHANE CORE FLAME SPREAD INDEX OF 50 AND SMOKE DEVELOPED INDEX OF 60 PER ASTM E84. POLYSTYRENE CORE FLAME SPREAD INDEX OF 15 AND SMOKE DEVELOPED INDEX OF 115 PER ASTM E84.
- PLASTICS TESTING OF FIBERGLASS FACING:

TEST DESCRIPTION	DESIGNATION	RESULT
SELF IGNITION TEMP	ASTM D1929	752 °F > 650 °F
RATE OF BURNING	ASTM D635	0.56 IN/MIN
SMOKE DENSITY	ASTM D2843	53.4%
TENSILE STRENGTH*	ASTM D638	3.2% DIFF

- PLASTICS TESTING OF LITE FRAME MATERIAL:

TEST DESCRIPTION	DESIGNATION	RESULT
SELF IGNITION TEMP	ASTM D1929	740 °F > 650 °F
RATE OF BURNING	ASTM D635	0.77 IN/MIN
SMOKE DENSITY	ASTM D2843	13.4%
TENSILE STRENGTH*	ASTM D638	-7.50% DIFF

\* COMPARATIVE TENSILE STRENGTH AFTER WEATHERING  
4500 HOURS XENON ARC METHOD 1

- IMPACT GLAZING LAMINATE MIAMI DADE BCCO NOA 09-0127.13.

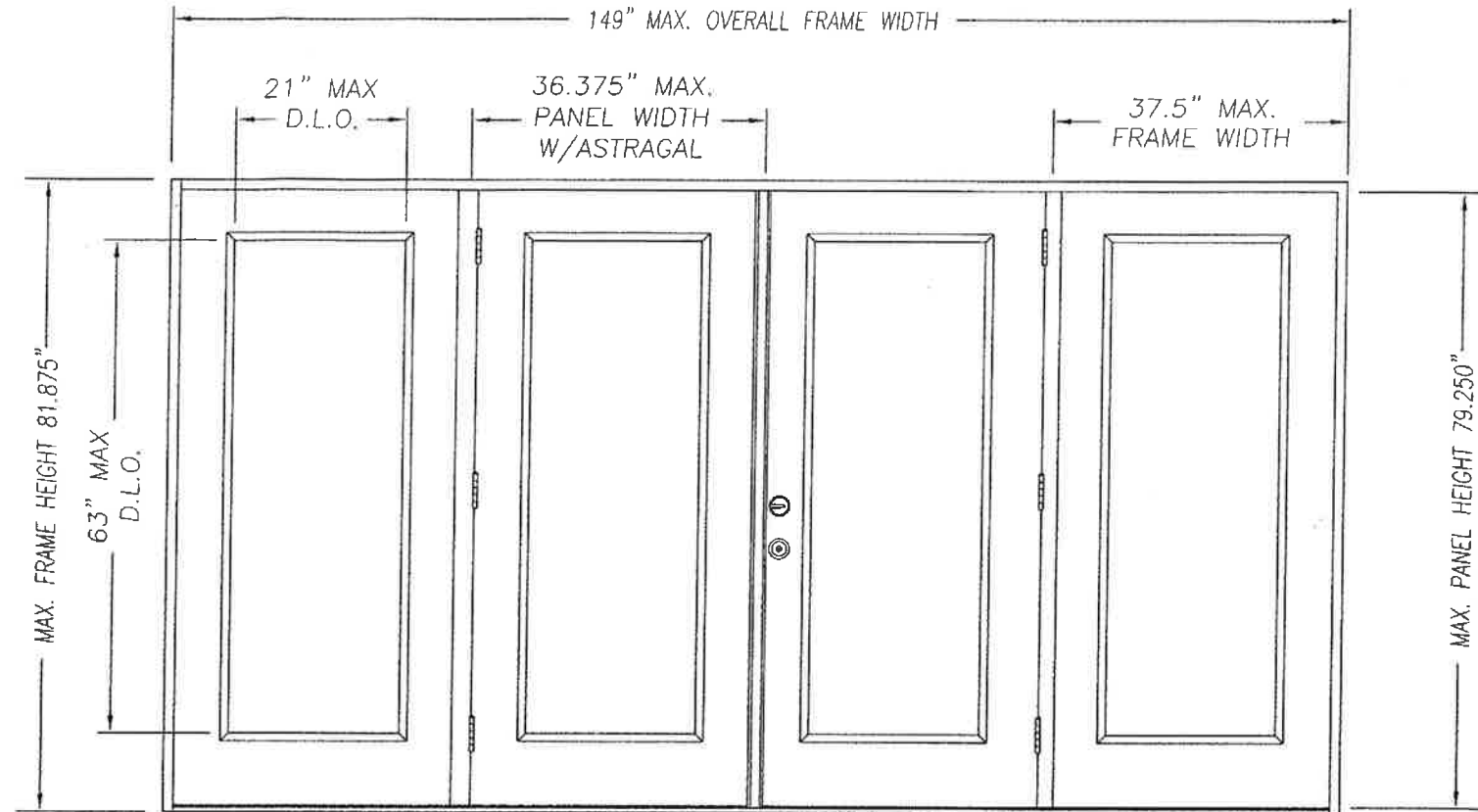

**DOUBLE DOOR UNIT W/SIDELITES**

Addendum to NAMI

Certification No.: N1006900-121  
Reviewed By: [Signature]  
Date Reviewed: 9/7/11

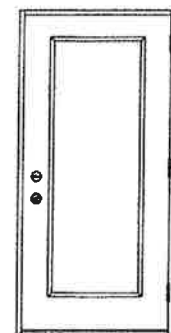

**SINGLE DOOR UNIT**

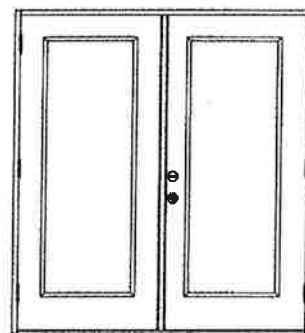

**DOUBLE DOOR UNIT**

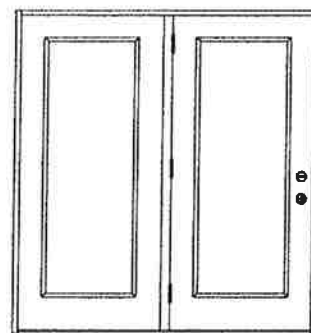

**SINGLE DOOR UNIT WITH SIDELITE**

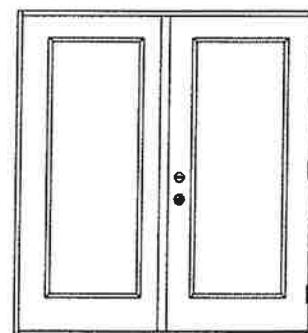

**SINGLE DOOR UNIT WITH SIDELITE**

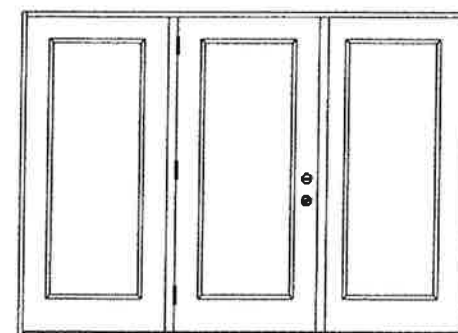

**SINGLE DOOR UNIT W/SIDELITES**

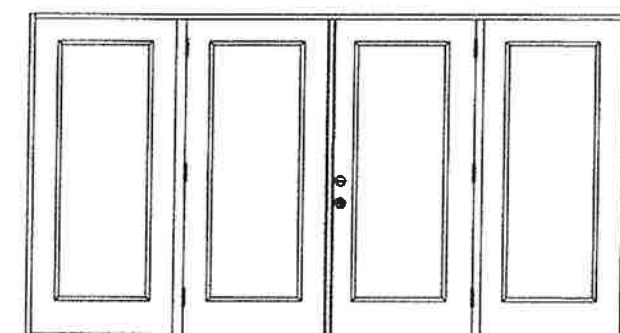

**DOUBLE DOOR UNIT W/SIDELITES**

TABLE OF CONTENTS	
SHEET #	DESCRIPTION
1	TYPICAL ELEVATIONS & GENERAL NOTES
2	ANCHORING LOCATIONS & DETAILS
3	ANCHORING LOCATIONS & DETAILS

CONFIG	MAX WIDTH	DESIGN PRESSURE RATING		WHERE WATER INFILTRATION PERFORMANCE IS REQUIRED TO BE 15% OF DESIGN PRESSURE		
		INSWING	OUTSWING	INSWING	OUTSWING	OUTSWING*
X	37.5"	+52.0 / -52.0	+55.0 / -55.0	+19.0 / -19.0	+40.0 / -40.0	+55.0 / -55.0
XX	74"	+52.0 / -52.0	+55.0 / -55.0	+19.0 / -19.0	+40.0 / -40.0	+55.0 / -55.0
OX or XO	75"	+52.0 / -52.0	+55.0 / -55.0	+19.0 / -19.0	+40.0 / -40.0	+55.0 / -55.0
OXO	112.5"	+52.0 / -52.0	+55.0 / -55.0	+19.0 / -19.0	+40.0 / -40.0	+55.0 / -55.0
OXXO	149"	+52.0 / -52.0	+55.0 / -55.0	+19.0 / -19.0	+40.0 / -40.0	+55.0 / -55.0

\* High Dam Threshold Design

*Kurt Balthazor*

KURT BALTHAZOR  
FLORIDA P.E.  
#56533

NO.	DATE	REVISIONS			
		DETAIL CLARIFICATION	MISC UPDATES	HINGE SCREW LENGTH	UPDATED DP RATINGS
D	9/7/11	SWS	SWS	SWS	SWS
C	11/2/10	SWS	SWS	SWS	SWS
B	1/2/08	SWS	SWS	SWS	SWS
A	4/9/07	SWS	SWS	SWS	SWS
		BY			

DATE:	1/5/07
SCALE:	N.T.S.
DWG. BY:	SWS
CHK. BY:	
DRAWING NO.:	
DWG-MA-FL0162-07	
SHEET	1 OF 3

PRODUCT: "EXTERIOR DOOR PRODUCT"  
DOUBLE 6'8" GLAZED FIBERGLASS DOOR  
PART OR ASSEMBLY:  
TYPICAL ELEVATIONS & GENERAL NOTES

MASONITE INTERNATIONAL CORP.  
1955 POWIS ROAD  
WEST CHICAGO, IL 60185

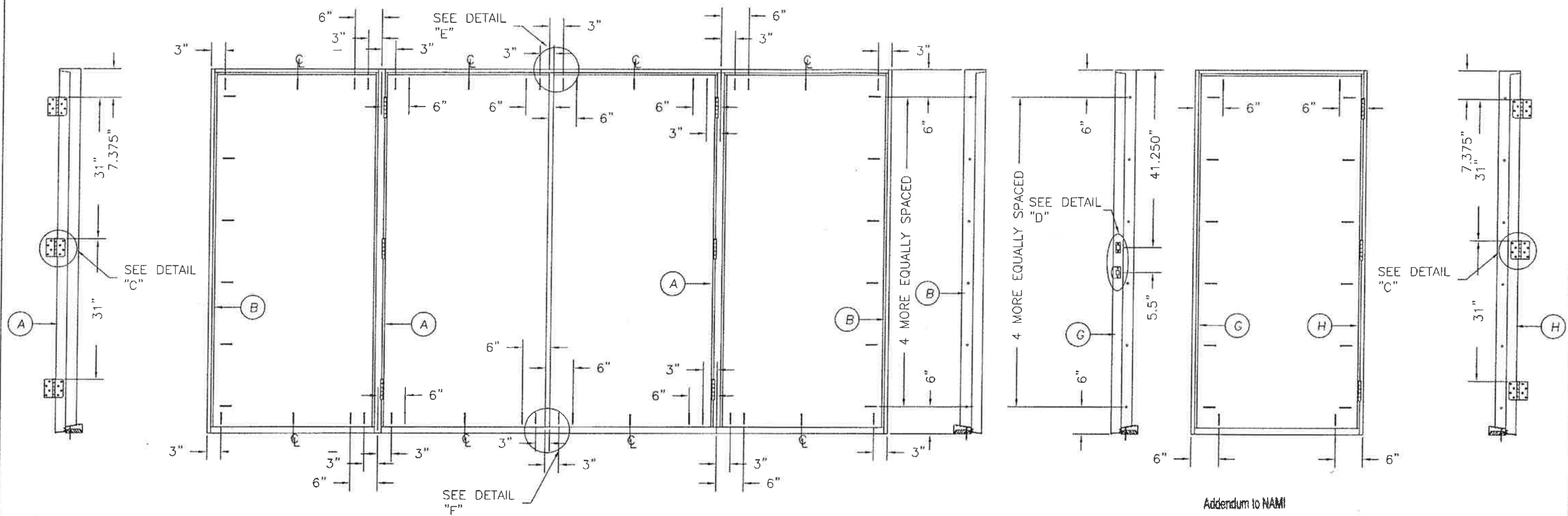

MASONITE INTERNATIONAL CORP.  
 1955 POWIS ROAD  
 WEST CHICAGO, IL 60185

PRODUCT: "EXTERIOR DOOR PRODUCT"  
 6"-8" FIBERGLASS GLAZED  
 DOUBLE DOOR UNIT  
 PART OR ASSEMBLY:  
 ANCHORING LOCATIONS  
 & DETAILS

Addendum to NAMI  
 Certification No.: N1006900-121  
 Reviewed By: [Signature]  
 Date Reviewed: 10/22/11

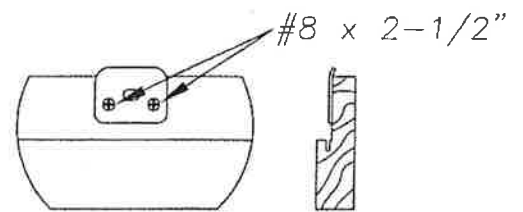
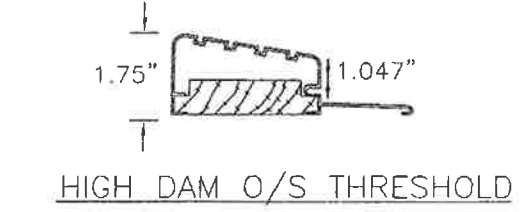
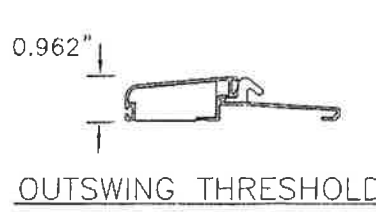
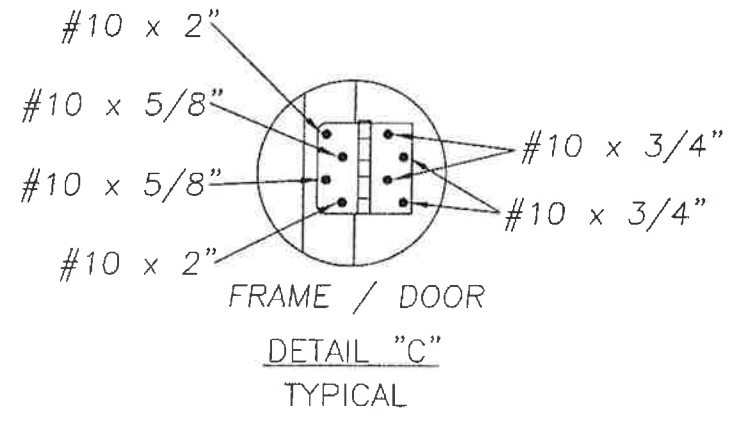
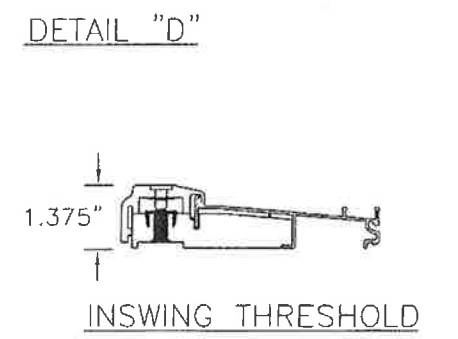
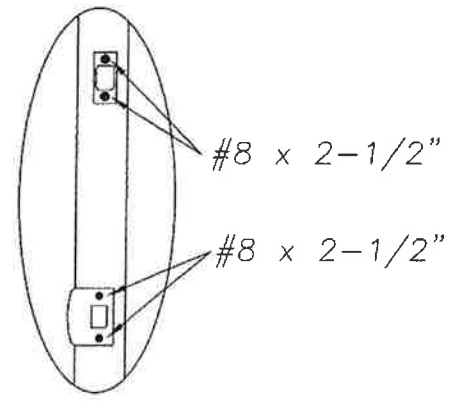

DETAIL "E" ASTRAGAL  
 ATTACH ASTRAGAL RETAINER BOLT  
 STRIKE PLATE TO FRAME  
 AS SHOWN.

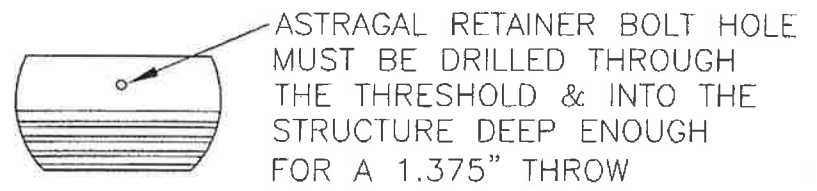

DETAIL "F" ASTRAGAL

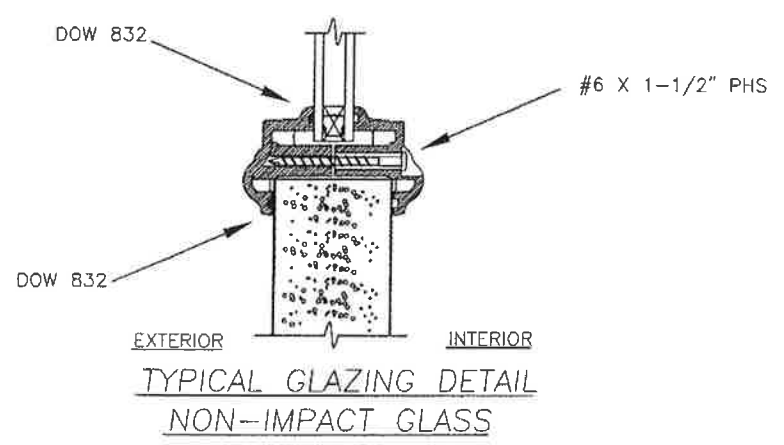
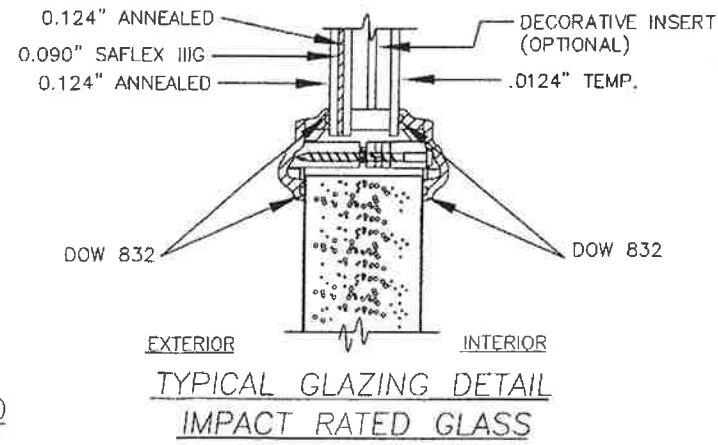

NO.	DATE	REVISIONS		
		BY	DATE	DESCRIPTION
D	9/7/11	SWS		DETAIL CLARIFICATION
C	11/2/10	SWS		MISC UPDATES
B	1/2/08	SWS		HINGE SCREW LENGTH
A	4/9/07	SWS		UPDATED DP RATINGS

DATE: 1/5/07  
 SCALE: N.T.S.  
 DWG. BY: SWS  
 CHK. BY:  
 DRAWING NO.: DWG-MA-FL0162-07  
 SHEET 2 OF 3

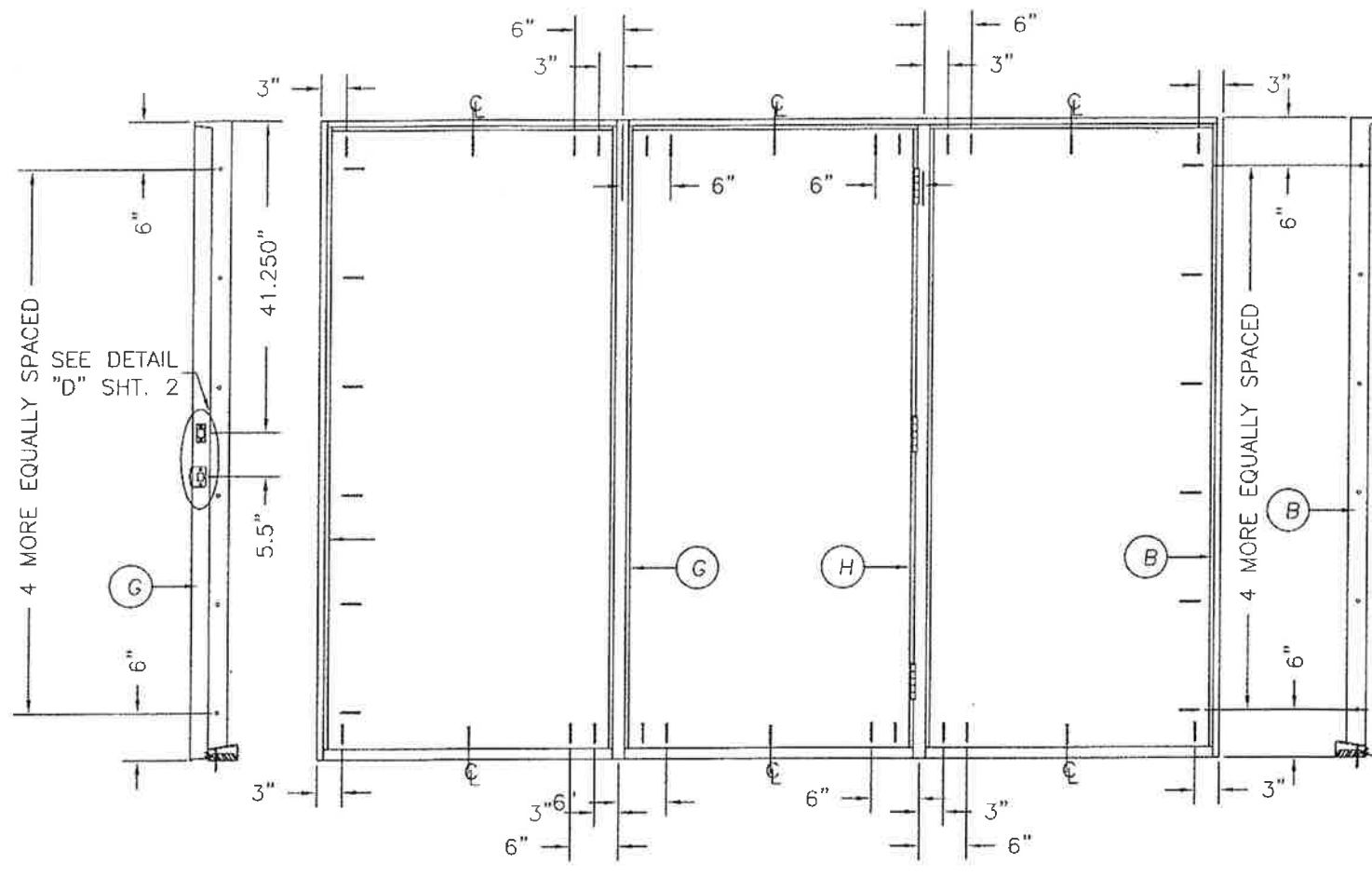
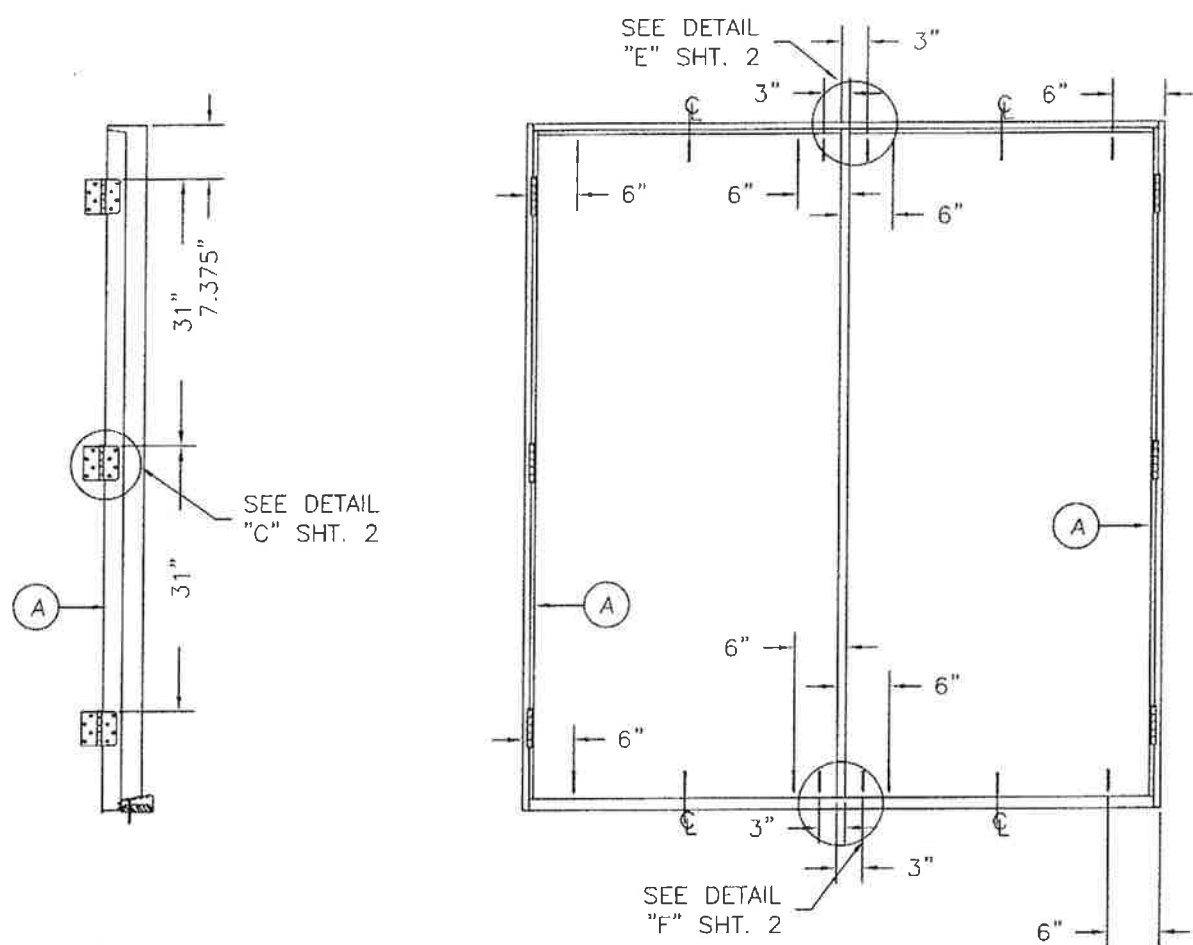

ATTACHMENT DETAIL

1. ANCHOR ANALYSIS FOR LOADING CONDITIONS PREPARED, SIGNED AND SEALED BY LUIS R. LOMAS, PE (FLORIDA #62514) WITH THE LOWEST (LEAST) FASTENER RATING FROM THE DIFFERENT FASTENERS BEING CONSIDERED FOR USE. JAMB, HEAD, AND THRESHOLD FASTENERS ANALYZED FOR THIS UNIT INCLUDE #10 WOOD SCREWS OR 3/16" TAPCONS. A PHYSICAL SHIM MUST BE PLACED IN SHIM SPACE AT EACH ANCHOR LOCATION. TAPCON EDGE DISTANCE MIN 2-5/8".
2. MULLIONS TO BE 2-1/2" X 4-3/8" STRUCTURAL GRADE FJ PINE ON CONTINUOUS HEAD AND SILL UNITS. BACK TO BACK JAMB UNITS JOINED WITH 1" X 1/2" LONG CORRUGATED FASTENERS LOCATED 3" FROM EACH END AND MAXIMUM 7" O.C. OR #10 X 2" FLAT HEAD WOOD SCREWS LOCATED 6" FROM EACH END AND MAXIMUM 12" O.C.
3. THE WOOD SCREW SINGLE SHEAR DESIGN VALUES COME FROM ANSI/AF&PA NDA FOR SOUTHERN PINE LUMBER AND ACHIEVEMENT OF 1-1/2" MINIMUM EMBEDMENT. THE TAPCON MUST ACHIEVE MINIMUM EMBEDMENT OF 1-1/4".
4. WOOD BUCKS BY OTHERS MUST BE ANCHORED PROPERLY TO TRANSFER LOADS TO STRUCTURE.
5. MINIMUM DESIGN VALUE STRENGTH OF ANCHORS 171 LBS.

HARDWARE SCHEDULE

1.	KWIKSET SERIES 400 GRADE 3 CYLINDRICAL LATCH AND SERIES 980 GRADE 1 DEADLOCK HARDWARE TO BE INSTALLED AT 5-1/2" CENTERLINE.
2.	4" X 4" FULL MORTISE BUTT HINGES.

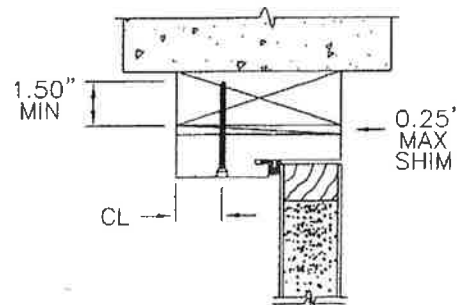

TYPICAL WOOD BUCK ANCHOR INSTALLATION

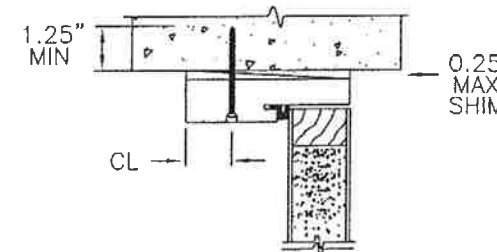

TYPICAL MASONRY ANCHOR INSTALLATION

Addendum to NAMI  
 Certification No.: N1006909-121  
 Reviewed By: [Signature]  
 Date Reviewed: 10/22/11

PRODUCT: "EXTERIOR DOOR PRODUCT"  
 6'-8" FIBERGLASS GLAZED  
 DOUBLE DOOR UNIT  
 PART OR ASSEMBLY:  
 ANCHORING LOCATIONS  
 & DETAILS

NO.	DATE	REVISIONS	
		BY	
D	9/7/11	DETAIL CLARIFICATION	SWS
C	11/2/10	MISC UPDATES	SWS
B	1/2/08	HINGE SCREW LENGTH	SWS
A	4/9/07	UPDATED DP RATINGS	SWS

DATE: 1/5/07  
 SCALE: N.T.S.  
 DWG. BY: SWS  
 CHK. BY:  
 DRAWING NO.:  
 DWG-MA-FL0162-07  
 SHEET 3 OF 3



**STATE OF FLORIDA  
DEPARTMENT OF BUSINESS AND PROFESSIONAL REGULATION**

**CONSTRUCTION INDUSTRY LICENSING BOARD  
1940 NORTH MONROE STREET  
TALLAHASSEE FL 32399-0783**

**(850) 487-1395**

**CAFARO, PETER ANTHONY III  
LOWE'S HOME CENTERS, LLC  
PO BOX 781993  
ORLANDO FL 32878-1993**

**Congratulations! With this license you become one of the nearly one million Floridians licensed by the Department of Business and Professional Regulation. Our professionals and businesses range from architects to yacht brokers, from boxers to barbeque restaurants, and they keep Florida's economy strong.**

**Every day we work to improve the way we do business in order to serve you better. For information about our services, please log onto [www.myfloridalicense.com](http://www.myfloridalicense.com). There you can find more information about our divisions and the regulations that impact you, subscribe to department newsletters and learn more about the Department's initiatives.**

**Our mission at the Department is: License Efficiently, Regulate Fairly. We constantly strive to serve you better so that you can serve your customers. Thank you for doing business in Florida, and congratulations on your new license!**



**STATE OF FLORIDA  
DEPARTMENT OF BUSINESS AND  
PROFESSIONAL REGULATION**

**CGC1508417 ISSUED: 08/03/2014**

**CERTIFIED GENERAL CONTRACTOR  
CAFARO, PETER ANTHONY III  
LOWE'S HOME CENTERS, LLC**

**IS CERTIFIED under the provisions of Ch. 489 FS.  
Expiration date : AUG 31, 2016 L1408030003362**

**DETACH HERE**

**RICK SCOTT, GOVERNOR**

**KEN LAWSON, SECRETARY**

**STATE OF FLORIDA  
DEPARTMENT OF BUSINESS AND PROFESSIONAL REGULATION  
CONSTRUCTION INDUSTRY LICENSING BOARD**

<b>LICENSE NUMBER</b>	
CGC1508417	

**The GENERAL CONTRACTOR  
Named below IS CERTIFIED  
Under the provisions of Chapter 489 FS.  
Expiration date: AUG 31, 2016**



**CAFARO, PETER ANTHONY III  
LOWE'S HOME CENTERS, LLC  
1605 CURTIS BRIDGE RD  
WILKESBORO NC 28697**



**ISSUED: 08/03/2014**

**DISPLAY AS REQUIRED BY LAW**

**SEQ # L1408030003362**



**Cott Randolph, Tax Collector      Local Business Tax Receipt      Orange County, Florida**

is local business tax receipt is in addition to and not in lieu of any other tax required by law or municipal ordinance. Businesses are subject to regulation of zoning, health and other vital authorities. This receipt is valid from October 1 through September 30 of receipt year. Delinquent penalty is added October 1.

1801	CERTIFIED GENERAL C	2014	EXPIRES	9/30/2015	1801-0590711		
1806	CERTIFIED ROOFING CO	\$30.00	2 EMPLOYEES	5000	BUSINESS OFFICE	\$30.00	2 EMPLOYEES

TOTAL TAX \$90.00  
PREVIOUSLY PAID \$90.00  
TOTAL DUE \$0.00

12200 LAKE UNDERHILL RD  
U - ORLANDO, 32825  
CAFARO PETER ANTHONY III  
PAID: \$90.00 2504-00588732 8/25/2014



CAFARO PETER ANTHONY III QUALIFIER  
LOWES HOME CENTERS LLC  
CAFARO PETER ANTHONY III  
P O BOX 781993  
ORLANDO FL 32878

This receipt is official when validated by the Tax Collector.



April 14, 2015

Ms. Susan Manchester  
Universal Engineering Sciences, Inc.  
3532 Maggie Blvd.  
Orlando, FL 32811

Via Email: [SManchester@universalengineering.com](mailto:SManchester@universalengineering.com)

Re: Lowe's Home Centers, LLC Competency License Florida General Contractor's License # CGC1508417,  
Peter Anthony Cafaro, III, Certified General Contractor.  
Florida Contractor's License # CCC1326824, Peter Anthony Cafaro, III, Certified Roofing Contractor.

Dear Sir/Madam:

This letter will confirm that Lowe's Home Centers, LLC (a wholly owned subsidiary of Lowe's Companies, Inc. (hereinafter "Lowe's")) intends to satisfy the general liability insurance requirement through a program of self-insurance. Lowe's self insures for each general liability claim in an amount up to and including \$5,000,000 which is the attachment point for Lowe's excess liability policy which is written through Steadfast Insurance Company as evidenced on our certificate of insurance. Lowe's Companies, LLC maintains reserves to support this program of self insurance based on a review (performed at least annually) by a certified casualty actuary.

Lowe's Companies, Inc. is a Fortune 50 company and operates more than 1,750 stores in the US, Canada and Mexico. Lowe's sales in 2014 were in excess of \$53 billion. You may access Lowe's financial information at [www.lowes.com](http://www.lowes.com).

Please feel free to contact me at (704) 758-3123 or [Shonna.M.Splain@lowes.com](mailto:Shonna.M.Splain@lowes.com) if you have any questions.

Very truly yours,

A handwritten signature in black ink that reads "Shonna Splain".

Shonna Splain  
Insurance & Risk Administrator  
Risk Management Dept