

# City of Belle Isle

Universal Engineering Sciences 3532 Maggie Blvd., Orlando, FL 32811  
 Tel 407-581-8161 \* Fax 407-581-0313 \* [www.universalengineering.com](http://www.universalengineering.com)

## PERMIT CARD – PLEASE POST AT JOB SITE

THIS DOCUMENT BECOMES YOUR PERMIT WHEN PROPERLY VALIDATED

Per FBC 105.3.3: An enforcing authority may not issue a building permit for any building construction, erection, alteration, modification, repair or addition unless the permit either includes on its face or there is attached to the permit the following statement: "NOTICE: In addition to the requirements of this permit, there may be additional restrictions applicable to this property that may be found in the public records of this county, and there may be additional permits required from other governmental entities such as water management districts, state agencies, or federal agencies." The issuance of this permit does not grant permission to violate any applicable City, Orange County, State of Florida and/or Federal codes and/or ordinances. Separate permits are required for Signs, Roofing, Electrical, Gas, Plumbing and Mechanical services. This permit becomes VOID if the work authorized is not commenced within 6 months, or is suspended or abandoned for a period of 6 months after commencement. **WORK SHALL BE CONSIDERED SUSPENDED IF AN APPROVED INSPECTION HAS NOT BEEN MADE WITHIN A 6 MONTH PERIOD. PERMISSION IS GRANTED TO DO THE FOLLOWING WORK ACCORDING TO THE CONDITIONS HEREON AND THE APPROVED PLANS AND SPECIFICATIONS, SUBJECT TO COMPLIANCE WITH THE ORDINANCES OF THE CITY OF BELLE ISLE, FLORIDA.**

**Scope of Work:** WINDOWS: 7, size for size  
**Comments:** None  
**Project Information**  
 Address: 2727 Nela Avenue, Belle Isle, FL 32809  
 Parcel ID: 19-23-30-5892-00-040  
 Property Owner: Johnson, Leslie  
 Phone Number: 407-222-8779  
 \*\*\*\*\*  
 Company Name: FASWD, LLC dba FAS Windows & Doors  
 Contractor Name: Varga, Scott  
 License Number: CGC1518212  
 Address: 3020 Mercy Drive, Orlando, FL32808  
 Phone Number: 407-489-8683

**Permit Number: 2014-06-011**

**Date of Application: 06/04/2014**  
**Date Permit Issued: 06/04/2014**

**WARNING TO OWNER:** "YOUR FAILURE TO RECORD A NOTICE OF COMMENCEMENT MAY RESULT IN YOU PAYING TWICE FOR IMPROVEMENTS TO YOUR PROPERTY. IF YOU INTEND TO OBTAIN FINANCING, CONSULT WITH YOUR LENDER OR AN ATTORNEY BEFORE RECORDING YOUR NOTICE OF COMMENCEMENT." ON THE JOB INSPECTION(S) MUST BE MADE BEFORE PROCEEDING WITH SUBSEQUENT WORK. THIS CARD MUST BE DISPLAYED OUTSIDE AND BE PROTECTED FROM THE WEATHER WHILE BEING VISIBLE FROM THE STREET UNTIL THE FINAL INSPECTIONS HAVE BEEN APPROVED.

### BUILDING FEATURES

#### IMPACT FEES

School \$  
 Traffic \$

#### ZONING FEES

Zoning Fee \$

#### UNIVERSAL ENG - BUILDING FEES

Cert of Occ \$  
 Demo \$  
 Building \$  
 Fence \$  
 Driveway \$  
 Shed \$  
 Window(s) \$61.50  
 Door(s) \$  
 PrePower \$  
 Electrical \$  
 Temp Pole \$  
 Plumbing \$  
 Mechanical \$  
 Gas \$  
 Roofing \$  
 Boat Dock \$  
 Screen Encl \$  
 Swimming Pool \$  
 Sign \$

#### SURCHARGE FEES

Surcharge Fee \$2.00  
 Surcharge Fee \$2.00

**TOTAL FEES \$65.50**

Date Paid 6-4-14

CC or Check # VIA 4147

Amount Paid 65.50

The person accepting this permit shall conform to the terms of the application on file and construction shall conform to the requirements of the Florida Building Code (FS 553).

#### BUILDING INSPECTOR USE ONLY

IF APPLICABLE:

Have Zoning Approval Conditions Been Met? YES NO Have Stormwater Approval Conditions Been Met? YES NO Silt fencing in place? YES NO Turbidity Barrier in place? YES NO

#### BUILDING

1<sup>st</sup> \_\_\_\_\_ (Footing/Foundation)  
 Survey specific foundation plan must be onsite before slab pour. Approved Plan on Site? \_\_\_\_  
 2<sup>nd</sup> \_\_\_\_\_ (Slab)  
 3<sup>rd</sup> \_\_\_\_\_ (Lintel)(Wall Reinforcing on Masonry Building)  
 4<sup>th</sup> \_\_\_\_\_ (Exterior Framing)(Roof/Wall Sheathing)  
 5<sup>th</sup> \_\_\_\_\_ (Framing) (To be made after Plumbing/ Mechanical/ Electrical Rough-Ins & Windows/Doors Installed)  
 6<sup>th</sup> \_\_\_\_\_ (Insulation to be Made After Roof Installed)  
 7<sup>th</sup> \_\_\_\_\_ (Drywall)  
 8<sup>th</sup> \_\_\_\_\_ (Sidewalk/Driveway)  
 9<sup>th</sup> \_\_\_\_\_ (Other)  
 10<sup>th</sup> \_\_\_\_\_ (Final – After MEP and Other Applicable Finals)

#### ROOFING

1<sup>ST</sup> ROOFING Deck Nailing/Dry-in/Flashing \_\_\_\_\_  
 2<sup>nd</sup> ROOFING Covering In-Progress \_\_\_\_\_  
 3<sup>rd</sup> ROOFING Covering Final \_\_\_\_\_

#### PLUMBING (Pool-Piping, Solar, Irrigation, Water Treatment Equip, Etc...)

1<sup>ST</sup> \_\_\_\_\_ (Underground) 2<sup>nd</sup> \_\_\_\_\_ (Sewer)  
 3<sup>rd</sup> \_\_\_\_\_ (Rough-In/Tub Set) 4<sup>th</sup> \_\_\_\_\_ (Final)

#### CHECK APPROPRIATE BOX

GAS  Natural  LP  MECHANICAL  ELECTRICAL  LOW VOLTAGE

1<sup>st</sup> \_\_\_\_\_ (Rough-In) 2<sup>nd</sup> \_\_\_\_\_ (Final)

Inspection requests are to be emailed to [BI scheduling@UniversalEngineering.com](mailto:BI scheduling@UniversalEngineering.com); a confirmation email will be sent back to you upon scheduling. **Next-Day Inspection requests must be made by 1pm.** Please include the following in your request: Permit #, project address, type of inspection, date of the requested inspection, a contact name & a contact phone number. AM or PM may be requested but cannot be guaranteed.

For a copy of your permit, or to check inspection results, please visit <https://universalengineering.sharefile.com/f/fo94edc4-832d-44bd-9809-ecf32f9e2e63>

login ID = [cobi@universalengineering.com](mailto:cobi@universalengineering.com)

password = universal13



**City of Belle Isle**  
 1600 Nela Avenue, Belle Isle, FL 32809  
 Tel 407-851-7730 \* Fax 407-240-2222 \* [www.cityofbelleislefl.org](http://www.cityofbelleislefl.org)  
**APPLICATION FOR LAND USE/BLDG PERMIT**  
 ALL APPLICATIONS MUST COMPLY WITH  
 CONCURRENCY REQUIREMENTS\*

**received**  
 6-4-14

DATE: 5-31-14 PERMIT # 2014-06011  
 PROJECT ADDRESS 2727 NELA AVENUE, Belle Isle, FL 32809 32812  
 PROPERTY OWNER LESLIE JOHNSON PHONE 407-222-8779  
 OWNER'S ADDRESS 2727 NELA AVENUE  
 CONTRACTOR FASWD, LLC LICENSE NO. 6061518212 PHONE 407-489-8683  
 ARCHITECT Ala LICENSE NO. \_\_\_\_\_ PHONE \_\_\_\_\_  
 CIVIL ENGINEER Ala LICENSE NO. \_\_\_\_\_ PHONE \_\_\_\_\_  
 NATURE OF PROPOSED IMPROVEMENTS Replace 7 size for size windows  
 DEMOLITION PERMIT NUMBER \_\_\_\_\_

**Please fill out for City of Belle Isle Zoning Review**  
 PARCEL TAX I.D. NUMBER SEC 19-23-30-5892-06-040  
 LEGAL DESCRIPTION LOT 4 BLOCK \_\_\_\_\_ SUBDIVISION Nela Isle  
 ZONING CLASS \_\_\_\_\_ HEIGHT LIMIT \_\_\_\_\_ NO. OF PARKING SPACES \_\_\_\_\_ ZONING TECH \_\_\_\_\_  
 FLOOD PERMIT NO. \_\_\_\_\_ F.L.U. DESIGNATION \_\_\_\_\_ SIDEWALKS REQ'D \_\_\_\_\_ PAVED DRIVE REQ'D \_\_\_\_\_  
 SETBACKS: FRONT \_\_\_\_\_ REAR \_\_\_\_\_ SIDE \_\_\_\_\_ SIDE \_\_\_\_\_

**SPECIAL CONDITIONS: STRUCTURES MAY NOT ENCROACH INTO ANY EASEMENT OR REQUIRED SETBACK.**  
 Attached Survey \_\_\_\_\_ SETS and Construction Plans \_\_\_\_\_ SETS  
 Note, this Zoning Approval MAY or MAY NOT be in conflict with your Deed Restrictions. For New Single Family Resident Application a \$1,430 Traffic Impact Fee will be assessed.  
 PLANNING & ZONING APPROVAL: \_\_\_\_\_ DATE \_\_\_\_\_

**Please fill out for Building Review**  
 NATURE OF WORK \_\_\_\_\_ CONSTRUCTION TYPE \_\_\_\_\_ TYPE OF STRUCTURE \_\_\_\_\_  
 OWNER EST VALUE \$ 4241.00 BLDG. DEPT. VALUE \$ \_\_\_\_\_  
 OCCUPANCY GROUP \_\_\_\_\_ #BLDG. \_\_\_\_\_ #UNITS \_\_\_\_\_ #STORIES \_\_\_\_\_  
 TOTAL SQ.FT. \_\_\_\_\_ SQUARE FEET/FLOOR \_\_\_\_\_  
 MAX. FLOOR LOAD \_\_\_\_\_ MAX. OCCUPANCY \_\_\_\_\_  
 MIN. FLOOD ELEV. \_\_\_\_\_ SEER \_\_\_\_\_  
 LOW FLOOR ELEV. \_\_\_\_\_ WATER SERVICE \_\_\_\_\_  
 SUBMITTAL FEE \$ \_\_\_\_\_ COP \_\_\_\_\_  
 RECEIPT # \_\_\_\_\_ AUTHORIZATION # \_\_\_\_\_  
 REG. PERMIT FEE \$ \_\_\_\_\_ IMPACT - SCHOOL \$ \_\_\_\_\_  
 BLDG. PERMIT SURCHARGE \$ \_\_\_\_\_  
 OPERATING TRUST FUND SURCHARGE \$ \_\_\_\_\_  
 VIOLATION \$ \_\_\_\_\_ OTHER FEES \$ \_\_\_\_\_

SPRINKLERS REQ'D	Y	N	_____
C/O REQUIRED	Y	N	_____
GOVT. OWNED	Y	N	_____
THRESH INSP. REQ'D	Y	N	_____
PLAN (FORMAT?)	Y	N	_____
OTHER PERMITS REQUIRED	Y	N	_____
ELECTRICAL	Y	N	_____
MECHANICAL	Y	N	_____
PLUMBING	Y	N	_____
ROOFING	Y	N	_____
GAS	Y	N	_____
HOLD C/O	Y	N	REV.FEE
ZONING	Y	N	\$ _____
ENGINEERING	Y	N	\$ _____
FIRE LOSS MGT.	Y	N	\$ _____
PUBLIC UTILITY	Y	N	\$ _____
ENVIRO. PROT.	Y	N	\$ _____
PLANNING	Y	N	\$ _____
HEALTH	Y	N	\$ _____
BUILDING	Y	N	\$ _____
FINANCE	Y	N	\$ _____
STORMWATER	Y	N	\$ _____

**BUILDING REVIEWER** \_\_\_\_\_  
 Waste Management is by legal contract the sole authorized provider of garbage, recycling, yard waste, and commercial garbage and construction debris collection and disposal services with the city limits of the City of Belle Isle. Contractors, homeowners and commercial businesses may contact Waste Management at 407-788-0800 to setup accounts for Commercial, Construction Roll Off, or other services needed. Rates are fixed by contract and are available at City Hall or from Waste Management. The City enforces the contract through its code enforcement office. Failure to comply will result in a stop work order.

41<sup>00</sup> + 20.50  
 + 4<sup>00</sup>  
 -----  
 45.50  
 45.50

I hereby make Application for Permit as outlined above, and if same is granted I agree to conform to all Division of Building Safety Regulations and City Ordinances regulating same and in accordance with plans submitted. The issuance of this permit does not grant permission to violate any applicable City and/or State of Florida codes and/or ordinances.  
 Personally appeared Jennifer A. Rupert who on oath says, that he/she is the applicant for the foregoing, that all the above statements are true to the best of his/her knowledge, and that the work to be done is authorized by the owner and will be done by contract with \_\_\_\_\_ Contractor/Owner.  
 SIGNATURE Jennifer Rupert ADDRESS 3020 Mercy Dr.  
 SWORN TO AND SUBSCRIBED BEFORE ME THIS 30 DAY OF May, 20 14  
 \_\_\_\_\_ NOTARY PUBLIC, ORANGE COUNTY, FLORIDA

**JEANA YOUNG** Notary Public  
 MY COMMISSION # EE084507  
 EXPIRES June 16, 2015  
 (407) 398-0153 FloridaNotaryService.com

**RETAIN A COPY FOR OFFICE USE AND RETURN ORIGINAL TO APPLICANT**  
 out FORM 003 Building Permit Application - Required by State Section 713  
**THE ORIGINAL IS A GREEN FORM - FORM #LANDUSE002**

licenses +  
 ins on file  
 cq 6/4/14

Permit Application

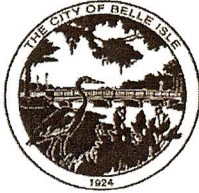

City of Belle Isle

1600 Nela Avenue, Belle Isle, FL 32809

Tel 407-851-7730 \* Fax 407-240-2222 \* www.cityofbelleislefl.org

Building Permit Application Information

To be completed as required by

State Statute Section 713 and other applicable sections.

3049219

Owner's Name: LESLIE JOHNSON
Owner's Address: 2727 NELA AVENUE, BELLE ISLE, FL 32809
Contractor's Name: FASWD, LLC
Contractor's Address: 3020 Mercy Drive, Orlando, FL 32808

Application is hereby made to obtain a permit to do the work and installations as indicated. I certify that no work or installation has commenced prior to the issuance of a permit...

WARNING TO OWNER: Your failure to record a Notice of Commencement may result in your paying twice for improvements to your property.

Owner Signature: [Signature]
The foregoing instrument was acknowledged before me this 4/18/14 by LESLIE JOHNSON...

Contractor Signature: [Signature]
The foregoing instrument was acknowledged before me this 5/30/14 by Scott A. Varga...

Notary as to Owner: [Signature]
Commission No. [Blank]

Notary as to Owner: [Signature]
Commission No. [Blank]

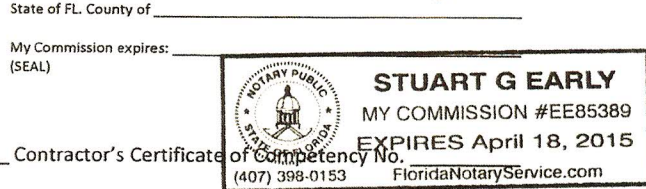
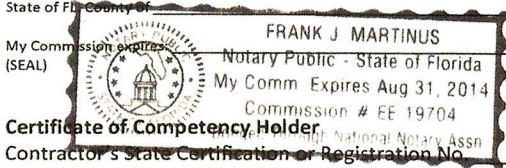

Application Approved by \_\_\_\_\_

RETAIN A COPY FOR OFFICE USE AND RETURN ORIGINAL TO APPLICANT
THE ORIGINAL IS A WHITE FORM - FORM # BLDG003

**LIMITED POWER OF ATTORNEY**

Date: 5-29-14

I hereby name and appoint Jeana Young & Jennifer Ripert to be my lawful attorney in fact to act for me and apply for a Building permit for work to be performed at the location described as:

2727 Nela Ave Belle Isle  
(Address of Job)

Leslie Johnson & Susan Turner Trust  
(Owner of Property)

And to sign my name and do all things necessary to this appointment.

[Signature]  
(Signature of Certified Contractor)

Scott A. Varga (CGC1518212)  
(Printed Name of Contractor and License Number)

STATE OF FLORIDA  
COUNTY OF Orange

The foregoing instrument was acknowledged before me this 29 day of May, 20 14, by Scott A. Varga, who is  personally known to me or has  produced \_\_\_\_\_ (type of identification) as identification.

Signature of Notary Public, State of Florida

Terence G. Muldoon II  
Print/Type/Stamp Name of Notary Public



Prepared By: J. P. Pugh  
Return to: FASWD, LLC  
3020 Mercy Dr. Orlando, FL 32808

DOCH 20140248289 B: 10746 P: 9399  
05/20/2014 11:43:22 AM Page 1 of 1  
Rec Fee: \$10.00  
Martha O. Haynie, Comptroller  
Orange County, FL  
PU - Ret To: FAS WINDOWS & DOORS LLC

NOTICE OF COMMENCEMENT



State of Florida  
County of ORANGE  
Parcel ID: 19-23-30-5892-00-040 Permit #: \_\_\_\_\_

The undersigned hereby gives notice that improvement will be made to certain real property. In accordance with Chapter 713, Florida Statutes, the following information is provided in the Notice of Commencement:

1. Legal description of Property (and street address if available): LOT 4 & W 2 SFF LOTS 3 Land on N to Lake Nela Isle Annex R/74
2. General description of improvement: 2727 NELA AVENUE window replacement
- 3 a. Owner name/address: LESLIE JOHNSON, 2727 NELA AVENUE, BELLE GLE, FL  
b. Interest in property: \_\_\_\_\_  
c. Name and address of fee simple title holder (if other than owner): SAME
4. Contractor Name and Address: FASWD, LLC  
3020 MERCY DRIVE, ORLANDO, FL 32808  
Phone: 407-770-0184 Fax: 407-770-0187
5. Surety - Name and Address: na  
Amount of bond: \$ \_\_\_\_\_
6. Lender - Name and Address: na
7. Persons within the State of Florida designated by Owner upon whom notices or other documents may be served as provided by Section 713.13(1)(a) 7, Florida Statutes: \_\_\_\_\_
8. In addition to him/herself, Owner designates the following person(s) to receive a copy of the Lienor's Notice as provided in Section 713.13(1)(b), Florida Statutes [Provide Name/Mailing Address]: \_\_\_\_\_
9. NOC expiration date (one full year from the date of recording unless different date is specified): \_\_\_\_\_

WARNING TO OWNER: ANY PAYMENTS MADE BY THE OWNER AFTER THE EXPIRATION OF THE NOTICE OF COMMENCEMENT ARE CONSIDERED IMPROPER PAYMENTS UNDER CHAPTER 713, PART I, SECTION 713.13, FLORIDA STATUTES, AND CAN RESULT IN YOUR PAYING TWICE FOR IMPROVEMENTS TO YOUR PROPERTY. A NOTICE OF COMMENCEMENT MUST BE RECORDED AND POSTED ON THE JOB SITE BEFORE THE FIRST INSPECTION. IF YOU INTEND TO OBTAIN FINANCING, CONSULT WITH YOUR LENDER OR AN ATTORNEY BEFORE COMMENCING WORK OR RECORDING YOUR NOTICE OF COMMENCEMENT.

Verification pursuant to Section 92.525, Florida Statutes: Under penalties of perjury, I declare that I have read the foregoing and that the facts stated in it are true to the best of my knowledge and belief.

Leslie Johnson  
Signature of Owner/A Natural Person (or Owner's Authorized Officer/Director/Partner/Manager)

The foregoing instrument was acknowledged before me this 18 day of APR, 2014, by LESLIE JOHNSON (print name of person) as OWNER (type of authority) for SELF (name of party on behalf of whom instrument was executed).

Frank J. Martinus  
Notary Public Personally Known      -OR- Produced Identification     

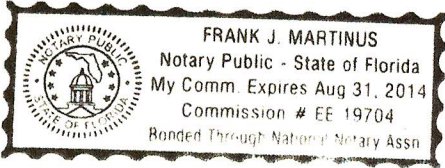

State of FLORIDA, County of ORANGE  
I hereby certify that this is a true copy of the document as reflected in the Official Records.  
MARTHA O. HAYNIE, COUNTY COMPTROLLER  
By: Martha O. Haynie Deputy Comptroller  
Dated: 5/20/2014

38492R1  
 2020 Mercy Drive  
 Orlando, FL 32808  
 (407)770-0184

**FAS**  
**WINDOWS & DOORS**  
 www.faswd.com  
 FL Lic. # CGC1518212  
 Tel# H: 407-222-8779  
 Tel# C:

7715 Anderson Rd.  
 Tampa, FL 33634  
 (813)514-9490

Name: LESLIE JOHNSON Tel# H: 407-222-8779 Email: \_\_\_\_\_  
 I/We, the owner(s) of the premises described below, hereinafter referred to as "Buyer" offer to contract with FAS Windows & Doors, hereinafter referred to as "FASWD", to furnish all materials listed below for use at the premises located at:

2727 NELA AVENUE, BELLE ISLE, FL 32809

(Street) (City) (State) (Zip)  
**Congratulations on your purchase of the finest home improvement products in the industry today! Below are the names and contact information of key people involved with your purchase. We believe that communication is the pathway to success! Please contact the people below at any time regarding your purchase and installation.**

**Installation**

You will be contacted by a member of your Installation Team to discuss the following:

1. Confirm receipt of your contract and review specifications.
2. Schedule a time for the tight measure.
3. Identify an approximate installation start or delivery date.
4. Answer any concerns you may have related to the project.

**Customer Care**

In the event that you have any questions or concerns regarding the window or door installation, please do not hesitate to contact F. MARTINUS, your Production Coordinator, or TAMMY HEURLEN, your Production Manager, at 407-770-0184. If you feel that we did not deliver on any of our promises to you, please contact us at \_\_\_\_\_.

Install  Pick Up  Delivery  Low-E  Mixed  Impact  Mixed

	Qty	Manufacturer	Series	Style	Color	Size	Glass	Grids	Screens	Oriel	Obscure/ Temper	Swing/ Slide	Line Notes
1	1	SIM	PF	PICTURE	W		LE						
2	2	SIM	PE	CASEHOLD	W		LE		F				
3	3	SIM	PF	SLIDERS	W		LE		1/2				
4	1	SIM	PF	SH	W		LE		1/2				
5													
6													
7													
8													

\*Please note all grid specifications, finish, hardware, trim and hinge details in line notes.

**Special Instructions:**

FAS LIFETIME LABOR

Please read the following bold type and initial corresponding line.

Verbal understandings and agreements with representative shall not be binding. All understandings and agreements must be set forth in writing in this Contract. I understand and recognize all terms and conditions on the front and reverse of this contract and am initialing to indicate my complete understanding. Buyer initials: [Signature]

**HURRICANE PROTECTION** I acknowledge that I am the owner of the residence and have contracted with FASWD to replace windows/doors. The home is located in an impact zone and I have existing hurricane protection equipment that complies with local jurisdiction. FASWD will not be liable if my existing protection equipment is deemed inadequate by the local government inspector after my windows are installed. In the event that my hurricane protection equipment fails inspection, I understand that FASWD will supply appropriate materials at a cost to me of \$375.00 per opening. I am initialing to indicate my complete understanding.  Not Applicable Buyer initials: [Signature]

NOTE: The warranty provisions as stated on the reverse have been explained and I/We understand them fully. Additional provisions and warranties are stated on the reverse side and are part of this contract. Buyer initials: [Signature]

The TOTAL PRICE for all  Labor &  Materials (including any applicable discount) is \_\_\_\_\_  
 Terms: \_\_\_\_\_  
 Credit (Subject to the approval of the Credit Department)  
 Credit Approval Code: \_\_\_\_\_  
 Credit Card (Please fill out credit card information sheet)  
 Cash (Final Payment payable to Installer upon completion)

SUB TOTAL: \$4241.00  
 TAX (DELIVERY OR PICK UP ONLY): 0  
 GRAND TOTAL: \$4241.00  
 DEPOSIT REQUIRED: \$2120.50  
 BALANCE DUE: \$2120.50

If this is a credit transaction, the agreement for credit is contained in a separate document which is incorporated herein by reference and made a part hereof. IN WITNESS WHEREOF Buyer(s) have hereunto signed their name(s) this 18 day of APRIL, 2014 and acknowledge receipt of a true copy of this Contract and unless otherwise specified, it is understood that the Buyer is ready for work to begin.

You, the Buyer(s), may cancel this transaction at any time prior to midnight of the third day after the date of this transaction. Signature affixed below acts as a receipt that buyer(s) received appropriate cancellation forms. See reverse side for details.

FASWD  
 SUBMITTED BY: Representative Date 4/18/14  
 APPROVED BY: Sales Manager Date \_\_\_\_\_

BUYER  
 BUYER: [Signature] Date 4/18/14  
 BUYER: \_\_\_\_\_ Date \_\_\_\_\_

Buyer(s) understand that this document does not constitute a valid and binding Contract for any purpose unless and until it is signed and accepted by an authorized representative of FASWD. All amounts due under this agreement shall be paid upon the date specified herein, if so set out, or upon the day the last of the work or products are furnished to the Buyer. Past due amounts are subject to a service charge of 18% per annum from the due date. Buyer agrees to pay FASWD all costs of enforcement or collection, including reasonable attorney fees, whether or not a lawsuit is commenced as a part of the collection process. This Contract and the agreement for credit, if any, shall constitute the entire agreement between the parties, which entire agreement and specifications shall not be altered or modified except by written agreement between the parties hereto.

IN THE EVENT THIS CONTRACT IS NOT ACCEPTED BY FASWD, ANY PAYMENT MADE HEREUNDER SHALL BE REFUNDED TO THE BUYER(S) AND THE CONTRACT SHALL BE NULL AND VOID AND OF NO EFFECT. FASWD IS NOT RESPONSIBLE FOR EXISTING STRUCTURAL DEFECTS, DRY ROT OR CODE VIOLATIONS, REPAIRING, PLASTERING, CARPENTRY AND/OR DECORATING ARE NOT INCLUDED UNLESS SPECIFICALLY CHARGED FOR AND SPECIFIED IN WRITING HEREIN.

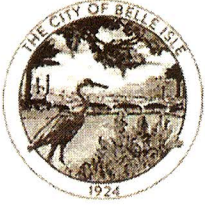

## City of Belle Isle

Universal Engineering Sciences 3532 Maggie Blvd., Orlando, FL 32811  
 Tel 407-581-8161 \* Fax 407-581-0313 \* [www.universalengineering.com](http://www.universalengineering.com)

### Product Approval Form

DATE: 5-31-14

PERMIT # \_\_\_\_\_

PROJECT ADDRESS 2727 Nela Ave

, Belle Isle, FL  32809  32812

As required by Florida Statute 553.842 and Florida Administrative Code 9B-72m, please provide the information and approval numbers of the building components listed below if they will be utilized on the building or structure. FL Approved products are listed online at [www.floridabuilding.org](http://www.floridabuilding.org) or can be obtained from the local product supplier. The following information must be turned in with permit application and available onsite for inspections:

1. This Product Approval Cover Sheet
2. Internet screen from FloridaBuilding.org showing PA#, approval and code edition stamped
3. Manufacturer's installation details from FloridaBuilding.org and requirements for each product stamped

Product Type	Manufacturer	Model/Series	FL Product Approval #	Product Type	Manufacturer	Model/Series	FL Product Approval #
<b>EXTERIOR DOORS</b>				<b>WALL PANELS</b>			
Swinging				Sliding			
Sliding				Soffits			
Sectional/Rollup				Storefront			
Other				Glass Block			
				Other			
<b>WINDOWS</b>				<b>ROOFING PRODUCTS</b>			
Single/Dbf Hung	Simonton	Profinish	5414.4	Asphalt Shingles			
Horizontal Slider	Simonton	Profinish	5179.10	Non Struct Metal			
Casement	Simonton	Profinish	107.2	Roofing Tiles			
Fixed	Simonton	Profinish	5177.12	Single Ply Roof			
Mullion	Simonton	Mull	12117.4	Other			
Skylights							
Other							
<b>STRUCTURAL COMPONENTS</b>				<b>OTHER</b>			
Wood Connectors							
Wood Anchors							
Truss Plates							
Insulation Forms							
Lintels							
Other							

It is the applicant's responsibility to verify that specific products have been installed in accordance with their limitations and with the minimum required design pressures for the structure. Specific compliance will be verified during field inspections.

Applicant Signature 

Date 5-31-14

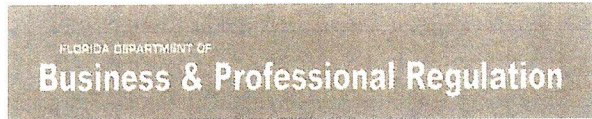

Florida Department of  
**Business & Professional Regulation**

[BCIS Home](#) | [Log In](#) | [User Registration](#) | [Hot Topics](#) | [Submit Surcharge](#) | [Stats & Facts](#) | [Publications](#) | [FBC Staff](#) | [BCIS Site Map](#) | [Links](#) | [Search](#)



**Product Approval**  
USER: Public User

License efficiently. Regulate fairly.

[Product Approval Menu](#) > [Product or Application Search](#) > [Application List](#) > [Application Detail](#)

OFFICE OF THE SECRETARY

FL #	FL5414-R9	
Application Type	Revision	5414.4
Code Version	2010	
Application Status	Approved	
Comments	*Approved by DBPR. Approvals by DBPR shall be reviewed and ratified by the POC and/or the Commission if necessary.	
Archived	<input type="checkbox"/>	
Product Manufacturer	Simonton Windows	
Address/Phone/Email	1 Cochrane Ave Pennsboro, WV 26415 (800) 746-6687 Ext 2329 tiffany_davies@simonton.com	
Authorized Signature	Tiffany Davies tiffany_davies@simonton.com	
Technical Representative	Tiffany Davies	
Address/Phone/Email	PO Box 1646 5300 Briscoe Road Parkersburg, WV 26102 (800) 542-9118 Ext 9329 tiffany_davies@simonton.com	
Quality Assurance Representative	AAMA	
Address/Phone/Email	1827 Walden Office Square Suite 550 Schaumburg, IL 60173 (847) 303-5664 webmaster@aamanet.org	
Category	Windows	
Subcategory	Single Hung	
Compliance Method	Certification Mark or Listing	
Certification Agency	American Architectural Manufacturers Association	
Validated By	American Architectural Manufacturers Association	
Referenced Standard and Year (of Standard)	<u>Standard</u>	<u>Year</u>
	AAMA/WDMA/CSA 101/I.S 2/A440	2005
	AAMA/WDMA/CSA 101/I.S 2/A440	2008
Equivalence of Product Standards Certified By		
Product Approval Method	Method 1 Option A	

Date Submitted 10/16/2013  
 Date Validated 11/01/2013  
 Date Pending FBC Approval  
 Date Approved 11/08/2013

**Summary of Products**

FL #	Model, Number or Name	Description
5414.1	41-18	ProFinish Brickmould 300 Vinyl Single Hung
<b>Limits of Use</b> Approved for use in HVHZ: No Approved for use outside HVHZ: Yes Impact Resistant: No Design Pressure: N/A Other: 48x80 (+/-25 PSF), 53x71 (+/-30 PSF), 44x63 (+/-35 PSF), 48x72 (+/-40 PSF), 36x63 (+/-45 PSF), 44x63 (+/-45 PSF), 36x76 (+/-50 PSF)		<b>Certification Agency Certificate</b> <a href="#">FL5414 R9 C CAC 41-18 SH 36x63 R45.pdf</a> <a href="#">FL5414 R9 C CAC 41-18 SH 36x76 R50.pdf</a> <a href="#">FL5414 R9 C CAC 41-18 SH 44x63 R35.pdf</a> <a href="#">FL5414 R9 C CAC 41-18 SH 44x63 R45.pdf</a> <a href="#">FL5414 R9 C CAC 41-18 SH 48x72 R40.pdf</a> <a href="#">FL5414 R9 C CAC 41-18 SH 48x80 R25.pdf</a> <a href="#">FL5414 R9 C CAC 41-18 SH 53x71 R30.pdf</a> <b>Quality Assurance Contract Expiration Date</b> 09/26/2015 <b>Installation Instructions</b> <a href="#">FL5414 R9 II IN0228 41-18 SH 2X.pdf</a> Verified By: American Architectural Manufacturers Association Created by Independent Third Party: <b>Evaluation Reports</b> Created by Independent Third Party:
5414.2	41-18	ProFinish Brickmould 300 Vinyl Twin Single Hung
<b>Limits of Use</b> Approved for use in HVHZ: No Approved for use outside HVHZ: Yes Impact Resistant: No Design Pressure: N/A Other: 96x80 (+/-25 PSF), 89x63 (+/-30 PSF), 73x74 (+/-45 PSF), 73x74 (+/-50 PSF)		<b>Certification Agency Certificate</b> <a href="#">FL5414 R9 C CAC 41-18 SH Twin 73x74 R PG50.pdf</a> <a href="#">FL5414 R9 C CAC 41-18 SH Twin 73x74 R45.pdf</a> <a href="#">FL5414 R9 C CAC 41-18 SH Twin 89x63 R30.pdf</a> <a href="#">FL5414 R9 C CAC 41-18 SH Twin 96x80 R35.pdf</a> <b>Quality Assurance Contract Expiration Date</b> 09/27/2015 <b>Installation Instructions</b> <a href="#">FL5414 R9 II IN0230 41-18 SH T-Mulled Twin 2X.pdf</a> Verified By: American Architectural Manufacturers Association Created by Independent Third Party: <b>Evaluation Reports</b> Created by Independent Third Party:
5414.3	41-18	ProFinish Brickmould 300 Vinyl Triple Single Hung
<b>Limits of Use</b> Approved for use in HVHZ: No Approved for use outside HVHZ: Yes Impact Resistant: No Design Pressure: N/A Other: 109x63 (+/-35 PSF) or 109x72 (+/-45 PSF)		<b>Certification Agency Certificate</b> <a href="#">FL5414 R9 C CAC 41-18 SH Triple 109x63 r35.pdf</a> <a href="#">FL5414 R9 C CAC 41-18 SH Twin 109x72 R PG45.pdf</a> <b>Quality Assurance Contract Expiration Date</b> 03/08/2016 <b>Installation Instructions</b> <a href="#">FL5414 R9 II IN0232 41-18 SH T-Mull Triple 2X.pdf</a> Verified By: American Architectural Manufacturers Association Created by Independent Third Party: <b>Evaluation Reports</b> Created by Independent Third Party:
5414.4	43-06 / 43-17	THD 6060 Vantage Pointe, ProFinish Builder, ProFinish Contractor, ProFinish Master, Grand Estates New Construction Vinyl Single Hung
<b>Limits of Use</b> Approved for use in HVHZ: No Approved for use outside HVHZ: Yes Impact Resistant: No Design Pressure: N/A Other: 36x72 (+/-25 PSF), 48x80 (+/-25 PSF), 44x63 (+/-35 PSF), 36x74 (+/-35 PSF), 53x71 (+/-35 PSF), 48x72 (+/-40 PSF), 44x63 (+/-45 PSF), 36x84 (+/-50 PSF), 36x74 (+/-50 PSF), 32x62 (+/-50 PSF)		<b>Certification Agency Certificate</b> <a href="#">FL5414 R9 C CAC 43-06 SH 32x62 R50.pdf</a> <a href="#">FL5414 R9 C CAC 43-06 SH 36x72 R25.pdf</a> <a href="#">FL5414 R9 C CAC 43-06 SH 36x74 R35.pdf</a> <a href="#">FL5414 R9 C CAC 43-06 SH 36x74 R50.pdf</a> <a href="#">FL5414 R9 C CAC 43-06 SH 36x84 R50.pdf</a> <a href="#">FL5414 R9 C CAC 43-06 SH 44x63 R35.pdf</a> <a href="#">FL5414 R9 C CAC 43-06 SH 44x63 R45.pdf</a> <a href="#">FL5414 R9 C CAC 43-06 SH 48x72 R40.pdf</a> <a href="#">FL5414 R9 C CAC 43-06 SH 48x80 LC25.pdf</a> <a href="#">FL5414 R9 C CAC 43-06 SH 53x71 R35.pdf</a> <a href="#">FL5414 R9 C CAC 43-17 to 43-06 Waiver.pdf</a> <b>Quality Assurance Contract Expiration Date</b> 08/04/2015 <b>Installation Instructions</b> <a href="#">FL5414 R9 II IN0160 43-06 43-17 SH 2X.pdf</a> <a href="#">FL5414 R9 II IN0242 43-06 43-17 SH 1X.pdf</a> Verified By: American Architectural Manufacturers Association

SIZE CHART		DP RATING
OVERALL SIZE	HEIGHT	
WIDTH	72"	±25 PSF
	80"	
	63"	
	74"	±35 PSF
	71"	
	48"	±40 PSF
	63"	±45 PSF
	32"	±50 PSF
	36"	
	74"	

REV. #	REVISIONS	REVISED BY	DATE
1	ENGINEERS REVIEW	JAR	04/21/08
2	ENGINEERS REVIEW, 2010 FBC, ADDED 2x OPT.	JAR	07/21/12
3	CORRECTED 53X71 IN SIZE CHART	JAR	01/31/13

- NOTES:
- Installations depicted satisfy the requirements of the 2010 Florida Building Code for design wind pressures and overall sizes listed in the Size Chart
  - Concrete masonry installations are assumed at least ASTM C90-hollow masonry units with a 1-1/4" wall thickness or normal weight concrete with a minimum compressive strength of  $f'c=3,192$  psi.
  - Tapcon masonry anchors shall have a minimum embedment of 1-1/4" or full penetration of concrete masonry unit shell. They shall also have a minimum of 2" edge distance and 3" spacing between anchors. Install concrete masonry anchors per manufacturer's installation instructions.
  - Wood buck strips and wood frames are assumed S-P-F ( $G=0.42$ ) or denser. Buck width shall be greater than the window frame width. Tapered or partial width buck strips are not allowed.
  - Maximum shim thickness of 1/4" permitted at each fastener location. Shims shall be non-compressible and load bearing type.
  - All interior and exterior perimeter surfaces of the window must be caulked.
  - When the optional head expanders are used, the INSTALLER MUST ADJUST the anchor lengths to maintain the required minimum embedment into the substrate.
  - The responsibility for selection of Simonton Products to meet any applicable local laws, building codes, ordinances, or other safety requirements rests solely with the architect, building owner, or contractor.
  - Pre-drill the thru hole at specified installation screw locations.
  - Screws at mid-height of sash for DP50, 36x84 windows only.
  - Products are non-impact and will require approved protection devices if used in wind-borne debris regions.
  - Not for use in High Velocity Hurricane Zone (HVHZ)

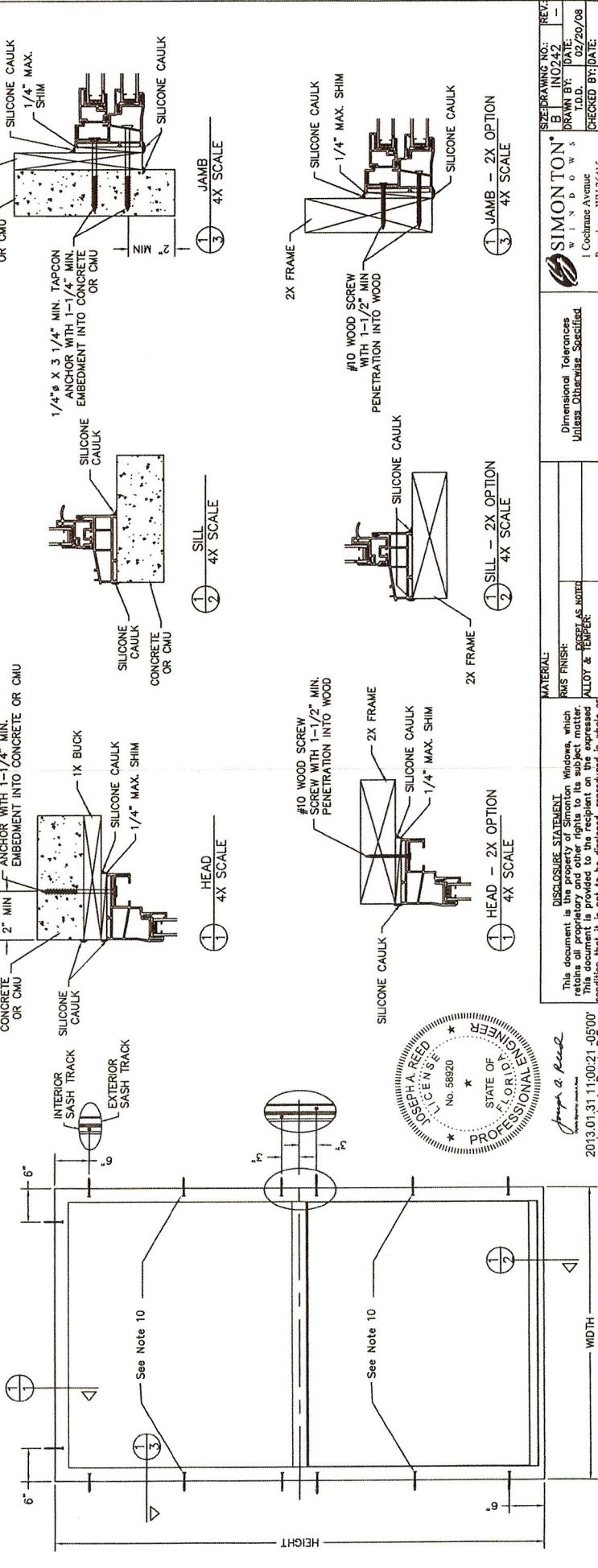

2013.01.31 11:00:21 -05'00'  
 Joseph A. Reed, P.E.  
 FL PE 58920  
 FL COA 29274  
 130 Derry Ct.  
 York, PA 17406  
 717-664-0706

DISCLOSURE STATEMENT  
 This document is the property of Simonton Windows, which retains all proprietary and other rights to its subject matter. This document is provided to the recipient on the expressed condition that it is not to be disclosed, reproduced in whole or in part, or used for any purpose other than the repair or repair of goods for anyone other than Simonton Windows without its consent. This restriction does not limit the recipient's rights to utilize information contained in this document which is properly obtained from another source.

MATERIALS:  
 FINISH FINISH:  
 ALLOY & TEMPER:  
 WEIGHT:  
 VOLUME:  
 SURFACE AREA:  
 FINISH TREATMENT:

Dimensional Tolerances Unless Otherwise Specified  
 Decimals  
 Angles  
 X ± .03  
 .XX ± .01  
 .XXX ± .005

Scale: FIT 1 of 1  
 Series: 43-06 SINGLE HUNG  
 Title: 1X BUCK AND 2X FRAME INSTALLATION

REVISIONS NO.: E-110242  
 DRAWN BY: DATE: 02/20/08  
 T.O.D.:  
 CHECKED BY: DATE:  
 SHEET: 1 of 1  
 APPROVED BY: DATE:

SIMONTON®  
 W I N D O W S  
 1 Cochran Avenue  
 Painesboro, WI 56415

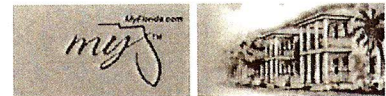
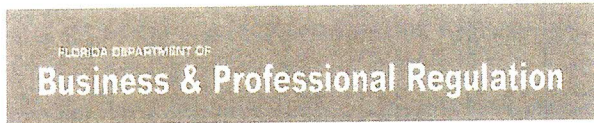

[DBPR HOME](#) | [ABOUT DBPR](#) | [DBPR DIVISIONS](#) | [CONTACT DBPR](#)



[BCIS Home](#) | [Log In](#) | [User Registration](#) | [Hot Topics](#) | [Submit Surcharge](#) | [Stats & Facts](#) | [Publications](#) | [FBC Staff](#) | [BCIS Site Map](#) | [Links](#) | [Search](#)



**Product Approval**  
USER: Public User

License efficiently. Regulate fairly.

[Product Approval Menu](#) > [Product or Application Search](#) > [Application List](#) > [Application Detail](#)



FL #	FL5179-R11
Application Type	Revision <i>5179,10</i>
Code Version	2010
Application Status	Approved
Comments	*Approved by DBPR. Approvals by DBPR shall be reviewed and ratified by the POC and/or the Commission if necessary.
Archived	<input type="checkbox"/>
Product Manufacturer	Simonton Windows
Address/Phone/Email	1 Cochrane Ave Pennsboro, WV 26415 (800) 746-6687 Ext 2329 tiffany_davies@simonton.com
Authorized Signature	Tiffany Davies tiffany_davies@simonton.com
Technical Representative	Tiffany Davies
Address/Phone/Email	PO Box 1646 5300 Briscoe Road Parkersburg, WV 26102 (800) 542-9118 Ext 9329 tiffany_davies@simonton.com
Quality Assurance Representative	AAMA
Address/Phone/Email	1827 Walden Office Square Suite 550 Schaumburg, IL 60173 (847) 303-5664 webmaster@aamanet.org
Category	Windows
Subcategory	Horizontal Slider <i>Profinish</i>
Compliance Method	Certification Mark or Listing
Certification Agency	American Architectural Manufacturers Association
Validated By	American Architectural Manufacturers Association
Referenced Standard and Year (of Standard)	<b>Standard</b> AAMA/WDMA/CSA 101/I.S.2/A440
Equivalence of Product Standards Certified By	<b>Year</b> 2005
Product Approval Method	Method 1 Option A
Date Submitted	04/16/2013

	<p><b>Design Pressure:</b> +30/-30 <b>Other:</b> 96x63</p>	<p>09/07/2014 <b>Installation Instructions</b> <a href="#">FL5179 R11 II IN0170 43-06 43-17 EV 2X.pdf</a> <a href="#">FL5179 R11 II IN0269 43-06 EV 1X.pdf</a> Verified By: American Architectural Manufacturers Association Created by Independent Third Party: <b>Evaluation Reports</b> <a href="#">FL5179 R11 AE 43-17 to 43-06 Waiver.pdf</a> <a href="#">FL5179 R11 AE PER 1636 - 43-06 End Vent Slider 1X.pdf</a> Created by Independent Third Party: Yes</p>
5179.10	43-06 and 43-17	THD 6060 Vantage Pointe, ProFinish Builder, ProFinish Contractor, ProFinish Master, Grand Estates New Construction Vinyl 2-Lite Horizontal Slider
	<p><b>Limits of Use</b> <b>Approved for use in HVHZ:</b> No <b>Approved for use outside HVHZ:</b> Yes <b>Impact Resistant:</b> No <b>Design Pressure:</b> N/A <b>Other:</b> 72x63 (+/-30 PSF), 72x48 (+/-35 PSF)</p>	<p><b>Certification Agency Certificate</b> <a href="#">FL5179 R11 C CAC 43-06 HS 72x48 R35.pdf</a> <a href="#">FL5179 R11 C CAC 43-06 HS 72x63 R30.pdf</a> <a href="#">FL5179 R11 C CAC 43-17 to 43-06 Waiver.pdf</a> <b>Quality Assurance Contract Expiration Date</b> 07/11/2016 <b>Installation Instructions</b> <a href="#">FL5179 R11 II IN0142 43-06 43-17 SL 2X.pdf</a> Verified By: American Architectural Manufacturers Association Created by Independent Third Party: <b>Evaluation Reports</b> Created by Independent Third Party:</p>
5179.11	43-17	Profinish Contractor, Amcraft Grand Estates New Construction Vinyl 2-Lite Horizontal Slider
	<p><b>Limits of Use</b> <b>Approved for use in HVHZ:</b> No <b>Approved for use outside HVHZ:</b> Yes <b>Impact Resistant:</b> No <b>Design Pressure:</b> N/A <b>Other:</b> 72x63 (+/-30 PSF), 72x48 (+/-35 PSF)</p>	<p><b>Certification Agency Certificate</b> <a href="#">FL5179 R11 C CAC 43-17 HS 72x48 R35.pdf</a> <a href="#">FL5179 R11 C CAC 43-17 HS 72x63 r30.pdf</a> <b>Quality Assurance Contract Expiration Date</b> 08/02/2015 <b>Installation Instructions</b> <a href="#">FL5179 R11 II IN0141 43-17 SL 2X.pdf</a> <a href="#">FL5179 R11 II IN0262 43-17 SL 1X.pdf</a> Verified By: American Architectural Manufacturers Association Created by Independent Third Party: <b>Evaluation Reports</b> <a href="#">FL5179 R11 AE PER 2311 - 43-17 Horizontal Slider 1X SS.pdf</a> Created by Independent Third Party: Yes</p>
5179.12	43-35	6100 Vantage Pointe, Asure, Prism Gold, Grand Estates Vinyl 2-Lite Horizontal Slider
	<p><b>Limits of Use</b> <b>Approved for use in HVHZ:</b> No <b>Approved for use outside HVHZ:</b> Yes <b>Impact Resistant:</b> No <b>Design Pressure:</b> N/A <b>Other:</b> 69x65 (+/-25 PSF), 78x63 (+/-25 PSF), 72x54 (+/-30 PSF), 72x36 (+/-35 PSF)</p>	<p><b>Certification Agency Certificate</b> <a href="#">FL5179 R11 C CAC 43-35 HS 72x36 R35.pdf</a> <a href="#">FL5179 R11 C CAC 43-35 HS 72x54 R30.pdf</a> <a href="#">FL5179 R11 C CAC 43-35 HS 78x63 R25.pdf</a> <a href="#">FL5179 R11 C CAC 43-35 to 43-40 SL Waiver.pdf</a> <a href="#">FL5179 R11 C CAC 43-40 HS 69x65 R25.pdf</a> <a href="#">FL5179 R11 C CAC 43-40 HS 72x36 R40.pdf</a> <b>Quality Assurance Contract Expiration Date</b> 06/16/2013 <b>Installation Instructions</b> <a href="#">FL5179 R11 II IN0138 43-35 43-40 SL 1X.pdf</a> <a href="#">FL5179 R11 II IN0139 43-35 SL 2X.pdf</a> Verified By: American Architectural Manufacturers Association Created by Independent Third Party: <b>Evaluation Reports</b> <a href="#">FL5179 R11 AE PER 1630 - 43-35 43-40 Horizontal Slider 1X.pdf</a> <a href="#">FL5179 R11 AE PER 1630 - 43-35 IN0138 Addendum.pdf</a> Created by Independent Third Party: Yes</p>
5179.13	43-35	6100 Vantage Pointe, Asure, Prism Gold, Grand Estates Vinyl 3-Lite Endvent Slider
	<p><b>Limits of Use</b> <b>Approved for use in HVHZ:</b> No <b>Approved for use outside HVHZ:</b> Yes <b>Impact Resistant:</b> No <b>Design Pressure:</b> +35/-35 <b>Other:</b></p>	<p><b>Certification Agency Certificate</b> <a href="#">FL5179 R11 C CAC 43-35 EV 84x36 R35.pdf</a> <b>Quality Assurance Contract Expiration Date</b> 01/23/2016 <b>Installation Instructions</b> <a href="#">FL5179 R11 II 43-35 to 43-40 Waiver.pdf</a> <a href="#">FL5179 R11 II IN0146 43-35 43-40 EV 1X.pdf</a> <a href="#">FL5179 R11 II IN0147 43-35 EV 2X.pdf</a> Verified By: American Architectural Manufacturers</p>

MODEL DESIGNATION: Simonton Horizontal Slider Series 43-40 Vinyl Window

MAXIMUM OVERALL NOMINAL SIZE: See Size Chart

DESIGN PRESSURE RATING: See Size Chart

USABLE CONFIGURATIONS: XX, OX, or XO

GENERAL DESCRIPTION: The head, sill, and side jombs are extruded PVC. The wall thickness through which the anchor screw penetrates is a minimum of 0.070".

REV. #	REVISIONS:	REVISED BY:	DATE:
1	REMOVED "CONCRETE" FROM TITLE	T.O.D.	11/02/07
2	ADDED "7/8" X 63 AND 69 X 63 TO SIZE CHART & REVISED 43-45 FROM SERIES.	T.O.D.	01/24/08
3	REMOVED TAPCON FROM SILL	T.O.D.	06/11/08
4	UPDATED NOTES, GENERAL DESCRIPTION & SIZE CHART.	T.O.D.	03/16/10

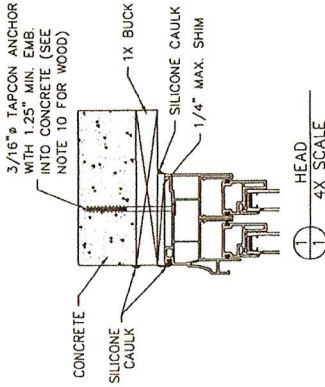

HEAD 4X SCALE

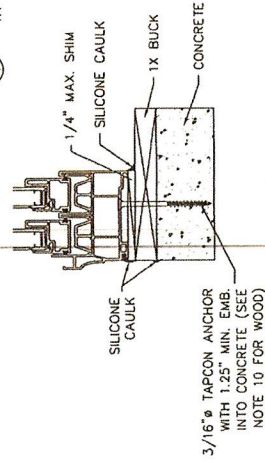

SILL 4X SCALE

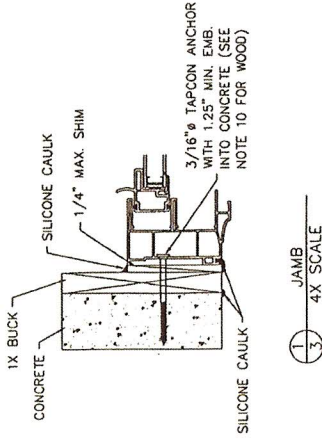

JAMB 4X SCALE

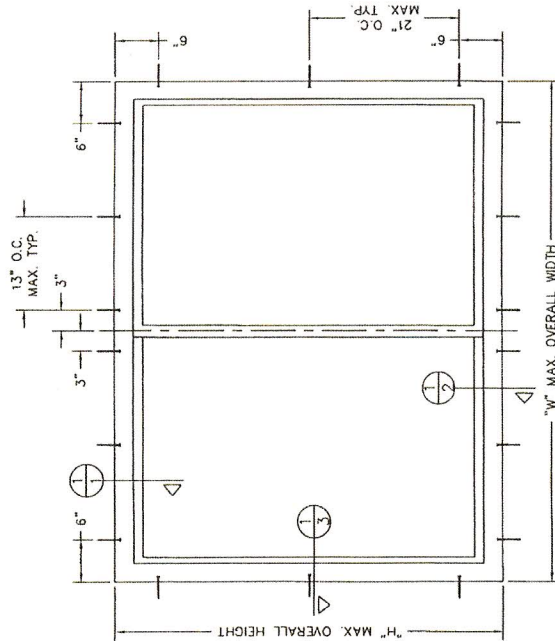

OVERALL SIZE	DP RATING
WIDTH "W"	
HEIGHT "H"	
78"	±15 PSF
78"	±25 PSF
69"	±30 PSF
72"	±40 PSF
72"	±40 PSF

NOTES:

- This installation has been evaluated for use in locations adhering to the Florida Building Code and where design pressure requirements as determined by ASCE 7 Minimum Design Loads for Buildings and Other Structures do not exceed the design pressure ratings listed herein.
- For installation where the sub-buck is less than 1 1/2" (FBC section 1707.4.4 Anchorage Methods and sub-sections 1707.4.4.1 and 1707.4.4.2) Tapcon type concrete anchors must be used and the length must be such that a minimum 1 1/4" embedment of the Tapcon into the concrete is obtained. Anchors must be a minimum of 2 1/2" from the edge of the concrete or concrete-filled block.
- All interior and exterior perimeter surfaces of the window must be caulked.
- Adjust Tapcon anchor locations, if necessary, to maintain a minimum of 2.0" clearance from mortar joints.
- When the optional head expanders are used, the INSTALLER MUST ADJUST the anchor lengths to maintain the required minimum embedment into the substrate.
- Anchors shall be specified and spaced as shown. Anchor embedment to base material shall be beyond wall dressing or stucco and into wood of concrete.
- Wood bucks (by others) must be engineered and anchored properly to transfer loads to the structure.
- Follow ITW/Eco Tapcon anchoring instructions.
- The responsibility for selection of Simonton Products to meet any applicable local laws, building codes, ordinances, or other safety requirements rests solely with the architect, building owner, or contractor.
- For woodbuck substrates, use #10 wood screws with 1 1/2" min. embedment into wood. Screws must be a minimum of 3/4" from the edge of the wood.
- Concrete compressive strength = 3000 PSI at 28 days.
- Shims are optional. Max. shim stack is 1/4".
- When using a 3/16" tapcon or #10 wood screw through the window frame, pre-drill the thru hole at specified installation screw locations.
- When used in areas requiring impact protection, this product REQUIRES the use of approved impact resistant shutters or other external protection.

DISCLOSURE STATEMENT  
 This document is the property of Simonton Windows, which retains all proprietary and other rights to its subject matter. This document is provided to the recipient on the expressed condition that it is not to be disclosed, reproduced in whole or in part, or used for any other purpose without the written consent of Simonton Windows. This restriction does not limit the recipient's rights to utilize information contained in this document which is properly obtained from another source.

Kristina S. Dougherty  
 Florida P.E. No. 89465  
 172 Water Park, Ft. 32789  
 FPPE Cert. of Authorization No. 28520

MATERIAL:  
 FRAME FINISH:  
 EXCIT. AS NOTED  
 ALLOY & TEMPER:  
 WEIGHT:  
 VOLUME:  
 SURFACE AREA:  
 PERIMETER:  
 FINISH TREATMENT:

Dimensional Tolerances  
 Unless Otherwise Specified

Decimals  
 X ± .03  
 .XX ± .01  
 .XXX ± .005

**SIMONTON**  
 W I N D O W S  
 1 Cochran Avenue  
 Pennington, WV 26415  
 SCALE: FT 1 of 1  
 SERIES: 43-40 HORIZONTAL SLIDER  
 TITLE: 1X BUCK INSTALLATION  
 DRAWING NO.: E1-INO138  
 DRAWN BY: DATE: 10/24/07  
 CHECKED BY: DATE:  
 APPROVED BY: DATE:  
 SHEET: 1 of 1

FILE: INO138

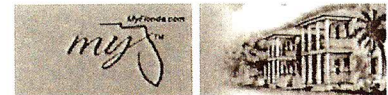
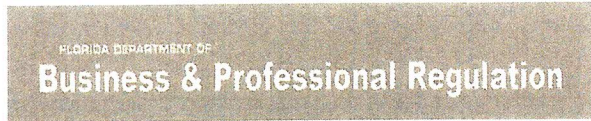

DBPR HOME ABOUT DBPR DBPR DIVISIONS CONTACT DBPR



BCIS Home | Log In | User Registration | Hot Topics | Submit Surcharge | Stats & Facts | Publications | FBC Staff | BCIS Site Map | Links | Search



**Product Approval**  
USER: Public User

License efficiently. Regulate fairly.

Product Approval Menu > Product or Application Search > Application List > Application Detail

OFFICE OF THE SECRETARY

FL #	FL5177-R13	5177.12
Application Type	Revision	
Code Version	2010	
Application Status	Approved	
	*Approved by DBPR. Approvals by DBPR shall be reviewed and ratified by the POC and/or the Commission if necessary.	
Comments		
Archived	<input type="checkbox"/>	
Product Manufacturer	Simonton Windows	
Address/Phone/Email	1 Cochrane Ave Pennsboro, WV 26415 (800) 746-6687 Ext 2329 tiffany_davies@simonton.com	
Authorized Signature	Tiffany Davies tiffany_davies@simonton.com	
Technical Representative	Tiffany Davies	
Address/Phone/Email	PO Box 1646 5300 Briscoe Road Parkersburg, WV 26102 (800) 542-9118 Ext 9329 tiffany_davies@simonton.com	
Quality Assurance Representative	AAMA	
Address/Phone/Email	1827 Walden Office Square Suite 550 Schaumburg, IL 60173 (847) 303-5664 webmaster@aamanet.org	
Category	Windows	
Subcategory	Fixed	Pro finish
Compliance Method	Certification Mark or Listing	
Certification Agency	American Architectural Manufacturers Association	
Validated By	American Architectural Manufacturers Association	
Referenced Standard and Year (of Standard)	<u>Standard</u>	<u>Year</u>
	AAMA 450	2010
	AAMA/WDMA/CSA 101/I.S 2/A440	2005
	AAMA/WDMA/CSA 101/I.S 2/A440	2008
	ASTM E 1300	2004
Equivalence of Product Standards Certified By		

		Created by Independent Third Party: <b>Evaluation Reports</b> Created by Independent Third Party:
5177.10	42-19	ProFinish Brickmould 600 Vinyl Fixed Window Twin
<b>Limits of Use</b> Approved for use in HVHZ: No Approved for use outside HVHZ: Yes Impact Resistant: No Design Pressure: +35/-35 Other: 97x80		<b>Certification Agency Certificate</b> <a href="#">FL5177 R13 C CAC 42-19 PW T-Mull Twin 97x80 R35.pdf</a> <b>Quality Assurance Contract Expiration Date</b> 11/01/2014 <b>Installation Instructions</b> <a href="#">FL5177 R13 II IN0155 42-19 PW Twin 2X.pdf</a> Verified By: American Architectural Manufacturers Association Created by Independent Third Party: <b>Evaluation Reports</b> Created by Independent Third Party:
5177.11	42-19	ProFinish Brickmould 600 Vinyl Fixed Window Triple
<b>Limits of Use</b> Approved for use in HVHZ: No Approved for use outside HVHZ: Yes Impact Resistant: No Design Pressure: +35/-35 Other: 109x74		<b>Certification Agency Certificate</b> <a href="#">FL5177 R13 C CAC 42-19 PW T-Mull Triple 109x74 R35.pdf</a> <b>Quality Assurance Contract Expiration Date</b> 11/01/2014 <b>Installation Instructions</b> <a href="#">FL5177 R13 II IN0156 42-19 PW Triple 2X.pdf</a> Verified By: American Architectural Manufacturers Association Created by Independent Third Party: <b>Evaluation Reports</b> Created by Independent Third Party:
5177.12	43-06	ProFinish Builder, 6060 Vantage Pointe Vinyl Fixed Window
<b>Limits of Use</b> Approved for use in HVHZ: No Approved for use outside HVHZ: Yes Impact Resistant: No Design Pressure: N/A Other: 96x72 (+/-30 PSF), 96x63 (+/-45 PSF), 72x63 (+/-50 PSF)		<b>Certification Agency Certificate</b> <a href="#">FL5177 R13 C CAC 43-06 PW 48x63 R50.pdf</a> <a href="#">FL5177 R13 C CAC 43-06 PW 72x63 R50.pdf</a> <a href="#">FL5177 R13 C CAC 43-06 PW 96x63 R45.pdf</a> <a href="#">FL5177 R13 C CAC 43-06 PW 96x72 LC30.pdf</a> <b>Quality Assurance Contract Expiration Date</b> 04/02/2014 <b>Installation Instructions</b> <a href="#">FL5177 R13 II IN0294 43-06 PW 2X.pdf</a> Verified By: American Architectural Manufacturers Association Created by Independent Third Party: <b>Evaluation Reports</b> Created by Independent Third Party:
5177.13	43-17	ProFinish Contractor/Master, Grand Estates New Construction Vinyl Fixed Window
<b>Limits of Use</b> Approved for use in HVHZ: No Approved for use outside HVHZ: Yes Impact Resistant: No Design Pressure: N/A Other: 96x72 (+/-30 PSF), 96x63 (+/-35 PSF), 74x63 (+/-50 PSF), 80x48 (+/-55 PSF)		<b>Certification Agency Certificate</b> <a href="#">FL5177 R13 C CAC 43-17 PW 74x63 R50.pdf</a> <a href="#">FL5177 R13 C CAC 43-17 PW 80x48 R55.pdf</a> <a href="#">FL5177 R13 C CAC 43-17 PW 96x63 R35.pdf</a> <a href="#">FL5177 R13 C CAC 43-17 PW 96x72 C30.pdf</a> <b>Quality Assurance Contract Expiration Date</b> 12/07/2014 <b>Installation Instructions</b> <a href="#">FL5177 R13 II IN0088 43-17 PW 1X.pdf</a> <a href="#">FL5177 R13 II IN0278 43-17 PW 2X.pdf</a> Verified By: American Architectural Manufacturers Association Created by Independent Third Party: <b>Evaluation Reports</b> <a href="#">FL5177 R13 AE PER 2309 - 43-17 Fixed Window 1X SS.pdf</a> Created by Independent Third Party: Yes
5177.14	43-35	6100 Vantage Pointe, Asure, Prism Gold, Grand Estates, Vinyl Fixed Window
<b>Limits of Use</b> Approved for use in HVHZ: No Approved for use outside HVHZ: Yes Impact Resistant: No Design Pressure: N/A Other: 96x72 (+/-40 PSF), 74x63 (+/-50 PSF), 80x48 (+/-50 PSF)		<b>Certification Agency Certificate</b> <a href="#">FL5177 R13 C CAC 43-35 PW 74x63 LC50.pdf</a> <a href="#">FL5177 R13 C CAC 43-35 PW 80x48 LC50.pdf</a> <a href="#">FL5177 R13 C CAC 43-35 PW 96x72 LC40.pdf</a> <b>Quality Assurance Contract Expiration Date</b> 09/10/2016 <b>Installation Instructions</b> <a href="#">FL5177 R13 II IN0094 43-35 PW 2X.pdf</a> Verified By: American Architectural Manufacturers Association Created by Independent Third Party:



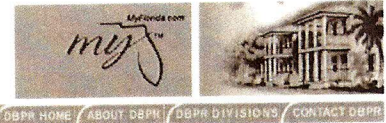
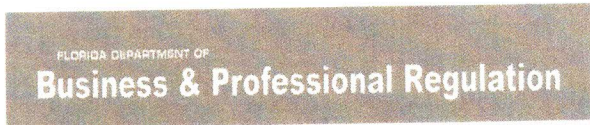

[BCIS Home](#) | [Log In](#) | [User Registration](#) | [Hot Topics](#) | [Submit Surcharge](#) | [Stats & Facts](#) | [Publications](#) | [FBC Staff](#) | [BCIS Site Map](#) | [Links](#) | [Search](#)



**Product Approval**  
USER: Public User

License efficiently. Regulate fairly.

OFFICE OF THE SECRETARY

[Product Approval Menu](#) > [Product or Application Search](#) > [Application List](#) > **Application Detail**

FL #	FL107-R10								
Application Type	Revision								
Code Version	2010								
Application Status	Approved								
	*Approved by DBPR. Approvals by DBPR shall be reviewed and ratified by the POC and/or the Commission if necessary.								
Comments									
Archived	<input type="checkbox"/>								
Product Manufacturer	Simonton Windows								
Address/Phone/Email	1 Cochrane Ave Pennsboro, WV 26415 (800) 746-6687 Ext 2329 tiffany_davies@simonton.com								
Authorized Signature	Tiffany Davies tiffany_davies@simonton.com								
Technical Representative	Tiffany Davies								
Address/Phone/Email	PO Box 1646 5300 Briscoe Road Parkersburg, WV 26102 (800) 542-9118 Ext 9329 tiffany_davies@simonton.com								
Quality Assurance Representative	AAMA								
Address/Phone/Email	1827 Walden Office Square Suite 550 Schaumburg, IL 60173 (847) 303-5664 webmaster@aamanet.org								
Category	Windows								
Subcategory	Casement								
Compliance Method	Certification Mark or Listing								
Certification Agency	American Architectural Manufacturers Association								
Validated By	American Architectural Manufacturers Association								
Referenced Standard and Year (of Standard)	<table border="0"> <thead> <tr> <th><u>Standard</u></th> <th><u>Year</u></th> </tr> </thead> <tbody> <tr> <td>AAMA 450</td> <td>2006</td> </tr> <tr> <td>AAMA/WDMA/CSA 101/I.S.2/A440</td> <td>2005</td> </tr> <tr> <td>AAMA/WDMA/CSA 101/I.S.2/A440</td> <td>2008</td> </tr> </tbody> </table>	<u>Standard</u>	<u>Year</u>	AAMA 450	2006	AAMA/WDMA/CSA 101/I.S.2/A440	2005	AAMA/WDMA/CSA 101/I.S.2/A440	2008
<u>Standard</u>	<u>Year</u>								
AAMA 450	2006								
AAMA/WDMA/CSA 101/I.S.2/A440	2005								
AAMA/WDMA/CSA 101/I.S.2/A440	2008								
Equivalence of Product Standards Certified By									
Product Approval Method	Method 1 Option A								

107.2

Profinish

Date Submitted 02/18/2014  
 Date Validated 03/11/2014  
 Date Pending FBC Approval  
 Date Approved 03/13/2014

**Summary of Products**

FL #	Model, Number or Name	Description
107.1	08-08	ProFinish Contractor, ProFinish Master, Amcraft Grand Estates New Construction Vinyl Casement Triple with Integral T-Mullions
<b>Limits of Use</b> Approved for use in HVHZ: No Approved for use outside HVHZ: Yes Impact Resistant: No Design Pressure: N/A Other: 107x72 (+/-45 PSF), 101x63 (+/-50 PSF)		<b>Certification Agency Certificate</b> <a href="#">FL107 R10 C CAC 08-08 CS Triple 101x63 R50.pdf</a> <a href="#">FL107 R10 C CAC 08-08 CS Triple 107x72 R45.pdf</a> <b>Quality Assurance Contract Expiration Date</b> 08/03/2015 <b>Installation Instructions</b> <a href="#">FL107 R10 II IN0324 08-08 CS Triple 2X.pdf</a> Verified By: American Architectural Manufacturers Association Created by Independent Third Party: <b>Evaluation Reports</b> Created by Independent Third Party:
107.2	08-08	ProFinish Contractor, ProFinish Master, Amcraft Grand Estates New Construction Vinyl Casement (Left or Right Hinge)
<b>Limits of Use</b> Approved for use in HVHZ: No Approved for use outside HVHZ: Yes Impact Resistant: No Design Pressure: N/A Other: 36x72 single strength glass (+/-40 PSF), 36x80 (+/-50 PSF), 36x72 double strength glass (+/-55 PSF)		<b>Certification Agency Certificate</b> <a href="#">FL107 R10 C CAC 08-08 CS 36x72 R PG55.pdf</a> <a href="#">FL107 R10 C CAC 08-08 CS 36x72 R40.pdf</a> <a href="#">FL107 R10 C CAC 08-08 CS 36x80 R PG50.pdf</a> <b>Quality Assurance Contract Expiration Date</b> 04/18/2015 <b>Installation Instructions</b> <a href="#">FL107 R10 II IN0166 08-08 CS 2X.pdf</a> Verified By: American Architectural Manufacturers Association Created by Independent Third Party: <b>Evaluation Reports</b> Created by Independent Third Party:
107.3	08-09, 08-10, 08-20	Reflections 5500, Prism Platinum, Generations, 9400, 9800, 9300, Amcraft Grand Estates Premium Plus, Grandura, 6500 Vantage Pointe, 6100 Vantage Pointe Vinyl Casement (Left or Right Hinge)
<b>Limits of Use</b> Approved for use in HVHZ: No Approved for use outside HVHZ: Yes Impact Resistant: No Design Pressure: +55/-55 Other: 36x72		<b>Certification Agency Certificate</b> <a href="#">FL107 R10 C CAC 08-10 08-20 waiver to 08-09.pdf</a> <a href="#">FL107 R10 C CAC Sim 08-09 CS 36x72 R55.pdf</a> <b>Quality Assurance Contract Expiration Date</b> 10/05/2014 <b>Installation Instructions</b> <a href="#">FL107 R10 II IN0052 08-09 08-10 08-20 CS 2X.pdf</a> Verified By: American Architectural Manufacturers Association Created by Independent Third Party: <b>Evaluation Reports</b> Created by Independent Third Party:
107.4	08-09, 08-10, 08-20	Reflections 5500, Prism Platinum, Generations, Impressions 9800, Sears 9300, Grand Estates Premium Plus/Premier, Grandura, 6100 Vantage Pointe, 6500 Vantage Point Vinyl Casement T-Mulled Triple
<b>Limits of Use</b> Approved for use in HVHZ: No Approved for use outside HVHZ: Yes Impact Resistant: No Design Pressure: +50/-50 Other: 105x63		<b>Certification Agency Certificate</b> <a href="#">FL107 R10 C CAC 08-09 CS Triple 105x63 R PG50.pdf</a> <a href="#">FL107 R10 C CAC 08-10 08-20 waiver to 08-09.pdf</a> <b>Quality Assurance Contract Expiration Date</b> 04/24/2017 <b>Installation Instructions</b> <a href="#">FL107 R10 II IN0325 08-09 08-10 08-20 CS Triple 2X.pdf</a> Verified By: American Architectural Manufacturers Association Created by Independent Third Party: <b>Evaluation Reports</b> Created by Independent Third Party:
107.5	42-19	ProFinish Brickmould 600 Vinyl Casement

**MODEL DESIGNATION:** Simonton Casement Series 08-08 Vinyl Window

**MAXIMUM OVERALL NOMINAL SIZE:** See Size Chart

**DESIGN PRESSURE RATING:** See Size Chart

**USABLE CONFIGURATIONS:** XXX

**GENERAL DESCRIPTION:** The head, sill, and side jambs are extruded PVC. The wall thickness through which the anchor screw penetrates is a minimum of 0.120".

B

A

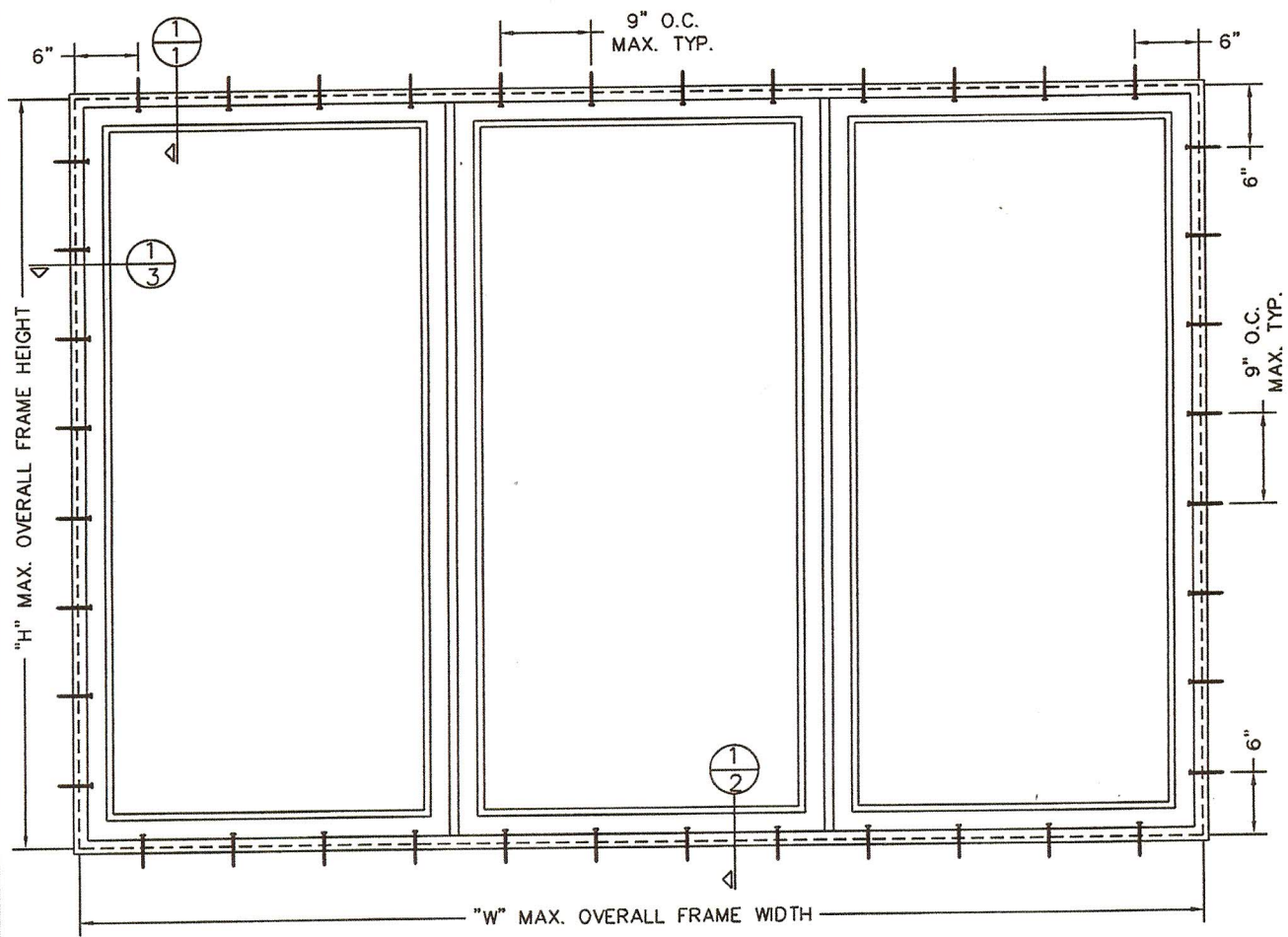

- NOTES:**
1. This installation shall follow ASCE 7 Minimum Wind Speed.
  2. For installation in concrete, anchors must be set in a minimum of 4 inches of concrete.
  3. All interior surfaces shall be primed and painted.
  4. Adjust Tapes to provide proper drainage.
  5. When the operation is in the open position, the substrate shall be protected.
  6. Anchors shall be installed in concrete such that the embedment depth is a minimum of 4 inches.
  7. Wood bucks shall be used such that the window is supported from the exterior.
  8. Follow ITW/EI instructions for installation.
  9. The responsibility for proper installation shall be solely with the installer.
  10. For wood bucks, use a minimum of 2x4s.
  11. A. Concrete  
B. Concrete  
C. Wood Minimum
  12. Shims are required.
  13. When using wood bucks, use 2x4s.
  14. When used in concrete, use 2x4s.
  15. Flashing shall be installed.
  16. Glazing shall be installed.

SIZE CHART		
OVERALL SIZE		DP RATING
WIDTH "W"	HEIGHT "H"	
107"	72"	±45 PSF
101"	63"	±50 PSF

5-19-014  
 Hermes F. Noferc, P.E.  
 Florida P.E. No. 73478  
 Building Group, Inc.  
 398 E. Ocean Beach Blvd., Ste. 333  
 Ocean Beach, FL 33004  
 FBPE Cert. of Authorization No. 29573

**DISCLOSURE STATEMENT**  
 This document is the property of Simonton Windows. It remains the property of Simonton Windows and all proprietary and other rights to it are reserved. This document is provided to the recipient on the condition that it is not to be disclosed, reproduced, or used in conjunction with the design or repair of goods for anyone other than Simonton Windows without its consent. This restriction does not affect the recipient's rights to utilize information contained in this document which is properly obtained from Simonton Windows.

FILE: IN0435

3/16"Ø TAPCON ANCHOR WITH 1.25" MIN. EMB. INTO CONCRETE (SEE NOTE 10 FOR WOOD)

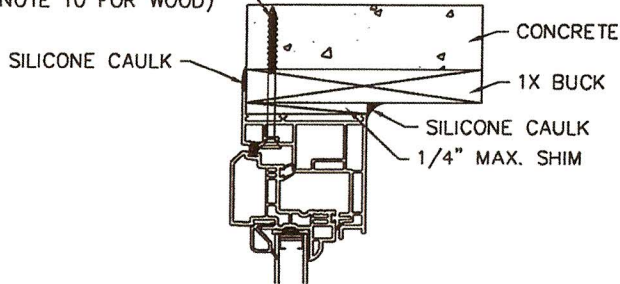

1 HEAD  
1 4X SCALE

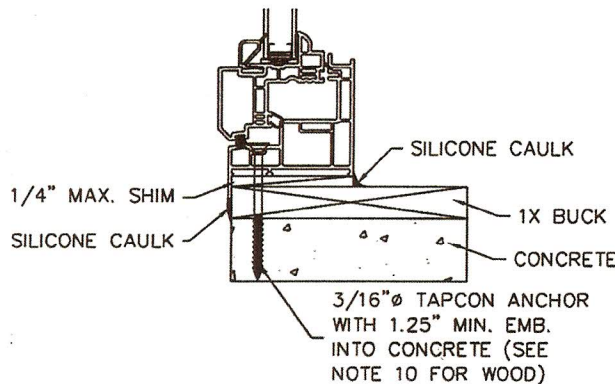

1 SILL  
2 4X SCALE

REV. #:	REVISIONS:	REVISED BY:	DATE:
1	ADDED NOTES 15 & 16.	T.D.D.	12/08/11
.	.	.	.
.	.	.	.
.	.	.	.

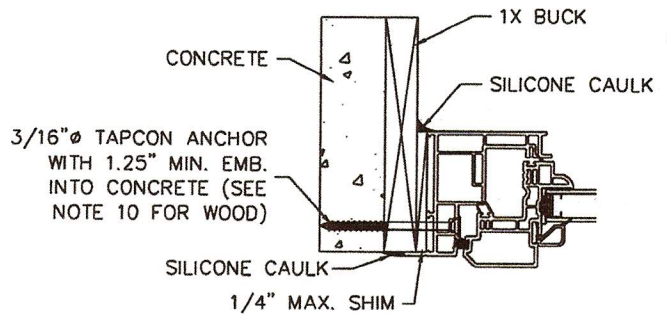

1 JAMB  
3 4X SCALE

Installation has been evaluated for use in locations adhering to the Florida Building Code and where design pressure requirements as determined by Minimum Design Loads for Buildings and Other Structures do not exceed the design pressure ratings listed herein. Installation where the sub-buck is less than 1 1/2" (FBC chapter 17 Anchorage Methods) Tapcon type concrete anchors must be used and the length must be such that a minimum 1 1/4" embedment of the Tapcon into the concrete or concrete block is obtained, unless otherwise noted. Anchors should be a minimum of 2 1/2" from the edge of the concrete, hollow block CMU, or concrete block. Interior and exterior perimeter surfaces of the window must be caulked.

When Tapcon anchor locations, if necessary, to maintain a minimum of 2.0" clearance from mortar joints. If optional head expanders are used, the INSTALLER MUST ADJUST the anchor lengths to maintain the required minimum embedment into the concrete.

Anchor lengths shall be specified and spaced as shown. Anchor embedment to base material shall be beyond wall dressing or stucco and into wood or concrete. Buck anchors (by others) must be engineered and anchored properly to transfer loads to the structure. Bucks shall extend beyond interior face of frame at full support of the frame is provided.

Follow W/Elco Tapcon anchoring instructions.

Responsibility for selection of Simonton Products to meet any applicable local laws, building codes, ordinances, or other safety requirements rests with the architect, building owner, or contractor.

On wood buck substrates, use #10 wood screws with 1 1/2" min. embedment into wood, unless otherwise noted. Screws should be a minimum of 3/4" from edge of the wood.

Concrete compressive strength = 3000 PSI at 28 days.

Concrete Masonry Units shall conform with strength requirements of ASTM C90.

Minimum Specific Gravity = 0.55

Shims are optional. Max. shim stack is 1/4".

When using a 3/16"Ø Tapcon or #10 wood screw through the window frame, pre-drill the thru hole at specified installation screw locations.

Used in areas requiring impact protection, this product REQUIRES the use of approved impact resistant shutters or other external protection.

Installation should be applied using the ASTM E 2112 method appropriate for the opening into which the window is being installed.

Installation shall comply with ASTM E 1300-04.

MATERIAL:		Dimensional Tolerances Unless Otherwise Specified	SIMONTON® WINDOWS 1 Cochrane Avenue Pennsboro, WV 26415	SIZE:	DRAWING NO.:	REV.:
RMS FINISH:	EXCEPT AS NOTED			Decimals	Angles	B
ALLOY & TEMPER:		.X ± .03	0° 30 min.	DRAWN BY:	T.D.D.	DATE:
WEIGHT:	VOLUME:	.XX ± .01		CHECKED BY:		09/16/09
SURFACE AREA:	PERIMETER:	.XXX ± .005		APPR'VD BY:		DATE:
FINISH TREATMENT:				SCALE:	SHEET:	
				FIT	1 of 1	
				SERIES:	08-08 TRIPLE T-MULLED CASEMENT	
				TITLE:	1X BUCK INSTALLATION	

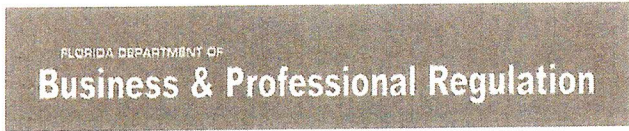

BCIS Home | Log In | User Registration | Hot Topics | Submit Surcharge | Stats & Facts | Publications | FBC Staff | BCIS Site Map | Links | Search



License efficiently. Regulate fairly. Product Approval Menu > Product or Application Search > Application List > Application Detail

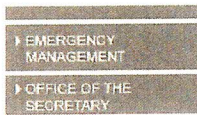

FL #	FL12117-R2	
Application Type	Revision	12117.4
Code Version	2010	
Application Status	Approved	
Comments		
Archived		
Product Manufacturer	Simonton Windows	
Address/Phone/Email	1 Cochrane Ave Pennsboro, WV 26415 (800) 746-6687 Ext 2329 tiffany_davies@simonton.com	
Authorized Signature	Tiffany Davies tiffany_davies@simonton.com	
Technical Representative	Tiffany Davies	
Address/Phone/Email	PO Box 1646 5300 Briscoe Road Parkersburg, WV 26102 (800) 542-9118 Ext 9329 tiffany_davies@simonton.com	
Quality Assurance Representative	AAMA	
Address/Phone/Email	1827 Walden Office Square Suite 550 Schaumburg, IL 60173 (847) 303-5664 webmaster@aamanet.org	
Category	Windows	
Subcategory	Mullions	
Compliance Method	Evaluation Report from a Florida Registered Architect or a Licensed Florida Professional Engineer <input checked="" type="checkbox"/> Evaluation Report - Hardcopy Received	
Florida Engineer or Architect Name who developed the Evaluation Report	Charles Anthony Pagen	
Florida License	PE-49121	
Quality Assurance Entity	Architectural Testing, Inc.	
Quality Assurance Contract Expiration Date	12/31/2014	
Validated By	Shawn G. Collins, PE <input checked="" type="checkbox"/> Validation Checklist - Hardcopy Received	
Certificate of Independence	<a href="#">FL12117 R2 COI PER Stand Alone Mullions.pdf</a>	
Referenced Standard and Year (of Standard)		
Equivalence of Product Standards Certified By		

Sections from the Code

1714.1

Product Approval Method

Method 2 Option B

Date Submitted

02/21/2012

Date Validated

02/28/2012

Date Pending FBC Approval

03/12/2012

Date Approved

04/03/2012

Summary of Products		
FL #	Model, Number or Name	Description
12117.1	V346A Mullion/16990 Reinforcement	Aluminum reinforced vinyl mullions
<b>Limits of Use</b> Approved for use in HVHZ: No Approved for use outside HVHZ: Yes Impact Resistant: No Design Pressure: N/A Other: Various performance ratings: See installation instructions for sizes and applicable design pressure ratings.		<b>Installation Instructions</b> <a href="#">FL12117 R2 II RM0015B Stand Alone Mullions.pdf</a> Verified By: Charles Anthony Pagen P.E. 49121 Created by Independent Third Party: Yes <b>Evaluation Reports</b> <a href="#">FL12117 R2 AE PER Stand Alone Mullions.pdf</a> Created by Independent Third Party: Yes
12117.2	VPI 436 Mullion/20634 Reinforcement	Aluminum reinforced vinyl mullions
<b>Limits of Use</b> Approved for use in HVHZ: No Approved for use outside HVHZ: Yes Impact Resistant: No Design Pressure: N/A Other: Various performance ratings: See installation instructions for sizes and applicable design pressure ratings.		<b>Installation Instructions</b> <a href="#">FL12117 R2 II RM0015B Stand Alone Mullions.pdf</a> Verified By: Charles Anthony Pagen P.E. 49121 Created by Independent Third Party: Yes <b>Evaluation Reports</b> <a href="#">FL12117 R2 AE PER Stand Alone Mullions.pdf</a> Created by Independent Third Party: Yes
12117.3	VPI 573 Mullion/CM0146 Reinforcement	Aluminum reinforced vinyl mullions
<b>Limits of Use</b> Approved for use in HVHZ: No Approved for use outside HVHZ: Yes Impact Resistant: No Design Pressure: N/A Other: Various performance ratings: See installation instructions for sizes and applicable design pressure ratings.		<b>Installation Instructions</b> <a href="#">FL12117 R2 II RM0015B Stand Alone Mullions.pdf</a> Verified By: Charles Anthony Pagen p.E. 49121 Created by Independent Third Party: Yes <b>Evaluation Reports</b> <a href="#">FL12117 R2 AE PER Stand Alone Mullions.pdf</a> Created by Independent Third Party: Yes
12117.4	VPI-354 or VPI-560 Mullion/16991 Reinforcement	Aluminum reinforced vinyl mullions
<b>Limits of Use</b> Approved for use in HVHZ: No Approved for use outside HVHZ: Yes Impact Resistant: No Design Pressure: N/A Other: Various performance ratings: See installation instructions for sizes and applicable design pressure ratings.		<b>Installation Instructions</b> <a href="#">FL12117 R2 II RM0015B Stand Alone Mullions.pdf</a> Verified By: Charles Anthony Pagen P.E. 49121 Created by Independent Third Party: Yes <b>Evaluation Reports</b> <a href="#">FL12117 R2 AE PER Stand Alone Mullions.pdf</a> Created by Independent Third Party: Yes

Back

Next

Contact Us :: 1940 North Monroe Street, Tallahassee FL 32399 Phone: 850-487-1824

The State of Florida is an AA/EEO employer. Copyright 2007-2010 State of Florida. :: [Privacy Statement](#) :: [Accessibility Statement](#) :: [Refund Statement](#)

Under Florida law, e-mail addresses are public records. If you do not want your e-mail address released in response to a public-records request, do not send electronic mail to this entity. Instead, contact the office by phone or by traditional mail. If you have any questions regarding DBPR's ADA web accessibility, please contact our Web Master at [webmaster@dbpr.state.fl.us](mailto:webmaster@dbpr.state.fl.us).

Product Approval Accepts:



**SIMONTON**  
 1 CORNING INC. FARMING, NY 2048  
 PC 02-02-001  
 EXTRUDED NON-IMPACT VINYL MULLIONS  
 WITH ALUMINUM REINFORCEMENT  
 ALL NON-IMPACT VINDIV SERIES

MULLIONS MEET THE REQUIREMENTS OF THE 2010  
 FLORIDA BUILDING CODE.

REVISIONS			
REV.	DESCRIPTION	DATE	BY
1	REVISED WORKING AT CHARTS (SHEETS 2-5)	4/4/2007	GLS
2	Revised per 2007 Florida Building Code, Added Sheet 7.	12/15/2008	TBD
3	Revised per 2007 Florida Building Code, Added Sheet 8.	04/15/2011	JRH
4	Revised per 2010 Florida Building Code, updated general notes.	01/20/2012	CAP

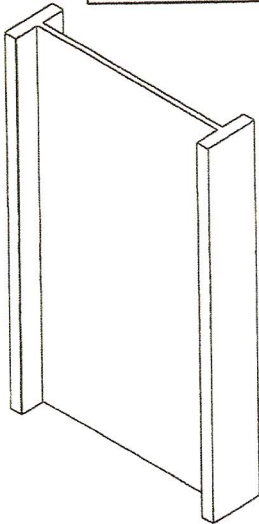

LARGE MULL REINFORCEMENT CM0146  
 ALUMINUM 6063-T6

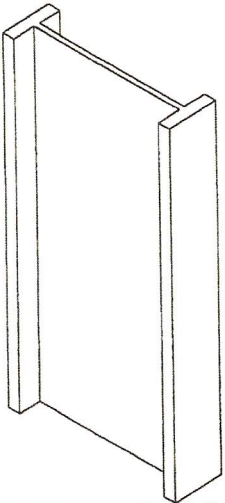

LARGE MULL REINFORCEMENT #16991  
 ALUMINUM 6063-T6



MEDIUM MULL REINFORCEMENT #16990  
 ALUMINUM 6063-T6

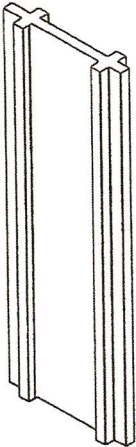

MEDIUM MULL REINFORCEMENT #20634  
 ALUMINUM 6063-T6



ALL FIN & J FRAMES H-MULLION  
 LARGE VINYL MULLION COVER #VPI-573  
 EXTRUDED VINYL .071" MIN.



PROFILE FINISH H-MULLION  
 LARGE VINYL MULLION COVER #VPI-560  
 EXTRUDED VINYL .079" MIN.

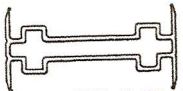

NEW CONSTRUCTION H-MULLION  
 MEDIUM VINYL MULLION COVER #V346A  
 EXTRUDED VINYL .071" MIN.

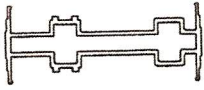

RETROFIT HOOKED FRAMES MULLION  
 MEDIUM VINYL MULLION COVER #VPI-436  
 EXTRUDED VINYL .070" MIN.



ALL RETROFIT H-MULLION  
 LARGE VINYL MULLION COVER #VPI-354  
 EXTRUDED VINYL .071" MIN.

TABLE OF CONTENTS	
SHEET	DESCRIPTION
1	INDIVIDUAL MULLION APPLICATIONS
2	DESIGN PRESSURES FOR REINFORCEMENT CM0146
3	DESIGN PRESSURES FOR REINFORCEMENT 16991
4	DESIGN PRESSURES FOR REINFORCEMENT 16990
5	DESIGN PRESSURES FOR REINFORCEMENT 20634
6	MULLION ATTACHMENT AND ANCHORING
7	MULLION CROSS SECTIONS-WOOD FRAME SUBSTRATE
8	MULLION CROSS SECTIONS-MASONRY/CONCRETE SUBSTRATE

**PRODUCT DESCRIPTION:**

1. ALL MULLION REINFORCEMENTS ARE EXTRUDED ALUMINUM 6063-T6.
2. ALL MULLIONS ARE EXTRUDED VINYL. SEE ABOVE FOR INDIVIDUAL MULLION THICKNESS.

**GENERAL NOTES:**

1. THE FOUR (4) MULLION PRODUCTS MEET THE 2010 FLORIDA BUILDING CODE.
2. PRODUCT ANCHORS SHALL BE AS LISTED AND SPACED AS SHOWN ON DETAILS.

CHARLES A. BAGLEY, P.E.  
 FLA. REG. ENG. #10921  
 DATE: 12-20-12

**SIMONTON**  
 1 CORNING INC. FARMING, NY 2048  
 PC 02-02-001

REV	DATE
1	3-20-06
2	12/15/08
3	04/15/11
4	01/20/12

**SIMONTON**  
 1. EXTRUDED VINYL MULLIONS WITH ALUMINUM REINFORCEMENT  
 ALL NON-IMPACT WINDOW SERIES

REVISIONS			
REV.	DESCRIPTION	DATE	BY
1	REVISED WORKING AT CHARTS (SHEETS 2-5)	4/4/2007	GLS
2	REVISED PER 2007 FLORIDA BUILDING CODE, ADDED SHEET 7	12/15/2008	TDB
3	REVISED PER 2007 FLORIDA BUILDING CODE, ADDED SHEET 8	04/15/2011	JRM
4	REVISED PER 2010 FLORIDA BUILDING CODE, UPDATED GENERAL NOTES	01/20/2012	CAP

△ TOTAL TWO (2) WINDOW UNITS WIDTH (INCHES)

	144"	136"	124"	116"	104"	96"	84"	72"	64"	56"	48"
96"	22.5	23.1	24.2	25.0	26.7	28.2	30.9	34.7	38.0	42.4	48.3
92"	24.1	24.7	25.7	26.6	28.4	29.8	32.6	36.5	40.0	44.6	50.7
88"	26.0	26.5	27.5	28.4	30.2	31.7	34.6	38.6	42.3	47.0	53.4
84"	28.2	28.6	29.6	30.5	32.3	33.8	36.8	41.0	44.7	49.7	56.3
80"	30.7	31.1	32.0	32.9	34.7	36.2	39.3	43.6	47.5	52.7	59.6
76"	33.8	34.1	34.9	35.7	37.4	39.0	42.1	46.6	50.7	56.1	63.4
72"	37.6	37.7	38.3	39.0	40.7	42.3	45.4	50.1	54.3	59.9	67.6
68"	42.1	42.1	42.4	43.0	44.6	46.1	49.3	54.1	58.5	64.4	72.4
64"	47.5	47.5	47.6	48.0	49.3	50.7	53.9	58.8	63.4	69.5	75.0
60"	54.1	54.1	54.1	54.1	55.1	56.3	59.4	64.4	69.1	75.0	75.0
56"	62.1	62.1	62.1	62.1	62.4	63.4	66.2	71.2	75.0	75.0	75.0
52"	72.0	72.0	72.0	72.0	72.0	72.4	74.8	75.0	75.0	75.0	75.0
48"	75.0	75.0	75.0	75.0	75.0	75.0	75.0	75.0	75.0	75.0	75.0
44"	75.0	75.0	75.0	75.0	75.0	75.0	75.0	75.0	75.0	75.0	75.0
40"	75.0	75.0	75.0	75.0	75.0	75.0	75.0	75.0	75.0	75.0	75.0

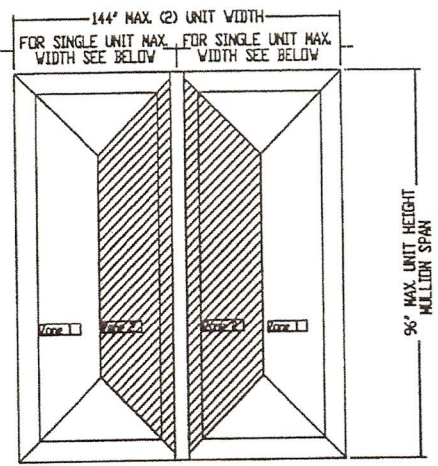

MULLION SPAN OVERALL UNIT HEIGHT (INCHES)

△ TABLE A - MAXIMUM DESIGN PRESSURES (PSF) MULLION # CH0146

MAXIMUM SINGLE WINDOW WIDTH

WINDOW TYPE	WINDOW WIDTH
SINGLE HUNG	56"
DOUBLE HUNG	56"
HORIZONTAL SLIDER	72"
CASHEM	32"
FIXED	96"

MULLION TRIBUTARY WIDTH = ONE (1) WINDOW WIDTH

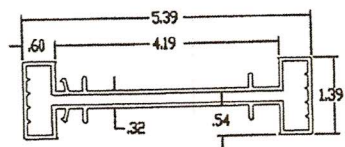

ALL FIN & J FRAMES H-MULLION  
 LARGE VINYL MULLION COVER #VPI-573  
 EXTRUDED VINYL .071" MIN

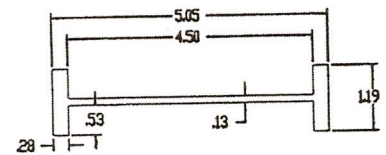

LARGE MULL REINFORCEMENT #CH0146  
 ALUMINUM 6063-T6

- NOTES:
- WOOD FRAME USE (4) #10 X 1 3/4" WOOD SCREWS AT THE HEAD AND SILL WITH 1-1/2" MINIMUM EMBEDMENT INTO WOOD FOR ALUMINUM MULLION.
  - MASONRY/CONCRETE USE (2) 3/16" L.T.W. ADVANCED THREADFORM TECHNOLOGY TAPCON ANCHORS AT HEAD AND SILL WITH 1" MIN. EMBEDMENT FOR CHU, 1 1/2" MINIMUM EMBEDMENT FOR CONCRETE FOR MULLION.
  - TWO (2) BREVETS OR BAGSEL NUTS ARE REQUIRED TO ATTACH L-BRACKETS TO ALUMINUM MULLION. SEE TABLE I SHEET 6A.

CHARLES A. PRINCE, P.E.  
 LICENSE # 1754  
 SIMONTON  
 12/28/08  
 11/28/08  
 11/28/12

**SIMANTON**  
 1 SIMON AC. JENNIFER, W. 246  
 AL 35-25-000  
 EXTRUDED NON-IMPACT VINYL MULLIONS  
 WITH ALUMINUM REINFORCEMENT  
 ALL NON-IMPACT VINDOV SERIES

REVISIONS			
REV.	DESCRIPTION	DATE	BY
1	REVISED WORKING AT CHARTS (SHEETS 2-5)	4/4/2007	GLS
2	Revised per 2007 Florida Building Code, Added Sheet 7.	12/15/2008	TBD
3	Revised per 2007 Florida Building Code, Added Sheet 8.	04/15/2011	JRH
4	Revised per 2010 Florida Building Code, updated general notes sht. 1.	01/20/2012	CAF

△ TOTAL TWO (2) WINDOW UNITS WIDTH (INCHES)

	144"	136"	124"	116"	104"	96"	84"	72"	64"	56"	48"
96"	22.5	23.1	24.2	25.0	26.7	28.2	30.9	34.7	38.0	42.4	48.3
92"	24.1	24.7	25.7	26.6	28.4	29.8	32.6	36.5	40.0	44.6	50.7
88"	26.0	26.5	27.5	28.4	30.2	31.7	34.6	38.6	42.3	47.0	53.4
84"	28.2	28.6	29.6	30.5	32.3	33.8	36.8	41.0	44.7	49.7	56.3
80"	30.7	31.1	32.0	32.9	34.7	36.2	39.3	43.6	47.5	52.7	59.6
76"	33.8	34.1	34.9	35.7	37.4	39.0	42.1	46.6	50.7	56.1	63.4
72"	37.6	37.7	38.3	39.0	40.7	42.3	45.4	50.1	54.3	59.9	67.6
68"	42.1	42.1	42.4	43.0	44.6	46.1	49.3	54.1	58.5	64.4	72.4
64"	47.5	47.5	47.6	48.0	49.3	50.7	53.9	58.8	63.4	69.5	75.0
60"	54.1	54.1	54.1	54.1	55.1	56.3	59.4	64.4	69.1	75.0	75.0
56"	62.1	62.1	62.1	62.1	62.4	63.4	66.2	71.2	75.0	75.0	75.0
52"	72.0	72.0	72.0	72.0	72.0	72.4	74.8	75.0	75.0	75.0	75.0
48"	75.0	75.0	75.0	75.0	75.0	75.0	75.0	75.0	75.0	75.0	75.0
44"	75.0	75.0	75.0	75.0	75.0	75.0	75.0	75.0	75.0	75.0	75.0
40"	75.0	75.0	75.0	75.0	75.0	75.0	75.0	75.0	75.0	75.0	75.0

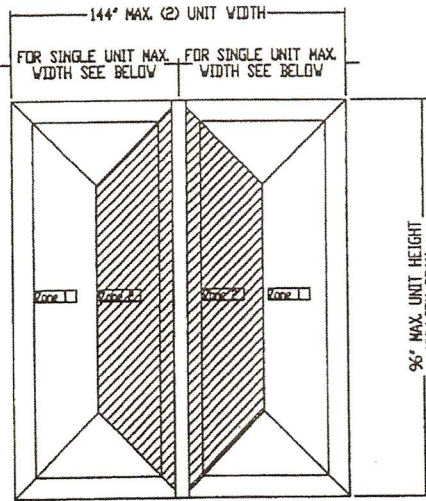

MULLION SPAN OVERALL UNIT HEIGHT (INCHES)

△ TABLE B - MAXIMUM DESIGN PRESSURES (PSF)  
 MULLION #16991

MAXIMUM SINGLE WINDOW WIDTH	
WINDOW TYPE	WINDOW WIDTH
SINGLE HUNG	50"
DOUBLE HUNG	50"
HORIZONTAL SLIDER	72"
CASHER	36"
FIXED	36"

MULLION TERTIARY WIDTH = ZONE 2 WINDOW WIDTHS

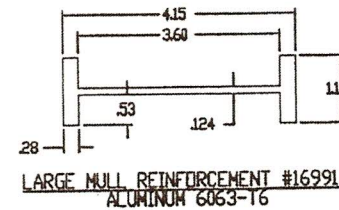
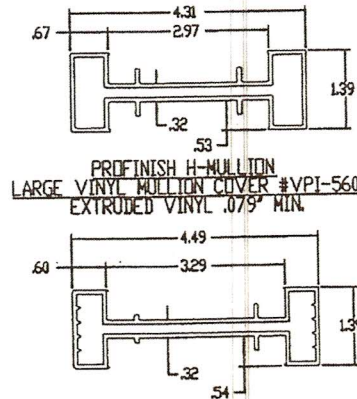

- NOTES
- WOOD FRAME USE 60 #10 X 1 3/4" WOOD SCREWS AT THE HEAD AND SILL WITH 1-1/2" MINIMUM EMBEDMENT INTO WOOD FOR ALUMINUM MULLION.
  - MASONRY/CONCRETE USE (2) 3/16" I.T.V. ADVANCED THREADFORM TECHNOLOGY TAPCON ANCHORS AT HEAD AND SILL WITH 1" MIN. EMBEDMENT FOR CMU, 1 1/2" MINIMUM EMBEDMENT FOR CONCRETE FOR MULLION.
  - TWO (2) REVETS OR BARREL NUTS ARE REQUIRED TO ATTACH L-BRACKETS TO ALUMINUM MULLION. SEE TABLE 1 (SHEET 6).

ALL RETROFIT H-MULLION  
 LARGE VINYL MULLION COVER #VPI-354  
 EXTRUDED VINYL .071" MIN.

ALABAMA ARCHITECTURE LICENSE

*Charles A. Bagen, P.E.*

CHARLES A. BAGEN, P.E.  
 REGISTERED PROFESSIONAL ENGINEER  
 STATE OF ALABAMA  
 LICENSE NO. 12012

SIMANTON  
 1 SIMON AC. JENNIFER, W. 246  
 AL 35-25-000

DATE: 12/18/08  
 BY: JRH  
 CHECKED: JRH  
 DATE: 12/18/08

REVISIONS			
REV.	DESCRIPTION	DATE	BY
1	REVISED WINDOW AT CHARTS SHEETS 2-3	4/14/2007	GLS
2	REVISED PER 2007 Florida Building Code, Added Sheet 8.	12/15/2008	TBB
3	REVISED PER 2007 Florida Building Code, Added Sheet 8.	04/15/2011	JRH
4	REVISED PER 2010 Florida Building Code, Updated general notes spt. 1.	01/20/2012	CAP

△ TOTAL TWO(2) WINDOW UNITS WIDTHS (INCHES)

MULLION SPAN OVERALL UNIT HEIGHT (INCHES)	144"	136"	124"	116"	104"	96"	84"	72"	64"	56"	48"
76"	16.8	17.0	17.5	18.0	19.1	20.0	22.0	24.8	27.3	30.7	35.3
72"	20.8	20.9	21.3	21.8	22.9	24.0	26.2	29.5	32.4	36.4	41.7
68"	26.1	26.1	26.4	26.8	28.0	29.2	31.7	35.4	38.9	43.5	49.8
64"	33.3	33.3	33.3	33.6	34.8	36.1	38.9	43.1	47.2	52.6	60.1
60"	43.1	43.1	43.1	43.1	44.1	45.3	48.4	53.4	58.1	64.6	73.6
56"	56.8	56.8	56.8	56.8	57.1	58.2	61.5	67.2	72.8	75.0	75.0
52"	72.0	72.0	72.0	72.0	72.0	72.4	74.8	75.0	75.0	75.0	75.0
48"	75.0	75.0	75.0	75.0	75.0	75.0	75.0	75.0	75.0	75.0	75.0
44"	75.0	75.0	75.0	75.0	75.0	75.0	75.0	75.0	75.0	75.0	75.0
40"	75.0	75.0	75.0	75.0	75.0	75.0	75.0	75.0	75.0	75.0	75.0

△ TABLE C - MAXIMUM DESIGN PRESSURES (PSF) MULLION #16990

**SIMONTON**  
 17000 W. UNIVERSITY BLVD  
 TAMPA, FL 33613  
 (813) 971-1000

EXTRUDED NON-IMPACT VINYL MULLIONS WITH ALUMINUM REINFORCEMENT ALL NON-IMPACT WINDOW SERIES

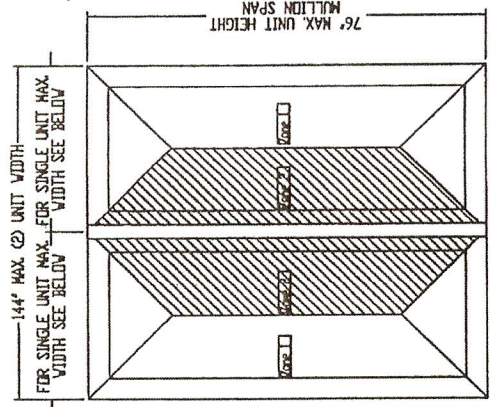

MAXIMUM SINGLE WINDOW WIDTH

WINDOW TYPE	WINDOW WIDTH
SHEET GLASS	60"
DOUBLE GLASS	54"
INSULATED GLASS	54"
CLIMATE CONTROL	54"
FIXED	54"

MULLION REINFORCEMENT - ZONE 2 WINDOW WIDTHS

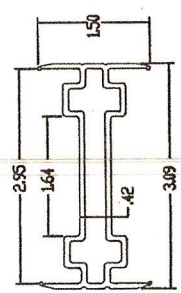

MEDIUM H-MULLION VINYL COVER #V346A  
 ALL NEW CONSTRUCTION  
 EXTRUDED VINYL .071" MIN

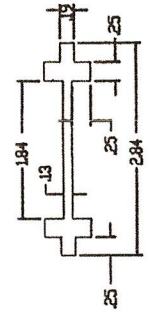

MEDIUM MULLION REINFORCEMENT #16990  
 ALUMINUM 6063-T6

- NOTES
1. WINDOW FRAMES USE (3) 480 X 1.3/4" WOOD SCREWS AT THE HEAD AND SILL WITH 1-1/2" MINIMUM EMBEDMENT INTO WOOD FOR ALUMINUM MULLION.
  2. CONCRETE/CONCRETE USE (2) 3/16" DIA. ADVANCED TECHNOLOGY TYPICAL ANCHORS AT HEAD AND SILL WITH 1" MIN EMBEDMENT FOR CMU, 1 1/2" MINIMUM EMBEDMENT FOR CONCRETE FOR MULLION.
  3. TWO (2) BOLTS OR BARREL NUTS ARE REQUIRED TO ATTACH L-BRACKETS TO ALUMINUM MULLION. SEE TABLE T SHEET 8A.

REGISTERED PROFESSIONAL ENGINEER  
 STATE OF FLORIDA  
 EXPIRES 12/31/2012

*John P. ...*

FL. REG. ENG. NO. 16676  
 DATE: 07/26/12

ALL MULLION PRODUCTS  
 ARE MANUFACTURED BY  
 SIMONTON

**SIMMONTON**  
 1 CEDAR AVE. WINNERS, VA 2440  
 (540) 863-2200

EXTRUDED NON-IMPACT VINYL MULLIONS  
 WITH ALUMINUM REINFORCEMENT  
 ALL NON-IMPACT WINDOW SERIES

REVISIONS			
REV.	DESCRIPTION	DATE	BY
1	REVISION WORKING AT CHARTS (SHEETS 2-5)	4/4/2007	ELS
2	Revised per 2007 Florida Building Code, Added Sheet 7.	12/15/2008	TMO
3	Revised per 2007 Florida Building Code, Added Sheet 8.	04/15/2011	JRN
4	Revised per 2011 Florida Building Code, updated general notes sheet 1.	01/28/2012	CAP

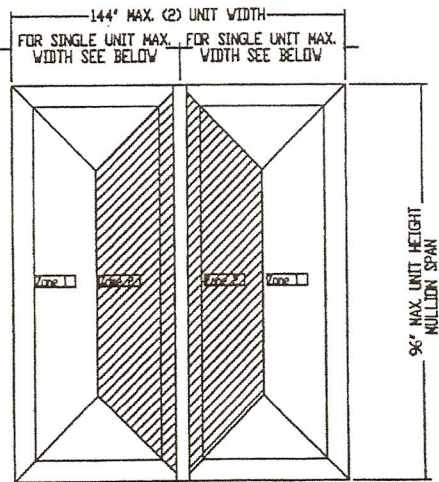

MULLION SPAN OVERALL UNIT HEIGHT (INCHES)

△ TOTAL TWO (2) WINDOW UNITS WIDTH (INCHES)

	144"	136"	124"	116"	104"	96"	84"	72"	64"	56"	48"
76"	17.8	17.9	18.5	19.0	20.2	21.2	23.3	26.2	28.9	32.5	37.3
72"	22.0	22.1	22.5	23.1	24.3	25.4	27.8	31.2	34.3	38.5	44.1
68"	27.6	27.6	27.9	28.4	29.6	30.9	33.5	37.5	41.1	46.0	52.7
64"	35.2	35.2	35.2	35.6	36.8	38.1	41.1	45.6	49.9	55.7	63.6
60"	45.6	45.6	45.6	45.6	46.6	47.9	51.2	56.4	61.5	68.3	75.0
56"	60.0	60.0	60.0	60.0	60.4	61.6	65.0	71.0	75.0	75.0	75.0
52"	72.0	72.0	72.0	72.0	72.0	72.4	74.8	75.0	75.0	75.0	75.0
48"	75.0	75.0	75.0	75.0	75.0	75.0	75.0	75.0	75.0	75.0	75.0
44"	75.0	75.0	75.0	75.0	75.0	75.0	75.0	75.0	75.0	75.0	75.0
40"	75.0	75.0	75.0	75.0	75.0	75.0	75.0	75.0	75.0	75.0	75.0

△ TABLE D - MAXIMUM DESIGN PRESSURES (PSF)  
 MULLION # 20634

MAXIMUM SINGLE WINDOW WIDTH

WINDOW TYPE	WINDOW WIDTH
SINGLE HUNG	96"
DOUBLE HUNG	96"
HORIZONTAL SLIDER	72"
CASMENT	86"
FIXED	96"

MULLION TRIBUTARY WIDTH = ZONE 2 WINDOW WIDTH

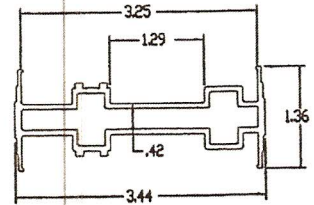

MEDIUM H-MULLION VINYL COVER #VPI-436  
 FOR ANY RETROFIT HUNG FRAME  
 EXTRUDED VINYL .070" MIN.

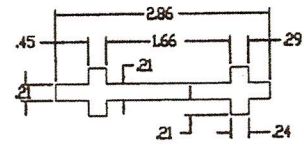

MEDIUM MULL REINFORCEMENT #20634  
 ALUMINUM 6063-T6

- NOTES
- WOOD FRAME USE (4) 8# X 1 3/4" WOOD SCREWS AT THE HEAD AND SILL WITH 1-1/2" MINIMUM EMBEDMENT INTO WOOD FOR ALUMINUM MULLION.
  - MASONRY/CONCRETE USE (2) 3/16" I.T.W. ADVANCED THREADFORM TECHNOLOGY TAPCON ANCHORS AT HEAD AND SILL WITH 1" MIN. EMBEDMENT FOR CHU, 1 1/2" MINIMUM EMBEDMENT FOR CONCRETE FOR MULLION.
  - TWO (2) RIVETS OR BARREL NUTS ARE REQUIRED TO ATTACH L-BRACKETS TO ALUMINUM MULLION. SEE TABLE 1 SHEET 6A.

CHARLES A. RAGAN, P.E.  
 LICENSE

*Charles A. Ragan*

CHARLES A. RAGAN, P.E.  
 FL. REG. ENG. #10257  
 DATE: 12/25/12

SIMMONTON  
 1 CEDAR AVE. WINNERS, VA 2440  
 (540) 863-2200

REV. 3-20-06  
 12/18/08  
 11/28/12

ALL UNITS IN INCHES  
 UNLESS OTHERWISE NOTED





1 CEDARHURST AVE., FORT MONROE, VA 22045  
PH: 800-422-2299

EXTRUDED NON-IMPACT VINYL MULLIONS  
WITH ALUMINUM REINFORCEMENT  
ALL NON-IMPACT WINDOW SERIES

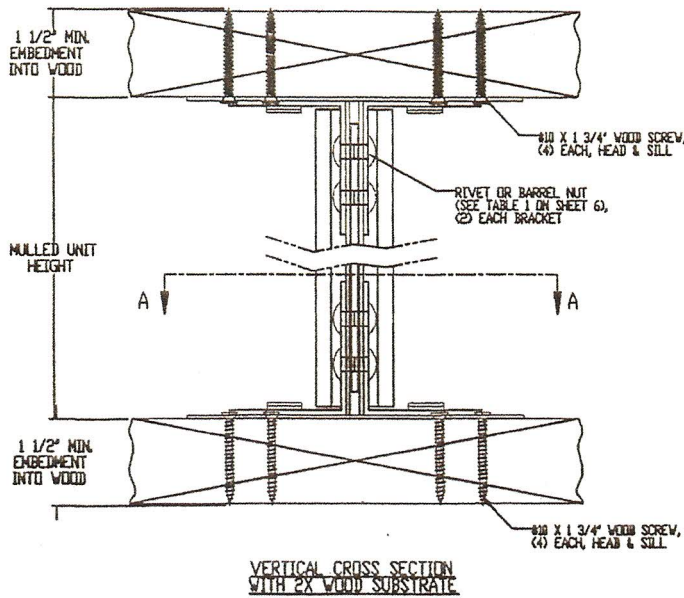

REVISIONS			
REV.	DESCRIPTION	DATE	BY
1	REVISED WORKING AT CHARTS (SHEET 2-5)	4/4/2007	GLS
2	Revised per 2007 Florida Building Code, Added Sheet 7.	12/15/2008	TBD
3	Revised per 2007 Florida Building Code, Added Sheet 8.	04/15/2011	JRH
4	Revised per 2010 Florida Building Code, updated general notes 1.	01/26/2012	CAP

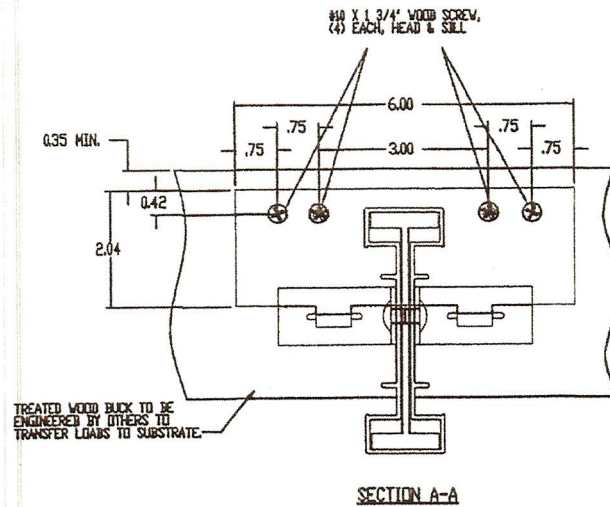

NOTES:

1. THE MULLION PRODUCTS AND THEIR INSTALLATION COMPLY WITH THE 2010 FBC STRUCTURAL REQUIREMENTS AND ARE LIMITED TO USE OUTSIDE THE HVHZ.
2. THE MULLIONS SHALL BE USED IN CONNECTION WITH FBC APPROVED PRODUCTS.
3. ANCHORS SHALL HAVE 1 1/2" MINIMUM EMBEDMENT INTO WOOD.
4. ATTACHMENT OF ALL 2X TREATED WOOD BUCKS SHALL BE ENGINEERED SEPARATELY BY OTHERS.
5. WOOD SHALL BE TREATED #2 SPRUCE, PINE OR FIR.
6. #10 WOOD SCREWS SHALL BE STEEL CONFORMING TO ASTM - A 653.
7. BASE PLATES AND L-BRACKETS ARE STAINLESS STEEL CONFORMING TO AMERICAN NATIONAL STANDARDS INSTITUTE (ANSI) 302/304.
8. SIMILAR INSTALLATIONS ARE USED ON HEAD AND SILL.
9. WHEN INSTALLED IN LOCATIONS WHERE WINDBORNE DEBRIS PROTECTION REQUIREMENTS EXIST, USE OF AN IMPACT PROTECTIVE SYSTEM IS REQUIRED.

CHARLES A. GREEN, P.E.  
 STATE OF FLORIDA  
 LICENSE NO. 11212  
 DATE 1-2012

SIMONTON WINDOW  
 1 CEDARHURST AVE., FORT MONROE, VA 22045  
 TEL: 800-422-2299  
 FAX: 800-422-2299  
 WWW.SIMONTONWINDOW.COM

**SIMONTON**  
WINDOWS

1 CORDAWE AVE. FORT WORTH, TX 76145  
PH 817-331-1247

EXTRUDED NON-IMPACT VINYL MULLIONS  
WITH ALUMINUM REINFORCEMENT  
ALL NON-IMPACT WINDOW SERIES

REVISIONS			
REV.	DESCRIPTION	DATE	BY
1	REVISED WORKING AT CHARTS (SHEETS 9 - 9)	4/4/2007	GLS
2	Revised per 2007 Florida Building Code, Added Sheet 7.	12/15/2008	TBB
3	Revised per 2010 Florida Building Code, Added Sheet 8.	04/15/2011	JRH
4	Revised per 2010 Florida Building Code, updated general notes sht. 1.	01/20/2012	CAP

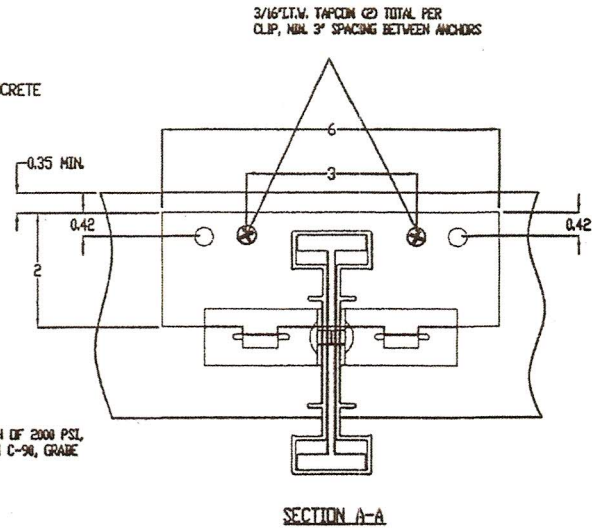
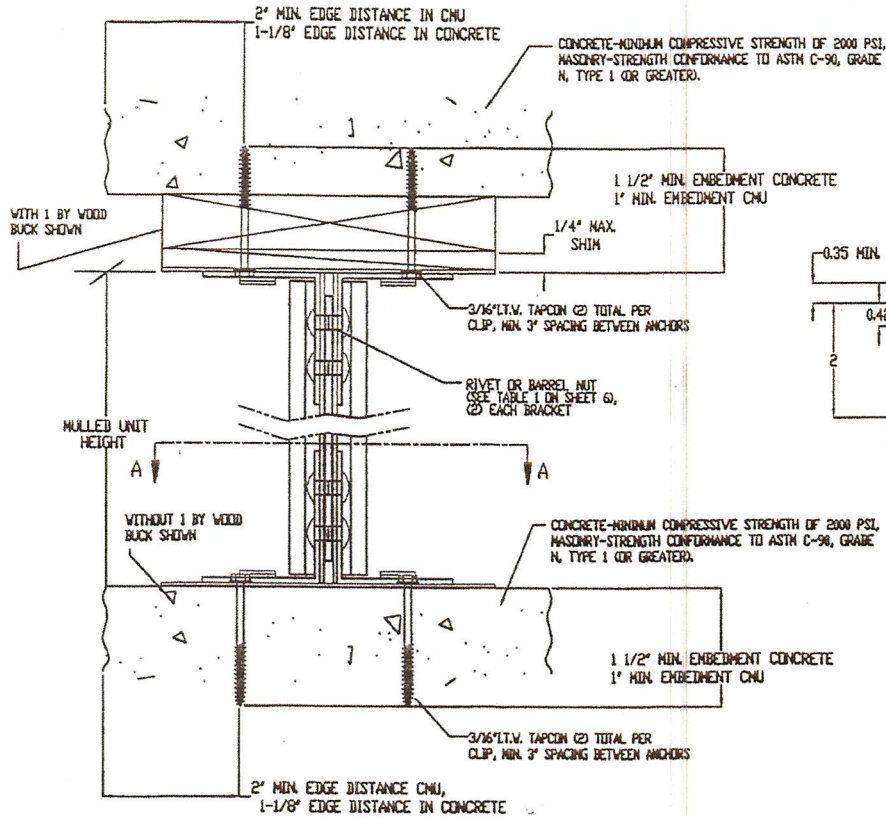

**VERTICAL CROSS SECTION  
WITH MASONRY/CONCRETE  
SUBSTRATE**

**NOTES**

1. THE MULLION PRODUCTS AND THEIR INSTALLATION COMPLY WITH THE 2010 IRC STRUCTURAL REQUIREMENTS AND ARE LIMITED TO USE OUTSIDE THE HVHZ.

2. THE MULLIONS SHALL BE USED IN CONNECTION WITH FCC APPROVED PRODUCTS.

3. ANCHORS SHALL HAVE 1" MINIMUM EMBEDMENT FOR CMU BLOCK, 1-1/2" MINIMUM EMBEDMENT FOR CONCRETE.

4. ATTACHMENT OF ALL 1X TREATED WOOD BUCKS SHALL BE ENGINEERED SEPARATELY BY OTHERS.

5. WOOD SHALL BE TREATED BY SPRUCE, PINE, OR FIR.

6. 3/16" L.T.V. ADVANCED THREADBURN TECHNOLOGY TAPCONS OR EQUAL SHALL BE GRADE 5 HEAT TREATED STEEL.

7. BASE PLATES AND L-BRACKETS ARE STAINLESS STEEL CONFORMING TO AMERICAN NATIONAL STANDARDS INSTITUTE (ANSI) 302/304.

8. SIMILAR INSTALLATIONS ARE USED ON HEAD AND SILL.

9. WHEN INSTALLED IN LOCATIONS WHERE WINDBORNE DEBRIS PROTECTION REQUIREMENTS EXIST, USE OF AN IMPACT PROTECTIVE SYSTEM IS REQUIRED.

CHARLES ANTHONY PAGEN, P.E.  
LICENSE  
C. Pagen  
FL REG. ENG. #1212  
DATE 12/12/12  
PROFESSIONAL ENGINEER

SIMONTON  
WINDOWS

REVISED BY  
C-12-11

0.751 gpb  
ALL LETTERS PROTECTED  
18/2012



Searches
Sales Search
Results
Property Record Card
My Favorites

Sign up for e-Notify...

### 2727 Nela Ave < 19-23-30-5892-00-040 >

<p><small>Name(s)</small> <b>Turner Susan H Trust</b></p> <p><small>Mailing Address On File</small> C/O Leslie Johnson 2735 Nela Ave Belle Isle, FL 32809-6174</p> <p><small>Incorrect Mailing Address?</small></p>	<p><small>Physical Street Address</small> <b>2727 Nela Ave</b></p> <p><small>Postal City and Zipcode</small> Orlando, FL 32809</p> <p><small>Property Use</small> 0130 - Sfr - Lake Front</p> <p><small>Municipality</small> Belle Isle</p>
---	---

302319589200040 09/04/2013

Values, Exemptions and Taxes
Property Features
Sales Analysis
Location Info
Market Stats

Update Information

**Property Description** View Plat

NELA ISLE ANNEX R/74 LOT 4 & W 25 FT LOT 5 & LAND ON N TO LAKE

**Total Land Area** 22,646 sqft (+/-) | 0.52 acres (+/-) GIS Calculated Notice

**Land**

Land Use Code	Zoning	Land Units	Unit Price	Land Value	Class Unit Price	Class Value
0130 Sfr - Lake Front	R-1-AA	1 LOT(S)	\$290,000.00	\$290,000	\$0.00	\$290,000

Page 1 of 1 (1 total records)

**Buildings**

Important Information		Structure	
	<b>Model Code:</b> 01 - Single Fam Residence	<b>Actual Year Built:</b> 1954	<b>Gross Area:</b> 2720 sqft
	<b>Type Code:</b> 0103 - Single Fam Class III	<b>Beds:</b> 3	<b>Living Area:</b> 1932 sqft
	<b>Building Value:</b> \$76,471	<b>Baths:</b> 2.5	<b>Exterior Wall:</b> Concrete/Cinder Block
	<b>Estimated New Cost:</b> \$147,060	<b>Floors:</b> 1	<b>Interior Wall:</b> Plastered

Page 1 of 1 (1 total records)

**Extra Features**

Description	Date Built	Units	XFOB Value
BD2 - Boat Dock 2	01/01/1954	1 Unit(s)	\$4,000
BC3 - Boat Cover 3	01/01/1954	1 Unit(s)	\$6,000
PT1 - Patio 1	01/01/1954	1 Unit(s)	\$1,000
FPL2 - Average Fireplace	12/31/2011	1 Unit(s)	\$2,500
SHNV - Shed No Value	12/31/2011	1 Unit(s)	\$0

Page 1 of 1 (5 total records)

This Data Printed on 04/30/2014 and System Data Last Refreshed on 04/29/2014

Site Notice • About Us • Contact Us • OCPAFL Home • Property Search • Exemption FRAUD Hotline

Orange County Property Appraiser • 200 S. Orange Avenue, Suite 1700 • Orlando, FL 32801

Office Hours: 8:00 a.m. to 5:00 p.m. Monday - Friday • Phone: 407.836.5044

Copyright © 2010 Orange County Property Appraiser. All rights reserved.

http://www.ocpafl.org/searches/parcelsearch.aspx

4/30/2014