



City of Belle Isle

Universal Engineering Sciences 3532 Maggie Blvd., Orlando, FL 32811
Tel 407-581-8161 * Fax 407-581-0313 * www.universallengengineering.com

PERMIT CARD - PLEASE POST AT JOB SITE

THIS DOCUMENT BECOMES YOUR PERMIT WHEN PROPERLY VALIDATED

Per FBC 105.3.3: An enforcing authority may not issue a building permit for any building construction, erection, alteration, modification, repair or addition unless the permit either includes on its face or there is attached to the permit the following statement: "NOTICE: In addition to the requirements of this permit, there may be additional restrictions applicable to this property that may be found in the public records of this county, and there may be additional permits required from other governmental entities such as water management districts, state agencies, or federal agencies." The issuance of this permit does not grant permission to violate any applicable City, Orange County, State of Florida and/or Federal codes and/or ordinances. Separate permits are required for Signs, Roofing, Electrical, Gas, Plumbing and Mechanical services. This permit becomes VOID if the work authorized is not commenced within 6 months, or is suspended or abandoned for a period of 6 months after commencement. WORK SHALL BE CONSIDERED SUSPENDED IF AN APPROVED INSPECTION HAS NOT BEEN MADE WITHIN A 6 MONTH PERIOD. PERMISSION IS GRANTED TO DO THE FOLLOWING WORK ACCORDING TO THE CONDITIONS HEREON AND THE APPROVED PLANS AND SPECIFICATIONS, SUBJECT TO COMPLIANCE WITH THE ORDINANCES OF THE CITY OF BELLE ISLE, FLORIDA.

Scope of Work: WINDOW - Replacement

Comments: None

Project Information

Address: 3537 Country Lakes Drive, Belle Isle, FL 32812
Parcel ID: 20-23-30-4980-00-390
Property Owner: Wolek, Vincent & Blanca
Phone Number: None

Company Name: Baxter Restoration, LLC
Contractor Name: Baxter, David
License Number: CGC1514462
Address: 1106 W Central Blvd. Orlando, FL 32805
Phone Number: 407-341-9983

Permit Number: 2014-01-011

Date of Application: 01/06/2014

Date Permit Issued: 01/08/2014

WARNING TO OWNER: "YOUR FAILURE TO RECORD A NOTICE OF COMMENCEMENT MAY RESULT IN YOU PAYING TWICE FOR IMPROVEMENTS TO YOUR PROPERTY. IF YOU INTEND TO OBTAIN FINANCING, CONSULT WITH YOUR LENDER OR AN ATTORNEY BEFORE RECORDING YOUR NOTICE OF COMMENCEMENT." ON THE JOB INSPECTION(S) MUST BE MADE BEFORE PROCEEDING WITH SUBSEQUENT WORK. THIS CARD MUST BE DISPLAYED OUTSIDE AND BE PROTECTED FROM THE WEATHER WHILE BEING VISIBLE FROM THE STREET UNTIL THE FINAL INSPECTIONS HAVE BEEN APPROVED.

BUILDING FEATURES

IMPACT FEES

School \$
Traffic \$

ZONING FEES

Zoning Fee \$

UNIVERSAL ENG - BUILDING FEES

Cert of Occ \$
Demo \$
Building \$
Fence \$
Driveway \$
Shed \$
Window(s) \$114.90
Door(s) \$
PrePower \$
Electrical \$
Temp Pole \$
Plumbing \$
Mechanical \$
Gas \$
Roofing \$
Boat Dock \$
Screen Encl \$
Swimming Pool \$
Sign \$

SURCHARGE FEES

Surcharge Fee \$2.00
Surcharge Fee \$2.00

TOTAL FEES \$118.90

Date Paid 1-9-14

CC or Check # MC 3694

Amount Paid 118.90

The person accepting this permit shall conform to the terms of the application on file and construction shall conform to the requirements of the Florida Building Code (FS 553).

BUILDING INSPECTOR USE ONLY

IF APPLICABLE:

Have Zoning Approval Conditions Been Met? YES NO Have Stormwater Approval Conditions Been Met? YES NO Silt fencing in place? YES NO Turbidity Barrier in place? YES NO

BUILDING

1st Survey specific foundation plan must be onsite before slab pour. Approved Plan on Site? _____ (Footing/Foundation)
2nd _____ (Slab)
3rd _____ (Lintel)(Wall Reinforcing on Masonry Building)
4th _____ (Exterior Framing)(Roof/Wall Sheathing)
5th _____ (Framing) (To be made after Plumbing/ Mechanical/ Electrical Rough-Ins & Windows/Doors Installed)
6th _____ (Insulation to be Made After Roof Installed)
7th _____ (Drywall)
8th _____ (Sidewalk/Driveway)
9th _____ (Other)
10th _____ (Final - After MEP and Other Applicable Finals)

ROOFING

1ST ROOFING Deck Nailing/Dry-in/Flashing _____
2ND ROOFING Covering In-Progress _____
3RD ROOFING Covering Final _____

PLUMBING (Pool-Piping, Solar, Irrigation, Water Treatment Equip, Etc...)

1ST _____ (Underground) 2ND _____ (Sewer)
3RD _____ (Rough-In/Tub Set) 4TH _____ (Final)

CHECK APPROPRIATE BOX

GAS ___ Natural ___ LP MECHANICAL ELECTRICAL LOW VOLTAGE

1st _____ (Rough-In) 2nd _____ (Final)

Inspection requests are to be emailed to BiDscheduling@UniversalEngineering.com; a confirmation email will be sent back to you upon scheduling. Next-Day Inspection requests must be made by 1pm. Please include the following in your request: Permit #, project address, type of inspection, date of the requested inspection, a contact name & a contact phone number. AM or PM may be requested but cannot be guaranteed.



City of Belle Isle
1600 Nela Avenue, Belle Isle, FL 32809
Tel 407-851-7730 * Fax 407-240-2222 * www.cityofbelleislefl.org

Building Permit (Land Use) Application
To be completed as required by State Statute Section 713 and other applicable sections.

PERMIT #

Owner's Name Vincent Wolek Cost of Job 11,400
Owner's Address 3537 County Lakes Dr. Orlando, Fl. 32812-3530

Fee Simple Titleholder's Name (if other than owner's) _____

Address	City	State	Zip Code
Contractor's Name <u>Dario G. Baxter, Baxter Restoration</u>	Architect/Engineer's Name		
Contractor's Address <u>1106 W. Central Blvd, BSLA</u>	Architect/Engineer's Address		
City, State, ZIP <u>ORLANDO, FL 32805</u>	City, State, ZIP		
License # <u>CGC 1514462</u>	License #		
Contact Phone/Cell <u>407-341-9983</u>	Contact Phone/Cell		
Contact Email <u>NATHAN@BAXTERWINDOWS.COM</u>	Contact Email		

WARNING TO OWNER: Your failure to record a Notice of Commencement may result in your paying twice for improvements to your property. A notice of commencement must be recorded if job is \$2500(+) or if A/C Replacement \$7500(+) and posted on the job site before the first inspection. If you intend to obtain financing, consult with your lender or an attorney before recording your Notice of Commencement.

I hereby make Application for Permit as outlined above, and if same is granted I agree to conform to all Division of Building Safety Regulations (www.floridabuilding.org) and City Ordinances (www.municode.com) regulating same and in accordance with plans submitted. The issuance of this permit does not grant permission to violate any applicable City and/or State of Florida codes and/or ordinances. Application is hereby made to obtain a permit to do the work and installations as indicated. I certify that no work or installation has commenced prior to the issuance of a permit and that all work will be performed to meet the standards of all laws regulating construction in this jurisdiction. I understand that a separate permit must be secured for all other construction including ELECTRICAL, MECHANICAL, PLUMBING, GAS, SIGNS, POOLS, ENCLOSURES, ETC.

OWNER'S AFFIDAVIT: I certify that all the foregoing information is accurate and that all work will be done in compliance with all applicable laws regulating construction and zoning.

<p>Owner Signature <u>X Vincent Wolek</u></p> <p>The foregoing instrument was acknowledged before me this <u>12/31/2013</u> by <u>Vincent Wolek</u> who is personally known to me and who produced <u>FLORIDA DRIVERS LICENSE</u> as identification and who did not take an oath.</p> <p>Notary as to Owner State of Florida County of Orange</p> <div style="border: 1px solid black; padding: 5px; text-align: center;"> <p>HOWARD N MEISTER MY COMMISSION # EE042116 EXPIRES November 16, 2014 <small>FloridaNotaryService.com</small> (407) 398-0153</p> </div> <p>Contractor Signature <u>[Signature]</u></p> <p>COMPANY NAME <u>Baxter Restoration</u></p> <p>The foregoing instrument was acknowledged before me this <u>12/31/2013</u> by <u>David G. Baxter</u> who is personally known to me and who produced _____ as identification and who did not take an oath.</p> <p>Notary as to Owner State of Florida County of Orange</p> <div style="border: 1px solid black; padding: 5px; text-align: center;"> <p>HOWARD N MEISTER MY COMMISSION # EE042116 EXPIRES November 16, 2014 <small>FloridaNotaryService.com</small> (407) 398-0153</p> </div>	<p>Impervious Surface Ratio Worksheet</p> <p>Development Zoned A-1, A-2, R-1-AAA, R-1-AA, R-1-A, R-1 per Section 50-74 Impervious Surface Ratio of the City Code</p> <p>1. Total Lot Area (sqft) X 0.35 = Allowable Impervious Area (BASE) Total Lot Area _____ X 0.35= _____ Allowable Impervious Area (BASE) _____</p> <p>2. Calculate the "proposed" impervious area on the lot. This includes the sum of all areas that do not allow direct percolation of rainwater. <i>Examples include house, pool, deck, driveway, accessory building, etc</i></p> <ul style="list-style-type: none"> • House <u>Permit fee 76.60</u> • Driveway <u>Review 38.30</u> • Walkway <u>3% surcharge 345.40</u> • Accessory Buildings <u>Total 118.90</u> • Pool & Spa _____ • Deck & Patio _____ • Other _____ <p>Actual Impervious Area (AIA) _____</p> <p>3. If AIA is less than BASE, subtract AIA from BASE to determine the amount of impervious area that may be added without providing onsite retention.</p> <p>4. If AIA is greater than BASE, then onsite retention <u>must be provided.</u></p> <p>Assuming 7.5 inches of rainfall based on a 24hr 10 year Rain Event (TP-40), the formula is: <u>(7.5 inches rainfall/12 inches p/foot) X (result from line 4) = cubic feet of storage volume needed</u></p>
---	---

CITY OF BELLE ISLE
Permit Application Review Sheet

Permit Number	2014-01-011
Property Owner	Wolek, Vincent & Blanca
Address	3537 Country Lakes Dr
Nature of Improvement	Window Replacement
Received Application	1-6-14
Sent for Stormwater Review	N/A
Stormwater Approved	
Sent for Zoning Review	N/A
Zoning Approved	
Applied for Variance	N/A
Variance Approved	
Sent to BO for Review	1-6-14
Building Official Approved	
Comments	
1.	1-6-14 LW left message w need cost of job & ✓
2.	insurance w/ City of Belle Isle Cert Holder
3.	1-7-14 Permit reviewed WMS
4.	Frame + Final inspection required
5.	
6.	
7.	
8.	
9.	
10.	
11.	
12.	

State of FLORIDA, County of ORANGE
I hereby certify that this is a true copy of
the document as reflected in the Official Records

MARTHA O. HAYNIE, COUNTY COMPTROLLER

By D. McKenzie
Deputy Comptroller

Contact: 11/6/2014



Permit Number: _____
Folio/Parcel ID #: 20-23-30-4980-00-390
Prepared by: H. NATHAN MEISTER BAXTER WINDOWS LLC
1000 FORT LANE DR. ORLANDO, FL 32806

DOCH 20140006169 B: 10685 P: 3762
01/06/2014 10:27:52 AM Page 1 of 1
Rec Fee: \$10.00
Martha O. Haynie, Comptroller
Orange County, FL
MB - Ret To: DAVID G BAXTER

Return to: BAXTER WINDOWS LLC
1000 FORT LANE DR
ORLANDO, FL 32806



NOTICE OF COMMENCEMENT

State of Florida, County of Orange

The undersigned hereby gives notice that improvement will be made to certain real property, and in accordance with Chapter 713, Florida Statutes, the following information is provided in this Notice of Commencement.

1. Description of property (legal description of the property, and street address if available)
THE LANDINGS AT LAKE COUNTY, 9/125 LOT 39, 3537 County Lakes Dr, Belle Isle, FL 32812-3530

2. General description of improvement
REPLACEMENT WINDOWS

3. Owner information or Lessee information if the Lessee contracted for the improvement

Name SAPE Vincent Wolek
Address 3537 County Lakes Dr, Orlando, FL 32812
Interest in Property Owner
Name and address of fee simple titleholder (if different from Owner listed above)
Name SAPE
Address _____

4. Contractor
Name Baxter Restorations David G. Baxter Telephone Number 407-900-0370
Address 1106 W. CENTRAL BLVD, ORLANDO, FL 32805

5. Surety (if applicable, a copy of the payment bond is attached)
Name N/A Telephone Number _____
Address _____ Amount of Bond \$ _____

6. Lender
Name N/A Telephone Number _____
Address _____

7. Persons within the State of Florida designated by Owner upon whom notices or other documents may be served as provided by §713.13(1)(a)7, Florida Statutes.

Name NATHAN MEISTER Telephone Number 407-341-9953
Address 1000 FORT LANE DR ORLANDO, FL 32806

8. In addition to himself or herself, Owner designates the following to receive a copy of the Lienor's Notice as provided in §713.13(1)(b), Florida Statutes.

Name BAXTER WINDOWS LLC Telephone Number 407-341-9953
Address 1000 FORT LANE DR. ORLANDO, FL 32806

9. Expiration date of notice of commencement (the expiration date may not be before the completion of construction and final payment to the contractor, but will be 1 year from the date of recording unless a different date is specified) 03-25-2014

WARNING TO OWNER: ANY PAYMENTS MADE BY THE OWNER AFTER THE EXPIRATION OF THE NOTICE OF COMMENCEMENT ARE CONSIDERED IMPROPER PAYMENTS UNDER CHAPTER 713, PART I, SECTION 713.13, FLORIDA STATUTES, AND CAN RESULT IN YOUR PAYING TWICE FOR IMPROVEMENTS TO YOUR PROPERTY. A NOTICE OF COMMENCEMENT MUST BE RECORDED AND POSTED ON THE JOB SITE BEFORE THE FIRST INSPECTION. IF YOU INTEND TO OBTAIN FINANCING, CONSULT WITH YOUR LENDER OR AN ATTORNEY BEFORE COMMENCING WORK OR RECORDING YOUR NOTICE OF COMMENCEMENT.

X Vincent Wolek
Signature of Owner or Lessee, or Owner's or Lessee's Authorized Officer/Director/Partner/Manager Signatory's Title/Office

The foregoing instrument was acknowledged before me this 31st day of 12/2013 by VINCE WOLEK
month/year name of person

as Owner for self
Name of party on behalf of whom instrument was executed

Howard N. Meister
Signature of Notary Public - State of Florida Print, type, or stamp commissioned name of Notary Public

Personally Known OR Produced ID FL DR. LIC.
Type of ID Produced FL Drivers Lic.

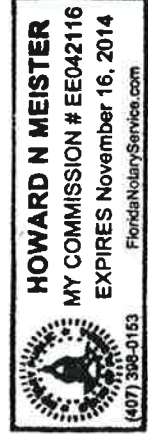



City of Belle Isle
 Universal Engineering Sciences 3532 Maggie Blvd., Orlando, FL 32811
 Tel 407-581-8161 * Fax 407-581-0313 * www.universalengineering.com

Product Approval Form

DATE: 01-05-2014 PERMIT # _____

PROJECT ADDRESS 3537 Country Lakes Dr Belle Isle, FL 32809 32812

As required by Florida Statue 553.842 and Florida Administrative Code 9B-72m, please provide the information and approval numbers of the building components listed below if they will be utilized on the building or structure. FL Approved products are listed online at www.floridabuilding.org or can be obtained from the local product supplier. The following information must be turned in with permit application and available onsite for inspections:

1. This Product Approval Cover Sheet
2. Internet screen from FloridaBuilding.org showing PA#, approval and code edition stamped
3. Manufacturer's installation details from FloridaBuilding.org and requirements for each product stamped

Product Type	Manufacturer	Model/Series	FL Product Approval #	Product Type	Manufacturer	Model/Series	FL Product Approval #
EXTERIOR DOORS							
Swinging				Sliding	WALL PANELS		
Sliding				Soffits			
Sectional/Rollup				Storefront			
Other				Glass Block			
				Other			
WINDOWS							
Single/Dbi Hung	AMI	201/601	11720.1	Asphalt Shingles	ROOFING PRODUCTS		
Horizontal Slider				Non Struct Metal			
Casement				Roofing Tiles			
Fixed				Single Ply Roof			
Mullion	AMI	C-CLASS	12078.7	Other			
Skylights							
Other							
STRUCTURAL COMPONENTS							
Wood Connectors					OTHER		
Wood Anchors							
Truss Plates							
Insulation Forms							
Lintels							
Other							



It is the applicant's responsibility to verify that specific products have been installed in accordance with their limitations and with the minimum required design pressures for the structure. Specific compliance will be verified during field inspections.

Applicant Signature _____ Date _____

FLORIDA DEPARTMENT OF
Business & Professional Regulation

CITY OF BELLE ISLE
 THE PLANS AND SPECIFICATIONS
 HAVE BEEN REVIEWED. FULL
 COMPLIANCE WITH CODES AND
 REGULATIONS ARE REQUIRED BY

BCIS Home | Log In | User Registration | Hot Topics | **THE PERMIT HOLDER** | Submit | Surcharge | Stats & Facts | Publicatio
 APPROVED *[Signature]*

Product Approval
 USER: Public User
 PX 1923 1-7-14



License efficiently. Regulate fairly.

OFFICE OF THE SECRETARY

[Product Approval Menu](#) > [Product or Application Search](#) > [Application List](#) > **Application Detail**

FL # FL12078-R3
 Application Type Revision
 Code Version 2010
 Application Status Approved
 Comments
 Archived

Product Manufacturer Associated Materials Inc.
 Address/Phone/Email 3773 State Road
 Cuyahoga Falls, OH 44223
 (330) 922-2108
 mfernbaugh@alside.com

Authorized Signature Vivian Wright
 rickw@rwbldgconsultants.com



Technical Representative
 Address/Phone/Email

Quality Assurance Representative
 Address/Phone/Email

Category Windows
 Subcategory Mullions

Compliance Method Evaluation Report from a Florida Professional Engineer
 Evaluation Report - Hardc

Florida Engineer or Architect Name who developed the Evaluation Report Lyndon F. Schmidt, P.E.

Florida License PE-43409
 Quality Assurance Entity Architectural Testing, Inc.
 Quality Assurance Contract Expiration Date 12/31/2014
 Validated By Ryan J. King, P.E.
 ✓ Validation Checklist - Harc

Certificate of Independence [FL12078_R3_COI_CERTIFICA](#)

Referenced Standard and Year (of Standard)

Equivalence of Product Standards Certified By



Sections from the Code 1715.5.5

Product Approval Method Method 2 Option B

Date Submitted 09/05/2013
 Date Validated 09/05/2013
 Date Pending FBC Approval 09/11/2013
 Date Approved 10/18/2013

Summary of Products

FL #	Model, Number or Name	Description
12078.1	a. 3100 Structural Mullion	Extruded Aluminum Wood Openings util Style Mounting Bra
Limits of Use Approved for use in HVHZ: No Approved for use outside HVHZ: Yes Impact Resistant: Yes Design Pressure: N/A Other: Mullion Design Pressure varies according to muller window size. Refer to EVAL 12078.1 and INST 12078.1 for Mullion Design Pressure Ratings, any additional use limitations, installation instructions and product particulars.		
Installation Instr FL12078_R3_II_IN Verified By: Lyndon Created by Indepe Evaluation Repor FL12078_R3_AE_E Created by Indepe		

12078.2	b. 3100 Structural Mullion	Extruded Aluminum Openings utilizing t (at head) Style Mot
<p>Limits of Use Approved for use in HVHZ: No Approved for use outside HVHZ: Yes Impact Resistant: Yes Design Pressure: N/A Other: Mullion Design Pressure varies according to mullied window size. Refer to EVAL 12078.2 and INST 12078.2 for Mullion Design Pressure Ratings, any additional use limitations, installation instructions and product particulars.</p>		
12078.3	c. 3100 Structural Transom Mullion	Extruded Aluminum Wood Openings util Style Mounting Bra
<p>Limits of Use Approved for use in HVHZ: No Approved for use outside HVHZ: Yes Impact Resistant: Yes Design Pressure: N/A Other: Mullion Design Pressure varies according to mullied window size. Refer to EVAL 12078.3 and INST 12078.3 for Mullion Design Pressure Ratings, any additional use limitations, installation instructions and product particulars.</p>		
12078.4	d. 3100 Structural Transom Mullion	Extruded Aluminum Openings utilizing t (at head) Style Mot
<p>Limits of Use Approved for use in HVHZ: No Approved for use outside HVHZ: Yes Impact Resistant: Yes Design Pressure: N/A Other: Mullion Design Pressure varies according to mullied window size. Refer to EVAL 12078.4 and INST 12078.4 for Mullion Design Pressure Ratings, any additional use limitations, installation instructions and product particulars.</p>		
12078.5	e. "I" Series Structural Mullion	Extruded Aluminum Masonry Openings Style Mounting Bra
<p>Limits of Use Approved for use in HVHZ: No Approved for use outside HVHZ: Yes Impact Resistant: Yes Design Pressure: N/A Other: Mullion Design Pressure varies according to mullied window size. Refer to EVAL 12078.5 and INST 12078.5 for Mullion Design Pressure Ratings, any additional use</p>		



limitations, installation instructions and product particulars.	
12078.6	f. "I" Series Structural Transom Mullion Limits of Use Approved for use in HVHZ: No Approved for use outside HVHZ: Yes Impact Resistant: Yes Design Pressure: N/A Other: Mullion Design Pressure varies according to mullion window size. Refer to EVAL 12078.6 and INST 12078.6 for Mullion Design Pressure Ratings, any additional use limitations, installation instructions and product particulars.
12078.7	g. "C-Class" Series Structural Mullion Limits of Use Approved for use in HVHZ: No Approved for use outside HVHZ: Yes Impact Resistant: Yes Design Pressure: N/A Other: Mullion Design Pressure varies according to mullion window size. Refer to EVAL 12078.7 and INST 12078.7 for Mullion Design Pressure Ratings, any additional use limitations, installation instructions and product particulars.
	Extruded Aluminum Masonry Openings Brackets Installation Instr FL12078 R3 II In Verified By: Lyndoi Created by Indepe Evaluation Repor FL12078 R3 AE E Created by Indepe
	Clipped Steel 2.0", Wood and Masonry Installation Instr FL12078 R3 II In Verified By: Lyndoi Created by Indepe Evaluation Repor FL12078 R3 AE E Created by Indepe



[Back](#)

[Next](#)

Contact Us :: [1940 North Monroe Street, Tallahassee FL 32399](#) Phone

The State of Florida is an AA/EEO employer. Copyright: 2007-2013 State of Florida. :: [Privacy Stateme](#)

Under Florida law, email addresses are public records. If you do not want your e-mail address released in electronic mail to this entity. Instead, contact the office by phone or by traditional mail. If you have any qu Section 455.275(1), Florida Statutes, effective October 1, 2012, licensees licensed under Chapter 455, F.S. they have one. The emails provided may be used for official communication with the licensee. However en supply a personal address, please provide the Department with an email address which can be made availabl Chapter 455, F.S., please click [here](#).

Product Approval Accepts:



Product Evaluation Report**Report No.:** FL-12078.7**Date:** September 5, 2013

Product Category	Sub Category	Manufacturer	Product Name
Window	Mullions	Associated Materials, Inc. 3773 State Road Cuyahoga Falls, OH 44223 Phone 330.922.5350	"C-Class" Series Structural Mullion

Scope: This is a Product Evaluation report issued by R W Building Consultants, Inc. and Lyndon F. Schmidt, P.E. (System ID # 1998) for Associated Materials, Inc. based on Rule Chapter No. 9N-3, Method 2B of the State of Florida Product Approval, Department of Community Affairs-Florida Building Commission.

RW Building Consultants and Lyndon F. Schmidt, P.E. do not have nor will acquire financial interest in the company manufacturing or distributing the product or in any other entity involved in the approval process of the product named herein.

Limitations:

- This product has been evaluated and is in compliance with the 2010 Florida Building Code (FBC) excluding the "High Velocity Hurricane Zone".
- Wood bucks by others, must be anchored properly to transfer loads to the structure and be reviewed by the building official.
- Mullion anchor embedment to base material shall be beyond wall dressing or stucco.
- When used in areas requiring wind borne debris protection, this product does not require protection with an impact resistant covering when used in Wind Zones 1, 2 and 3 as defined by ASTM E 1996; in Wind Zone 4 as defined by ASTM E 1996, this product must be protected with an impact resistant covering complying with Section 1609.1.2 of the FBC.
- Separate product approvals for each glazing product used with these mullions must be submitted along with this mullion product approval.
- Anchoring of each glazing product to the mullion shall be as shown in each individual glazing product approval.
- Any conditions not covered in this evaluation are subject to separate engineering evaluation.
- Mullion design pressure rating, see load rating table sheets 2 through 7 of drawing FL-12078.7.
- The design pressure rating of the assembly shall be the lesser of the load capacity of the mullion as determined using this approval or the design pressure rating of the individual glazing products used.
- Bounding box dimensions for geometric shapes must be equal to or less than the rectangular dimensions shown herein.
- See drawing FL-12078.7 for size and design pressure limitations.

Supporting Documents:

- Drawing No.**
No. FL-12078.7
Prepared by
RW Building Consultants, Inc. (CA #9813)
Signed & Sealed by
Lyndon F. Schmidt, P.E.
- Calculations**
Mullion/Anchoring
Prepared by
RW Building Consultants, Inc. (CA #9813)
Signed & Sealed by
Lyndon F. Schmidt, P.E.

- Quality Assurance**
Certificate of Participation issued by Architectural Testing, Inc., certifying that Associated Materials, Inc. is manufacturing products within a quality assurance program that complies with ISO/IEC 17020 and Guide 53.



ASSOCIATED MATERIALS INCORPORATED

3773 STATE ROAD
CUYAHOGA FALLS, OH 44223

"C-Class" SERIES STRUCTURAL MULLION

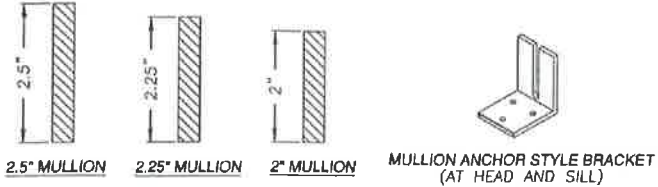

GENERAL NOTES:

- THIS PRODUCT HAS BEEN EVALUATED AND IS IN COMPLIANCE WITH THE 2010 FLORIDA BUILDING CODE (FBC) EXCLUDING THE "HIGH VELOCITY HURRICANE ZONE".
- WOOD BUCKS BY OTHERS, MUST BE ANCHORED PROPERLY TO TRANSFER LOADS TO THE STRUCTURE AND BE REVIEWED BY THE BUILDING OFFICIAL.
- MULLION ANCHOR EMBEDMENT TO BASE MATERIAL SHALL BE BEYOND WALL DRESSING OR STUCCO.
- WHEN USED IN AREAS REQUIRING WIND BORNE DEBRIS PROTECTION, THIS PRODUCT DOES NOT REQUIRE PROTECTION FROM AN IMPACT RESISTANT COVERING WHEN USED IN WIND ZONES 1, 2 AND 3 AS DEFINED BY ASTM E 1996; IN WIND ZONE 4 AS DEFINED BY ASTM E 1996, THIS PRODUCT MUST BE PROTECTED WITH AN IMPACT RESISTANT COVERING COMPLYING WITH SECTION 1609.1.2 OF THE FBC.
- SEPARATE PRODUCT APPROVALS FOR EACH GLAZING PRODUCT USED WITH THESE MULLIONS MUST BE SUBMITTED ALONG WITH THIS MULLION PRODUCT APPROVAL.
- ANCHORING OF EACH GLAZING PRODUCT TO THE MULLION SHALL BE AS SHOWN IN EACH INDIVIDUAL GLAZING PRODUCT APPROVAL.
- ANY CONDITIONS NOT COVERED IN THIS EVALUATION ARE SUBJECT TO SEPARATE ENGINEERING EVALUATION.
- MULLION DESIGN PRESSURE RATING, SEE LOAD RATING TABLE SHEETS 2 THROUGH 7 OF THIS DRAWING.
- THE DESIGN PRESSURE RATING OF THE ASSEMBLY SHALL BE THE LESSER OF THE LOAD CAPACITY OF THE MULLION AS DETERMINED USING THIS APPROVAL OR THE DESIGN PRESSURE RATING OF THE INDIVIDUAL GLAZING PRODUCTS USED.
- BOUNDING BOX DIMENSIONS FOR GEOMETRIC SHAPES MUST BE EQUAL TO OR LESS THAN THE RECTANGULAR DIMENSIONS SHOWN HEREIN.

SUPPORTING DOCUMENTS & EVIDENCE:

- THIS PRODUCT HAS BEEN ENGINEERED FOLLOWING ACCEPTED ENGINEERING PRACTICE CONFORMING TO THE REQUIREMENTS OF CHAPTER 17 OF THE FBC.

TABLE OF CONTENTS	
SHEET #	DESCRIPTION
1	TYPICAL ELEVATIONS & GENERAL NOTES
2	2.0" MULLION LOAD TABLE FOR WOOD SCREW ANCHORS
3	2.0" MULLION LOAD TABLE FOR CONCRETE SCREW ANCHORS
4	2.25" MULLION LOAD TABLE FOR WOOD SCREW ANCHORS
5	2.25" MULLION LOAD TABLE FOR CONCRETE SCREW ANCHORS
6	2.5" MULLION LOAD TABLE FOR WOOD SCREW ANCHORS
7	2.5" MULLION LOAD TABLE FOR CONCRETE SCREW ANCHORS
8	MULLION SECTION & ANCHOR DETAILS

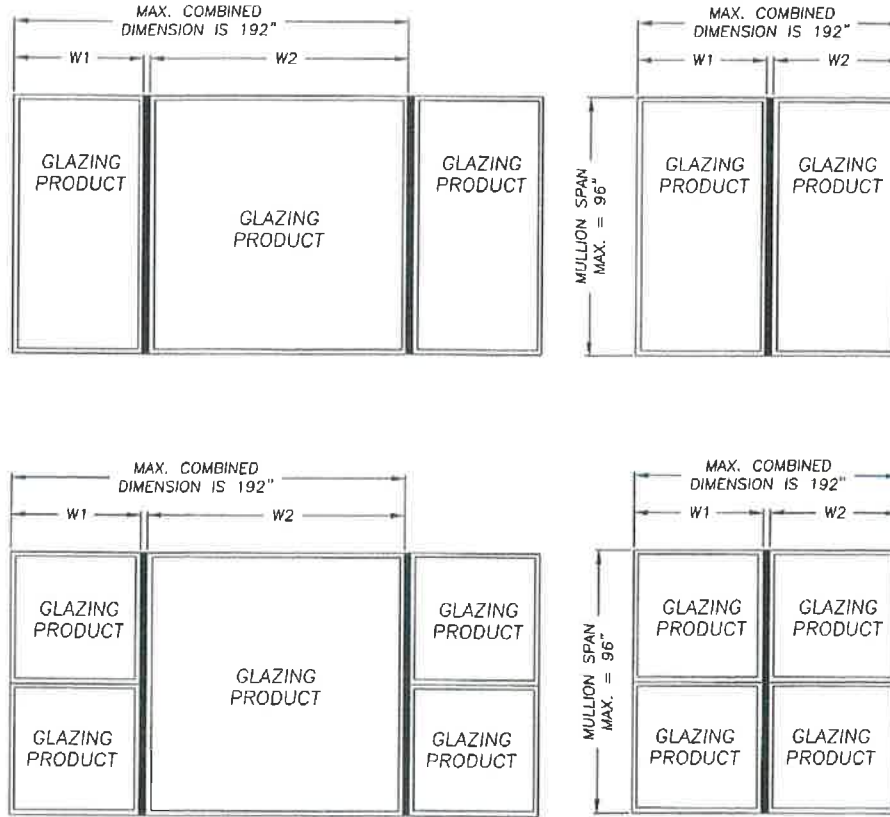

Documents Prepared By:
RW BUILDING CONSULTANTS, INC.
P.O. Box 230 Vero Beach, FL 33585
Phone No.: 813.659.5197
Florida Board of Professional Engineers
Certificate Of Authorization No. 9813
RWS
Lyndon F. Schmidt, P.E. No. 43409

PRODUCT: STRUCTURAL MULLION
PART OR ASSEMBLY: TYPICAL ELEVATION AND GENERAL NOTES

NO.	DATE	REVISIONS
3	9/03/13	ADDED 2.25" MULLION
2	11/08/11	UPDATE TO 2010 FBC
1	5/25/09	REV. LOAD TABLES

DATE: 2/17/09
SCALE: NTS
DWG BY: DWS
CHK. BY: LFS
DRAWING NO: FL-12078.7
SHEET 1 of 8

© 2011 R.W. BUILDING CONSULTANTS INC.



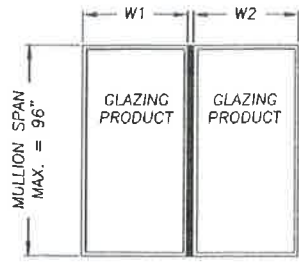

$$\text{TRIBUTARY WIDTH} = \frac{W1 + W2}{2}$$

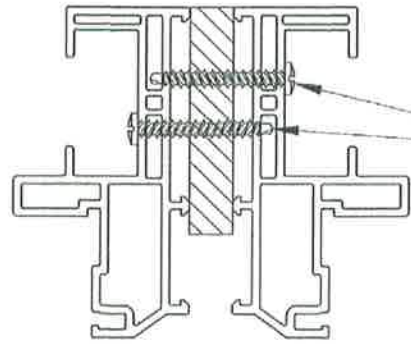
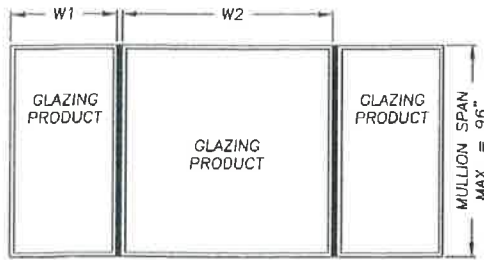

WOOD SCREW ANCHORS	"C-Class" STRUCTURAL MULLION LOAD TABLE (PSF) - 2.0"													
	TRIBUTARY WIDTH													
	24"	30"	36"	40"	46"	50"	54"	60"	66"	72"	78"	84"	96"	
96"	21.0	17.0	14.0	13.0	11.0	10.0	10.0	NA	NA	NA	NA	NA	NA	
94"	22.0	18.0	15.0	14.0	12.0	11.0	10.0	10.0	NA	NA	NA	NA	NA	
92"	23.0	19.0	16.0	15.0	13.0	12.0	11.0	10.0	NA	NA	NA	NA	NA	
90"	25.0	20.0	17.0	16.0	14.0	13.0	12.0	11.0	10.0	NA	NA	NA	NA	
88"	27.0	22.0	19.0	17.0	15.0	14.0	13.0	12.0	11.0	10.0	NA	NA	NA	
86"	29.0	24.0	20.0	18.0	16.0	15.0	14.0	12.0	11.0	10.0	NA	NA	NA	
84"	31.0	25.0	22.0	20.0	17.0	16.0	15.0	13.0	12.0	11.0	10.0	NA	NA	
82"	34.0	27.0	23.0	21.0	18.0	17.0	15.0	14.0	12.0	11.0	10.0	10.0	NA	
80"	36.0	30.0	25.0	23.0	19.0	18.0	16.0	15.0	13.0	12.0	11.0	10.0	NA	
78"	39.0	32.0	27.0	23.0	20.0	18.0	17.0	15.0	14.0	13.0	12.0	11.0	NA	
76"	43.0	35.0	30.0	24.0	21.0	19.0	18.0	16.0	15.0	13.0	12.0	11.0	10.0	
74"	46.0	38.0	32.0	26.0	22.0	21.0	19.0	17.0	15.0	14.0	13.0	12.0	10.0	
72"	51.0	41.0	35.0	27.0	24.0	22.0	20.0	18.0	16.0	15.0	14.0	13.0	11.0	
70"	55.0	45.0	32.0	29.0	25.0	23.0	21.0	19.0	17.0	16.0	15.0	13.0	12.0	
68"	61.0	50.0	34.0	31.0	27.0	24.0	23.0	20.0	18.0	17.0	15.0	14.0	12.0	
66"	67.0	55.0	36.0	33.0	28.0	26.0	24.0	22.0	20.0	18.0	16.0	15.0	13.0	
64"	72.0	60.0	39.0	35.0	30.0	28.0	26.0	23.0	21.0	19.0	18.0	16.0	14.0	
62"	75.0	65.0	41.0	37.0	32.0	29.0	27.0	24.0	22.0	20.0	19.0	17.0	15.0	
60"	75.0	71.0	44.0	40.0	34.0	32.0	29.0	26.0	24.0	22.0	20.0	19.0	16.0	
58"	75.0	57.0	47.0	42.0	37.0	34.0	31.0	28.0	25.0	23.0	21.0	20.0	17.0	
56"	75.0	61.0	51.0	45.0	39.0	36.0	34.0	30.0	27.0	25.0	23.0	21.0	19.0	
54"	75.0	65.0	54.0	49.0	42.0	39.0	36.0	32.0	29.0	27.0	25.0	23.0	20.0	
52"	75.0	71.0	59.0	53.0	46.0	42.0	39.0	35.0	32.0	29.0	27.0	25.0	22.0	
50"	75.0	75.0	64.0	57.0	50.0	46.0	42.0	38.0	34.0	32.0	29.0	27.0	24.0	
48"	75.0	75.0	69.0	62.0	54.0	50.0	46.0	41.0	37.0	34.0	32.0	29.0	26.0	
40"	75.0	75.0	75.0	75.0	75.0	72.0	66.0	60.0	54.0	50.0	45.0	42.0	37.0	

INSTRUCTIONS FOR USE OF THE MULLION LOAD TABLE:

1. DETERMINE THE DESIGN LOAD REQUIREMENT FOR THE PARTICULAR OPENING AS SPECIFIED BY THE BUILDING DESIGNER (ARCHITECT OR ENGINEER OR RECORD).
2. FOR THE PARTICULAR OPENING, DETERMINE THE TRIBUTARY WIDTH AND MULLION SPAN. REFERENCE THE SKETCHES ON THIS SHEET FOR MULLION SPAN AND TRIBUTARY WIDTH DETERMINATION.
3. IN THE FIRST COLUMN OF THE TABLE, LOCATE THE MULLION SPAN. IN THE FIRST ROW OF THE TABLE, LOCATE THE TRIBUTARY WIDTH. AT THE INTERSECTION OF THE ROW CONTAINING THE MULLION SPAN AND THE COLUMN CONTAINING THE TRIBUTARY WIDTH, READ THE MULLION LOAD RATING GIVEN IN PSF. THE MULLION LOAD RATING MUST BE EQUAL TO OR GREATER THAN THE DESIGN LOAD REQUIREMENT DETERMINED IN STEP 1 ABOVE.

FOR ANCHORING GLAZING PRODUCTS TO THE MULLION, ANCHOR SIZE AND SPACING SHALL BE AS SPECIFIED IN ONE OF THE FOLLOWING:

1. SUBSTITUTE (1 FOR 1) 1/4"-14 SELF-DRILLING SCREWS FOR THE FASTENERS SHOWN IN THE INDIVIDUAL GLAZING PRODUCT APPROVAL.
2. SUBSTITUTE #8-18 PANHEAD SELF-DRILLING SCREWS FOR THE FASTENERS SHOWN IN THE INDIVIDUAL GLAZING PRODUCT APPROVAL. MAXIMUM FASTENER SPACING ALLOWED IS 6" FROM EACH END AND AT 15" O.C. MAX. SPACING.

NOTE: A MINIMUM OF 3 THREADS OF THE SELF-DRILLING SCREWS MUST PROTRUDE THROUGH THE WALL OF THE MULLION. THIS SECTION VIEW IS SHOWN FOR ILLUSTRATIVE PURPOSES; OTHER FRAME SECTIONS OF FLORIDA APPROVED WINDOWS BY ALSIDE WINDOWS CAN BE USED IN THIS FASHION.

Documents Prepared By: **RW** BUILDING CONSULTANTS, INC.
 P.O. Box 230 Valrico FL 33595
 Phone No.: 813.639.9187
 Florida Board of Professional Engineers
 Certificate of Authorization No. 9813
 LYNCH F. SCHMIDT, P.E. No. 43409

PRODUCT: STRUCTURAL MULLION
 PART OR ASSEMBLY: 2.0" MULLION LOAD TABLE FOR WOOD SCREW ANCHORS

NO.	DATE	REVISIONS
3	5/03/13	ADDED 2.25" MULLION.
2	11/06/11	UPDATE TO 2010 FBC
1	5/5/09	REV. LOAD TABLES
		NO. DATE

DATE: 2/17/09
 SCALE: NTS
 DWG BY: DWS
 CHK BY: LFS
 DRAWING NO.: FL-12078.7
 SHEET 2 of 8



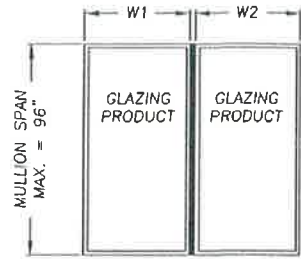

$$\text{TRIBUTARY WIDTH} = \frac{W1 + W2}{2}$$

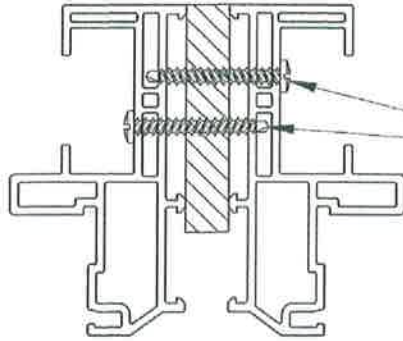
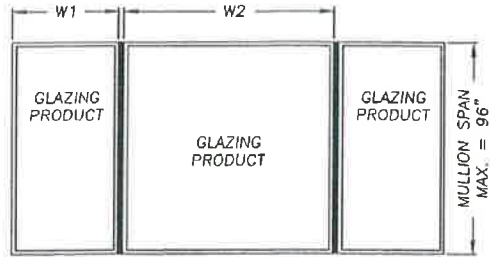

SECTION THRU MULLION & FRAME

CONCRETE SCREW ANCHORS	"C-Class" STRUCTURAL MULLION LOAD TABLE (PSF) - 2.0"													
	TRIBUTARY WIDTH													
	24"	30"	36"	40"	46"	50"	54"	60"	66"	72"	78"	84"	90"	96"
96"	21.0	17.0	14.0	13.0	11.0	10.0	10.0	NA	NA	NA	NA	NA	NA	NA
94"	22.0	18.0	15.0	14.0	12.0	11.0	10.0	10.0	NA	NA	NA	NA	NA	NA
92"	23.0	19.0	16.0	15.0	13.0	12.0	11.0	10.0	NA	NA	NA	NA	NA	NA
90"	25.0	20.0	17.0	16.0	14.0	13.0	12.0	11.0	10.0	NA	NA	NA	NA	NA
88"	27.0	22.0	19.0	17.0	15.0	14.0	13.0	12.0	11.0	10.0	NA	NA	NA	NA
86"	29.0	24.0	20.0	18.0	16.0	15.0	14.0	12.0	11.0	10.0	NA	NA	NA	NA
84"	31.0	25.0	22.0	20.0	17.0	16.0	15.0	13.0	12.0	11.0	10.0	NA	NA	NA
82"	34.0	27.0	23.0	21.0	18.0	17.0	15.0	14.0	12.0	11.0	10.0	10.0	NA	NA
80"	36.0	30.0	25.0	23.0	19.0	18.0	16.0	15.0	13.0	12.0	11.0	10.0	NA	NA
78"	39.0	32.0	27.0	23.0	20.0	18.0	17.0	15.0	14.0	13.0	12.0	11.0	NA	NA
76"	42.0	35.0	30.0	24.0	21.0	19.0	18.0	16.0	15.0	13.0	12.0	11.0	10.0	NA
74"	44.0	37.0	32.0	26.0	22.0	21.0	19.0	17.0	15.0	14.0	13.0	12.0	10.0	NA
72"	45.0	38.0	33.0	27.0	24.0	22.0	20.0	18.0	16.0	15.0	14.0	13.0	11.0	NA
70"	47.0	39.0	32.0	29.0	25.0	23.0	21.0	19.0	17.0	16.0	15.0	13.0	12.0	NA
68"	49.0	41.0	34.0	31.0	27.0	24.0	23.0	20.0	18.0	17.0	15.0	14.0	12.0	NA
66"	50.0	43.0	36.0	33.0	28.0	26.0	24.0	22.0	20.0	18.0	16.0	15.0	13.0	NA
64"	52.0	44.0	39.0	35.0	30.0	28.0	26.0	23.0	21.0	19.0	18.0	16.0	14.0	NA
62"	54.0	46.0	41.0	37.0	32.0	29.0	27.0	24.0	22.0	20.0	19.0	17.0	15.0	NA
60"	57.0	48.0	43.0	39.0	34.0	32.0	29.0	26.0	24.0	22.0	20.0	19.0	16.0	NA
58"	59.0	51.0	45.0	41.0	37.0	34.0	31.0	28.0	25.0	23.0	21.0	20.0	17.0	NA
56"	62.0	53.0	47.0	43.0	39.0	36.0	34.0	30.0	27.0	25.0	23.0	21.0	19.0	NA
54"	65.0	56.0	49.0	45.0	41.0	38.0	36.0	32.0	29.0	27.0	25.0	23.0	20.0	NA
52"	68.0	58.0	51.0	47.0	42.0	40.0	37.0	34.0	32.0	29.0	27.0	25.0	22.0	NA
50"	72.0	62.0	54.0	50.0	45.0	42.0	39.0	36.0	33.0	31.0	29.0	27.0	24.0	NA
48"	75.0	65.0	57.0	52.0	47.0	44.0	41.0	38.0	35.0	32.0	30.0	28.0	25.0	NA
40"	75.0	75.0	71.0	65.0	58.0	54.0	51.0	47.0	43.0	40.0	37.0	35.0	31.0	NA

INSTRUCTIONS FOR USE OF THE MULLION LOAD TABLE:

1. DETERMINE THE DESIGN LOAD REQUIREMENT FOR THE PARTICULAR OPENING AS SPECIFIED BY THE BUILDING DESIGNER (ARCHITECT OR ENGINEER OR RECORD).
2. FOR THE PARTICULAR OPENING, DETERMINE THE TRIBUTARY WIDTH AND MULLION SPAN. REFERENCE THE SKETCHES ON THIS SHEET FOR MULLION SPAN AND TRIBUTARY WIDTH DETERMINATION.
3. IN THE FIRST COLUMN OF THE TABLE, LOCATE THE MULLION SPAN. IN THE FIRST ROW OF THE TABLE, LOCATE THE TRIBUTARY WIDTH. AT THE INTERSECTION OF THE ROW CONTAINING THE MULLION SPAN AND THE COLUMN CONTAINING THE TRIBUTARY WIDTH, READ THE MULLION LOAD RATING GIVEN IN PSF. THE MULLION LOAD RATING MUST BE EQUAL TO OR GREATER THAN THE DESIGN LOAD REQUIREMENT DETERMINED IN STEP 1 ABOVE.

FOR ANCHORING GLAZING PRODUCTS TO THE MULLION, ANCHOR SIZE AND SPACING SHALL BE AS SPECIFIED IN ONE OF THE FOLLOWING:

1. SUBSTITUTE (1 FOR 1) 1/4"-14 SELF-DRILLING SCREWS FOR THE FASTENERS SHOWN IN THE INDIVIDUAL GLAZING PRODUCT APPROVAL.
2. SUBSTITUTE #8-18 PANHEAD SELF-DRILLING SCREWS FOR THE FASTENERS SHOWN IN THE INDIVIDUAL GLAZING PRODUCT APPROVAL. MAXIMUM FASTENER SPACING ALLOWED IS 6" FROM EACH END AND AT 15" O.C. MAX. SPACING.

NOTE: A MINIMUM OF 3 THREADS OF THE SELF-DRILLING SCREWS MUST PROTRUDE THROUGH THE WALL OF THE MULLION. THIS SECTION VIEW IS SHOWN FOR ILLUSTRATIVE PURPOSES; OTHER FRAME SECTIONS OF FLORIDA APPROVED WINDOWS BY ALSIDE WINDOWS CAN BE USED IN THIS FASHION.

Documents Prepared By: **RW** BUILDING CONSULTANTS, INC.
 P.O. Box 230, Vero Beach, FL 33595
 Phone No.: 813.659.9197
 Florida Board of Professional Engineers
 Certificate of Authorization No. 9813
 Lyndon F. Schmidt, P. E. No. 43409

PRODUCT: STRUCTURAL MULLION

PART OF ASSEMBLY: 2.0" MULLION LOAD TABLE FOR CONCRETE SCREW ANCHORS

NO.	DATE	REVISIONS
3	9/03/13	ADDED 2.25" MULLION
2	11/09/11	UPDATE TO 2010 FBC
1	5/25/09	REV. LOAD TABLES

DATE: 2/17/09
 SCALE: NTS
 DWG. BY: DWS
 CHK. BY: LFS
 DRAWING NO.: FL-12078.7
 SHEET 3 OF 8

© 2011 R.W. BUILDING CONSULTANTS INC.



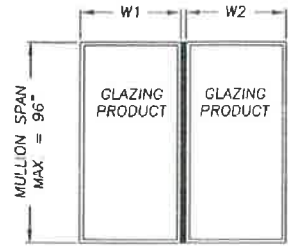

$$\text{TRIBUTARY WIDTH} = \frac{W1 + W2}{2}$$

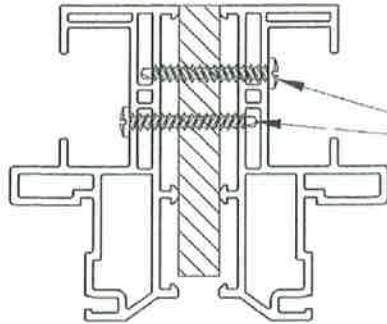
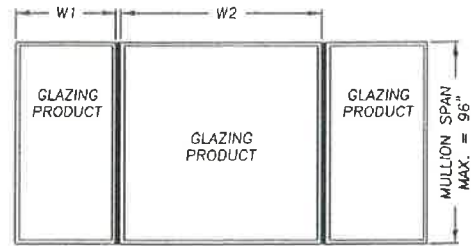

SECTION THRU MULLION & FRAME

WOOD SCREW ANCHORS	"C-Class" STRUCTURAL MULLION LOAD TABLE (PSF) - 2.5"													
	TRIBUTARY WIDTH													
	24"	30"	36"	40"	46"	50"	54"	60"	66"	72"	78"	84"	96"	
MULLION SPAN	96"	41.0	33.0	28.0	25.0	22.0	19.0	18.0	16.0	14.0	13.0	12.0	11.0	10.0
	94"	43.0	35.0	30.0	27.0	24.0	20.0	18.0	16.0	15.0	14.0	13.0	12.0	10.0
	92"	46.0	38.0	32.0	29.0	26.0	21.0	19.0	17.0	18.0	14.0	13.0	12.0	11.0
	90"	50.0	40.0	34.0	31.0	24.0	22.0	20.0	18.0	16.0	15.0	14.0	13.0	11.0
	88"	53.0	43.0	37.0	34.0	25.0	23.0	21.0	19.0	17.0	16.0	14.0	13.0	12.0
	86"	57.0	47.0	40.0	36.0	26.0	24.0	22.0	20.0	18.0	16.0	15.0	14.0	12.0
	84"	61.0	50.0	43.0	39.0	27.0	25.0	23.0	21.0	19.0	17.0	16.0	15.0	13.0
	82"	63.0	53.0	46.0	42.0	29.0	26.0	24.0	22.0	20.0	18.0	17.0	15.0	13.0
	80"	65.0	54.0	48.0	44.0	30.0	28.0	26.0	23.0	21.0	19.0	18.0	16.0	14.0
	78"	67.0	56.0	49.0	38.0	32.0	29.0	27.0	24.0	22.0	20.0	18.0	17.0	15.0
	76"	69.0	58.0	51.0	38.0	33.0	31.0	28.0	25.0	23.0	21.0	19.0	18.0	16.0
	74"	72.0	60.0	53.0	41.0	35.0	32.0	30.0	27.0	24.0	22.0	21.0	19.0	17.0
	72"	74.0	62.0	55.0	43.0	37.0	34.0	32.0	28.0	26.0	24.0	22.0	20.0	18.0
	70"	75.0	64.0	50.0	45.0	39.0	36.0	33.0	30.0	27.0	25.0	23.0	21.0	19.0
	68"	75.0	67.0	54.0	48.0	42.0	38.0	36.0	32.0	29.0	27.0	24.0	23.0	20.0
	66"	75.0	70.0	57.0	51.0	44.0	41.0	38.0	34.0	31.0	28.0	26.0	24.0	21.0
	64"	75.0	72.0	61.0	54.0	47.0	43.0	40.0	36.0	33.0	30.0	28.0	26.0	22.0
	62"	75.0	75.0	64.0	58.0	50.0	46.0	43.0	38.0	35.0	32.0	29.0	27.0	24.0
	60"	75.0	75.0	69.0	62.0	54.0	49.0	46.0	41.0	37.0	34.0	32.0	29.0	26.0
	58"	75.0	75.0	73.0	66.0	58.0	53.0	49.0	44.0	40.0	37.0	34.0	31.0	27.0
56"	75.0	75.0	75.0	70.0	62.0	57.0	53.0	47.0	43.0	39.0	36.0	34.0	29.0	
54"	75.0	75.0	75.0	74.0	66.0	61.0	57.0	51.0	46.0	42.0	39.0	38.0	32.0	
52"	75.0	75.0	75.0	75.0	69.0	65.0	61.0	55.0	50.0	48.0	42.0	39.0	34.0	
50"	75.0	75.0	75.0	75.0	73.0	68.0	64.0	59.0	54.0	49.0	46.0	42.0	37.0	
48"	75.0	75.0	75.0	75.0	75.0	72.0	67.0	62.0	57.0	53.0	49.0	46.0	40.0	
40"	75.0	75.0	75.0	75.0	75.0	75.0	75.0	75.0	70.0	65.0	60.0	56.0	50.0	

INSTRUCTIONS FOR USE OF THE MULLION LOAD TABLE:

1. DETERMINE THE DESIGN LOAD REQUIREMENT FOR THE PARTICULAR OPENING AS SPECIFIED BY THE BUILDING DESIGNER (ARCHITECT OR ENGINEER OR RECORD).
2. FOR THE PARTICULAR OPENING, DETERMINE THE TRIBUTARY WIDTH AND MULLION SPAN. REFERENCE THE SKETCHES ON THIS SHEET FOR MULLION SPAN AND TRIBUTARY WIDTH DETERMINATION.
3. IN THE FIRST COLUMN OF THE TABLE, LOCATE THE MULLION SPAN. IN THE FIRST ROW OF THE TABLE, LOCATE THE TRIBUTARY WIDTH. AT THE INTERSECTION OF THE ROW CONTAINING THE MULLION SPAN AND THE COLUMN CONTAINING THE TRIBUTARY WIDTH, READ THE MULLION LOAD RATING GIVEN IN PSF. THE MULLION LOAD RATING MUST BE EQUAL TO OR GREATER THAN THE DESIGN LOAD REQUIREMENT DETERMINED IN STEP 1 ABOVE.

FOR ANCHORING GLAZING PRODUCTS TO THE MULLION, ANCHOR SIZE AND SPACING SHALL BE AS SPECIFIED IN ONE OF THE FOLLOWING:

1. SUBSTITUTE (1 FOR 1) 1/4"-14 SELF-DRILLING SCREWS FOR THE FASTENERS SHOWN IN THE INDIVIDUAL GLAZING PRODUCT APPROVAL.
2. SUBSTITUTE #8-18 PANHEAD SELF-DRILLING SCREWS FOR THE FASTENERS SHOWN IN THE INDIVIDUAL GLAZING PRODUCT APPROVAL. MAXIMUM FASTENER SPACING ALLOWED IS 6" FROM EACH END AND AT 15" O.C. MAX. SPACING.

NOTE: A MINIMUM OF 3 THREADS OF THE SELF-DRILLING SCREWS MUST PROTRUDE THROUGH THE WALL OF THE MULLION. THIS SECTION VIEW IS SHOWN FOR ILLUSTRATIVE PURPOSES; OTHER FRAME SECTIONS OF FLORIDA APPROVED WINDOWS BY ALSIDE WINDOWS CAN BE USED IN THIS FASHION.

Documents Prepared By:
 BUILDING CONSULTANTS, INC.
 P.O. Box 230 Venice FL 33595
 Phone No.: 813.659.9137
 Florida Board of Professional Engineers
 Certificate of Authorization No. 9813
 EFR 957
 Lyndon F. Schmidt, P.E. No. 43469

PRODUCT: STRUCTURAL MULLION
 PART OR ASSEMBLY:
 2.5" MULLION LOAD TABLE FOR WOOD SCREW ANCHORS

NO.	DATE	REVISIONS
3	9/03/13	ADDED 2.25" MULLION
2	11/08/11	UPDATE TO 2010 FBC
1	5/5/09	REV. LOAD TABLES

DATE: 2/17/09
 SCALE: NTS
 DWG BY: DWS
 CHK BY: LFS
 DRAWING NO.: FL-12078.7
 SHEET 6 OF 8

Reviewed for Code Compliance
 Universal Engineering Sciences

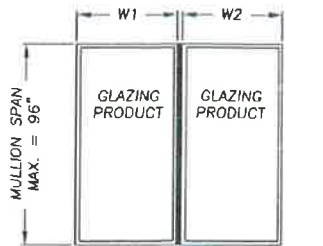

$$\text{TRIBUTARY WIDTH} = \frac{W1 + W2}{2}$$

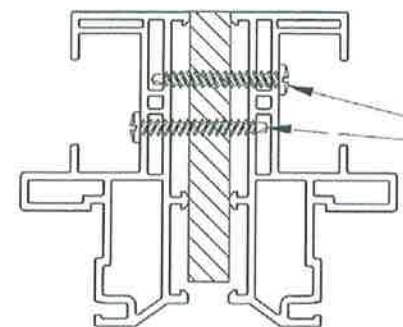
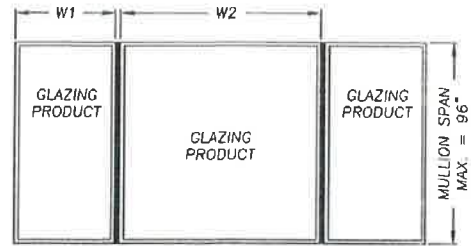

CONCRETE SCREW ANCHORS	"C-Class" STRUCTURAL MULLION LOAD TABLE (PSF) - 2.5"												
	TRIBUTARY WIDTH												
	24"	30"	36"	40"	46"	50"	54"	60"	66"	72"	78"	84"	96"
96"	32.0	27.0	23.0	21.0	19.0	18.0	17.0	16.0	14.0	13.0	12.0	11.0	10.0
94"	33.0	27.0	24.0	22.0	20.0	19.0	18.0	16.0	15.0	14.0	13.0	12.0	10.0
92"	34.0	28.0	24.0	22.0	20.0	19.0	18.0	17.0	16.0	14.0	13.0	12.0	11.0
90"	35.0	29.0	25.0	23.0	21.0	20.0	19.0	17.0	16.0	15.0	14.0	13.0	11.0
88"	36.0	30.0	26.0	24.0	22.0	20.0	19.0	18.0	17.0	15.0	14.0	13.0	12.0
86"	37.0	30.0	26.0	24.0	22.0	21.0	20.0	18.0	17.0	16.0	15.0	14.0	12.0
84"	38.0	31.0	27.0	25.0	23.0	22.0	20.0	19.0	18.0	16.0	15.0	14.0	13.0
82"	39.0	32.0	28.0	26.0	24.0	22.0	21.0	19.0	18.0	17.0	16.0	15.0	13.0
80"	40.0	33.0	29.0	27.0	24.0	23.0	22.0	20.0	19.0	17.0	16.0	15.0	14.0
78"	41.0	34.0	30.0	28.0	25.0	24.0	23.0	21.0	19.0	18.0	17.0	16.0	14.0
76"	42.0	36.0	31.0	29.0	26.0	25.0	23.0	21.0	20.0	19.0	17.0	16.0	15.0
74"	44.0	37.0	32.0	30.0	27.0	26.0	24.0	22.0	21.0	19.0	18.0	17.0	15.0
72"	45.0	38.0	33.0	31.0	28.0	26.0	25.0	23.0	21.0	20.0	19.0	17.0	16.0
70"	47.0	39.0	35.0	32.0	29.0	27.0	26.0	24.0	22.0	21.0	19.0	18.0	16.0
68"	49.0	41.0	36.0	34.0	30.0	28.0	27.0	25.0	23.0	21.0	20.0	19.0	17.0
66"	50.0	43.0	38.0	35.0	31.0	30.0	28.0	26.0	24.0	22.0	21.0	19.0	17.0
64"	52.0	44.0	39.0	36.0	33.0	31.0	29.0	27.0	25.0	23.0	21.0	20.0	18.0
62"	54.0	46.0	41.0	38.0	34.0	32.0	30.0	28.0	26.0	24.0	22.0	21.0	19.0
60"	57.0	48.0	43.0	39.0	36.0	33.0	31.0	29.0	27.0	25.0	23.0	22.0	19.0
58"	59.0	51.0	45.0	41.0	37.0	35.0	33.0	30.0	28.0	26.0	24.0	23.0	20.0
56"	62.0	53.0	47.0	43.0	39.0	36.0	34.0	31.0	29.0	27.0	25.0	24.0	21.0
54"	65.0	56.0	49.0	45.0	41.0	38.0	36.0	33.0	30.0	28.0	26.0	25.0	22.0
52"	88.0	58.0	51.0	47.0	42.0	40.0	37.0	34.0	32.0	29.0	27.0	26.0	23.0
50"	72.0	62.0	54.0	50.0	45.0	42.0	39.0	36.0	33.0	31.0	29.0	27.0	24.0
48"	75.0	65.0	57.0	52.0	47.0	44.0	41.0	38.0	35.0	32.0	30.0	28.0	25.0
40"	75.0	75.0	71.0	65.0	60.0	54.0	51.0	47.0	43.0	40.0	37.0	35.0	31.0

- INSTRUCTIONS FOR USE OF THE MULLION LOAD TABLE:**
1. DETERMINE THE DESIGN LOAD REQUIREMENT FOR THE PARTICULAR OPENING AS SPECIFIED BY THE BUILDING DESIGNER (ARCHITECT OR ENGINEER OR RECORD).
 2. FOR THE PARTICULAR OPENING, DETERMINE THE TRIBUTARY WIDTH AND MULLION SPAN. REFERENCE THE SKETCHES ON THIS SHEET FOR MULLION SPAN AND TRIBUTARY WIDTH DETERMINATION.
 3. IN THE FIRST COLUMN OF THE TABLE, LOCATE THE MULLION SPAN. IN THE FIRST ROW OF THE TABLE, LOCATE THE TRIBUTARY WIDTH. AT THE INTERSECTION OF THE ROW CONTAINING THE MULLION SPAN AND THE COLUMN CONTAINING THE TRIBUTARY WIDTH, READ THE MULLION LOAD RATING GIVEN IN PSF. THE MULLION LOAD RATING MUST BE EQUAL TO OR GREATER THAN THE DESIGN LOAD REQUIREMENT DETERMINED IN STEP 1 ABOVE.

FOR ANCHORING GLAZING PRODUCTS TO THE MULLION, ANCHOR SIZE AND SPACING SHALL BE AS SPECIFIED IN ONE OF THE FOLLOWING:

1. SUBSTITUTE (1 FOR 1) 1/4"-14 SELF-DRILLING SCREWS FOR THE FASTENERS SHOWN IN THE INDIVIDUAL GLAZING PRODUCT APPROVAL.
2. SUBSTITUTE #8-18 PANHEAD SELF-DRILLING SCREWS FOR THE FASTENERS SHOWN IN THE INDIVIDUAL GLAZING PRODUCT APPROVAL. MAXIMUM FASTENER SPACING ALLOWED IS 6" FROM EACH END AND AT 15" O.C. MAX. SPACING.

NOTE: A MINIMUM OF 3 THREADS OF THE SELF-DRILLING SCREWS MUST PROTRUDE THROUGH THE WALL OF THE MULLION. THIS SECTION VIEW IS SHOWN FOR ILLUSTRATIVE PURPOSES; OTHER FRAME SECTIONS OF FLORIDA APPROVED WINDOWS BY ALSIDE WINDOWS CAN BE USED IN THIS FASHION.

Documents Prepared By: **RW** BUILDING CONSULTANTS, INC.
 P.O. Box 230 Vero Beach, FL 33590
 Phone No.: 813.659.9197
 Florida Board of Professional Engineers
 Certificate of Authorization No. 9813
 Lyndon F. Schmidt, P.E. No. 43409

PRODUCT: STRUCTURAL MULLION

PART OR ASSEMBLY: 2.5" MULLION LOAD TABLE FOR CONCRETE SCREW ANCHORS

NO.	DATE	REVISIONS
3	9/03/13	ADDED 2.25" MULLION
2	11/06/11	UPDATE TO 2010 FRC
1	5/9/09	REV. LOAD TABLES

DATE: 2/17/09
 SCALE: NTS
 DWG BY: DWS
 CHK BY: LFS
 DRAWING NO.: FL-12078.7
 SHEET 7 OF 8

© 2011 R.W. BUILDING CONSULTANTS INC.



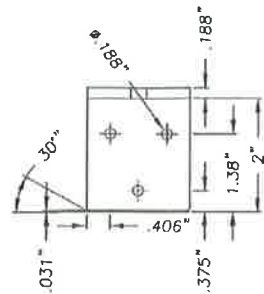

MULLION (2.5", 2.25", 2")
 MAT'L: 1018 STEEL
 (MIN. Fy = 50,000 ksi)

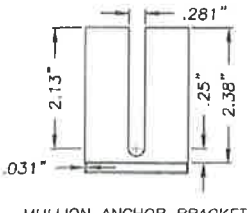

MULLION ANCHOR BRACKET
 MAT'L: 6063-T6

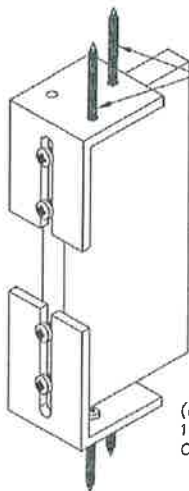
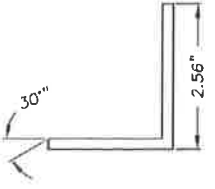

USE 2 HOLES ONLY FOR CONCRETE SCREW INSTALLATIONS

(2) #10-32 X 1" P.H. MACHINE SCREW
 (INCREASE TO #10-32 X 1.5" P.H. M.S. FOR MULLION OFFSET BY UP TO 0.5")

BASIC MULLION BRACKET ANCHORING FOR CONCRETE SCREW CONNECTIONS

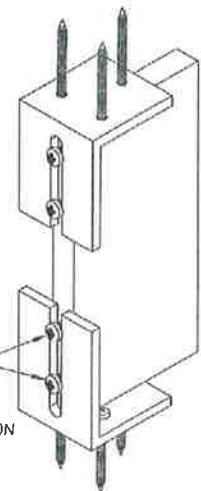

BASIC MULLION BRACKET ANCHORING FOR WOOD SCREW CONNECTIONS AND MACHINE SCREW (MULL TO MULL) CONNECTIONS

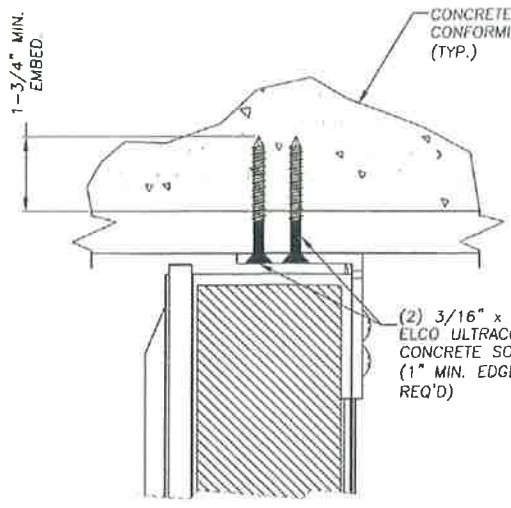
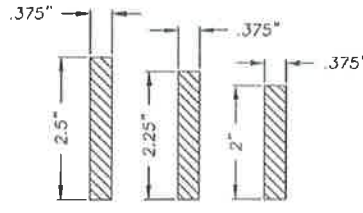

ANCHOR THROUGH 1X BUCK
 USING 3/16" X 3-1/4" CONCRETE SCREWS

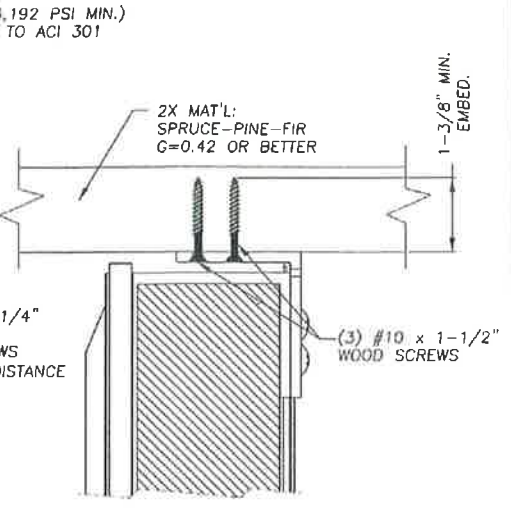

ANCHOR TO 2X STUD OR TO 2X BUCK
 USING #10 X 1-1/2" WOOD SCREWS

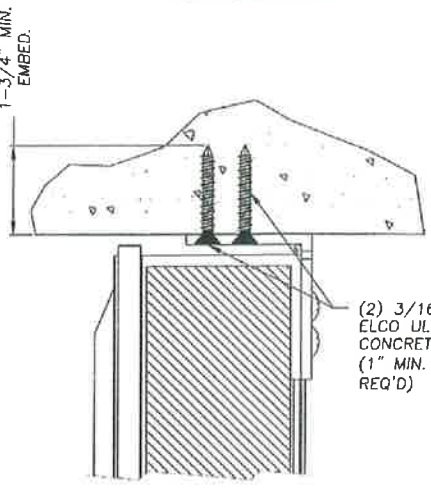

ANCHOR TO MASONRY
 USING 3/16" X 2-1/4" CONCRETE SCREWS

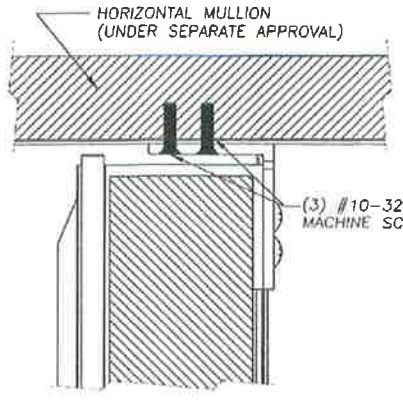

MULLION TO MULLION ANCHORING

CONCRETE (3,192 PSI MIN.) CONFORMING TO ACI 301 (TYP.)

2X MAT'L: SPRUCE-PINE-FIR G=0.42 OR BETTER

(2) 3/16" x 3-1/4" ELCO ULTRACON CONCRETE SCREWS (1" MIN. EDGE DISTANCE REQ'D)

(3) #10 X 1-1/2" WOOD SCREWS

1-3/4" MIN. EMBED.

(3) #10-32 X 1" MACHINE SCREW

Documents Prepared By: **RW** BUILDING CONSULTANTS, INC.
 P.O. Box 230 Vero Beach FL 33595
 Phone No.: 813.658.9197
 Florida Board of Professional Engineers
 Certificate Of Registration No. 98113
 Lyndon F. Schmidt, P.E. No. 43409

PRODUCT:	STRUCTURAL TRANSOM
PART OR ASSEMBLY:	MULLION SECTION & ANCHOR DETAILS
DATE:	2/17/09
SCALE:	NTS
DWG BY:	DWS
CHK BY:	LFS
DRAWING NO.:	FL-12078.7
SHEET	8 OF 8

FLORIDA DEPARTMENT OF

Business & Professional Regulation



License efficiently. Regulate fairly.

OFFICE OF THE SECRETARY

BCIS Home | Log In | User Registration

Hot Topics | Submit Surcharge | Stats & Facts | Publications



Product Approval
USER: Public User

THE PERMIT HOLDER

APPROVED *[Signature]*
PX 1923 1-7-14

CITY OF BELLE ISLE
PLANS AND SPECIFICATIONS
HAVE BEEN REVIEWED. FULL

COMPLIANCE WITH CODES AND REGULATIONS ARE REQUIRED BY

[Product Approval Menu](#) > [Product or Application Search](#) > [Application List](#)



Search Criteria

Code Version 2010 FL#

Application Type ALL Product Manufacturer

Category ALL Subcategory

Application Status ALL Compliance Method

Quality Assurance Entity ALL Quality Assurance Entity Contract Expirec

Product Model, Number or Name ALL Product Description

Approved for use in HVHZ ALL Approved for use outside HVHZ

Impact Resistant ALL Design Pressure

Other ALL

Search Results - Applications

<u>FL#</u>	<u>Type</u>	<u>Manufacturer</u>	<u>Validat</u>
FL9909-R9 History	Revision	Associated Materials Inc. Category: Windows Subcategory: Fixed	Ryan J. (813) 7
FL10465-R5 History	Revision	Associated Materials Inc. Category: Windows Subcategory: Single Hung	Ryan J. (813) 7
FL10465-R6	Revision	Associated Materials Inc. Category: Windows Subcategory: Single Hung	Ryan J. (813) 7
FL11141-R9 History	Revision	Associated Materials Inc. Category: Windows Subcategory: Horizontal Slider	Ryan J. (813) 7
FL11141-R10	Revision	Associated Materials Inc. Category: Windows Subcategory: Horizontal Slider	Ryan J. (813) 7
FL11720-R8 History	Revision	Associated Materials Inc. Category: Windows	Ryan J. (813) 7

FL11720-R9	Revision	Subcategory: Double Hung Associated Materials Inc. Category: Windows Subcategory: Double Hung	Ryan J. (813) 7
FL11850-R2 History	Revision	Associated Materials Inc. Category: Windows Subcategory: Awning	Ryan J. (813) 7
FL11907-R1 History	Revision	Associated Materials Inc. Category: Windows Subcategory: Casement	Ryan J. (813) 7
FL12078-R3 History	Revision	Associated Materials Inc. Category: Windows Subcategory: Mullions	Ryan J. (813) 7
FL12323-R3 History	Revision	Associated Materials Inc. Category: Exterior Doors Subcategory: Sliding Exterior Door Assemblies	Ryan J. (813) 7

*Approved by DBPR. Approvals by DBPR shall be reviewed and ratified by the POC and/or the Commission if n

[Contact Us](#) :: [1940 North Monroe Street, Tallahassee FL 32399](#) [Phone](#)

The State of Florida is an AA/EEO employer. [Copyright 2007-2013 State of Florida.](#) :: [Privacy Statement](#)

Under Florida law, email addresses are public records. If you do not want your e-mail address released in electronic mail to this entity. Instead, contact the office by phone or by traditional mail. If you have any question under Section 455.275(1), Florida Statutes, effective October 1, 2012, licensees licensed under Chapter 455, F.S., they have one. The emails provided may be used for official communication with the licensee. However, email supply a personal address, please provide the Department with an email address which can be made available Chapter 455, F.S., please click [here](#).

Product Approval Accepts:



FLORIDA DEPARTMENT OF
Business & Professional Regulation



[BCIS Home](#) |
 [Log In](#) |
 [User Registration](#) |
 [Hot Topics](#) |
 [Submit Surcharge](#) |
 [Stats & Facts](#) |
 [Publicatio](#)



Product Approval
 USER: Public User

License efficiently. Regulate fairly.

► OFFICE OF THE SECRETARY

[Product Approval Menu](#) >
 [Product or Application Search](#) >
 [Application List](#) >
 Application Detail

FL # FL11720-R8
Application Type Revision
Code Version 2010
Application Status Approved
Comments
Archived

Product Manufacturer Associated Materials Inc.
Address/Phone/Email 3773 State Road
 Cuyahoga Falls, OH 44223
 (330) 922-2108
 mfermbaugh@alside.com

Authorized Signature Vivian Wright
 rickw@rwbldgconsultants.com

Technical Representative
Address/Phone/Email

Quality Assurance Representative
Address/Phone/Email Windows
 Double Hung
Category
Subcategory

Compliance Method Evaluation Report from a Flori
 Florida Professional Engineer
 Evaluation Report - Hardc

Florida Engineer or Architect Name who developed the Evaluation Report Lyndon F. Schmidt, P.E.

Florida License

PE-43409

Quality Assurance Entity

Architectural Testing, Inc.

Quality Assurance Contract Expiration Date

12/31/2014

Validated By

Ryan J. King, P.E.

Validation Checklist - Harc

Certificate of Independence

[FL11720 R8 COI Certificate](#)

Referenced Standard and Year (of Standard)

Standard

101/I.S.2

ANSI/AAMA/NWDA 101/I.S

ANSI/AAMA/NWDA 101/I.S

ASTM E1886/E1996

Equivalence of Product Standards Certified By



Sections from the Code

Product Approval Method

Method 1 Option D

Date Submitted

08/29/2013

Date Validated

08/29/2013

Date Pending FBC Approval

09/11/2013

Date Approved

10/18/2013

Date Revised

12/09/2013

Summary of Products

FL #	Model, Number or Name	Description
11720.1	a. Model 0201	Extruded Vinyl Dou
<p>Limits of Use Approved for use in HVHZ: No Approved for use outside HVHZ: Yes Impact Resistant: No Design Pressure: N/A Other: See INST 11720.1 for Design Pressure Ratings, any additional use limitations, installation instructions and product particulars.</p>		
<p>Installation Instr FL11720 R8 II IN Verified By: Lyndon Created by Indepe Evaluation Report FL11720 R8 AE E Created by Indepe</p>		

11720.2	b. Model 0301	Extruded Vinyl Dou "Non-Impact"
Limits of Use Approved for use in HVHZ: No Approved for use outside HVHZ: Yes Impact Resistant: No Design Pressure: N/A Other: See INST 11720.2 for Design Pressure Ratings, any additional use limitations, installation instructions and product particulars.		
11720.3	c. Model 0401	Extruded Vinyl Dou
Limits of Use Approved for use in HVHZ: No Approved for use outside HVHZ: Yes Impact Resistant: No Design Pressure: N/A Other: See INST 11720.3 for Design Pressure Ratings, any additional use limitations, installation instructions and product particulars.		
11720.4	d. Model 0501	Extruded Vinyl Dou
Limits of Use Approved for use in HVHZ: No Approved for use outside HVHZ: Yes Impact Resistant: No Design Pressure: N/A Other: See INST 11720.4 for Design Pressure Ratings, any additional use limitations, installation instructions and product particulars.		
11720.5	e. Model 0501 HP	Extruded Vinyl Dou
Limits of Use Approved for use in HVHZ: No Approved for use outside HVHZ: Yes Impact Resistant: No Design Pressure: N/A Other: See INST 11720.5 for Design Pressure Ratings, any additional use limitations, installation instructions and product particulars.		
11720.6	f. Model 0601	Extruded Vinyl Dou
Limits of Use Approved for use in HVHZ: No Approved for use outside HVHZ: Yes Impact Resistant: No Design Pressure: N/A Other: See INST 11720.6 for Design Pressure Ratings, any additional use limitations, installation instructions and product particulars.		
 Reviewed for Code Compliance Universal Engineering Sciences		
Installation Instr FL11720 R8 II IN Verified By: Lyndon Created by Indepe Evaluation Report FL11720 R8 AE E Created by Indepe		

additional use limitations, installation instructions and product particulars.	Created by Indepe
<p>11720.7</p> <p>g. Model 8001</p> <p>Limits of Use Approved for use in HVHZ: No Approved for use outside HVHZ: Yes Impact Resistant: No Design Pressure: N/A Other: See INST 11720.7 for Design Pressure Ratings, any additional use limitations, installation instructions and product particulars.</p>	<p>Extruded Vinyl Dou</p> <p>Installation Instr FL11720 R8 II IN Verified By: Lyndon Created by Indepe Evaluation Report FL11720 R8 AE E Created by Indepe</p>
<p>11720.8</p> <p>h. Model 9001</p> <p>Limits of Use Approved for use in HVHZ: No Approved for use outside HVHZ: Yes Impact Resistant: No Design Pressure: N/A Other: See INST 11720.8 for Design Pressure Ratings, any additional use limitations, installation instructions and product particulars.</p>	<p>Extruded Vinyl Dou</p> <p>Installation Instr FL11720 R8 II IN Verified By: Lyndon Created by Indepe Evaluation Report FL11720 R8 AE E Created by Indepe</p>
<p>11720.9</p> <p>i. Model "i" 201</p> <p>Limits of Use Approved for use in HVHZ: No Approved for use outside HVHZ: Yes Impact Resistant: No Design Pressure: N/A Other: See INST 11720.9 for Design Pressure Ratings, any additional use limitations, installation instructions and product particulars.</p>	<p>Extruded Vinyl "Tilt</p> <p>Installation Instr FL11720 R8 II IN Verified By: Lyndon Created by Indepe Evaluation Report FL11720 R8 AE E Created by Indepe</p>
<p>11720.10</p> <p>j. Model "i"-201</p> <p>Limits of Use Approved for use in HVHZ: No Approved for use outside HVHZ: Yes Impact Resistant: Yes Design Pressure: N/A Other: See INST 11720.10 for Design Pressure Ratings, any additional use limitations, installation instructions and product particulars.</p>	<p>Extruded Vinyl "Tilt</p> <p>Installation Instr FL11720 R8 II IN Verified By: Lyndon Created by Indepe Evaluation Report FL11720 R8 AE E Created by Indepe</p>
<p>11720.11</p> <p>k. Model V101</p> <p>Limits of Use Approved for use in HVHZ: No Approved for use outside HVHZ: Yes</p> <p> Reviewed for Code Compliance Universal Engineering Sciences</p>	<p>Extruded Vinyl Dou "Non-Impact"</p> <p>Installation Instr FL11720 R8 II IN Verified By: Lyndon</p>

<p>Impact Resistant: No Design Pressure: N/A Other: See INST 11720.11 for Design Pressure Ratings, any additional use limitations, installation instructions and product particulars.</p>	<p>Created by Indepe Evaluation Report FL11720 R8 AE E Created by Indepe</p>
<p>11720.12</p>	<p>Extruded Vinyl Twir Mullion and Nail Fir</p>
<p>Limits of Use Approved for use in HVHZ: No Approved for use outside HVHZ: Yes Impact Resistant: No Design Pressure: N/A Other: See INST 11720.12 for Design Pressure Ratings, any additional use limitations, installation instructions and product particulars.</p>	<p>Installation Instr FL11720 R8 II IN Verified By: Lyndon Created by Indepe Evaluation Report FL11720 R8 AE E Created by Indepe</p>

[Back](#)
[Next](#)

Contact Us :: [1940 North Monroe Street, Tallahassee FL 32399](#) [Phone](#)

The State of Florida is an AA/EEO employer. [Copyright 2007-2013 State of Florida](#). :: [Privacy Statement](#)

Under Florida law, email addresses are public records. If you do not want your e-mail address released in electronic mail to this entity, instead, contact the office by phone or by traditional mail. If you have any question 455.275(1), Florida Statutes, effective October 1, 2012, licensees licensed under Chapter 455, F.S. they have one. The emails provided may be used for official communication with the licensee. However, to supply a personal address, please provide the Department with an email address which can be made available Chapter 455, F.S., please click [here](#).

Product Approval Accepts:



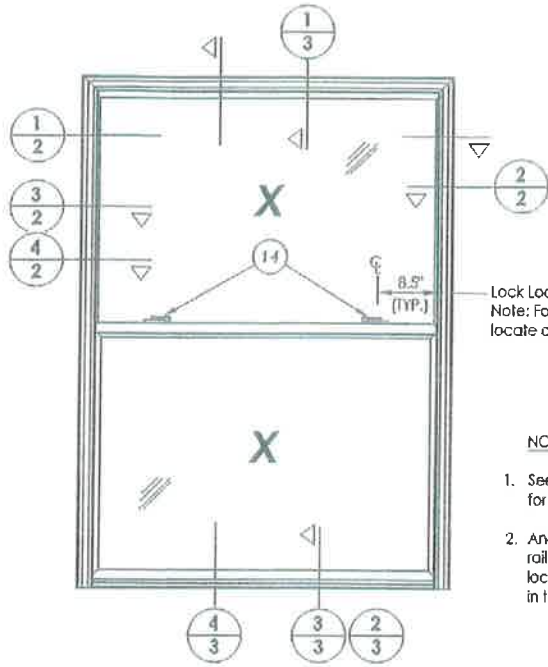

Reviewed for Code Compliance
 Universal Engineering Sciences

NOTES:

1. See Design Pressure Table, Sheet 1, for sash stile reinforcement requirements.
2. Anchors located above the meeting rail are in the interior track and anchors located below the meeting rail are in the exterior track.

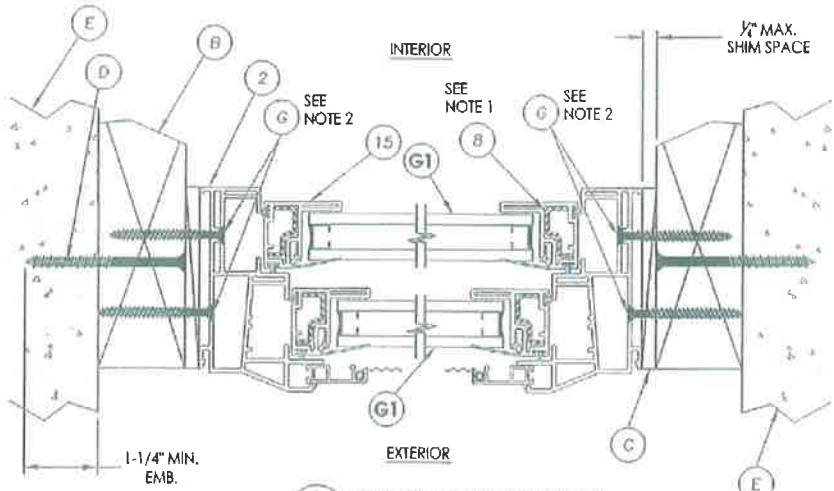

1 HORIZONTAL CROSS SECTION
 2 2x buck Construction

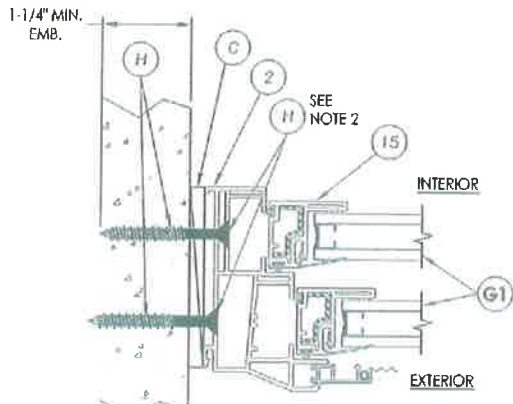

3 HORIZONTAL CROSS SECTION
 2 Shown w/ Direct to Masonry Option

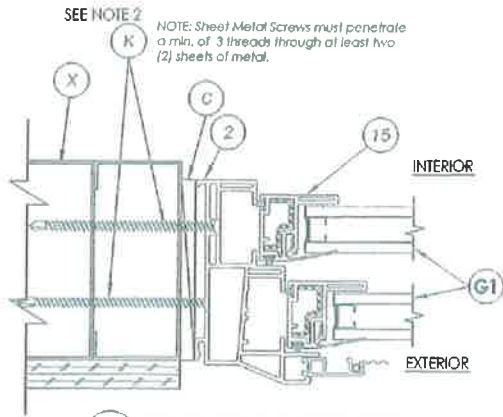

4 HORIZONTAL CROSS SECTION
 2 Shown w/ Steel Stud Framing Option

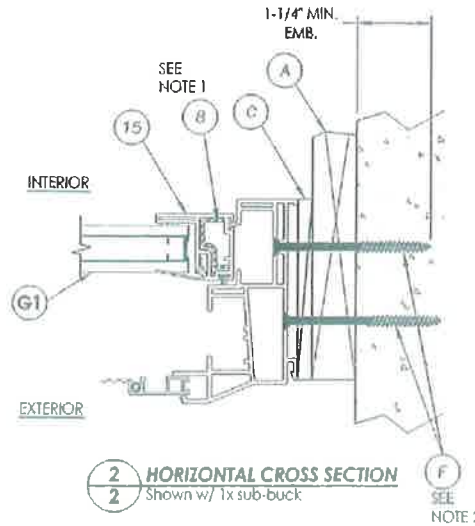

2 HORIZONTAL CROSS SECTION
 2 Shown w/ 1x sub-buck

Documents Prepared By:
 BUILDING CONSULTANTS, INC.
 P.O. Box 230, Venice, FL 33595
 Phone No: 813.659.9137
 Florida Board of Professional Engineers
 Certificate of Authorization No. 9813
 LYNDSY F. SCHMIDT, P.E. No. 43409

PRODUCT:
 DOUBLE HUNG WINDOW
 PART OR ASSEMBLY:
 HORIZONTAL CROSS SECTIONS

NO.	DATE	REVISIONS
JK		
LFS		
JK		
RW		
BT		

DATE: 11/25/08
 SCALE: N.T.S.
 ENG. BY: AL
 CHL. BY: LFS
 DRAWING NO.: FL-11720.1
 SHEET 2 OF 5

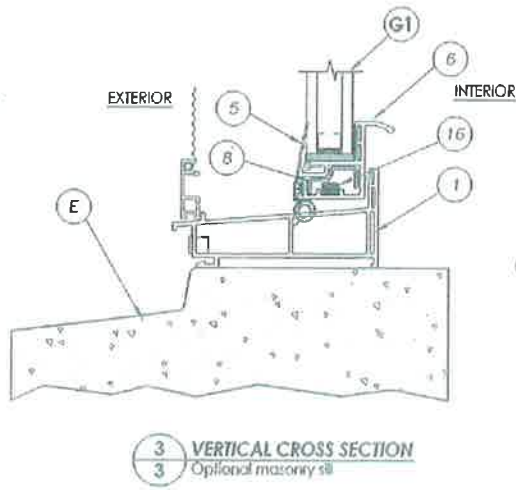
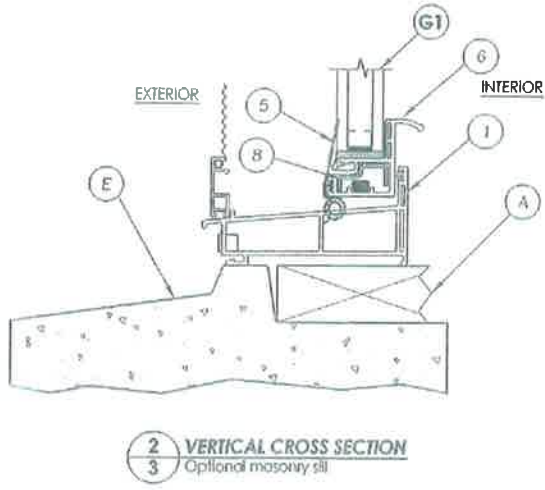
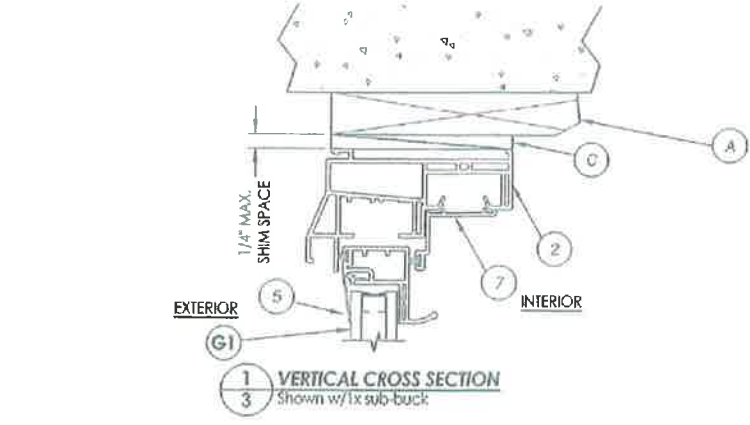

Reviewed for Code
Compliance
Universal Engineering
Sciences

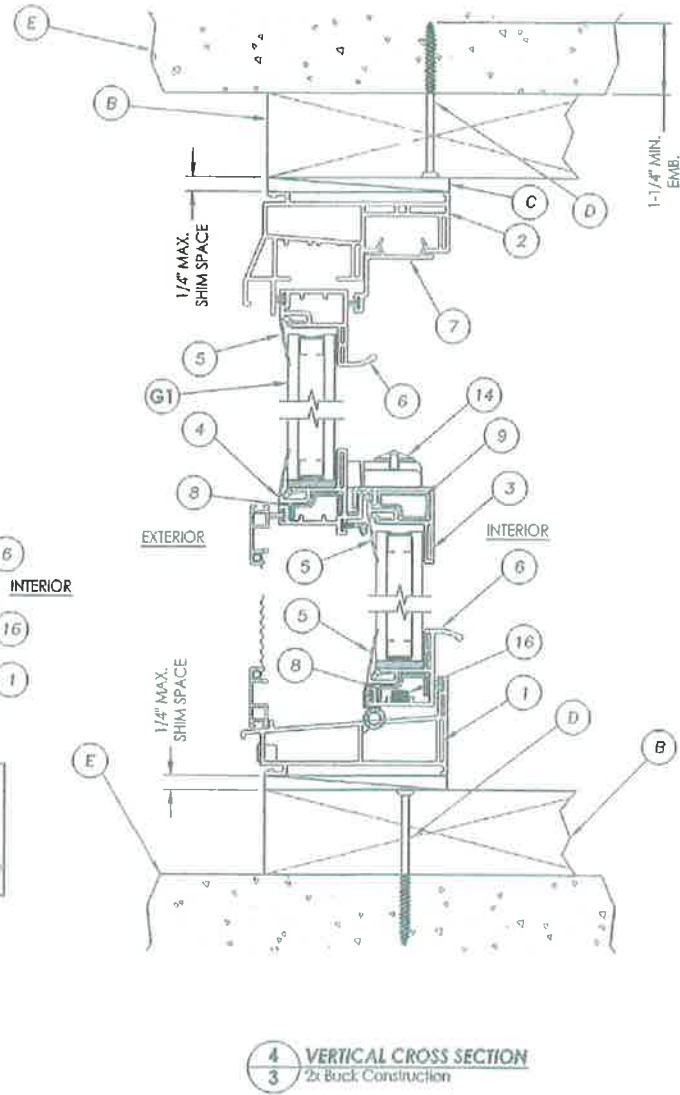



Documents Prepared By:
RW
BUILDING CONSULTANTS, INC.
P.O. Box 230 Vero Beach, FL 33595
Phone No: 813.659.8197
Florida Board of Professional Engineers
Certificate of Authorization No. 8813
RW 12-21-11
Lyndon F. Schmidt, P.E. No. 43409

PRODUCT:
DOUBLE HUNG WINDOW
PART OR ASSEMBLY:
VERTICAL CROSS SECTIONS

NO.	DATE	REVISIONS
4	09/13/11	UPDATED FOR 2010 IBC
3	12/8/10	REVISED FRAME SIZES/D.P.
2	03/18/10	ANCHOR CORRECTION
1	8/20/08	ANCHOR CLARIFICATION
		BY
		BT

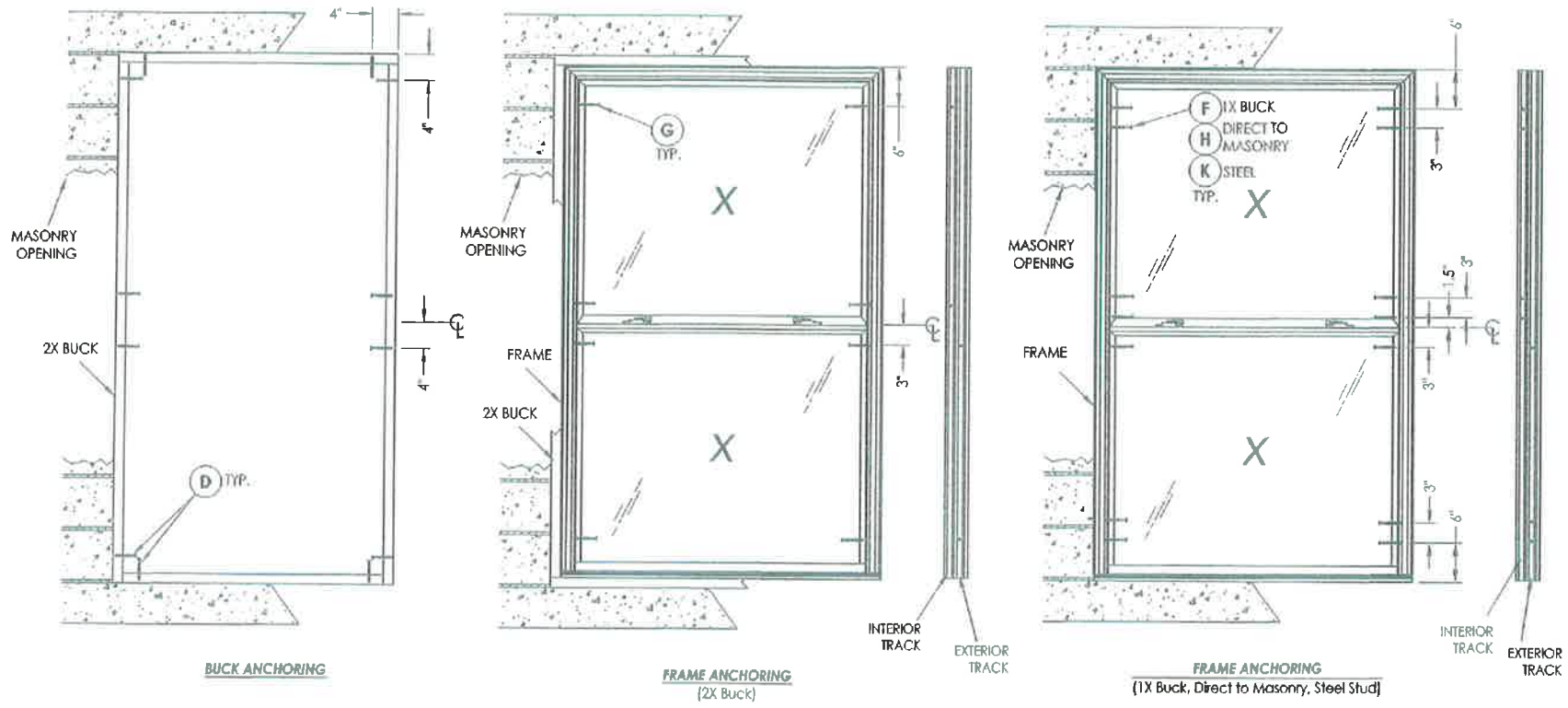
DATE: 11/25/08
SCALE: N.T.S.
DWG. BY: AL
CHK. BY: LFS
DRAWING NO.: FL-11720.1
SHEET 3 OF 5



CONCRETE ANCHOR NOTES:

1. Substitution of equal concrete anchors from a different supplier may have different edge distance and center distance requirements.
2. Concrete anchor locations at the corners may be adjusted to maintain the min. edge distance to mortar joints. If concrete anchor locations noted as "MAX. ON CENTER" must be adjusted to maintain the min. edge distance to mortar joints, additional concrete anchors may be required to ensure the "MAX. ON CENTER" dimensions are not exceeded.
3. Concrete anchor table:

ANCHOR TYPE	ANCHOR SIZE	MIN. EMBEDMENT	MIN. CLEARANCE TO MASONRY EDGE	MIN. CLEARANCE TO ADJACENT ANCHOR
ITW	1/4"	1-1/4"	2-1/2"	3"
ELCO	1/4"	1-1/4"	1"	4"

Reviewed for Code Compliance
Universal Engineering Sciences



Documents Prepared By:
RW BUILDING CONSULTANTS, INC.
 P.O. Box 230, Yalco, FL 33595
 Phone No: 813.859.9187
 Florida Board of Professional Engineers
 Certificate of Authorization No. 9813
 12-10-11
 Lyndon F. Schmidt, P.E. No. 43408

PRODUCT: DOUBLE HUNG WINDOW
 PART OR ASSEMBLY: BUCK & FRAME ANCHORING

NO.	DATE	BY	REVISIONS
4	09/13/11	LFS	UPDATED FOR 2010 FBC
3	12/08/10	LFS	REVISED FRAME SIZES/D.P.
2	03/18/10	LFS	ANCHOR CORRECTION
1	08/20/09	RW	ANCHOR CLARIFICATION

DATE: 11/25/08
 SCALE: N.T.S.
 DWG. BY: AL
 CHK. BY: LFS
 DRAWING NO.: FL-11720.1
 SHEET 4 OF 5

BILL OF MATERIALS		
ITEM #	DESCRIPTION	MATERIAL
A	1X BUCK SG >= 0.55	WOOD
B	2X BUCK SG >= 0.55	WOOD
C	1/4" MAX. SHIM SPACE	
D	1/4" X 2-3/4" PFH ELCO OR ITW CONCRETE SCREW	STEEL
E	MASONRY - 3,192 PSI MIN. CONCRETE CONFORMING TO ACI 301 OR HOLLOW BLOCK CONFORMING TO ASTM C90	CONCRETE
F	1/4" X 2-3/4" PFH ITW CONCRETE SCREW	STEEL
G	#10 x 2" PFH WS	STEEL
H	1/4" X 2-1/4" PFH ITW CONCRETE SCREW	STEEL
K	#10 PFH SELF-DRILLING SMS	STEEL
X	STEEL STUD Min. Thk .033" (ASTM A653 GRADE 33 Fy=33 Ksi Min, Fu=45 Ksi Min)	STEEL
1	EXTRUDED VINYL SILL *	RIGID PVC
2	EXTRUDED VINYL HEAD & JAMB *	RIGID PVC
3	EXTRUDED VINYL LOCK RAIL *	RIGID PVC
4	EXTRUDED VINYL KEEPER RAIL *	RIGID PVC
5	EXTRUDED VINYL GLAZING BEAD *	RIGID PVC
6	EXTRUDED VINYL HANDLE RAIL *	RIGID PVC
7	EXTRUDED VINYL SASH STOP *	RIGID PVC
8	SASH STILE AND RAIL REINFORCEMENT	STEEL
9	LOCK RAIL REINFORCEMENT	STEEL
11	GLAZING TAPE (1/16" X 3/8")	
12	STEEL INTERCEPT SPACER	STEEL
13	GLAZING SHIM 1/8" THICK	BUTYL
14	METAL BUTTON CAM LOCK (ASHLAND)	
15	SASH STILE	STEEL
16	PIVOTRUE PIVOT BAR	

* THE APPROVED WHITE RIGID PVC EXTRUSIONS FOR WINDOWS ARE TO BE PRODUCED BY EXTRUDERS LICENSEES IN "AAMA CERTIFICATION PROGRAMS FOR RIGID PVC EXTRUSIONS".

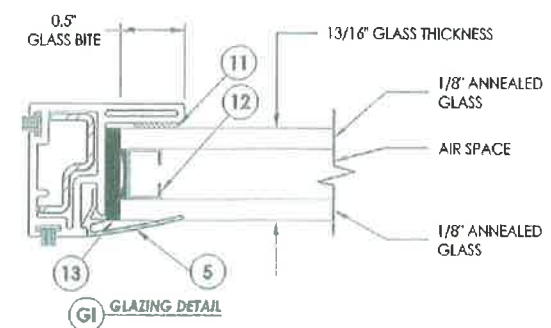
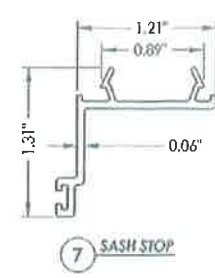
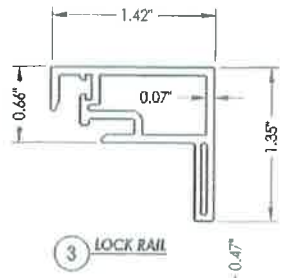
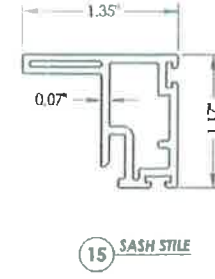
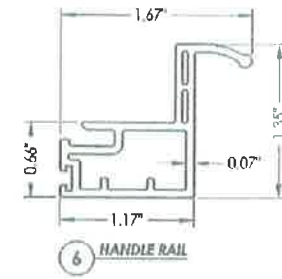
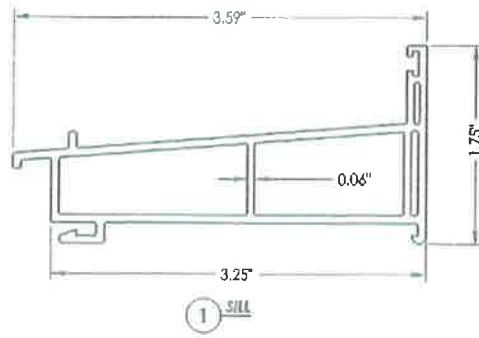
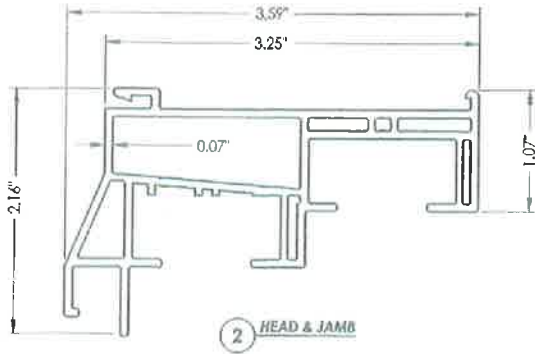

Documents Prepared By:		RWBC BUILDING CONSULTANTS, INC. P.O. Box 230 Venice, FL 33595 Phone No.: 813.899.9197 Florida Board of Professional Engineers Certificate Of Authorization No. 9813 License No. 2111 Lyndon F. Schmidt, P.E. No. 43409	
PRODUCT:	DOUBLE HUNG WINDOW	DATE:	11/25/08
BY:	RW	SCALE:	N.T.S.
CHK:	LFS	DWG. BY:	AL
APP:		CHK. BY:	LFS
REV:		DRAWING NO.:	FL-11720.1
NOI:		SHEET:	5 OF 5

WINDOW MEASUREMENTS

NAME: Wolek # OF STORIES: 2 DATE: 12/31/2013

TYPE OF CONSTRUCTION: CB/Stucco, Circa 1984 TYPE OF WINDOWS: AL/SH # OF WINDOWS: 20

U.I	SIZE(wxh)	MDL	LE	OBS	TP	GRID PATTERN	L/H	FS	SQ'
1	36	37 1/2	201	LE					9.375
2	23 3/4	59 7/8	201	LE					9.875
3	24	59 7/8	201	LE					9.979
4	36	36 5/8	201	LE					9.156
5	36	36 7/8	201	LE					9.219
6	52	60 7/8	201	LE					21.983
7	52	70 1/4	201	LE	TB				25.368
8	51 3/4	70 3/4	201	LE	TB				25.426
9	52	61 1/2	201	LE					22.208
10	35 7/8	59 1/2	201	LE					14.823
11	35 7/8	59 1/2	201	LE					14.823
12	24	51 5/8	201	LE					8.604
13	71 3/4	59 5/8	201	LE					29.709
14	71 3/4	59 5/8	201	LE					29.709
15	24	51 5/8	201	LE					8.604
16	35 3/4	71 3/4	201	LE	TB				107.500
17	23 3/4	35 5/8	201	LE	OF TB				5.876
18	48	59 3/4	201	LE					19.917
19									
20									210.549

Drawing
 Screwed In: X
 Stucco: X Brick: X
 Other: FRAME 2nd Floor

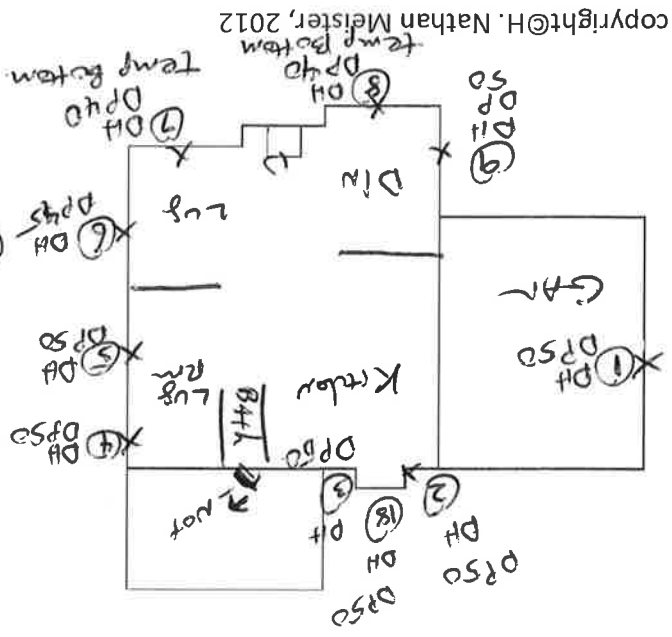

copyright © H. Nathan Meister, 2012

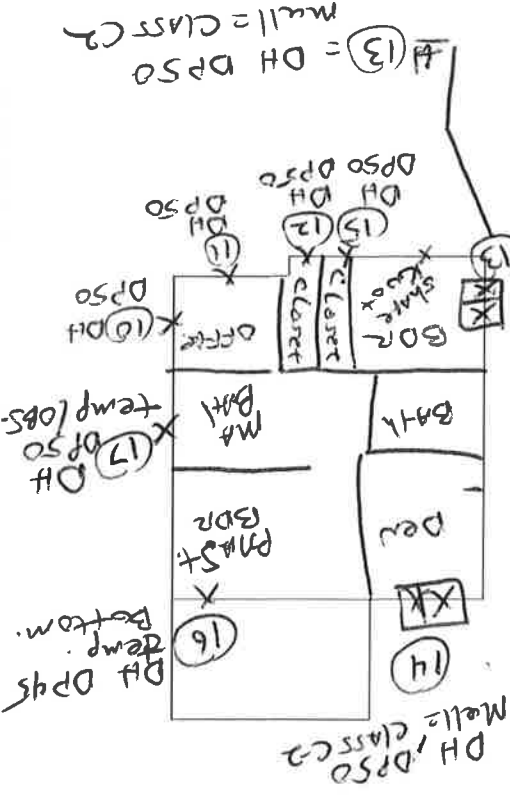

Mull = CLASS C2
 = DH DP50



CERTIFICATE OF LIABILITY INSURANCE

BAXTE-4 OP ID: SH

DATE (MM/DD/YYYY)
01/06/2014

THIS CERTIFICATE IS ISSUED AS A MATTER OF INFORMATION ONLY AND CONFERS NO RIGHTS UPON THE CERTIFICATE HOLDER. THIS CERTIFICATE DOES NOT AFFIRMATIVELY OR NEGATIVELY AMEND, EXTEND OR ALTER THE COVERAGE AFFORDED BY THE POLICIES BELOW. THIS CERTIFICATE OF INSURANCE DOES NOT CONSTITUTE A CONTRACT BETWEEN THE ISSUING INSURER(S), AUTHORIZED REPRESENTATIVE OR PRODUCER, AND THE CERTIFICATE HOLDER.

IMPORTANT: If the certificate holder is an ADDITIONAL INSURED, the policy(ies) must be endorsed. If SUBROGATION IS WAIVED, subject to the terms and conditions of the policy, certain policies may require an endorsement. A statement on this certificate does not confer rights to the certificate holder in lieu of such endorsement(s).

PRODUCER Brown & Brown of Florida, Inc. 2600 Lake Lucien Dr., Ste. 330 Maitland, FL 32751-7234 Richard I. Biondi, CIC	CONTACT NAME: Sandra Harrelson PHONE (A/C, No. Ext.): 407-660-8282 E-MAIL ADDRESS: sharrelson@bborlando.com	FAX (A/C, No.): 407-660-2012
INSURED Baxter Windows LLC 1106 West Central Blvd Orlando, FL 32805	INSURER(S) AFFORDING COVERAGE INSURER A: Ohio Security Ins. Co. INSURER B: INSURER C: INSURER D: INSURER E: INSURER F:	
		NAIC #

COVERAGES

REVISION NUMBER:

THIS IS TO CERTIFY THAT THE POLICIES OF INSURANCE LISTED BELOW HAVE BEEN ISSUED TO THE INSURED NAMED ABOVE FOR THE POLICY PERIOD INDICATED. NOTWITHSTANDING ANY REQUIREMENT, TERM OR CONDITION OF ANY CONTRACT OR OTHER DOCUMENT WITH RESPECT TO WHICH THIS CERTIFICATE MAY BE ISSUED OR MAY PERTAIN, THE INSURANCE AFFORDED BY THE POLICIES DESCRIBED HEREIN IS SUBJECT TO ALL THE TERMS, EXCLUSIONS AND CONDITIONS OF SUCH POLICIES. LIMITS SHOWN MAY HAVE BEEN REDUCED BY PAID CLAIMS.

INSR LTR	TYPE OF INSURANCE	ADDITIONAL INSURER(S)	POLICY NUMBER	POLICY EFF. DATE (MM/DD/YYYY)	POLICY EXP. DATE (MM/DD/YYYY)	LIMITS
A	GENERAL LIABILITY <input checked="" type="checkbox"/> COMMERCIAL GENERAL LIABILITY <input type="checkbox"/> CLAIMS-MADE <input checked="" type="checkbox"/> OCCUR GEN'L AGGREGATE LIMIT APPLIES PER: <input checked="" type="checkbox"/> POLICY <input type="checkbox"/> PROJECT <input type="checkbox"/> LOC AUTOMOBILE LIABILITY <input type="checkbox"/> ANY AUTO <input type="checkbox"/> ALL OWNED AUTOS <input type="checkbox"/> SCHEDULED AUTOS <input type="checkbox"/> HIRED AUTOS <input type="checkbox"/> NON-OWNED AUTOS UMBRELLA LIAB <input type="checkbox"/> OCCUR EXCESS LIAB <input type="checkbox"/> CLAIMS-MADE DED. <input type="checkbox"/> RETENTION \$		BLS55794394	11/01/2013	11/01/2014	EACH OCCURRENCE \$ 1,000,000 DAMAGE TO RENTED PREMISES (Ea. occurrence) \$ 300,000 MED EXP (Any one person) \$ 15,000 PERSONAL & ADV INJURY \$ 1,000,000 GENERAL AGGREGATE \$ 2,000,000 PRODUCTS - COMP/OP AGG \$ 2,000,000 COMBINED SINGLE LIMIT (Ea. accident) \$ BODILY INJURY (Per person) \$ BODILY INJURY (Per accident) \$ PROPERTY DAMAGE (Per accident) \$ EACH OCCURRENCE \$ AGGREGATE \$ WORKERS COMPENSATION AND EMPLOYERS' LIABILITY ANY PROPRIETOR/PARTNER/EXECUTIVE OFFICER/MEMBER EXCLUDED? (Mandatory in NH) <input type="checkbox"/> Y / <input checked="" type="checkbox"/> N / A If yes, describe under DESCRIPTION OF OPERATIONS below

DESCRIPTION OF OPERATIONS / LOCATIONS / VEHICLES (Attach ACORD 101, Additional Remarks Schedule, if more space is required)
91340 - Carpentry-Construct Of Resident Prop Not Exceeding 3 Stories
fax# 407-581-0313

CERTIFICATE HOLDER

CANCELLATION

City of Belle Isle
3532 Maggle Blvd.
Orlando, FL 32811

SHOULD ANY OF THE ABOVE DESCRIBED POLICIES BE CANCELLED BEFORE THE EXPIRATION DATE THEREOF, NOTICE WILL BE DELIVERED IN ACCORDANCE WITH THE POLICY PROVISIONS.

AUTHORIZED REPRESENTATIVE

Sandra Harrelson

ACORD 25 (2010/05)

The ACORD name and logo are registered marks of ACORD

© 1988-2010 ACORD CORPORATION. All rights reserved.

THIS DOCUMENT HAS A COLORED BACKGROUND • MICROPRINTING • LINEMARK • PATENTED PAPER

AC# 6226226

STATE OF FLORIDA

DEPARTMENT OF BUSINESS AND PROFESSIONAL REGULATION
CONSTRUCTION INDUSTRY LICENSING BOARD

SEQ# L12072501226

DATE	BATCH NUMBER	LICENSE NBR
07/25/2012	128017241	CGC1514462

The GENERAL CONTRACTOR
Named below IS CERTIFIED
Under the provisions of Chapter 489 FS.
Expiration date: AUG 31, 2014

BAXTER, DAVID G
BAXTER RESTORATION, LLC
960 FORT LANE DRIVE
ORLANDO FL 32806



RICK SCOTT
GOVERNOR

KEN LAWSON
SECRETARY

DISPLAY AS REQUIRED BY LAW

2013-2014

CITY OF ORLANDO

ECONOMIC DEVELOPMENT
PERMITTING SERVICES

LOCAL BUSINESS TAX RECEIPT

(Formerly known as "Business License," changed per state law HB1269-2006)

Issued Date: 11/11/2013
Expiration Date: 09/30/2014

Business Name

BAXTER WINDOWS LLC
1000 FORT LANE DR
ORLANDO, FL 32806

Business Type(s):

BUSOFF 9990 BUSINESS OFFICE

Case Number: BUS-0038770

Business Owner

BAXTER WINDOWS,LLC

Business Location:

1000 Fort Lane Dr

Fees:

Home Occupation Fee 50.00
2014 Business Tax 110.26
Administration Fee 20.00
Total Paid: \$180.26

NOTICE-THIS RECEIPT ONLY EVIDENCES PAYMENT OF THE LOCAL BUSINESS TAX PURSUANT TO CH. 205, FLORIDA STATUTES. IT DOES NOT PERMIT THE HOLDER TO OPERATE IN VIOLATION OF ANY CITY, STATE, OR FEDERAL LAW. CITY PERMITTING MUST BE NOTIFIED OF ANY MATERIAL CHANGE TO THE INFORMATION FOUND HEREIN BELOW. THIS RECEIPT DOES NOT CONSTITUTE AN ENDORSEMENT OR APPROVAL OF THE HOLDER'S SKILL OR COMPETENCY.

Scott Randolph, Tax Collector

Local Business Tax Receipt

Orange County, Florida

This local business tax receipt is in addition to and not in lieu of any other tax required by law or municipal ordinance. Businesses are subject to regulation of zoning, health and other lawful authorities. This receipt is valid from October 1 through September 30 of receipt year. **Delinquent penalty is added October 1.**

ORIGINAL

2013

EXPIRES 9/30/2014

3501-1119393

3501 MFG REP RESIDENTIAL WIND \$30.00

1 EMPLOYEE

TOTAL TAX \$30.00
PREVIOUSLY PAID \$30.00
TOTAL DUE \$0.00

1000 FORT LANE DR
A - ORLANDO, 32806

MEISTER HOWARD N

BAXTER WINDOWS LLC
1000 FORT LANE DR
ORLANDO FL 32806

PAID: \$30.00 025-00053716 11/11/2013

This receipt is official when validated by the Tax Collector.

