



City of Belle Isle
 Universal Engineering Sciences 3532 Maggie Blvd., Orlando, FL 32811
 Tel 407-581-8161 * Fax 407-581-0313 * www.universalengineering.com

PERMIT CARD - PLEASE POST AT JOB SITE

THIS DOCUMENT BECOMES YOUR PERMIT WHEN PROPERLY VALIDATED

Per FC 105.3.3: An enforcing authority may not issue a building permit for any building construction, erection, alteration, modification, repair or addition unless the permit either includes on its face or there is attached to the permit the following statement: **"NOTICE: In addition to the requirements of this permit, there may be additional restrictions applicable to this property that may be found in the public records of this county, and there may be additional permits required from other governmental entities such as water management districts, state agencies, or federal agencies."** The issuance of this permit does not grant permission to violate any applicable City, Orange County, State of Florida and/or Federal codes and/or ordinances. Separate permits are required for Signs, Roofing, Electrical, Gas, Plumbing and Mechanical services. This permit becomes VOID if the work authorized is not commenced within 6 months, or is suspended or abandoned for a period of 6 months after commencement. **WORK SHALL BE CONSIDERED SUSPENDED IF AN APPROVED INSPECTION HAS NOT BEEN MADE WITHIN A 6 MONTH PERIOD.** PERMISSION IS GRANTED TO DO THE FOLLOWING WORK ACCORDING TO THE CONDITIONS HEREON AND THE APPROVED PLANS AND SPECIFICATIONS, SUBJECT TO COMPLIANCE WITH THE ORDINANCES OF THE CITY OF BELLE ISLE, FLORIDA.

<p>Scope of Work: DOOR: rear entry, size-for-size</p> <p>Comments: None</p> <p>Project Information Address: 7157 Conway Circle, Belle Isle, FL 32809 Parcel ID: 25-23-29-5884-15-130 Property Owner: Stewart, Pamela Phone Number: 407-421-8334 ***** Company Name: Decker Doors, Inc. Contractor Name: Decker, Daniel License Number: CBC1250499 Address: 724 Brooks Court, Winter Springs, FL 32708 Phone Number: 407-696-0830</p>	<p align="center">Permit Number: 2014-01-051 Date of Application: 01/30/2014 Date Permit Issued: 01/30/2014</p> <p>WARNING TO OWNER: "YOUR FAILURE TO RECORD A NOTICE OF COMMENCEMENT MAY RESULT IN YOU PAYING TWICE FOR IMPROVEMENTS TO YOUR PROPERTY. IF YOU INTEND TO OBTAIN FINANCING, CONSULT WITH YOUR LENDER OR AN ATTORNEY BEFORE RECORDING YOUR NOTICE OF COMMENCEMENT." ON THE JOB INSPECTION(S) MUST BE MADE BEFORE PROCEEDING WITH SUBSEQUENT WORK. THIS CARD MUST BE DISPLAYED OUTSIDE AND BE PROTECTED FROM THE WEATHER WHILE BEING VISIBLE FROM THE STREET UNTIL THE FINAL INSPECTIONS HAVE BEEN APPROVED.</p>
---------------------------------------------------------------------------------------------------------------------------------------------------------------------------------------------------------------------------------------------------------------------------------------------------------------------------------------------------------------------------------------------------------------------------------------------------------------------------------------------------------------------------------------------------------------------------------------------	---------------------------------------------------------------------------------------------------------------------------------------------------------------------------------------------------------------------------------------------------------------------------------------------------------------------------------------------------------------------------------------------------------------------------------------------------------------------------------------------------------------------------------------------------------------------------------------------------------------------------------------------------------------------

BUILDING FEATURES

<p>IMPACT FEES</p> <p>School \$ Traffic \$</p> <p>ZONING FEES</p> <p>Zoning Fee \$</p> <p>UNIVERSAL ENG - BUILDING FEES</p> <p>Cert of Occ \$ Demo \$ Building \$ Fence \$ Driveway \$ Shed \$ Window(s) \$ Door(s) \$43.50 PrePower \$ Electrical \$ Temp Pole \$ Plumbing \$ Mechanical \$ Gas \$ Roofing \$ Boat Dock \$ Screen Encl \$ Swimming Pool \$ Sign \$</p> <p>SURCHARGE FEES</p> <p>Surcharge Fee \$2.00 Surcharge Fee \$2.00</p> <p align="center">TOTAL FEES \$47.50</p> <p>Date Paid 2-4-14</p> <p>CC or Check # 13681</p> <p>Amount Paid 47.50</p> <p>The person accepting this permit shall conform to the terms of the application on file and construction shall conform to the requirements of the Florida Building Code (FS 553).</p>	<p align="center">BUILDING INSPECTOR USE ONLY</p> <p>IF APPLICABLE:</p> <p>Have Zoning Approval Conditions Been Met? YES NO Have Stormwater Approval Conditions Been Met? YES NO Silt fencing in place? YES NO Turbidity Barrier in place? YES NO</p> <p>€ BUILDING 1st _____ (Footing/Foundation) Survey specific foundation plan must be onsite before slab pour. Approved Plan on Site? _____ 2nd _____ (Slab) 3rd _____ (Lintel)(Wall Reinforcing on Masonry Building) 4th _____ (Exterior Framing)(Roof/Wall Sheathing) 5th _____ (Framing) (To be made after Plumbing/ Mechanical/ Electrical Rough-Ins & Windows/Doors Installed) 6th _____ (Insulation to be Made After Roof Installed) 7th _____ (Drywall) 8th _____ (Sidewalk/Driveway) 9th _____ (Other) 10th _____ (Final – After MEP and Other Applicable Finals)</p> <p>€ ROOFING 1ST ROOFING Deck Nailing/Dry-in/Flashing _____ 2nd ROOFING Covering In-Progress _____ 3rd ROOFING Covering Final _____</p> <p>€ PLUMBING (Pool-Piping, Solar, Irrigation, Water Treatment Equip, Etc...) € _____ (Underground) 2nd _____ (Sewer) 3rd _____ (Rough-In/Tub Set) 4th _____ (Final)</p> <p>CHECK APPROPRIATE BOX € GAS ___ Natural ___ LP € MECHANICAL € ELECTRICAL € LOW VOLTAGE 1st _____ (Rough-In) 2nd _____ (Final)</p>
-----------------------------------------------------------------------------------------------------------------------------------------------------------------------------------------------------------------------------------------------------------------------------------------------------------------------------------------------------------------------------------------------------------------------------------------------------------------------------------------------------------------------------------------------------------------------------------------------------------------------------------------------------------------------------------------------------------------------------------------------------------------------------------------------------------------------------------------------------------------------------------------------------------------------------------------------------------------------------------------------------------------------------------------------------------------------------------------	---------------------------------------------------------------------------------------------------------------------------------------------------------------------------------------------------------------------------------------------------------------------------------------------------------------------------------------------------------------------------------------------------------------------------------------------------------------------------------------------------------------------------------------------------------------------------------------------------------------------------------------------------------------------------------------------------------------------------------------------------------------------------------------------------------------------------------------------------------------------------------------------------------------------------------------------------------------------------------------------------------------------------------------------------------------------------------------------------------------------------------------------------------------------------------------------------------------------------------------------------------------------------------------------------------------------------------------------------------------------------------------------------------------------------------------------------------------------------------------------------------------------------------------------------------------------------------------------------------------------------------------------------------------------------------------------------------------------------------------------------------------------------------

Inspection requests are to be emailed to IDScheduling@UniversalEngineering.com; a confirmation email will be sent back to you upon scheduling. **Next-Day Inspection requests must be made by 1pm.** Please include the following in your request: Permit #, project address, type of inspection, date of the requested inspection, a contact name & a contact phone number. AM or PM may be requested but cannot be guaranteed.



City of Belle Isle
 Universal Engineering Sciences 3532 Maggie Blvd., Orlando, FL 32811
 Tel 407-581-8161 * Fax 407-581-0313 * www.universaleengineering.com

Received
 1-30-14

Building Permit (Land Use) Application

DATE: 1-29-14 PERMIT # 2014-01-051

PROJECT ADDRESS 7159 Conway CT Belle Isle, FL 32809 32812
 PROPERTY OWNER Pamela Steward PHONE 407-421-8333 VALUE OF WORK (labor & material) \$ 18333 29

PLEASE LIST THE NATURE OF YOUR PROPOSED IMPROVEMENTS

Replace leanerently door unit

- Survey specific foundation plan required to show compliance with zoning setbacks. *Please provide information, if applicable.*
- **BOAT DOCK:** DEP Clearance Required with Application (Call 407-897-4100); please provide a copy of their report
- **SEPTIC SYSTEM (RESIDENTIAL):** - Provide verification of OC Health Dept approval for on-site septic tank system, per FAC Chap. 64E-6
- Homeowners will be required to have a contractor on record for homes that are rented and/or not homestead

Please Complete for the City of Belle Isle Zoning Review: Parcel Id Number: 25-23-29-5884 15-130
 To obtain this information, please visit: <http://www.ocpafl.org/Searches/ParcelSearch.aspx>

SPECIAL CONDITIONS: STRUCTURES MAY NOT ENCROACH INTO ANY EASEMENT OR REQUIRED SETBACK. Note, this Zoning Approval MAY or MAY NOT be in conflict with your Deed Restrictions. For New Single Family Residence, a Traffic Impact Fee and School Impact will be assessed.

Attached Survey SETS and Construction Plans SETS
 PLANNING & ZONING APPROVAL: DATE

PLEASE COMPLETE for Building Review
 CONSTRUCTION TYPE
 OCCUPANCY GROUP #UNITS #STORIES Comm Single Fam Multi Fam Res:
 #BLDG. TOTAL SQ.FT.
 MAX. FLOOR LOAD MAX. OCCUPANCY
 MIN. FLOOR ELEV. LOW FLOOR ELEV.
 WATER SERVICE WELL SEPTIC

BUILDING REVIEWER DATE
 NOTES 2900
14.50

Per FSS 105.3.3:
 An enforcing authority may not issue a building permit for any building construction, erection, alteration, modification, repair or addition unless the permit either includes on its face or there is attached to the permit the following statement: "NOTICE: In addition to the requirements of this permit, there may be additional restrictions applicable to this property that may be found in the public records of this county, and there may be additional permits required from other governmental entities such as water management districts, state agencies, or federal agencies."

Republic Services is by legal contract the sole authorized provider of garbage, recycling, yard waste, and commercial garbage and construction debris collection and disposal services with the city limits of the City. Contractors, homeowners and commercial businesses may contact Republic Services at 407-293-8000 to setup accounts for Commercial, Construction Roll Off, or other services needed. Rates are fixed by contract and are available at City Hall or from Republic Services. The City enforces the contract through its code enforcement office. Failure to comply will result in a stop work order.

SEPARATE PERMITS ARE REQUIRED FOR ROOFING, ELECTRICAL, PLUMBING, GAS, MECHANICAL, SIGNS, POOLS, ENCLOSURES, ETC.

Wind Exposure Category: B C D

SPRINKLERS REQ'D	Y	N	
if Required - SUBMIT COPY OF PLANS FOR FIRE REVIEW	Date: Sent	RCD	
ZONING	Y	N	\$
CERT OF OCC	Y	N	\$
TRAFFIC	Y	N	\$
SCHOOL	Y	N	\$
FIRE	Y	N	\$
SWIMMING POOL	Y	N	\$
SCREEN ENCLOSURE	Y	N	\$
ROOFING	Y	N	\$
BOAT DOCK	Y	N	\$
BUILDING	Y	N	\$
WINDOW(S)	Y	N	\$
DOOR(S)	<input checked="" type="checkbox"/>	N	\$ <u>43.50</u>
FENCE	Y	N	\$
SHED	Y	N	\$
DRIVEWAY	Y	N	\$
OTHER	Y	N	\$
3% FL SURCHARGE			<u>4.00</u>
TOTAL			<u>47.50</u>
By Owner Form	Y	NA	
Notice of Commencement	Y	<input checked="" type="checkbox"/> NA	
Power of Attorney	<input checked="" type="checkbox"/>	NA	
Contractor Packet Included?	<input checked="" type="checkbox"/>	N	
OTHER PERMITS REQUIRED:			
ELECTRICAL	Y	NA	
PREPOWER	Y	NA	
MECHANICAL	Y	NA	
PLUMBING	Y	NA	
ROOFING	Y	NA	
GAS	Y	NA	



City of Belle Isle
 Universal Engineering Sciences 3532 Maggie Blvd., Orlando, FL 32811
 Tel 407-581-8161 * Fax 407-581-0313 * www.universaleengineering.com

Building Permit (Land Use) Application
 To be completed as required by State Statute Section 713 and other applicable sections.

PERMIT # _____

Owner's Name Pamela Stewart
 Owner's Address 1157 Conway Cir Belle Isle FL 32809

Contractor Name	<u>Daniel T. Decker</u>
License #	<u>C19C1030199</u>
Contact Phone/Cell	<u>407-696-0830</u>
Contact Email	<u>MES031@aol.com</u>
Company Name	<u>Decker Dues Inc</u>
Company Address	<u>724 Blaxs Ct</u>
City, State, ZIP	<u>Winter Springs FL 32708</u>
Contact Fax	<u>407-696-7356</u>

WARNING TO OWNER: Your failure to record a Notice of Commencement may result in your paying twice for improvements to your property. A notice of commencement must be recorded if job is \$2500(+) or if A/C Replacement \$7500(+) and posted on the job site before the first inspection. If you intend to obtain financing, consult with your lender or an attorney before recording your Notice of Commencement.

I hereby make Application for Permit as outlined above, and if same is granted I agree to conform to all Division of Building Safety Regulations (www.floridabuilding.org) and City Ordinances (www.municode.com) regulating same and in accordance with plans submitted. The issuance of this permit does not grant permission to violate any applicable City and/or State of Florida codes and for ordinances. Application is hereby made to obtain a permit to do the work and installations as indicated. I certify that no work or installation has commenced prior to the issuance of a permit and that all work will be performed to meet the standards of all laws regulating construction in this jurisdiction. I understand that a separate permit must be secured for all other construction including ROOFING, ELECTRICAL, MECHANICAL, PLUMBING, GAS, SIGNS, POOLS, SCREEN ENCLOSURES, ETC.

OWNER'S AFFIDAVIT: I certify that all the foregoing information is accurate and that all work will be done in compliance with all applicable laws regulating construction and zoning.

Owner Signature [Signature]
 The foregoing instrument was acknowledged before me this 11/23/14
 by Pamela Stewart who is personally known to me
 and who produced FL Driver Lic.
 as identification and who did not take an oath
 Notary as to Owner
 State of Florida
 County of Orange



Contractor Signature [Signature]
 COMPANY NAME Decker Dues Inc
 The foregoing instrument was acknowledged before me this 11/23/14
 by Daniel T. Decker who is personally known to me
 and who produced _____
 as identification and who did not take an oath.
 Notary as to Owner
 State of Florida
 County of Orange



Impervious Surface Ratio Worksheet
 Development Zoned A-1, A-2, R-1-AAA, R-1-AA, R-1-A, R-1 per City Code, Section 50-74: Impervious Surface Ratio

1. Total Lot Area (sqft) X 0.35 = Allowable Impervious Area (BASE).
 Total Lot Area _____ X 0.35 =
 Allowable Impervious Area (BASE) _____

Calculate the "proposed" impervious area on the lot. This includes the sum of all areas that do not allow direct percolation of rainwater.
Examples include house, pool, deck, driveway, accessory building, etc

- House _____
- Driveway _____
- Walkway _____
- Accessory Buildings _____
- Pool & Spa _____
- Deck & Patio _____
- Other _____

Actual Impervious Area (AIA) _____

3. If AIA is less than BASE, subtract AIA from BASE to determine the amount of impervious area that may be added without providing onsite retention.

4. If AIA is greater than BASE, then onsite retention **must be provided**.
 Assuming 7.5 inches of rainfall based on a 24hr. 10 year Rain Event (TP40), the formula is: (7.5 inches rainfall/12 inches p/foot) X (result from line 4) = cubic feet of storage volume needed

LIMITED POWER OF ATTORNEY

I hereby name and appoint:
MICHELLE SNYDER Printed Name of Appointee
Decor Doors Inc Company Name of Appointee

to be my lawful attorney-in-fact to act for me in applying to Government Commercial/Residential Permitting for a permit enabling work to be performed at the location below-described and to sign my name and do all things necessary to this appointment.

<u>25</u>	Section	
<u>23</u>	Township	
<u>29</u>	Range	
<u>5884</u>	Subdivision	
<u>15</u>	Block	
<u>120</u>	Lot	
<u>7157 Conway Cir Orlando</u>	Project Address	
<u>Pamela Stewart</u>	Owner of Property	
<u>7157 Conway Cir Orlando</u>	Owner Address	

Signed: Daniel T. Decker
certified contractor signature

Date: 1-4-14

Certified Contractor: Daniel T. Decker
printed name

Contractor License #: CBC 1250499

State of Florida
County of Orange

Sworn to and subscribed before me this 16 day of Jan 2014 by Daniel T. Decker (name of person acknowledged) who is personally known to me or who has produced (identification).

Leslie A. Tischler
Notary Public
Commission expires: _____

Florida Power of Attorney # 20091668

(not)

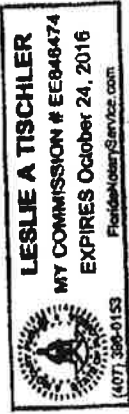



City of Belle Isle
 1600 Nela Avenue, Belle Isle, FL 32809
 Tel 407-851-7730 * Fax 407-240-2222 * www.cityofbelleislefl.org

Product Approval Form

DATE: 1-12-2014

PERMIT # _____

PROJECT ADDRESS 7157 Conway Circle

Belle Isle, FL 32809 32812

As required by Florida Statute 553.842 and Florida Administrative Code 9B-72m please provide the information and approval numbers of the building components listed below if they will be utilized on the building or structure. FL Approved products are listed online at www.floridabuilding.org or can be obtained from the local product supplier.

The following information must be available onsite for inspections:

1. Copy of this Product Approval Cover Sheet stamped with OCDBS approval
2. A copy of the manufacturer's installation details and requirements for each product stamped with OCDBS approval. (Approved in the office)
3. A copy of the internet screen showing PA#, approval, and code edition stamped with OCDBS approval.

Product Type	Manufacturer	Model/Series	FL Product Approval #	Product Type	Manufacturer	Model/Series	FL Product Approval #			
EXTERIOR DOORS										
Swinging	<i>Feld Wen</i>	<i>Wood Edge Slu</i>	<i>FL 12579.1</i>	Sliding	WALL PANELS					
				Soffits						
Other				Storefront						
				Glass Block						
				Other	ROOFING PRODUCTS					
WINDOWS										
Single/Dbf Hung				Asphalt Shingles*						
Horizontal Slider				Non Struct Metal						
Casement				Roofing Tiles	OTHER					
Fixed				Single Ply Roof						
Mullion				Other						
Skylights										
Other					STRUCTURAL COMPONENTS					
WOOD CONNECTORS										
Wood Connectors										
Wood Anchors										
Truss Plates										
Insulation Forms										
Lintels										
Other										

*Manufacturer's installation instructions for asphalt shingles are not required to be submitted to the office, but must be available onsite.

It is the applicant's responsibility to verify that specific products have been installed in accordance with their limitations and with the minimum required design pressures for the structure. Specific compliance will be verified during field inspections.

Applicant Signature *David T. Quinn*

Date 1-12-2014

RETAIN A COPY FOR OFFICE USE AND RETURN ORIGINAL TO APPLICANT
THE ORIGINAL IS A WHITE FORM - FORM #PRODAPP012



Product Approval Menu > Product or Application Search > Application List > Application Detail

FL # FL12509-R1
 Application Type Affirmation
 Code Version 2010
 Application Status Approved
 Comments
 Archived

Product Manufacturer JELD-WEN
 Address/Phone/Email 3737 Lakeport Blvd
 Klamath Falls, OR 97601
 (800) 535-3936
 fbc@jeld-wen.com

Authorized Signature Janet Gerard
 fbc@jeld-wen.com

Technical Representative Steve Saifell
 Address/Phone/Email 3737 Lakeport Blvd
 Klamath Falls, OR 97601
 (541) 882-3451 Ext 2900
 stevesa@jeld-wen.com

Quality Assurance Representative
 Address/Phone/Email

Category Exterior Doors
 Subcategory Swinging Exterior Door Assemblies

Compliance Method Certification Mark or Listing

Certification Agency Validated By National Accreditation & Management Institute,
 National Accreditation & Management Institute,

Referenced Standard and Year (of Standard) **Standard** **Year**
 ASTM-E330 2002
 ASTM-E331 2000
 TAS-202 1994

Equivalence of Product Standards
 Certified By

I affirm that there are no changes in the new Florida Building Code which affect my product(s) and my product(s) are in compliance with the new Florida Building Code.

Documentation from approved Evaluation or Validation Entity Yes No N/A

[FL12509_R1_COC_SA12509 signed and cert.pdf](#)

Product Approval Method

Method 1
 Option A

Date Submitted

12/19/2011

Date Validated

12/19/2011

Date Pending FBC Approval

01/05/2012

Date Approved

Summary of Products

PL #	Model, Number or Name	Description
12509.1	Gladiator/Finishield	12'-0" x 6'-8", Glazed, Steel, Wood Edge, Inswing Door System with and without Sidelites Certification Agency Certificate EL12509_R1_C_CAC_N1009861-R1.PDF Quality Assurance Contract Expiration Date 10/31/2012 Installation Instructions EL12509_R1_IL_JW192008.PDF Verified By: National Accreditation & Management Institute, Created by Independent Third Party: Evaluation Reports EL12509_R1_AE_Glad_Fin_Rpt.656_Inswing_Anchor Eval.PDF Created by Independent Third Party: Yes
12509.2	Gladiator/Finishield	12'-0" x 6'-8", Glazed, Steel, Wood Edge, Inswing Door System with and without Sidelites Certification Agency Certificate EL12509_R1_C_CAC_N1009861-R1.PDF Quality Assurance Contract Expiration Date 10/31/2012 Installation Instructions EL12509_R1_IL_JW192008.PDF Verified By: National Accreditation & Management Institute, Created by Independent Third Party: Evaluation Reports EL12509_R1_AE_Glad_Fin_Rpt.656_Inswing_Anchor Eval.PDF Created by Independent Third Party: Yes
12509.3	Gladiator/Finishield	12'-0" x 6'-8", Glazed, Steel, Wood Edge, Outswing Door System with and without Sidelites Certification Agency Certificate EL12509_R1_C_CAC_N1009861-R1.PDF Quality Assurance Contract Expiration Date 10/31/2012 Installation Instructions EL12509_R1_IL_JW122008.PDF Verified By: National Accreditation & Management Institute, Created by Independent Third Party: Evaluation Reports EL12509_R1_AE_Glad_Fin_Rpt.657_Outswing_Anchor Eval.PDF Created by Independent Third Party: Yes
12509.4	Gladiator/Finishield	12'-0" x 6'-8", Glazed, Steel, Wood Edge, Outswing Door System with and without Sidelites Certification Agency Certificate EL12509_R1_C_CAC_N1009861-R1.PDF Quality Assurance Contract Expiration Date 10/31/2012 Installation Instructions EL12509_R1_IL_JW122008.PDF Verified By: National Accreditation & Management Institute, Created by Independent Third Party: Evaluation Reports EL12509_R1_AE_Glad_Fin_Rpt.657_Outswing_Anchor Eval.PDF Created by Independent Third Party: Yes

[Back](#)

[Next](#)

JELD-WEN
GLADIATOR/FINISHIELD GLAZED
WOOD EDGE 12-0x8-8 INSWING
STEEL DOOR SYSTEM

GENERAL NOTES

1. THE PRODUCT SHOWN HEREIN IS DESIGNED TO COMPLY WITH THE CURRENT FLORIDA BUILDING CODE (FBC) BASED ON THE SIGNED AND SEALED DATE, INCLUDING HVHZ AND HAS BEEN EVALUATED IN ACCORDANCE WITH TAS 202-94 AND ASTM E930 AND ASTM E331.
2. 2X AND 1X WOOD BUCKS BY OTHERS, MUST BE ANCHORED PROPERLY TO TRANSFER LOADS TO THE STRUCTURE.
3. PRODUCT ANCHORS SHALL BE AS LISTED AND SPACED AS SHOWN ON DETAILS. ANCHOR EMBEDMENT TO BASE MATERIAL SHALL BE BEYOND WALL DRESSING OR STUCCO.
4. DESIGNED PRESSURE RATING SEE TABLE 1, PAGE 1.
5. FLORIDA APPROVED IMPACT RESISTANCE SHUTTERS ARE REQUIRED
6. SCALE BASED ON 11x17 SHEET SIZE.

DOOR LEAF CONSTRUCTION:

FACE SHEETS: THE FACE SHEETS ARE GLUED TO THE CORE AND SUBSTRATE WITH LMC ADHESIVE.
CORE DESIGN: THE CORE CONSISTS OF 1-1.25 POUND DENSITY EXPANDED POLYSTYRENE (EPS).
PANEL CONSTRUCTION: EACH DOOR PANEL IS CONSTRUCTED FROM TWO SHEETS OF 26-GAUGE (.018" MINIMUM) GALVANIZED STEEL. THE FACE SHEETS ARE BENT 90° OVER THE 1.885" X 1.0" LVL (LAMINATED VENEER LUMBER) STILES AND TOP RAIL. THE 1.885" X 1.203" BOTTOM RAIL CONSISTS OF ROLLED-FORMED GALVANIZED 26-GAUGE (.018" MINIMUM) STEEL. THE WOOD LOCK BLOCK IS 1.885" X 3 1/8" X 12".
FRAME CONSTRUCTION: THE FRAME JAMBS AND HEAD ARE CONSTRUCTED OF WOOD. THE SILL IS COMPRISED OF COMPOSITE MATERIAL WITH ALUMINUM CLADDING AND A SNAP FIT PLASTIC ADJUSTABLE HEIGHT THRESHOLD AND VINYL SIDELITE BILL SEAT. ALL CORNERS ARE COPED, BUTTED, SEALED USING SILICONE AND FASTENED USING THREE 16 GA. 7/16" X 2" LONG STAPLES PER CORNER. THE VERTICAL MULLIONS ARE FASTENED THROUGH THE HEAD AND SILL USING FOUR #8X1/2" SCREWS PER END. A 5/8" HOLE IS DRILLED AT THE CENTER OF THE SILL AND A PLASTIC COVER IS INSERTED TO RECEIVE THE BOTTOM ASTRAGAL BOLT. A 3/8" HOLE IS DRILLED AT THE CENTER OF THE FRAME HEAD AND A METAL STRIKE PLATE IS FASTENED USING TWO #8 X 1 1/2" SCREWS TO RECEIVE THE TOP ASTRAGAL BOLT. EACH FIXED PANEL IS SECURED INTO THE FRAME USING FOUR 16 GA. 7/16" X 2" LONG STAPLES PER STILE LOCATED 8" AND 30" FROM EACH END FASTENED THROUGH THE JAMBS. ALL MULLION JOINERY AND THE FIXED PANELS / FRAME JOINERY ARE SEALED AT THE INTERIOR AND EXTERIOR USING SILICONE.

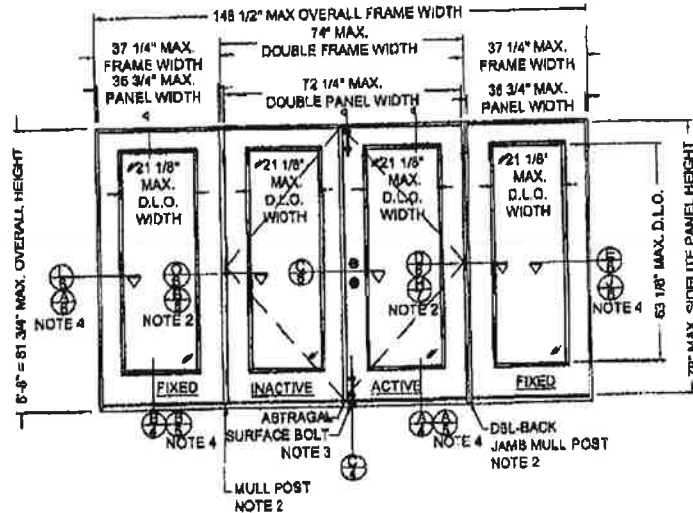

QUAD UNIT (OXXC)
(INSWING NON-IMPACT)

- NOTE:
1. ALL VIEWS FROM INTERIOR.
 2. MULL POSTS & DOUBLE BACK JAMBS ARE INTERCHANGEABLE
 3. SURFACE BOLT NOT REQUIRED FOR APPLICATIONS OF DP45 OR LESS.
 4. OPTIONAL MASONRY CONSTRUCTION.

TABLE 1

	DESIGN PRESSURE RATING	
	WHERE WATER INFILTRATION REQUIREMENT IS NEEDED	
	WITHOUT BOLTS	WITH SURFACE BOLTS
POSITIVE	±45	±55
NEGATIVE	±45	±55

SHT #	DESCRIPTION
1	TYPICAL ELEVATIONS & GENERAL NOTES
2	TYPICAL ELEVATIONS
3	TYPICAL ELEVATIONS
4	VERTICAL CROSS SECTIONS & BILL OF MATERIALS
5	VERTICAL & HORIZ. CROSS SECTIONS
6	HORIZONTAL CROSS SECTIONS
7	HORIZONTAL CROSS SECTIONS
8	ANCHORING LOCATIONS & DETAILS
9	ANCHORING LOCATIONS & DETAILS
10	ANCHORING LOCATIONS & DETAILS
11	ANCHORING LOCATIONS & DETAILS
12	UNIT COMPONENTS

Appendum to NAMI

JELD-WEN, INC.
3797 LAKEPORT BLVD.
KLAMATH FALLS, OR. 97601
PH. 541-882-3451

PRODUCT: GLADIATOR/FINISHIELD GLAZED WOOD EDGE 12-0x8-8 INSWING STEEL DOOR
PART OR ASSEMBLY: TYPICAL ELEVATIONS

NO.	DATE	BY	REVISIONS
1	04.08.09	WBD	
2		WBD	
3		S. FREY	

DATE: 04.08.09
SCALE: 3/8" = 1"
CHK. BY: S. FREY
DRAWING NO.: JW192008
SHEET 1 OF 12

Application No.: N1009861-R1
Reviewed By: [Signature]
Date Reviewed: 4/16/09

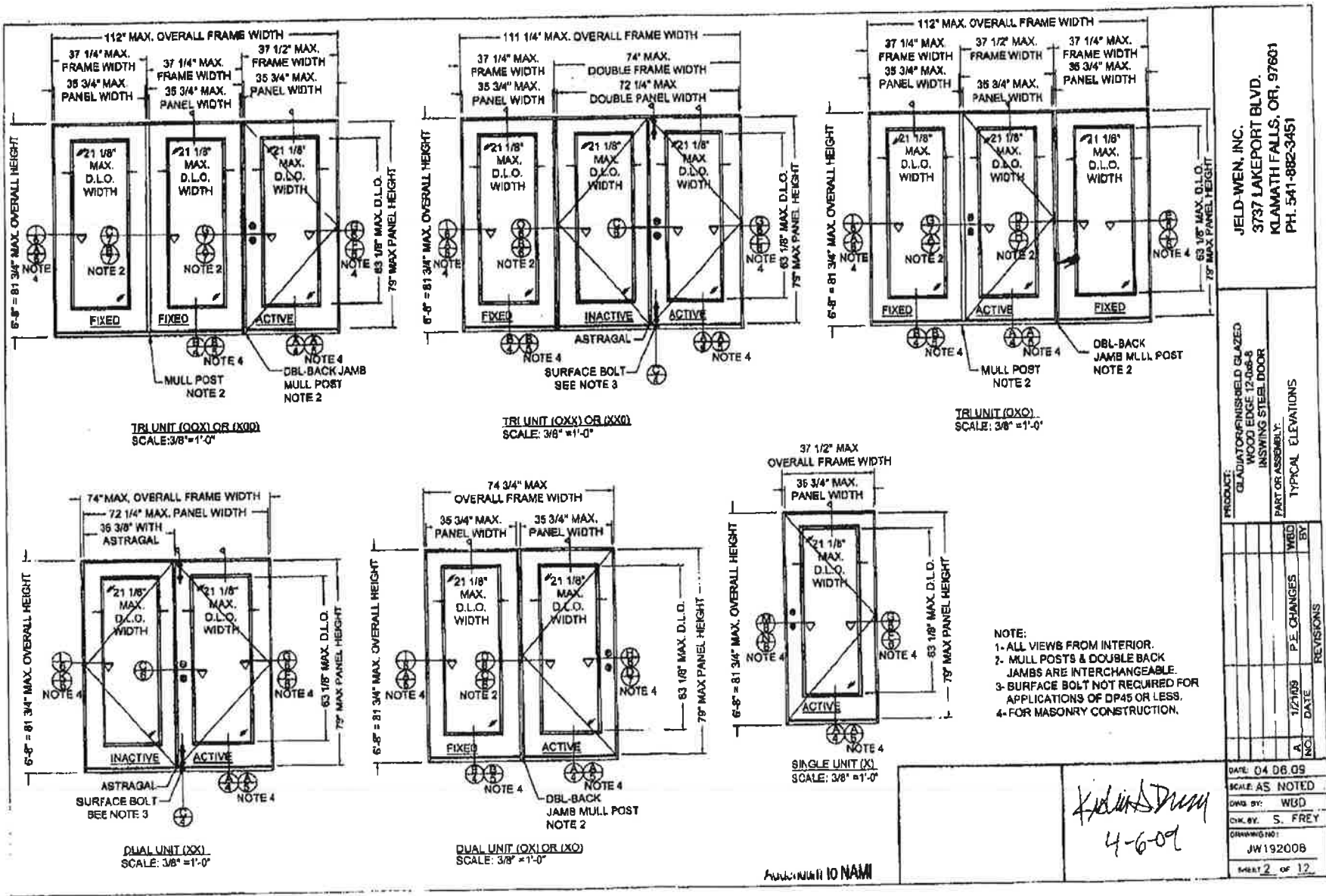

JELD-WEN, INC.
 3737 LAKEPORT BLVD.
 KLAMATH FALLS, OR, 97601
 PH. 541-882-3451

PRODUCT: GLAZED/UNFINISHED WOOD EDGE 17-06-8 INSWING STEEL DOOR
 PART OR ASSEMBLY: TYPICAL ELEVATIONS

NO.	DATE	BY	REVISIONS
1	12/15/09	WBD	P.E. CHANGES
2			
3			

DATE: 04.06.09
 SCALE: AS NOTED
 DWG BY: WBD
 CHK BY: S. FREY
 DRAWING NO: JW192008
 SHEET 2 OF 12

- NOTE:
- 1- ALL VIEWS FROM INTERIOR.
 - 2- MULL POSTS & DOUBLE BACK JAMBS ARE INTERCHANGEABLE.
 - 3- SURFACE BOLT NOT REQUIRED FOR APPLICATIONS OF DP45 OR LESS.
 - 4- FOR MASONRY CONSTRUCTION.

Kidman
 4-6-09

Modification No.: N1009861-R1
 Reviewed By: JU
 Date Reviewed: 4/16/09

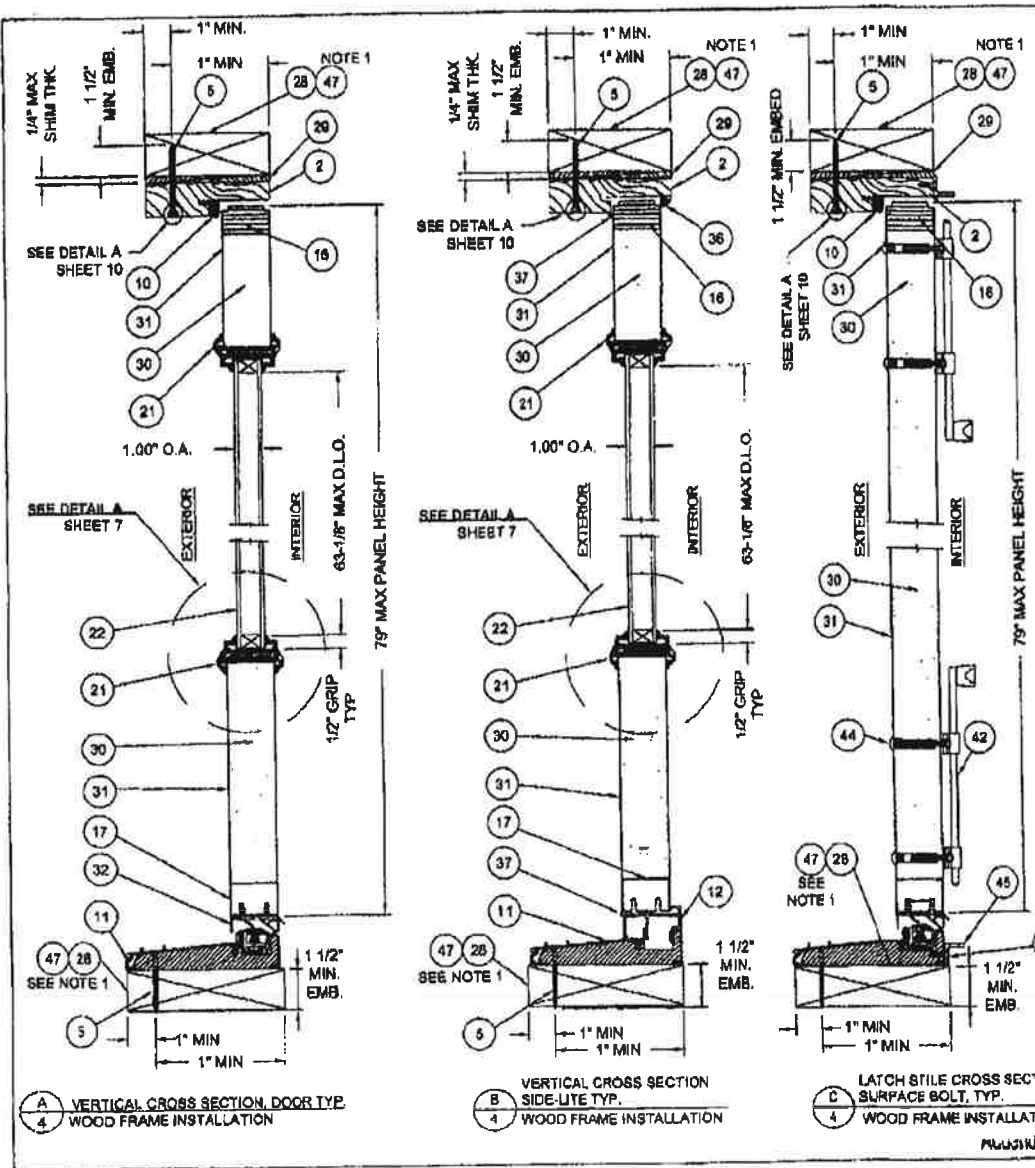

Item	DESCRIPTION	Material
1	HINGE JAMB (1 1/4"x4-5/8" FINGERJOINTED PINE)	PINE
2	HEAD JAMB (1 1/4"x6-5/8" FINGERJOINTED PINE)	PINE
3	LATCH JAMB (1 1/4"x4-5/8" FINGERJOINTED PINE)	PINE
4	SHOULDER JAMB (1 1/4"x4-5/8" FINGERJOINTED PINE)	PINE
5	#10 PHILLIPS FLATHEAD WOOD SCREW WITH 1 1/2" MIN. EMBEDMENT	STEEL
6	4" x 4" BUTT HINGE (2BA, 120° WH)	STEEL
7	#8 x 3/4" PHILLIPS FLATHEAD WOOD SCREW	STEEL
8	#10 x 1 1/2" PHILLIPS FLATHEAD WOOD SCREW	STEEL
9	3/16" ELCO TAPCON WITH 1 1/4" MIN. EMBEDMENT	STEEL
10	COMPRESSION WEATHERSTRIP (Lexel 8830)	ALUMINUM
11	INSWING THRESHOLD ENDURA MODEL LZ1822R0SR	ALUMINUM
12	720 SERIES SIDELITE SEAT (ENDURA)	ALUMINUM
13	EXTRUDED ASTRAGAL (GLOBAL PRODUCTS)	ALUMINUM
14	#10 x 1" PHILLIPS PAN HEAD SHEET METAL SCREW	STEEL
15	ATA STRIKE PLATE - RA (GLOBAL PRODUCTS)	STEEL
16	TOP RAIL (LAMINATED VENEER LUMBER)	LVL
17	BOTTOM RAIL (2GA 10 C18) GALVANIZED STEEL	STEEL
18	HINGE SIDE STILE (LAMINATED VENEER LUMBER)	LVL
19	LATCH SIDE STILE (LAMINATED VENEER LUMBER)	LVL
20	LOCK BLOCK x 1 1/2" LG PINE	PINE
21	ODL LITE FRAME	PLASTIC
22	1.00" OVER ALL INSULATED TEMPERED GLASS	GLASS
23	18 GA 1 1/2" CROWN x 2" LONG STAPLES	STEEL
24	PORRUGATED NAUL 1/2" x 1 1/4"	STEEL
25	KWIKSET LOCK SERIES 410	STEEL
26	KWIKSET DRAGBOLT SERIES 80	STEEL
27	#10 x 2" PHILLIPS FLATHEAD WOOD SCREW	STEEL
28	2x WOOD BUCK	WOOD
29	NON-COMPRESSION SHIM	WOOD
30	EXPANDED POLYSTYRENE (1.0 TO 1.25 lb DENSITY)	FOAM
31	STEEL DOOR PANEL SKIN MATERIAL (25 GA GALVANIZED A-625 COMMERCIAL QUALITY 0.018" MIN. THICK)	STEEL
32	INSWING VINYL DOOR BOTTOM SWEEP	VINYL
33	CORNER PADS 2", LOCATED AT THE BOTTOM OF EACH JAMB LEG SETTING ON TOP OF THE SILL BEHIND THE WEATHERSTRIP	FOAM
34	#8 x 1 1/2" PHILLIPS WOOD SCREW	STEEL
35	SOLID MULL POST, LAMINATED VENEER LUMBER (LVL)	WOOD
36	3/8" ROUNDED SCOTIA	WOOD
37	SILICONE BEAD	SILICONE
38	ODL MODEL 719 VENTED HALF LITE FRAME	PLASTIC
39	0.75" OVERALL INSULATED TEMPERED GLASS (VENT LITE PANELS)	GLASS
40	DOUBLE BACK JAMB, LAMINATED VENEER LUMBER (LVL)	LVL
41	#8 x 1" PHILLIPS FLATHEAD WOOD SCREW	STEEL
42	IVES SURFACE BOLT #84 6.0" LG. X .25" THK	STEEL
43	ASTRAGAL BOLT	STEEL
44	SEX BOLT 10-32 X 1-9/16 LG X 1/16 BARREL	STEEL
45	IVES SURFACE BOLT STRIKE PLATE	STEEL
46	#8 x 3/4" LG FLATHEAD WOODSCREWS FOR STRIKE PLATE	STEEL
47	OPTIONAL 1X WOOD BUCK	WOOD

NOTE 1: 1X MAY BE UTILIZED AS AN OPTION AS LONG AS MINIMUM ANCHOR EMBEDMENT DEPTH, INTO MASONRY OR WOOD, IS MAINTAINED.
 NOTE 2: OPTIONALLY ANCHOR CAN BE PLACED IN NARROW SECTION OF HEAD OR JAMB.

JELD-WEN, INC.
 3737 LAKEPORT BLVD.
 KLAMATH FALLS, OR, 97601
 PH. 541-882-3451

PRODUCT: GLAZIATOR/HIGHFIELD GLAZED WOOD EDGE 12-06-8 INSWING STEEL DOOR
 PART OR ASSEMBLY: VERTICAL CROSS SECTIONS

NO.	DATE	P.E. CHANGES	WBD BY	REVISIONS
1	04.08.09			

DATE: 04.08.09
 SCALE: 3" = 1'
 DWG. BY: WBD
 CHK BY: S. FREY
 DRAWING NO: JW1920C8
 SHEET 4 OF 12

Handwritten signature
 4-6-09

Revision No.: N1009361-R1
 Reviewed By: [Signature]
 Date Reviewed: 4/16/09

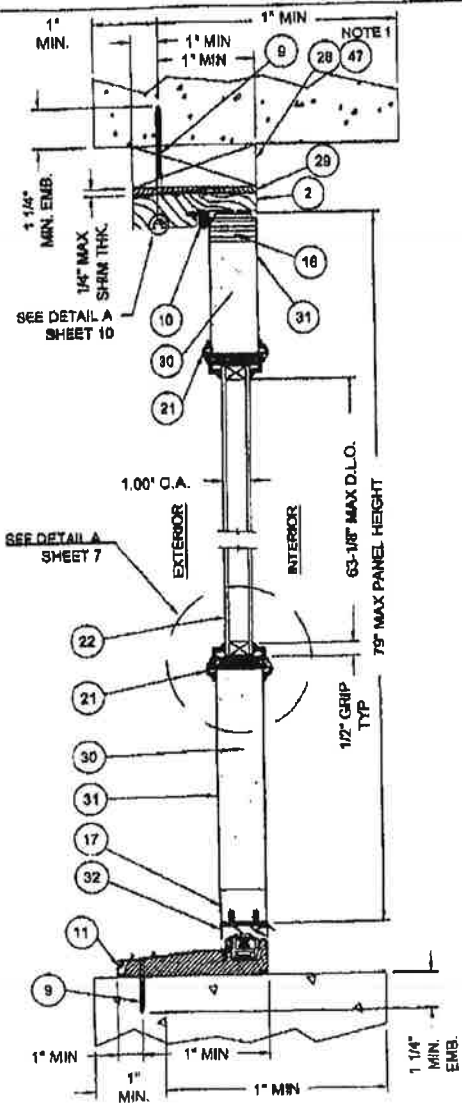

A VERTICAL CROSS SECTION, DOOR TYP. MASONRY INSTALLATION

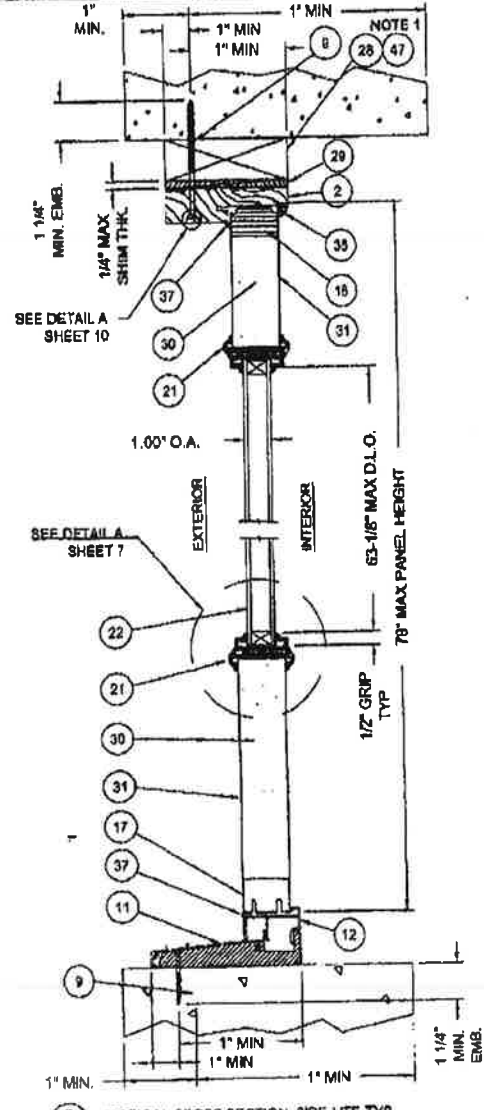

B VERTICAL CROSS SECTION, SIDE-LITE TYP. MASONRY INSTALLATION

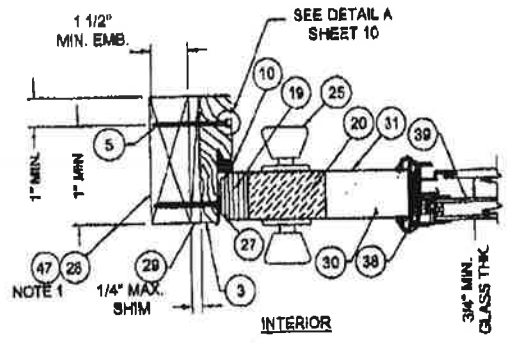

C HORIZONTAL CROSS SECTION WOOD INSTALLATION

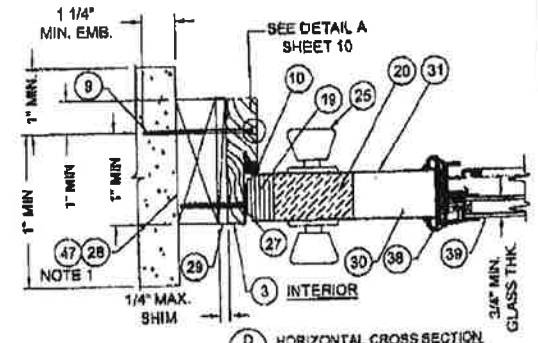

D HORIZONTAL CROSS SECTION MASONRY INSTALLATION

NOTE 1: 1X MAY BE UTILIZED AS AN OPTION AS LONG AS MINIMUM ANCHOR EMBEDMENT DEPTH, INTO MASONRY OR WOOD, IS MAINTAINED.
 NOTE 2: OPTIONALLY ANCHOR CAN BE PLACED IN NARROW SECTION OF HEAD OR JAMB.

JELD-WEN, INC.
 3737 LAKEPORT BLVD.
 KLAMATH FALLS, OR, 97601
 PH. 541-882-3451

PROJECT: GLADATOR/FINISH/ELD GLAZED WOOD EDGE 12-DIG-9 INSULATED STEEL DOOR
 PART OR ASSEMBLY: VERTICAL & HORIZONTAL CROSS SECTIONS

NO.	DATE	REVISIONS

DATE: 04.06.09
 SCALE: AS NOTED
 DWG. BY: WBC
 CHK. BY: S. FREY
 DRAWING NO.: JW192008
 SHEET 5 OF 12

Kidly Army
 4-6-09

Drawn No.: NI009361-21
 Reviewed By: [Signature]
 Date Reviewed: 4/16/09

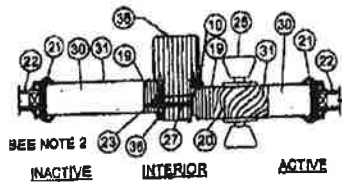

SEE NOTE 2
INACTIVE INTERIOR ACTIVE
A HORIZONTAL CROSS SECTION
7 VIEW AT SOLID MULL POST

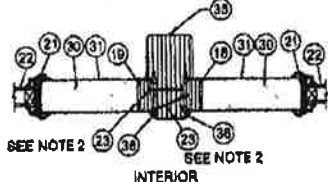

SEE NOTE 2
B HORIZONTAL CROSS SECTION
7 VIEW AT SOLID MULL POST

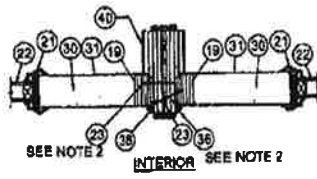

SEE NOTE 2
C HORIZONTAL CROSS SECTION
7 VIEW AT DBL BACK JAMB

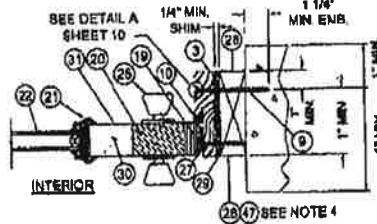

SEE DETAIL A SHEET 10
D HORIZONTAL CROSS SECTION
7 VIEW AT DOOR LATCH SIDE JAMB (MASONRY INSTALL)

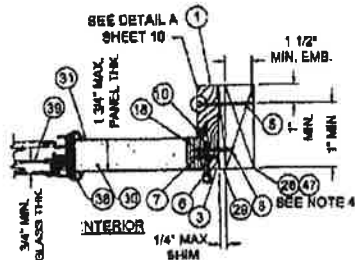

SEE DETAIL A SHEET 10
E HORIZONTAL CROSS SECTION
7 VIEW AT DOOR HINGE/SIDE JAMB (WOOD INSTALL)

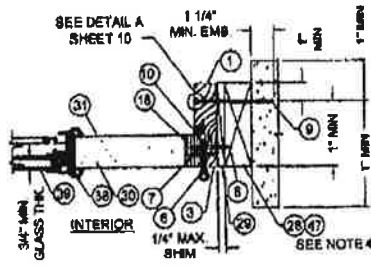

SEE DETAIL A SHEET 10
F HORIZONTAL CROSS SECTION
7 VIEW AT DOOR HINGE/SIDE JAMB (MASONRY INSTALL)

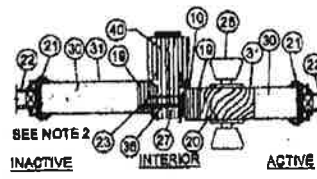

SEE NOTE 2
G HORIZONTAL CROSS SECTION
7 VIEW AT DBL BACK JAMB

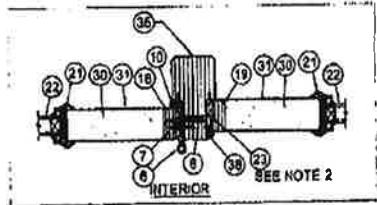

H HORIZONTAL CROSS SECTION
7 VIEW AT SOLID MULL POST

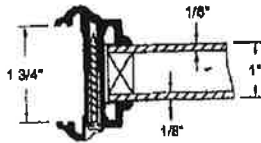

INTERIOR
GLAZING DETAIL A
SCALE: 8" = 1'-0"

NOTES:

- FOR ANCHOR SPACING, SEE SHEETS 8, 9, 10 & 11.
- SPACING FOR #23 FROM TOP DOWN: 8'-28" - 50" - 73".
- ASTRAGAL SCREW PATTERN SPACING FOR #13 FROM TOP DOWN: 1/2", 2", 3 1/2", 20", 24 3/4", 38".
- 1X MAY BE UTILIZED AS AN OPTION AS LONG AS MINIMUM ANCHOR EMBEDMENT DEPTH, INTO MASONRY OR WOOD, IS MAINTAINED.
- OPTIONALLY ANCHOR CAN BE PLACED IN NARROW SECTION OF HEAD OR JAMB.

JELD-WEN, INC.
3737 LAKEPORT BLVD.
KLAMATH FALLS, OR, 97601
PH. 541-882-3451

PRODUCT: GLAZED/UNFINISHED GLAZED
WOOD EDGE 12-04-3
INSWING STEEL DOOR
PART OR ASSEMBLY:
HORIZONTAL CROSS SECTION

NO.	DATE	BY	REVISIONS
A	12/10/08	WBD	

DATE: 04.06.09
SCALE: 3" = 1'
DWG BY: WBD
CHK BY: S. FREY
DWG NO: JW192008
SHEET 7 OF 12

Kyle Atmy
4-6-09

REVISION 10 NAMI

Certification No.: N1009861-21
Reviewed By: LD
Date Reviewed: 4/16/09

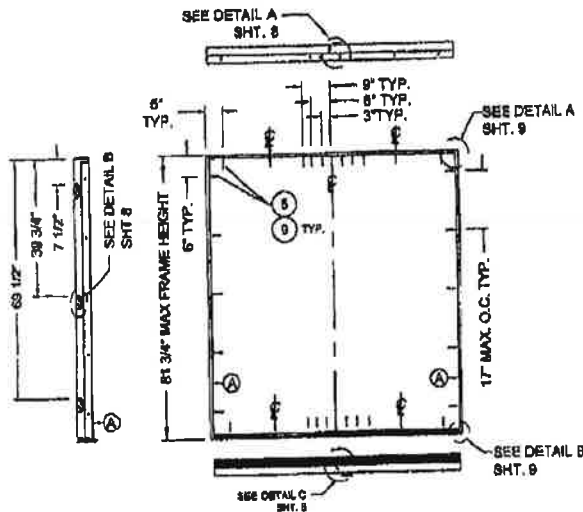

ANCHORING LOCATIONS
DOUBLE INSWING UNIT (2X)
SCALE: 3/8" = 1'-0"

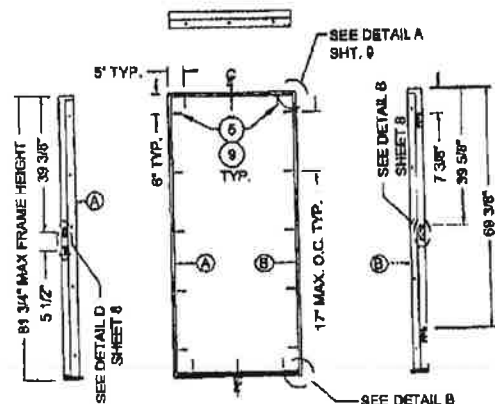

ANCHORING LOCATIONS
SINGLE INSWING UNIT (X)
SCALE: 3/8" = 1'-0"

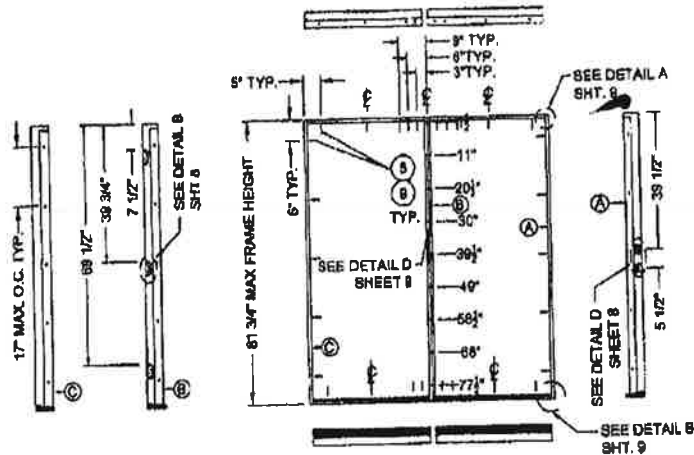

ANCHORING LOCATIONS
SINGLE INSWING UNIT W/ 1 SIDELITE (OX)
SCALE: 3/8" = 1'-0"

3/16" C-SINK



NOTE

1. USE #10 WOOD INSTALLATION SCREW W/ 1.50" MIN. EMBEDMENT WHEN INSTALLING INTO WOOD SUBSTRATE.
2. USE #8 x 2 1/2" PFH WOOD SCREW WHEN INSTALLING INTO MULLIONS.
3. USE 3/16" ELCO TAPCON ANCHOR W/ 1 1/4" MIN. EMBED. WHEN INSTALLING INTO CONCRETE/MASONRY SUBSTRATE.
4. SCREW AND TAPCON ANCHORS CAN BE EMBEDDED IN EITHER THE 1 1/4" OR 3/4" THICK PORTION OF THE JAMB AS LONG AS THE SUBSTRATE EMBEDMENT IS MAINTAINED.

DETAIL - A
SCALE: 1/4" = 1'-0"

NOTES:

1. CORRUGATED STAPLES TO BE APPLIED ON BOTH INTERIOR AND EXTERIOR SURFACES AT SPACING SHOWN ON OXXX MODEL (SEE SHEET 8) +/- 1". FOR TOTAL OF NINE FASTENERS PER SIDE.
2. ALL VIEWS FROM INTERIOR
3. CORRUGATED NAILS ARE UTILIZED ON DOUBLE BACK JAMBS ONLY. OMIT NAILS ON SOLID MULL POST CONFIGURATIONS.

JELD-WEN, INC.
3737 LAKEPORT BLVD.
KLAMATH FALLS, OR, 97601
PH. 541-882-3451

PRODUCT: GLAZED
WOOD EDGE 12-66-8
INSWING STEEL DOOR
PART OR ASSEMBLY:
ANCHORING LOCATIONS
& DETAILS

NO.	DATE	P.E. CHANGES	WRD BY
A	12/1/09		

DATE:	04.08.09
SCALE:	AS NOTED
CHKD BY:	WRD
CHKD BY:	S. FREY
DRAWING NO:	JW192008
SHEET 10 OF 12	

Handwritten signature and date:
4-6-09

Revision No.: N1009861-21
Reviewed By: [Signature]
Date Reviewed: 4/16/09

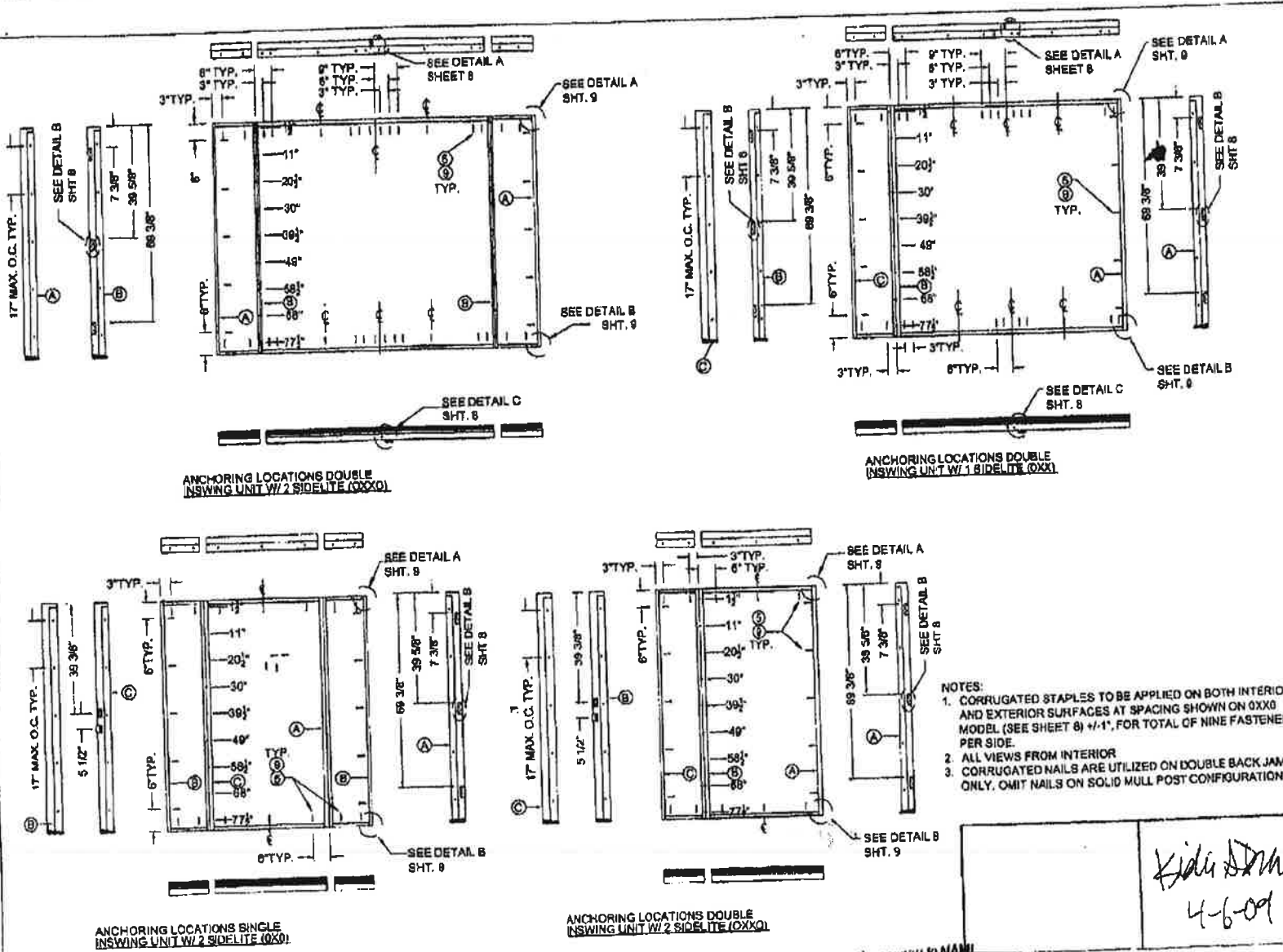

JELD-WEN, INC.
 3787 LAKEPORT BLVD.
 KLAMATH FALLS, OR, 97601
 PH. 541-882-3451

PRODUCT: GLAZIANT OR FINISH-WELED GLAZED WOOD EDGE 1X4-6X6 INSWING STEEL DOOR FIBER OR ASSEMBLY.
 ANCHORING LOCATIONS & DETAILS

NO.	DATE	BY	REVISIONS
1	1/21/09	WBD	P.E. CHANGES

- NOTES:
- CORRUGATED STAPLES TO BE APPLIED ON BOTH INTERIOR AND EXTERIOR SURFACES AT SPACING SHOWN ON 0XX0 MODEL (SEE SHEET 8) +1", FOR TOTAL OF NINE FASTENERS PER SIDE.
 - ALL VIEWS FROM INTERIOR
 - CORRUGATED NAILS ARE UTILIZED ON DOUBLE BACK JAMBS ONLY. OMIT NAILS ON SOLID MULL POST CONFIGURATIONS.

DATE: 04.08.09
 SCALE: 3/8"=1"
 DWG. BY: WBD
 CHK. BY: S. FREY
 DRAWING NO.: JW192008
 SHEET 11 OF 12

Kidder
 4-6-09

Revision No.: 411009361-R1
 Reviewed By: [Signature]
 Date Reviewed: 4/16/09

NAMI NOTICE OF PRODUCT LINE CERTIFICATION

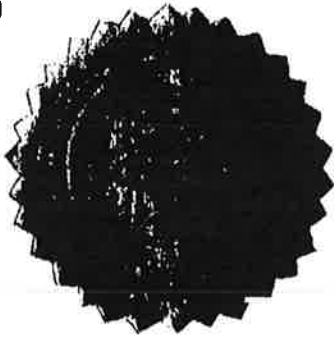

Certification No.: NI009861-R1 Page 1
Date: 04/14/2009
Revision Date: 04/16/2009
Certification Program: Structural
Company: Jeld-Wen
Code: J-104-3

The "Notice of Product Line Certification" is valid only when Administrator's Seal is applied to the upper left hand portion of this form and a certification label is applied to the product. This certification seal represents product conformity to the applicable specification and that all certification criteria has been satisfied.

The products and systems listed below are approved for listing in the Directory of Certified Products at www.NAMICertification.com. Please review, and advise NAMI immediately if data, as shown requires corrections.

Company: Jeld-Wen Exterior Doors
3737 Lakeport Boulevard
Klamath Falls, OR 97601

Product Line: Jeld-Wen Gladiator/Finishield Glazed Wood-Edge Steel Double
Doors with Glazed Fixed Side-Lites

Test Report: NCTL-210-3558-1 & NCTL-210-3558-1A

Section 1: General Description of the Products and Systems under this Certification

- 1.1 **Frame:** The frame jambs consist of wood with all corners coped and butted. The head/jamb corners were fastened with three (4) 16 ga 7/16" crown x 2" long staples per corner. The threshold was attached to the side jambs with three (3) 16 ga 1/4" crown x 2" long wire staples at each end.
- 1.2 **Door Panel/Sidelite Construction:** Each door panel was constructed from two (2) face sheets of 25 gauge (0.018" minimum) galvanized steel and an internal expanded polystyrene foam core.
- 1.3 **Sidelite Glazing:** The overall insulated glass unit was comprised of two (2) 1/8" sheets of clear tempered glass.

National Accreditation & Management Institute, Inc.
11870 Merchants Walk Suite 202-Newport News, VA 23606
TEL(757) 594.8658 FAX(757)594-8659

Section 2: Registered Suppliers

2.1	Door Lites:	ODL
2.2	Astragal:	Global
2.3	Sills	Endura, AFCCO

See additional Pages of Certification for Certified Product Line Matrix(s) and Installation Details. If you have any questions regarding this certification, please contact NAMI at (757)594-8658.

National Accreditation & Management Institute, Inc.
11870 Merchants Walk Suite 202-Newport News, VA 23606
TEL(757) 594.8658 FAX(757)594-8659

NOTICE OF PRODUCT CERTIFICATION

Company: Jeld-Wen Exterior Doors
3737 Lakeport Boulevard
Klamath Falls, OR 97601

Certification No.: NI009861-R1 Page 3
Certification Date: 04/14/2009
Expiration Date: 10/31/2012
Revision Date: 04/16/2009

Product: Series "Gladiator/Finishield Glazed Wood Edge Steel Doors w/ or w/o Side-Lites (w/Wood Frame unless noted)

Specifications Tested To: TAS 202-94/ASTM E283-04/E330-02/E331-00

The "Notice of Product Certification" is only valid if the NAMI Certification Label has been applied to the product as described within this document. The certification label represents product conformity to the applicable specification and that all certification criteria has been satisfied. This product has been approved for listing within NAMI's Certified Product Listing at www.Namincertification.com. NAMI's Certification Program is accredited by The American National Standards Institute (ANSI).

Configuration	In-swing or Out-swing	Glazed or Opaque	Maximum Size	Design Pressure Pos/Neg	Missile Impact Rated	Test Report Number Drawing Number & Comments
X Single	I/S or O/S	Glazed	3'2" x 6'10"	+45/-45	No	NCTL-210-3558-1/210-3558-1A Max Panel Size: 3'0" x 6'7" Daylight Opening: 1'9" x 5'3" w/o Surface Bolts Installation Details: JW122008(1-12)/JW192008(1-12)
X Single	I/S or O/S	Glazed	3'2" x 6'10"	+55/-55	No	NCTL-210-3558-1/210-3558-1A Max Panel Size: 3'0" x 6'7" Daylight Opening: 1'9" x 5'3" w/Surface Bolts Installation Details: JW122008(1-12)/JW192008(1-12)
OX/XO Single w/Sidelite	I/S or O/S	Glazed	6'3" x 6'10"	+45/-45	No	NCTL-210-3558-1/210-3558-1A Max Panel Size: 3'0" x 6'7" Daylight Opening: 1'9" x 5'3" w/o Surface Bolts Installation Details: JW122008(1-12)/JW192008(1-12)
OX/XO Single w/Sidelite	I/S or O/S	Glazed	6'3" x 6'10"	+55/-55	No	NCTL-210-3558-1/210-3558-1A Max Panel Size: 3'0" x 6'7" Daylight Opening: 1'9" x 5'3" w/Surface Bolts Installation Details: JW122008(1-12)/JW192008(1-12)
XX Double	I/S or O/S	Glazed	6'2" x 6'10"	+45/-45	No	NCTL-210-3558-1/210-3558-1A Max Panel Size: 3'0" x 6'7" Daylight Opening: 1'9" x 5'3" w/o Surface Bolts Installation Details: JW122008(1-12)/JW192008(1-12)
XX Double	I/S or O/S	Glazed	6'2" x 6'10"	+55/-55	No	NCTL-210-3558-1/210-3558-1A Max Panel Size: 3'0" x 6'7" Daylight Opening: 1'9" x 5'3" w/Surface Bolts Installation Details: JW122008(1-12)/JW192008(1-12)

National Accreditation & Management Institute, Inc./11870 Merchants Walk Suite 202/Newport News, VA 23606
Tel-757.594.8658/Fax-757.594.8659

NAMI AUTHORIZED SIGNATURE: _____

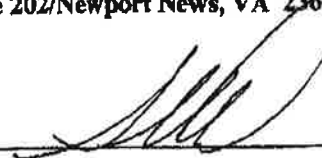

NOTICE OF PRODUCT CERTIFICATION

Company: Jeld-Wen Exterior Doors
3737 Lakeport Boulevard
Klamath Falls, OR 97601

Certification No.: NI009861-R1 Page 4
Certification Date: 04/14/2009
Expiration Date: 10/31/2012
Revision Date: 04/16/2009

Product: Series "Gladiator/Finishield Glazed Wood Edge Steel Doors w/ or w/o Side-Lites (w/Wood Frame unless noted)

Specifications Tested To: TAS 202-94/ASTM E283-04/E330-02/E331-00

The "Notice of Product Certification" is only valid if the NAMI Certification Label has been applied to the product as described within this document. The certification label represents product conformity to the applicable specification and that all certification criteria has been satisfied. This product has been approved for listing within NAMI's Certified Product Listing at www.Namjcertification.com. NAMI's Certification Program is accredited by The American National Standards Institute (ANSI).

Configuration	In-swing or Out-swing	Glazed or Opaque	Maximum Size	Design Pressure Pos/Neg	Missile Impact Rated	Test Report Number Drawing Number & Comments
OXX/XXO Double w/Sidelite	I/S or O/S	Glazed	9'3" x 6'10"	+45/-45	No	NCTL-210-3558-1/210-3558-1A Max Panel Size: 3'0" x 6'7" Daylight Opening: 1'9" x 5'3" w/o Surface Bolts Installation Details: JW122008(1-12)/JW192008(1-12)
OXX/XXO Double w/Sidelite	I/S or O/S	Glazed	9'3" x 6'10"	+55/-55	No	NCTL-210-3558-1/210-3558-1A Max Panel Size: 3'0" x 6'7" Daylight Opening: 1'9" x 5'3" w/Surface Bolts Installation Details: JW122008(1-12)/JW192008(1-12)
OXO Single w/Sidelites	I/S or O/S	Glazed	9'4" x 6'10"	+45/-45	No	NCTL-210-3558-1/210-3558-1A Max Panel Size: 3'0" x 6'7" Daylight Opening: 1'9" x 5'3" w/o Surface Bolts Installation Details: JW122008(1-12)/JW192008(1-12)
OXO Single w/Sidelites	I/S or O/S	Glazed	9'4" x 6'10"	+55/-55	No	NCTL-210-3558-1/210-3558-1A Max Panel Size: 3'0" x 6'7" Daylight Opening: 1'9" x 5'3" w/Surface Bolts Installation Details: JW122008(1-12)/JW192008(1-12)
OXXO Double w/Sidelites	I/S or O/S	Glazed	12'5" x 6'10"	+45/-45	No	NCTL-210-3558-1/210-3558-1A Max Panel Size: 3'0" x 6'7" Daylight Opening: 1'9" x 5'3" w/o Surface Bolts Installation Details: JW122008(1-12)/JW192008(1-12)
OXXO Double w/Sidelites	I/S or O/S	Glazed	12'5" x 6'10"	+55/-55	No	NCTL-210-3558-1/210-3558-1A Max Panel Size: 3'0" x 6'7" Daylight Opening: 1'9" x 5'3" w/Surface Bolts Installation Details: JW122008(1-12)/JW192008(1-12)

National Accreditation & Management Institute, Inc./11870 Merchants Walk Suite 202/Newport News, VA 23606
Tel-757.594.8658/Fax-757.594.8659

NAMI AUTHORIZED SIGNATURE: _____

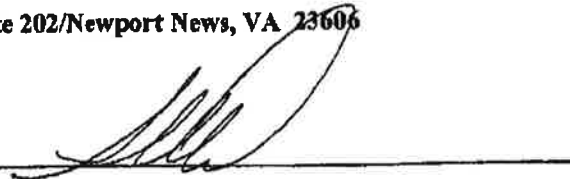

Stewart Residence
7157 Conway Cir
Orlando, FL 32809



Opening will meet 35 PSF +/- requirement

Replace front entry door unit



DECK000-01

MATERAT

CERTIFICATE OF LIABILITY INSURANCEDATE (MM/DD/YYYY)
1/30/2014

THIS CERTIFICATE IS ISSUED AS A MATTER OF INFORMATION ONLY AND CONFERS NO RIGHTS UPON THE CERTIFICATE HOLDER. THIS CERTIFICATE DOES NOT AFFIRMATIVELY OR NEGATIVELY AMEND, EXTEND OR ALTER THE COVERAGE AFFORDED BY THE POLICIES BELOW. THIS CERTIFICATE OF INSURANCE DOES NOT CONSTITUTE A CONTRACT BETWEEN THE ISSUING INSURER(S), AUTHORIZED REPRESENTATIVE OR PRODUCER, AND THE CERTIFICATE HOLDER.

IMPORTANT: If the certificate holder is an ADDITIONAL INSURED, the policy(ies) must be endorsed. If SUBROGATION IS WAIVED, subject to the terms and conditions of the policy, certain policies may require an endorsement. A statement on this certificate does not confer rights to the certificate holder in lieu of such endorsement(s).

PRODUCER Insurance Office of America-LNG 1855 West State Road 434 Longwood, FL 32750		CONTACT NAME: PHONE (A/C No. Ext): (407) 788-3000 FAX (A/C. No.): (407) 788-7933 E-MAIL: ADDRESS:	
INSURED Decker Doors, Inc. 724 Brooks Ct. Winter Springs, FL 32708		INSURER(S) AFFORDING COVERAGE INSURER A : Mid-Continent Casualty Company INSURER B : INSURER C : INSURER D : INSURER E : INSURER F :	
		NAIC # 23418	

COVERAGES**REVISION NUMBER:**

THIS IS TO CERTIFY THAT THE POLICIES OF INSURANCE LISTED BELOW HAVE BEEN ISSUED TO THE INSURED NAMED ABOVE FOR THE POLICY PERIOD INDICATED. NOTWITHSTANDING ANY REQUIREMENT, TERM OR CONDITION OF ANY CONTRACT OR OTHER DOCUMENT WITH RESPECT TO WHICH THIS CERTIFICATE MAY BE ISSUED OR MAY PERTAIN, THE INSURANCE AFFORDED BY THE POLICIES DESCRIBED HEREIN IS SUBJECT TO ALL THE TERMS, EXCLUSIONS AND CONDITIONS OF SUCH POLICIES. LIMITS SHOWN MAY HAVE BEEN REDUCED BY PAID CLAIMS.

INSR LTR	TYPE OF INSURANCE	ADDITIONAL SUBRS INSR WVD	POLICY NUMBER	POLICY EFF (MM/DD/YYYY)	POLICY EXP (MM/DD/YYYY)	POLICY LIMITS
A	GENERAL LIABILITY <input checked="" type="checkbox"/> COMMERCIAL GENERAL LIABILITY <input type="checkbox"/> CLAIMS-MADE <input checked="" type="checkbox"/> OCCUR		04GL000888174	10/28/2013	10/28/2014	EACH OCCURRENCE \$ 1,000,000 DAMAGE TO RENTED PREMISES (Ea occurrence) \$ 100,000 MED EXP (Any one person) \$ PERSONAL & ADV INJURY \$ 1,000,000 GENERAL AGGREGATE \$ 2,000,000 PRODUCTS - COMPIOP AGG \$ 2,000,000
	GEN'L AGGREGATE LIMIT APPLIES PER: <input checked="" type="checkbox"/> POLICY <input type="checkbox"/> PRO-JECT <input type="checkbox"/> LOC					
	AUTOMOBILE LIABILITY ANY AUTO ALL OWNED AUTOS HIRED AUTOS					COMBINED SINGLE LIMIT (Ea accident) \$ BODILY INJURY (Per person) \$ BODILY INJURY (Per accident) \$ PROPERTY DAMAGE (PER ACCIDENT) \$ \$
	UMBRELLA LIAB EXCESS LIAB					EACH OCCURRENCE \$ AGGREGATE \$
	DED \$ RETENTION \$					WG STATUS: <input type="checkbox"/> OTH-ER E.L. - EACH ACCIDENT \$ E.L. - DISEASE - EA EMPLOYEE \$ E.L. - DISEASE - POLICY LIMIT \$
	WORKERS COMPENSATION AND EMPLOYERS' LIABILITY ANY PROPRIETOR/PARTNER/EXECUTIVE OFFICER/MEMBER EXCLUDED? <input type="checkbox"/> (Mandatory in NH) If yes, describe under DESCRIPTION OF OPERATIONS below					

DESCRIPTION OF OPERATIONS / LOCATIONS / VEHICLES (Attach ACORD 101, Additional Remarks Schedule, if more space is required)

CERTIFICATE HOLDER**CANCELLATION**

	SHOULD ANY OF THE ABOVE DESCRIBED POLICIES BE CANCELLED BEFORE THE EXPIRATION DATE THEREOF, NOTICE WILL BE DELIVERED IN ACCORDANCE WITH THE POLICY PROVISIONS.
City of Belle Isle 3532 Maggie Blvd. Orlando, FL 32811	AUTHORIZED REPRESENTATIVE

ACORD 25 (2010/05)

The ACORD name and logo are registered marks of ACORD

© 1988-2010 ACORD CORPORATION. All rights reserved.



02-03-2012

JEFF ATWATER
CHIEF FINANCIAL OFFICER

STATE OF FLORIDA
DEPARTMENT OF FINANCIAL SERVICES
DIVISION OF WORKERS' COMPENSATION

* * CERTIFICATE OF ELECTION TO BE EXEMPT FROM FLORIDA WORKERS' COMPENSATION LAW * *
CONSTRUCTION INDUSTRY EXEMPTION

This certifies that the individual listed below has elected to be exempt from Florida Workers' Compensation law.

EFFECTIVE DATE: 03/05/2012
PERSON: DECKER
FEIN: 593713342
BUSINESS NAME AND ADDRESS:
DECKER DOORS INC
724 BROOKS COURT
WINTER SPRINGS FL 32708

EXPIRATION DATE: 03/05/2014
DANIEL T

SCOPE OF BUSINESS OR TRADE:
1- DOOR INSTALLATION

IMPORTANT: Pursuant to Chapter 448 - 98714, F.S., an officer of a corporation who elects exemption from this chapter by filing a certificate of election under this section may not recover benefits or compensation under this chapter. Pursuant to Chapter 440.05(12), F.S., Certificates of election to be exempt... apply only within the scope of the business or trade listed on the notice of election to be exempt. Pursuant to Chapter 440.05(13), F.S., Notices of election to be exempt and certificates of election to be exempt shall be subject to revocation if, at any time after the filing of the notice or the issuance of the certificate, the person named on the notice or certificate no longer meets the requirements of this section for issuance of a certificate. The department shall revoke a certificate at any time for failure of the person named on the certificate to meet the requirements of this section.

IC-252 CERTIFICATE OF ELECTION TO BE EXEMPT REVISED 01-11

QUESTIONS? (850) 413-1609

PLEASE CUT OUT THE CARD BELOW AND RETAIN FOR FUTURE REFERENCE

STATE OF FLORIDA
DEPARTMENT OF FINANCIAL SERVICES
DIVISION OF WORKERS' COMPENSATION
CONSTRUCTION INDUSTRY
CERTIFICATE OF ELECTION TO BE EXEMPT FROM FLORIDA
WORKERS' COMPENSATION LAW



EFFECTIVE DATE: 03/05/2012 EXPIRATION DATE: 03/05/2014
PERSON: DANIEL T DECKER

FEIN: 593713342
BUSINESS NAME AND ADDRESS:
DECKER DOORS INC
724 BROOKS COURT
WINTER SPRINGS, FL 32708

SCOPE OF BUSINESS OR TRADE:
1- DOOR INSTALLATION

IMPORTANT

F Pursuant to Chapter 440.05(14), F.S., an officer of a corporation who
O elects exemption from this chapter by filing a certificate of election
L under this section may not recover benefits or compensation under this
D chapter.

H Pursuant to Chapter 440.05(12), F.S., Certificates of election to be
E exempt... apply only within the scope of the business or trade listed on
R the notice of election to be exempt.

E Pursuant to Chapter 440.05(13), F.S., Notices of election to be exempt
and certificates of election to be exempt shall be subject to revocation
if, at any time after the filing of the notice or the issuance of the
certificate, the person named on the notice or certificate no longer meets
the requirements of this section for issuance of a certificate. The
department shall revoke a certificate at any time for failure of the
person named on the certificate to meet the requirements of this
section.

QUESTIONS? (850) 413-1609

CUT HERE

* Carry bottom portion on the job, keep upper portion for your records.



STATE OF FLORIDA

DEPARTMENT OF BUSINESS AND PROFESSIONAL REGULATION

CONSTRUCTION INDUSTRY LICENSING BOARD
1940 NORTH MONROE STREET
TALLAHASSEE

(850) 487-1395

FL 32399-0783

DECKER, DANIEL TRACEY
DECKER DOORS INC
724 BROOKS CT.
WINTER SPRINGS

FL 32708

Congratulations! With this license you become one of the nearly one million Floridians licensed by the Department of Business and Professional Regulation. Our professionals and businesses range from architects to yacht brokers, from boxers to barbecue restaurants, and they keep Florida's economy strong.

Every day we work to improve the way we do business in order to serve you better. For information about our services, please log onto www.myfloridalicense.com. There you can find more information about our divisions and the regulations that impact you, subscribe to department newsletters and learn more about the Department's initiatives.

Our mission at the Department is: License Efficiently, Regulate Fairly. We constantly strive to serve you better so that you can serve your customers. Thank you for doing business in Florida, and congratulations on your new license!

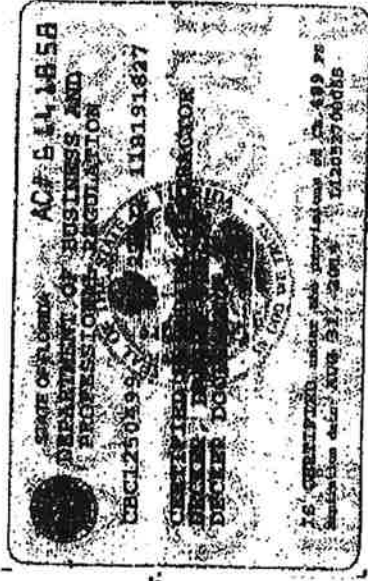

DETACH HERE

2#6141858

STATE OF FLORIDA

DEPARTMENT OF BUSINESS AND PROFESSIONAL REGULATION
CONSTRUCTION INDUSTRY LICENSING BOARD

STATE LICENSE NUMBER LICENSE NBR

05/27/2013 188191827 CBCL250499

THE BUILDING CONTRACTOR

NAME BELOW IS CERTIFIED

UNDER THE PROVISIONS OF CHAPTER

EXPIRATION DATE: AUG 31, 2014

DECKER, DANIEL TRACEY
DECKER DOORS INC
724 BROOKS CT.
WINTER SPRINGS

FL 32708



RICK SCOTT
GOVERNOR

KEN LAWSON
SECRETARY

DISPLAY AS REQUIRED BY LAW

SEQ# 111052700055

CITY OF WINTER SPRINGS BUSINESS TAX RECEIPT

1126 East State Road 434
Winter Springs, FL 32708

Owner's Name and Mailing Address:

DANIEL T DECKER
724 BROOKS COURT
WINTER SPRINGS, FL 32708

Business ID: 425
Tax Year: 2014
Valid: 10/01/2013 - 09/30/2014
Fee: \$45.00
REGULATED B

Business Location:
724 BROOKS
Category:
HBO2 - CASH HOME BASED

Business Name:
DECKER DOORS INC

Dear Owner of Winter Springs:

This is to certify that the Business Tax Receipt which also includes
Seminole County Business Tax. Please note receipts are renewed
automatically each year unless we are otherwise notified.

Renewal requires that a copy of the active communication or license
be submitted with the renewal application.



Handwritten signature

City Manager

*** Business Tax must be exhibited conspicuously at your place of business ***